

"NOT FOR FINAL RECORDING"
TOTAL AREA = 7.22 ± ACRES

PARCEL: 055 038 ZONED: B-G

REZONE REQUEST: CURRENTLY ZONED B-G
REQUESTING L-M ZONING TO ALLOW FOR THE
LUXURY LANDSCAPE SUPPLY DEVELOPMENT.
TOTAL SITE AREA = 7.22 ± ACRES

PROPOSED USE = LANDSCAPE SUPPLY RETAILER

NOTES:

- BOUNDARY SURVEY INFORMATION TAKEN FROM A SURVEY BY XXXXXX,
DATED XX/XX/2024
- THERE ARE NO NWI WETLAND ON THE SITE.
- UN-NAMED TRIBUTARY OF CEDAR CREEK IS LOCATED ALONG THE
SOUTH SIDE OF THE SITE.
- NO PORTION OF THIS PROPERTY IS IN A DESIGNATED FLOOD HAZARD
AREA PER F.I.R.M. PANEL 13135C0074F DATED SEP. 29, 2006.
- THERE ARE NO STATE WATER ON SITE.
- THE PROJECT WILL BE SERVED BY GWINNETT COUNTY WATER.
- THE PROJECT WILL BE SERVED BY GWINNETT COUNTY SEWER.

SITE ANALYSIS

BUILDING OFFICE	5,400 S.F.
ZONED	LM
TOTAL AREA	7.22 AC.
PARKING CALCULATION	
1 SP. / 300 S.F. MIN.	18 SPACES
TOTAL REQUIRED MIN.	18 SPACES
TOTAL PROVIDED	59 SPACES
H.C. SPACES REQ.	
1 H.C. SP. / 25 SP.	3 SPACES
H.C. SPACES REQUIRED	3 SPACES
H.C. SPACES PROVIDED	4 SPACES

TOTAL SITE AREA = 7.22 ACRES
TOTAL DISTURBED AREA = XX ACRES
THERE ARE NO STATE WATERS ON THE SITE.
THERE ARE NO NWI WETLAND ON SITE. UPON A SITE VISIT, THERE WERE NO VEGETATION WHICH INDICATES WETLANDS ON SITE.
NOTES: NO PORTION OF THIS PROPERTY IS IN A DESIGNATED FLOOD HAZARD AREA PER F.I.R.M. PANEL 13135C0074F, DATED SEP. 29, 2006.

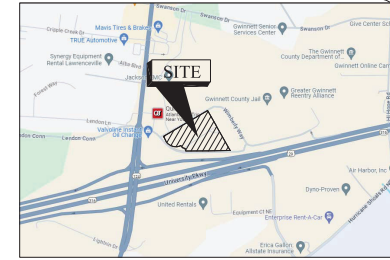

VICINITY MAP
N.T.S.

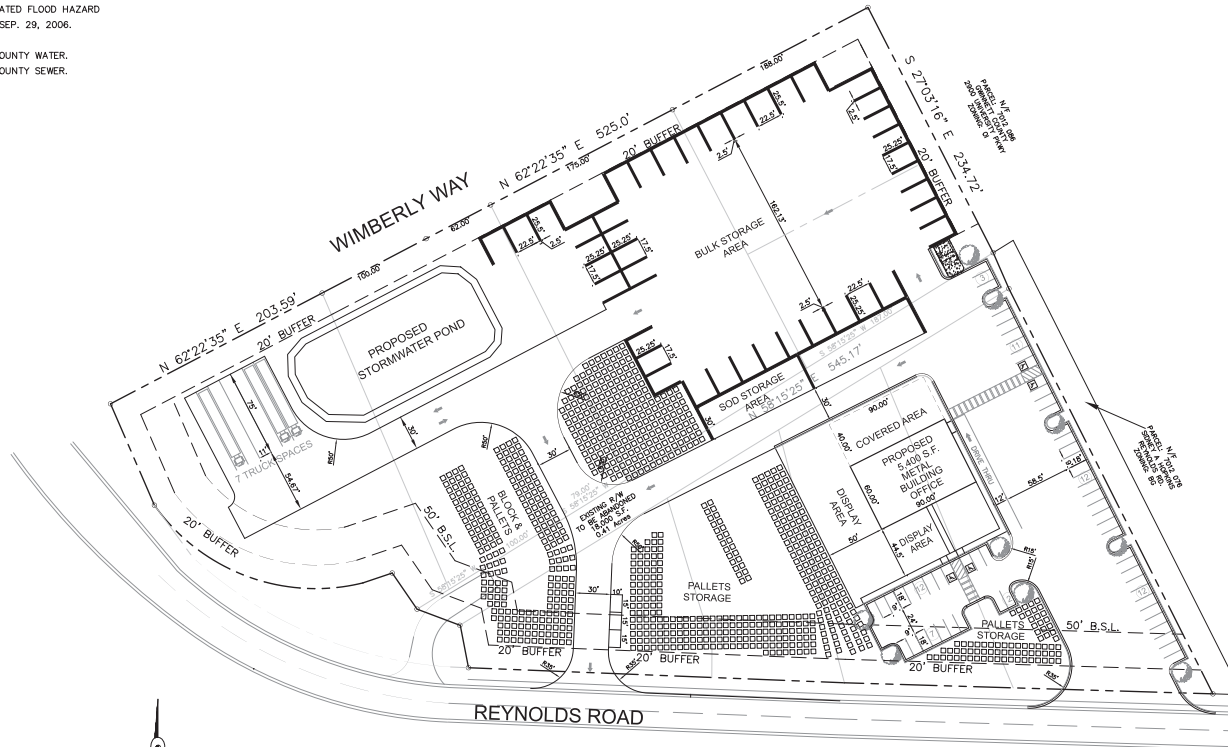

RZC2024-00058
RECEIVED: MAY 3, 2024
PLANNING AND DEVELOPMENT DEPARTMENT

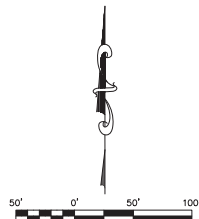

GEORGIA811
www.Georgia811.com

A.C.E.
ALCOVY CONSULTING ENGINEERING
AND ASSOCIATES, L.L.C.
P.O. BOX 110111, N.E.
485 Edwards Rd.
Oxford, Georgia 30054
Phone: 770-486-4002
lpsacell@gmail.com

© 2024
Alcovy Surveying & Engineering, Inc. - ALL RIGHTS RESERVED
This drawing and any permitted reproductions,
in whole or part, are the sole property of Alcovy
Consulting Engineering and Associates L.L.C. and
shall not be reproduced or conveyed in any way
without the written permission of Alcovy
Consulting Engineering and Associates L.L.C.



REZONE PLAN

PROPOSED LUXURY LANDSCAPE SUPPLY

7012 062 7012 039
7012 081 7012 049
7012 022A 7012 026A
PARCEL: 7012 021 7012 035

LAND LOT: 12

DISTRICT: 7th

REYNOLDS ROAD

CITY OF LAWRENCEVILLE, GA

DATE: 4/30/2024

SCALE: 1"=50'

DEVELOPER

LUXURY LANDSCAPE SUPPLY
185 PARK ACCESS DR.
LAWRENCEVILLE, GA 30046
ALEC RICHARDSON
PHONE: 770-513-7333
alec@luxurylandscape.com

24 HOUR - EMERGENCY CONTACT
ALEC RICHARDSON
PHONE: 770-513-7333
alec@luxurylandscape.com

REVISIONS

NO.	DATE	DESCRIPTION

JOB No. # 24-020

RZ