



IDENTIFICATION OF SUBJECT PROPERTY

The property under appraisal and reported herein, consists of a tract measuring 0.21 acres along the west side of Lyle Circle north and south of Hurricane Shoals Road. The property is within the city limits of Lawrenceville. The tract is located in the 5th District, Land Lot 176, Gwinnett County, Georgia. A copy of the tax map with additional maps of the subject property are included in the addenda and shown below.

Aerial Map



Drawing

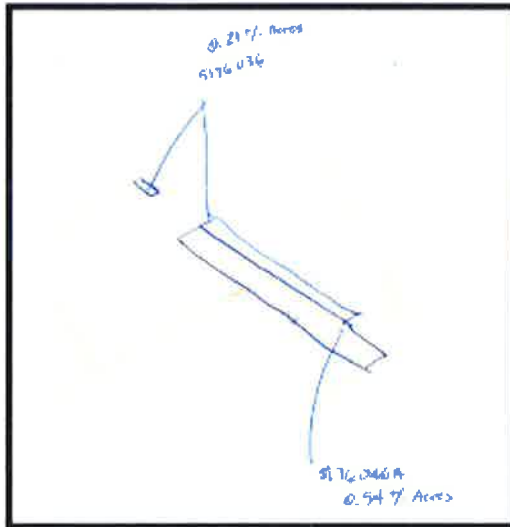

2023-1161.mjm

8

Thanks,

Jennifer

From: Chuck Warbington <chuck.warbington@lawrencevillega.org>

Sent: Friday, October 20, 2023 11:57 AM

To: Fennell, Jennifer <jfennell@jacksonemc.com>

Subject: *EXTERNAL* FW: Appraisal for Lyle Circle

IDENTIFICATION OF SUBJECT PROPERTY

The property under appraisal and reported herein, consists of a tract measuring 0.54 acres along the south side of Hurricane Shoals Road. The property is within the city limits of Lawrenceville. The tract is located in the 5th District, Land Lot 176, Gwinnett County, Georgia. A copy of the tax map with additional maps of the subject property are included in the addenda and shown below.

Aerial Map



Drawing

