



SERVPRO® OF WEST STERLING HEIGHTS

TAX I.D. #38-3334352 - FRANCHISE #11110
7025 METROPLEX DRIVE
ROMULUS, MI 48174
OFFICE: (586) 480-2400
FAX: (313) 914-3734
office@servproromulus.com

Insured: Lathrup Village Water Department
Business: 19101 W 12 Mile Road
Southfield, MI 48076

Cellular: (248) 232-9480
E-mail: mgreene@lathrupvillage.org

Claim Number:

Policy Number:

Type of Loss:

Date of Loss:
Date Inspected:

Date Received:
Date Entered: 6/26/2024 8:52 AM

Price List: MIDE8X_JUN24
Restoration/Service/Remodel
Estimate: WSH24-10965-ABTM1

This estimate is provided pursuant to Client's request for an approximation of the cost of the contemplated work. All estimates are subject to change without notice to Client. This estimate may be used by Client to determine whether to hire Provider to perform the work, and for no other purposes.

Client may provide this estimate to an insurance carrier to determine whether the work is covered under any insurance policy, but may not provide to any of Provider's competitors or any other individual or entity without Provider's prior written consent. This estimate does not guarantee insurance coverage for the work. Client should consult with an insurance carrier to ensure that the work is covered.



SERVPRO® OF WEST STERLING HEIGHTS

TAX I.D. #38-3334352 - FRANCHISE #11110
 7025 METROPLEX DRIVE
 ROMULUS, MI 48174
 OFFICE: (586) 480-2400
 FAX: (313) 914-3734
 office@servproromulus.com

WSH24-10965-ABTM1

Generals

DESCRIPTION	QTY	REMOVE	REPLACE	TAX	TOTAL
1. Asbestos test fee - self test (per sample)	6.00 EA	0.00	82.45	0.00	494.70
2. Asbestos test fee - full service survey - base fee	1.00 EA	0.00	465.00	0.00	465.00
3. Equipment decontamination charge - per piece of equipment	2.00 EA	0.00	43.78	0.00	87.56
4. Add for personal protective equipment (hazardous cleanup)	8.00 EA	0.00	12.49	0.00	99.92
***Note: Two(2) Technicians, Four(4) Changes, One(1) Day					
5. Respirator - Full face - multi-purpose resp. (per day)	2.00 DA	0.00	7.61	0.00	15.22
***Note: Two (2) Technicians with Full Face Respirators for One(1) Day					
6. Respirator cartridge - HEPA only (per pair)	2.00 EA	0.00	15.20	0.00	30.40
7. Add for HEPA filter (for canister/backpack vacuums)	2.00 EA	0.00	89.58	0.00	179.16
8. Haul debris - per pickup truck load - including dump fees	1.00 EA	184.21	0.00	0.00	184.21
Totals: Generals				0.00	1,556.17

Main Level

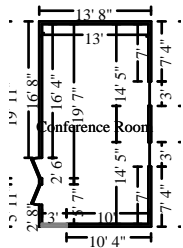

Conference Room

Height: 8'

578.67 SF Walls	317.42 SF Ceiling
896.08 SF Walls & Ceiling	317.42 SF Floor
35.27 SY Flooring	71.83 LF Floor Perimeter
74.83 LF Ceil. Perimeter	

Missing Wall - Goes to Floor

3' X 6' 8"

Opens into Exterior

DESCRIPTION	QTY	REMOVE	REPLACE	TAX	TOTAL
9. Content Manipulation charge - per hour	3.00 HR	0.00	54.93	0.00	164.79
10. Protect contents - Cover with plastic	150.00 SF	0.00	0.26	0.00	39.00



SERVPRO® OF WEST STERLING HEIGHTS

TAX I.D. #38-3334352 - FRANCHISE #11110
 7025 METROPLEX DRIVE
 ROMULUS, MI 48174
 OFFICE: (586) 480-2400
 FAX: (313) 914-3734
 office@servproromulus.com

CONTINUED - Conference Room

DESCRIPTION	QTY	REMOVE	REPLACE	TAX	TOTAL
11. Dehumidifier (per 24 hr period) - 70-109 ppd - No monitor.	4.00 EA	0.00	77.02	0.00	308.08
12. Neg. air fan/Air scrub.-Large (per 24 hr period)-No monit.	4.00 DA	0.00	120.00	0.00	480.00
13. Add for HEPA filter (for neg. air machine/vacuum - Large)	0.50 EA	0.00	320.28	0.00	160.14
14. Ducting - lay-flat - Large	10.00 LF	0.00	0.50	0.00	5.00
15. Containment Barrier/Airlock/Decon. Chamber	40.00 SF	0.00	0.98	0.00	39.20
16. Peel & seal zipper - heavy duty	1.00 EA	0.00	16.62	0.00	16.62
17. Tear out wet drywall, cleanup, bag, per LF - to 4' - Cat 3	71.83 LF	10.10	0.00	0.00	725.48
18. Tear out wet paneling, bag for disposal - Cat 3	286.00 SF	1.19	0.00	0.00	340.34
19. Tear out and bag wet insulation - Category 3 water	286.00 SF	1.41	0.00	0.00	403.26
20. Remove Furring strip - 1" x 2"	289.33 SF	0.53	0.00	0.00	153.34
21. HEPA Vacuuming - Detailed - (PER SF)	1,213.50 SF	0.00	0.95	0.00	1,152.83
22. Clean stud wall - Heavy	148.00 SF	0.00	1.33	0.00	196.84
23. Apply mold/mildew stain remover to part of the walls	289.33 SF	0.00	0.71	0.00	205.42
24. Clean the floor with pressure steam	317.42 SF	0.00	1.12	0.00	355.51
25. Water extraction from hard surface floor - Cat 3 water	317.42 SF	0.00	0.81	0.00	257.11
Totals: Conference Room				0.00	5,002.96
Total: Main Level				0.00	5,002.96

Equipment Set Up, Take Down & Monitoring

Day 1

DESCRIPTION	QTY	REMOVE	REPLACE	TAX	TOTAL
26. Equipment setup, take down, and monitoring (hourly charge)	1.50 HR	0.00	60.58	0.00	90.87
Totals: Day 1				0.00	90.87



SERVPRO® OF WEST STERLING HEIGHTS

TAX I.D. #38-3334352 - FRANCHISE #11110
 7025 METROPLEX DRIVE
 ROMULUS, MI 48174
 OFFICE: (586) 480-2400
 FAX: (313) 914-3734
 office@servproromulus.com

Day 2

DESCRIPTION	QTY	REMOVE	REPLACE	TAX	TOTAL
27. Equipment setup, take down, and monitoring (hourly charge)	1.50 HR	0.00	60.58	0.00	90.87
Totals: Day 2				0.00	90.87

Day 3

DESCRIPTION	QTY	REMOVE	REPLACE	TAX	TOTAL
28. Equipment setup, take down, and monitoring (hourly charge)	1.50 HR	0.00	60.58	0.00	90.87
Totals: Day 3				0.00	90.87

Day 4

DESCRIPTION	QTY	REMOVE	REPLACE	TAX	TOTAL
29. Equipment setup, take down, and monitoring (hourly charge)	1.50 HR	0.00	60.58	0.00	90.87
Totals: Day 4				0.00	90.87

Total: Equipment Set Up, Take Down & Monitoring **0.00** **363.48**

Line Item Totals: WSH24-10965-ABTM1 **0.00** **6,922.61**

Grand Total Areas:

578.67 SF Walls	317.42 SF Ceiling	896.08 SF Walls and Ceiling
317.42 SF Floor	35.27 SY Flooring	71.83 LF Floor Perimeter
0.00 SF Long Wall	0.00 SF Short Wall	74.83 LF Ceil. Perimeter
317.42 Floor Area	342.81 Total Area	578.67 Interior Wall Area
677.50 Exterior Wall Area	77.50 Exterior Perimeter of Walls	
0.00 Surface Area	0.00 Number of Squares	0.00 Total Perimeter Length
0.00 Total Ridge Length	0.00 Total Hip Length	



SERVPRO® OF WEST STERLING HEIGHTS

TAX I.D. #38-3334352 - FRANCHISE #11110
7025 METROPLEX DRIVE
ROMULUS, MI 48174
OFFICE: (586) 480-2400
FAX: (313) 914-3734
office@servproromulus.com

Summary for Dwelling

Line Item Total	6,922.61
Replacement Cost Value	\$6,922.61
Net Claim	\$6,922.61



SERVPRO® OF WEST STERLING HEIGHTS

TAX I.D. #38-3334352 - FRANCHISE #11110
7025 METROPLEX DRIVE
ROMULUS, MI 48174
OFFICE: (586) 480-2400
FAX: (313) 914-3734
office@servproromulus.com

Recap of Taxes



SERVPRO® OF WEST STERLING HEIGHTS

TAX I.D. #38-3334352 - FRANCHISE #111110
7025 METROPLEX DRIVE
ROMULUS, MI 48174
OFFICE: (586) 480-2400
FAX: (313) 914-3734
office@servproromulus.com

Recap by Room

Estimate: WSH24-10965-ABTM1

Generals	1,556.17	22.48%
Area: Main Level		
Conference Room	5,002.96	72.27%
<hr/>		
Area Subtotal: Main Level	5,002.96	72.27%
Area: Equipment Set Up, Take Down & Monitoring		
Day 1	90.87	1.31%
Day 2	90.87	1.31%
Day 3	90.87	1.31%
Day 4	90.87	1.31%
<hr/>		
Area Subtotal: Equipment Set Up, Take Down & Monitoring	363.48	5.25%
<hr/>		
Subtotal of Areas	6,922.61	100.00%
<hr/>		
Total	6,922.61	100.00%



SERVPRO® OF WEST STERLING HEIGHTS

TAX I.D. #38-3334352 - FRANCHISE #11110
7025 METROPLEX DRIVE
ROMULUS, MI 48174
OFFICE: (586) 480-2400
FAX: (313) 914-3734
office@servproromulus.com

Recap by Category

Items	Total	%
CLEANING	552.35	7.98%
CONTENT MANIPULATION	203.79	2.94%
GENERAL DEMOLITION	1,806.63	26.10%
HAZARDOUS MATERIAL REMEDIATION	2,684.93	38.78%
WATER EXTRACTION & REMEDIATION	1,674.91	24.19%
Subtotal	6,922.61	100.00%

This estimate is provided pursuant to Client’s request for an approximation of the cost of the contemplated work. All estimates are subject to change without notice to Client. This estimate may be used by Client to determine whether to hire Provider to perform the work, and for no other purposes.

Client may provide this estimate to an insurance carrier to determine whether the work is covered under any insurance policy, but may not provide to any of Provider’s competitors or any other individual or entity without Provider’s prior written consent. This estimate does not guarantee insurance coverage for the work. Client should consult with an insurance carrier to ensure that the work is covered.

Provider’s bids, costs, & pricing are based in part on Provider’s costs of goods & services. Vendors & subcontractors to Provider may provide quick pay or other discounts for invoices paid within 7 days. Payment of your invoice within 7 days may qualify you for such discounts. Provider reserves the right to determine eligibility for & how any discounting may be applied.

The line item pricing in this estimate is good for 30 days. We reserve the right to adjust, change and modify pricing to reflect the rapid market changes to the costs of labor and materials incurred while performing the project.

