

**PROPOSED SUBDIVISION
LANDS OF
LUCENTE HOLDINGS, INC.**

TOWN OF LANSING
COUNTY OF TOMPKINS
STATE OF NEW YORK
TAX MAP NOS. 39.-1-38.8
AND 39.-1-38.16
REFERENCE DEEDS: L.895/P.150
AND L.811/P.283

LEGEND:

- EXISTING PIN
- SET 5/8" REBAR AND SURVEY CAP
- R.O. REPUTED OWNER



GRAPHIC SCALE

OWASCO LAND SURVEYING
52 HART DRIVE
FREEVILLE, NEW YORK 13068
PHONE: (607) 898-5051
email: owascos@outlook.com

NOTE: Any revisions to this map must comply with section 7209, Subdivision 2 of the New York State Education Law. All certifications hereon are valid for this map and copies thereof only if said map or copies bear the embossed seal of the licensed land surveyor whose signature appears hereon. This map is not valid when used in conjunction with a "Survey Affidavit" or "Certificate of No-Change".

Drawn By: BMK Scale: 1"=50' Job No.: 23-016 Drawing File: 23016.DWG
Coordinate File: 23016.CRD

I hereby certify to LUCENTE HOLDINGS, INC.

that I am a licensed land surveyor, New York State License No. 050380, that this map correctly delineates an actual survey on the ground made by me or under my direct supervision, and that I found no visible encroachments either way across property lines except as shown hereon.

Signed: *Brian M. Klump* Dated: APRIL 24, 2023

"Copyright 2023: All Rights Reserved, Owasco Land Surveying"

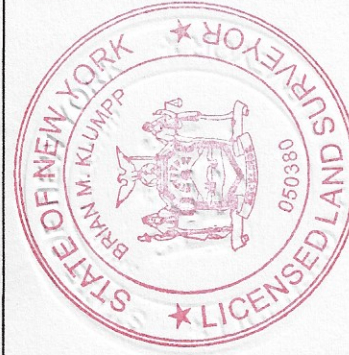

REFERENCE SURVEYS:

1. "REVISED PLANS OF VILLAGE APARTMENTS...", MADE BY HOWARD SCHLIEDER, P.E., L.S., DATED APRIL 16, 1975, REVISED APRIL 12, 1976.
- *2. "SURVEY MAP, HIGHWAY DEDICATION VILLAGE CIRCLE & VILLAGE PLACE...", MADE BY LAWRENCE FABBRONI, P.E., L.S., DATED DECEMBER 20, 2016.

