

FARRELL ROAD

(3 ROD RIGHT OF WAY=49.5')

0.42± MILES TO THE CL INT.
OF SPRINGBROOK CIRCLE

P.O.B.

R=11600.00'
L=121.82'

CH=N 86°48'23" E
121.82'

PRESENT CENTERLINE

R/W

O.H.

NORTH

LEGEND

- -COMPUTED POINT
- -EXISTING IRON, LABELED
- ⊙ -3/4" REBAR SET WITH CAP
- ⊗ -UTILITY POLE

TITLE INFORMATION

JOHN R. MORAVEC
SUE K. MORAVEC
P/O DEED BOOK 733 PAGE 92
P/O TAX MAP NO.39-1-13.21
AREA=1.401 ACRES TO C/L
(1.332 ACRES TO R/W)
(TO BE CONVEYED TO MICHAEL MORAVEC
& CONSOLIDATED WITH TAX PARCEL 39-1-13.23)

REMAINING LANDS OF
JOHN & SUE MORAVEC
TAX PARCEL 39-1-13.21
(4.480 ACRES REMAINING TO CL)

MAP REFERENCES:

- 1) MAP OF SURVEY LANDS OF ANNA VICTORIA KOZEL MORAVEC DATED JANUARY 27, 1993 AND LAST AMENDED NOVEMBER 19, 2021 BY ROBERT RUSSLER, L.S.

NOTES

1- Unauthorized alteration or addition to a survey map bearing a licensed land surveyor's seal is a violation of section 7209, sub-division 2, of the New York State Education Law.

2- Only copies from the original of this survey map with the surveyor's embossed seal are genuine, true and valid copies of the surveyor's original work and opinion.

3- Certifications on this boundary survey map signify that the map was prepared in accordance with the current existing Code of Practice for Land Surveys adopted by the New York State Association of Land Surveyors, Inc. The certification is limited to persons for whom the boundary survey map is prepared, to the title company, and to the lending institution listed on this survey map and are not transferable.

MICHAEL MORAVEC
INST. NO.484219-001
TAX PARCEL 39-1-13.23

JOHN R. MORAVEC
SUE K. MORAVEC
MICHAEL MORAVEC

I hereby certify to:
that I am a licensed land surveyor, New York State License No. 050823, and that this map delineates an actual survey on the ground made by me or under my direct supervision, that it was prepared in accordance with the current Code of Practice adopted by the New York State Association of Professional Land Surveyors, and that I found no visible encroachments either way across property lines except as shown hereon.

SIGNED: *Edward Ripic, Jr.* DATE: 6/9/2023
EDWARD RIPIC, JR.

NOTE:

THIS SURVEY MAP PREPARED WITHOUT
BENEFIT OF AN ABSTRACT OF TITLE
PROVIDED, SUBJECT TO ANY STATE OF
FACT THAT AN UPDATED ABSTRACT OF
TITLE MAY SHOW.

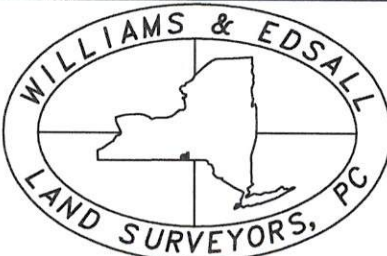

WILLIAMS & EDSALL LAND SURVEYORS, P.C.
The Turner House Suite 101
24 NYS Rte 96 Owego, NY 13827
phone: (607)687-8953
www.williamsandedsall.com

Survey for

MICHAEL MORAVEC

LOCATED AT 129 FARRELL ROAD
TOWN of LANSING

TOMPKINS COUNTY

DATE: 6/9/2023

NEW YORK

SCALE: 1"=60'

JOB NO: 2023-208
© COPYRIGHT 2023