

GENERAL NOTES:

A. CONTRACTOR SHALL COORDINATE WITH OTHER TRADES PRIOR TO START OF PROJECT WORK AND SUBMIT COORDINATED PROJECT WORK ON SHOP FABRICATION AND INSTALLATION DRAWINGS FOR REVIEW AND APPROVAL BY ENGINEER OF RECORD.

B. CONTRACTOR SHALL COORDINATE INSTALLATION REQUIREMENTS AND SCHEDULING OF ALL WORK WITH BUILDING REPRESENTATIVE AND GENERAL CONTRACTOR.

C. INSTALLATION SHALL COMPLY WITH LATEST EDITION OF NATIONAL ELECTRICAL CODE AS ADOPTED BY THE LOCAL AUTHORITY HAVING JURISDICTION, NFPA, IECQ, ALL FEDERAL, STATE, CITY, AND LOCAL CODE.

D. CONTRACTOR SHALL BE LICENSED TO PERFORM WORK IN MUNICIPALITY WHERE PROJECT IS LOCATED, OBTAIN AND PAY FOR ALL PERMIT AND INSPECTION FEES.

E. VERIFY LOCATION AND WIRING REQUIREMENT FOR ALL RECEPTACLES AND POWER FEEDS TO OWNER FURNISHED EQUIPMENT PRIOR TO INSTALLATION.

F. PROVIDE 1/2" CONDUIT AND PULL STRING TO ABOVE CEILING AND ACCESSIBLE FOR ALL DATA OUTLETS.

G. FOR THE PURPOSES OF THIS PROJECT, THE TERM PROVIDE SHALL BE DEFINED AS, "FURNISH AND INSTALL".

PLAN NOTES:

LIGHT FIXTURE SCHEDULE						
TYPE	MANUFACTURER	LAMP	LUMENS	VOLTS	WATTS	DESCRIPTION
B	HUBBELL, PRESCOLITE, OR APPROVED EQUAL	LED	700	120	10	6" LED RECESSED DOWNLIGHT, ALUMINUM HOUSING AND REFLECTOR WITH CLEAR ANODIZED TRIM, HIGH PERFORMANCE ISOLATED LED DRIVER, DIMMING RANGE FROM 100% TO 10%, WET LOCATION RATED, 5 YEAR WARRANTY.
I	SUPERBRIGHTLED, OR APPROVED EQUAL	LED	4400	120	40	LED WALL CUTOFF, EXTERIOR RATED LED DRIVER, WET LOCATION RATED, DIE CAST ALUMINUM HOUSING, POWDER COAT FINISH, 5000K TEMP, 5 YEAR WARRANTY, MOUNT AT 8'-6" (±) AFF. COORDINATE COLOR AND EXACT LOCATION WITH ARCHITECT.

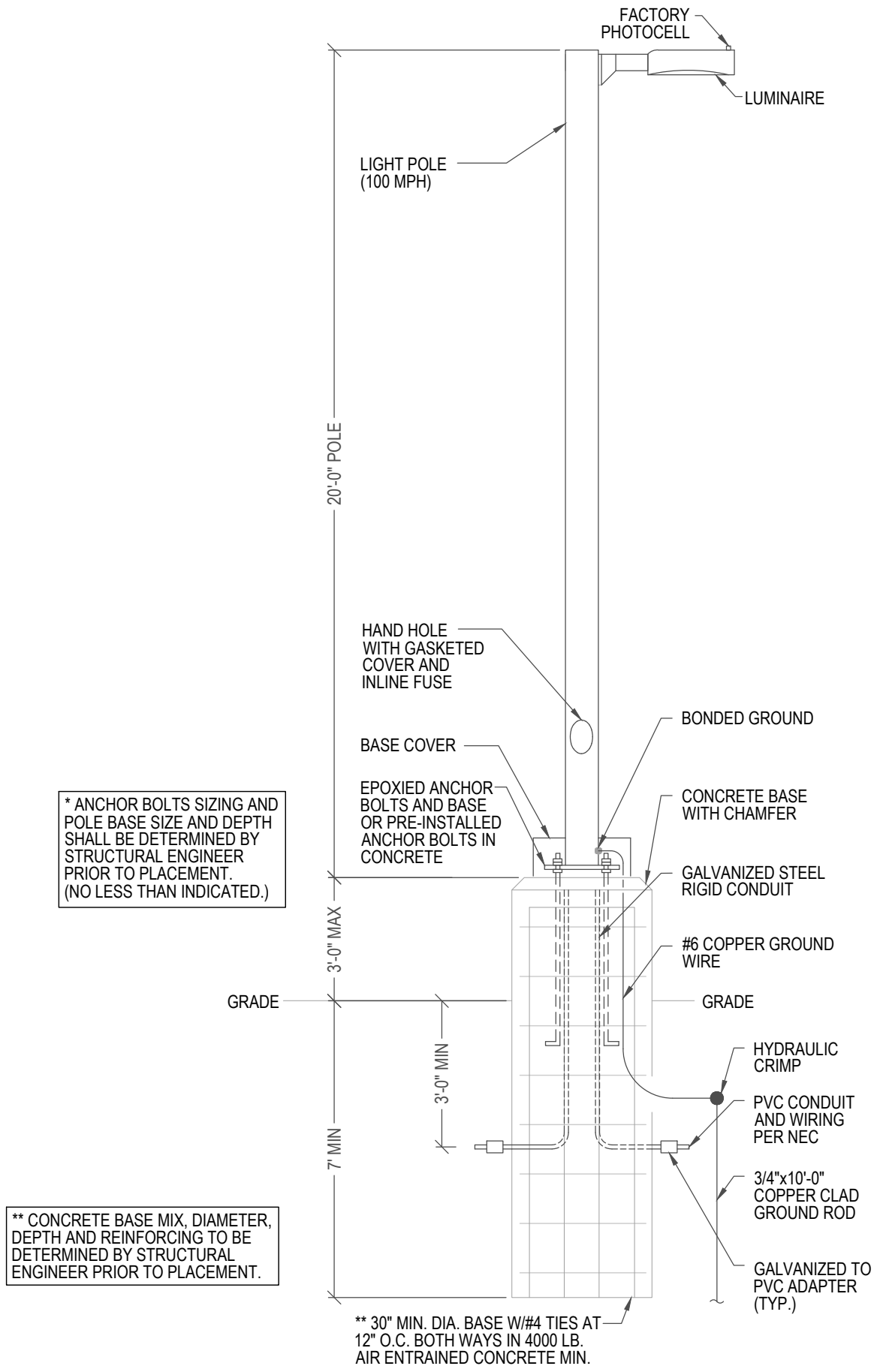
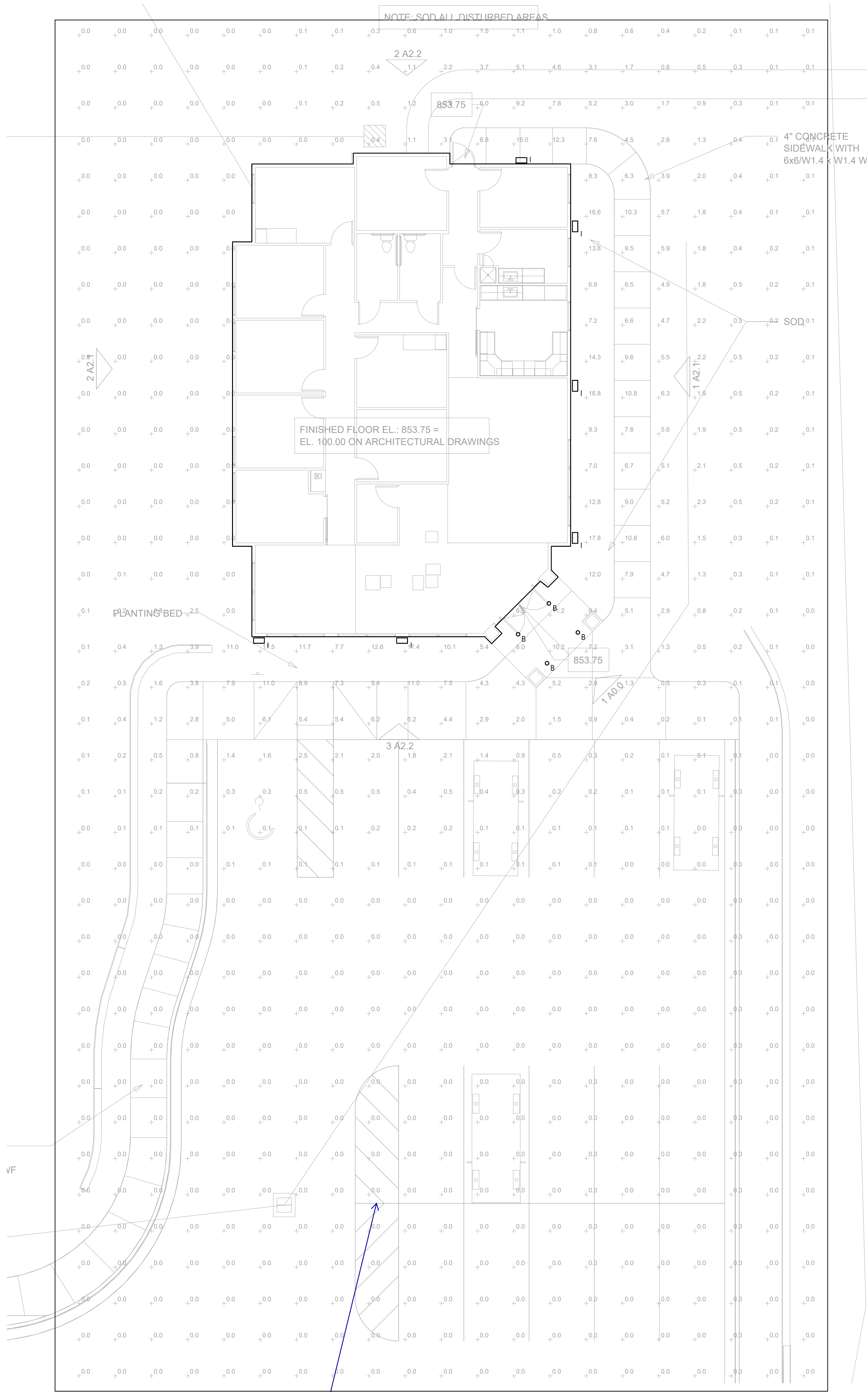

2 AREA LIGHT DETAIL  
NTS

Reviewed By CED  
12/10/2021 3:24:12 PM  
By mschmitz

SITE PLAN  
1/8" = 1'-0"

Would strongly suggest the addition of one pole light in this area with a 4-way luminaire assembly to provide lighting for the parking lot area.

wnbarchitects

WARNER NEASE BOST ARCHITECTS, INC.

517 DELAWARE, KANSAS CITY, MO 64105

816.283.3731 www.wnbarchitects.com

Professional Engineers, Inc.

PS

19547 West 162nd Street

Olathe, Kansas 66062

Phone (913) 390-6002

MECHANICAL

ELECTRICAL

PLUMBING

CONSULTING • MANAGEMENT • DESIGN/BUILD

THIS DRAWING AND THE DETAILS ON IT ARE THE SOLE PROPERTY OF THE PROFESSIONAL, AND MAY BE USED FOR THIS SPECIFIC PROJECT ONLY. IT SHALL NOT BE LOANED, COPIED, OR REPRODUCED IN WHOLE OR IN PART, OR USED FOR ANY OTHER PURPOSE OR PROJECT, WITHOUT THE WRITTEN CONSENT OF THE PROFESSIONAL.

PROGRESS SET - NOT FOR CONSTRUCTION

THE PROFESSIONAL'S SEAL AFFIXED TO THIS SHEET APPLIES ONLY TO THE MATERIAL AND ITEMS SHOWN ON THIS SHEET. ALL DRAWINGS, INSTRUMENTS OR OTHER DOCUMENTS NOT EXHIBITING THIS SEAL SHALL NOT BE CONSIDERED PREPARED BY THIS PROFESSIONAL, AND THE PROFESSIONAL EXPRESSLY DISCLAIMS ANY AND ALL RESPONSIBILITY FOR SUCH PLAN, DRAWING OR DOCUMENT NOT EXHIBITING THIS SEAL.

PROJECT:	FAMILY EYECARE CENTER	SHEET TITLE:	DATE:	PROJECT NUMBER:	SMP	LOCATION:	ADDRESS:							
Electrical - Site Photometric														
Revisions														
NO.	DESCRIPTION	PERMIT/BIDDING SET												
1	ELEC SERVICE ADDENDUM 1 - 10/5/21													

Sheet Number

ES1.01