

EXISTING BOUNDARY, UTILITY INFORMATION AND BUILDING LOCATION, ETC. WAS TAKEN FROM A DRAWING PROVIDED BY RAMSAY, BURGIN, SMITH ARCHITECTS, INC. RECEIVED 5/2/09.

- LEGEND**
- Existing Stone
 - Existing Bolt
 - Existing Iron
 - New Iron
 - ▲ Point
 - New P.K. Nail
 - ⊕ Centerline
 - RW Right-of-Way
 - Water Meter
 - ⊙ Water Valve
 - Fire Hydrant
 - ⊕ Power & Light Pole
 - Sanitary Sewer Manhole
 - ⊕ Yard Inlet

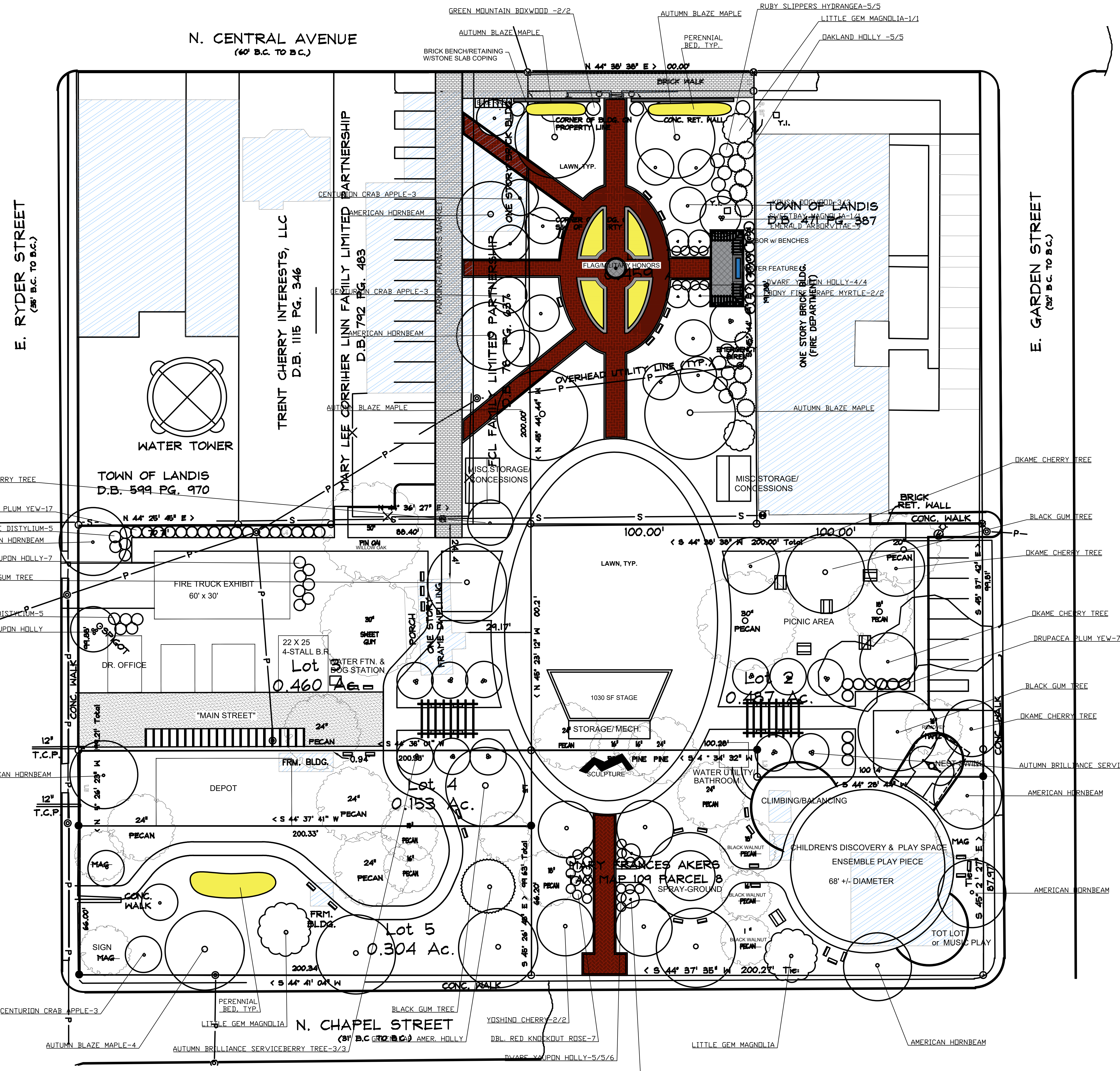

LANDSCAPE
SITE PLAN
SCALE: 1" = 20'

PROPOSED
**LANDSCAPE
PLAN**

LANDSCAPE PLAN

**DC & FRANCIS
LINN PARK**
North Central Ave
Landis NC

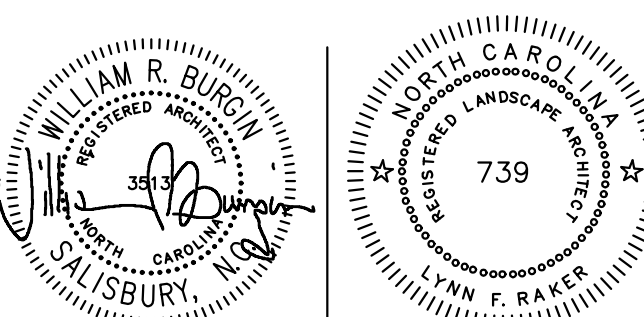

PG. DRAWN BY: _____
APRD. CHECKED BY: _____
DATE: SEPT 2023
SITE: _____
CONNO. NO.: _____

SHEET NO.
A1
OF