

S:\PROJECTS\2020-2025\20-0164 LAKE ORION LUMBER-REVISED\CONCEPTUAL\20-0164 SKETCH PLAN 02.dwg



BROADWAY ST/M-24

Downtown
Village of Lake
Orion

Retail

Retail
4,500 Sq Ft

Railroad
Historical Walk

Public
Restrooms

Hotel
3,000 Sq Ft

Market
3,000 Sq Ft

Food
Truck

Refuse
Area

20' WIDE
SANITARY
SEWER ESMT
(L.4689, P.481)

Trail
Head

Art

Event Barn

Public Space

Market Shed

VENDOR PARKING/ LOADING AREA

Leo's Coney
Island

ATWATER STREET

NORTH LINE SECTION 11

NORTHEAST
CORNER
SECTION 11
T.4N., R.10E.

6' CHAIN
LINK FENCE

4' SPLIT RAIL FENCE
ASPH

ASPH
4' SPLIT RAIL FENCE
PAINT
CREEK
TRAIL

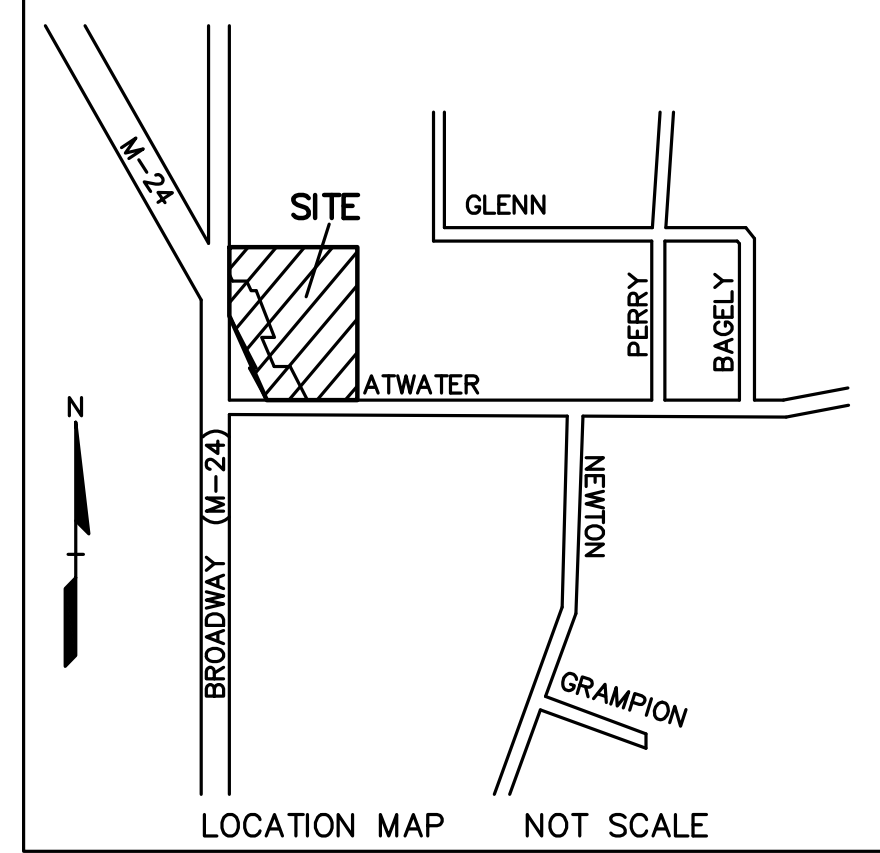

PEA
GROUP
t: 844.813.2949
www.peagroup.com

0 15 30 60
SCALE: 1" = 30'



CAUTION!!
THE LOCATIONS AND ELEVATIONS OF EXISTING UNDERGROUND UTILITIES AS SHOWN ON THIS DRAWING ARE ONLY APPROXIMATE. NO GUARANTEE IS OFFERED EXCEPT OR IMPLIED AS TO THE COMPLETENESS OR ACCURACY THEREOF. THE CONTRACTOR SHALL BE EXCLUSIVELY RESPONSIBLE FOR DETERMINING THE EXACT UTILITY LOCATIONS AND ELEVATIONS PRIOR TO THE START OF CONSTRUCTION.

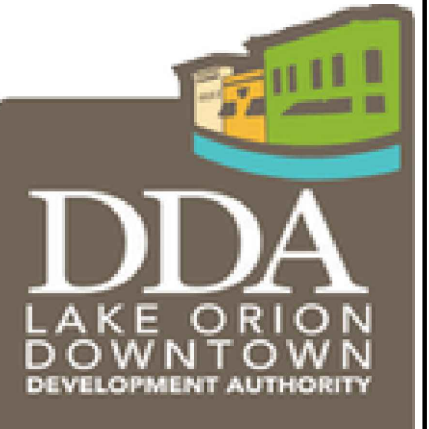

PROJECT TITLE
**LAKE ORION
LUMBER**
215 SOUTH BROADWAY
LAKE ORION, MI

REVISIONS

ORIGINAL ISSUE DATE:
MARCH 27, 2025

DRAWING TITLE
CONCEPT PLAN

PEA JOB NO. 20-0164

P.M. JPB

DN. JPB

SUR. JPB

DRAWING NUMBER:

C-2.0

LEGEND:

●	IRON FOUND / SET
⬤	NAIL FOUND / NAIL & CAP SET
⬤	BRASS PLUG SET
⬤	MONUMENT FOUND / SET
⬤	SECTION CORNER FOUND
R M C	RECORDED / MEASURED / CALCULATED
TAX P TC	TAX DESCRIPTION / PLATTED/
	TITLE COMMITMENT