



City of
Lake Worth
Beach
FLORIDA

The Art of Florida Living.SM



Reopening Lake Worth Beach





Phase One

Wednesday, May 13th- Sunday, May 17th

- Lake Worth Beach, Beach Park and William O. Lockhart Pier will remain closed
- Tenants will operate at 25% indoor capacity and offer outdoor seating with 6ft. between parties
- The parking lot will open to 25% capacity (approximately 180 spaces)
- Old Bridge Park employee parking only



25% Parking Capacity

Yellow notates closed parking spaces



- 50 Resident decal Spaces
- 132 public spaces



Phase Two- Beach and Beach Park

Monday, May 18 - Monday, May 25th

- Dates pursuant to County Commission decision
- Open 50% of the parking lot- 6 ft. physical distancing markers
- Heavy promotion of ParkMobile parking app
- William O. Lockhart Pier Open-10 ft. physical distancing markers
- Restrooms open
- Towers one lifeguard- frequent shift rotation
 - 6ft. distancing between staff and beach patrons
- Medical Emergencies addressed by PBCFR Only
- All staff will adhere to CDC and Social Distancing guidelines



ParkMobile



50% Parking Capacity

Yellow notates closed parking spaces

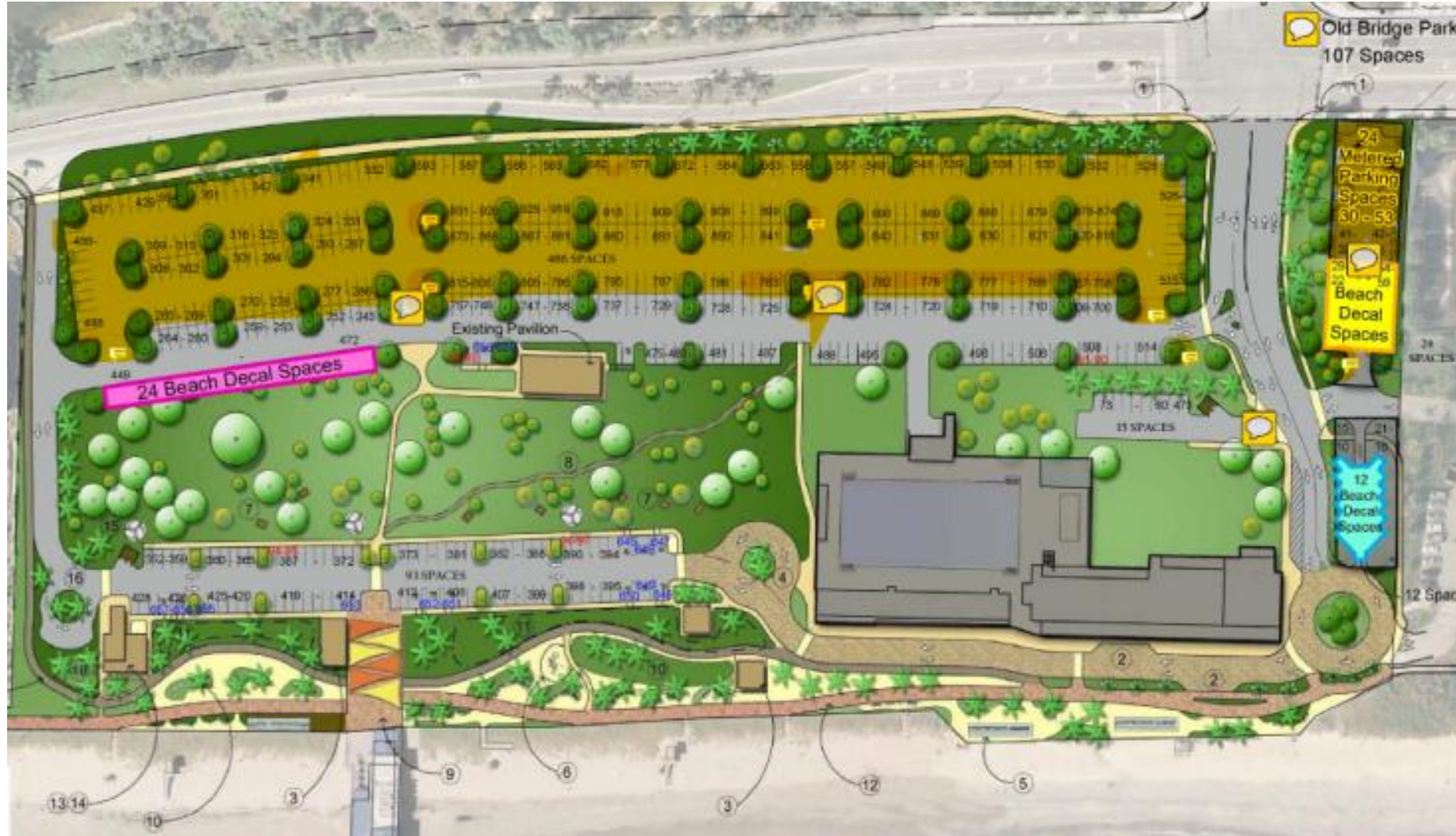

- 50 Resident decal Spaces
- 300 public spaces



PRACTICE SAFE SOCIAL DISTANCING



City of
Lake Worth
Beach
FLORIDA™





Phase Two- Casino Tenants

- Pursuant to PBC Executive Orders
- Outdoor seating priority
- Parties not to exceed 10 people
- 6 ft. distancing between parties





Phase Three- Beach and Beach Park

- Open 75% of the parking lot- 6ft. physical distancing markers
- Towers one guard inside, one guard outside. Frequent shift rotation
 - Open: William O. Lockhart Pier, Restrooms
 - Medical Emergencies addressed by PBCFR Only
 - All staff will adhere to CDC and Social Distancing Guidelines



Phase Three- Casino Tenants

- Pursuant to PBC Executive Orders
- Outdoor seating priority
- Parties not to exceed 10 people
- 6 ft. distancing between parties





Phase Four

- Resume pre-COVID19 normal beach operations





Thank You for the shout out!





Reopening Downtown Lake Worth Beach



Option One

J Street- L Street



Option One

L Street & M Street





Option Two

Lake Avenue Closure: Friday-Sunday

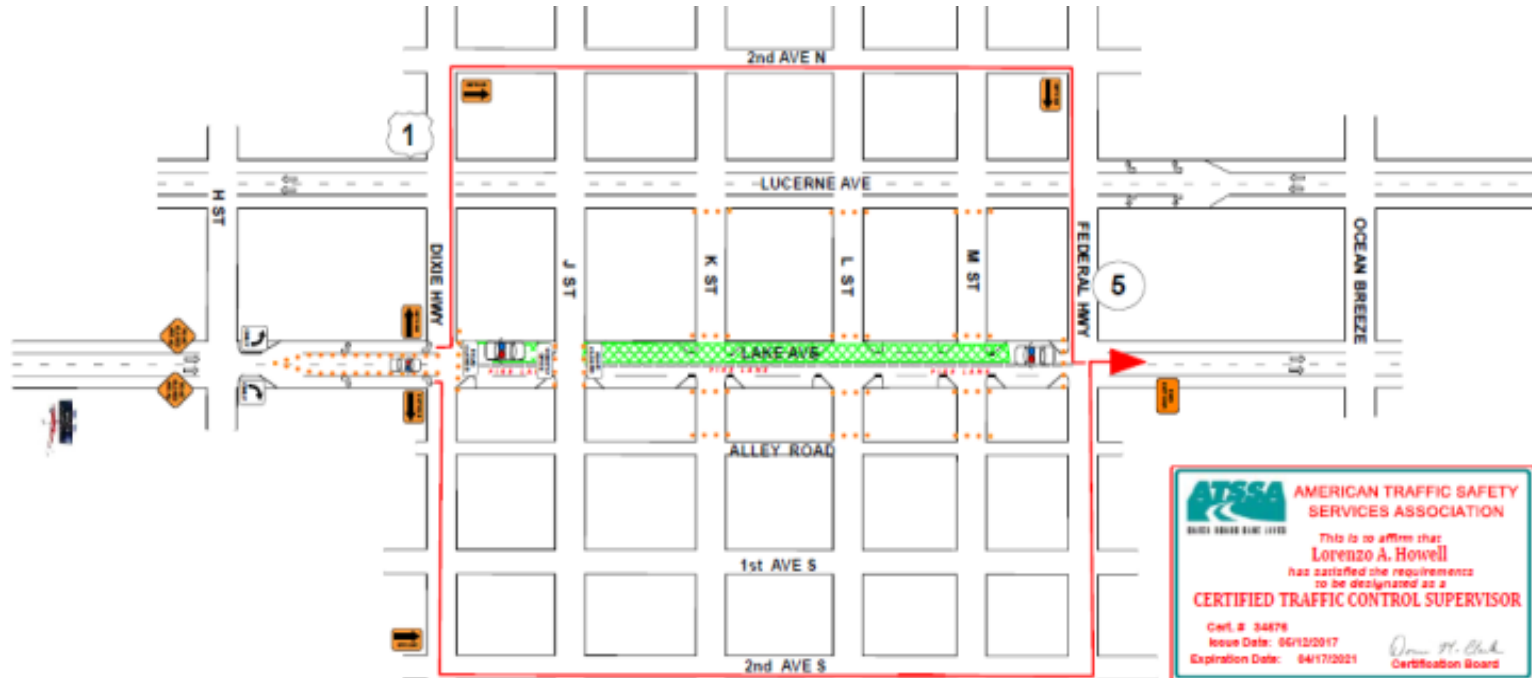

- Daily Costs
- Barricades \$2,400.00
- PBSO \$1,430
- Total: \$3,830

- Weekend Costs
- Barricades \$7,200
- PBSO: \$4,290
- Total: \$11,490



Option Three

Lake & Lucerne Closure: Friday-Sunday

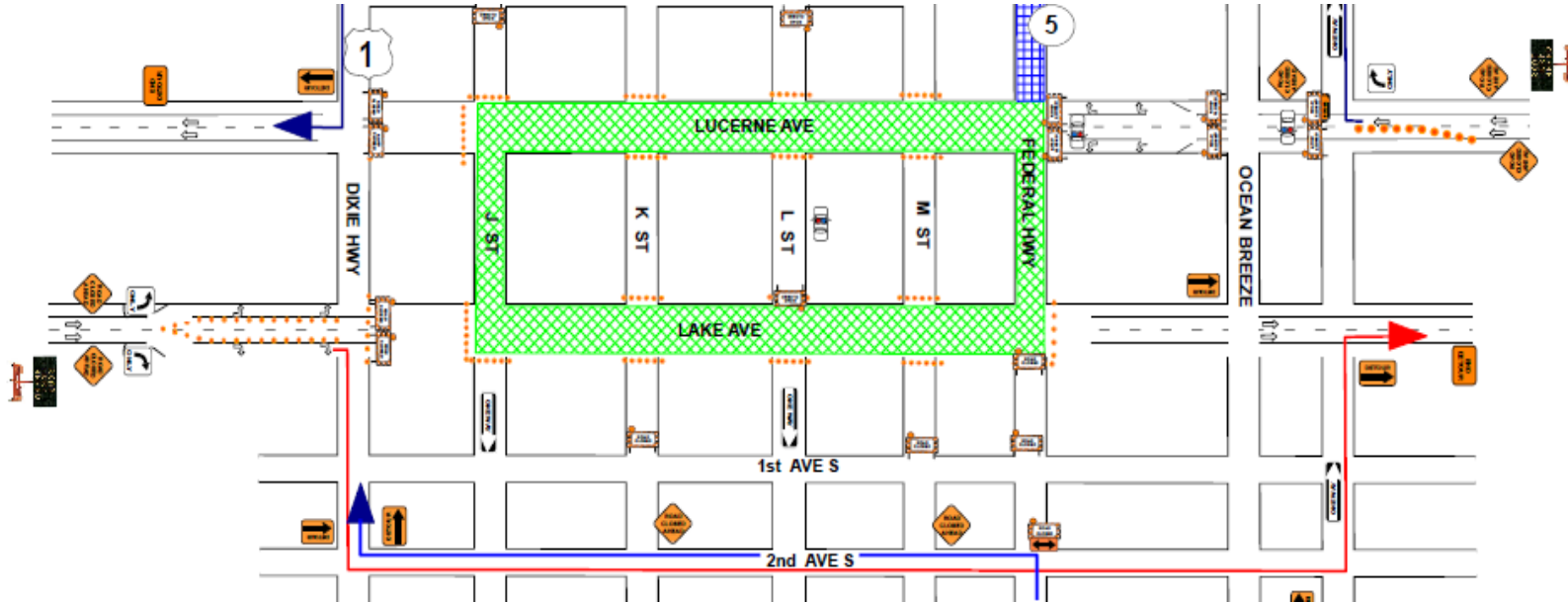

- Daily Costs
- Barricades \$4,500
- PBSO \$2,860
- Total: \$7,360
- Weekend Costs
- Barricades \$13,500
- PBSO \$8,580
- Total: \$22,080