



Public Works
Department

Town of Lake Park Storm Water Project

Project price quote for the excavation and replacement of the following

1. 525 Flagler Blvd. to 1030 Seminole Blvd. - Main line #259 a 251' of 18" HDPE exfiltration system structure 10-010D to 10-011D
2. 1007 to 1021 Seminole Blvd. - Main line #262 a 231' of 18" HDPE structure 10-012D to 10-013D

Additional instructions:

1. Replacing the 18" High Density Poly Ethaline (HDPE) exfiltration line with 18" Reinforced Concrete Pipe (RCP) exfiltration line
2. Use the attached Town exfiltration trench detail as the construction design standard and the Towns typical swale replacement detail as the right-of-way restoration plan.
3. Repair and or replace all irrigation components disturbed during this project.
4. Replace all areas of disturbed sod / grass.
5. Provide a maintenance of traffic (MOT) design for traffic control, if selected for this project.
6. The Town has 152' feet of 18" exfiltration RCP (19 sticks) to be used in this project.
7. The Town will be using our current contract we have with your company to expedite commission approvals.
8. A site inspection is recommended to determine if any trees will need to be removed to facilitate the installation of the new main line, tree removal and disposal will be included in this project, tree replacement is not anticipated to be required.
9. Contractor is required to obtain all utility locations to determine if other utilities will be obstructing any area of this project.

Please provide a project timetable to be initiated upon notification of project approval.
Let me know if you have any questions.

650 Old Dixie Highway
Lake Park, FL 33403
Phone: (561) 881-3345
Fax: (561) 881-3349

www.lakeparkflorida.gov

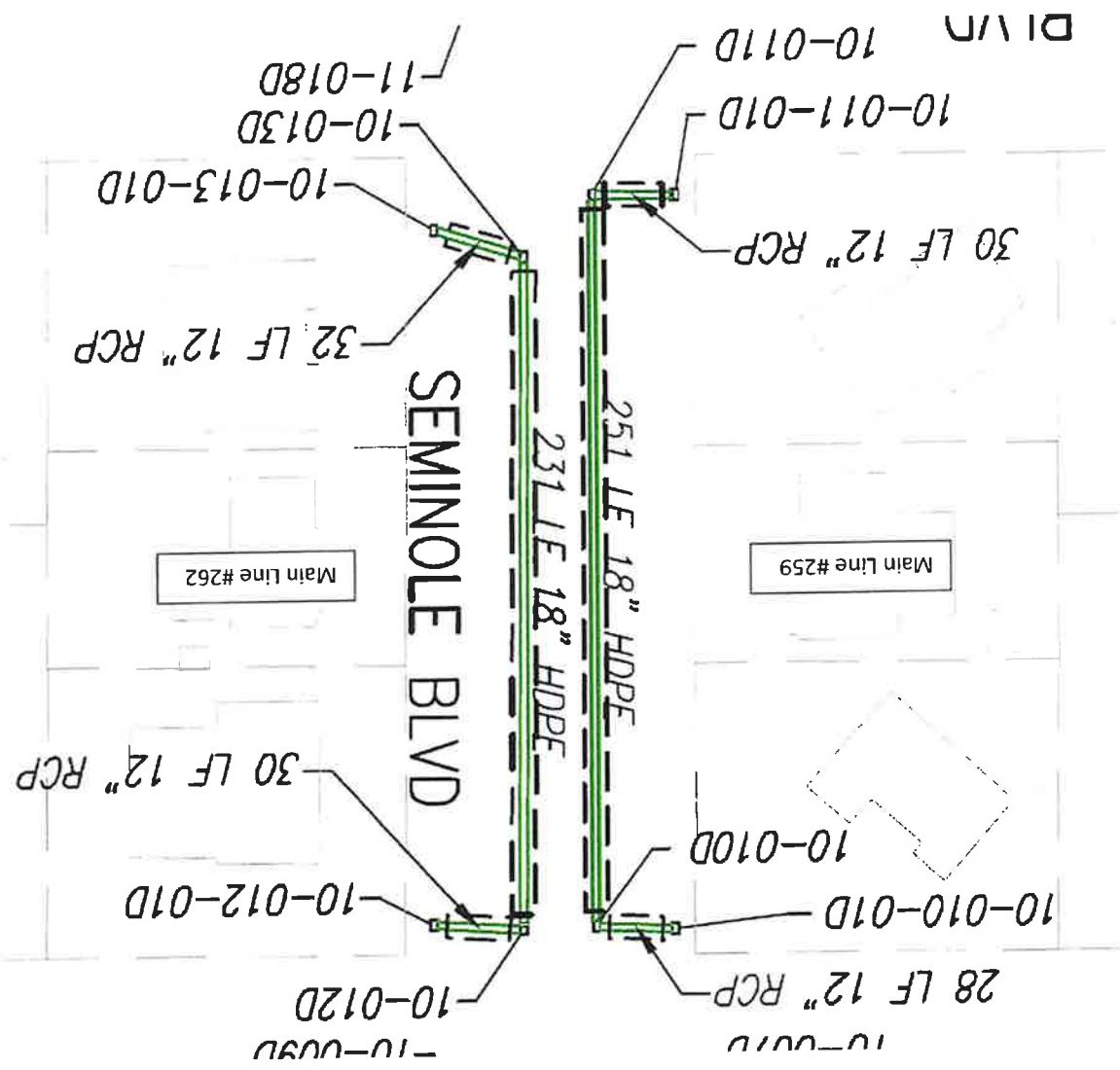



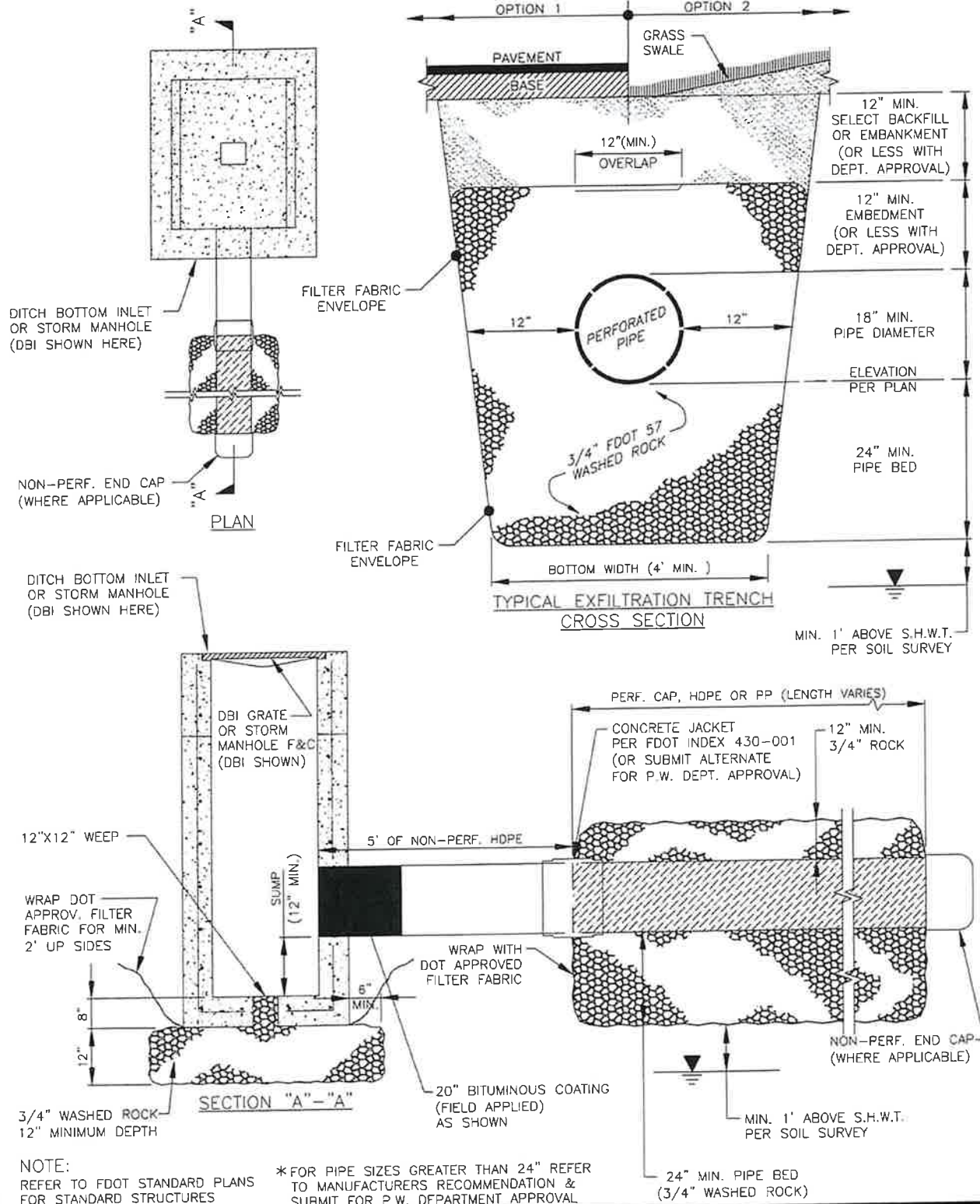

PUBLIC WORKS
DEPARTMENT

TOWN OF LAKE PARK PUBLIC WORKS DEPARTMENT CONSTRUCTION STANDARDS & DETAILS

TYPICAL INLET & EXFILTRATION TRENCH DETAIL FOR NON-TRAFFIC AREAS 24" OR SMALLER

NOT TO SCALE EFF. DATE
05/24

PAGE NUMBER
D-1

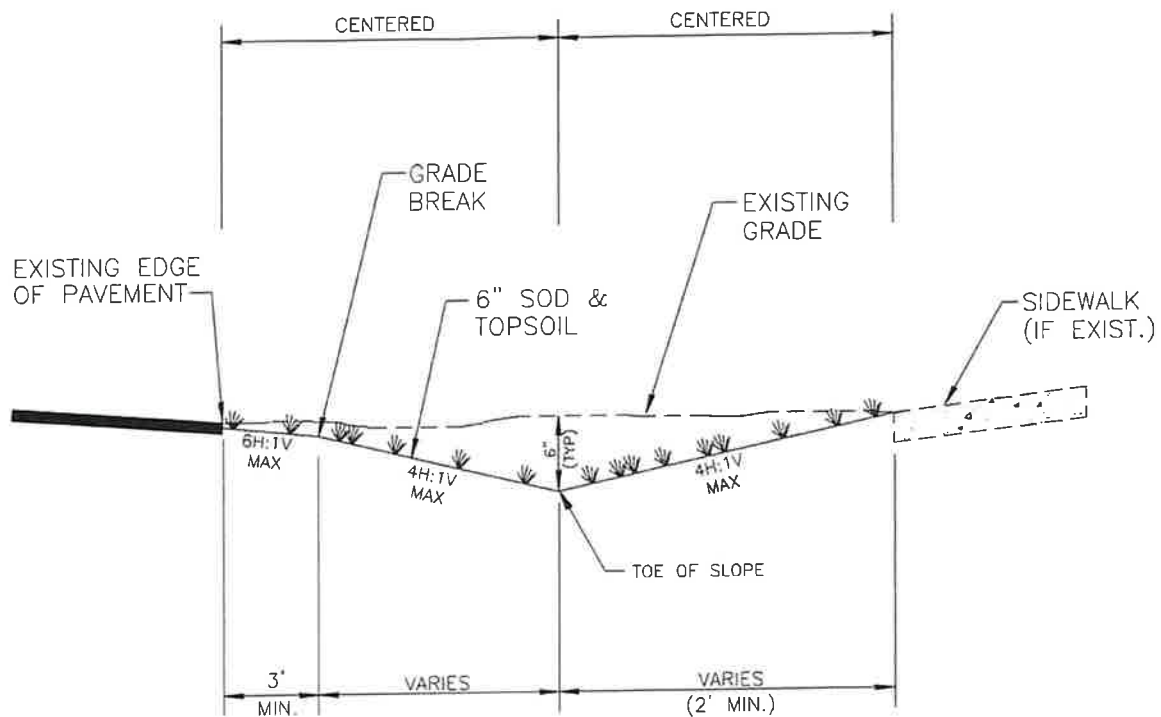

NOTE:

1. CONTRACTOR TO REPLACE ALL IRRIGATION IN SWALES DAMAGED DURING CONSTRUCTION.
2. SOD SHALL BE PLACED PER SPECIFICATIONS.
3. MAXIMUM SWALE DEPTH SHALL BE 9" AND MINIMUM 6".
4. PROVIDE POSITIVE SLOPE OFF THE ROAD.
5. MAINTAIN SLOPES ON EACH SIDE OF SWALE PER DETAIL THROUGH CONSTRUCTION.
6. 12" FLAT AT BOTTOM OF SWALE MAY BE OMITTED WHEN REQUIRED TO ATTAIN 4:1 SLOPES.
7. OFFSET BOTTOM OF SWALE AS REQUIRED. DEEPER SWALES MAY BE APPROVED BY THE DEPARTMENT FOR SPECIFIC SITE CONDITIONS.
8. DETAIL APPLICABLE FOR NARROW AREAS AND ELEVATION DIFFERENCES BETWEEN SIDEWALK AND EDGE OF PAVEMENT >9"
9. IF APPLICABLE, THE PROPERTY OWNER ABUTTING THE R/W COMMON TO THE SWALE SHALL INSTALL AND MAINTAIN AN OPERATING IRRIGATION SYSTEM IN COMPLIANCE WITH TOWN OF LAKE PARK CODE, SECTIONS 34-12 AND 4-14 (REF. TOWN ORDINANCES 04-2009 & 02-2006).



PUBLIC WORKS
DEPARTMENT

TOWN OF LAKE PARK PUBLIC WORKS DEPARTMENT CONSTRUCTION STANDARDS & DETAILS

TYPICAL SWALE REPLACEMENT DETAIL

NOT TO SCALE EFF. DATE
05/24

PAGE NUMBER
D-2