

CONTRACTOR AND ALL SUBCONTRACTORS  
PERFORMING ANY WORK ON THIS  
PROJECT ARE TO VISIT THE SITE AND  
VERIFY ALL MEASUREMENTS INCLUDING  
BUT NOT LIMITED TO BUILDING HEIGHTS,  
ROOF SLOPES, ROOM DIMENSIONS ETC.  
TO CONFIRM ALL EXISTING CONDITIONS  
BEFORE ORDERING OR FABRICATING ANY  
MATERIALS. CONTRACTOR SHALL REPORT  
ANY INCONSISTENCIES WITH THE  
CONSTRUCTION DOCUMENTS TO THE  
ARCHITECT BEFORE CONTINUING WORK.

REV # DATE DESCRIPTION

SEAL

ROGER HANSROTE, ARCHITECT  
FLAR # 14300

REVISION

JOB NUMBER: 2022-53  
DATE: 07-22-2022  
DRAWN BY: AL/MG  
APPROVED BY: RH

SHEET TITLE

EXISTING  
EXTERIOR  
PHOTOGRAPHS

SHEET NUMBER

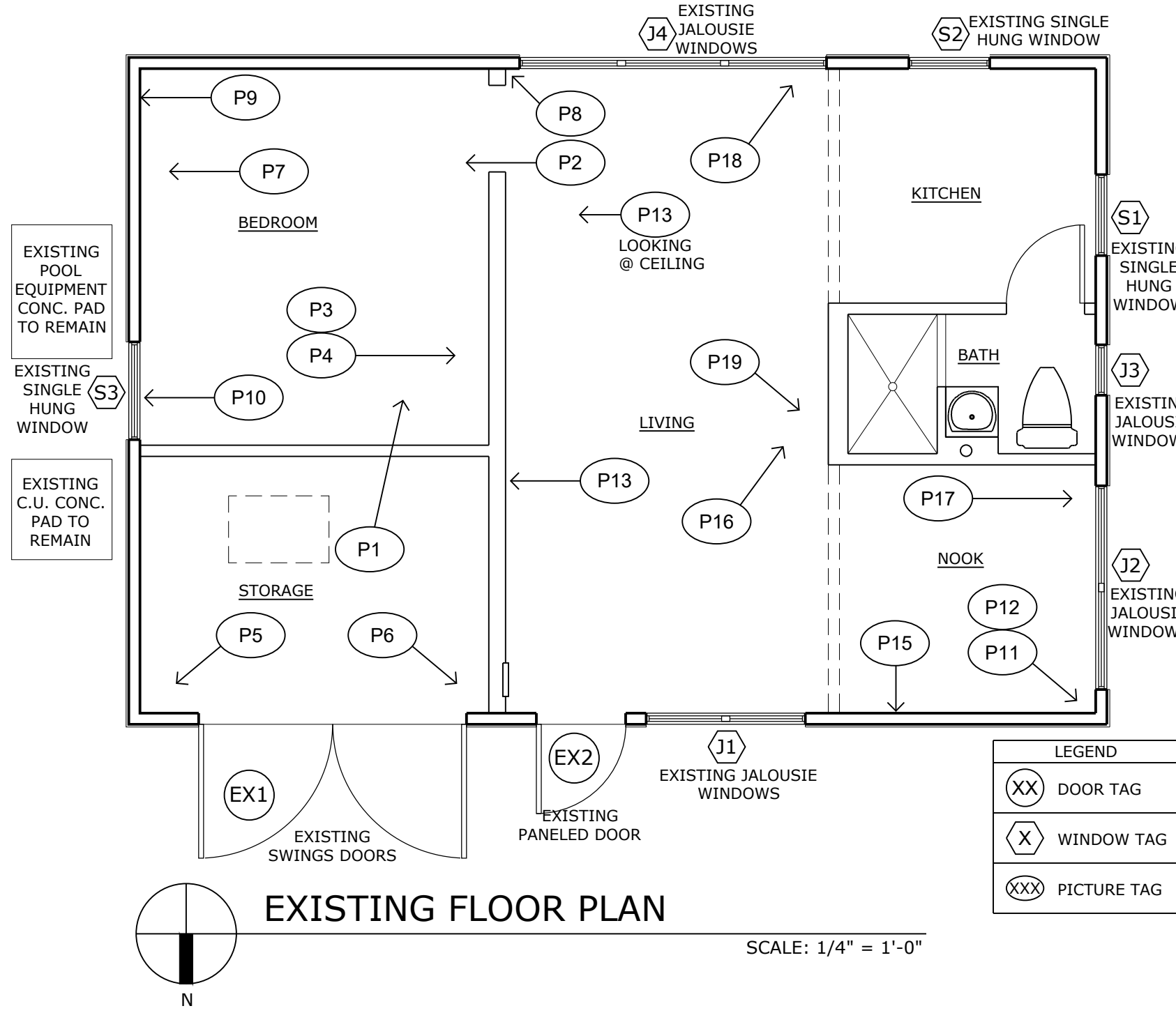

EXISTING EAST ELEVATION



EXISTING EAST ELEVATION



EXISTING NORTH ELEVATION



EXISTING NORTH ELEVATION



EXISTING WEST ELEVATION



EXISTING WEST ELEVATION



EXISTING SOUTH ELEVATION

GENERAL NOTES. TYP.

AS SHOWN EXTERIOR PICTURES: WOOD ROD  
AND TERMITE DAMAGED, INCLUDING BUT NOT  
LIMITED TO:

WINDOWS AND WINDOWS WOOD FRAMING,  
WOOD DOOR AND DOORS WOOD FRAMING,  
WINDOWS AND DOORS WOOD TRIM, EXTERIOR  
WOOD SIDING.