



## Exhibit G



### Public Input Opportunities

- Events
  - Holiday Celebration on December 5, 2025
  - MLK Movie In the Park January 16, 2026
  - Sunset Celebration January 29, 2026
- Stakeholder Meeting
  - January 24, 2026
- Online Survey
  - Distributed to the 5,000 +/- households in Lake Park, FL
  - Email outreach to stakeholders

## Public Engagement Event Stations



Welcome Station



Existing Conditions



Priority Voting

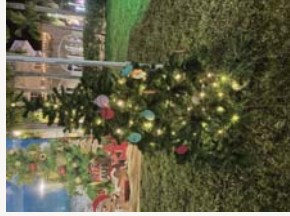

Ornament Wish List



Results

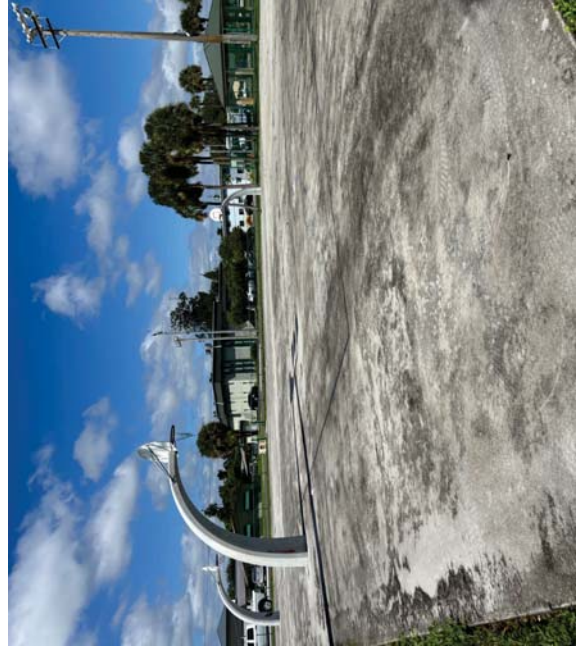

## Existing Conditions Station

- Desire to remove certain facilities, including the concession stand/restroom building and the community center trailer
- Opportunity to resurface the basketball courts
- Reinstate the Rec Center Sports program



# Priority Voting Station

- Highest priorities were the inclusion of soccer facilities and a ninja course
- Other top priorities identified included dog-friendly areas, playgrounds, and a fitness center
- Written suggestions featured bocce ball, handball, dodgeball, swings for all ages, volleyball, water fountains, and monkey bars
- The Town has very few dog-friendly areas

Priority Dot Voting Station	
Soccer	94
Ninja Course	43
Dog-Friendly Areas	42
Playground	41
Fitness Center	41
Community Events	34
Fitness Equipment	32
Shade	30
Football	29
Indoor Gymnasium Court	29
Walking/Multi-Use Path	26
Pickleball	25
Tennis	24
Picnic Pavilion	24
Rental Space	22
Baseball	21
Basketball	20
Meeting Room/Classes	13

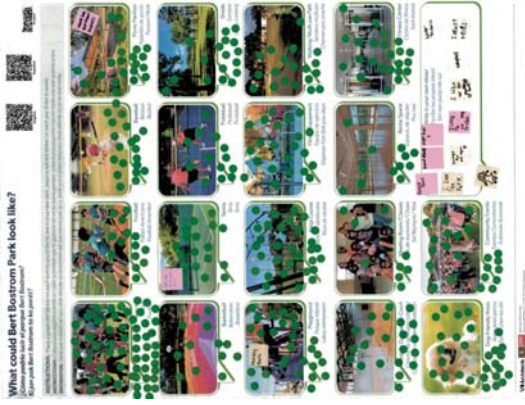

# Ornament Wish List Station

- Children shared a variety of amenities they would like to see in the park, along with activities they enjoy when visiting
- Responses included soccer fields, playgrounds, swings, monkey bars, and slides
- Prefer spaces where they can play freely and have room to run around



# Existing Conditions Station

- Desire to remove existing community center trailer
- Update the concession stand, as well as adding an autolocking system to the restroom building
- Desire for interpretive signage to explain the stormwater system
- Resurfacing the existing basketball court
- Enhancing the pavilion with added seating



**Bert Bostrom Park**  
 10000 West County Road 100  
 Fort Myers, FL 33907

What are your favorite aspects of this park?  
 (Please check all that apply.)

What would you like to see in the future?  
 (Please check all that apply.)

10000 West County Road 100  
 Fort Myers, FL 33907

**Bert Bostrom Park**  
 10000 West County Road 100  
 Fort Myers, FL 33907

What are your favorite aspects of this park?  
 (Please check all that apply.)

What would you like to see in the future?  
 (Please check all that apply.)

10000 West County Road 100  
 Fort Myers, FL 33907

# Priority Voting Station

- Highest priorities were the inclusion of soccer facilities and walking paths
- Other top priorities identified included community event space, ninja course, and picnic pavilions

Priority Dot Voting Station	
Soccer	12
Walking/Multi-Use Path	11
Community Events	10
Ninja Course	8
Picnic Pavilion	8
Football	7
Indoor Gymnasium Court	6
Meeting Room/Classes	6
Shade	6
Playground	5
Baseball	4
Basketball	3
Dog-Friendly Areas	2
Pickleball	2
Outdoor Fitness Equipment	2
Indoor Fitness Center	0
Rental Space	0
Tennis	0

**Bert Bostrom Park**  
 10000 West County Road 100  
 Fort Myers, FL 33907

What would Bert Bostrom Park look like?  
 (Please check all that apply.)

10000 West County Road 100  
 Fort Myers, FL 33907

**Bert Bostrom Park**  
 10000 West County Road 100  
 Fort Myers, FL 33907

What would Bert Bostrom Park look like?  
 (Please check all that apply.)

10000 West County Road 100  
 Fort Myers, FL 33907

## Open Forum

- Support for adding a fence around the playground
- Open-play playgrounds and ninja-style courses
- Shade trees, walking trails, benches, and educational signage
- Sports programming, including soccer, baseball, and flexible recreation spaces.
- Desire for multigenerational design
- Mixed views on indoor facilities: some prefer a fully outdoor park, while others support a small multipurpose building for offices, restrooms, storage, or flexible indoor sports.
- Recommendations to avoid duplicating amenities already available elsewhere
- Additional ideas included a park renaming process with public involvement



## Survey Results

Are you a resident of Lake Park, FL?

199 responses

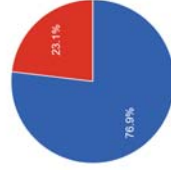

Yes  
No

¿Es usted residente de Lake Park, FL?

4 responses



SI  
No

## Survey Results

Which of the following best describes your household?

199 responses

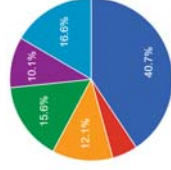

Couple with children at home  
Single with children at home  
Empty nester  
Couple, no children  
Single, no children  
Multi-generational home (grandparents, parents, children)

¿Cuál de los siguientes mejor describe su hogar?

4 responses

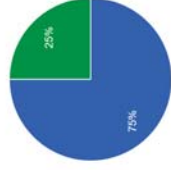

Pareja con niños en el hogar  
Soltero(a) con niños en el hogar  
Nido Vacío  
Pareja sin niños  
Soltero(a) sin niños  
Hogar multi generacional (abuelos, padres, niños)



# Survey Results

The central field must remain open space due to underground stormwater infrastructure. How would you prefer this space be used?  
199 responses



El campo central deberá permanecer como espacio abierto debido a la infraestructura para aguas pluviales. ¿Como preferiría que se usara este espacio?  
4 responses

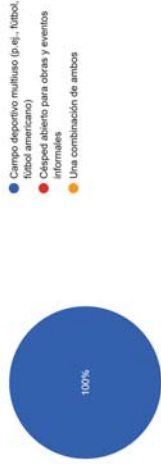

# Survey Results

How important is it to you that the park includes spaces for community gatherings or events (e.g., concerts, markets, movie nights)?  
199 responses

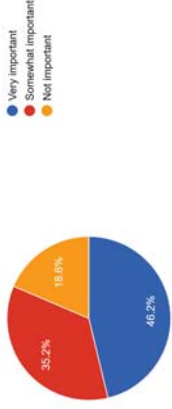

¿Qué tan importante es para usted que el parque incluya espacios para encuentros comunitarios o eventos (p.ej., conciertos, mercados, noches de películas)?  
4 responses



# Survey Results

Would you support a community center/gymnasium building in the park?  
199 responses

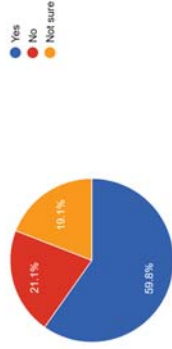

¿Apoyaría usted la edificación de un centro comunitario/gimnasio en el parque?  
4 responses

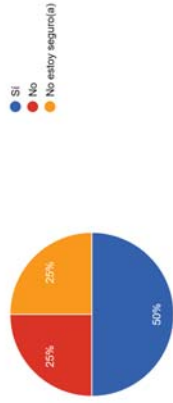

If a community center/gymnasium building were added to this park, what new amenities or features would you like to be included?  
199 responses



¿Si se edifica un centro comunitario/gimnasio en este parque, que nuevos elementos/servicios le gustaría que incluyera?  
4 responses



# Survey Results

How important is it that the park includes environmentally sustainable features (e.g., native landscaping, shade trees, stormwater-friendly design)?  
199 responses



¿Qué tan importante es que el parque incluya elementos ambientalmente sostenibles (p.ej., paisajismo autóctono, árboles de sombra, diseño amigable con las aguas pluviales)?  
4 responses



# Survey Results

- Category Breakdown:
- ADA/Accessibility: 13 responses (18.1%)
  - Other Suggestions: 12 responses (16.7%)
  - No/None/N/A: 9 responses (12.5%)
  - Sports Facilities: 6 responses (8.3%)
  - Benches/Scoreboard: 5 responses (6.9%)
  - Security/Safety: 5 responses (6.9%)

Do you have any accessibility needs or suggestions to make the park more inclusive for all users?  
84 responses

No	
no	
N/A	
ADA	
n/a	
Have the kids play soccer on the field	
Benches, concession stands, and a Score board.	
ADA provisions	
No	

# Survey Results

- Category Breakdown:
- Soccer / Sports: 22 answers (29.33%)
  - Kids & Families: 14 answers (18.67%)
  - Amenities: 13 answers (17.33%)
  - Budget / Funding Concerns. & Opposition: 8 answers (10.67%)
  - Community Events & Programming: 7 answers (9.33%)
  - Safety & Security: 6 answers (8%)
  - Trails / Dogs / Open Space: 5 answers (6.67%)

Do you have any additional comments or ideas for the future of Bert Bostrum Park?  
81 responses

No	
benches, concession stands, and scoreboard.	
Would love to see any type of improvement	
It would be nice to have seating, a scoreboard for games, and concession options. Shaded picnic/raiting areas would be appreciated especially during games or being at the park with kids.	
Bert Bostrum park would be a great place for soccer fields.	
Please, when asking the question "do you support a community center at Bert Bostrum Park", give at least a cost estimate that residents would be agreeing to if they said they will support a community center.	
A community center is a tremendous never ending expense for the taxpayers. It serves a small percentage of residents and often non residents.	
We share a fence with Bert Bostrum. We'd like to see adequate lighting and guidelines put in place to make	

# School Outreach Park Design Activity

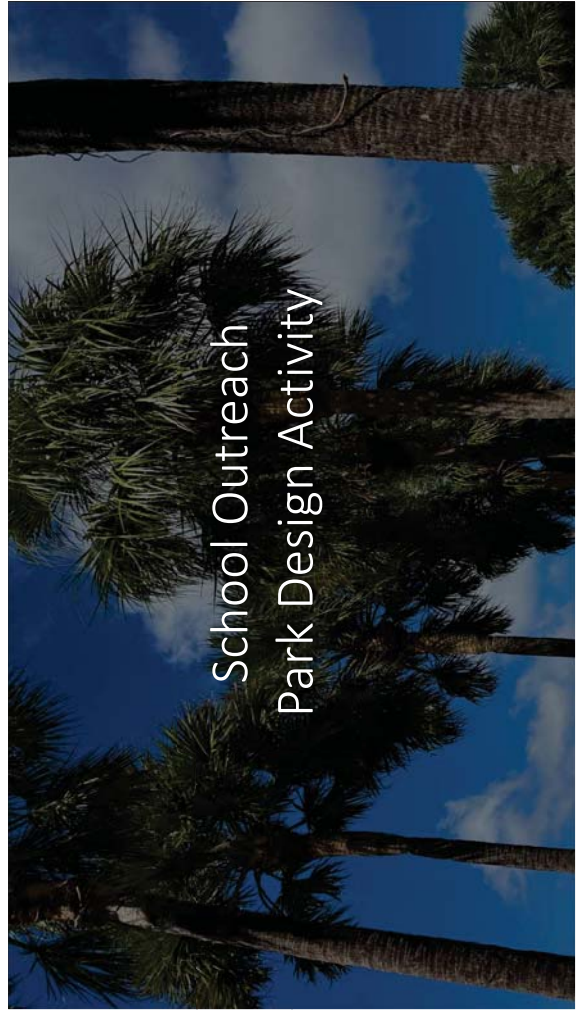

**DRAW YOUR DREAM BEST BOSTROM PARK**

What does your dream park look like? What activities would you like to do?

Name: DAVID Date: 3/15/24

Age: 10

**DRAW YOUR DREAM BEST BOSTROM PARK**

What does your dream park look like? What activities would you like to do?

Name: DAVID Date: 3/15/24

Age: 10

**DRAW YOUR DREAM BEST BOSTROM PARK**

What does your dream park look like? What activities would you like to do?

Top 3 activities:  
Play  
Pool  
Swimming

Any parents?  
Yes  
 Name: DAVID  
 Survey QR Code:

Name: DAVID Date: 3/15/24

Age: 10

**DRAW YOUR DREAM BEST BOSTROM PARK**

What does your dream park look like? What activities would you like to do?

Name: DAVID Date: 3/15/24

Age: 10

**DRAW YOUR DREAM BEST BOSTROM PARK**

What does your dream park look like? What activities would you like to do?

Name: DAVID Date: 3/15/24

Age: 10

**DRAW YOUR DREAM BEST BOSTROM PARK**

What does your dream park look like? What activities would you like to do?

Top 3 activities:  
Party  
Pool  
Swimming

Any parents?  
Yes  
 Name: DAVID  
 Survey QR Code:

Name: DAVID Date: 3/15/24

Age: 10

**DRAW YOUR DREAM BEST BOSTROM PARK**

What does your dream park look like? What activities would you like to do?

Name: DAVID Date: 3/15/24

Age: 10

**DRAW YOUR DREAM BEST BOSTROM PARK**

What does your dream park look like? What activities would you like to do?

Name: DAVID Date: 3/15/24

Age: 10

**DRAW YOUR DREAM BEST BOSTROM PARK**

What does your dream park look like? What activities would you like to do?

Top 3 activities:  
Basketball  
Soccer  
Swimming

Any parents?  
Yes  
 Name: DAVID  
 Survey QR Code:

Name: DAVID Date: 3/15/24

Age: 10

# Program Statement

- Multi-Use Field
- Backstop
- Walking Path
- Outdoor Fitness
- Playground
  - Netting
  - Gaga ball
  - Zipline
- Ninja Course
- Basketball
- Dog Friendly

**DRAW YOUR DREAM PARK**

What does your dream park look like? What activities would you like to do?

Older workout  
 Any can include Basketball courts  
 Concept is Building Blocks of like different areas for all ages.

Making Trail Small Goals  
 Bigger along path  
 Ninja Course  
 Re-school Park  
 Grade School  
 Park

Name: DAVID Date: 3/15/24

Age: 10



## Existing Conditions

### Underground Storage





### Underground Storage

- Space available for things other than multi-use field in yellow

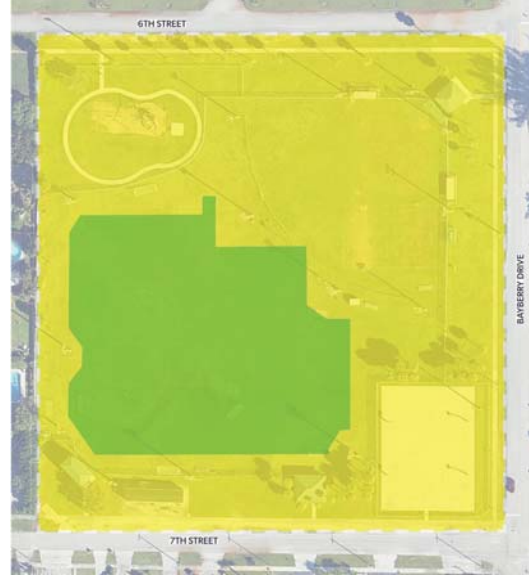



# Greenfields Outdoor Recreation

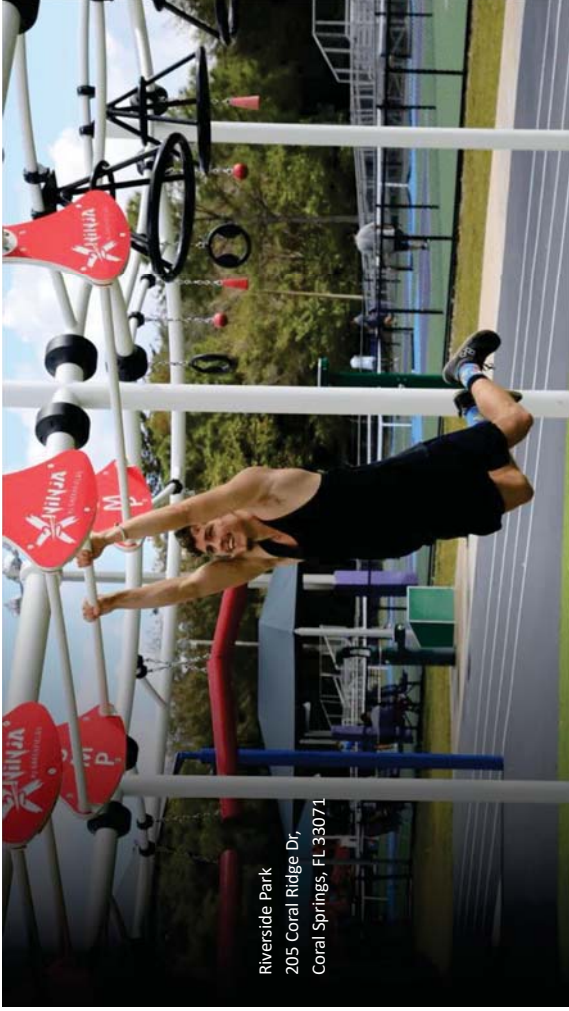

Riverside Park  
205 Coral Ridge Dr,  
Coral Springs, FL 33071



# GameTime



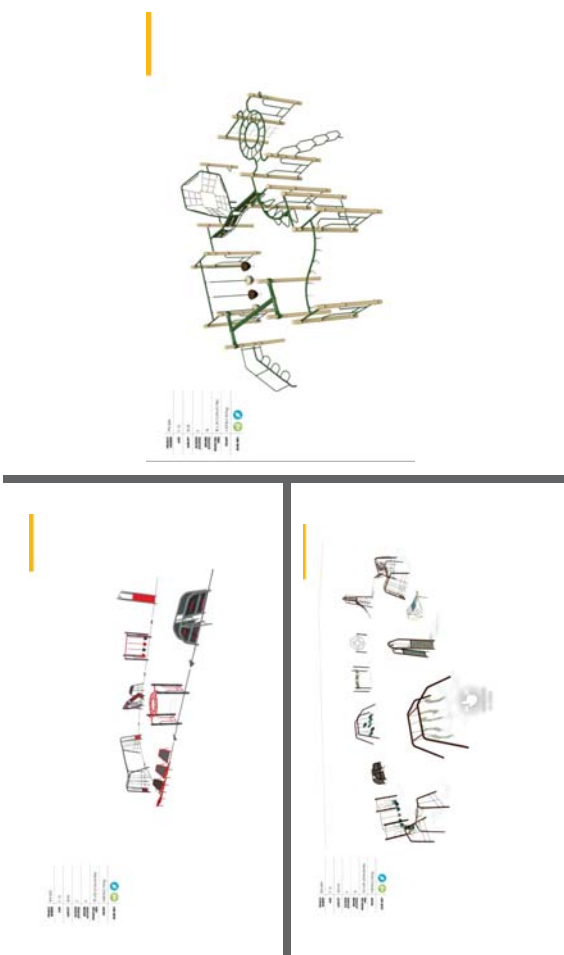
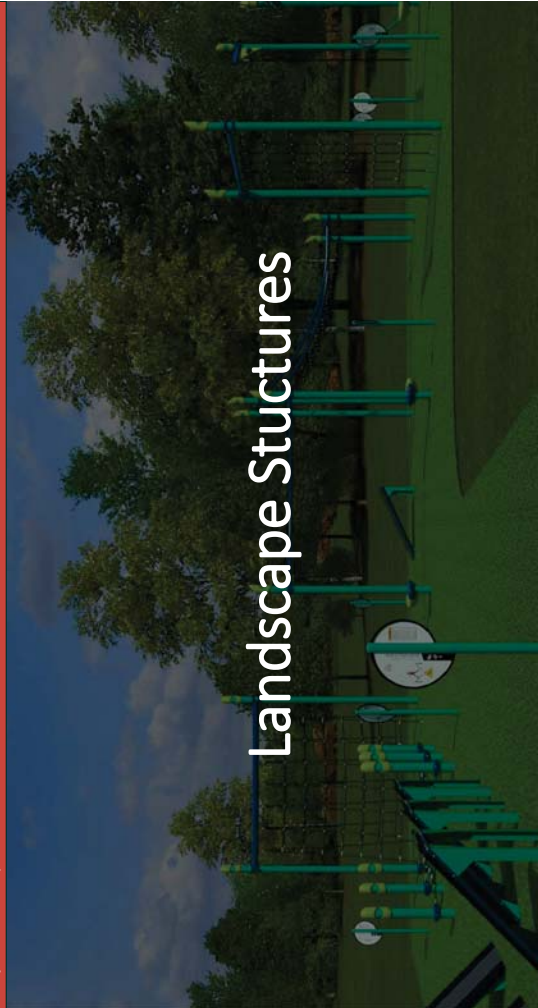
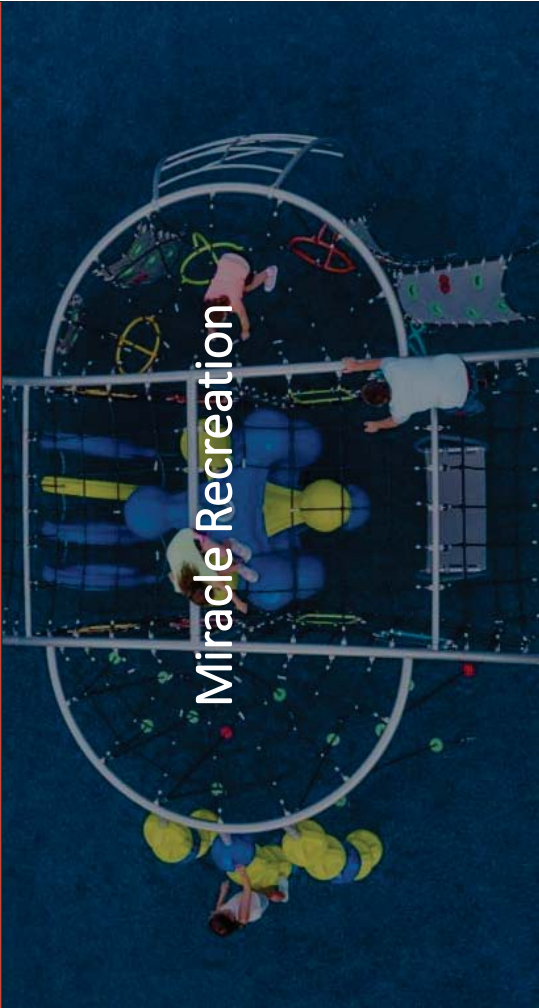

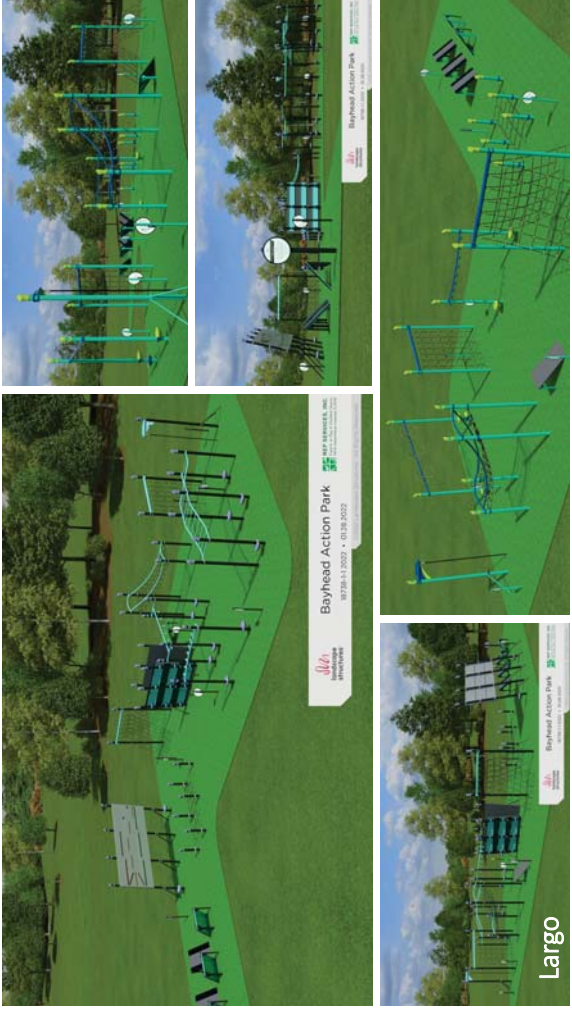

Largo

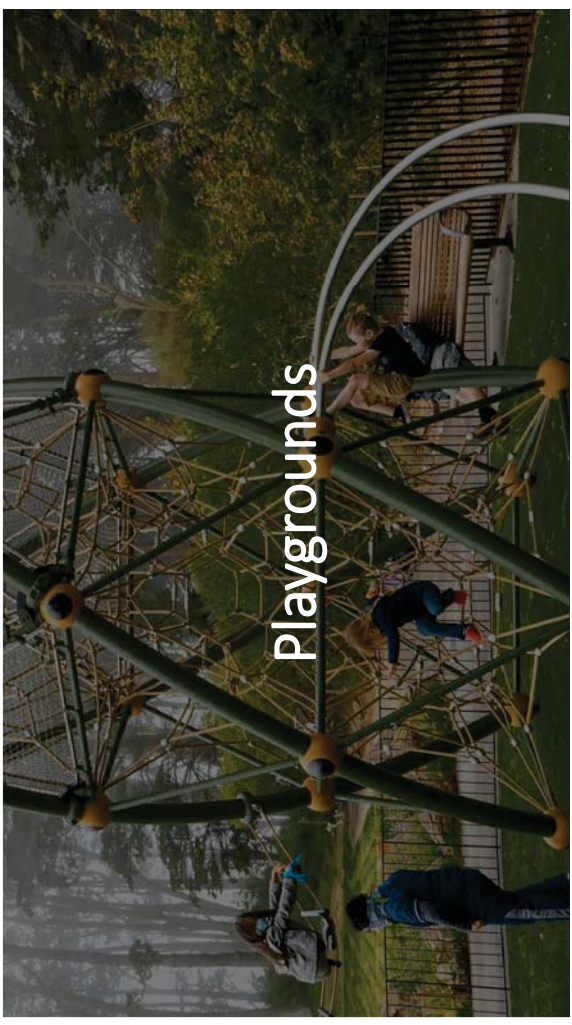

Playgrounds

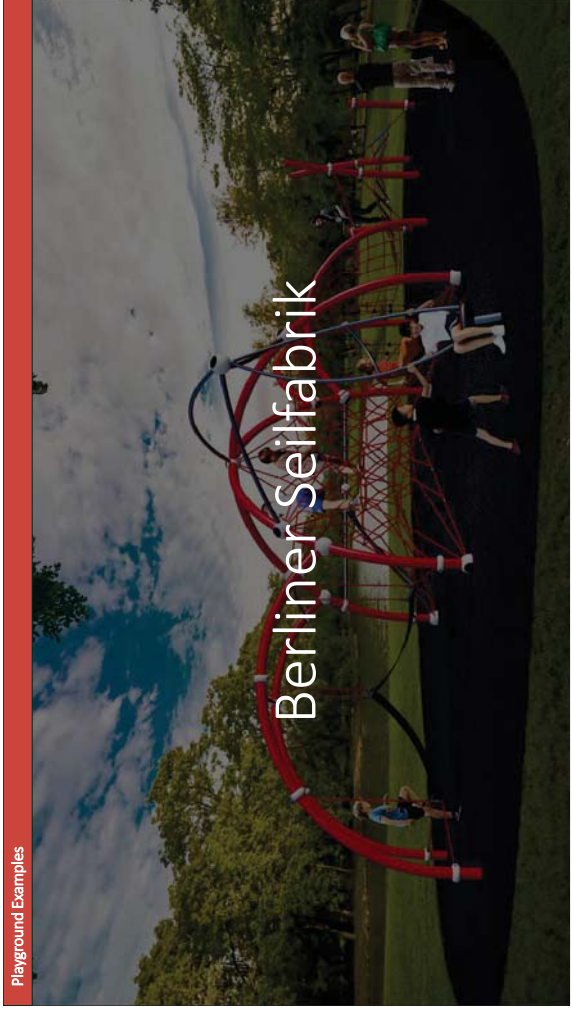

Playground Examples



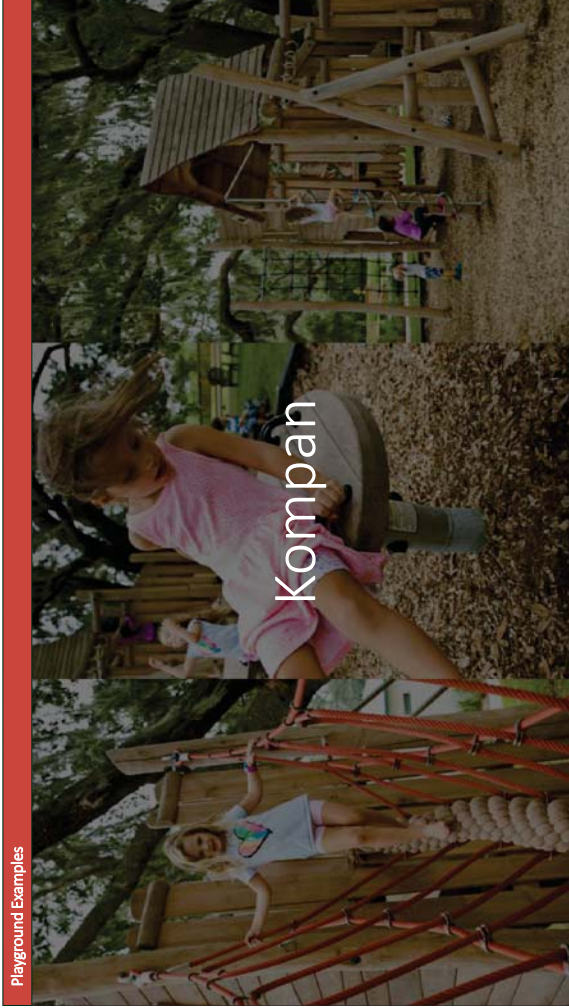

Kompan

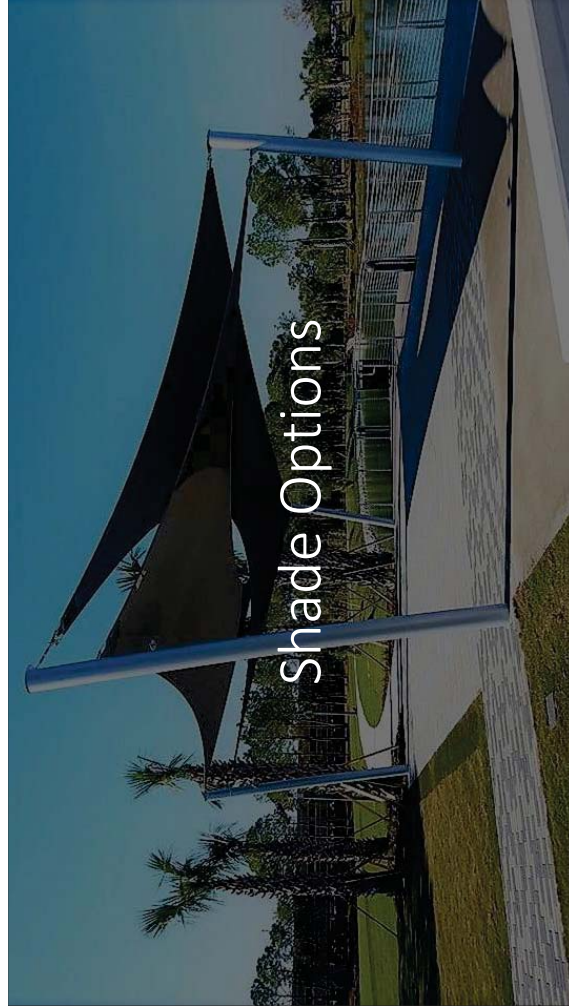

Shade Options



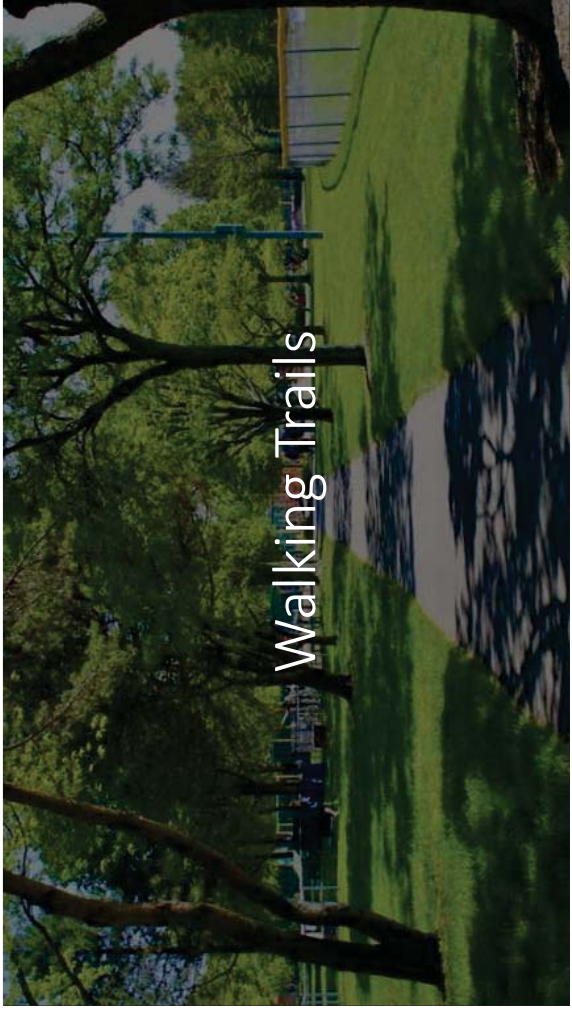

Walking Trails

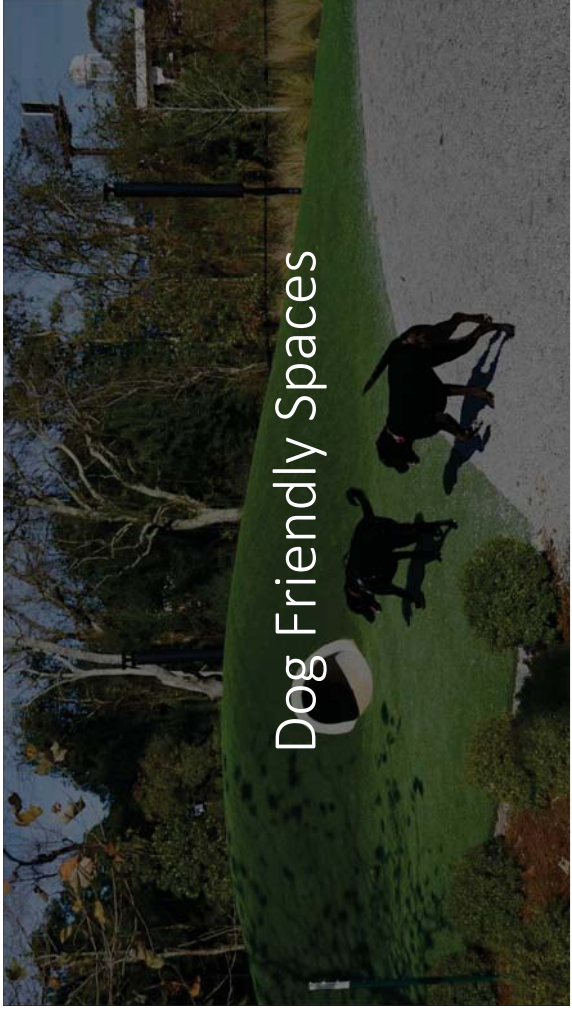

Dog Friendly Spaces





Section

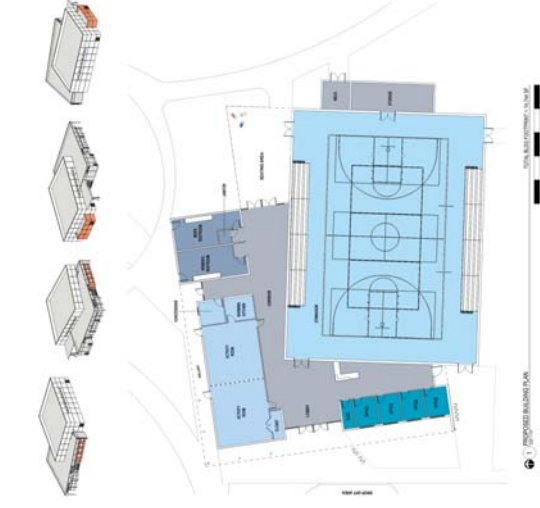

# Bert Bostrom Park

ESTIMATE OF PROBABLE CONSTRUCTION COST

Rough Order of Magnitude Estimate

6/23/2026

ESTIMATE OF PROBABLE CONSTRUCTION COST		ABSOLUTE	VALUE ADDED
SUMMARY (BY COMPONENT)			
A	MULTI-USE SPORTS FIELD (EXISTING)	59,190	0.53%
B	ATHLETIC COMPLEX	7,213,487	64.61%
C	BASKETBALL COURTS (EXISTING)	118,381	1.06%
D	PLAYGROUND	1,040,465	9.32%
E	PLAY MOUND	83,208	0.83%
F	NINJA COURSE	376,757	3.37%
G	PICNIC AREA	49,403	0.44%
H	COMMUNAL LAWN	73,044	0.65%
I	EXISTING CONCESSIONS / RESTROOM BUILDINGS	189,664	1.70%
J	EXISTING TRAILER	Net in Scope	0.00%
K	EXISTING PAVILLION	61,691	0.55%
L	DOG FRIENDLY WALK	276,032	2.47%
M	PARKING	810,366	7.26%
Y	GENERAL SITE WORK & PARK IMPROVEMENTS	802,998	7.19%
<b>ESTIMATE TOTAL:</b>		<b>\$ 11,164,486</b>	

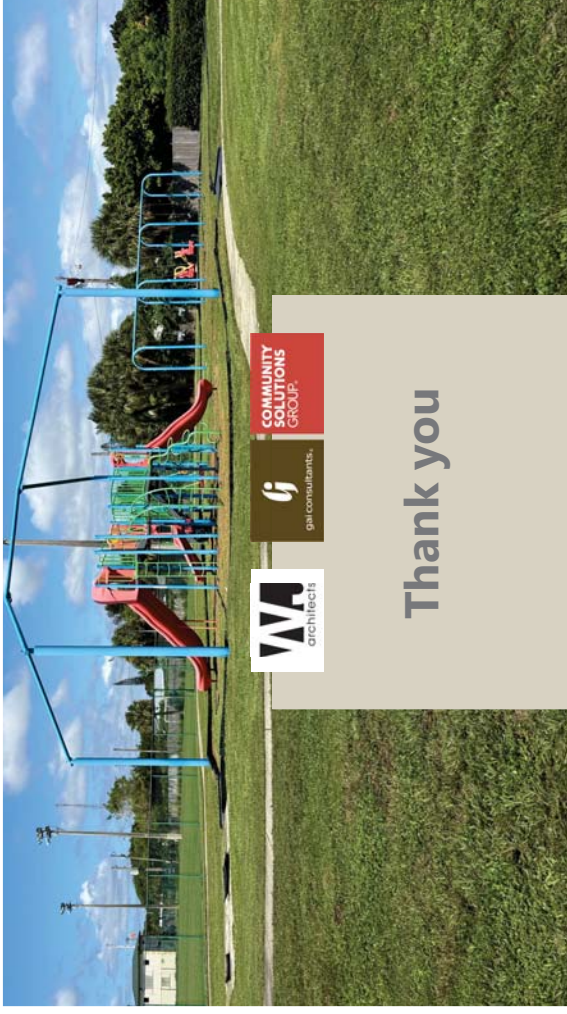

Thank you