



TOWN OF LAKE PARK, FLORIDA - REQUEST FOR PROPOSALS 113-2023

Architecture, Engineering (Various Types),
Landscape Architecture, Survey & Mapping,
Planning and Other Related Services

COMPREHENSIVE PLAN AND COMMUNITY IMPROVEMENT PROGRAM

Tuesday, October 24, 2023, 2 p.m.

Town of Lake Park
Attn: Office of the Town Clerk
535 Park Avenue
Lake Park, Florida, 33403
townclerk@lakeparkflorida.gov



LETTER OF INTEREST

Town of Lake Park
Attn: Office of the Town Clerk
535 Park Avenue
Lake Park, Florida, 33403
townclerk@lakeparkflorida.gov

Subject: REQUEST FOR PROPOSALS (RFP) No. 113-2023 CONTINUING SERVICES - ARCHITECTURE, ENGINEERING

DDEC is pleased to submit this Statement of Interest on behalf of our team of esteemed consultants, BusinessFlare®, Craven Thompson and Associates (CTA), NUE Urban Concepts LLC (NUC), Tierra South Florida, Inc. (TSF), and EXP US. SERVICES Inc. (EXP). This letter serves as an introduction to our firm and team provides relevant information, and includes resumes and forms as required.

DDEC is an engineering, planning, and design firm that creates and implements safe and sustainable transportation infrastructures that promote mobility, accessibility, and improved quality of life in our communities. We are a certified **SBE and M/WBE with FDOT Prequalification** in many categories. With a focus on community engagement, communication, and new technologies, we specialize in federally funded grant projects and innovative solutions that meet our clients' needs and enhance the built environment. At our company, we take great pride in our collaborative approach, which involves working closely and in partnership with our clients to comprehensively understand their unique needs and goals. By fostering a close relationship with our clients, our dedicated teams are able to leverage their extensive technical expertise and industry best practices to deliver innovative and sustainable solutions. These solutions are specifically tailored to enhance the overall implementation of comprehensive plans and community investment program projects.

Our teams of experienced civil engineers and design consultants possess the expertise and knowledge required to execute a wide range of civil engineering projects, grant-funded projects, and support services as described in the Scope of Services provided in the RFP. We possess extensive experience in transportation planning, civil and roadway engineering, landscape architecture, planning, survey, and geotechnical support, which positions our team as highly qualified to assist the Town with its implementation of Lake Park's Comprehensive Plan and Community Investment Program (CIP) for FY 2024-2027. Our proven expertise is evident through successful collaborations with various municipalities, government agencies, and community redevelopment agencies. The team that we have assembled is highly experienced in implementing comprehensive plans and community investment programs and in providing a wide range of professional services including architecture, engineering, landscape architecture, surveying and mapping, planning, and other support services.

Our team's commitment to innovation, combined with our extensive experience, allows us to deliver comprehensive plan and CIP projects that surpass expectations. With our comprehensive understanding of urban design, engineering, architecture, transportation systems, and urban design, we have the ability to create thriving and inclusive communities that benefit residents, businesses, and visitors. Through our collaborative efforts and meticulous attention to detail, we improve infrastructure, support economic development, enhance accessibility, and create sustainable environments that support long-term success.

By combining the strengths of DDEC, BusinessFlare®, CTA, NUC, TSF, and EXP, we offer a comprehensive and multidisciplinary approach to the project. About our Team:



- **CTA:** CTA is a distinguished full-service engineering and surveying firm with over 70 years of experience, specializing in landscape, surveying, transportation, and civil design. Their team of professionals collaborates to deliver innovative solutions tailored to client needs. They offer comprehensive services, including transportation planning and design, site development, water and wastewater treatment, and more, with an emphasis on sustainability. In a support role alongside EXP, CTA bolsters projects, ensuring successful outcomes and a positive impact on communities and the environment.
- **BusinessFlare®:** BusinessFlare® is a renowned planning firm specializing in Community Redevelopment Areas (CRAs), committed to creating inclusive and sustainable spaces that enhance residents' lives and support economic growth. They actively engage with local stakeholders and prioritize community involvement. Beyond planning, they aim to nurture unity and a sense of belonging among residents. Partnering with EXP and other stakeholders, they work to build robust, vibrant communities and promote sustainable growth and prosperity.
- **NUE Urban Concepts, LLC (NUC):** NUE Urban Concepts focuses on innovative land use concepts, mobility plans, and parking strategies. They emphasize reimagining transportation networks and creative techniques like mobility fees. NUC collaborates with other small businesses to provide personalized services and has a strong commitment to community engagement. They have successfully provided land use and transportation planning services across Florida. Although EXP is not explicitly mentioned in NUC's description, it's possible that they collaborate on projects involving transportation and planning.
- **EXP US Services, Inc. (EXP):** EXP is a highly experienced and reputable planning, engineering, and public engagement firm with a strong presence of over 3,500 professionals across North America, including more than 250 experts in Florida spanning 12 offices. EXP is well-positioned to deliver exceptional services, with extensive knowledge in transportation planning, PD&E (Project Development and Environment), and community outreach. They have a track record that includes successfully hosting over 200 charrettes, visioning workshops, and hybrid public meetings throughout Florida, employing tailored strategies to honor the unique character of communities and facilitate meaningful public participation. EXP's skilled team provides cost-effective planning, design, and public information services that align with the goals and objectives of the CRAs they work with. Their commitment to collaboration, innovation, and sustainability ensures the delivery of high-quality solutions tailored to the specific needs of each project, supporting community restoration and economic growth in CRAs.
- **Tierra South Florida, Inc. (TSF):** is a trusted materials testing, inspection, and geotechnical engineering consultant serving South Florida. They have extensive experience working with agencies such as FDOT and USACE. TSF has a local presence with strategically located offices and laboratories, a highly qualified team, and a proven track record of timeliness, accuracy, and cost-effectiveness. Their services include testing and inspections in asphalt and concrete plants, material testing laboratories, pre-stress/precast yards, and earthwork testing in the field.

Our team is committed to delivering exceptional results, leveraging our collective Town, Comprehensive Plan, and CIP experience, and applying innovative strategies to elevate community redevelopment. With our track record of successful implementation and our dedication to creating places where people want to be and stay, we are confident in our ability to make a lasting positive impact in the Town of Lake Park.

Please find enclosed the necessary resumes and forms as requested in the RFP. These documents highlight the qualifications, experience, and roles of our key personnel. Please consider this letter our Statement of Interest, clearly indicating the personnel authorized to make representations on behalf of our firm.

My contact information is as follows:

Uyen Dang, PE
Principal, DDEC
250 Royal Ct.
Delray Beach, FL 33309
Uyen@ddec.com
813-380-6574

Thank you for considering our team for this opportunity. Our technical skills, experience, and dedication to excellence, along with DDEC's leadership, make us the ideal partners for the Town.

Sincerely,



Uyen Dang, PE
Principal, DDEC, LLC

TABLE OF CONTENTS



Tabs

- 1** Designation Form, Organizational Chart, and Debarment Certification
- 2** Respondent and Subconsultant Experience and Proposals
- 3** Proposals and Experience of Consultant's Employees Assigned to the Town
- 4** Effective Communication and Location Considerations for Consultant and Sub-Consultants
- 5** Availability/Scheduling Capacity
- 6** Knowledge/Understanding of Town
- 7** Appendix



1

**Designation Form,
Organizational Chart, and
Debarment Certification**

EXHIBIT I

DESIGNATION OF QUALIFIED DISCIPLINE FORM

Proposed Discipline(s)

Please indicate for which discipline(s) that your firm wishes to be considered by checking next to the discipline(s) shown below and indicating whether services will be provided by 1. Employees of your firm, 2. Sub-contractors, or 3. Both.

Respondents shall include information regarding individuals who will be responsible for this discipline and provide experience and qualifications for each discipline as a part of Respondent's Narrative Response.

<i>Qualified Discipline</i>	<i>Firm's Employees</i>	<i>Sub-Contractor</i>	<i>Firm's Employees and Subcontractor</i>
General Civil Engineering and Roadway Design	<input type="checkbox"/>	<input type="checkbox"/>	X
Stormwater Engineering	<input type="checkbox"/>	X	<input type="checkbox"/>
Transportation Consulting (i.e., Traffic Engineering)	<input type="checkbox"/>	<input type="checkbox"/>	X
Engineering and planning studies/investigations, preparation of plans and specifications, provide bidding assistance, inspection, and administration of construction, permitting of TOWN roads, bridges and other horizontal control work as required in the implementation of the approved capital program.	<input type="checkbox"/>	<input type="checkbox"/>	X
Architectural, (preferably with experience in historic preservation work)	<input type="checkbox"/>	X	<input type="checkbox"/>

Electrical, Supervisory Control and Data Acquisition (SCADA), and geographical information systems (GIS)	<input type="checkbox"/>	X	<input type="checkbox"/>
Environmental Planning and Studies	<input type="checkbox"/>	X	<input type="checkbox"/>
Irrigation Design	<input type="checkbox"/>	X	<input type="checkbox"/>
Landscape Architectural	<input type="checkbox"/>	X	<input type="checkbox"/>
Land Surveying and Mapping	<input type="checkbox"/>	X	<input type="checkbox"/>
Mechanical	<input type="checkbox"/>	X	<input type="checkbox"/>
Urban Planning (AICP Certification preferred)	<input type="checkbox"/>	<input type="checkbox"/>	X

END OF RFP 113-2023 DOCUMENT.

P:\DOCS\26508\00001\DOC\28H4116.DOCX



ORGANIZATIONAL CHART

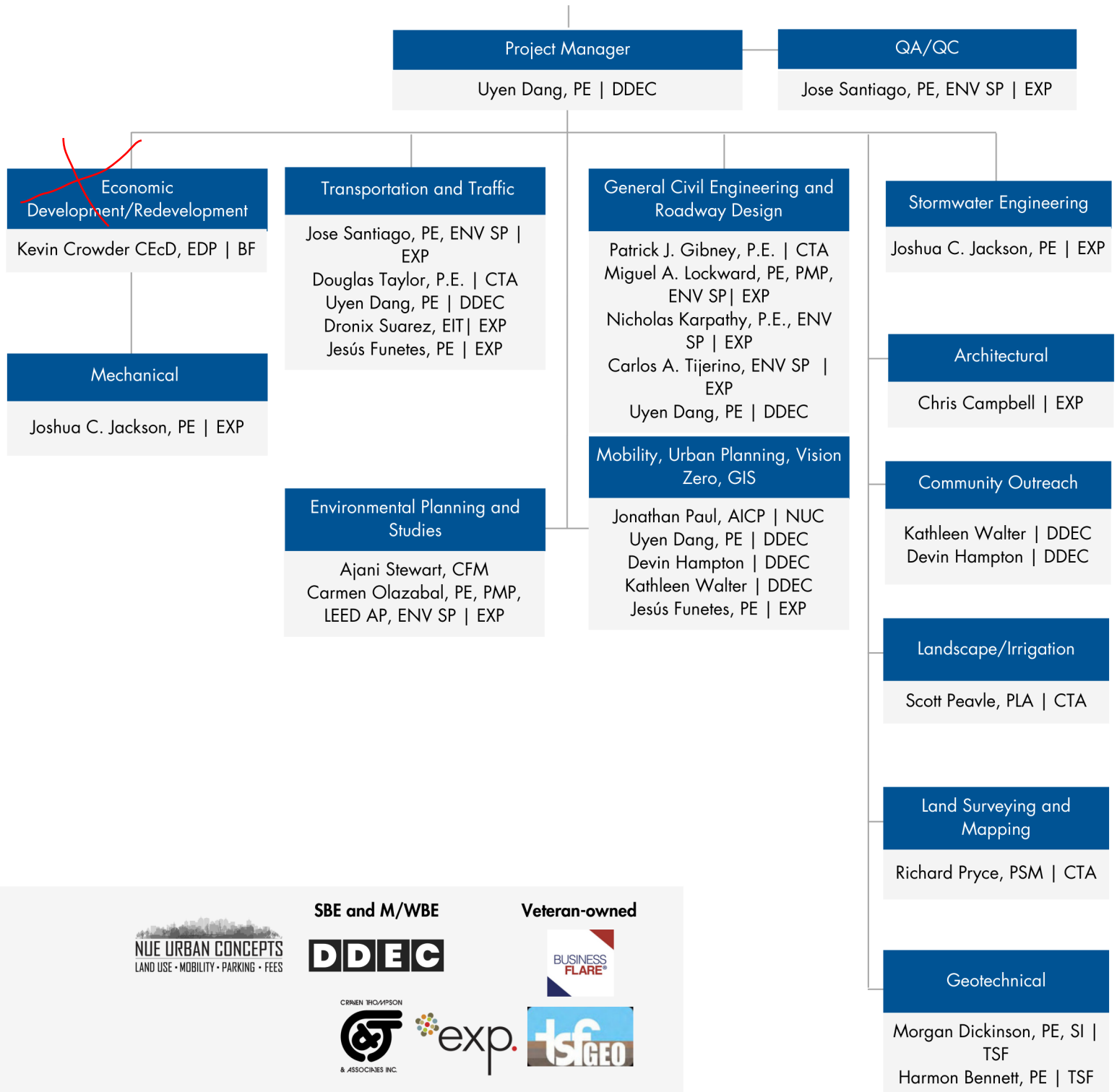

EXHIBIT H

**CERTIFICATION REGARDING DEBARMENT,
SUSPENSION, INELIGIBILITY, AND VOLUNTARY
EXCLUSION – LOWER TIER PARTICIPANT**

Certification regarding Debarment Suspension, Ineligibility and Voluntary Exclusion- Lower Tier Covered Transactions pursuant to 49 CFR 24, Code of Federal Regulations, Part 24.510(b):

By signing and submitting this proposal, the prospective lower-tier participant certifies that neither it, nor its principals are presently debarred, suspended, proposed for debarment, declared ineligible, or voluntarily excluded from participation in this transaction by any Federal department or agency. The prospective Lower-Tier participant further certifies that:

3. I, and any principals of my firm, understand that the certification in this clause is a material representation of fact upon which reliance was placed when this transaction was entered into. If it is later determined that I/we knowingly rendered an erroneous certification, in addition to other remedies available to the Federal Government, the department or agency with which this transaction originated may pursue available remedies.
4. Further, I, and any principal of my firm, shall provide immediate written notice to the person to whom this proposal is submitted if, at any time, we learn that my/our certification was erroneous when submitted, or has become erroneous by reason of changed circumstances.
5. By submitting this proposal, I, and any principals of my firm, agree that should the proposed covered transaction be entered into, I/we will not knowingly enter into any Lower-Tier covered transaction with a person who is debarred, suspended, declared ineligible, or voluntarily excluded from participation in this covered transaction unless authorized by the agency with which this transaction originated.
6. I, and any principals of my firm, further agree by submitting this proposal that I/we will include this Certification, without modification, in all Lower-Tier covered transactions and in all solicitations for Lower-Tier covered transactions.

Contractor Name: DDEC, LLC

Address: 250 Royal Court

City: Delray Beach State: Florida Zip: 33444

Signature: [Signature] Date: 10.23.23

NON-CERTIFICATION:

Contractor Name: _____

Address: _____

City: _____ State: _____ Zip: _____

Signature: _____ Date: _____



2

Respondent and Subconsultant Experience and Proposals

PAST PERFORMANCE RECORDS IN SUPPORT OF MUNICIPALITIES OR OTHER GOVERNMENT AGENCIES

Project	DDEC	BusinessFlare®	NUC	CTA	EXP	TSF
Transit Enhancements	X				X	X
Traffic Signal Optimization					X	X
Intersection Improvements	X			X	X	X
Road Widening or Expansion	X			X	X	X
Traffic Calming Measures	X	X	X	X	X	
Intelligent Transportation Systems (ITS)					X	
Parking Management and Expansion	X	X	X			
Traffic Impact Studies	X				X	
Transportation Demand Management	X	X	X			
Traffic Safety Education and Enforcement	X				X	
Transportation System Maintenance and Repair					X	X

THREE CURRENT CUSTOMERS/REFERENCES

Three (3) current customers/references to which the firm is providing or has provided similar services include the following:

- Dept. of Engineering Services, City of West Palm Beach – Kevin Volbrecht (561) 494-1091
- Martin County Community Redevelopment Agency, Susan Kores, (561) 288-5400
- City of West Palm Beach, Office of Sustainability – Penni Redford (561) 822-1400

ORG CHART & AVAILABILITY OF QUALIFIED PERSONNEL

Our organizational chart is detailed in section 1. Our Availability of Qualified Personnel is detailed in Section 5.

PAST EXPERIENCE WITH THE TOWN

The DDEC team, in close collaboration with NUC and BusinessFlare, has not only been instrumental in shaping the Town of Lake Park's infrastructure and development plans but has also demonstrated a profound understanding of the Town's governance processes. Their expertise extends beyond the mere execution of projects; they comprehend the intricate framework of the Town's procedures for taking a project from initial planning stages through to final development. This nuanced understanding has allowed them to seamlessly navigate the bureaucratic intricacies, ensuring that projects are not only well-conceived but also align with the Town's long-term vision.

Moreover, the DDEC, NUC, and BusinessFlare partnership has proven to be invaluable in bridging the gap between community needs and municipal objectives. Their involvement in crafting the mobility plan and engaging with the local population during adoption demonstrates a commitment to participatory governance, ensuring that the community's voice is heard and integrated into the planning process. This collaborative approach extends to identifying funding needs for essential projects, including traffic calming measures, which helps ensure the Town's infrastructure developments are both fiscally responsible and community-focused. Overall, their profound understanding of the Town's governance processes, combined with their dedication to community engagement, has established them as trusted partners in Lake Park's growth and development journey.



PAST PROJECT EXPERIENCE

Our collaborative team, comprising DDEC, BusinessFlare®, CTA, TSF, NUC, and EXP, has successfully undertaken diverse projects within the Comprehensive Plan and Community Improvement Program (CIP) across South Florida. With expertise in engineering services, transportation planning, strategic planning, and review consultation, we have played a key role in supporting the development and revitalization efforts within these CIPs. Our contributions to the City of Hollywood Florida Community Redevelopment Agency, including essential engineering services in coastal marine, traffic engineering, and transportation planning, have been instrumental. Additionally, completing the Omni Community Redevelopment Agency Plan Update 2023 and providing strategic planning and review consultation services for Miami-Dade County’s OCITT showcase our commitment to driving progress and transformation in these communities.

BusinessFlare® and DDEC have led Planning Services for the Martin County CIP, demonstrating our ability to develop visionary plans and frameworks for design and construction. Noteworthy projects, such as the SE Railway Avenue Extension and the **Creekside Linear Park Boardwalk**, exemplify our capacity to deliver innovative solutions in support of CIPs, driving growth and prosperity within the communities we serve. BusinessFlare®’s concept and design for **the Innovation Hub, spanning two CIPs**, received unanimous approval from the Martin County Board of Commissioners, further highlighting our team’s dedication to delivering exceptional outcomes. Additionally, NUC and DDEC collaborated on the Town of Lake Park Mobility Study. At the same time, BusinessFlare® took on the **CIP Plan** for the Town of Lake Park, ensuring efficient transportation systems and laying the groundwork for revitalization. With our extensive experience and commitment to excellence, we are the ideal partner for the Town of Lake Park, ready to drive progress and transform communities.

Team Collaborative Experience Current Projects:

Project	DDEC	BusinessFlare®	CTA	EXP	TSF
City of Hollywood Florida Community Redevelopment Agency Engineering Services - Coastal Marine and Traffic Engineering & Transportation Planning	X	X	X	X	X
Martin County Planning Services for Community Redevelopment Agency	X	X			
Omni Community Redevelopment Agency Plan Update 2023	X	X			
Miami Dade County - Strategic Planning and Review Consultant Services for OCITT	X	X		X	
City of Parkland General Engineering Services	X		X		
Town of Lake Park Mobility Study	X				

The following section will highlight relevant projects that best represent the Town’s capital project program. These projects helped revitalize many communities like the Town. We believe that, with our experience, we can help deliver results effectively and help navigate through complex funding challenges. The DDEC team has a successful track record in securing capital funds through successful grant-writing efforts, effectively offsetting capital costs for various projects. Our expertise in grant acquisition has resulted in significant achievements, including securing over \$10 million in total funding within the last year alone. We have played a role in assisting the City of West Palm Beach, where we currently hold a contract, in securing multiple grants such as the RAISE Grant and the Local Initiative Grant, among others. Our substantial grant awards provided crucial financial support, enabling vital projects and driving positive community transformation. Our dedication to grant writing and identifying funding opportunities showcases our commitment to helping clients realize their vision.

GRANT AWARDED: \$7,408,000
FEE: \$200,000
Construction Cost: TBD

PROJECT LOCATION: City of West Palm Beach, FL

PROJECT FOCUS: Grant Administration, Environmental Compliance, Geometric Design, FDOT Coordination, Plans Review, Community Engagement, Stakeholder Coordination, Branding, Wayfinding, Commission Approval, Cost Estimating, Specifications and bid documents.

SCHEDULE: 2022 Completed

REFERENCE:

Kevin Volbrecht, PE
Director of Engineering Services
401 West Clematis Street
West Palm Beach, FL 33441
kcvolbrecht@wpb.org



Parker Avenue Rehabilitation Complete Streets Project

The Parker Avenue Improvement Project, initiated by Uyen during her tenure with the City of West Palm Beach, is now being supported by the DDEC team in administering the project through the design and construction phases. The Parker Avenue Improvement Project aims to enhance the transportation infrastructure and improve the overall quality of the community. The project focuses on Parker Avenue and involves various elements such as roadway improvements, traffic signal enhancements, sidewalk enhancements, landscaping, and drainage improvements. It also incorporates pedestrian and bicycle-friendly features to promote safer and more accessible transportation options. The project is expected to enhance connectivity, improve traffic flow, and create a more vibrant and sustainable environment for residents and visitors of West Palm Beach. Their involvement includes thorough plan review, community engagement efforts to gather input and address concerns, and stakeholder coordination with local businesses and residents. Additionally, they focus on branding and wayfinding to enhance visual identity and provide clear directions and information for users.

FEE: \$60,000
Construction Cost: Unknown

PROJECT LOCATION: City of West Palm Beach, FL

PROJECT FOCUS: Smart Cities, Curb Management, Mobility Hub, Transit Shelters ITS, Access Management, Parking Study, Pilot Implementation.

SCHEDULE: 2022 Completed

REFERENCE:

NDT Development
Damien Barr
Co-Founder & Managing Partner
Phone: 561-252-1319
damien@ndtdevelopment.com



NoRa Smart Mobility Hub and Transportation Demand Management

DDEC is the mobility consultant for a newly established mixed-use redevelopment district in the heart of Downtown West Palm Beach CRA. The team provided an implementation strategy such as a Mobility Hub design to expand mobility services, and connectivity to Downtown West Palm Beach. Other implementation strategy includes parking management technology, on-demand microtransit, electrification, access management, event management, and circulation.

FEE: \$34,000

Construction Cost: TBD

PROJECT LOCATION: Martin County

PROJECT FOCUS: Roadway Design, Streetscape, Urban Design, Cost Estimating, Community Engagement

SCHEDULE: 2023 - Ongoing

REFERENCE:

Susan Kores

Community Development Manager

Phone: 772 320-3095

E-mail: skores@martin.fl.us

2401 SE Monterey Road

Stuart, Florida 34996



SE Railway Avenue Extension and Creekside Linear Park/ Boardwalk

DDEC and BusinessFlare® were selected by Martin County CRA to conduct continuing services as needed. The purpose of this project is to assess the feasibility of extending SE Railway Avenue in Downtown Port Salerno. The goal of the extension is to better connect the downtown to the southern neighborhood and to the future creek-side linear park and open space. This project is part of the Martin County Innovation Hub, therefore any solutions should work towards that vision.

FEE: \$200,000

Construction Cost: TBD

PROJECT LOCATION: Town of Lake Park, Florida

PROJECT FOCUS: Mobility Plan, Multimodal Network, Cost Estimating, Traffic Calming Concept, Design Standards, Community Engagement

SCHEDULE: Completed

REFERENCE:

Town of Lake Park

Nadia Di Tommaso - Community

Development Director

535 Park Avenue

Lake Park, FL 33403

Phone: (561) 881-3319

NDiTommaso@lakeparkflorida.gov



Town of Lake Park Mobility Plan and Traffic Calming Program



This project focuses on aligning competing demands for space and a limited public right of way to prioritize and implement a multimodal transportation network. The project team provided transportation planning, transportation modeling, mapping, cost estimating, and development of mobility fees. As part of the communications strategy, the team developed the project website, direct mail marketing, online surveying, and social media marketing, and prepared press releases to gain public interest. The plan will help the Town balance prioritizing pedestrian safety and providing adequate vehicular access for future growth.

PROJECT EXAMPLES:

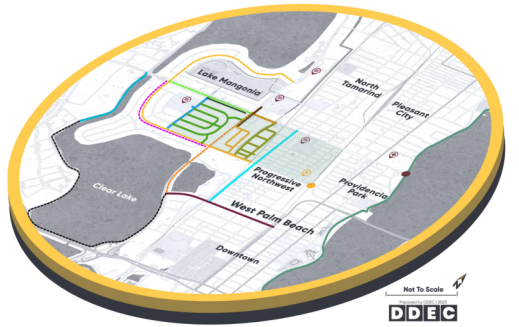

GRANT APPLIED: \$10,168,884.00

PROJECT LOCATION: City of West Palm Beach, FL

PROJECT FOCUS: Grant Writing, Grant Application, Stakeholder Engagement, Research, Resiliency, Utilities and Drainage Improvements, Lighting, Transit Access, Neighborhood Improvements, Safety, Transportation Planning, Equity, Cost Estimating



SCHEDULE: 2023 Completed

REFERENCE:

Kevin Volbrecht, PE
Director of Engineering Services
401 West Clematis Street
West Palm Beach, FL 33441
kcvolbrecht@wpb.org

Rebuilding American Infrastructure with Sustainability and Equity (RAISE)

DDEC helped the City of West Palm Beach apply for an RAISE grant emphasizing sustainability, equity, and resilience in infrastructure. WPB on the RISE project met the criteria by incorporating innovative design, community engagement, and mobility/accessibility measures. DDEC obtained letters of support, collaborated with the City, and obtained commission approval.

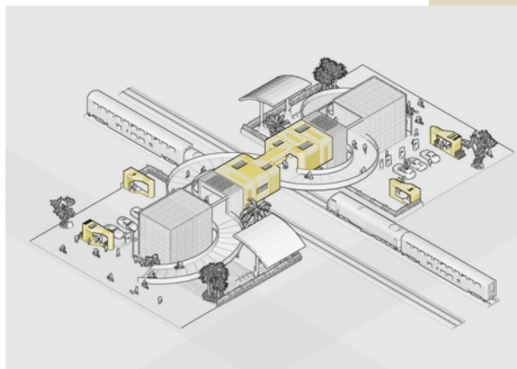

GRANT AWARDED: \$400,000

PROJECT LOCATION: City of West Palm Beach, FL

PROJECT FOCUS: Grant Writing, Grant Application, Stakeholder Engagement, Railroad Safety, Transportation Planning, Pedestrian Bridges, Conceptual Design.



SCHEDULE: 2022 Completed

REFERENCE:

Genia Baker
Project Manager
West Palm Beach CRA
401 West Clematis Street
West Palm Beach, FL 33441
gbaker@wpb.org

Reconnecting Communities Pilot and Railroad Crossing Elimination Discretionary Grant

West Palm Beach pursued the RCP and RCE grants to enhance safety along the FEC Railway, with DDEC's support in preparing documents for the WPB SUN PATH planning study. The study aimed to build bridges and restore community connectivity, with resolutions passed by the City Commission. The grant was awarded in 2023.

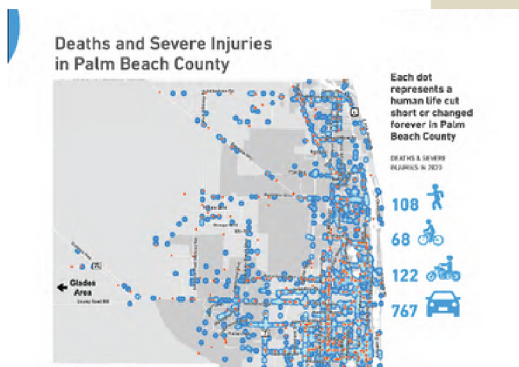

FEE: \$200,000

CONSTRUCTION COST: TBD

PROJECT LOCATION: City of West Palm Beach

PROJECT FOCUS: Data Analysis, Grant Application, Program Development, Scope Development



SCHEDULE: 2023 Completed

REFERENCE:

Kevin Volbrecht, PE
Director of Engineering Services
401 West Clematis Street
West Palm Beach, FL 33441
kcvolbrecht@wpb.org

City of West Palm Beach SS4A Vision Zero Action Plan Grant Application

The City of West Palm Beach adopted a Vision Zero Policy in 2018 and began creating a framework behind road safety. Since Covid19, the program was deferred until 2022 where the opportunity to apply for SS4A funding. DDEC supported the City of West Palm Beach under the Grant Services contract to develop and secured over \$400k funding to develop the Action Plan. This plan will include railroad safety initiatives and falls in line with the Safe Systems Approach Plan



Multimodal Corridor Analysis

Experience Level

EXP as Prime

Timeline

2021-present

Services

- Transportation Planning
- Transit Operations Planning
- Facilities Planning
- Public Participation
- Environmental + Sustainability
- Visualization + Graphics

Agency/Client Contact

FDOT Modal Development Office

Daniel Lameck

(305) 470-5238

Daniel.Lameck@dot.state.fl.us

NW 36 Street Multimodal Corridor Study

Florida Department of Transportation (FDOT) District Six
Miami-Dade County, FL

NW 36 Street is an east-west corridor in Miami-Dade County that goes from SR-826/Palmetto Expressway to I-195/SR-112/Julia Tuttle Causeway for about 8.626 miles and traverses the Village of Virginia Gardens as well as the Cities of Miami Springs, Hialeah, and Miami.

This corridor serves the Miami International Airport (MIA) and the Florida East Coast (FEC) Hialeah Railyard, as well as major recreational and community centers such as the Miami Springs Golf and Country Club, Casino Miami, Tropicana Flea Market, Miami Jackson Senior High School, and the Shops at Midtown Miami.

During the development of concept alternatives and multimodal improvements, EXP developed corridor-specific High Injury Networks (HINs) to determine high-injury clusters and segments. This approach helped identify locations where creating safer road environments for all users was urgently needed to reduce the number of crashes, injuries, and fatalities in close coordination with local municipalities, FDOT District Six, and Miami-Dade County Department of Transportation and Public Works (DTPW).





5 Tri-Rail Stations

Experience Level

EXP as Sub

Timeline

2023-present

Services

- Transportation Planning
- Transit Operations Planning
- Facilities Planning
- Bike/Ped Facilities

Agency/Client Contact

Jeannine Gaslonde, EI, FCCM
(305) 375-1739

Jeannine.Gaslonde@miamidade.gov

SMART STEP Tri-Rail Pedestrian/Bicycle Infrastructure Needs Evaluation and Recommendations Study

Miami-Dade Transportation Planning Organization (TPO)
Miami-Dade County, FL

The Miami-Dade TPO Urban Mobility and Non-Urban Core Task Force is facilitating interagency coordination, innovation, and accelerated implementation of pedestrian and bicycle improvement projects in Miami-Dade County to increase connectivity and enhance safety.

EXP prepared a set of recommendations for all five (5) Tri-Rail Stations (Golden Glades, Opa-Locka, Metrorail Transfer, Hialeah Market, and the Miami International Airport Tri-Rail Stations) in Miami-Dade County to address bicycle and pedestrian safety needs after collecting and analyzing comprehensive crash data to identify trends, high-risk areas, and contributing factors to crashes. Commuter station-specific High Injury Networks (HINs) were developed to allocate resources for road safety initiatives, infrastructure improvements, and educational campaigns, using data to inform decision-making and prioritize interventions as part of the Strategic Miami Area Rapid Transit (SMART) Street Transportation Enhancements Program (STEP) from the Miami-Dade TPO Urban Mobility and Non-Urban Core Task Forces. as part of the Strategic Miami Area Rapid Transit (SMART) Street Transportation Enhancements Program (STEP) countywide.



Intersection Safety

NW 154 Street and Miami Lakeway North Intersection Safety Study Town of Miami Lakes Miami Lakes, FL

Experience Level

EXP as Prime

Timeline

2022

Services

- Traffic Engineering

Agency/Client Contact

Carlos Acosta, PE

(305) 364-6100

acostac@miamilakes-fl.gov

EXP conducted an intersection safety study at the high-profile location of NW 154 Street (Miami Lakes Drive) and Miami Lakeway North in the Town of Miami Lakes. The study's purpose was to reduce crashes, most importantly fatalities, and serious injuries by evaluating the intersection and providing recommendations for improvement.

The T-intersection lands on a sharp horizontal curve, creating concern about the overall safety of the intersection. The intersection was experiencing roadside departure crashes in a residential neighborhood, generating apprehension for community safety, particularly regarding pedestrians and cyclists within the area.

EXP's study included day and night-time site visits to assess visibility, signage, pavement markings, and driver behavior. The analysis also included assessing speeds for over 400 vehicles. Operational analyses to review any kind of turn lane constraints, spillback into the thru lanes, turn lane warrant analyses, and deficiencies in signal timing were performed.

Bluesten Park Hallandale Beach, Florida

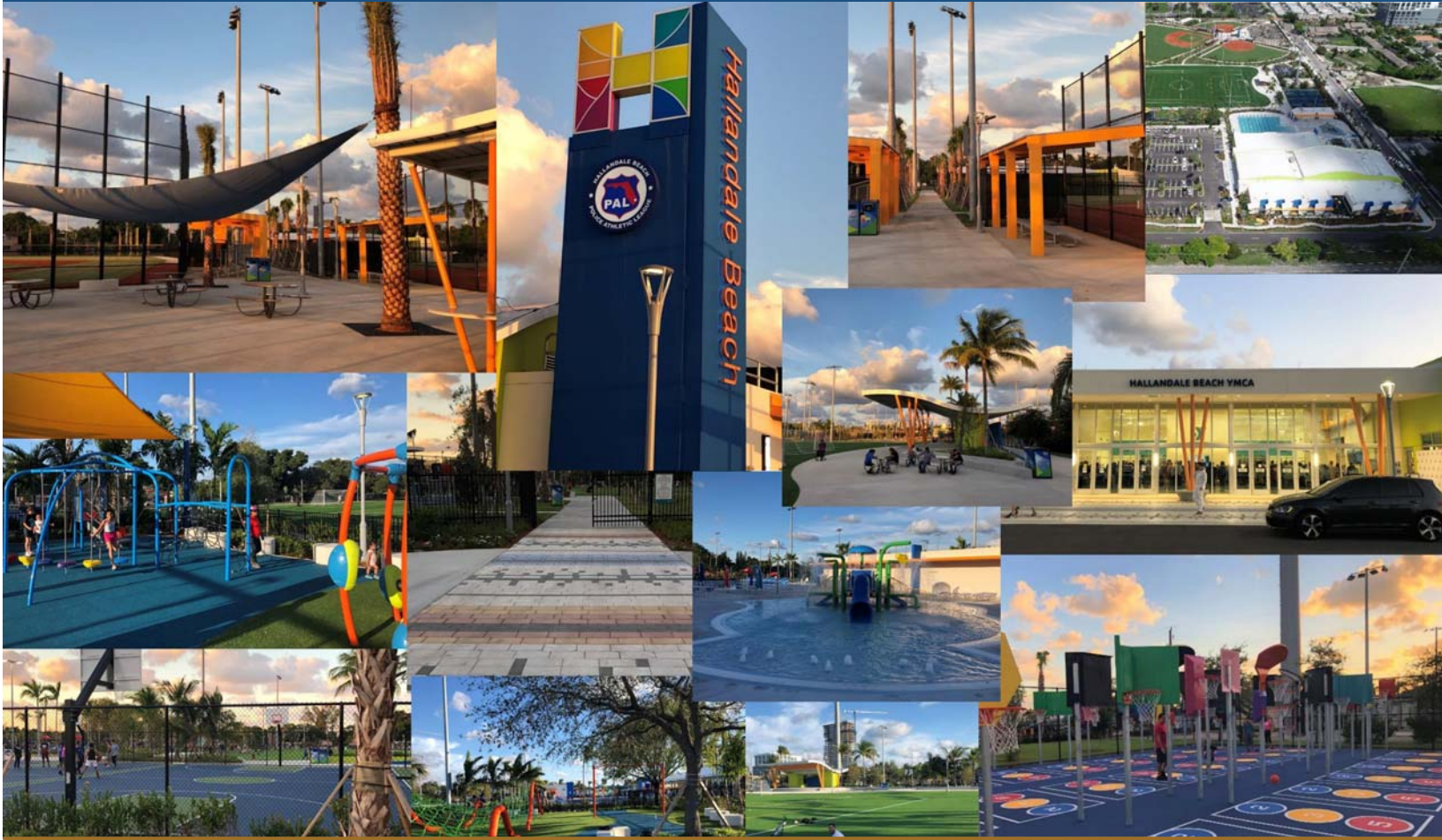

Description of Work:

Bluesten Park includes a 42,000 sf Recreation Center with Pool and Splash Play Area, Soccer-Multi-Use Field, three baseball Fields, three basketball courts, two tennis courts, two racquetball courts, boundless ADA inclusive playground, walking trails and pavilions; and full promenade streetscape design for surrounding streets for pedestrian friendly corridors and parallel parking.

Craven Thompson provided landscape architecture, surveying, civil engineering, and CEI services for the project.

Client Contact:

Ms. Cathie Shanz
Director Parks & Recreation
City of Hallandale Beach
630 NW 2nd Street
Hallandale Beach, Florida 33009
Phone: (954) 457-1452
Email: cshanz@cohb.org

Construction Cost:

\$29.4 Million (including buildings)

Project Dates: Start: 2015

Complete: 2018

Project Role: Sub-consultant



QUALITY CONTROL AND PROCEDURE CONTROL

Developing a Quality Control Plan Specifically for the Town of Lake Park: As we engage in data analysis and capital improvement tasks for the Town of Lake Park, our team will commence the project by creating a project-specific QA/QC plan. We have previously implemented specific plans for numerous significant projects, and we will prepare supplementary quality control plans with checklists tailored to the unique requirements of the Town of Lake Park. The QA/QC plan will be regularly reviewed throughout the project's duration, and any necessary amendments will be made and re-issued for client review. Our plan will clearly outline the responsibilities for delivery and quality control assigned to all key team members.

The following are common elements of our QA/QC process that we will apply:

- **Initiating Quality:** Quality is initiated through a thorough understanding of the project goals and objectives, emphasizing effective communication with the Town's Project Manager as well as a comprehensive review of project inputs. We will assign experienced and qualified personnel to generate and review the work, ensuring a solid foundation for the project through initial planning and scheduling activities. This includes defining various project tasks and associated quality activities. A project plan and kickoff meeting will be crucial milestones that we will complete at the project's outset.
- **Producing Quality:** The Town of Lake Park requires a project plan for all projects, which delineates key parameters and guides the team's work. This plan will be concise and undergo quality control checks by our team before being submitted to the Town.
- **Confirming Quality:** While it is essential to incorporate quality into the work during its execution, formal checks and reviews are critical activities for quality management.
- **Delivering Quality:** Prior to submission, all deliverables will undergo a final verification check. A lead verifier will evaluate the completeness, consistency, adherence to quality requirements, and resolution of comments within the deliverable. As a check-and-balance measure, quality reviews will be conducted at the end of each phase, ensuring consistent delivery of high-quality results to the Town of Lake Park.
- **Improving Quality:** Continuous improvement is a fundamental component of our quality program. We actively learn from our experiences and apply those lessons to future projects through a formal, step-by-step process.

We firmly believe that value management is directly linked to quality management, and both are crucial for excellence in project delivery. Therefore, quality assurance and quality control are our top priorities. Every aspect of the project will be thoroughly assessed by our team of specialists within the organization to uphold the exceptional level of service we are renowned for.

In particular, our quality management system comprises numerous procedures and policies, including but not limited to:

- Assigning experienced and qualified staff to execute and review work, including documentation.
- It is identifying a specific lead in each key area of work to provide technical guidance, leadership, policies, and support for maintaining the quality of service delivered.
- We are conducting independent checks and reviews during the project, including an internal peer review process, to verify output and ensure adherence to quality procedures and practices.
- We are providing professional services in accordance with recognized codes, procedures, manuals, and generally accepted practices.
- Measuring client satisfaction through a dedicated client evaluation performance program.
- By implementing these robust quality control measures, we are committed to delivering outcomes that meet the necessary quality standards and exceed the Town of Lake Park's expectations.



FDOT Prequalification



Florida Department of Transportation

RON DESANTIS
GOVERNOR

JARED W. PERDUE, P.E.
SECRETARY

July 24, 2023

Uyen Dang, Managing Member

DDEC LLC
7220 NW 4th Avenue
Boca Raton, Florida 33487

Dear Ms. Dang:

The Florida Department of Transportation has reviewed your application for prequalification package and determined that the data submitted is adequate to technically prequalify your firm for the following types of work:

Group 3 - Highway Design - Roadway

3.1 - Minor Highway Design

Group 6 - Traffic Engineering and Operations Studies

6.1 - Traffic Engineering Studies

Group 7 - Traffic Operations Design

7.1 - Signing, Pavement Marking and Channelization

7.2 - Lighting

7.3 - Signalization

Group 13 - Planning

13.5 - Subarea/Corridor Planning

Your firm is now technically prequalified with the Department for Professional Services in the above referenced work types. Your firm may pursue projects in the referenced work types with fees estimated at less than \$500,000.00. * This status shall be valid until July 24, 2024, for contracting purposes.

*Limit for FDOT projects only

Should you have any questions, please feel free to contact me by email at carliayn.kell@dot.state.fl.us or by phone at 850-414-4597.

Sincerely,

Carliayn Kell
Professional Services
Qualification Administrator

1

DBE Certification

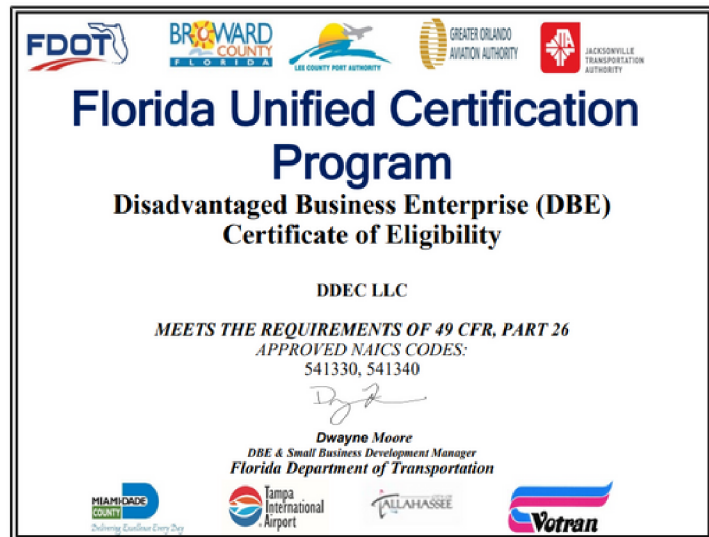

State Business Certification

State of Florida Department of State

I certify from the records of this office that DDEC LLC is a limited liability company organized under the laws of the State of Florida, filed on December 10, 2020, effective December 10, 2020.

The document number of this limited liability company is L20000386727.

I further certify that said limited liability company has paid all fees due this office through December 31, 2023, that its most recent annual report was filed on January 25, 2023, and that its status is active.

Given under my hand and the
Great Seal of the State of Florida
at Tallahassee, the Capital, this
the Twenty-fifth day of January,
2023

Secretary of State

Tracking Number: 0920394701CC

To authenticate this certificate, visit the following site, enter this number, and then follow the instructions displayed.

<https://services.sunbiz.org/Filings/CertificateOfStatus/CertificateAuthentication>

MWBE Certification



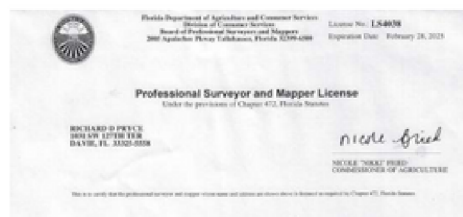
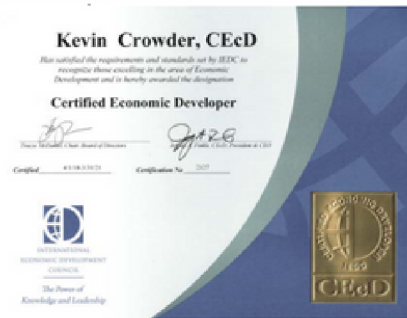
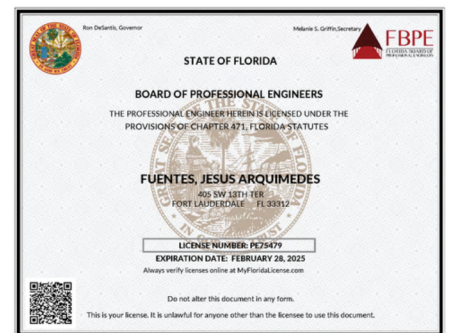
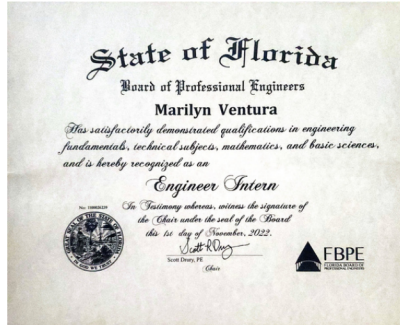
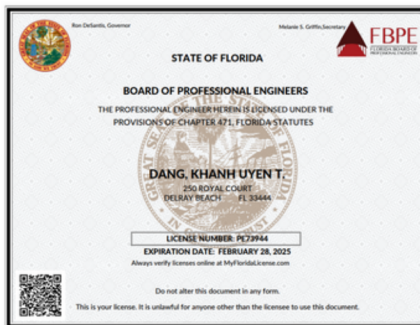

LICENSEE DETAILS

5:11:29 PM 5/4/2023

Name: SANTIAGO, JOSE LUIS (Primary Name)
Main Address: 9936 NW 29TH TERRACE
MIAMI Florida 33172
County: DADE

License Information
License Type: Professional Engineer
Rank: Prof Engineer
License Number: 60248
Status: Current/Active
License Date: 06/23/2003
Expires: 02/28/2025

Special Qualifications
Qualification Effective





3

**Proposals and Experience of
Consultant's Employees
Assigned to the Town**



CORE TEAM COMMUNICATION



Harmon Bennett, P.E.



Patrick J. Gibney, P.E.



Jesus Fuentes, PE



Uyen Dang, PE



Kevin Crowder



Jonathan Paul, AICP



Collaborative Team Communication and Expertise Integration

Within our collaborative team of our firm, and BusinessFlare®, CTA, TSF, NUC, and EXP, we prioritize and support an environment of strong core team communication. This commitment to effective communication allows us to leverage our team members' collective expertise and diverse perspectives to deliver exceptional outcomes for our clients.

As the lead engineering company within the group, DDEC plays a crucial role in facilitating core team communication. We understand the importance of open and transparent channels of communication to ensure that all team members are aligned and working towards a common goal. We encourage active participation and meaningful dialogue among our team members through regular team meetings, brainstorming sessions, and collaborative workshops. BusinessFlare®, with its expertise in community redevelopment planning, actively engages with local stakeholders and prioritizes community involvement. Their inclusive approach and open lines of communication contribute to the core team's ability to address community needs and incorporate diverse perspectives into our projects.

CTA, a distinguished engineering and surveying firm, brings its extensive experience and collaborative mindset to the core team. Their professionals collaborate closely with other team members, sharing their expertise and insights to deliver innovative and tailored solutions. Their commitment to effective communication ensures seamless integration within the core team. TSF, as a materials testing and geotechnical engineering consultant, understands the importance of accurate and timely communication within the core team. Their local presence, strategically located offices, and highly qualified team enable efficient information sharing, contributing to the overall success of our projects. NUC, specializing in innovative land use concepts and mobility plans, emphasizes collaboration with other small businesses and community engagement. Their commitment to personalized services and community involvement enhances core team communication, allowing for the sharing of ideas and the integration of unique perspectives. EXP, a planning, engineering, and public engagement firm with a strong presence across North America brings its vast expertise and skilled team to the core team. Their commitment to collaboration, innovation, and sustainability enhances communication within the team, ensuring the delivery of high-quality solutions tailored to the specific needs of each project.



EMPLOYEES & TITLES

Our organizational chart is detailed in section 1. Due to page restrictions, it's essential to note that our key personnel have been highlighted in the sections above, underscoring their critical roles and expertise in the successful execution of projects for the Town of Lake Park. However, it's important to emphasize that our team consists of dedicated professionals whose contributions extend beyond the core team. In Section 5, you will find comprehensive information about the availability and roles of our additional staff members who are actively involved in the project. This collective effort ensures that the Town of Lake Park receives a comprehensive and multifaceted approach, with all team members working in tandem to bring projects to fruition efficiently and effectively. Our commitment to delivering the highest quality results remains unwavering, with every member of our team playing an integral role in the success of our endeavors.

CEI PROJECT EXAMPLE: EXP - EAST HOLLYWOOD MOBILITY IMPROVEMENTS





Uyen Dang, PE

Project Manager/Transportation Engineer

Years of Experience: 18+



CERTIFICATIONS

Certification

Florida PE LIC. #73944

EDUCATION

Civil Engineering

University of South Florida
Tampa, Florida

EXPERTISE

Transportation  100%

Policies and Compliance  100%

Urban Design  100%

Mobility Planning  100%

Safety  100%

Grant Writing/Management  100%

Technical Qualifications:

- Leadership NACTO 2018
- Founder Mobility Cohort
- NACTO National Standards Working Group
- Palm Beach TPA -Chair of the Palm Beach TPA Citizen Advisory Committee
- Palm Beach TPA - Vice Chair Board Member for Transportation Disadvantage Local Coordination Board
- NCUTCD Council Member - NACTO Delegation
- NCUTCD Markings Committee
- NCUTCD Technical Committee - Pedestrian and Advisory Bike Lane

WORK EXPERIENCE

Uyen Dang is a professional engineer with over 18-year experience in transportation, streetscape, and livable communities. She was the City Traffic Engineer for the City of West Palm Beach and oversaw all transportation elements including transformative projects such as the Clematis Street Streetscape project and the Reimagine of Rosemary Square. She led in the City's adoption of the City's multimodal transportation program including the WPB Bicycle Masterplan, Vision Zero program, smart parking technology and the micromobility program.

In 2017, Uyen helped define the term "Mobility" through a range of transportation planning efforts such as the WPB Mobility Study, Downtown Parking Study, the Okeechobee Corridor Study, and the proposed ITC Mobility Hub. She provided leadership in securing over \$50M federal grants and established a transportation capital improvement program of over \$150M of roadway infrastructure improvements through the City's Public Works Bond and the 1% Sales Tax Referendum. She is part of Leadership NACTO, serves as chair of the Palm Beach TPA Citizen Advisory Committee, board member of the Palm Beach Transportation Disadvantaged LCB, and a delegate of the NCUTCD.

General Qualifications:

- Engineering: 18 Years
- Grant Management: 12 Years
- Project Management: 12 Years
- Program Development and Policies: 10 Years
- Florida PE #73944

Projects Qualifications:

- Pilot Projects Completed: 4
 - Pop-up Bike Lane Pilot Project
 - Intersection Repair Tactical Urbanism
 - COVID19 Open Streets Pilot/Policy
 - Smart Parking Pilot Program
- Grants: 10+ and over \$60M secured
- Overhauled Parking Policy and Increased Parking Rates
- More than 5 Multimodal/Mobility Study
- Constructed more than 10 Miles of Bike Lanes as the Engineer of Record
- Developed concept for Mobility Hubs

Planning and Design

- Broadway Lane Repurposing
- Mercer Avenue Complete Streets
- Parker Avenue Complete Streets
- Lake Avenue Phase 1, 2 and 3
- Pine Terrace Drainage Improvements
- Executive Center Bike Lane
- Forest Hill Traffic Calming
- Winter Haven Intersection Improvements
- Pine Terrace Drainage Improvements

Construction Management

- South Olive Bike Lane
- Cumberland Drive Protected Bike Lane and Roundabout
- Olive Island Safety Improvements
- Clematis Streetscape Improvement
- Tamarind Avenue Phase 1 Streetscape
- Fern Street Bike Lane
- WPB Trolley Shelters
- Pioneer Plaza Roundabout
- Elizabeth Avenue Drainage Improvements

General Engineering Services

- City of Parkland General Engineering Services
- City of West Palm Beach General Engineering Services
- City of Fort Lauderdale General Engineering Services
- City of Hollywood Florida Community Redevelopment Agency Engineering Services - Coastal Marine and Traffic Engineering & Transportation Planning
- Miami Dade County - Strategic Planning and Review Consultant Services for OCITT



Kathleen Walter

Public Affairs and Communications

Years of Experience: 25+

Years with DDEC: 1<



EDUCATION

Master of Arts

Political Science, Florida
Atlantic University (2012)

Bachelor of Arts

English Language &
Literature, Smith
College (1996)

EXPERTISE



SKILLS

- FEMA Advanced PIO
- Lean Six Sigma Yellow Belt
- FAU College of Business Certificate in Digital Marketing
- FAU College of Business Kathleen W. Brush Women in Executive Leadership
- PRSA Accreditation (Anticipated)
- Emmy Award Nomination
- Associated Press Best Newscast Award
- Edward R. Murrow Best Newscast Award
- Gold Coast PR Council Best Campaign
- Alachua County Beach STAR Award
- Languages studied: Spanish, French, German, and Latin
- Over 20 FEMA Emergency Management Institute Certifications
- Safety Council of Palm Beach County Award for Road Safety Communications

WORK EXPERIENCE

With a career spanning over 25 years in the realm of communications, public relations, and marketing, Kathleen Walter stands as a respected professional renowned for her unwavering commitment to advancing the interests of engineering firms and local governments. Her journey in the world of strategic communication is underpinned by an award-winning background as a media correspondent, complemented by her adeptness in both traditional and digital public relations strategies. Kathleen Walter is celebrated for her ability to synthesize complex information into compelling narratives that captivate audiences, solidify reputations, and foster lasting relationships.

West Palm Beach Vision Zero Policy

West Palm Beach, FL

Kathleen led the West Palm Beach Vision Zero communications strategy and project programs, including more than 50 organized events. Kathleen managed media output and other marketing needs for the project. She helped design the project logo and marketing materials. With the adoption of the Vision Zero policy in 2018, the City was able to reduce crashes in target corridors by over 20% in the first year. She provided leadership of many engagement events and supported the development of a strategic speed bump program, sidewalk program, and citywide lighting program. The City was also awarded with enforcement grants to supplement the Police Department in their efforts to reduce traffic crashes.

West Palm Beach Quiet Zones

West Palm Beach, FL

Kathleen led the West Palm Beach Brightline and Quiet Zones communications strategy. The City developed a strategy for supplement safety improvements and the See Tracks? Think Train safety campaign. The program maximizes existing City Resources, including communications, engagement staff, and messaging platforms (i.e. Community Engagement, Neighborhoods First/Neighborhood Services, Volunteer Services, TV, media relations, digital communications, executive communications) with fun and engaging content. The campaign highlights the intensity of the rail environment and how poor and risky choices can lead to fatal consequences. The goal is to elicit behavior changes by influencing users to make more informed safer choices.

Clematis Street Improvements

West Palm Beach, FL

Kathleen led all communications for the Clematis Streetscape project, between Flagler Drive and Sapodilla Avenue. While reducing more than 50% of parking spaces, Kathleen coordinated all public engagement activities, shaped positive and informative messaging, and cultivated media opportunities for this major reconstruction project. She worked with the WPB DDA to develop a program for adjacent business owners that were displaced during construction and provided digital marketing, print marketing and other communications support to the project. The design features a paver-covered, curbside street with narrowed travel lanes, premium paver sidewalks, permeable paver parking spaces, custom-designed seating areas, and a landscape featuring large live oaks to provide shade for pedestrians.



Devin Hampton

GIS Planner

Years of Experience: 4+

Years with DDEC: 2+



EDUCATION

Marketing

Palm Beach State
Boca Raton, FL

Visual Arts

International University
of Arts and Design
Miami, FL

EXPERTISE

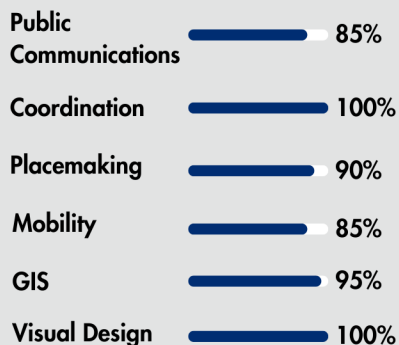

SKILLS

- GIS
- Urban Design
- Mobility Planning
- Communications
- Equity Analysis
- Data Collection

WORK EXPERIENCE

Devin Hampton is a dedicated GIS planner with a strong focus on equity and mobility, and she has an impressive track record of supporting grant projects through extensive research, strategic planning, and community engagement. With a deep understanding of grants and their impact on communities, Devin utilizes her expertise in data analysis and GIS tools to provide valuable insights for grant applications and project implementation. She is adept at conducting thorough research, identifying funding opportunities, and developing comprehensive grant proposals. Additionally, Devin excels in engaging with stakeholders and community members, ensuring their voices are heard and integrated into the planning process. Her collaborative approach, combined with her exceptional communication skills, allows her to build meaningful relationships with project partners and stakeholders.

Town of Lake Park Mobility Study

Lake Park, Florida

Devin created the communications strategy to engage residents through the development of the Mobility Cohort website. As part of this project, she created print media, social media and survey residents through different community engagement meetings. As part of the data collection, she will analyze the survey to be presented to the Town Council.

Tamarac Multimodal Study

Tamarac, Florida

Devin served as the project lead for all communications strategy including the development of a public engagement plan for print media and social media. She developed an interactive map using GIS and oversees the development of movetamarac.com.

rideWPB Transit Plan

West Palm Beach, Florida

Devin provides GIS analysis including an online survey and an interactive map on the existing fixed route system and developed a zone-based strategy for on-demand services. The stopgap plan aims to connect different parts of the transit operation to the surrounding areas of downtown West Palm Beach. This plan was implemented to improve transportation connectivity for commuters and residents alike. Devin's contribution in creating data models for the project helped in identifying potential routes, modes of transportation, and key locations for transit connectivity.



Cape Coral Parking Study

Cape Coral, Florida

During a parking study in the city of Cape Coral, Devin was instrumental in developing, managing, and maintaining GIS databases, mapping tools, and datasets for the project. Her proficiency in conducting spatial analyses and creating GIS maps and visualizations were indispensable to the transportation engineering and planning teams involved in the project. Her work enabled her to offer insights and suggestions to enhance parking accessibility in the city, which has significantly improved the quality of life for both residents and visitors.



MOBILITY COHORT

 Jonathan B. Paul, AICP
Tel: +1 833-NUC-8484
 E-mail: nueurbanconcepts@gmail.com

 747 SW 2nd Ave, Suite 190
Gainesville, Florida
32601

 www.nueurbanconcepts.com

Years of Experience

Public, Private, University	25
NUE Urban Concepts, LLC	12
Impact & Mobility Fee Manager	10
Concurrency & Transportation Planning Manager	10
FDOT Level of Service (LOS) Task Force (Local Government Representative)	10
Interim Transportation Planning Director	3
MPO Experience as Staff & TAC	15
Development Plan & Impact Review	2

Education

MA Public Administration University of South Florida (2002)
MA Urban & Regional Planning University of Florida (2000)
BA History University of South Florida (1997)
BS Social Science Florida State University (1995)

Certifications

American Institute of Certified Planners No. 017909
Certified Public Manager (2010)

FDOT Prequalifications

Group 13 Planning:
Work Type 13.4: Systems Planning
Work Type 13.5: Subarea / Corridor Planning
Work Type 13.6: Land Planning / Engineering

Affiliations

American Planning Association
Congress for New Urbanism
Past Chairman - Celebration Pointe CDD
No. 1 Institute of Transportation Engineers

Jonathan B. Paul, AICP

Mobility Plan and Fees

Profile

Jonathan has 25 years of experience in land use and transportation planning, including parking management and traffic impact analysis. He founded NUE Urban Concepts to work with local governments on innovative land use and mobility strategies, such as complete and shared street design and mobility fees. Previously, he worked as a Principal Planner for Hillsborough County and as the Concurrency & Impact Fee Manager for Alachua County, where he led significant updates to their Comprehensive Plan and Mobility Plan, including the adoption of Mobility Fees in Florida. Jonathan also served as Interim Transportation Planning Director for Sarasota County and has been an adjunct professor at the University of Florida. He has extensive involvement in various land use and transportation technical review committees. Jonathan has a passion for advancing sustainable and accessible transportation options to create more vibrant communities.

Publications

"Mobility Fees" Chapter

Proportionate Share Impact Fees and Development Mitigation APA (2023)

"Personal e-Mobility: Redefining Personal Transport in the 21st Century"

APA Planning Journal (2018)

"Woonerfs: Living Streets for All Users"

APA Planning Journal (2016)

"Mobility: Alachua County's Plan to Effectively Link Land Use & Transportation"
Florida Planning (2010)

Relevant Project Experience

Palm Coast, FL: Update of Transportation Impact Fee (2023 to Present)

Updating the City's transportation impact fee. Conducted the transportation impact fee in 2018.

Alachua County, FL: Update of Impact Fees, Mobility Plan, Mobility Fee (2022 to Present)

Updating the County's park and recreation and fire rescue impact fees, mobility plan, and mobility fee.

City of Palm Beach Gardens, FL: Update of Impact Fees, Mobility Plan, Mobility Fee (2022 to Present)

Updating the City's park and recreation, fire rescue, police, and public buildings impact fees, updating the mobility plan and mobility fee. Provided Continuous Planning Services since 2016 assisting with the Evaluation & Appraisal Report (EAR), Comprehensive Plan Amendments (CPA), original Mobility Plan and Mobility Fee development and implementation, and Land Development Code (LDC) updates for concurrency and traffic impact studies.

City of Oviedo, FL: Update of Impact Fees, Mobility Plan & Mobility Fee (2021 to Present)

Updating the City's park and recreation, fire rescue, police, and public buildings impact fees. Developing a mobility plan and fee. Assisted with amendments to the Comprehensive Plan as part of the Evaluation & Appraisal Report (EAR).



Kevin Crowder, CEcD, EDP

FOUNDER



Education

IEDC Economic
Development Certification
Courses

B.A. Spanish and Political
Science, West Texas A&M
University

Defense Language Institute,
Spanish

Primary Leadership
Development Course, US
Army



Licenses and Certifications
IEDC Certified Economic
Developer (CECD)

FAA Certified Remote Pilot



**Years of Professional
Experience**
29

Email

kevin@businessflare.net



linkedin.com/in/kcrowder

Topics: Project Lead / Economics / Tourism / Intergovernmental / CRA / Entertainment /
Housing / Strategy and Feasibility

Kevin Crowder is the founder of BusinessFlare® and is an IEDC Certified Economic Developer and an IEDC Certified Entrepreneurship Development Professional. Mr. Crowder has almost 30 years of experience planning and implementing economic development, including 15 years as the Director of Economic Development and Government Affairs for the City of Miami Beach and the Miami Beach Redevelopment Agency working out of the City Manager's office. Kevin is a veteran of the U.S. Army, where he served in intelligence. He understands the policy and intergovernmental aspects of economic development and has significant experience in economic development research, training, planning, and implementation throughout municipal organizations. Kevin developed his analytical and leadership skills at college at West Texas A&M University and during his service in US Army Intelligence and US Army leadership programs. He credits his Army service for his collaborative but focused team approach and data analysis skills.

Since leaving the City of Miami Beach and establishing the BusinessFlare® brand in January 2013, Mr. Crowder has used the BusinessFlare® approach to help more than 60 communities improve their economic conditions ranging in size from 1,500 to over 150,000, and in 2022 he performed economic and fiscal analysis on projects representing more than \$5 billion in private sector investment. He is also the President of the BusinessFlare® Academy, a 501c3 not-for-profit dedicated to economic development education for local elected officials. He is a prior board member of the Florida Redevelopment Association and the Florida Council for Public-Private Partnerships and is a member of the Urban Land Institute, the International Council of Shopping Centers, the International Economic Development Council, the Florida Brewers Guild, and the American Legion.

Mr. Crowder is also the President of the BusinessFlare® Academy, a nonprofit providing economic development and redevelopment training for local elected officials and micro-enterprise assistance to veterans, and he is the author of Governing for Economic Development, an elected official's guide to economic development.

Recent/ Relevant Experience

- Hollywood CRA Foot Traffic Assessment
- Martin County COVID-19 Economic Development Action Plan & Innovation Hub
- Stuart Market Analysis and Industrial Assessment
- Palm Springs Economic Development Strategic Plan
- Rockledge Economic Development Strategy and Implementation
- Pembroke Park Economic Development Strategic Plan
- Groveland Market Analysis and P3 Development Projects
- Wooster, OH Economic Development Strategic Plan



Jesús Fuentes, PE

CEI and Bike Ped Feasibility

Mr. Fuentes is a detail-oriented, active transportation engineer who has held project management and field positions with more than 18 years of experience in the South Florida region. He has been involved in the administration and completion of several transportation projects as well as in grant funding application efforts for FDOT District 4/6, MDX, and the Fort Lauderdale DDA. He is also a mass transit, complete streets, and a "Vision Zero" advocate working to create more accessible, walkable, and bikeable places. Under his management, he has led the implementation of more than 8 mi of buffered on-street bicycle lanes, 11 mi of shared-use pathways, 17 mi of conventional on-street bicycle lanes, and 5 mi of other bikeways on low-volume streets as part of the Miami-Dade TPO, Palm Beach TPA and Broward MPO regional mobility plans.

Education + Training

- MS, Construction Management, Florida International University, 2012
- MS, Administration, Saint Michael's College Colchester, 2004
- BS, Civil Engineering, UNEFA, Venezuela, 2002

Professional Registrations

Professional Engineer No. 75479 – FL, 2013

Certifications

- CTQP - Asphalt Paving I & II
 - CTQP - QC Manager
- Advanced Maintenance of Traffic
- Nuclear Gauge
 - Stormwater Inspector
 - Radiation Safety Officer
 - Hazmat Certification MSE Wall Installation Inspection Course
 - OSHA 30-hour Training Course
 - Master Class in Bicycle Urbanism
 - Unraveling the Cycling City
 - Designing the Cycling City
 - Bicycle Infrastructure Design Principles
 - Bicycle Facility Design
 - Traffic and Mobility Fundamentals
 - Bikeconomics
 - The 15-minute City - How to Transform Urban Mobility

Project Experience

Miami-Dade TPO, SMART STEP Tri-Rail Pedestrian and Bicycle Infrastructure Needs Evaluation and Recommendations, Miami-Dade County, FL. Senior Project Manager. The Miami-Dade TPO Urban Mobility and Non-Urban Core Task Forces is facilitating interagency coordination, innovation, and accelerated implementation of pedestrian and bicycle improvement projects in Miami-Dade County to increase connectivity and enhance safety. Jesús leads the evaluation and documentation of the pedestrian and bicycle infrastructure needs at the Golden Glades, Opa-Locka, Metrorail Transfer, Hialeah Market, and the Miami International Airport Tri-Rail station areas as part of the SMART Street Transportation Enhancements Program (STEP) countywide.

NW 67 Avenue Freight Intermodal Connector Analysis. Senior Project Manager.

The study for NW 67 Avenue is part of an evaluation of a roadway segment of the National Highway Freight Network. Jesús is leading the effort to develop improvements that address existing and future operational, social, economic, and safety needs of this corridor including the cargo area of the Miami International Airport as well as the adjacent street network that encompasses parts of NW 36 Street, Perimeter Drive, and NW 25 Street. This intermodal connector analysis will also provide freight travel continuity to this critical regional system and a large industrial and trade area.

Miami-Dade Department of Transportation and Public Works, Reconnecting Communities Pilot Discretionary Grant Application, Miami-Dade County, FL. Senior Project Manager.

The USDOT published a Notice of Funding Opportunity (NOFO) in grant funding as part of the Reconnecting Communities Pilot (RCP) program dedicated to reconnecting communities that were previously cut off from economic opportunities by transportation infrastructure. Jesús led the assistance provided to the Miami-Dade County Department of Transportation and Public Works to seek funding for preparing an equitable TOD Master Plan for two SMART Plan - North Transit Corridor stations (Dr. MLK Jr Plaza and Unity). These efforts aimed to perform an Economic and Affordable Housing Market Analysis, develop a Water and Wastewater Capacity Analysis Technical Memo, as well as perform an analysis to prepare a Bicycle and Pedestrian Facilities Plan. Funding was also sought for developing a Community Partnership and Stakeholder Involvement Plan, an Economic Development Targeted Analysis, and an equitable TOD Report and Master Plan while preparing Station Area Urban Design Guidelines.

FDOT District Six, 36 Street Multimodal Corridor Study, Miami-Dade, FL. Senior Project Manager.

SR-948/NW-NE 36 Street is an east-west corridor in Miami-Dade County that goes from SR-826/Palmetto Expressway to I-195/SR-112/Julia Tuttle Causeway and traverses the cities of Miami Springs, Hialeah, and Miami as well as the County of Virginia Gardens. Jesús is assisting FDOT with the development and evaluation of multimodal improvements to address existing and future mobility, operational, social, economic, and safety needs along this corridor.



Tyler Blair, PE, PTP, PTOE

Senior Traffic Engineer

Tyler Blair has extensive experience in active transportation planning, bicycle/pedestrian safety, and traffic assessment. He specializes in developing comprehensive multimodal studies and conceptual design for safety improvement projects, including vehicular mobility, active transportation, and golf cart facilities. Tyler has conducted numerous Roadway Safety Audits (RSA), crash analyses, intersection safety studies, pedestrian and bicyclist safety improvement studies, signal warrant analyses, turn lane analyses, and traffic calming studies. In addition to safety, Tyler is very well versed in short- and long-range travel demand forecasting, traffic operational analysis, traffic modeling and 3D simulation, concurrency management, technical and code compliance review, traffic study review, maintenance of traffic, and identification of opportunities for innovative design alternatives.

Project Experience

Professional Registrations

FL PE – 88369

TX PE – 146572

OH PE - 88331

- Professional Traffic Operations Engineer No. 5299
- Professional Transportation Planner Cert No. 685
- Advanced Maintenance of Traffic Cert. No. 69214

Education + Training

- M. Eng. Civil Engineering, University of Florida, Gainesville, FL
- B.S. Civil Engineering, University of Florida, Gainesville, FL

Affiliations + Memberships

- Past President – First Coast Institute of Transportation Engineers
- Professional Liaison – University of Florida ITE
- ITE Traffic Engineering Council
- FDOT Traffic Safety Team
- FDOT Multimodal Task Force
- FDOT Model Task Force
- City of Jacksonville Bicycle & Pedestrian Advisory Committee

NW 154th St. & Miami Lakeway North Safety Study, Town of Miami Lakes, FL

Engineer of Record for a comprehensive safety analysis at the intersection of NW 154th St. and Miami Lakeway North in the Town of Miami Lakes. The project included site investigation, geometric assessment, historical crash data assessment, vehicle volume and operational analysis, and a spot-speed study assessing over 400 vehicles. Recommended multiple short- and long-term safety improvements including striping and signing enhancements, median modifications, and signal retiming.

Protected "Dutch" Intersection Study and Conceptual Design, Port St. Lucie, FL

Prepared feasibility study for the implementation of a Dutch-style protected intersection at Tradition Parkway and SW County Parkway. The study included signage recommendations to command driver attention and enhance pedestrian and cyclist crossing safety. The study included interim and long-term recommendations with conceptual design layouts, providing safe multimodal alternatives for pedestrian safety.

Safe Routes to School – Felmor Road*, Yulee, FL

Engaged the 5 E's, hosted public workshops, conducted parent surveys, and prepared conceptual design and cost estimation to provide a shared-use path for Yulee Elementary School. Students were walking in the ditch or on the road to get to class. Prepared Comprehensive Grant Application for funding of the 1.9-mile project, connecting the existing sidewalk on SR-200 to Pages Dairy Road.

Ridgewood / Fox Ridge Area Study*, North Florida TPO, Jacksonville, FL

Project was developed to assess mobility chokepoints, accessibility constraints, circulation, and opportunities to minimize cut-through traffic. As project engineer, developed travel sheds, delineating vehicular movement and conflict points with residential and commercial-front sidewalk facilities. Additional oversight included estimating annual average daily traffic (AADT) on each of the segments connecting the neighborhoods to SR-21/Blanding Blvd.

Flora Park Boulevard. Traffic Calming Study, Fernandina Beach, FL

Upon resident's request, conducted a traffic study to assess for the need and implementation of traffic calming measures in the Flora Park Community. The traffic study involved data collection, including vehicular speeds and volume. This data was assessed for 85th percentile speed, speed bin, and statistical data to determine speed consistency with the posted speed limit and design of the facility. The analysis resulted in the implementation of speed humps throughout the corridor.

East Nassau Community Planning Area (ENCPA)*, Yulee, FL

Responsible for overseeing 20-year delivery and phasing of \$140M Mobility Network including roadway, sidewalk, and bicycle infrastructure improvements for 24,000 acres in eastern Nassau County. Coordinated with Client, Nassau County, and FDOT to execute well-timed roadway enhancements for future development, while proposing mitigation strategies for existing facilities.

Professional Registrations

- Professional Engineer: FL, NE, & LA

Education + Training

- BSME, Arkansas State University, 2006
- Bosch Rexroth, Industrial and mobile hydraulics design, 2009
- Tunneling Short Course, Colorado School of Mines, Golden, OH, 2010
- OSHA, 10-hour

Publications

- Patent # US 2015/0246681 System, apparatus, and method for the transport and positioning of a display

Movable Bridge Inspection - Routine

- Longboat Key Bascule, FDOT, Longboat Key, FL (2019)
- Arcelor Mittal Scherzer Rolling Lift, Cleveland, OH (2018)
- Independence Rolling Lift, MIDOT, Bay City, MI (2017)
- I-110 over Biloxi Bay Rolling Lift, Biloxi, MS (2016 & 2018)

Movable Bridge Inspection - Special

- Baseline Swing Bridge, Wallaceburg, ON (2020)
*remote
- Stickney Point Hopkins Bascule, FDOT Sarasota, FL (2019)
- Siesta Key Hopkins Bascule, FDOT, Siesta Key, FL (2019)
- LaBelle Hopkins Bascule, FDOT, LaBelle, FL (2019)
- Cortez Hopkins Bascule, FDOT, Cortez, FL (2019)

Joshua C. Jackson, PE

Senior Mechanical Engineer

Joshua has 15 years of professional experience and over 25 years of total work experience in several diverse areas including design and inspection of mechanical systems for movable bridges, heavy movable structures, specialized material handling and hoisting equipment, small to moderate-sized civil structures, and other general transportation facilities. He is responsible for complex fluid power systems, electro-hydraulic and electro-mechanical power transmission drive systems, controls, mechanical ventilation, and other typical mechanical systems associated with his licensure as a Mechanical Engineer. He has extensive previous experience in the mining and tunneling industry as well as general construction. Specialties include Complex hydraulic circuit design, large gear trains, and speed reducers, tunnel boring machine design, hydraulic troubleshooting, hydraulic controls, overland and vertical conveyors, and design of mine and tunnel ventilation systems.

Project Experience

Movable Bridge Racine Street Rolling Lift Bridge, Menasha, WI, USA

Responsible for the design of the complete electro-mechanical span drive system for a new double-leaf rolling lift bridge. The machinery room came with tight constraints for machinery fit so special personnel access was designed by the inclusion of access stairs designed into the bearing weldments allowing access over the pinion shafts. Only a single rotation of the pinion achieved span motion which will reduce contact tooth wear and extend the life of the rack and pinion. Produced drawings, the Technical Special Provisions (TSP), and cost estimates.

Longboat Key Bascule, FDOT, Longboat Key, FL, USA

The mechanical Engineer of Record is responsible for the design of a temporary hydraulic span drive system for use while the electro-mechanical span drive was rehabilitated. Components of the temporary system included temporary hydraulic cylinders that operated the bridge while the primary system was disconnected. Design of AASHTO-compliant Hydraulic Power Unit, cylinders, the control system, and integration into the existing control system. Also designed modifications to replace portions of the span locks. Produced stamped drawings, specifications, and cost estimates.

Hatchett Creek Bascule, FDOT, Venice, FL, USA

Mechanical Engineer of Record responsible for the design of a mechanical rehabilitation of the hydraulic span drive components which included refurbishment of the existing hydraulic power units, control valves, filtration systems, replacement, and adjustment of live load shoes, adjustments to balance condition, and complete replacement of the span locks.

Universal Studios Bascule Bridge, Beijing, China

Responsible for the design of mechanical components for a new bascule bridge being constructed as part of a design-build contract in Beijing, China. Due to high seismic activity in the region and evacuation routes across the bridge, the span drive system engagement was elevator chain driven. The design included the primary span drive system, span drive support and engagement structure, and span lock machinery design as well as the writing of the Technical Specifications, engineer's cost estimate, and construction schedule. 90% of design deliverables were provided to the local China regional office for translation and design-build contract execution.

**PATRICK J. GIBNEY, P.E.**

Senior Engineer

Mr. Gibney has over thirty-six years of experience providing project management, design, and construction management (CEI) services for public civil engineering projects. These projects include infrastructure improvements for a multitude of infrastructure rehabilitation projects. This includes design and CEI services for roadway and complete streets projects, pavement design, stormwater management systems, drainage systems, preparation of contract documents and specifications & construction inspections.

**Firm:**

**Craven Thompson & Associates,
Inc.**

3563 NW 53rd Street
Fort Lauderdale,
Florida 33309

Education

Rutgers, The
State University,
Bachelor of Science
in Civil Engineering (1987)

Years of Experience

Total: 36; With Firm: 30

Licenses/Certifications

State of Florida
Professional Civil Engineer
Florida No. 49428 (1995)
FDOT Pre-Qualified
Roadway Construction
Engineering Inspection

Relevant Experience:**NE 34th Court Complete Streets Project** | Oakland Park, Florida | Project

The project involved streetscape and engineering services, including surveying, design, and permitting for full roadway reconstruction. It also covered stormwater management design, utility coordination and relocation, landscape enhancement, and jurisdictional permitting. This LAP project required permits from Broward County EPD, Broward County Health Department, and Oakland Park Public Works & Engineering and Community Development Depts.

NE 38th Street Complete Streets Project | Oakland Park, Florida | Project Manager

Consulting services included surveying and designing a storm sewer system, a roundabout to replace a traffic signal, traffic calming devices, utility coordination, and reconstruction. The goal was to redirect traffic. Permits were required from Broward County EPD and the City of Oakland Park Public Works, Engineering, and FDOT funding was used.

SW 41st Place, Eastside Infrastructure Improvements, Phase I | Davie, Florida | Project

Manager - Preparation, permitting, bidding, and CEI of Phase I of Eastside Infrastructure Improvements, including storm drainage, roadway, water, and sanitary sewer improvements.

Sidewalk, Swale, Drainage & Roadway Improvements CDBG Improvements | Hallandale

Beach, Florida | The project included ADA connections, details, and cross-sections for the Project Area. The sidewalk was installed to complete the existing neighborhood sidewalk network. Swales were constructed adjacent to the new sidewalks and an exfiltration trench was installed to eliminate nuisance flooding and upgraded ADA pedestrian ramps, driveways, sidewalks, and re-graded swales and coordinated with drainage agencies.

NW 10th Avenue Roadway Improvement Project | Oakland Park, Florida | Project

Manager - The project scope included designing a 2,900 linear feet roadway funded by LAP. It involved landscaping, drainage, and street lighting improvements, adding bike lanes, curbing, a 6-foot-wide sidewalk on the west side, and a swale. The project spanned Park Lane West (NW 33rd Street) to Prospect Road.



DOUGLAS R. TAYLOR, P.E.

Senior Engineer

Mr. Taylor's responsibilities include site planning, landscape and hardscape, design, tree removal, and relocation plan in AutoCAD and presentation graphics, utilizing knowledge of local and state regulations involved in land development on a range of projects. Coordinating with Clients, City officials, and other consultants to obtain project input and approvals. Has direct client contact. Preparation of color renderings of landscape plans for presentation.



Firm:

Craven Thompson & Associates, Inc.
3563 NW 53rd Street
Fort Lauderdale, Florida 33309

Education

University of Illinois,
Bachelor of Science in
Civil Engineering (1984)

Years of Experience

Total: 39; With Firm: 12

Licenses/Certifications

State of Florida
Professional Civil Engineer
Florida No. 50569 (1996)
TS EM5 Intermediate
ICS (G300) Certification

Relevant Experience:

Swain Boulevard Complete Streets Project | Greenacres, Florida | Senior Engineer

Mr. Taylor is assisting with designing and permitting the Swain Boulevard Complete Streets Project, a 4,500 linear foot project running from Lake Worth Road to 10th Avenue North. The project includes bicycle lanes on both sides of the street, sidewalks, parallel parking, landscape, hardscape, and drainage. It also includes traffic circles at 1st Street and 4th Street.

2nd Street Traffic Circle and Sidewalk Improvements | Greenacres, Florida | Senior Engineer

Craven Thompson Designed and permitted a traffic circle at 2nd Street and Swain Boulevard in Greenacres City, featuring landscape, hardscape, and a clock feature. The project scope included curb & gutter, sidewalk, drainage, utility adjustments, and relocations. Additionally, 18,300 feet (3.14 miles) of proposed sidewalk and ADA improvements were incorporated, along with drainage design to address conflicts with the sidewalk.

Kimberly Boulevard Complete Streets Project | North Lauderdale, Florida | Project Manager

Project Manager for the design and permitting of 1.2 miles of roadway, bicycle lane, median enhancements, a roundabout, landscaping, hardscape, and lane reduction for an existing four-lane roadway subject to speeding and traffic accidents between autos, pedestrians, and bicyclists. Craven Thompson is providing survey, civil engineering, landscape architecture, and construction administration and inspection.

NE 14th Avenue Streetscape Project | Hallandale Beach Florida | Senior Engineer

The project area is along NE 14th Avenue The project spans 3,400 linear feet with roadway milling, bike lanes, and landscaping on NE 14th Avenue. Canopy trees, ground cover, and irrigation included.

Miramar Historical Area Complete Streets Project. Phase II | Miramar, Florida

Senior Engineer - Craven Thompson I was elected for Phase II of the Historical Area Complete Streets Project, covering six streets with improvements including sidewalks, ADA ramps, crosswalks, lighting, landscaping, and hardscape. ADA ramps, crosswalks, pedestrian-level lighting, landscaping, and hardscape.



SCOTT W. PEAVLER, P.L.A. LANDSCAPE ARCHITECT

Mr. Peavler's responsibilities include site planning, landscape and hardscape design, tree removal, relocation plan in AutoCAD, and presentation graphics, utilizing knowledge of local and state regulations involved in land development on a range of projects. Coordinating with Clients, City officials, and other consultants to obtain project input and approvals. Has direct client contact. Preparation of color renderings of landscape plans for presentation.

Relevant Experience:



Firm

**Craven Thompson &
Associates, Inc.**
3563 NW 53rd Street Fort
Lauderdale, Florida 33309

Education

Kansas State University,
Bachelor's of Landscape
Architecture (2005)

Years of Experience

Total: 18; With Firm: 14

Licenses/Certifications

Florida Registered
Landscape Architect:
LA6666976 (2008)

NE 38th Street Complete Streets Project | Oakland Park, Florida Landscape Architect - The consulting services included landscape and streetscape enhancement, a complete storm sewer system, a roundabout to replace an existing traffic signal, traffic calming devices, utility coordination and relocation, and full roadway reconstruction. The main project objective was to discourage truck traffic and redirect cut-through traffic from NE 38th Street to alternate routes between Andrews Avenue and NE 11th Avenue. This project required permit approvals from Broward County Environmental Protection Department (EPD), and the City of Oakland Park Public Works and Engineering and Community Development Departments. This project utilizes FDOT LAP funding for construction.

Miramar Historical Area Complete Streets Project - Phase II

 | Miramar, Florida

Lead Landscape Architect - Craven Thompson & Associates was selected by the City of Miramar to survey, design, permit, and provide construction services for Phase II of their Historical Area Complete Streets Project. The project includes surveying, landscape and engineering design, permitting, and construction services for complete streets bounded by Pembroke Road to the north, County Line Road to the south, SW 62nd Avenue to the west, and State Road 7 to the east. The project includes six (6) streets in the Historical Area. The improvements include sidewalks, ADA ramps, crosswalks, pedestrian-level lighting, landscaping, and hardscape. The City of Miramar received a grant through the Broward Redevelopment Program for the improvements.

NE 5th Avenue Roadway & Streetscape Improvements | Oakland Park, Florida Landscape Architect - This 0.6-mile roadway project consisted of the reconstruction of a two (2) lane roadway, paver intersection, and crosswalks, addition of parallel parking stalls, 3,000 linear feet of water main replacement, 2,500 linear feet of storm drain installation, sidewalks, landscaping and irrigation, lighting and franchise utility service placement underground.

Landscape Peer Plan Review

 | Coconut Creek, Florida

Review Landscape Architect - Mr. Peavler reviews DRC submittals for Coconut Creek, including landscape & hardscape elements. The Swain Blvd. Complete Streets Project in Greenacres, Florida, spans 4,500 linear feet from Lake Worth Road to 10th Avenue North. It features bicycle lanes, sidewalks, parallel parking, landscape, hardscape, drainage, and traffic circles at 1st Street and 4th Street.

PROFESSIONAL RESUME



RICHARD D. PRYCE, P.S.M.
SURVEYOR & MAPPER

Mr. Pryce has over fifty years of experience surveying in South Florida. He has specialized in all aspects of the land surveying & mapping profession and has also specialized in developing GIS/Survey applications using ESRI ArcGIS software since 1990. Mr. Pryce has been fully trained on Leica 3D Laser Scanners and 3D Modeling. He has also been developing ways to analyze Lidar data for City-wide Storm water and Drainage studies.



CRAVEN THOMPSON & ASSOCIATES INC.

Firm:

Craven Thompson &
Associates, Inc.
3563 NW 53rd Street
Fort Lauderdale, Florida 33309

Education

Broward Community College, Associate of
Science in Criminal Justice (1978)

Years of experience

Total: 50; With Firm: 17

Licenses/Certifications

Professional Surveyor
and Mapper: LS4038 (1983)

Publications

Co-author POB Magazine -
"22,000 Acres and Counting"
November 1998
Co-author POB Magazine -
"The CAD Resolution"
September 1999

Affiliations

Past Director - Broward County Chapter of
Florida Surveying &
Mapping Society
State & County Chapters, Florida
Surveying & Mapping Society
American Congress on
Surveying and Mapping
American Society of
Photogrammetry and
Remote Sensing

Relevant Experience:

North Riverside Drive Topographic Survey | Pompano Beach, Florida | Lead Surveyor -
Mr. Pryce performed a topographic survey of the full right-of-way of North Riverside
Drive, between East Atlantic Boulevard and Northeast 14th Street, about 1.3 miles
within the City of Pompano Beach.

NE 34th Court Complete Streets Project Survey | Oakland Park, Florida | Lead Surveyor
- Mr. Pryce managed the topographic surveying to create the design base sheets for the
complete streets project. The project included full roadway reconstruction design, traffic
calming, stormwater, utility relocation, landscape and streetscape enhancement Central
Broward Water Control District (Surveys, Plan & Survey Review, Easements, Record
Searches) - Mr. Pryce oversees the Surveying and Plan review for the District Engineer,
reviewing compliance with FS Chapter 177 and F.A.C. Rule 5J-17, he also creates and
reviews easements for the CBWCD.

Miramar Historical Area Complete Streets Project - Phase II Survey | Miramar, Florida |
Principal Surveyor - Mr. Pryce directed the topographic & right-of-way survey for Phase
II of their Historical Area Complete Streets Project. The project includes surveying,
landscape and engineering design, permitting, and construction services for complete
streets bounded by Pembroke Road to the north, County Line Road to the south, SW
62nd Avenue to the west, and State Road 7 to the east. The project includes six (6)
streets in the Historical Area. The improvements include sidewalks, ADA ramps,
crosswalks, pedestrian-level lighting, landscaping, and hardscape. The City of Miramar
received a grant through the Broward Redevelopment Program for the improvements.

Pine Island Road Drainage As-builts for BCHCED | Broward County, Florida | Lead
Surveyor - Craven Thompson prepared a Record Drawing of Drainage Structures on
Pine Island Road for Broward County Highway Construction & Engineering Division.
We established horizontal control points within the project area. All survey control
horizontal locations were tied into the State Plane, Florida East Zone, NAD 83/90
Coordinate system.

King Fisher Canal Hydrographic Survey | Deerfield Beach, Florida Project Manager for
Hydrographic Survey of the existing canal to determine the amount of silt at the bottom
for dredging and engineering purposes. The survey included GPS network control,
Benchmark establishment, and Hydrographic survey using Hydrolyte Echo sounding
equipment.



Morgan Dickinson, P.E., S.I.

Principal Engineer/ Special Inspector

Professional Registrations

- Professional Engineer: Florida, 37557 (Year Received: 1986)
- Special Threshold Engineer: Florida, 1029 (Year Received: 2001)
- Professional Engineer: Colorado, 20191
- American Society of Civil Engineers
- Florida Engineering Society
- National Society of Professional Engineers
- CTQP Quality Control Manager
- Advanced Maintenance of Traffic (MOT) Education + Training
- MS in Geotechnical Engineering, Northwestern University, 1980
- PhD Candidate in Structural Engineering, Florida International University, studies ongoing

Mr. Morgan Dickinson, P.E., S.I., is a highly experienced Florida registered Professional Engineer and Special Inspector with 44 years of diverse expertise. He has a strong background in construction material testing, engineering management, geotechnical engineering, and threshold building inspection. With a track record of success, he has provided construction engineering services for various projects, including roadways, bridges, retaining walls, high-rise structures, airports, earthen dams, and impoundments. As a Principal Materials Engineer, Mr. Dickinson excels in delivering exceptional QA/QC services for both public and private sector projects. He has successfully managed contractors' QC programs, provided QA and verification services, and conducted threshold inspection services for owners. His responsibilities also involve supervising and overseeing project testing activities, acting as a liaison between contractors and FDOT, and planning and managing field investigations and materials testing. Mr. Dickinson's dedication to meeting project timelines and budgets is evident through his flexibility in scheduling, including night/weekend shifts and 24-hour shifts as required. His commitment to excellence makes him a valuable asset to any project team.

Project Experience

Materials Testing Contract, Florida Department of Transportation District 4 and 6, Davie, Florida, \$1 million (2010 to 2011, 2018 to 2019).

Mr. Dickinson served as Principal Engineer for the Construction Material Laboratory Testing support.

U.S. 1 from SR 80 to Forest Lake Blvd, Florida Department of Transportation District 4, Florida.

Mr. Dickinson served as the Principal Engineer of CEI services for widening, resurfacing, and utility reconstruction.

SR 5 from Palm Beach Lakes to Okeechobee Blvd, Florida Department of Transportation District 4, Florida.

Mr. Dickinson served as the CEI services for Widening, resurfacing, and utility reconstruction.

U.S. 41 Bridge Replacement at Monroe Station, Florida Department of Transportation District 1, Lee County, Florida. Mr. Dickinson served as the Project Engineer on this bridge replacement contract.

U.S. 27 Bridge Replacement at Fisheating Creek, Florida Department of Transportation District 1, Florida.

Mr. Dickinson served as the Senior Project Engineer on this bridge replacement contract.

SR 78 Stroud Creek Bridge Replacement, Florida Department of Transportation District 1, Florida.

Mr. Dickinson served as the Senior Project Engineer on this bridge replacement contract.

SR 686 Ulmerton Road Widening, Florida Department of Transportation District 7, Clearwater, Florida.

Mr. Dickinson served as the Senior Project Manager providing CEI services for road widening and reconstruction.

U.S. 41 from Rattlesnake Hammock to Barefoot Williams, Wilson Miller, Florida. Mr. Dickinson served as the Project Manager providing CEI services as a sub-consultant for the widening of U.S. 41 from four to six lanes, including a bridge replacement.



Harmon Bennett, P.E.

Principal Engineer



Professional Registrations

Professional Engineer:
Florida, 53130 (Year
Received: 1998)
Tin# B53032365
CTQP Manager
CTQP Final Estimates -
Levels 1 & 2

Education+ Training

BSC in Geotechnical
Engineering,
University of Southern
Florida, 1994

Mr. Harmon Bennett is a highly experienced and Florida-registered Professional Engineer with over 30 years of expertise in geotechnical engineering and construction materials testing and inspection services. His impressive track record includes completing more than 100 projects for the FDOT as a Geotechnical Engineer, covering areas such as roadway and bridge foundation investigations, asphalt coring and evaluation programs, and design studies. Additionally, he has successfully managed multiple FDOT Districtwide Materials Testing Contracts and Districtwide CEI Contracts, as well as various Construction Engineering & Inspection (CEI) Projects for state agencies.

Project Experience

CTQP Provider / Coordinator / Instructor

Mr. Harmon Bennett has been a CTQP Provider/Coordinator/Instructor since 2013, delivering over 20 courses on Earthwork, Pile Driving Inspection, and Drilled Shaft Inspection to construction industry inspection staff. He also played a key role in developing the first Pile Inspector Inspection Manual in 1995 while working on several FDOT Pile projects.

Powerline Road at NW 13th Street Lighting Broward County, Florida; FPID No. 441796-1. Mr. Bennett was Principal Engineer for the Geotechnical Engineering Services for Powerline Road at NW 13th Street Lighting in Broward County. The project consisted of two lanes in both north/south directions with left turn lanes for both directions and bike lanes. Improvements for this project also included new light poles. TSFgeo provided a geotechnical engineering report including geotechnical recommendations regarding standard/non-standard review.

SR 817/University Drive at Johnson St, Widen/Resurface Existing Lanes, Broward County, Florida; FPID No. 441774-1.

Mr. Bennett led Geotechnical Engineering for the SR 817/University Drive widening at Johnson St, Broward County. The project included three lanes in each direction with turn lanes, existing sidewalks, and a raised median. New light poles were also installed. TSFgeo provided a geotechnical report for site evaluation and foundation recommendations.

SW 148th Avenue from SW 52nd Dr to SW 48th Ct/Bass Creek Road, Broward County, Florida; FPID No. 439993-1-52-01.

Mr. Bennett was Principal Engineer for the Geotechnical Engineering Services for SW 148th Avenue from SW 52nd Drive to SW 48th Court/ Bass Creek Road located in Broward County, Florida. The project consisted of sidewalk improvements in the subject area. The purpose of the study was to provide geotechnical and existing pavement information to the design team to assist in the design and construction of the roadway improvements. TSFgeo provided a geotechnical engineering report including recommendations regarding permanent cut and fill slopes, excavations, groundwater control, pavement design considerations, on-site suitability, pavement cores and vibration and settlement monitoring, and pre and post-construction survey.

SR A1A from NE 5th Street (MP 10.443) to Bay Drive, Broward County, Florida (TWO #05). Mr. Bennett was Principal Engineer for the Geotechnical Engineering Services for SR A1A from NE 5th Street to Bay Drive. The project was administered under the FDOT District Four Districtwide Geotechnical & Pavement Coring, required maintenance of traffic, and consisted of the milling and resurfacing, lighting, and drainage structure improvements.



4

Effective Communication and Location Considerations for Consultant and Subconsultants



FIRM LOCATIONS & COMMUNICATION

Reliable Location

The DDEC office is located in Palm Beach County, at 250 Royal Court, Delray Beach, which allows us to promptly respond to project needs and provide efficient solutions tailored to the specific requirements of the Town of Lake Park.

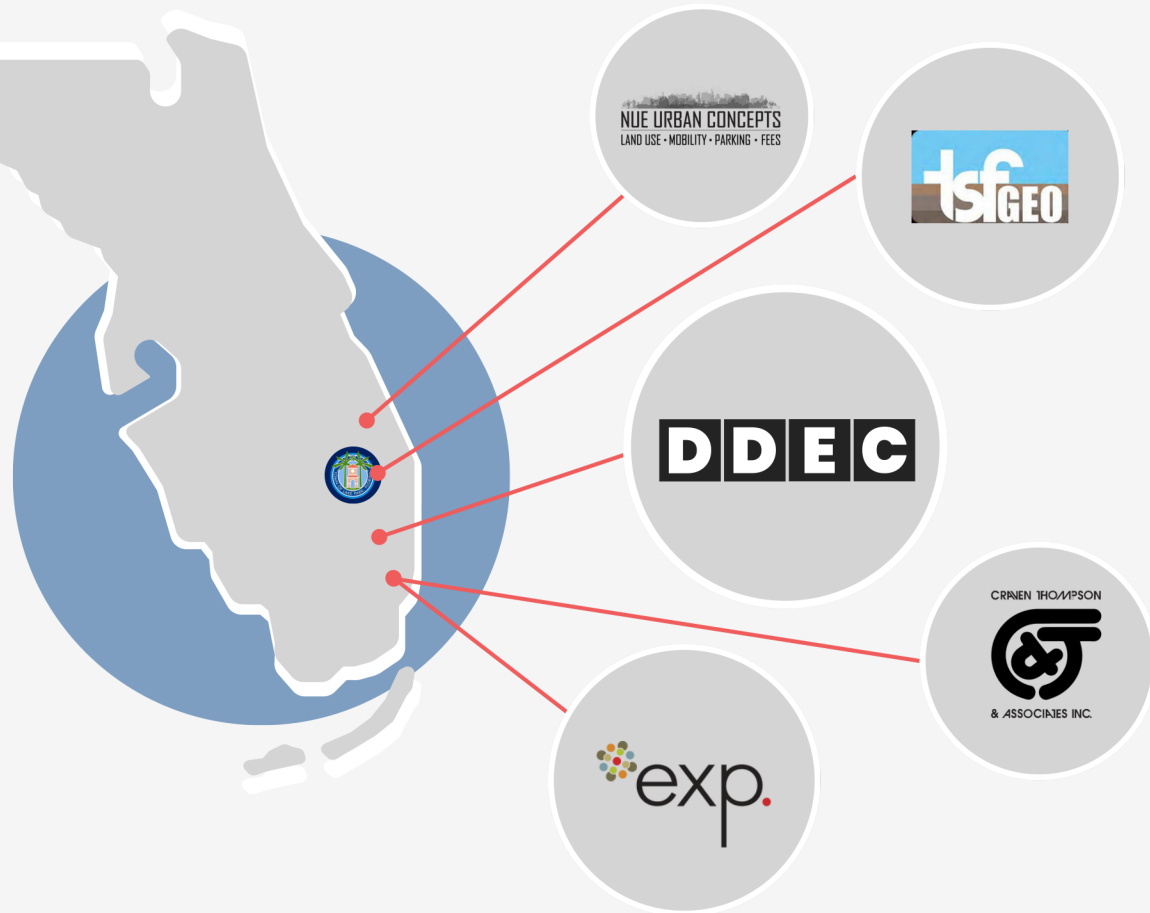

Our Approach to Communication

The project team is committed to maintaining good communication to deliver exceptional services and projects to the Town of Lake Park. This involves clear and effective technical communications, contract administration, management, inspection, and coordination of work. The team uses cloud-based software to facilitate open and collaborative communication among all stakeholders. Weekly meetings and daily debriefs will be held to ensure project milestones are being reached. The communications plan and strategy involve close coordination with Town of Lake Park managers and schedules, as well as the general public as needed. Clear communication with the community and adjacent buildings is also a priority, with updates and information provided regularly. Our team is skilled at facilitating public meetings and workshops, media relations, public relations, digital marketing. Our project manager and key personnel are located in Palm Beach County and the South Florida region.

Project Manager and Key Personnel	Location	Distance from Town of Lake Park (mi)
Allison Justice	Lake Park	0
Uyen Dang, PE	Delray Beach	26.1 mi
Kathleen Walter, APIO	Delray Beach	26.1
Jonathan B. Paul, AICP	Palm Beach Gardens	4.3 mi
Tyler Blair, PE, PTOE	Fort Lauderdale	45.7 mi

An aerial photograph of a city street. In the top left, a blue car is parked next to a person. In the middle left, a red car is driving on a road with yellow lane markings. In the bottom left, a white truck is driving on a road. A person is walking on a sidewalk in the bottom left. The background shows trees and a building.

5

Availability/Scheduling Capacity



AVAILABILITY/SCHEDULING CAPACITY

DDEC and its partners have the available resources to meet project deadlines and budget requirements. Our commitment is to provide exceptional service to the Town of Lake Park.

FIRM	NAME	YEARS OF EXPERIENCE	DISCIPLINE	Availability	Location
DDEC	Uyên Dang, PE	18+	Traffic Engineering, Transportation Engineering, Vision Zero, Urban Design, Microtransit, Curb Management, Mobility Plan, Lane Repurposing, Traffic Calming	70%	Delray Beach
DDEC	Kathleen Walter	25+	Strategic Planner, Communications, Outreach, Engagement, Vision Zero	90%	Delray Beach
DDEC	Marilyn Ventura, EIT	1	Roadway Design, Complete Streets, MOT, Construction Management	75%	Delray Beach
DDEC	Nhat Nguyen, EIT	1	Roadway Design, Complete Streets, MOT	90%	Delray Beach
DDEC	Orlando Toro	15+	Urban Design, Wayfinding, Bicycle/Pedestrian, Complete Streets, Mobility, and UI/UX	90%	Delray Beach
DDEC	Devin Hampton	2+	GIS, StoryMaps, Data Collection, Parking Study, Parking Analysis Equity and Visualization	80%	Delray Beach
DDEC	Jason Kahrim	25+	Digital Engagement, Marketing, Vision Zero, Interactive Maps, UI/UX, Full Stack	90%	Delray Beach
NUE	Jonathan Paul, AICP	25+	Mobility Plan, Mobility Fee, Traffic Calming, Impact Fees, Parking Analysis, Parking Study	70%	Palm Beach Gardens
NUE	Lauren Rushing	3+	Mobility Plan, Mobility Fee, Parking Study, Curb Management	80%	Saint Augustine
BusinessFlare	Kevin Crowder	17+	Economic Development, Market and Development Analysis, Equity, Financial Planning, Redevelopment Programs, and Government Affairs	70%	Delray Beach
BusinessFlare	Allison Justice	15+	CRA-Related Economic Development, Project Management, Equity, and Government Affairs	85%	Delray Beach
EXP	Jesús Fuentes, PE	18+	Bicycle/Pedestrian, Safety, and Traffic Operations	70%	Miami
EXP	Jose Santiago	25+	Drainage Lead, Transportation engineering, Project management, Roadway design	70%	Miami
EXP	Carmen Olazabal, PE	24+	Public Infrastructure, Stormwater Capacity, Quality Assurance, Cohesive and Comprehensive Strategy	70%	Miami
EXP	Nicholas Karpathy, P.E., ENV SP	7+	Project Engineer, Civil Engineer, Construction Administration, Stormwater Drainage Networks	70%	Miami
EXP	Miguel A. Lockward, P.E., PMP, ENV SP	13+	Stormwater Management Design, Water Distribution, Sanitary Sewer Collection Systems	70%	Miami
EXP	Dronix Suarez, EIT	11+	Stormwater Improvements, Construction Management Experience, Municipal Sector	70%	Miami
EXP	Marilou Sarmiento-VanGee	33+	Senior Project Manager, Urban Planning, Architectural Design, Construction Management	70%	Miami
EXP	Gino Valderrama, P.E., J.D	29+	Mechanical Engineer, Engineering, Construction, Civil, Structural,	70%	Miami

FIRM	NAME	YEARS OF EXPERIENCE	DISCIPLINE	Availability	Location
EXP	Sebastian Eilert, AIA	20+	Senior Project Manager, Architect of Record, Professional Registrations, Education + Training, Affiliations + Memberships, Construction industry	70%	Miami
EXP	Chris Campbell	8+	Lead Architectural Designer, Gate Optimization & Infrastructure Upgrades, Commercial Projects	70%	Miami
CTA	Patrick J. Gibney, P.E.	36+	Landscape design, Construction Services, Landscape peer Plan Review, DRC submittal Review, Complete Streets Project	70%	Fort Lauderdale
CTA	Richard D. Pyrce, P.S.M.	50+	Surveyor, Mapper, Specialist, Innovator, Analyst, Leader, Experienced, Skilled Technician, GIS Specialist, Lidar Analyst, Project Manager	70%	Fort Lauderdale
CTA	Douglas R. Taylor, P.E.	39+	Skilled in Site Planning, Landscape and Hardscape design, Relocation plans.	70%	Fort Lauderdale
CTA	Scott W. Pleaver, P.L.A.	18+	Lead Landscape Architect, Surveying, Site planning, Drainage, Construction Services	70%	Fort Lauderdale
tsfGEO	Morgan Dickinson, P.E., S.I. Principal Engineer/ Special Inspector	40+	Special Threshold Engineer, pecial Threshold Engineer, Advanced Maintenance of Traffic (MOT)	70%	Miami
tsfGEO	Harmon Bennett, P.E.	30+	Geotechnical Engineering, Inspection Services, Professional registrations, CTQP manager	70%	Miami

DDEC EXAMPLE: VILLAGE OF PALM SPRINGS CRA WAYFINDING

Comprehensive Wayfinding Signage



02





WORKLOAD OF FIRM

	Project/Contract Name	Client	Status
1	Longwood Mobility Study	City of Longwood, FL	Active
2	West Palm Beach GES	City of West Palm Beach	Active
3	Tamarac Multimodal Master Plan	City of Tamarac, FL	Active
4	City of Saint Augustine Transportation Engineering and Mobility Planning	Saint Augustine, Florida	Active
5	City of Port Saint Lucie Mobility Study	City of Port Saint Lucie	Active
6	NORA TDM Program	NDT Holdings	Completed
7	City of Palm Beach Gardens Mobility Plan Update	Palm Beach Gardens, FL	Active
8	Dixie/Atlantic Lane Repurposing Segment 2	Pompano Beach	Active
9	WPB Grant Administration	City of West Palm Beach	Active
10	Jacksonville Classical Academy Consulting services	Jacksonville Classical Academy	Active
11	Riviera Beach Quiet Zones	City of Riviera Beach	Active
12	Cape Coral CRA Parking Study	City of Cape Coral	Active
13	Indian River County Multimodal Study Update	Indian River County	Active
14	City of Fort Lauderdale Drainage GES	Fort Lauderdale	Active
15	Martin County CRA - Innovation HUB Implementation	Martin County	Active
16	West Palm Beach CRA Strategic Planning	West Palm Beach	Upcoming
17	West Palm Beach Utilities GES	West Palm Beach	Active
18	City of Saint Augustine Mobility and Curb Management Plan	City of Saint Augustine	Active
19	City of Hollywood Florida Community Redevelopment Agency Engineering Services - Coastal Marine and Traffic Engineering & Transportation Planning	Hollywood Beach	Active
20	Miami Dade County - Strategic Planning and Review Consultant Services for OCITT	Miami Dade	Upcoming
21	City of West Palm Beach Grant Services	West Palm Beach, FL	Upcoming
22	Historic Northwest Pleasant City and Coleman Park Strategic Planning	West Palm Beach, FL	Upcoming
23	City of Cape Coral Wayfinding	Cape Coral, FL	Ongoing



6

Knowledge & Understanding of Town of Lake Park



Understanding & Knowledge of the Town

Understanding of the Town's Government Process

Knowledge of the Town's government process is critical to the success of our projects within the Town. Our project manager and many team members have this knowledge through past work with the Town. Our past experience working with Lake Park has helped develop our understanding of the Town's government process. When DDEC and NUC served as the Mobility Plan and Fee consultant adopted last year, we developed an understanding of the Town's strategic goals and how to bring a project before the Town council and secure an approval. Additionally, Business Fare is the past consultant for the Town's CRA plan. Many of our team members are also former municipal government employees with insights into local government. Also, we have conducted a comprehensive review of the Town's municipal charter, which has equipped us with valuable insights into the Town's governance and the mechanisms through which residents engage in vital processes. Understanding the Town's governance is pivotal in ensuring our projects adhere to local regulations and maintain the highest standards of professionalism. This knowledge forms the cornerstone of our commitment to working in alignment with the Town's legal and procedural requirements, fostering a constructive and mutually beneficial relationship with the Town of Lake Park.

Understanding of the Town's Engineering/Technical Capability

Our team has a comprehensive understanding of the town's engineering and technical capabilities. With a broad range of expertise in general civil engineering, place-making, and innovative projects, we are well-positioned to support the town's proposed Comprehensive Plan and Community Improvement Program (CIP) endeavors. Our track record includes the successful execution of diverse civil engineering projects, facilitation of place-making initiatives, and integration of cutting-edge technologies to enhance public engagement. Collaborating with esteemed partners such as BusinessFlare®, CTA, TSF, EXP, and NUE Urban Concepts, our approach focuses on creating vibrant and inviting spaces that align with Lake Park's unique vision. By leveraging our multidisciplinary expertise and dedication to innovation, we are confident in delivering exceptional results that will transform the CIP into thriving and stable communities.

Our Insight into the Town's Development and Capital Program

We have reviewed the Town's Development and Capital Program. We have also gained a comprehensive understanding of development activity and capital program through thorough analysis and collaboration with various departments.

Our engagement with the town's Public Works Department has provided us with insights into planned elements such as wide joint-use paths and on-street parking, indicating a focus on creating pedestrian-friendly and accessible spaces. Additionally, working closely with the Planning Division has allowed us to align our projects with the town's long-term vision, as outlined in the Comprehensive Plan, which addresses crucial aspects such as land use, environmental considerations, housing, transportation, and recreation facilities.

Collaborating with the Community Development Department has given us deep insights into the town's Code of Ordinances, ensuring that our projects align with the guidelines and boundaries set forth by the town. Furthermore, our partnership with the Community Redevelopment Agency has allowed us to contribute to the capital projects listed in the Lake Park Plan, supporting the town's revitalization efforts. By incorporating innovative stormwater management solutions, such as the green infrastructure at Bert Bostrom, we are actively contributing to the town's sustainable development while addressing flooding concerns. Our firm's understanding of Lake Park's development activity and capital program enables us to deliver engineering solutions that align with the town's priorities and enhance the overall quality of life for its residents.

EnerGOV

Drawing upon our extensive experience, we have a proven track record of effectively utilizing advanced systems like Tyler Technologies' EnerGov Enterprise Community Development Software Suite for various municipalities. As in-house consultants, we have harnessed the power of this robust software to streamline operations, enhance data security, and empower citizens within the communities we serve. Our deep understanding of the intricacies of EnerGov allows us to maximize its potential, providing tailored solutions that align with each municipality's unique needs. We recognize that this software offers not only efficiency and flexibility but also the crucial element of ongoing support, ensuring that our clients receive the continued assistance required to adapt and thrive in a dynamic municipal landscape.

Past Work with the Town

For the Town of Lake Park, DDEC and NUC served as the Mobility Plan and Fee consultant for the mobility fee adopted last year. Our partner, BusinessFlare is the past consultant for the Town's CRA Plan Update and have been a partner in the development of the Town's brand and vision.

Town of Lake Park Mobility Plan and Traffic Calming Program



An aerial photograph of a city street. In the top left, a blue car is parked next to a person in a red shirt. In the center, a red car is driving on a road with yellow double lines. In the bottom left, a white truck is driving on a road next to a green lawn. A person is walking on a sidewalk in the bottom right. The image is partially covered by a dark blue overlay on the right side.

7

Appendix



TOWN OF LAKE PARK
535 Park Ave.
Lake Park, Florida 33403

PROJECT:
**CONTINUING SERVICES - ARCHITECTURE, ENGINEERING (VARIOUS TYPES),
LANDSCAPE ARCHITECTURE, SURVEY & MAPPING, PLANNING AND OTHER RELATED
SERVICES.**

ITB #: 113-2023

ADDENDUM #1:

September 11, 2023

Questions and Clarifications

Question 1: Regarding RFP 113-2023, Continuing Services for the Town of Lake Park, are you seeking firms to submit on each individual service? For example, one submission just for Civil Engineering, one just for Architecture, one just for Landscape Architecture, etc.

Or are you asking for each submittal to include a group of firms that collectively offer each of the services listed in the RFP?

Response: Firms responding to RFP 113-2023 may propose, in a single submittal, to provide qualified support to the Town in one (1) or more professional disciplines, using A.) The Proposing Firm's employees, B.) By contracting services with qualified Sub-Contractor, or C.) Through a combination of these two.

Firms are highly encouraged to review the entire RFP document, especially Paragraphs 2 and 3 of Article I, Article IV, Exhibit A and Exhibit I, when preparing a response.

Proposers must acknowledge receipt of this Addendum No. 1 in the space provided below. This addendum forms an integral part of the proposal document and therefore must be executed.

Failure to return this addendum with your proposal submittal will be cause for disqualification.

Issued By: Town of Lake Park, Office of the Town Clerk

Date: September 11, 2023

Laura

Digitally signed by Laura Weidgans
DN: cn=Laura Weidgans, o=Town of
Lake Park, ou=Deputy Town Clerk,
email=lweidgans@lakeparkflorida.g
ov, c=US
Date: 2023.09.11 13:03:34 -0400

Signed By: Weidgans

Laura Weidgans
Deputy Town Clerk

Proposer's Acknowledgement of Receipt of Addendum #1:

Firm's Name: DTG Corp

Authorized Signature: [Signature]

Print Name: Khanh Uyen Dang

Title: Principal

Date: 10/3/2023

End of Addendum No. 1



TOWN OF LAKE PARK
535 Park Ave.
Lake Park, Florida 33403

PROJECT:
**CONTINUING SERVICES - ARCHITECTURE, ENGINEERING (VARIOUS TYPES),
LANDSCAPE ARCHITECTURE, SURVEY & MAPPING, PLANNING AND OTHER RELATED
SERVICES.**

ITB #: 113-2023

ADDENDUM #2:

September 19, 2023

Questions and Clarifications

Question 1: Regarding RFP 113-2023, Could you please provide the List of Projects that this Continuing Services project(s) entails?

Response: As outlined in the RFP Document, the selected firm(s) shall support the TOWN's staff with the implementation of the TOWN's Comprehensive Plan and Capital Improvement Program (CIP) for FY 2024-2027 and beyond.

Specifically, the Town foresees requiring planning, design, and construction support for the following types of projects:

- Stormwater/Drainage
- Townwide Street Lighting Improvements
- Transportation, Mobility and Traffic Calming Improvements
- Community Center
- Aquatic Center
- Park Master Plan Implementation
- Strategic/Master Planning
- Other Projects, at the Town's sole discretion

Proposers must acknowledge receipt of this Addendum No. 2 in the space provided below. This addendum forms an integral part of the proposal document and therefore must be executed.

Failure to return this addendum with your proposal submittal will be cause for disqualification.

Issued By: Town of Lake Park, Office of the Town Clerk

Date: 9/19/2023

Signed By: Laura Weidgans

Digitally signed by Laura Weidgans
DN: cn=Laura Weidgans, ou=Town of
Lake Park, c=US, email=laura.weidgans@lakeparkfl.com
[Date: 2023.09.19 14:55:28 -0400]
Laura Weidgans
Deputy Town Clerk

Proposer's Acknowledgement of Receipt of Addendum #2:

Firm's Name: DDC
Authorized Signature: [Signature]
Print Name: Khanh Uyen Dang
Title: Principal
Date: 10/3/2023

End of Addendum No. 2



TOWN OF LAKE PARK
535 Park Ave.
Lake Park, Florida 33403

PROJECT:
**CONTINUING SERVICES - ARCHITECTURE, ENGINEERING (VARIOUS TYPES),
LANDSCAPE ARCHITECTURE, SURVEY & MAPPING, PLANNING AND OTHER RELATED
SERVICES.**

ITB #: 113-2023

ADDENDUM #3:

September 22, 2023

Questions and Clarifications

Question 1: Do resumes count toward the page limit in RFP 113-2023? On page 5 of the RFP it says the page limit is no more than 35 pages excluding resumes, but page 11 of the evaluation criteria states that resumes will be counted toward the page limit.

Response: Paragraph 2-a on Page 5 of the RFP Document is hereby amended as follows:

Proposals from responding firm (Respondents) shall be no more than thirty-five (35) pages in length, **including** résumés. Any résumé included (team leader, core team member, etc.) shall not exceed one (1) page. The proposal shall also include all information required in Exhibits B, H, and I of this RFP; these pages will not be counted toward the page limit.

Proposers must acknowledge receipt of this Addendum No. 3 in the space provided below. This addendum forms an integral part of the proposal document and therefore must be executed.

Failure to return this addendum with your proposal submittal will be cause for disqualification.

Issued By: Town of Lake Park, Office of the Town Clerk

Date: _____

Signed By: Laura Weidgans

Digitally signed by Laura Weidgans
DN: cn=Laura Weidgans, o=Town of
Lake Park, email=laura@lakeparkfla.gov,
c=US
Date: 2023.09.22 14:54:31 -0400

Laura Weidgans
Deputy Town Clerk

Proposer's Acknowledgement of Receipt of Addendum #3:

Firm's Name: DDFC
Authorized Signature: [Signature]
Print Name: Khanh Uyen Dang
Title: Principal
Date: 10/3/2023

End of Addendum No. 3



TOWN OF LAKE PARK
535 Park Ave.
Lake Park, Florida 33403

PROJECT:
**CONTINUING SERVICES - ARCHITECTURE, ENGINEERING (VARIOUS TYPES),
LANDSCAPE ARCHITECTURE, SURVEY & MAPPING, PLANNING AND OTHER RELATED
SERVICES.**

ITB #: 113-2023

ADDENDUM #4:

September 25, 2023

Questions and Clarifications

Question 1: Please provide us with the Comprehensive Plan and Capital Improvement Program for FY 2024-2027. If this plan is not yet finalized, please provide us with the draft version.

Response: The Town's current Comprehensive Plan is available on the Town's Website. Please visit the following URL to access the **Comprehensive Plan**:
<https://www.lakeparkflorida.gov/government/departments/community-development/permit-other-documents>

Details about principal Capital Improvement Projects currently underway or programmed for implementation during FY 2024-2027 can be accessed via the Town's Website.

Please visit the following URL to access the **Capital Projects**:
<https://www.lakeparkflorida.gov/government/departments/public-works-department/new-projects>

Question 2: May a firm submit qualifications as a prime respondent as well as a subconsultant on another team?

Response: Yes, this is permissible.

Question 3: Request for Proposals Advertisement, Section 2, Response Format and Other General Provisions, indicates that the 1 page resumes are "EXCLUDED" from the 35 page limit, however, Article IV. Evaluation Criteria, indicates that the resumes "WILL BE" counted toward the page limit. Please clarify your intent.

Response: This question was already addressed by the Town in Addendum No. 3, which was published on September 25, 2023. Please reference Addendum No. 3 for additional information.

Proposers must acknowledge receipt of this Addendum No. 4 in the space provided below. This addendum forms an integral part of the proposal document and therefore must be executed.

Failure to return this addendum with your proposal submittal will be cause for disqualification.

Issued By: Town of Lake Park, Office of the Town Clerk

Date: _____

Signed By: Laura Weidgans
Digitally signed by Laura Weidgans
DN: cn=Laura Weidgans, ou=Town of
Lake Park, email=Laura.Weidgans@lakeparkga.gov
c=US
Date: 2023.09.25 15:01:09 -0400
Laura Weidgans
Deputy Town Clerk

Proposer's Acknowledgement of Receipt of Addendum #4:

Firm's Name: DDEG
Authorized Signature: [Signature]
Print Name: Khaph Uyen Dang
Title: Principal
Date: 10/3/2023

End of Addendum No. 4



TOWN OF LAKE PARK
535 Park Ave.
Lake Park, Florida 33403

PROJECT:
**CONTINUING SERVICES - ARCHITECTURE, ENGINEERING (VARIOUS TYPES),
LANDSCAPE ARCHITECTURE, SURVEY & MAPPING, PLANNING AND OTHER RELATED
SERVICES.**

ITB #: 113-2023

ADDENDUM #5:

September 28, 2023

Questions and Clarifications

Question 1: Do tab/section dividers count towards the 35-page limit requirement?

Response: No, neither tab/section dividers, Addendums, or Exhibits required to be submitted with a Response (Exhibit B, Exhibit H, and Exhibit I) count toward the 35-page limit.

Proposers must acknowledge receipt of this Addendum No. 5 in the space provided below. This addendum forms an integral part of the proposal document and therefore must be executed.

Failure to return this addendum with your proposal submittal will be cause for disqualification.

Issued By: Town of Lake Park, Office of the Town Clerk

Date: _____

Signed By: Laura Weidgans
Digitally signed by Laura Weidgans
DN: cn=Laura Weidgans, o=Town of
Lake Park, ou=Deputy Town Clerk,
email=laura.weidgans@lakepark.org,
c=US
Date: 2023.09.28 13:39:53 -0400

Laura Weidgans
Deputy Town Clerk

Proposer's Acknowledgement of Receipt of Addendum #5:

Firm's Name: DEC

Authorized Signature: [Signature]

Print Name: Khambh Vyen Dang

Title: Principal
Date: 10/3/2023

End of Addendum No. 5



TOWN OF LAKE PARK
535 Park Ave.
Lake Park, Florida 33403

PROJECT:
CONTINUING SERVICES - ARCHITECTURE, ENGINEERING (VARIOUS TYPES),
LANDSCAPE ARCHITECTURE, SURVEY & MAPPING, PLANNING AND OTHER RELATED
SERVICES.

ITB #: 113-2023

ADDENDUM #6:

September 29, 2023

Questions and Clarifications

Question 1: Would a Table of Contents within the proposal be included or excluded from the established 35-page count limit?

Response: No, neither tab/section dividers, **Table of Content**, Addendums, or Exhibits required to be submitted with a Response (Exhibit B, Exhibit H, and Exhibit I) count toward the 35-page limit.

Proposers must acknowledge receipt of this Addendum No. 6 in the space provided below. This addendum forms an integral part of the proposal document and therefore must be executed.

Failure to return this addendum with your proposal submittal will be cause for disqualification.

Issued By: Town of Lake Park, Office of the Town Clerk

Date: _____

Signed By: **Laura Weidgans**
Digitally signed by Laura Weidgans
DN: cn=Laura Weidgans, o=Town of
Lake Park, email=laura@lakeparkfla.gov,
c=US
Date: 2023.09.29 15:07:27 -0400
Laura Weidgans
Deputy Town Clerk

Proposer's Acknowledgement of Receipt of Addendum #5:

Firm's Name: DD&C

Authorized Signature:
Print Name:
Title:
Date:

End of Addendum No. 6



TOWN OF LAKE PARK
535 Park Ave.
Lake Park, Florida 33403

PROJECT:
**CONTINUING SERVICES - ARCHITECTURE, ENGINEERING (VARIOUS TYPES),
LANDSCAPE ARCHITECTURE, SURVEY & MAPPING, PLANNING AND OTHER RELATED
SERVICES.**

ITB #: 113-2023

ADDENDUM #7:

October 9, 2023

Questions and Clarifications

Question 1: Are licenses, registrations, and certifications excluded from the 35-page limit?

Response: Licenses, registrations, certifications, and other documents submitted as evidence of a firm's qualifications **ARE INCLUDED** and count towards the RFP response's 35-page limit.

Proposers must acknowledge receipt of this Addendum No. 7 in the space provided below. This addendum forms an integral part of the proposal document and therefore must be executed.

Failure to return this addendum with your proposal submittal will be cause for disqualification.

Issued By: Town of Lake Park, Office of the Town Clerk

Date: _____

Signed By: Laura Weidgans
Digitally signed by Laura Weidgans
DN: cn=Laura Weidgans, o=Town of
Lake Park, ou=Deputy Town Clerk,
email=lweidgans@lakeparkflorida.gov,
c=US
Date: 2023.10.09 13:45:54 -0400
Laura Weidgans
Deputy Town Clerk

Proposer's Acknowledgement of Receipt of Addendum #7:

Firm's Name: DPEC

Authorized Signature: [Signature]

Print Name: Khah Yen Dang
Title: Principal
Date: 10/3/2023

End of Addendum No. 7



TOWN OF LAKE PARK
535 Park Ave.
Lake Park, Florida 33403

PROJECT:
**CONTINUING SERVICES - ARCHITECTURE, ENGINEERING (VARIOUS TYPES),
LANDSCAPE ARCHITECTURE, SURVEY & MAPPING, PLANNING AND OTHER RELATED
SERVICES.**

ITB #: 113-2023

ADDENDUM #8:

October 11, 2023

Questions and Clarifications

Question 1: Can the Town please clarify what documentation/agreements we'll need to provide for subconsultants?

Response: When proposing the use of sub-consultants in your response to the RFP, it will suffice to include details about the scope of services the sub-consultant is qualified, willing and able to provide to the Town on behalf of the Firm; also, include the sub-contractor's location and number of years of experience in each discipline. It's important to note that should your Firm be selected to enter into a continuing service agreement, the Town will at that time request copies of the subcontractor's licenses, certifications, and any and all agreements the Firm has entered into with the subconsultant(s). Such Agreement(s) must remain valid through the initial term of the Agreement the Town and the Firm will enter into.

Question 2: Will it suffice if we provide a scope of work definition for each of the subconsultants within the narrative of the RFP, in lieu of providing agreements?

Response: Please reference response to Question No. 1 in this Addendum.

Question 3: Can the Town please provide its CIP plan through 2027 with budgetary allocations on a year-by-year basis?

Response: Budgets for projects included in the Town's Capital Improvement Program (CIP) are developed, independently for each fiscal during the months of May through August each year and then approved/adopted by the Town Commission in the month of September for the following fiscal year, which runs from October 1 through September 30. For

additional information on recent, ongoing, and programmed CIP's please reference Addendum No. 2 and Addendum No. 4.

Proposers must acknowledge receipt of this Addendum No. 8 in the space provided below. This addendum forms an integral part of the proposal document and therefore must be executed.

Failure to return this addendum with your proposal submittal will be cause for disqualification.

Issued By: Town of Lake Park, Office of the Town Clerk

Date: _____

Signed By: Laura Weidgans
Digitally signed by Laura Weidgans
DN: cn=Laura Weidgans, o=Town of
Lake Park, ou=Engineering, Email=laurea.weidgans@lakeparkga.gov, c=US
Date: 2023.09.11 17:55:38 -0400

Laura Weidgans
Deputy Town Clerk

Proposer's Acknowledgement of Receipt of Addendum #8:

Firm's Name: DDEC, LLC

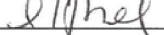
Authorized Signature: 

Print Name: Uyen Dang, PE

Title: Owner/Principal/Project Manager

Date: 10/12/2023

End of Addendum No. 8



TOWN OF LAKE PARK
535 Park Ave.
Lake Park, Florida 33403

PROJECT:
**CONTINUING SERVICES - ARCHITECTURE, ENGINEERING (VARIOUS TYPES),
LANDSCAPE ARCHITECTURE, SURVEY & MAPPING, PLANNING AND OTHER RELATED
SERVICES.**

ITB #: 113-2023

ADDENDUM #9:

October 13, 2023

Questions and Clarifications

Question 1: Please elaborate on what is requested in Tab 6 regarding our familiarity with Tyler Technologies' EnerGov Enterprise Community Development Software Suite.

Response: As outlined in Exhibit A, Section II, Paragraph D of the RFP Document, selected consultants will "Perform electronic planning/ engineering analysis, traffic studies, etc., as required in support of the TOWN's development review and approval process." Additionally, the TOWN recently purchased Tyler Technologies' EnerGov Enterprise Community Development Software Suite (<https://www.tylertech.com/products/enterprise-permitting-licensing>), which will soon replace CAP Government (<https://capfla.com/>) as the Town's software platform for submitting and review of plans and other documents associated with community development.

Furthermore, in Tab 6 of the Response, Consultants will be evaluated on several criteria, including among others, their understanding of the Town's governmental process, understanding of the Town's current development activity and capital program, previous direct work for the Town, and their familiarity and previous experience utilizing Tyler Technologies' EnerGov Enterprise Community Development Software Suite.

Proposers must acknowledge receipt of this Addendum No. 9 in the space provided below. This addendum forms an integral part of the proposal document and therefore must be executed.

Failure to return this addendum with your proposal submittal will be cause for disqualification.

Issued By: Town of Lake Park, Office of the Town Clerk

Date: _____

Signed By: Laura Weidgans
Digitally signed by Laura Weidgans
DN: cn=Laura Weidgans, o=Town of
Lake Park, ou=Deputy Town Clerk,
email=lweidgans@lakeparkga.gov,
c=US
Laura Weidgans
Deputy Town Clerk

Proposer's Acknowledgement of Receipt of Addendum #9:

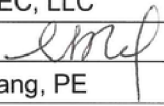
Firm's Name: DDEC, LLC
Authorized Signature: 
Print Name: Uyen Dang, PE
Title: Owner/Principal/Project Manager
Date: 10/13/23

End of Addendum No. 9