

7TH STREET POCKET PARK ALTERNATIVE CONCEPT

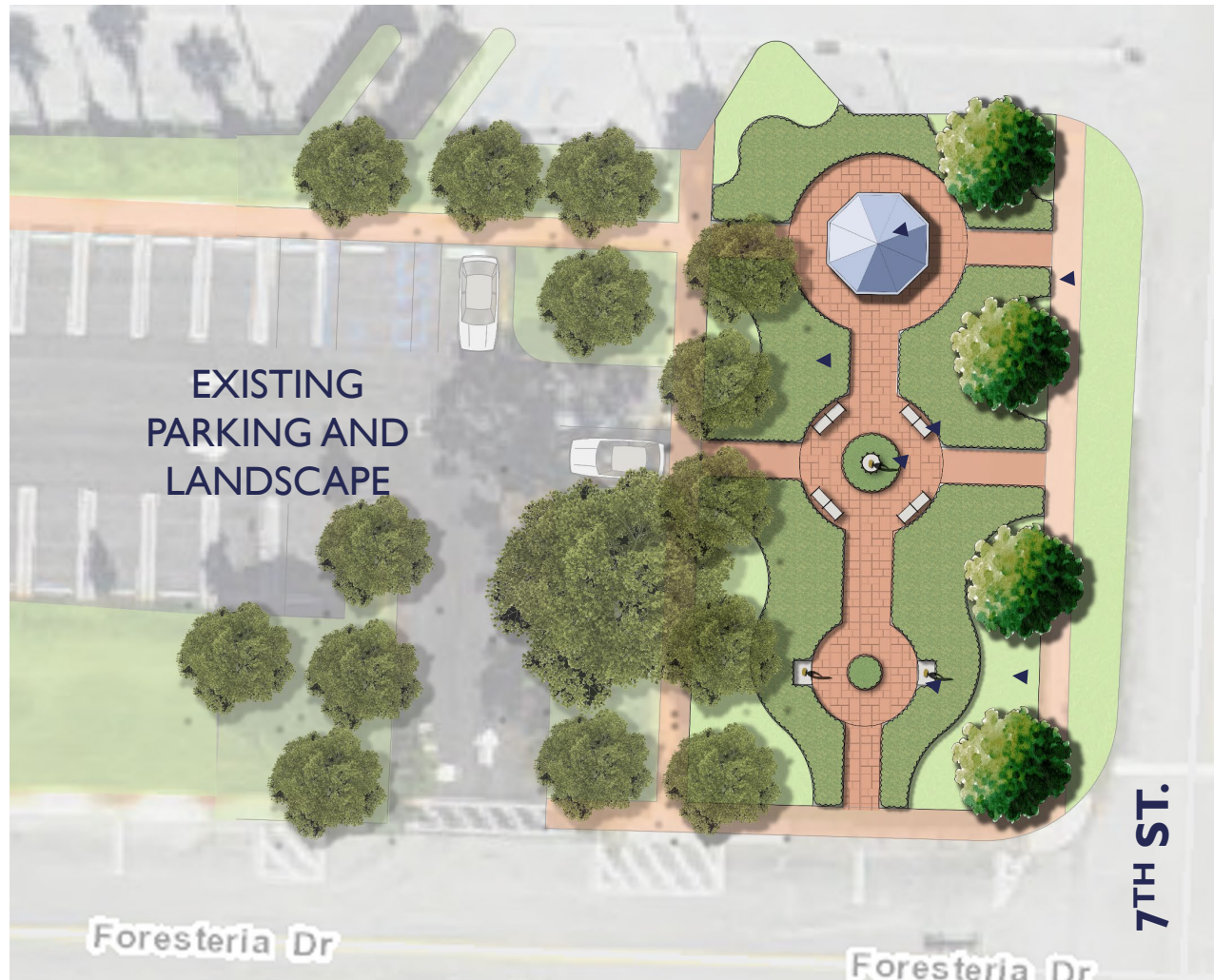

A large, ornate yellow gazebo with a multi-tiered roof and decorative railings, situated on a lawn surrounded by trees and shrubs.

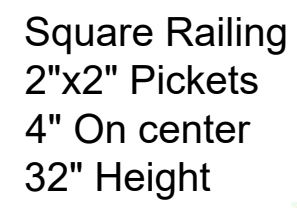
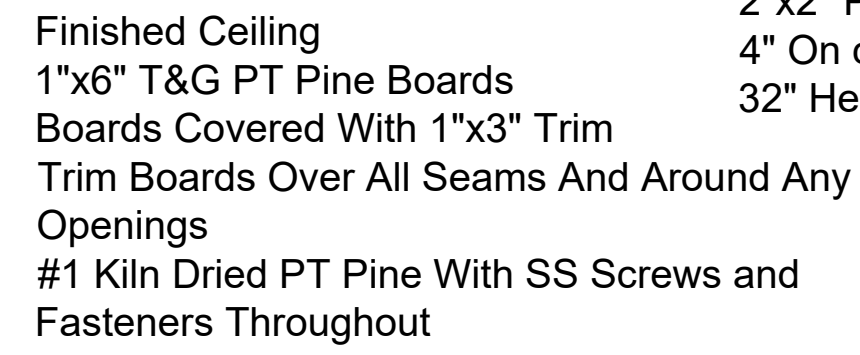
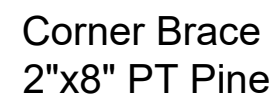
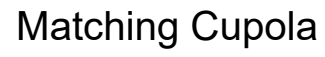

Decorative Posts
6"x6" PT Pine
Decorative Build-Out at
Base and Top

- Concrete Pad under Gazebo
- Contractor to Provide Shop Drawings

A wooden park bench with a metal frame, set against a red wall. The bench has a curved metal frame and wooden slats for the seat and backrest. It is positioned on a paved surface.



- Concrete Pad

	1980	1985	1990	1995	2000	2005	2010	2015	2020
Population	76.5	80.5	84.5	88.5	92.5	96.5	100.0	103.5	107.0
GDP per capita	1,000	1,200	1,400	1,600	1,800	2,000	2,200	2,400	2,600
Life expectancy at birth	65	68	71	74	77	80	83	86	89
Urban population (%)	35	40	45	50	55	60	65	70	75
Employment in agriculture (%)	45	40	35	30	25	20	15	10	5
Government expenditure as % of GDP	15	18	21	24	27	30	33	36	39
Foreign aid as % of GDP	2	3	4	5	6	7	8	9	10
Trade openness (% of GDP)	10	12	14	16	18	20	22	24	26

Diagram illustrating the cross-section of a concrete pad and steel reinforcement. The diagram shows a 6x6 W 1.4 W1.4 Galvanized steel beam supporting a poured concrete pad. The concrete pad is 6 inches thick, has a smooth finish, and a minimum strength of 3,000 PSI at 28 days. The steel beam is labeled "6x6 W 1.4 W1.4 Galvanized". The concrete pad is labeled "Poured Concrete Pad 6\" Thick; Smooth Finish 3,000 PSI Min. at 28 Days". The steel beam is labeled "6x6 W 1.4 W1.4 Galvanized". The diagram also shows "Tool Exposed Edges" and "Turf or Shrubs; See Plan".

Concrete Pad Detail
NTS

Confirm Location of Exist. Trees
Adjust Sidewalk as Needed

P = Planter/Turf Area

SCALE: AS SHOWN

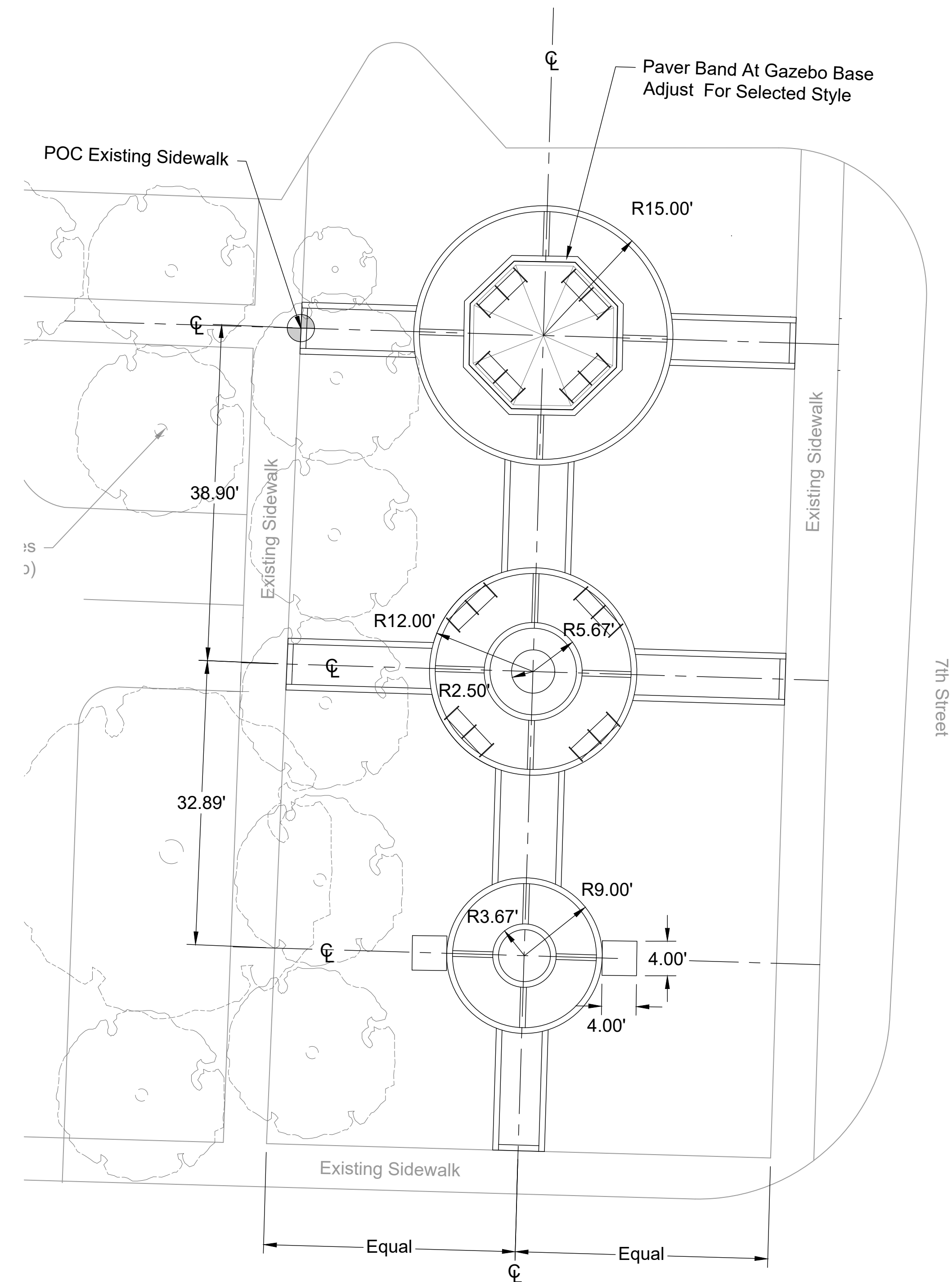

SCALE: AS SHOWN

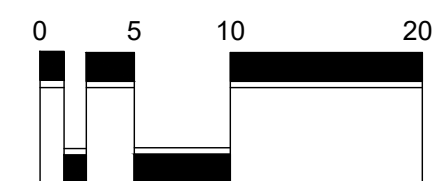
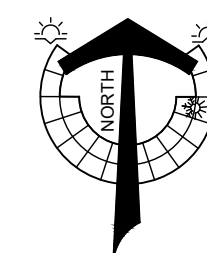

Scale: 1" = 10'

HARDSCAPE PLAN

Lake Park Pocket Park

Prepared for Town of Lake Park

Lake Park, Florida

REAL:

NAME	LA
------	----

REVISIONS

Landscape Plan

SCALE | AS SHOWN

DRAWN | KB/JR

CHECKED BY | HPH

FILE | G210.21 - LPStreetscape - LA

DATE | 2022-07-13

L1.1



Trees

Symbol	Qty	CommonName	LatinName	Size	Additional Spec	Native	Dro. Tol. (LMH)	Space
COLb12	4	Satinleaf	Chrysophyllum oliviforme	B&B; 12"x4"; 21/2" Cal.; 5' C.S.T.		N	H	A.S.
CSEb12	4	Orange Geiger Tree	Cordia sebestena	B&B; 12"x5; 2½ Cal.; 4' C.T.		N	H	A.S.
LJAb08	5	Japanese Privet	Ligustrum japonicum	B&B; 8"x6"; 1½" Cal.; 3' C.M.T.;	3-4 Major Trunks; Matched		H	A.S.
TC-65	1	Silver Trumpet/Yellow Flower	Tabebuia caraiba	65-Gal.; 14"x7; 3" Cal.; 6' C.T.			M	A.S.

Shrubs

Symbol	Qty	CommonName	LatinName	Size	Additional Spec	Native	Dro. Tol. (LMH)	Space
ASM	68	Meyers Foxtail Fern	Asparagus densiflorus 'Meyers'	3-Gal.; 18"x18"; Full			H	18" O.C.
CAU-15	6	Queen Emma Crinum Lily	Crinum augustum 'Queen Emma'	15-Gal.; 36" O.A.; Full			L	A.S.
DE	102	Autumn Fern	Dryopteris erythrosora	3-Gal.; 18"x18"; Full			H	24" O.C.
DT	42	Striped Flax Lily	Dianella tasmanica 'Variegata'	3-Gal.; 18"x18"; Full			H	24" O.C.
DV	85	White African Iris	Dietes vegetata	1-Gal.; 14" O.A.; 3 P.P.P.; Full			M	18" O.C.
FM	102	Green Island Ficus	Ficus microcarpa 'Green Island'	3-Gal.; 12"x12"; 7 PPP; Full			H	24" O.C.
HP	59	Firebush	Hamelia patens	3-Gal.; 24"x18"		N	H	24" O.C.
IVSD	120	Stokes Dwarf Yaupon Holly	Ilex vomitoria 'Stokes Dwarf'	3-Gal.; 14"x14"; Full		N	H	18" O.C.
LMUEG	74	Emerald Goddess Border Grass	Liriope muscari 'Emerald Goddess'	1-Gal.; 9 P.P.P.; Full			H	18" O.C.
NCR-03	36	Giant Apostle Iris	Neomarica caerulea 'Regina'	3-Gal.; 4 P.P.P.; 24" O.A.; Full	Blue Flwr.		M	24" O.C.
PMPD03	47	Pringles Yew Podocarpus	Podocarpus macrophyllus 'Dwarf Pringles'	3-Gal.; 18"x18"			H	24" O.C.
TAM	21	Dwarf Minima Jasmine	Trachelospermum asiaticum 'Minima'	1-Gal.; 18" Spread; Full			M	12" O.C.
TV	107	Society Garlic	Tulbaghia volacea	1 Gal.; Full		N	H	12" O.C.

Turf and Mulch

SSF	2713	Floratam St. Augustine Sod	<i>Stenotaphrum secundatum</i> 'Floratam'	Solid Sod	S.F.
-----	------	----------------------------	---	-----------	------

Plant List Notes

Container sizes, if shown above, are presented as a suggestion only and shall not be relied upon for the purposes of estimating, bidding or purchasing of labor and/or materials. The plant height, spread and caliper are the controlling specifications.

Quantities (Qty), if shown above, are presented as a courtesy and shall not be relied upon for the purposes of estimating, bidding or purchasing of labor and/or materials. Sod & Mulch quantities represent square feet.

Any interested party shall derive actual quantities by performing a thorough and complete review of the Landscape Plan(s) with adequate consideration given to all information in the Plant List above excluding quantities.

In the event of a discrepancy between the plant list and plan count, the plans shall control.

Turf quantity is approximate. Turf required is to be based on field conditions at time of installation

Native = (N); designation from the SFWMD Waterwise Guide, South Florida Edition, and UF Hort. Data Base

Drought tolerance (Dro. Tol.): L= Low, M = Moderate, H = High. Designation from the SFWMD Waterwise Guide, South Florida Edition, and UF Hort. Data Base

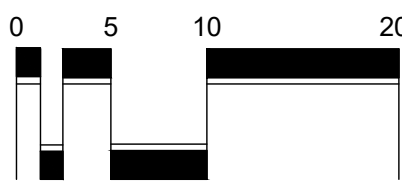

Scale: 1' = 10

LANDSCAPE PLAN

Lake Park Pocket Park

Prepared for Town of Lake Park

Lake Park, Florida

SEAL:

NAM

LA

REVISIONS

[illegible]

Landscape Plan

SCALE | AS SHOWN

DRAWN | KB/JR

CHECKED BY | HPH

FILE | G210.21 - LPStreetscape - LA

DATE | 2022-07-13

