

**GROWTH MANAGEMENT**

205 North Marion Ave.  
Lake City, FL 32055  
Telephone: (386)719-5750  
E-Mail:  
growthmanagement@lcfla.com

**FOR PLANNING USE ONLY**

Application # SP 21-02  
Application Fee \$200.00  
Receipt No. \_\_\_\_\_  
Filing Date 4/3/21  
Completeness Date 5/4/21

# Site Plan Application

**A. PROJECT INFORMATION**

- 1. Project Name: Cooper Garage/Shed
- 2. Address of Subject Property: 1214 SW Castle Heights Terrace Fl
- 3. Parcel ID Number(s): 05-45-17-07649-001
- 4. Future Land Use Map Designation: \_\_\_\_\_
- 5. Zoning Designation: \_\_\_\_\_
- 6. Acreage: 0.517 AC
- 7. Existing Use of Property: none
- 8. Proposed use of Property: Residential backyard /shed
- 9. Type of Development (Check All That Apply):
  - Increase of floor area to an existing structure: Total increase of square footage \_\_\_\_\_
  - New construction: Total square footage \_\_\_\_\_
  - Relocation of an existing structure: Total square footage \_\_\_\_\_

**B. APPLICANT INFORMATION**

- 1. Applicant Status  Owner (title holder)  Agent
- 2. Name of Applicant(s): Nathaniel Sterenton Title: President  
 Company name (if applicable): King Sterenton Inc  
 Mailing Address: 300 colonial St SE  
 City: Live Oak State: FL Zip: 32064  
 Telephone: (561) 654-5300 Fax: ( ) Email: nathansterenton@yahoo.com

**PLEASE NOTE: Florida has a very broad public records law. Most written communications to or from government officials regarding government business is subject to public records requests. Your e-mail address and communications may be subject to public disclosure.**

- 3. If the applicant is agent for the property owner\*.
  - Property Owner Name (title holder): Greg Cooper
  - Mailing Address: 1214 SW Castle Heights Terrace
  - City: Lake City State: FL Zip: 32025
  - Telephone: (904) 568-0501 Fax: ( ) Email: \_\_\_\_\_

- 4. Mortgage or Lender Information:  Yes  No  
 Name of Mortgage or Lender: \_\_\_\_\_  
 Contact Name: \_\_\_\_\_ Telephone Number: \_\_\_\_\_  
 E-Mail Address: \_\_\_\_\_

*If property has a mortgage or lender, the mortgage or lender shall be required to provide a release for this application to proceed.*

**PLEASE NOTE: Florida has a very broad public records law. Most written communications to or from government officials regarding government business is subject to public records requests. Your e-mail address and communications may be subject to public disclosure.**

**\*Must provide an executed Property Owner Affidavit Form authorizing the agent to act on behalf of the property owner.**

**C. ADDITIONAL INFORMATION**

- 1. Is there any additional contract for the sale of, or options to purchase, the subject property?  
If yes, list the names of all parties involved: no  
If yes, is the contract/option contingent or absolute:     Contingent     Absolute
- 2. Has a previous application been made on all or part of the subject property?  Yes     No  
Future Land Use Map Amendment:     Yes \_\_\_\_\_     No \_\_\_\_\_  
Future Land Use Map Amendment Application No. \_\_\_\_\_  
Site Specific Amendment to the Official Zoning Atlas (Rezoning):  Yes \_\_\_\_\_     No \_\_\_\_\_  
Site Specific Amendment to the Official Zoning Atlas (Rezoning) Application No. \_\_\_\_\_  
Variance:  Yes \_\_\_\_\_     No \_\_\_\_\_  
Variance Application No. \_\_\_\_\_  
Special Exception:     Yes \_\_\_\_\_     No \_\_\_\_\_  
Special Exception Application No. \_\_\_\_\_

**D. ATTACHMENT/SUBMITTAL REQUIREMENTS**

- 1. Vicinity Map – Indicating general location of the site, abutting streets, existing utilities, complete legal description of the property in question, and adjacent land use.
- 2. Site Plan – Including, but not limited to the following:
  - a. Name, location, owner, and designer of the proposed development.
  - b. Present zoning for subject site.
  - c. Location of the site in relation to surrounding properties, including the means of ingress and egress to such properties and any screening or buffers on such properties.
  - d. Date, north arrow, and graphic scale not less than one inch equal to 50 feet.
  - e. Area and dimensions of site (Survey).
  - f. Location of all property lines, existing right-of-way approaches, sidewalks, curbs, and gutters.
  - g. Access to utilities and points of utility hook-up.
  - h. Location and dimensions of all existing and proposed parking areas and loading areas.
  - i. Location, size, and design of proposed landscaped areas (including existing trees and required landscaped buffer areas).
  - j. Location and size of any lakes, ponds, canals, or other waters and waterways.
  - k. Structures and major features fully dimensioned including setbacks, distances between structures, floor area, width of driveways, parking spaces, property or lot lines, and percent of property covered by structures.
  - l. Location of trash receptacles.
  - m. For multiple-family, hotel, motel, and mobile home park site plans:
    - i. Tabulation of gross acreage.
    - ii. Tabulation of density.
    - iii. Number of dwelling units proposed.
    - iv. Location and percent of total open space and recreation areas.
    - v. Percent of lot covered by buildings.

- vi. Floor area of dwelling units.
  - vii. Number of proposed parking spaces.
  - viii. Street layout.
  - ix. Layout of mobile home stands (for mobile home parks only).
3. Stormwater Management Plan—Including the following:
  - a. Existing contours at one foot intervals based on U.S. Coast and Geodetic Datum.
  - b. Proposed finished elevation of each building site and first floor level.
  - c. Existing and proposed stormwater management facilities with size and grades.
  - d. Proposed orderly disposal of surface water runoff.
  - e. Centerline elevations along adjacent streets.
  - f. Water management district surface water management permit.
4. Fire Department Access and Water Supply Plan: The Fire Department Access and Water Supply Plan must demonstrate compliance with Chapter 18 of the Florida Fire Prevention Code, be located on a separate signed and sealed plan sheet, and must be prepared by a professional fire engineer licensed in the State of Florida. The Fire Department Access and Water Supply Plan must contain fire flow calculations in accordance with the Guide for Determination of Required Fire Flow, latest edition, as published by the Insurance Service Office (“ISO”) and/or Chapter 18, Section 18.4 of the Florida Fire Prevention Code, whichever is greater.
5. Concurrency Impact Analysis: Concurrency Impact Analysis of impacts to public facilities. For commercial and industrial developments, an analysis of the impacts to Transportation, Potable Water, Sanitary Sewer, and Solid Waste impacts are required.
6. Comprehensive Plan Consistency Analysis: An analysis of the application’s consistency with the Comprehensive Plan (analysis must identify specific Goals, Objectives, and Policies of the Comprehensive Plan and detail how the application complies with said Goals, Objectives, and Policies).
7. Legal Description with Tax Parcel Number (In Word Format).
8. Proof of Ownership (i.e. deed).
9. Agent Authorization Form (signed and notarized).
10. Proof of Payment of Taxes (can be obtained online via the Columbia County Tax Collector’s Office).
11. Fee. The application fee for a Site and Development Plan Application is \$200.00. No application shall be accepted or processed until the required application fee has been paid.

**NOTICE TO APPLICANT**

All eleven (11) attachments listed above are required for a complete application. Once an application is submitted and paid for, a completeness review will be done to ensure all the requirements for a complete application have been met. If there are any deficiencies, the applicant will be notified in writing. If an application is deemed to be incomplete, it may cause a delay in the scheduling of the application before the Planning & Zoning Board.

A total of eight (8) copies of proposed site plan application and all support materials must be submitted along with a PDF copy on a CD. See City of Lake City submittal guidelines for additional submittal requirements.

**THE APPLICANT ACKNOWLEDGES THAT THE APPLICANT OR AGENT MUST BE PRESENT AT THE PUBLIC HEARING BEFORE THE PLANNING AND ZONING BOARD, AS ADOPTED IN THE BOARD RULES AND PROCEDURES. OTHERWISE THE REQUEST MAY BE CONTINUED TO A FUTURE HEARING DATE.**

I hereby certify that all of the above statements and statements contained in any documents or plans submitted herewith are true and accurate to the best of my knowledge and belief.

Nathaniel Steventon

Applicant/Agent Name (Type or Print)

[Signature]

Applicant/Agent Signature

3/25/2021

Date

Applicant/Agent Name (Type or Print)

[Signature]

Applicant/Agent Signature

\_\_\_\_\_

Date

STATE OF FLORIDA  
COUNTY OF Columbia

The foregoing instrument was acknowledged before me this 25 day of March, 2021, by (name of person acknowledging).

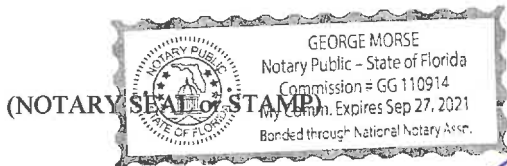

[Signature]

Signature of Notary

George Morse

Printed Name of Notary

Personally Known \_\_\_\_\_ OR Produced Identification [Signature] OR verified on-line virtually FLDL  
Type of Identification Produced



GROWTH MANAGEMENT DEPARTMENT  
 205 North Marion Ave, Lake City, FL 32055  
 Phone: 386-719-5750  
 E-mail: growthmanagement@lcfla.com

AGENT AUTHORIZATION FORM

I, Greg Cooper (owner name), owner of property parcel  
 number 05-45-1707647-001 (parcel number), do certify that

the below referenced person(s) listed on this form is/are contracted/hired by me, the owner, or, is an officer of the corporation; or, partner as defined in Florida Statutes Chapter 468, and the said person(s) is/are authorized to sign, speak and represent me as the owner in all matters relating to this parcel.

Printed Name of Person Authorized	Signature of Authorized Person
1. <u>Nathaniel Steventon</u>	1.
2.	2.
3.	3.
4.	4.
5.	5.

I, the owner, realize that I am responsible for all agreements my duly authorized agent agrees with, and I am fully responsible for compliance with all Florida Statutes, City Codes, and Land Development Regulations pertaining to this parcel.

If at any time the person(s) you have authorized is/are no longer agents, employee(s), or officer(s), you must notify this department in writing of the changes and submit a new letter of authorization form, which will supersede all previous lists. Failure to do so may allow unauthorized persons to use your name and/or license number to obtain permits.

[Signature] Date 3/25/21  
 Owner Signature (Notarized)

NOTARY INFORMATION:  
 STATE OF: Florida COUNTY OF: Columbia

The above person, whose name is Greg Cooper, personally appeared before me and is known by me or has produced identification (type of I.D.) FLDL on this 25 day of March, 2021.

[Signature]  
 NOTARY'S SIGNATURE

(Seal/Stamp)

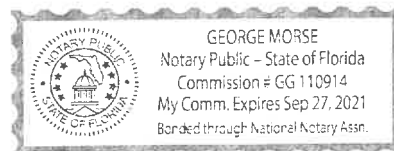

# PLAN OF SURVEY

189°04'32"E  
137.29'

GRANDVIEW AVENUE 50' R/W (PER PLAT)  
**S.W. HAPPINESS LANE**  
ASPHALT PAVEMENT (PUBLIC ROAD)

88'(F)  
59'(D)

N88°53'19"E 108.11'(F)  
N89°02'00"E 108.12'(D)

POINT OF BEGINNING  
PARCEL "B"  
PART 2

POINT OF BEGINNING  
PARCEL "B"  
PART 1

NW CORNER  
LOT 2

6HW

N88°53'19"E 226.52'(F) N

226.5'(P)

SOUTH RIGHT-OF-WAY LINE  
GRANDVIEW AVE. (PER DEED)

LOT-2

PARCEL "A"

50.2'(P)  
MERIDIAN REFERENCE

S00°29'30"E 139.42'(F) 139.68'(F) 50.2'(P)

EAST LINE SW 1/4 NW 1/4 SECTION 5-4-17

PARCEL "B"

1/4" FENCE

1'30"W 133.40'(D)  
1'52"W 132.96'(F)

MASONRY WALL

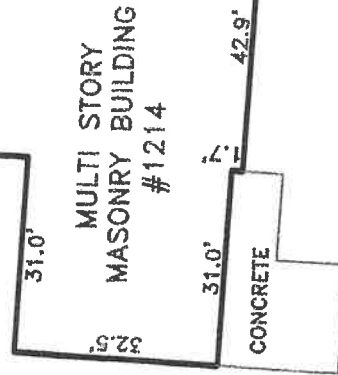

BRICK

MULTI STORY  
MASONRY BUILDING  
#1214

CONCRETE

LOT-3

BLOCK "C"

LOT-4

N88°15'00"W 207.01'(F)  
LESS THE SOUTH 16 FEET

20R7(D)

6HW

F.I.P. 3/4

F.I.P. 3/4

28.0'

S06°57'38"W 151.51'(F)

52.9'

53.4'

50.0'(P)

50.0'(P)

55.1'(P)

50.2'(P)

18.0'

42.9'

220'(P)

214'(P)

1.7'

42.9'

52.2'

10

10

# MAP OF SURVEY

site map

GRANDVIEW AVENUE 50' R/W (PI  
S.W. HAPPINESS I  
ASPHALT PAVEMENT (PUBLIC R

S.W. MAIN BOULEVARD  
2' CONCRETE TYPE "F" CURB  
CONCRETE SIDEWALK

N89°04'32"E 137.29'  
F.C.M.4"X4"  
N88°53'19"E 39.88'(F)  
N89°18'30"E 40.69'(D)  
F.C.M.4"X4"  
F.S.R.D. 1/4  
F.I.P. 1/3

N02°59'22"E 50.24'

NW CORNER LOT 2  
N88°53'19"E 226.5'  
CHW

N88°53'19"E 108.11'(F)  
N89°02'00"E 108.12'(D)

CONCRETE LIGHT POLE

POINT OF BEGINNING PARCEL "B"

CONCRETE LIGHT POLE

POINT OF BEGINNING PARCEL "B" PART 1

SOUTH RIGHT-OF-WAY LINE GRANDVIEW AVE. (PER DEED)

LOT-2

N10°00'08"E 140.82'(F)  
N09°53'30"E 140.82'(D)

N09°39'42"E 141.01'(F)  
N09°53'30"E 140.82'(D)  
EAST R/W LINE U.S. 41 (PER DEED)

55.1'(P) 50.2'(P) MERIDIAN REFERENCE  
S00°29'30"E 139.42'(F) 139.68'(F) 50.2'(P)

EAST LINE SW 1/4 NW 1/4 SECTION 5-4-17

PARCEL "A"

PARCEL "B"

LOT-3

BLOCK "C"

31.0 MAS 31.0' CONCRETE 214'

LOT

6' CHAIN LINK FENCE

S89°30'30"W 133.40'(D)  
S89°22'52"W 132.96'(F)

N88°15'00"W  
LESS THE SOUTH

S89°22'52"W 40.67'(F)  
S89°18'30"W 40.69'(D)

101  
Rear

20'

Parcel:  **05-4S-17-07647-001**   
**(28603)**

Aerial Viewer  Pictometry  Google Maps

Owner & Property Info			
Owner	<b>COOPER GREGORY &amp; SHAWNA L</b> <b>COOPER SHAWNA L</b> 1214 SW CASTLE HEIGHTS TER LAKE CITY, FL 32025		
Site			
Description *	BEG INTERS S R/W LINE OF GRANVIEW AVE & E LINE OF SW1/4 OF NW1/4, RUN S 139.42 FT, W 174.09 FT, N 140.82 FT, E 148.81 FT TO POB. 357-472, 457-634, WD 1019-122, WD 1171- 1534, WD 1350-247,		
Area	0.517 AC	S/T/R	05-4S-17
Use Code **	VACANT (0000)	Tax District	1
*The Description above is not to be used as the Legal Description for this parcel in any legal transaction. **The Use Code is a FL Dept. of Revenue (DOR) code and is not maintained by the Property Appraiser's office. Please contact your city or county Planning & Zoning office for specific zoning information.			



Property & Assessment Values			
2020 Certified Values		2021 Working	
Mkt Land	\$60,858	Mkt Land	
Ag Land	\$0	Ag Land	
Building	\$0	Building	
XFOB	\$0	XFOB	\$0
Just	\$60,858	Just	\$60,858
Class	\$0	Class	\$0
Appraised	\$60,858	Appraised	\$60,858
SOH Cap [?]	\$0	SOH Cap [?]	\$0
Assessed	\$60,858	Assessed	\$60,858



Prepared by and return to:

Rob Stewart  
Lake City Title  
426 SW Commerce Drive, Ste 145  
Lake City, FL 32025  
(386) 758-1880  
File No 2017-2194

Parcel Identification No 00-00-00-14293-000

[Space Above This Line For Recording Data]

## WARRANTY DEED

(STATUTORY FORM - SECTION 689.02, F.S.)

**This indenture made the 19th day of December, 2017 between W. David Crosby, a Single Man, individually and as Trustee of W. David Crosby Revocable Trust dated 4/14/09, whose post office address is 67 Ocean Shore Boulevard, Ormond Beach, FL 32176, of the County of Volusia, State of Florida, Grantors, to Gregory Cooper and Shawna L. Cooper, Husband and Wife, whose post office address is 1214 SW Castle Heights Terrace, Lake City, FL 32025, of the County of Columbia, State of Florida, Grantees:**

**Witnesseth**, that said Grantors, for and in consideration of the sum of TEN DOLLARS (U.S.\$10.00) and other good and valuable considerations to said Grantors in hand paid by said Grantees, the receipt whereof is hereby acknowledged, has granted, bargained, and sold to the said Grantees, and Grantees' heirs and assigns forever, the following described land, situate, lying and being in Columbia, Florida, to-wit:

A parcel of land in the SW 1/4 of NW 1/4, Section 5, Township 4 South, Range 17 East, Columbia County, Florida, more particularly described as follows:

The point of beginning is an iron pipe at the intersection of the South right of way line of Grandview Avenue and the East line of the SW 1/4 of NW 1/4 of said Section 5, this point also being the NW corner of Lot 2, Castle Hill Subdivision, run thence South 0 degree 29'30" East along said East line of the SW 1/4 of NW 1/4 of said Section 5, 139.42 feet, run thence South 89 degrees 30'30" West 133.40 feet to a concrete monument on the East right of way line of US 41 (SR 25), run thence North 09 degrees 53'30" East, 140.82 feet along said right of way line to a concrete monument, run thence North 89 degrees 02'00" East 108.12 feet to the point of beginning.

And

A parcel of land in the SW 1/4 of NW 1/4, Section 5, Township 4 South, Range 17 East, Columbia County, Florida, more particularly described as follows:

Begin at the intersection of the Southerly right of way line of Grandview Avenue with the Easterly right of way line of State Road 25 (US 41) (a 200 foot right of way); thence South 09 degrees 53'30" West along said right of way line of State Road 25, a distance of 140.82 feet, thence South 89 degrees 18'30" West 40.69 feet; thence North 09 degrees 53'30" East 140.82 feet to the South right of way line of Grandview Avenue; thence North 89 degrees 18'30" East along said right of way line 40.69 feet to the point of beginning.



**Columbia County Property Appraiser** Jeff Hampton | Lake City, Florida | 386-758-1083

**PARCEL: 05-4S-17-07647-001 (28603) | VACANT (0000) | 0.517 AC**

BEG INTERS S R/W LINE OF GRANVIEW AVE & E LINE OF SW1/4 OF NW1/4, RUN S 139.42 FT, W 174.09 FT, N 140.82 FT, E 148.81 FT TO POB. 357-472, 457-634, WD

**COOPER GREGORY & SHAWNA L**

Owner: **COOPER SHAWNA L**  
 1214 SW CASTLE HEIGHTS TER  
 LAKE CITY, FL 32025

**2021 Working Values**

Mkt Lnd	\$60,858	Appraised	\$60,858
Ag Lnd	\$0	Assessed	\$60,858
Bldg	\$0	Exempt	\$0
XFOB	\$0	county:	\$60,858
Just	\$60,858	Total	city:\$60,858
		Taxable	other:\$0
			school:\$60,858

Site:

12/19/2017	\$100	I (U)
4/14/2009	\$100	I (U)
6/23/2004	\$500,000	I (Q)

NOTES:

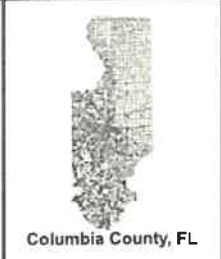

This information, was derived from data which was compiled by the Columbia County Property Appraiser Office solely for the governmental purpose of property assessment. This information should not be relied upon by anyone as a determination of the ownership of property or market value. No warranties, expressed or implied, are provided for the accuracy of the data herein, it's use, or it's interpretation. Although it is periodically updated, this information may not reflect the data currently on file in the Property Appraiser's office. [GrizzlyLogic.com](http://GrizzlyLogic.com)

**ix Record**

Last Update: 4/5/2021 10:34:09 AM EDT

**Register for eBill**

**Ad Valorem Taxes and Non-Ad Valorem Assessments**

The information contained herein does not constitute a title search and should not be relied on as such.

<b>Account Number</b> R07647-001	<b>Tax Type</b> REAL ESTATE	<b>Tax Year</b> 2020
-------------------------------------	--------------------------------	-------------------------

<b>Mailing Address</b> COOPER GREGORY & SHAWNA L 1214 SW CASTLE HEIGHTS TER LAKE CITY FL 32025	<b>Property Address</b>  <b>GEO Number</b> 054S17-07647-001
---	--

<b>Exempt Amount</b> See Below	<b>Taxable Value</b> See Below
-----------------------------------	-----------------------------------

<b>Exemption Detail</b> NO EXEMPTIONS	<b>Millage Code</b> 001	<b>Escrow Code</b>
<b>Legal Description (click for full description)</b> 05-4S-17 0000/0000.52 Acres BEG INTERS S R/W LINE OF GRANVIEW AVE & E LINE OF SW1/4 OF NW1/4, RUN S 139.42 FT, W 174.09 FT, N 140.82 FT, E 148.81 FT TO POB. 357-472, 457-634, WD 1019-122, WD 1171- 1534, WD 1350- 247,		

**Ad Valorem Taxes**

Levying Authority	Rate	Assessed Value	Exemption Amount	Taxable Value	Taxes Levied
TY OF LAKE CITY	4.9000	60,858	0	\$60,858	\$298.20
ARD OF COUNTY COMMISSIONERS	8.0150	60,858	0	\$60,858	\$487.78
LUMBIA COUNTY SCHOOL BOARD					
SCRETIONARY	0.7480	60,858	0	\$60,858	\$45.52
CAL	3.7810	60,858	0	\$60,858	\$230.10
PITAL OUTLAY	1.5000	60,858	0	\$60,858	\$91.29
WANNEE RIVER WATER MGT DIST	0.3696	60,858	0	\$60,858	\$22.49
KE SHORE HOSPITAL AUTHORITY	0.0001	60,858	0	\$60,858	\$0.01

<b>Total Millage</b>	19.3137	<b>Total Taxes</b>	\$1,175.39
----------------------	---------	--------------------	------------

**Non-Ad Valorem Assessments**

Code	Levying Authority	Amount
XLCF	CITY FIRE ASSESSMENT	\$50.40

<b>Total Assessments</b>	\$50.40
--------------------------	---------

Taxes & Assessments \$1,225.79

<b>If Paid By</b>	<b>Amount Due</b>
	<b>\$0.00</b>

Date Paid	Transaction	Receipt	Item	Amount Paid
4/7/2021	PAYMENT	2703141.0002	2020	\$1,201.27

Prior Years Payment History

**Prior Year Taxes Due**

NO DELINQUENT TAXES
---------------------

**Legal Desc.**

Last Update: 4/5/2021 10:35:35 AM

**Ad Valorem Taxes and Non-Ad Valorem Assessments**

The information contained herein does not constitute a title search and should not be relied on as such.

<b>Account Number</b>	<b>Tax Type</b>	<b>Tax Year</b>
R07647-001	REAL ESTATE	2020

**Legal Description (click for full description)**

BEG INTERS S R/W LINE OF GRANVIEW AVE & E LINE OF SW1/4 OF NW1/4, RUN  
S 139.42 FT, W 174.09 FT, N 140.82 FT, E 148.81 FT TO POB. 357-472,  
457-634, WD 1019-122, WD 1171- 1534, WD 1350-247,

# PLAN OF SURVEY

189°04'32"E  
137.29'

F.C.M.424

GRANDVIEW AVENUE 50' R/W (PER PLAT)  
**S.W. HAPPINESS LANE**  
ASPHALT PAVEMENT (PUBLIC ROAD)

88'(F)  
59'(D)

N88°53'19"E 108.11'(F)  
N89°02'00"E 108.12'(D)

POINT OF BEGINNING  
PARCEL "B"  
PART 2

POINT OF BEGINNING  
PARCEL "B"  
PART 1

NW CORNER  
LOT 2

OHW

N88°53'19"E 226.52'(F) 226.5'(P)

SOUTH RIGHT-OF-WAY LINE  
GRANDVIEW AVE. (PER DEED)

LOT-2

PARCEL "A"

MERIDIAN REFERENCE

55.1'(P) S00°29'30"E 139.42'(F) 139.68'(F) 50.2'(P)

EAST LINE SW 1/4 NW 1/4 SECTION 5-4-17

PARCEL "B"

1/4" FENCE  
1'30"W 133.40'(D)  
1'52"W 132.96'(F)

LOT-3

BLOCK "C"

LOT-4

MASONRY WALL

MASONRY WALL

BRICK

MULTI STORY  
MASONRY BUILDING  
#1214

CONCRETE

9.66'

18.0'

31.0'

42.9'

52.2'

220'(P)

52.9'

31.0'

42.9'

214'(P)

53.4'

52.9'

N88°15'00"W 207.01'(F)  
LESS THE SOUTH 16 FEET

28.0'

F.I.P.3/4

F.I.P.3/4

S06°57'38"W 151.51'(F)

# PLAN OF SURVEY

189°04'32"E  
137.29'

F.C.M.4"x4"

GRANDVIEW AVENUE 50' R/W (PER PLAT)  
**S.W. HAPPINESS LANE**  
ASPHALT PAVEMENT (PUBLIC ROAD)

88'(F)  
59'(D)

N88°53'19"E 108.11'(F)  
N89°02'00"E 108.12'(D)

POINT OF BEGINNING  
PART 2

POINT OF BEGINNING  
PART 1  
PARCEL "B"

NW CORNER  
LOT 2

611W

N88°53'19"E 226.52'(F) 226.5'(P)

SOUTH RIGHT-OF-WAY LINE  
GRANDVIEW AVE. (PER DEED)

LOT-2

PARCEL "A"

220'(P)

MULTI STORY  
MASONRY BUILDING  
#1214

BRICK

LOT-3

BLOCK "C"

PARCEL "B"

1/2" FENCE

1'30"W 133.40'(D)  
1'52"W 132.96'(F)

LOT-4

N88°15'00"W 207.01'(F)  
LESS THE SOUTH 16 FEET

611W

611W

MASONRY WALL

9.6'

18.0'

42.9'

42.9'

31.0'

32.5'

31.0'

42.9'

214'(P)

52.9'

53.4'

F.I.P. 3/4

S06°57'38"W 151.51'(F)

F.I.P. 3/4

28.0'

EAST LINE SW 1/4 NW 1/4 SECTION 5-4-17

MERIDIAN REFERENCE

F.I.P. 1/2

55.1'(P) 50.2'(P) S00°29'30"E 139.42'(F) 139.68'(F) 50.2'(P)

Parcel: << **05-4S-17-07647-001** >>  
(28603)

Aerial Viewer Pictometry Google Maps

### Owner & Property Info

**Owner**  
**COOPER GREGORY & SHAWNA L**  
**COOPER SHAWNA L**  
 1214 SW CASTLE HEIGHTS TER  
 LAKE CITY, FL 32025

**Site**

**Description\***  
 BEG INTERS S R/W LINE OF GRANVIEW AVE & E LINE OF SW1/4 OF NW1/4, RUN S 139.42 FT, W 174.09 FT, N 140.82 FT, E 148.81 FT TO POB. 357-472, 457-634, WD 1019-122, WD 1171- 1534, WD 1350-247,

<b>Area</b>	0.517 AC	<b>S/T/R</b>	05-4S-17
<b>Use Code**</b>	VACANT (0000)	<b>Tax District</b>	1

\*The Description above is not to be used as the Legal Description for this parcel in any legal transaction.  
 \*\*The Use Code is a FL Dept. of Revenue (DOR) code and is not maintained by the Property Appraiser's office. Please contact your city or county Planning & Zoning office for specific zoning information.

### Property & Assessment Values

2020 Certified Values		2021 Working	
Mkt Land	\$60,858	Mkt Land	
Ag Land	\$0	Ag Land	
Building	\$0	Building	
XFOB	\$0	XFOB	\$0
Just	\$60,858	Just	\$60,858
Class	\$0	Class	\$0
Appraised	\$60,858	Appraised	\$60,858
SOH Cap [?]	\$0	SOH Cap [?]	\$0
Assessed	\$60,858	Assessed	\$60,858





GROWTH MANAGEMENT DEPARTMENT  
 205 North Marion Ave, Lake City, FL 32055  
 Phone: 386-719-5750  
 E-mail: growthmanagement@lcfla.com

AGENT AUTHORIZATION FORM

I, Greg Cooper (owner name), owner of property parcel number 05-45-1707647-001 (parcel number), do certify that the below referenced person(s) listed on this form is/are contracted/hired by me, the owner, or is an officer of the corporation; or, partner as defined in Florida Statutes Chapter 468, and the said person(s) is/are authorized to sign, speak and represent me as the owner in all matters relating to this parcel.

Printed Name of Person Authorized	Signature of Authorized Person
1. <u>Nathaniel Steventon</u>	1.
2.	2.
3.	3.
4.	4.
5.	5.

I, the owner, realize that I am responsible for all agreements my duly authorized agent agrees with, and I am fully responsible for compliance with all Florida Statutes, City Codes, and Land Development Regulations pertaining to this parcel.

If at any time the person(s) you have authorized is/are no longer agents, employee(s), or officer(s), you must notify this department in writing of the changes and submit a new letter of authorization form, which will supersede all previous lists. Failure to do so may allow unauthorized persons to use your name and/or license number to obtain permits.

[Signature] Date 3/25/21  
 Owner Signature (Notarized)

NOTARY INFORMATION;  
 STATE OF: Florida COUNTY OF: Columbia

The above person, whose name is Greg Cooper, personally appeared before me and is known by me or has produced identification (type of I.D.) FLDL on this 25 day of March, 2021.

[Signature]  
 NOTARY'S SIGNATURE

(Seal/Stamp)

