

Tree #	Species	Comm on Name	DBH Inches	Health CR %	Structure CR %	Form CR %	Condition Rating	Condition	Comments
101	QL - <i>Quercus laurifolia</i>	Laurel Oak	29.5	15%	15%	10%	15%	Very Poor	Signs of internal decay, observations of decayed interior in large segment that were broken off. One large branch broken off was likely effected by storm influence compounded with the interior decay due to the compromised structural integrity of the branch. A separate segment of branch is dead with visible signs of previous trimming. The tree exhibits major canopy dieback and is asymmetric in its current state due to the loss of branching. Some branches have dead foliage at terminal end indicating poor nutrient distribution. The overall condition is very poor.
102	QV - <i>Quercus virginiana</i>	Live Oak	18.5	90%	80%	80%	85%	Good	One observed area of surficial root rot. Observations of a few dead branches in lower canopy which appear to have resulted from poor trimming practices by heading within the mid portion of the branch as opposed to the nearest collar. Inclusive bark with V shaping observed along multiple branching points. Tree exhibits flush leaf proliferation. Overall, a good, healthy tree
105	QV - <i>Quercus virginiana</i>	Live Oak	58.5	80%	75%	80%	80%	Good	Few dead lower canopy branches with broom branching stems observed at the terminal end where a break or previous trimming occurred. Minor tip dieback throughout the majority of all stems. Leaf proliferation abundant throughout. Tree exhibits exemplary branching pattern. Single large lower branch with bark peel back with signs of decay. Overall, a good, healthy tree.

# RaceTrac Lake City Arborist Report

Prepared for:

RaceTrac

Prepared by:

WGL, Inc.



US Highway 17 South Suite 203, Fleming Island, Florida

Report Prepared by: Derek Lee  
International Society of Arboriculture Certified Arborist  
ISA Certification No. FL-338502A

February 2026

### EXISTING TREES

#	TREE	DBH (INCHES)	CONDITION	STATUS	REMOVED (INCHES)
101	LAUREL OAK	30	VERY POOR	REMOVED	29.5
102	LIVE OAK	18	GOOD	REMOVED	18.0
103	CYPRESS	8	GOOD	REMOVED	8.0
104	CYPRESS	6	GOOD	REMOVED	6.0
105	LIVE OAK	59	GOOD	REMOVED	59.0

### LEGEND

- EXISTING TREE TO BE REMOVED
- EXISTING TREE TAG
- TREE PROTECTION FENCING

### LANDSCAPE REQUIREMENTS

A. OFF-STREET PARKING	
<b>REQUIRED</b>	1. 10% of any off-street parking shall be landscape area 8,745 SF x 10% = 875 SF of landscape area required 2. (1) 4' Hgt tree per 200 SF of required landscape area = 4 trees required
<b>PROVIDED</b>	1. Landscape area = 1,100 SF of landscape area provided 2. 4 crepe myrtle = 4 trees provided
B. MITIGATION	
<b>REQUIRED</b>	1. Tree removed shall be mitigated for at a rate of 1:1. 1 Live Oak, 3 Bald Cypress in good conditions removed. = 4 Mitigation Trees 1 Live Oak in poor condition removed.
<b>PROVIDED</b>	1. 4 Bald Cypress planted = 4 Mitigation Trees

### PLANT SCHEDULE

Symbol	Qty	Botanical Name	Common Name	Scheduled Size	Remarks
	4	<i>Lagerstroemia indica</i> 'Natchez'	Natchez Crepe Myrtle	Min 4' Hgt	Multi-trunked
	4	<i>Taxodium distichum</i>	Bald Cypress		
Shrubs					
Groundcovers					
	44,859	<i>Cynodon dactylon</i>	Hybrid Bermuda Grass	SF; Sod	See general landscape notes & accessories specifications.
	19,449	Bahia Sod	Bahia Sod	SF; Sod	See general landscape notes & accessories specifications.
Other					
	2,221	Rock Mulch	Rock Mulch	SF.	See general landscape notes & mulch Specifications

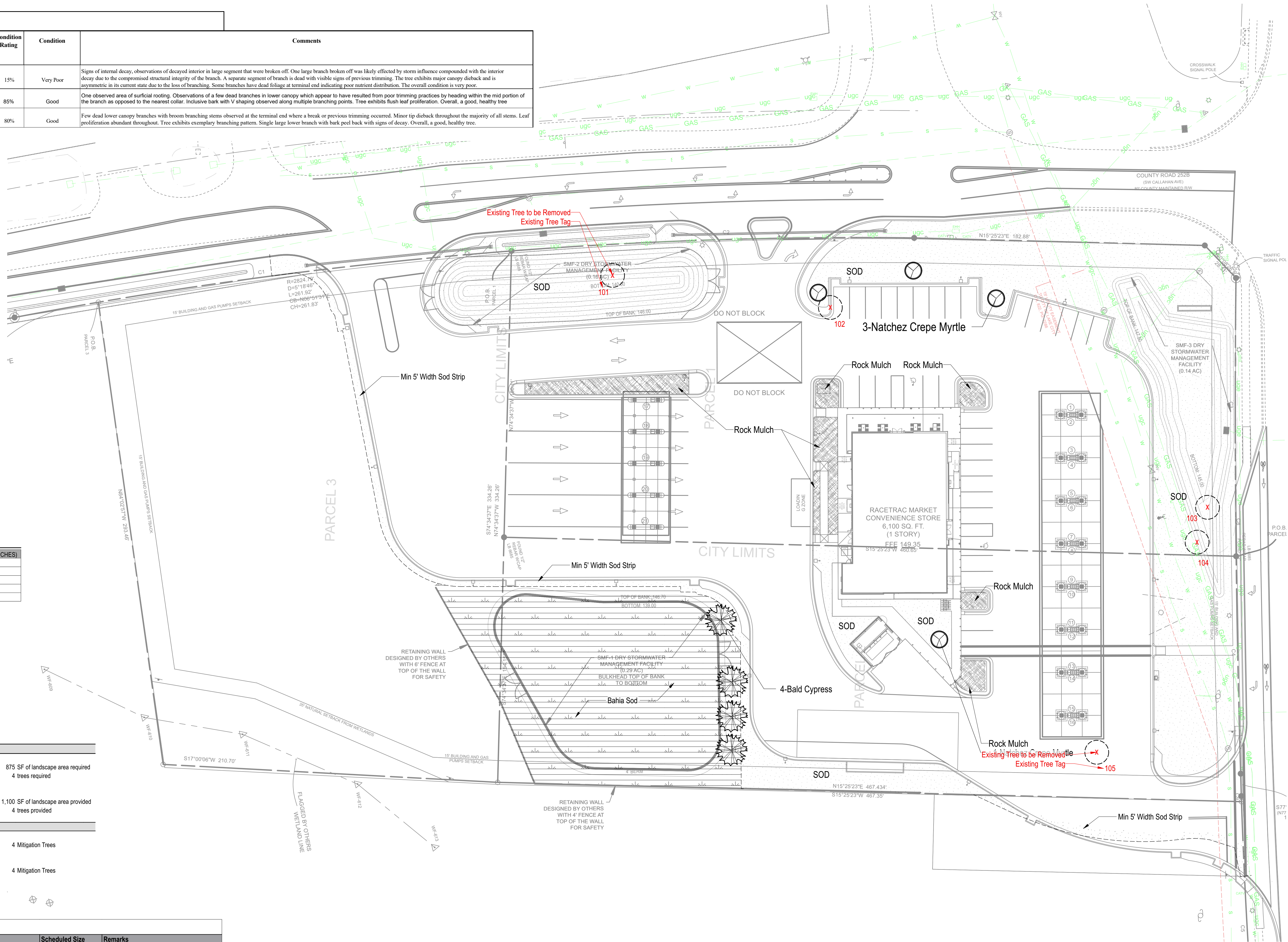

RACETRAC PETROLEUM, INC.  
3225 CUMBERLAND BLVD.  
ATLANTA, GEORGIA 30339  
(770) 431-7600

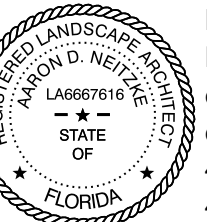

Digitally signed by Aaron D Neitzke  
DN: c=US, o=MLD Studio, dnQualifier=A01, 410C000019833, 459E6700040182, cn=Aaron D Neitzke  
Date: 2026.03.16 23:47:48 -04'00'

## LAKE CITY EDO

US 90 @ 2525B  
LAKE CITY, FL

### REVISION SCHEDULE

NO.	DATE	DESCRIPTION
1	2/17/26	ADDRESS CITY COMMENTS
2	3/16/26	Revised Site Plan

MLD PROJECT # 2025088  
DRAWN BY KCN  
CHECKED BY ADN  
DATE 10/16/25

### Landscape Plan

L-1.1

PERMIT

