

1 SIGNATURE RIVER ROCK MULCH
L1.2 NTS

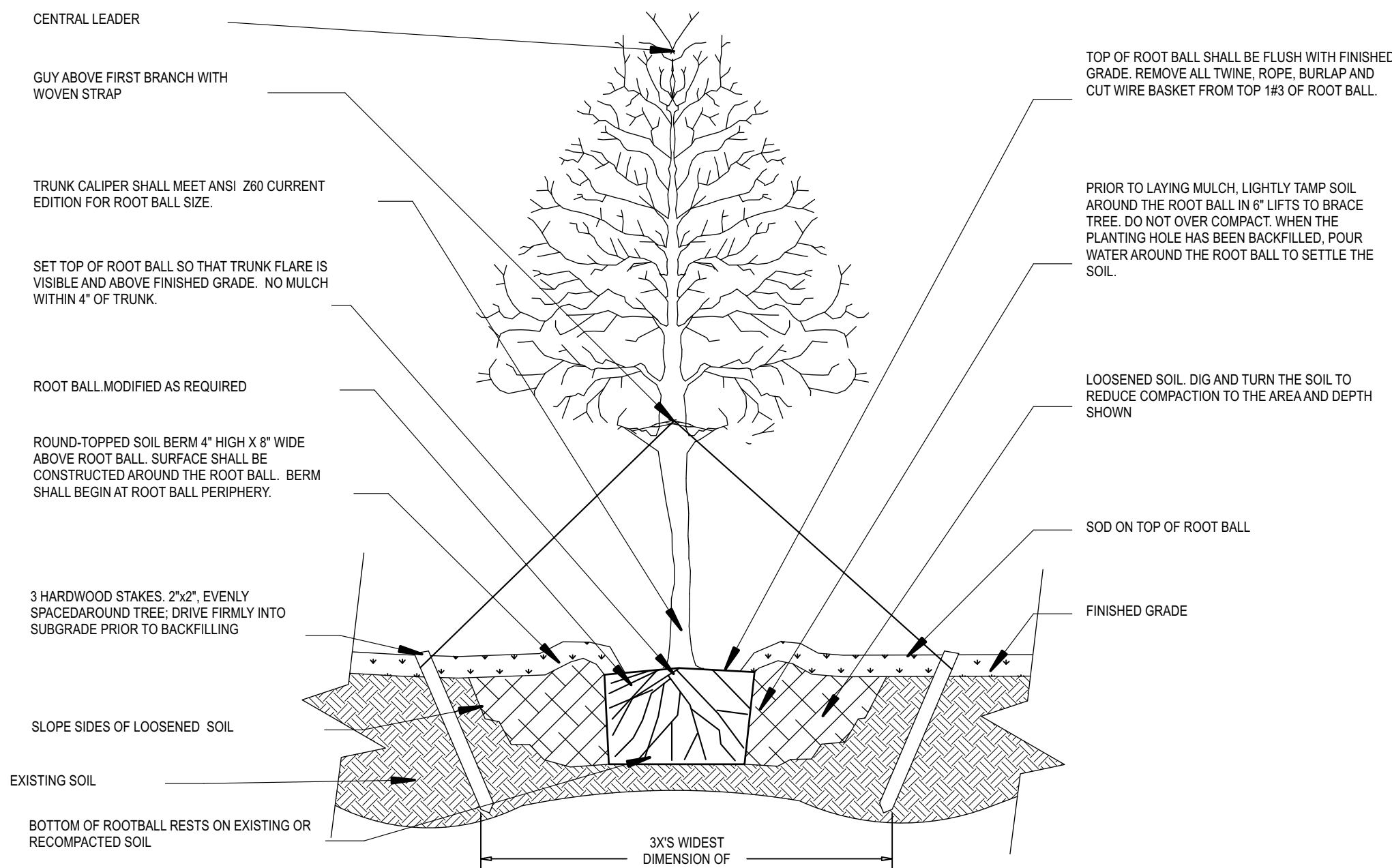

2 TREE STAKING AND PLANTING DETAIL
L1.2 NTS

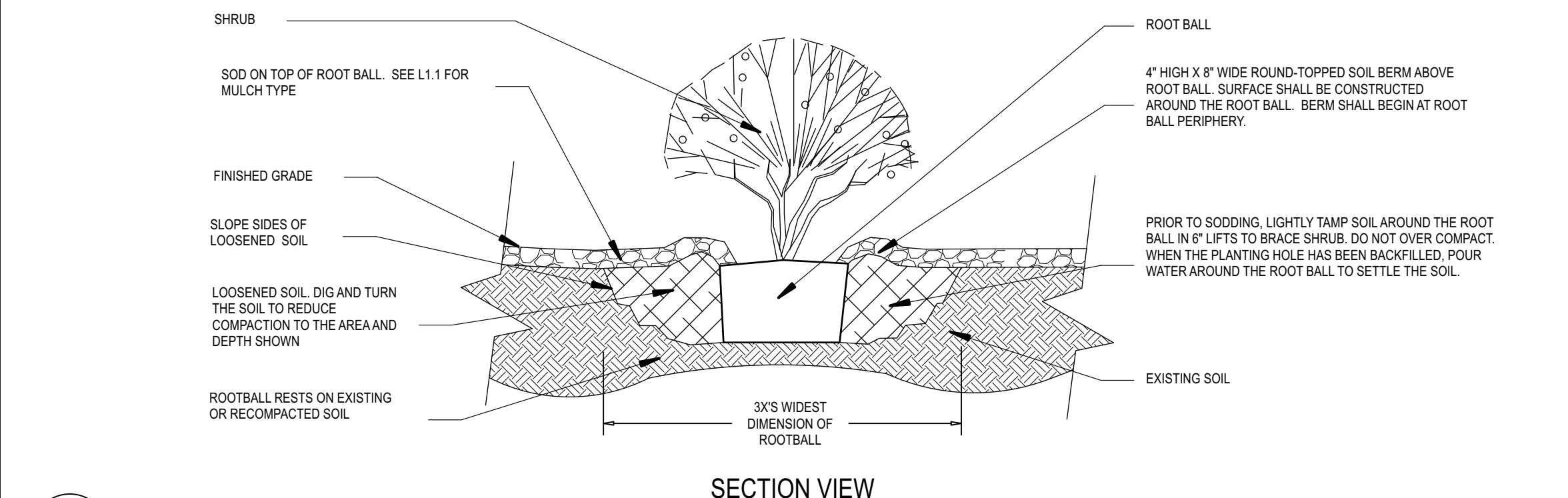

3 SHRUB PLANTING DETAIL
L1.2 NTS

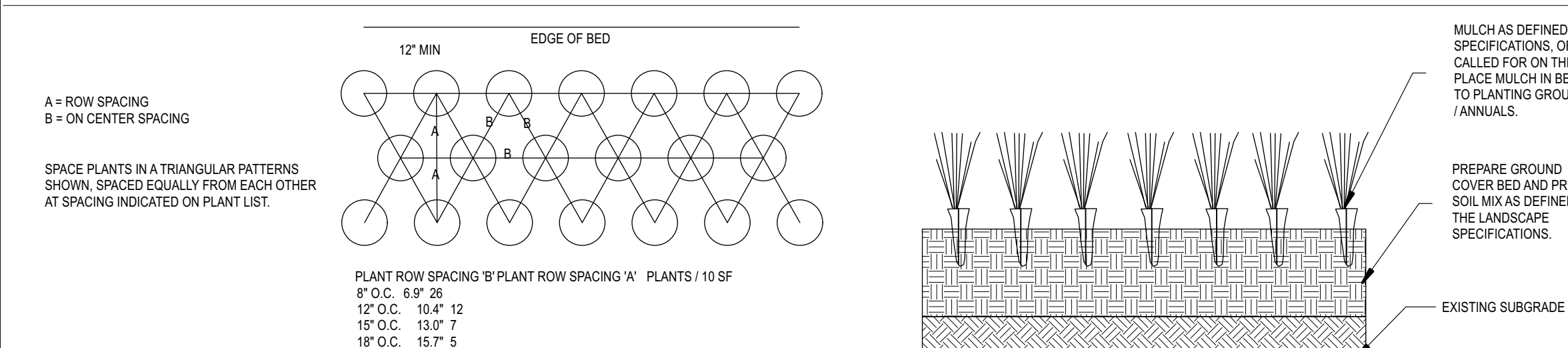

4 GROUND COVER PLANTING
L1.2 NTS

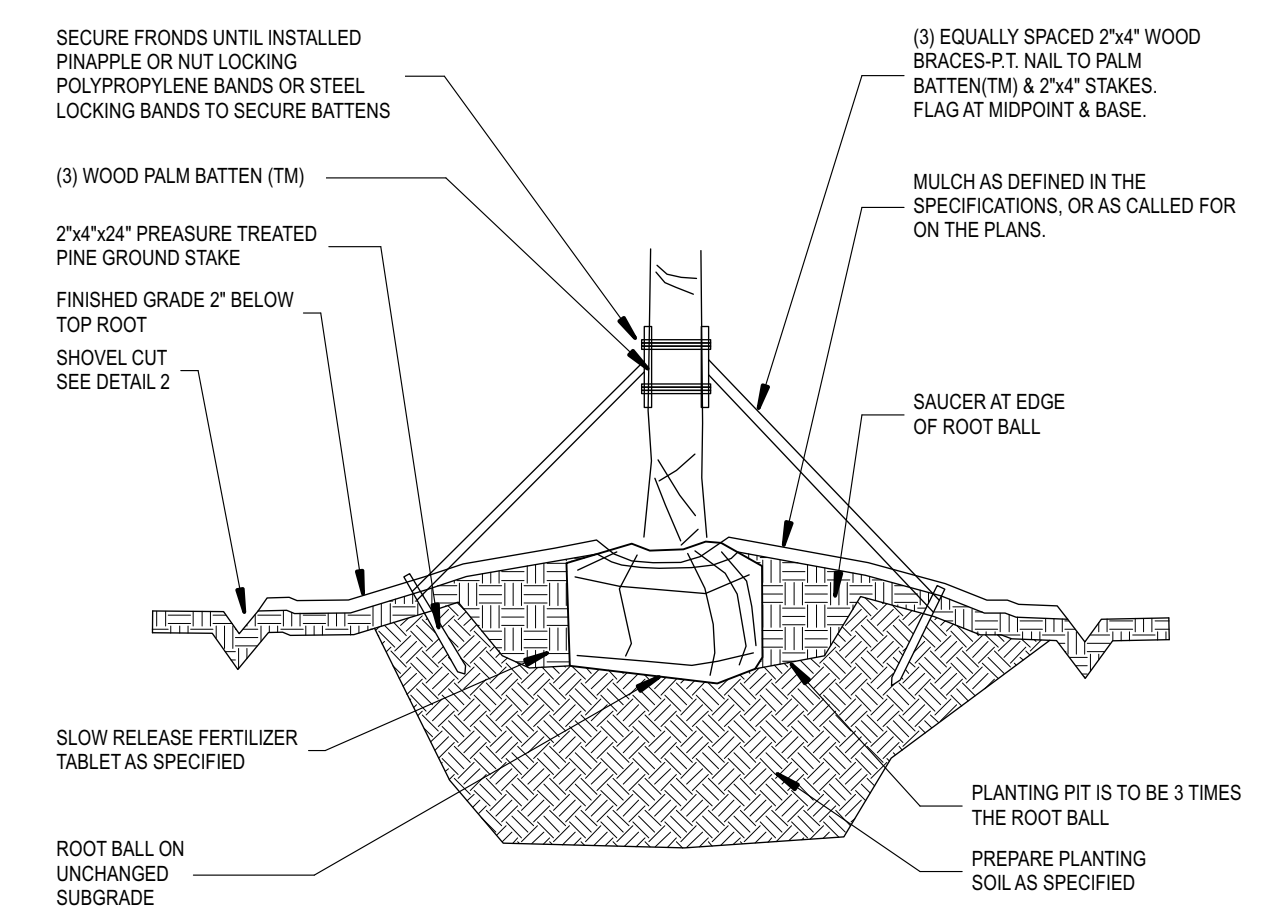

5 PALM TREE STAKING
L1.2 NTS

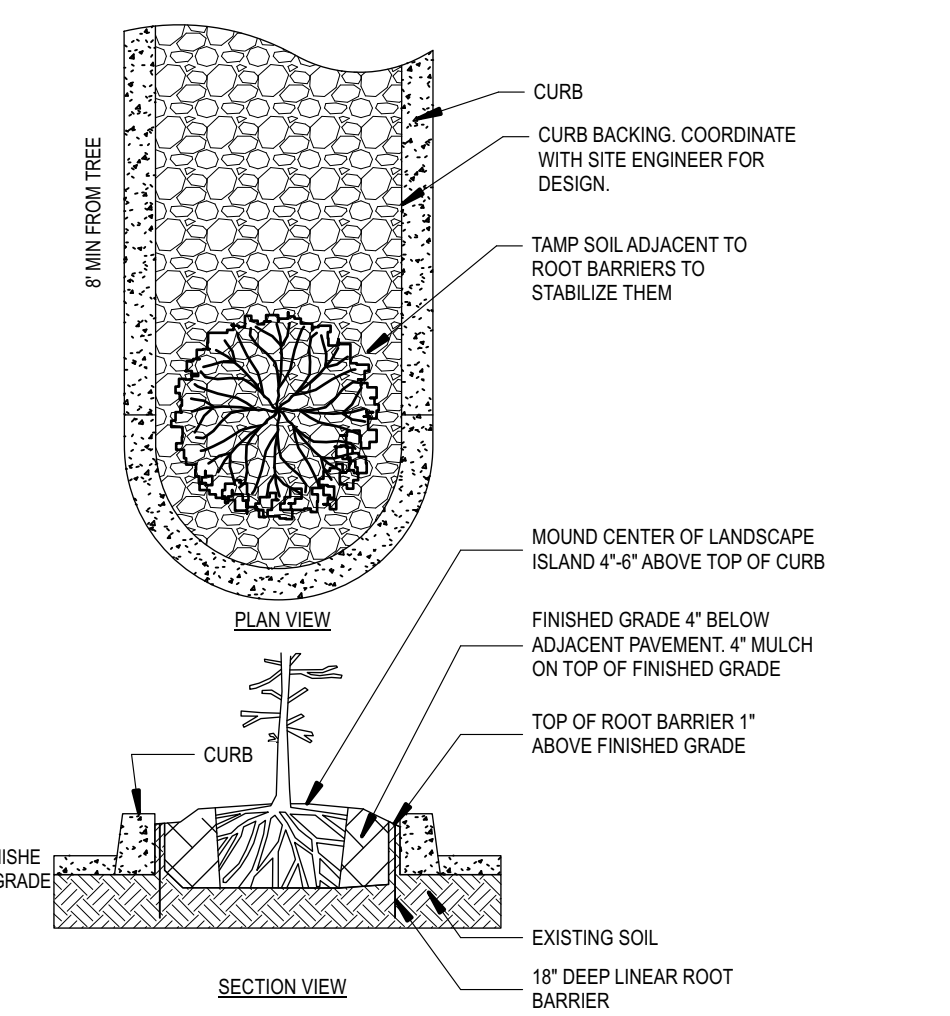

6 ROOT BARRIER - PARKING LOT ISLANDS
L1.2 NTS

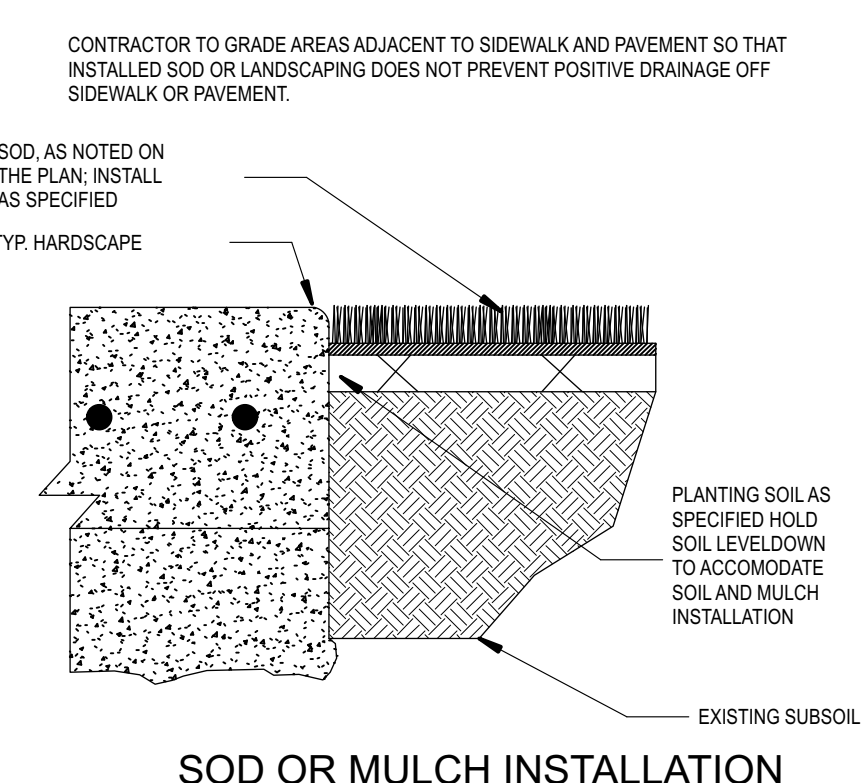

7 SOD OR MULCH INSTALLATION AGAINST HARDSCAPE
L1.2 NTS

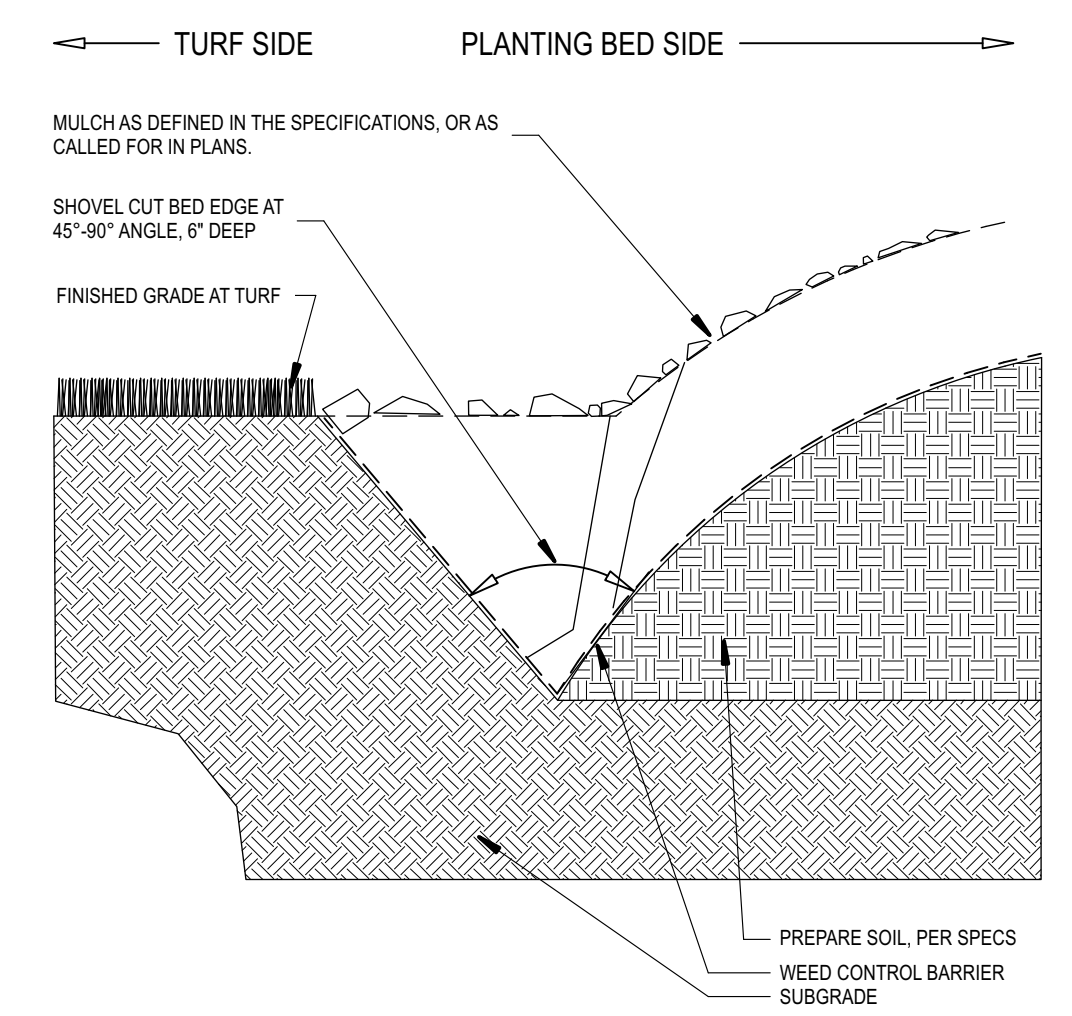

8 SHOVEL CUT BED EDGE
L1.2 NTS

- AGENDA ITEMS**
- SCHEDULE
 - LANDSCAPE ARCHITECT TO CONTRACT WITH RACETRAC FOR CONSTRUCTION ADMINISTRATION.
 - ARE THE CONSTRUCTION PROJECT MANAGER OR LANDSCAPE CONTRACTOR PRESENT?
 - HAS A START DATE BEEN TARGETED AND TIME FRAMES LAID OUT?
 - HAVE THE OTHER REQUIRED ON-SITE MEETINGS BEEN DISCUSSED?
 - IS EVERYONE ON THE SAME PAGE MOVING FORWARD?
 - TOP SOIL
 - WHO IS BRINGING IT TO THE SITE?
 - WHEN SHOULD IT BE BROUGHT TO THE SITE?
 - WHERE WILL IT BE STOCKPILED?
 - PLAN REVIEW
 - HAS IT BEEN STRESSED THAT WE PREFER ROLLED SOD OVER SQUARE PALLETS WHERE APPLICABLE?
 - ARE THE IRRIGATION SLEEVES IN THEIR PROPER LOCATIONS?
 - WILL STRUCTURES / UTILITIES PREVENT THE IRRIGATION MAINLINE FROM BEING THREE (3) FEET OFF OF CURB?
 - SUBMITTALS / APPROVALS
 - PICTURES OF SHRUBS, SOD, INDIVIDUAL TREES, ROCK MULCH
 - PRICE SIGN LOCATION
 - HAS THE SIGN SPOTTING BEEN DONE AND IS THE CURRENT LOCATION CONFIRMED?
 - IF THE LOCATION MAY CHANGE, HAS IT BEEN DISCUSSED HOW EVERYONE WILL BE NOTIFIED?
 - DOES ANY LANDSCAPING AFFECT THE VISIBILITY OF THE SIGN?
 - MISCELLANEOUS
 - HAVE CIRCUMSTANCES UNIQUE TO THE SITE BEEN DISCUSSED?
 - DOES ANYONE AT THE MEETING HAVE ANY QUESTIONS OR CONCERNS ABOUT THE RESPONSIBILITIES MOVING FORWARD WITH THE PROJECT?

12 LANDSCAPE PRE-CON MEETING AGENDA
L1.2 NTS

LANDSCAPE NOTES

- Contractor responsible for locating and protecting all underground utilities prior to digging.
- Contractor responsible for protecting existing trees from damage during construction as shown on plans.
- General Contractor to install 4" minimum depth of clean, friable topsoil at all planting beds and 4" minimum depth at lawn areas prior to fine grading. See Topsoil specification.
- All shrub beds (existing and new) to be mulched with a 4 inch minimum layer of rock mulch. Rock as defined in the landscape specifications.
- Existing grass in proposed planting areas to be killed and removed and area to be hand raked to remove all rocks and debris larger than 1 inch in diameter prior to planting shrubs or laying sod. Landscape Contractor to provide fine grading. See grading specification.
- Any existing grass disturbed during construction to be fully removed, regraded, and replaced. All tire marks and indentations to be repaired. No exceptions.
- Landscape Contractor to coordinate with Landscape Architect (L.A.) in the selection of plant material prior to shipment of plant material to site.
- Soil to be tested to determine fertilizer and lime requirements and distributed prior to laying sod as directed by L.A. Provide results to L.A. and Racetrac Project Manager.
- Sod to be delivered fresh (cut less than 24 hours prior to arriving on site) laid immediately, rolled and watered thoroughly immediately after planting. Edge of sod adjacent to mulch beds to be shovel cut as detailed. All sod to be delivered in largest rolls available. There shall be no gaps between sod joints.
- All changes to design or plant substitutions are to be authorized in writing by the Landscape Architect, Racetrac Construction Project Manager, and Engineering Project Manager.
- Planting Mix to be provided as specified in the landscape specifications.
- All plant material shall conform to the latest edition of American Standard for Nursery Stock (ANSI Z60.1)
- The Landscape Contractor shall guarantee all plants installed for one full year from date of acceptance by Racetrac. All plants shall be alive and at a vigorous rate of growth at the end of the guarantee period. The Landscape Contractor shall not be responsible for acts of God or vandalism.
- Any plant that is determined dead, in an unhealthy or unsightly condition, lost its shape due to dead branches or other symptoms of poor, non-vigorous growth, as determined by the Landscape Architect, shall be replaced by the Landscape Contractor at no cost to RaceTrac.
- General Contractor to mount all parking islands 4" with clean screened topsoil; see specification and detail.
- Prior to installation, the Landscape Contractor shall inspect the subgrade, general site conditions, verify elevations, utility locations; irrigation, approve topsoil provided by General Contractor and observe the site conditions under which the work is to be done. Notify General Contractor of any unsatisfactory conditions, and work shall not proceed until such conditions have been corrected and are acceptable to the Landscape Architect, Landscape Contractor and RaceTrac Construction Manager.
- Stake all evergreen and deciduous trees as noted in the specifications.
- Remove all stakes and guying from all trees after one year from planting.
- Water all plant material that are newly planted thoroughly twice in the first 24 hours and apply mulch immediately.
- Site to be 100% irrigated in all planting beds and grass area by an automatic underground irrigation system.
- All tree protection devices to be installed by General Contractor prior to start of land disturbance, and maintained until final landscaping.
- All tree protection areas to be protected from sedimentation.
- All tree protection fencing to be inspected daily, and repaired or replaced as needed or instructed by L.A.
- No parking, walking, storage or other construction activities shall occur within tree protection areas.
- Landscape Contractor shall provide a 1 year maintenance period under separate contract following acceptance by the Landscape Architect and RaceTrac Construction Manager. Maintenance contract to be assigned through RaceTrac Maintenance Department.
- These drawings are intended to be printed on 24X36 paper. Printing the file at a different size will impact scale. Verify the graphic scale before referencing any measurements on these sheets. Recipient of these drawings shall be responsible for any errors resulting from incorrect printing, copying, or any other changes that alter the scale of drawings.
- Verify all plan dimensions prior to the start of construction.
- Coordinate site access, staging, storage and cleanup areas with owner's representative.
- Contractor shall be responsible for protection of their material stockpiles and work from vandalism, erosion or unintended disturbance during construction period and until final acceptance is issued.
- Contractor is responsible for providing temporary safety fencing and barriers around all improvements such as walls, play structures, excavations, etc. associated with their work until such facilities are completely installed per the plans, specifications and manufacturer's recommendations.
- Local, state, and federal jurisdictional requirements, restrictions or procedures shall supercede the plans, notes and specifications when more stringent. Notify the owner's representative if conflict occurs.

13 TYPICAL LANDSCAPE NOTES
L1.2 NTS

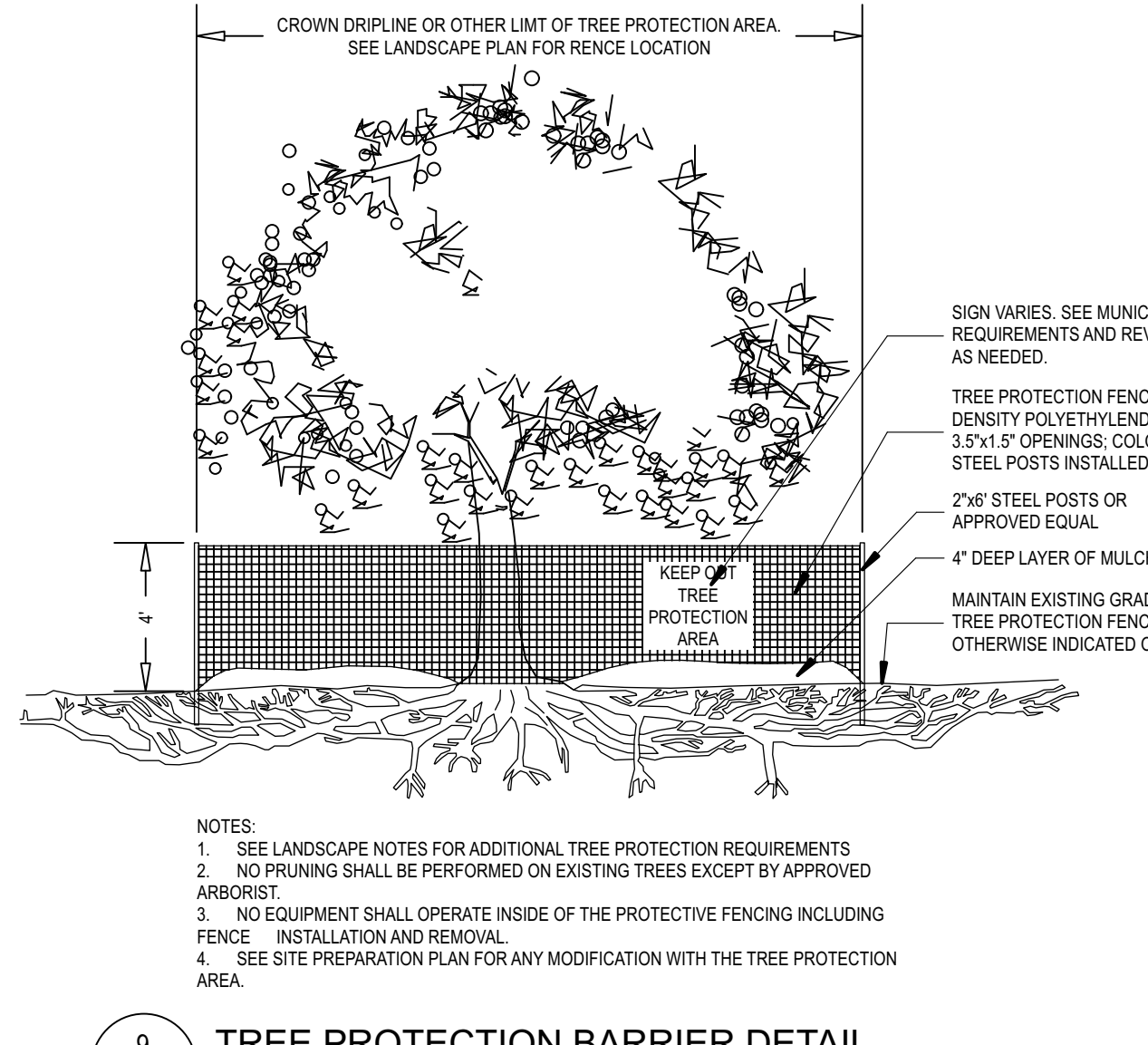

9 TREE PROTECTION BARRIER DETAIL
L1.2 NTS

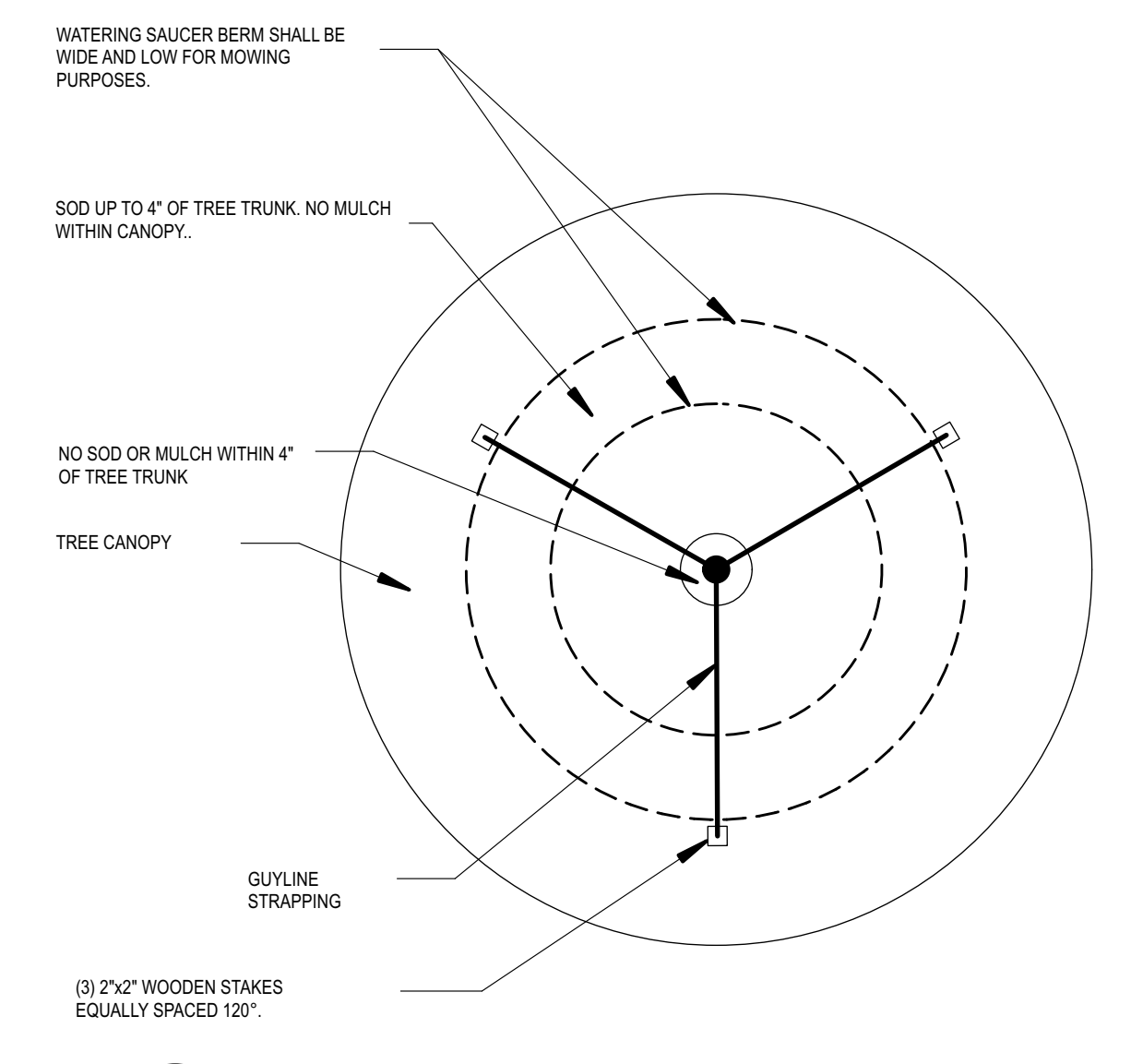

10 TREE PLANTED IN LAWNS
L1.2 NTS

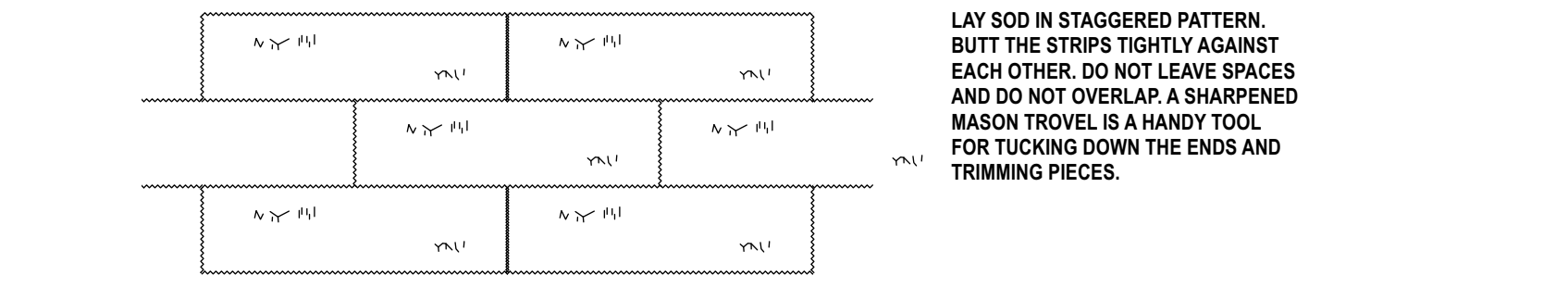

11 SOD INSTALLATION DETAILS
L1.2 NTS

SOD PLANTING REQUIREMENTS

GRASS	VARIETIES	RESOURCE AREA	GROWING SEASON
BERMUDA GRASS	COMMON TIWAY TIFGREEN TIFLAWN	MALPC PC PC	WARM WEATHER
BAHA GRASS	PENSACOLA	PC	WARM WEATHER
CENTPEDE		PC	WARM WEATHER
ST. AUGUSTINE	COMMON BITTERBLUE RALEIGH	C	WARM WEATHER
ZOYSIA	EMERALD MEYER	PC	WARM WEATHER
TALL FESCUE	KENTUCKY	MALP	COOL WEATHER

FERTILIZER REQUIREMENTS FOR SOD

TYPES OF SPECIES	PLANTING YEAR	FERTILIZER (N-P-K)	RATE (lbs/acre)	NITROGEN TOP DRESSING RATE (lbs/acre)
COOL SEASON GRASSES	FIRST MAINTENANCE	6-12-12	1500	50-100
	SECOND MAINTENANCE	6-12-12	1000	30
WARM SEASON GRASSES	FIRST MAINTENANCE	6-12-12	1500	50-100
	SECOND MAINTENANCE	6-12-12	800	30

FERTILIZER REQUIREMENTS FOR SOIL SURFACE APPLICATION

FERTILIZER TYPE	RATE (lbs/acre)	FERTILIZER RATE (lbs/kg ft)	SEASON
	1000	0.025	FALL

11 SOD INSTALLATION DETAILS
L1.2 NTS

MLD STUDIO
Landscape Architecture
51 Old Canton Street
Alpharetta, GA 30009
770.442.8171

RaceTrac
RACETRAC PETROLEUM, INC.
3225 CUMBERLAND BLVD.
ATLANTA, GEORGIA 30339
(770) 431-7600



Digitally signed by Aaron D Neitzke
DN: c=US, o=MLD Studio,
dnQualifier=A01410C00000198334
59E6700040182, cn=Aaron D
Neitzke
Date: 2026.03.16 23:46:34 -04'00'

LAKE CITY EDO
US 90 @ 2525B
LAKE CITY, FL

REVISION SCHEDULE

NO.	DATE	DESCRIPTION
1	2/17/26	ADDRESS CITY COMMENTS
2	3/16/26	Revised Site Plan

MLD PROJECT # 2025088
DRAWN BY KCN
CHECKED BY ADN
DATE 10/16/25

Landscape Details

PERMIT
L-1.2