

I-I-D HEAVY DUTY



\$4,500,000

08-1785-BP-3DY
60' x 76' = 4,560 SQ. FT.
BLISS PRODUKTS
JULY 21 2008

Live Oak, FL

SPOHN RANCH, INC. - P. 626-330-5803 - F. 626-330-5503 - WWW.SPOHNRANCH.COM

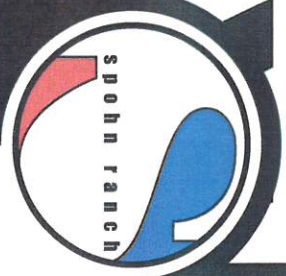

I-D HEAVY DUTY

08-1785-8P-3DY
60' X 76' = 4,560 SQ. FT.
BUSS PRODUCTS
JULY 21, 2008

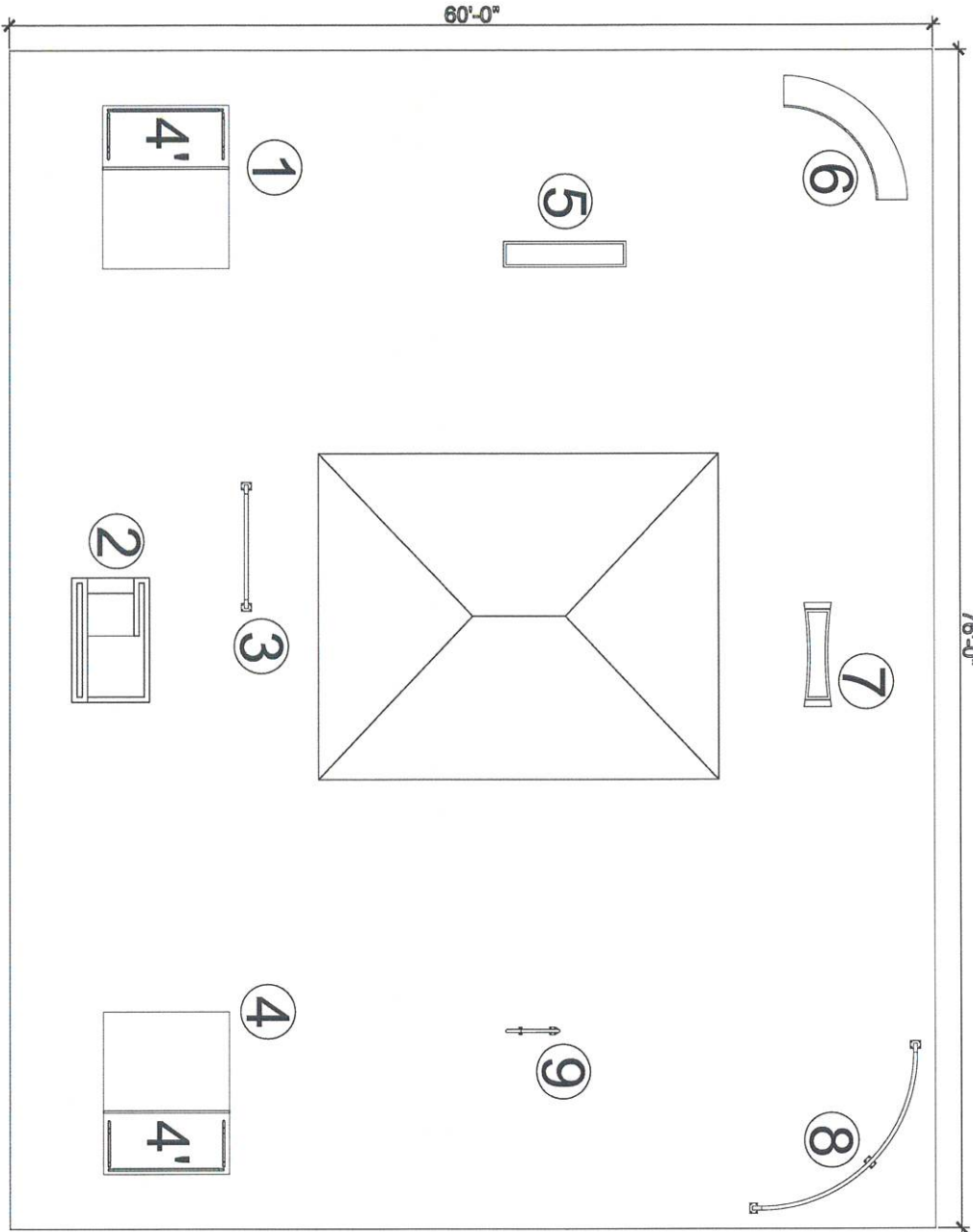

Live Oak, FL

SPOHN RANCH, INC. - P. 626-330-5803 - F. 626-330-5503 - SPOHNRANCH.COM

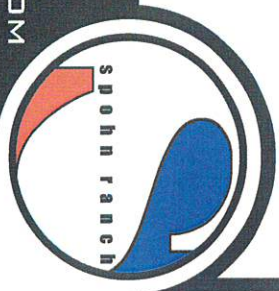

Live Oak Skate Park Inspection Checklist

Suwannee Parks & Recreation
John H. Hale Community Center Recreation Park
215 N.E. Duval Street - Live Oak, FL 32064
Phone 386-362-3004 - Fax 386-208-1580
www.suwanneeparksandrecreation.org

Date of Inspection _____ Day of Week _____
Name of Inspector _____ Time of Inspection _____

Form Instructions

1. Form must be completed by a maintenance employee.
2. Skate park equipment and general site inspection should be performed on Monday and Friday of each week in order to assess any items that can present danger to the park users or spectators.
3. Please fill out each section as completely as possible. Reference component list on site layout.
4. At the end of your inspection, you will need to indicate on this form what actions need to be taken, and the severity of damage, if any.
5. This form should be turned in to the maintenance supervisor so that any needed work can be scheduled as quickly as possible.
6. For documenting any maintenance performed, please use the Daily Work Report.

Concrete Slab, Flatwork, and Skating Elements

Note any cracks, holes, malformations, settling, anything to cause falls. Also mark them on the site layout. Minor cracking is normal; gaps wider than 1/8" should be addressed promptly. _____

Note condition and security of safety hand rails on skating elements. _____

Steel Grind Edges: Note heavy build-up of wax, broken coping welds, etc. _____

Slab Fasteners on Free-Standing Grind Rails: Note any loose red-heads. _____

Note any standing water, pools from rain or other sources. Also mark on site layout. _____

Note any debris in skate park, including leaves, dirt, rocks, or other foreign objects. _____

Miscellaneous

Is the Rules Signage intact or damaged? _____
Note any problems with drainage. _____
Note any damage to pavilion or post pads. _____

Note any other damage due to vandalism, storms, etc. Are any graffiti or stickers on ramps?

Recommendations and Actions Required

No repairs needed _____
Debris Found and Cleaned Up _____
Minor or Semi-Critical Repairs Needed Within the Week _____
Immediate Repairs Needed (Close Park Until Fixed) _____
Signature of Inspector _____
Date Signed _____

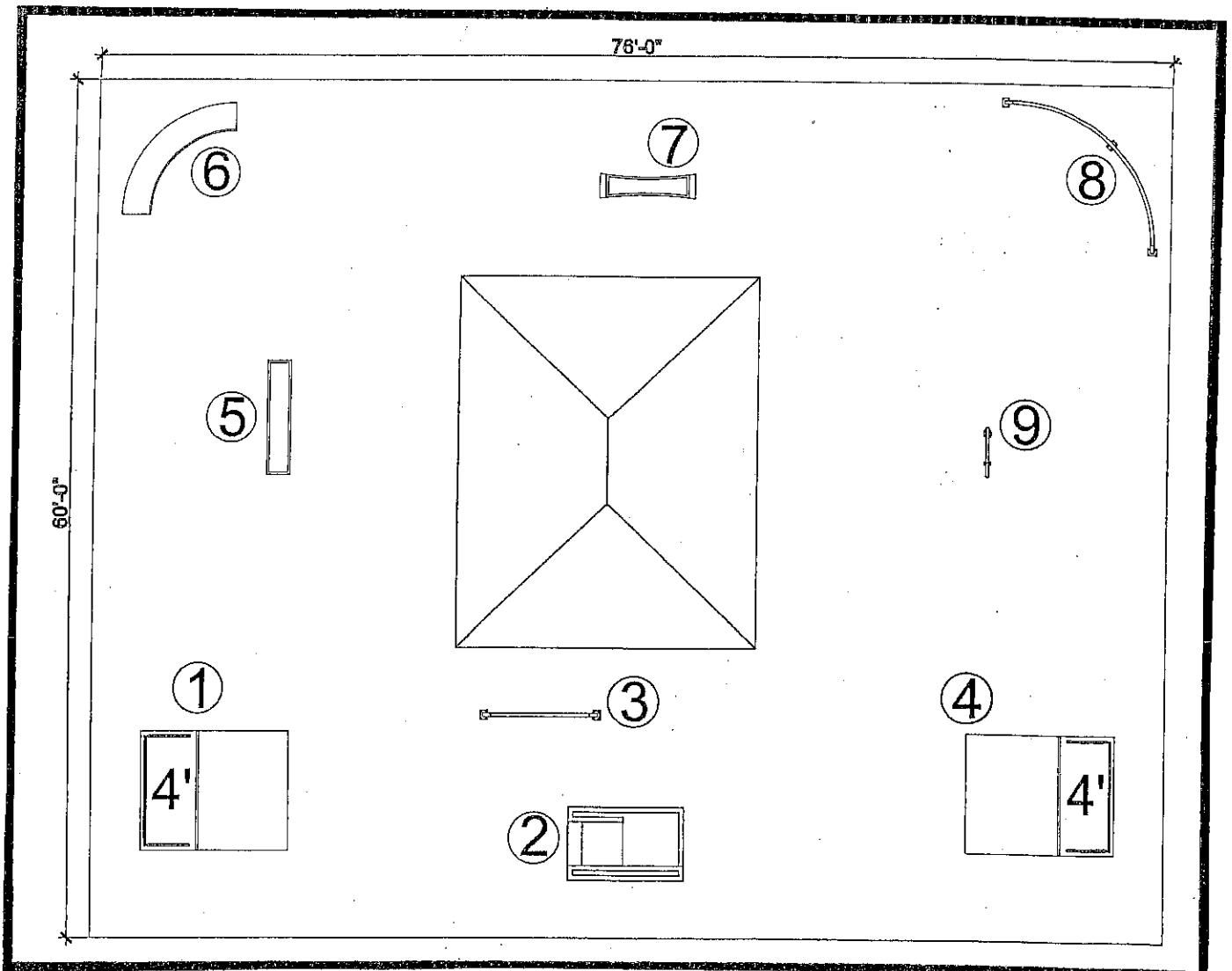

SKATEPARK INSPECTIONS

Performing regularly scheduled maintenance is critical to the success of your skatepark, and necessary to keep your equipment safe and the warranty valid (please refer to the warranty on page 12). Inspections should be performed weekly by park personnel, documented on the form provided by Spohn Ranch, Inc., and kept on file. If your town doesn't have the manpower to perform regular inspections, please contact Spohn Ranch to discuss options.

What to Look For:

- Inspect grout lines between modules for cracking, shifting, or breaking. Minor cracking in the grout is normal, gaps wider than 1/8" should be addressed promptly.
- Inspect the skatepark equipment, hand railings (if applicable), grind rail anchor bolts, and coping welds.
- Inspect the slab for any cracks, holes, settling or malformations. Minor cracking of poured in place concrete is normal and will happen over time. Cracks wider than 1/8" should be addressed promptly. If not, they may grow, especially where winter climates are experienced.
- Inspect the overall site for safety concerns such as standing water, debris, leaves, dirt, etc. Trip hazards should be addressed immediately.
- Inspect the fencing (if applicable) for any damage to the posts, chain link, locks, or security devices.
- Inspect the lighting for any burned out, malfunctioning, or misdirected bulbs.
- Inspect miscellaneous site items, such as the rules signage, overall drainage, and whether the pay phone is working, if applicable.
- Minor sticker and graffiti removal. If left too long, graffiti cannot be removed without industrial strength alternatives.
- Complete an inspection report, documenting the findings and repair items that need to be addressed.

To assist with this process, Spohn Ranch, Inc. offers a regular inspection service, where factory-certified skatepark installers inspect the equipment on a quarterly basis and provide the client with a follow-up report identifying any issues that need to be addressed. At that time, the client can request a repair quote from Spohn Ranch to perform the necessary work. Please call Spohn Ranch, Inc. to discuss pricing and scheduling options.

SUWANNEE

Parks & Recreation

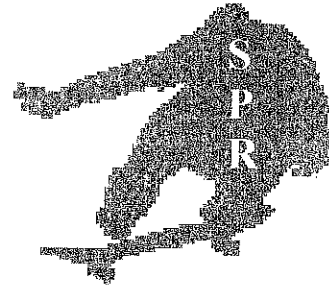

Live Oak Skate Park at John Hale Park PARENTAL CONSENT FORM

Decal No. _____

Minor's Name: _____ <small>(Anyone under 17 at time of registration)</small>	Date of Birth: _____	
Address: _____	Phone: _____	
City: _____	State: _____	Zip: _____
Emergency Contact: _____	Phone: _____	Cell: _____
Medical Alert (if applicable): _____		

PARENTAL CONSENT - Read Before Signing !

PURSUANT TO FLORIDA STATUTE § 316.0085(5)(c), AND IN CONSIDERATION of being allowed to participate in any way at Live Oak Skate Park, I _____, the parent of _____, a minor under 17, acknowledge, appreciate, and agree that:

1. The risk of injury from the activities involved in this program is significant, including the potential for permanent paralysis and death, and while particular rules, equipment, and personal discipline may reduce the risk, the risk of serious injury does exist even when these activities are conducted in accordance with all such rules. These activities are inherently dangerous; and,
2. I knowingly and freely assume all such risks that naturally arise from the inherently dangerous activities of skateboarding, scootering, or in-line skating, both known and unknown, and assume full responsibility for my participation; and,
3. I willingly agree to comply with the stated and customary terms and conditions for participation. If, however, I observe any unusual significant hazard during my presence or participation, I will remove myself from participation and bring such to the immediate attention of Suwannee Parks and Recreation at 386-362-3004.

Upon registering to participate at Live Oak Skate Park, participant will be issued a decal that must be affixed to user's helmet, and helmet must be worn at all times.

I have read this Parental Consent Form. I fully understand its terms. I sign freely and voluntarily. I understand that unless written parental consent is provided to Suwannee Parks and Recreation, my child should NOT skate in the park.

SPOHNCRETE

SPOHNCRETE PRECISION CAST SKATEPARK SYSTEM

MAINTENANCE PROCEDURES

It is not anticipated that SpohnCrete components should require repair at any time but if repairs become necessary for any reason there are only a few simple steps to follow.

1. **Cleaning** – If cleaning becomes necessary, washing with water and a mild detergent is recommended.
 - a. Remove graffiti by gently brushing the surface with a soft bristled brush and a combination of water and solvent until clean. Be careful not to score the polyurethane coating with the brush during this procedure.
 - b. Graffiti and tagging should be removed as soon as possible as delaying this procedure will increase the difficulty of its removal.
 - c. Avoid using abrasive cleaners unless absolutely necessary. If surface dulls due to cleaning, recoat using Spohn Ranch supplied polyurethane coating.

2. **Patching** – Mechanical chipping and gouges may occur, especially if BMX bikes are also using the ramps.
 - a. Thoroughly clean all surfaces to be patched. Use a solvent if necessary to remove wax.
 - b. Moisten the surface to be patched with water and or a bonding agent.
 - c. Be sure that surface to be patched is left rough to ensure proper bond between surface and new material.
 - d. Surface should be patched with materials found locally at a construction materials supply outlet or from the manufacturer. Be sure they are of a fine material to facilitate feathering of the patch to a smooth finish. (Specifications and technical information are available from Spohn Ranch upon request).
 - e. Sand patch to a smooth finish.
 - f. Recoat as necessary with polyurethane coating as supplied by Spohn Ranch.

3. **Re-Coating** – As an option, surfaces may be coated with a two-part polyurethane coating. Occasional touch-up of the surface coating may be required. This material is available from Spohn Ranch.
 - a. Surface must be cleaned thoroughly. It is especially important to remove any wax.
 - b. Surfaces to be recoated should be lightly sanded.
 - c. Larger areas should be primed with the recommended two-part primer if coating a bare concrete surface.

- d. Smaller areas may be coated directly with the two-part coating. Mixing instructions will be located on the container. The coating may be applied by a brush or a roller.
- e. Additional coating information can be obtained from Spohn Ranch upon request.

4. Footing Repair/ Replacement – The footings of SpohnCrete components should not require repair under normal circumstances. If required, the procedures are as follows.

- a. Clean the surface where grouting material is to be placed making sure to remove any oil or other foreign substances that may be left on the surface.
- b. Mix a reasonable amount of the grouting mixture (enough to fill the damaged area) and proceed to pack and fill the area using a trowel or similar apparatus.
- c. Continue this process until area is satisfactorily filled and smooth over with trowel.

5. Removal Procedures for Component Relocation – If your SpohnCrete components require relocation/ reinstallation, please contact Spohn Ranch, Inc. to discuss the procedures. There are a few additional details to keep in mind if components are to be relocated.

- a. The lifting anchors required during the original installation were filled, smoothed and painted. The first procedure requires that these areas be chiseled out thereby freeing the anchor for lifting.
- b. This will require a set of 'Swift Lift' Lifting Eyes for the relocation procedure. These lifting eyes can be obtained by either loan or purchase through Spohn Ranch.
- c. Depending on site conditions, a 40-90 ton crane should be utilized for these operations.
- d. The components have been placed on a grout bed that has bonded to both the underside of the components and the surface of the footing foundation. This bond must be broken before components are lifted. Using a crowbar, chisels etc. break out this bond. It is not necessary to break out the entire area around the perimeter of the ramp but enough to release the component.
- e. Remove any residual grouting material from underside of component to ensure a proper reinstallation.
- f. Saw cut all grouted joints and welded copings.
- g. Using the crane lift the components at a slight angle to avoid damage to adjacent components. Note that if the components do not release under the tension produced by the crane the bond has not yet been broken. Repeat the prior step.
- h. Proceed with relocation/ reinstallation using the General Installation Procedures found in the first section of these documents.

6. Maintenance Schedule – SpohnCrete components are essentially maintenance free. There are some procedures that can be done depending on the amount of use the ramps receive.

- a. The optional surface coating may be recoated 3-4 years after installation depending upon the aesthetic condition, though this is not required. The surface is designed to stand up to climatic conditions whether the surface is coated or not.
- b. The guardrails may require periodic touchups with Galvicon paint if the galvanized coating is vandalized.
- c. Inspect concrete surface for signs of chipping, gouging or holes as may occur in the case of abuse or vandalism. Repair as per above patching instructions.
- d. Check for weld breaks or damage to steel – dents, holes, cuts etc. and repair.
- e. Depending on the type and amount of use the park receives (i.e. BMX), the frequency of inspections may need to be increased.

7. **Fastening Specifications for Safety Rails** – Safety rails are normally casted directly into the surface of the ramps while at the factory and therefore will not require refastening or tightening after a ramp has been installed. In some cases safety rails will be grouted in place on site during the initial installation, these rails will also not require tightening/refastening under normal circumstances.

SPOHN SUCRETE

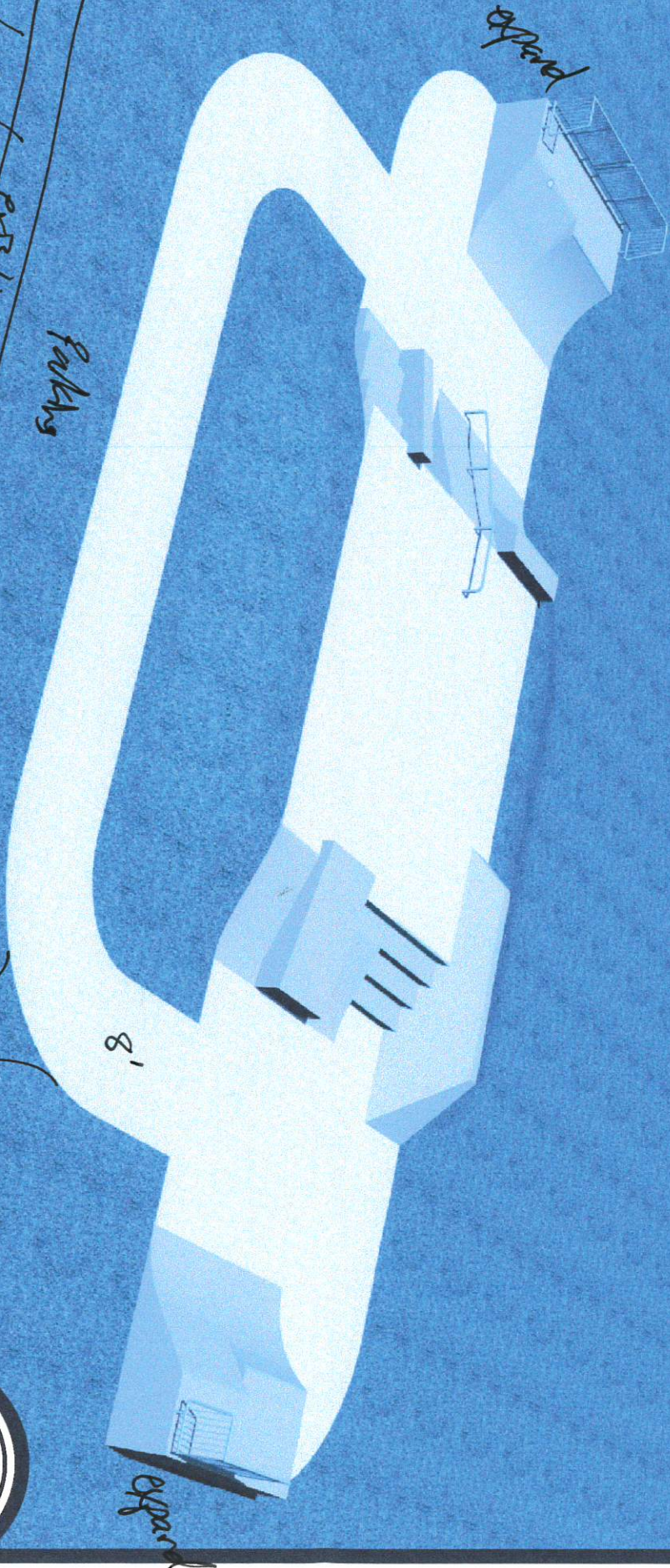

08-22233-BP-1SC
3448 SF
BLISS PRODUCTS
APRIL 27, 2009

Falks

IN
existing sidewalk

8'

Live Oak, FL

SPOHN RANCH - 15131 CLARK AVE., CITY OF INDUSTRY, CA 91745 - P: 626-330-5803 - F: 626-330-5103 - WWW.SPOHNRANCH.COM



SHAS DRIVE



LIVE OAK, FL
SKATEPARK PROPOSAL – 09-2233-BP-3SCTK

SPOHNCRETE

SPOHNCRETE SKATEPARK CONSTRUCTION AND INSTALLATION

\$ 101,978.80

INCLUDES:

- Precision-cast concrete skate elements, as shown
- Stainless steel edge protection
- Shipping and Handling
- Factory-Certified Installation
 - Obstacle Placement
 - Welding, grouting, and finishing
- Concrete flatwork (4-6" thick) ~3448 SF total
 - Concrete footer slabs
 - Finished concrete floor slab
 - Finished concrete deck slabs

~~57,000~~

~~158,978.80~~

CLIENT PROVIDES / PROVIDED BY OTHERS:

- Site Security
- Site map, with roads and access routes marked in detail for crane
- Protection of underground utilities in the area of the slab
- All earthwork including grading, compaction, backfill, and berming

EXCLUDES:

- Price does not include taxes, prevailing wage, or bonding of any kind
- Price does not include any purchasing contract fees
- Price does not include any engineering, permitting, surveying, or testing services
- Price does not include optional surface treatments (granite, brick, tint, etc.)
- Price does not include grubbing, fill, landscaping, or drainage

TERMS:

- Initial delivery date from time of order—approximately 10-12 weeks
- Payment Schedule: 40% upon order, 60% within 10 days of completion

PROPOSAL VALID FOR 10 DAYS FROM 4.27.09

PROPOSAL SUBJECT TO ATTACHED TERMS AND CONDITIONS

