

1 - ①

Roadway Access Permit Application

Fees: \$100 Application Fee + \$400 Culvert Installation = \$500

No person shall construct, reconstruct, improve, or expand any access providing direct movement to or from any roadway operated and maintained by the Village without possession of a permit approved and issued by the Village.



Applicant Information

1. Property Owner Name Michael Grundman Phone Number 715-297-5755
 Address 2337 Whitetail Dr Kronenwetter WI 54455
 Email mike@patsbodyshop.com

Property Information

2. Property Address 2337 Whitetail Dr
 3. Section _____ Township X Range _____ 4. Parcel Identification # (PIN), if known _____
 5. Will the access require a culvert? yes (If required, see information below)

Requirements

1. Sketch of property showing all existing/proposed driveway(s) with distances (in feet) to property lines, including neighboring driveways. **see back*
2. Call the Village at 715-693-4200 when you have marked the location and are ready to have the culvert site inspected. Please notify the Village at least one week in advance for inspection.
3. Payment is required at the time permit is issued.

Culvert Installation (if required)

1. The Village of Kronenwetter will investigate and field inspect the location conducted by the Public Works Department and if needed, install said culvert, including granite.
2. The installation price is for a standard culvert. Any deviation can result in additional charges.

Recommended Attachments (may be required by Village)

1. Roadway access approach plan and profile
2. Complete drainage plan of the site showing impact to the roadway right-of-way
3. Site map detailing utility locations before and after development in and along the roadway
4. A subdivision development plan

Applicant Acknowledgement

To the best of my knowledge, I certify that the information provided on this application and accompanying documents are true and accurate. I am aware of Village regulations contained in Chapter 419 of the Village Code of Ordinances. I also understand that submitting this application authorizes the Zoning Administrator or his/her designee to enter onto the property for the purposes outlined operation.

Applicant Signature

5-29-17

Date

***Sketch - Show all existing/proposed driveway(s) with distances (in feet) to property lines, including neighboring driveways.**

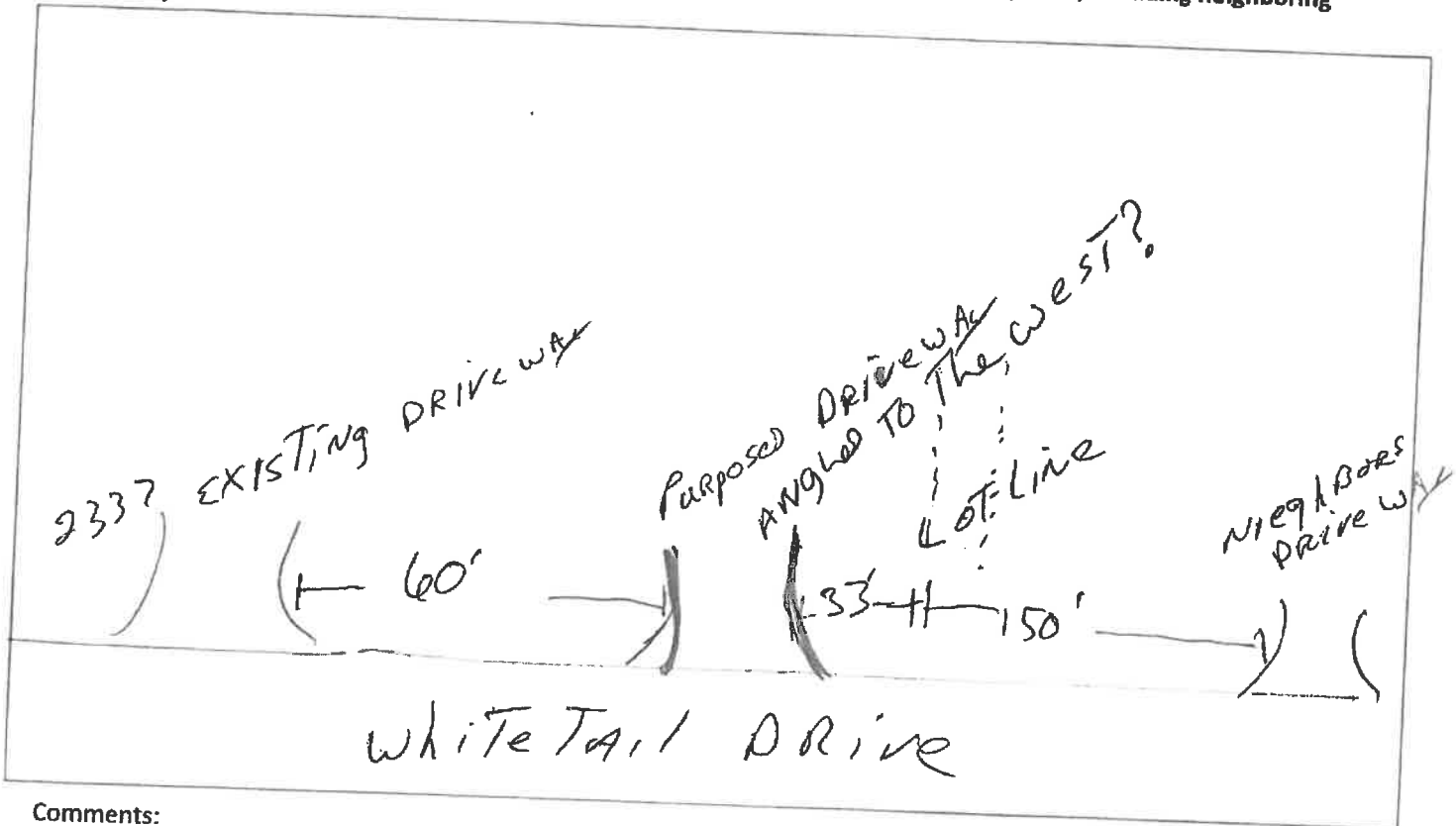

Comments:

EXTRA DRIVEWAY IS ABOUT 60' FROM EXISTING DRIVEWAY + ABOUT 30' FROM WEST LOT LINE. LOT LINE IS ABOUT 150' FROM NEIGHBORS DRIVEWAY

FOR OFFICE USE ONLY:

→ Application Received _____ Check # _____

Roadway Access Classification _____

Driveway Distance Separation (North or East) _____ ft and (South or West) _____ ft

VARIANCE
APPROVED or **DENIED**

Barbara Cancy
Reviewer _____

_____ Date

Date Called for Install: _____

By: _____

Date Ordered Materials: _____

By: _____

Date Installed: _____

By: _____

Date Inspected: _____

By: _____