

**Metal
Shingle
Roofing
Bids**

Request for Proposal

VILLAGE OF KRONENWETTER

MUNICIPAL CENTER ROOF REPAIR & REPLACEMENT PROJECT

This entire bid document must be returned, with all of the appropriate lines and spaces filled-in with the required information. To comply with this advertisement for bids, the following general specifications are to be adhered to: The materials must be NEW, the latest type and make manufacturer and must equal or exceed the following specification requirements.

Building Locations: 1582 I-39 Frontage Road, Kronenwetter WI 54455

1. Bid
 - This bid is intended for the removal and installation of a new roof on Village of Kronenwetter owned Municipal Center Facility locations listed above. Bids shall include all labor and materials to complete the entire project as specified.
2. Insurance
 - \$500,000 workmen's compensation policy
 - All workmen on the project shall be covered by workmen's compensation insurance and shall verify the same by providing the last two years insurance audits, if requested by owner. Workmen on the project shall not "opt out" of workmen's comp insurance.
 - A certificate of insurance shall be issued to the owner listing the owner as a certificate holder.
3. Safety Compliance
 - Compliance with all EPA and OSHA requirements shall be the responsibility of the Prime contractor, as published by local, state and federal authorities.
 - The Prime contractor shall be responsible for all means and methods as they relate to safety and shall comply with all applicable local, state and federal requirements that are safety related.
 - Safety shall be the responsibility of the Prime contractor.
 - All related personnel shall be instructed daily to be mindful of the full-time requirement to maintain a safe environment for the facility's occupants including staff, visitors, customers, and the occurrence of the general public on or near the site.
 - Written Safety Program including HazMat programs and MSDS sheets shall be on project site at all times. Prime contractor shall provide OSHA compliance plan for fall protection, barricades, and general work plan.
4. Contractor Qualifications
 - At least 75% of labor hours associated with this reroofing project must be worked by bona fide employees of the Prime Contractor, who have been employed by the Prime Contractor for more than one year, and for whom the Prime Contractor has paid worker's compensation premiums, based on hours worked, under a roofing class code during 9 of the 12 months immediately previous to the date of the contract. These pre-qualifications are subject to verification by the Owner.

- Contractor shall provide a minimum of 4 projects of similar scope and size with exact or similar materials.
 - Contractor shall have a minimum of 5 years of verifiable experience in both technical aspects of this type of work as well as verifiable experience in running and managing a business, unless approved by the owner prior to the bid opening
 - Contractor shall provide lien waivers at completion of project and before final payment is issued the Village of Kronenwetter.
5. Contractor Extent of Work
- Provide all labor, materials, tools, equipment, and supervision necessary to complete the installation of a stone coated steel roofing system including all flashing as specified herein* in accordance with the manufacturer's most current specifications and details.
 - The Prime contractor shall be fully knowledgeable of all requirements of the contract documents and shall make themselves aware of all job site conditions that will affect their work.
 - The Prime contractor shall confirm all given information and advise the building owner, prior to bid* of any conflicts that will affect their cost bid.
 - Prime contractor shall be responsible for obtaining the local building permit, and coordinating all required inspections.
6. Contractor Product Delivery, Storage, and Handling Responsibilities
- Contractor will be responsible for the unloading, proper storage and security of all materials delivered to the construction site.
 - Deliver materials to the job site in the manufacturer's original, unopened containers or wrappings with the manufacturer's name, brand name and installation instructions intact and legible. Deliver in sufficient quantity to permit work to continue without interruption.
 - Comply with the manufacturer's written instructions for proper material storage.
 - Store all materials in dry areas protected from water and direct sunlight. Follow all manufacturer's instructions for proper storage.
 - Any materials which are found to be damaged shall be removed and replaced at the Prime contractor's expense.
7. Use of the Premises
- Before beginning work, the Prime contractor must secure approval from the building owner's representative for the following:
 - Areas permitted for personnel parking.
 - Access to the site.
 - Areas permitted for storage of materials and debris.
 - Areas permitted for the locations of cranes, hoists and chutes for loading and unloading materials to and from the roof.
8. Discrepancies
- If discrepancies are discovered between the existing conditions and those noted, immediately notify the owner's representative by phone and solicit the manufacturer's approval prior to commencing with the work. Necessary steps shall be taken to make the building watertight until the discrepancies are resolved.
9. Temporary Facilities, Temporary Utilities: and Controls

- Water and power for construction purposes and lighting are available at the site and will be made available to the roofing contractor.
- Provide all hoses, valves and connections for water from source designated by the owner when made available.
- When available, electrical power should be extended as required from the source.
- Contractor Supplied Temporary Sanitary Facilities – Prime contractor will be responsible for supplying temporary sanitary facilities at the job site, through the duration of the project.
- Security - Obey the owner's requirements for personnel identifications, inspection and other security measures.

10. Job Site Protection & Debris Removal

- The Prime contractor shall adequately protect building, paved areas, service drives, lawns, shrubs, trees, etc. from damage while performing the required work. Provide canvas, boards and sheet metal (properly secured) as necessary for protection and remove protection material at completion. The contractor shall repair or be responsible for costs to repair all property damaged during the roofing application.
- During the Prime contractor's performance of the work, the building owner will continuously occupy the existing building. The contractor shall take precautions to prevent the spread of dust and debris, where such material may shift into the building. The Prime contractor shall provide labor and materials to construct, maintain and remove necessary temporary enclosures to prevent dust or debris in the construction area(s) from entering the building.
- Do not overload any portion of the building, either by use or placement of equipment, storage of debris, or storage of materials.
- All materials and equipment hoisted to the rooftop shall be secured against wind and water damage.
- Protect against fire and flame spread. Maintain proper and adequate fire extinguishers.
- Store moisture susceptible materials aboveground and protect with waterproof coverings.
- Remove all traces of piled bulk materials and return the job site to its original condition upon completion of the work.
- The Prime contractor shall remove all debris from the job site in a timely and legally acceptable manner so as not to detract from the aesthetics or the functions of the building.

11. Workmanship

- Applicators installing new roof, flashing and related work shall be factory trained and approved by the manufacturer they are representing.
- All work shall be of the highest quality and in strict accordance with the manufacturer's published specifications and shall be to the owner's satisfaction.
- There shall be a supervisor on the job site at all times while the work is in progress.

12. Quality Assurance

- Unless otherwise noted in this specification, the Prime contractor must strictly comply with the manufacturer's current specifications and details.
- The roofing system must be installed by an applicator authorized and trained by the manufacturer in compliance with shop drawings as approved by the manufacturer.
- Provide adequate number of experienced workmen engaged in each type of work who are skilled in the application techniques of the materials specified. Provide at least one

thoroughly trained and experienced superintendent on the job at all times work is in progress.

- There shall be no deviations made from this specification and/or the approved shop drawings without the prior written approval of the owner. Any deviation from the manufacturer's installations procedures must be supported by a written certification on the manufacturer's letterhead and presented for the owner's consideration.
 - Details shall be done according to Manufacturer's Specifications.
 - Reference materials for details are the NRCA Waterproofing Manual, and the Architectural Sheet Metal Manual by SMACNA, International Building Code, and other applicable industry publications.
 - Proceed with roofing work only when weather conditions are in compliance with the manufacturer's recommended limitations, and when conditions will permit the work to proceed in accordance with the manufacturer's requirements and recommendations.
 - The surface on which the roofing system is to be applied shall be clean, smooth, dry, and free of projections or contaminants that would prevent proper application of or be incompatible with the new installation, such as fans, sharp edges, foreign materials, oil and grease.
 - New roofing shall be complete and weather-tight at the end of each work day.
13. Job Conditions Cautions and Warnings
- Material Safety Data Sheets (MSDS) must be on location at all times during the transportation, storage and application of materials.
 - Do not apply adhesives in conditions such as fog, dew, rain or snow, or when frost occurs on the surfaces of the membrane or substrate.
 - When loading materials onto the roof, the Contractor must comply with the requirements of the building owner to prevent overloading and possible disturbance to the building structure.
14. Warranty
- Contractor's five-year labor, workmanship, and water-tightness warranty shall be issued upon completion.
 - Contractor shall complete all paperwork as needed for issuance of manufacturer's roof warranties.
15. Clean up
- Perform daily clean-up to collect all used roofing materials, wrappings, empty containers paper and other debris from the project site. Upon completion, all debris must be disposed of in a legally acceptable manner at an offsite facility.
 - Magnetic rake shall be used to ensure clean pick-up of metal debris and fasteners in driveway and landscaping areas.

Stone Coated Metal Roof Shingle

PART 1 - GENERAL

1.1 SUMMARY

- A. Related Documents: Provisions established within General and Supplementary Conditions of the Contract, Division 1 – General Requirements, and the Drawings are collectively applicable to this Section.
- B. Section Includes: Formed metal roofing panels with colored stone chip finish.
- C. Associated metal flashings.
- D. Alternates.

1.2 SUBMITTALS

- A. Submit full size shingle samples for color selection.
- B. Product Data: Include construction details, material descriptions, dimensions of individual components and profiles, finishes, fasteners, accessories, and manufacturers written installation instructions.
- C. Shop Drawings: Include roof plans and elevations; sections at ridges, gables, and eaves; and details of components, accessories, and attachments to other work.
- D. Samples for Initial Selection: Manufacturer's color charts and samples consisting of units or sections of units showing the full range of colors, textures, and patterns available for each type DECRA Shingle indicated.

1.3 QUALITY ASSURANCE

- A. Regulatory Requirements:
 - 1. Conform to applicable building code for roof assembly fire hazard requirements.
 - 2. Conform to building code for minimum wind uplift resistance.
 - 3. After project is completed, manufacturer's representative shall visit the site to verify compliance with manufacturer's installation instructions.

1.4 REFERENCES

- A. Fire-Test-Response Characteristics: Provide DECRA Shingle with fire-test-response characteristics indicated, as determined per test method ASTM E108 – Test Fire Resistance of Roof Covering Materials, for application and slopes indicated.
 - 1. Fire-Test Exposure: Class A.
- B. ASTM A792/A792M: Sheet Steel, Aluminum-Zinc Alloy Coated by the Hot Dip Process, Structural (physical) Quality.
- C. UL 1897 and UL 580: Wind Uplift Resistance of Roof Assemblies.
- D. ASTM C920: Specification for Elastomeric Joint Sealants.
- E. Impact Resistance: UL 2218, Class 4.
- F. Appraisal Certificates:
 - 1. International Code Council (ICC), Whittier California, Report No. ESR 1483.
 - 2. Underwriters Laboratories, Inc., Northbrook, Illinois, USA File No. R14710.
 - 3. Canadian Construction Materials Center, Ottawa, Ontario, CCMC#13085-R.

1.5 DELIVERY, STORAGE, AND HANDLING

- A. Store and handle roofing materials to ensure dryness. Store in a dry, well-ventilated, weather tight place. Protect from corrosion, staining and traffic and wind damage. Store rolls of felt and other sheet materials on end on pallets or another raised surface.

1.6 WARRANTY

- A. Manufacturing Warranty: Written, transferable, limited warranty provided by DECRA Roofing Systems, covering manufacturing defects/excessive granule loss. Refer to warranty for specifics.
 - 1. Warranty Period: 50 years from date of Substantial Completion.
 - 2. Wind Warranty: 120 mph winds, full warranty period.
 - 3. Hail Penetration: full warranty period.
 - 4. Normal warranty will apply without any exclusions.

PART 2 - PRODUCTS

2.1 MANUFACTURER or approved equal

- A. DECRA Roofing Systems, Inc., 1230 Railroad Street, Corona, CA 92882 (951-272-8180), (951-272-4476 FAX); www.decra.com.

2.2 MATERIALS

- A. Metal Shingle: DECRA Shingle formed interlocking panels resembling dimensional roofing shingles.
 - 1. Material: Rolled and pressure formed, Aluminum-Zinc Alloy Coated Steel with three vertical ribs forming three flat steps, each of which shall have raised and lowered pan sections.
 - 2. Finish: Ceramic coated colored stone chip finish.
 - 3. Thickness: 26 Gauge, .0179 inches (.455 mm).
 - 4. Size: 21" wide by 52" long (533 by 1321 mm).
 - 5. Exposure: 19-3/4" wide by 49" long (368 by 1270 mm).
 - 6. Weight: 125 pounds per square.
 - 7. Color: [Canyon Brown] [Fawn Grey] [Vintage Slate].
- B. Flashing:
 - 1. Valley: DECRA Roofing Systems, Inc., Shingle Valley, Aluminum-Zinc Alloy coated Steel sheet 26 Gauge, .0179 inches (.455 mm). Pressure formed into a valley with a stone coated valley cap. Finish: Match upper exposed stone coated surface of the valley cap to the shingle material.
 - 2. Drip Edge: DECRA Roofing Systems, Inc., Drip Edge, Aluminum-Zinc Alloy Coated Steel sheet, [3.5 inches] or [5 inches] (89 mm or 127 mm), 26 Gauge, .0179 inches (.455 mm). Pressure formed to fit along the leading edge of roof panels at eave/fascia.
 - 3. Rake / Gable Channel: DECRA Roofing Systems, Inc., Shingle Rake/Gable Channel, Aluminum-Zinc Alloy Coated Steel sheet, 26 Gauge,

- .0179 inches (.455 mm). Pressure formed to match roofing material, color, and finish to be applied along rakes and gables.
4. 24 gauge Kynar coated metal to be custom fabricated with an integral drip edge to transition from upper gambrel roof slope down over the skylight panels. Minimum lap over the upper end of skylight panels to be 4 inches with foam closure to be installed between skylight panel and metal trim.
- C. Substrate: 5/8" exterior structure plywood deck, must match existing substrate.
- D. Hip & Ridge: Shingle Hip & Ridge covers hips and ridges matching shingle material, color, and finish.
1. Hips / Ridges: DECRA Roofing Systems, Inc., DECRA Shingle Hip & Ridge, Aluminum-Zinc Alloy Coated Steel sheet, 26 Gauge, .0179 inches (.455 mm). Pressure formed to match roofing material, color, and finish to be applied along hips and ridges.
 2. Fasteners: Corrosion Resistant Screws: Minimum No. 8, of sufficient length to penetrate substrate 1/2 inch (12.7 mm) minimum, black or color coordinated to match the panels.]
- E. Translucent Panels: Translucent Panels: Polycarbonate translucent panels by Fabral or equal will be installed where the existing fiberglass panels are removed.

2.3 ACCESSORIES

- A. Synthetic Underlayment: Feltex, Deck Armor, Titanium UDL 30 or approved equal.
- B. Perimeter Underlayment: ASTM D 1970; self-adhering, polymer-modified, bituminous sheet underlayment; 40 mils (1 mm) thick. Provide primer when recommended by underlayment manufacturer.
- C. Sealant: One-part elastomeric polyurethane, sealant as recommended in writing by panel manufacturer. Where sealant will be exposed, provide in color to match panels.
1. Standard: ASTM C920-86.
- D. Fasteners: Corrosion resistant screws.
1. Screws: Minimum No. 8, hex head, of sufficient length to penetrate substrate 1/2 inch (12.7 mm) minimum see manufacturer's instructions for fastening positions. Recommended length is 1-1/2 inch (38mm) long.

PART 3 - EXECUTION

3.1 EXAMINATION

- A. Remove all roofing materials including existing shingles, tar paper, flashings, skylights, nails and/or staples and all other related roofing materials.
- B. Examine substrate and conditions for compliance with requirements for maximum moisture content, soundness of roof deck and other conditions affecting performance of DECRA metal roofing. [Damaged, rotted or loose roofing materials shall be removed and the substrate corrected for re-roofing applications]. Proceed with installation only after unsatisfactory conditions have been corrected.

3.2 PREPARATION

- A. Clean substrate of any projections and substances detrimental to metal panel roofing. Cover knotholes or other minor voids in substrate with sheet metal flashing secured with roofing nails.
- B. Remove existing skylight panels and replace with new polycarbonate translucent panels.
- C. Coordinate installation of metal shingles with roof deck, flashing and other adjoining work to ensure proper sequencing. Do not install roofing until vent stacks and other penetrations through roofing have been installed, are securely fastened and flashing is in place.

3.3 INSTALLATION

- A. General: Comply with manufacturer's written instructions for products and applications indicated, unless more stringent requirements apply.
- B. Underlayment: Apply number of plies required by governing code, but at least one ply, with each ply overlapping the ply below at least 3 inches (152 mm) and ends lapped at least 12 inches (457 mm).
 - 1. Omit synthetic underlayment at areas of perimeter underlayment. Lap felt underlayment over perimeter underlayment as recommended by manufacturer, but not less than 2 inches (51 mm).
- C. Perimeter Underlayment: (applicable only with complete tearoff of existing roofing shingles, and to be omitted if existing shingles remain in place) Apply minimum 24 inches (609 mm) wide layer of perimeter underlayment along entire perimeter of surface to receive metal shingles, including at eaves, ridges, edges, skylights, and around projections through roof. Extend perimeter underlayment a minimum of 36 inches (914 mm) inside exterior wall line at edges.]
- D. Drip edge will be installed on all roof plane perimeters.
- E. Shingle Panels: Install DECRA Shingle, accessories, flashing, and hip & ridge level and plumb. Use fasteners per above specifications.
 - 1. Using the recommended offset, the first course of panels lock into the Drip Edge.
 - 2. The second course of panels start at the rake edge, valley or hip with a panel that is 28 inches (711 mm) in length, panel exposure is 25 inches (635 mm), measured from the left side of the panel.
 - 3. Position the panel into the top clip of the panels on the course below. The center of each field panel will be placed directly above the overlap of the panels on the previous course.
 - 4. Make sure the top clips of each panel are flush. The maximum allowable gap should be 3/16 inches (76 mm).
 - 5. Once the panel is in position, firmly push (by hand or foot) on the panel in the area that overlaps the joint of the two panels below. This will help position the panel for fastener placement.
 - 6. After positioning the panel, firmly push (by hand or foot) on the left side of the panel until it is locked firmly into the clip-lock of the panel on the

- course below. Install a fastener in the upper left corner straight down through the panel.
7. Firmly push (by hand or foot) on the right side of the panel and make sure it is locked into the previously installed panel. Install a fastener in the upper right portion of the panel. Placing this fastener at a slight upward angle (45°) will help draw the shingle panel into the proper locking position. Complete the installation with 2 additional fasteners straight down into the panel.
 8. Fasten each panel with minimum [4] fasteners along top edge of panel.
 9. Cut and slot DECRA panels that will terminate at the Rake/Gable Channel or at the Valley in accordance with the manufacturer's instructions.
- F. Hip & Ridge: Install Shingle Hip & Ridge along hips, ridges and rakes as indicated on approved submittals and in accordance with manufacturers written instructions. Bend and fold exposed ends of hips ridges and neatly, cap with an end cap or a piece of similar material.
- 3.4 **CLEANING AND PROTECTION**
- A. Damaged Units: Replace panels and other components of the work that have been dented, damaged or have deteriorated beyond successful repair by finish touchup with acrylic coating and stone chip granules.
 - B. Cleaning: After completing installation, remove any debris from the roof.
 - C. Foot Traffic: Avoid walking on side laps.
4. **WARRANTY** Warranty must be furnished in writing, or printed material. All warranty work will be done by the selling dealer with all warranty work completed within 24 hours of notification of needed work, unless dealer can show justification for extension; mutually agreed upon by the county. Failure to comply with warranty specification will be grounds for disqualification for future bids. No service call, fuel or travel charges will be allowed for warranty repairs.
5. **WAGES:** Wage rates as established and set forth by the State of Wisconsin Department of Workforce Development, in accordance with Chapter 66.0903 of the Wisconsin Statute, shall be paid. **(SEE ATTACHED PDF FILE)**
6. **OWNER MATERIAL PURCHASE LIST:** The Owner will purchase the following materials directly from suppliers thru purchase orders. These items should be included in bid without the 5% sales tax (or county tax if applicable).
- Shingles/underlayment
 - Waterproofing membrane
 - Skylights
7. **TAXES** No State or Federal taxes are to be included in bid.

Bid Instructions

1. BID

- The Village of Kronenwetter is seeking bids for the teardown and replacement of the roofing system of the Municipal Center at 1582 and i-39 Frontage Road, Kronenwetter WI 54455. Estimated square footage is approximately 32,000 square feet but it is the bidder's responsibility to confirm. The bid specifications is attached, to include the following bid instructions:
- Bids must be submitted on or before Monday, October 16, 2023 by 4:30pm in a sealed envelope – addressed to Village of Kronenwetter, 1582 Kronenwetter Drive, Kronenwetter, WI 54455. Mark " VOK MUNICIPAL CENTER ROOF REPAIR & REPLACEMENT PROJECT" on outside of envelope. Bid will be considered good for 30 days unless otherwise indicated and can be received electronically if emailed to lludi@kronenwetter.org
- Please include all factory literature and specification sheets of complete units with bid.

2. BID FORM

- Bid must be on form issued by this office. Important: Incomplete bid form can result in loss of award All available lines on 'Bid Form' MUST BE filled in or failure to do so can result in bid disqualification.

3. BID AWARD

- Award will be made to a single vendor for the entire facility, unless agreed to otherwise. Payment will be made following accepted final installation and certification completion entire roofing system of the facility. Preliminary Procedures: Before requesting inspection for certification completion, the following must be met:
 - A. Show 100 percent completion
 - B. Advise the Owner of pending insurance changeover requirements
 - C. Submit specific warranties, workmanship bonds, maintenance agreements, final certifications, and similar documents.
 - D. Submit maintenance manuals & final record information.
 - E. Complete final cleanup requirements, including touchup painting.
 - F. Touch up and otherwise repair and restore marred, exposed finishes.

October 4, 2023

Note: The Village of Kronenwetter reserves the right to reject any or all bids or parts thereof, to waive any minor informalities in any bis submitted, and to make such award as deemed most advantageous to the Village of Kronenwetter.

Answers to questions regarding the above should be directed:

Leonard Ludi, Director of Public Works 715-693-4200 extension #112 or Pete Wegner, Community Development Director 715-693-4200 extension #113

ESTIMATE

Walk by Faith Roofing and Remodeling
 2932 Creek Valley Ln
 Appleton, WI 54914

james@walkbyfaithroofing.com
 +1 (920) 977-9306
 WWW.WALKBYFAITHROOFING.COM

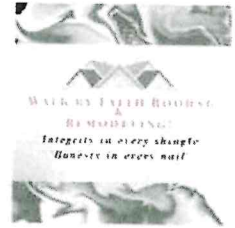

Leonard Ludi

Bill to
 Leonard Ludi
 Village of Kronenwetter
 1582 Kronenwetter Drive
 Kronenwetter, WI 54455 US

Ship to
 Leonard Ludi
 Village of Kronenwetter
 1582 Kronenwetter Drive
 Kronenwetter, WI 54455 US

Estimate details
 Estimate no.: 0088
 Estimate date: 10/15/2023

Material Deposit: 50 percent

Warranty not found in packet.

#	Date	Product or service	SKU	Qty	Rate	Amount
1.		Introduction This estimate contains cost of materials, labor for tear off, disposal and installation of new stone coated steel shingles.		1	\$0.00	\$0.00
2.		Tear off Removal of asphalt shingles, ridge cap, underlayment and current metal edge.--includes disposal		320	\$150.00	\$48,000.00
3.		Check for damaged or weak decking. Replace decking as needed-----10 sheets of 4 ft by 8 ft 7/16 OSB provided---extras will be charged at \$25 per sheet.		1	\$0.00	\$0.00
4.		Metal edge Rake Channel---6.3 Linear Feet per piece		65	\$36.00	\$2,340.00
5.		Metal edge Fascia Starter---		210	\$30.00	\$6,300.00
6.		Install ice and water shield Install a moisture barrier in valleys and rakes----sold per roll		25	\$125.00	\$3,125.00
7.		Install synthetic underlayment Purchased by the roll---		40	\$150.00	\$6,000.00
8.		Install W Valley metal Install W valley metal in valleys---Sold in 10 Linear feet sections		8	\$75.00	\$600.00
9.		DECRA---Shingle XD approximately 6400 stone coated steel shingles----includes fasteners.		350	\$850.00	\$297,500.00
10.		clear silicone sealant		60	\$10.00	\$600.00

sold per tube

11.	Install hip and ridge cap 640 Linear feet	640	\$15.00	\$9,600.00
12.	Valley Cap 6.3 Linear Feet per piece	13	\$40.00	\$520.00
13.	Touch up paint Sold per gallon	5	\$325.00	\$1,625.00
14.	Notice Please note the following---- 1. Gas Furnace and water heater exhaust pipes, if not correctly installed, may become dislodged during roof replacement. We highly recommend the homeowner have these connections checked by their A/C or Plumbing Service professional following new roof installation.		\$0.00	\$0.00
15.	Notice--2 Installing the roof requires nailing through the roof deck. Items such as conduit lines and T.V, Cable or refrigerant lines installed closer than 1 1/2 inches of the underside of roof decking shall be protected from damage by nails and other fasteners. As per the current International Residential/ Commercial building code.		\$0.00	\$0.00
16.	Re-Use all plumbing and pipe vents. Re-use all plumbing and pipe vents. Spray with rust inhibitor.		\$1,000.00	\$1,000.00
17.	Complete and seal Seal all roof penetrations. Remove and dispose of all job related debris. Provide Contractor 5 year roof installation warranty. Provide Material Manufacturers Warranty.		\$0.00	\$0.00
18.	Thank you Thank you for the opportunity to serve your needs.		\$0.00	\$0.00

Total

\$377,210.00

ESTIMATE

Walk by Faith Roofing and Remodeling
 2932 Creek Valley Ln
 Appleton, WI 54914

james@walkbyfaithroofing.com
 +1 (920) 977-9306
 WWW.WALKBYFAITHROOFING.COM



Leonard Ludi

Bill to
 Leonard Ludi
 Village of Kronenwetter
 1582 Kronenwetter Drive
 Kronenwetter, WI 54455 US

Alternate Bid

Ship to
 Leonard Ludi
 Village of Kronenwetter
 1582 Kronenwetter Drive
 Kronenwetter, WI 54455 US

Estimate details

Material Deposit: 50 percent

Estimate no.: 0088
 Estimate date: 10/15/2023
 Expiration date: 11/15/2023

#	Date	Product or service	SKU	Qty	Rate	Amount
1.		Introduction This estimate contains cost of materials, labor for tear off, disposal and installation of new stone coated steel shingles.		1	\$0.00	\$0.00
2.		Tear off Removal of asphalt shingles, ridge cap, underlayment and current metal edge.--includes disposal		320	\$100.00	\$32,000.00
3.		Check for damaged or weak decking. Replace decking as needed-----10 sheets of 4 ft by 8 ft 7/16 OSB provided---extras will be charged at \$25 per sheet.		1	\$0.00	\$0.00
4.		Metal edge Rake Channel---6.3 Linear Feet per piece		65	\$36.00	\$2,340.00
5.		Metal edge Fascia Starter---		210	\$30.00	\$6,300.00
6.		Install Ice and water shield Install a moisture barrier in valleys and rakes----sold per roll		25	\$125.00	\$3,125.00
7.		Install synthetic underlayment Purchased by the roll---			\$150.00	\$6,000.00
8.		Install W Valley metal Install W valley metal in valleys---Sold in 10 Linear feet sections		8	\$75.00	\$600.00
9.		DECRA---Shingle XD approximately 6400 stone coated steel shingles----includes fasteners.		350	\$850.00	\$297,500.00

10.	clear silicone sealant sold per tube	60	\$10.00	\$600.00
11.	Install hip and ridge cap 640 Linear feet		\$15.00	\$9,600.00
12.	Valley Cap 6.3 Linear Feet per piece	13	\$40.00	\$520.00
13.	Touch up paint Sold per gallon	5	\$325.00	\$1,625.00
14.	Notice Please note the following--- 1. Gas Furnace and water heater exhaust pipes, if not correctly installed, may become dislodged during roof replacement. We highly recommend the homeowner have these connections checked by their A/C or Plumbing Service professional following new roof installation.		\$0.00	\$0.00
15.	Notice--2 Installing the roof requires nailing through the roof deck. Items such as conduit lines and T.V, Cable or refrigerant lines installed closer than 1 1/2 inches of the underside of roof decking shall be protected from damage by nails and other fasteners. As per the current International Residential/ Commercial building code.		\$0.00	\$0.00
16.	Re-Use all plumbing and pipe vents. Re-use all plumbing and pipe vents. Spray with rust inhibitor.		\$1,000.00	\$1,000.00
17.	Complete and seal Seal all roof penetrations. Remove and dispose of all job related debris. Provide Contractor 5 year roof installation warranty. Provide Material Manufacturers Warranty.		\$0.00	\$0.00
18.	Thank you Thank you for the opportunity to serve your needs.		\$0.00	\$0.00

Total **\$361,210.00**

Expiry date 11/15/2023

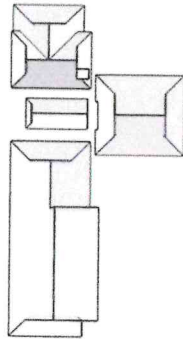

In this 3D model, facets appear as semi-transparent to reveal overhangs.

Building: 1

PREPARED FOR

Contact: James Franklin
 Company: Walk by Faith Roofing and Remodeling
 Address: 2932 W Creek Valley Ln
 Appleton, WI 54914
 Phone: 920-977-9306

TABLE OF CONTENTS

Images1
 Length Diagram4
 Pitch Diagram5
 Area Diagram6
 Notes Diagram.....7
 Penetrations Diagram.....8
 Report Summary.....9

MEASUREMENTS

Total Roof Area =31,129 sq ft
 Total Roof Facets =20
 Predominant Pitch =4/12
 Number of Stories >1
 Total Ridges/Hips =637 ft
 Total Valleys =79 ft
 Total Rakes =381 ft
 Total Eaves =1,306 ft
 Total Penetrations =22
 Total Penetrations Perimeter = 150 ft
 Total Penetrations Area = 72 sq ft

Measurements provided by www.eagleview.com



Certified Accurate

www.eagleview.com/Guarantee.aspx

IMAGES

The following aerial images show different angles of this structure for your reference.

Top View



IMAGES

North Side



South Side



IMAGES

East Side



West Side



LENGTH DIAGRAM

Total Line Lengths:

Ridges = 320 ft
Hips = 317 ft

 Valleys = 79 ft
 Rakes = 381 ft
 Eaves = 1,306 ft

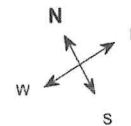
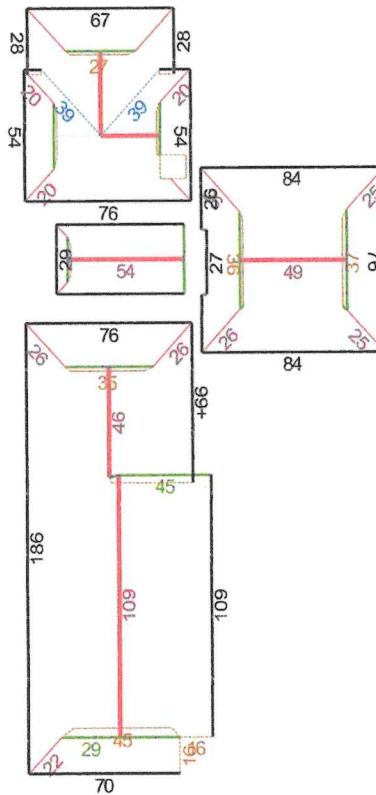
 Flashing = 249 ft
 Step flashing = 171 ft
 Parapets = 0 ft

Note: This diagram contains segment lengths (rounded to the nearest whole number) over 5.0 Feet. In some cases, segment labels have been removed for readability. Plus signs preface some numbers to avoid confusion when rotated (e.g. +6 and +9).

PITCH DIAGRAM

Pitch values are shown in inches per foot, and arrows indicate slope direction. The predominant pitch on this roof is 4/12

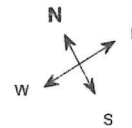
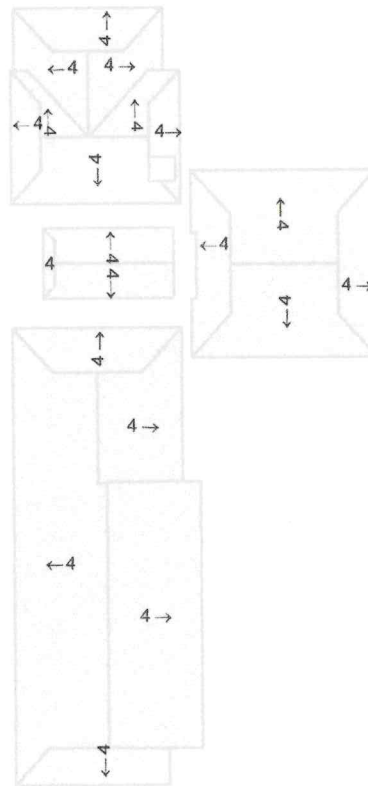

Note: This diagram contains labeled pitches for facet areas larger than 20.0 square feet. In some cases, pitch labels have been removed for readability. Blue shading indicates a pitch of 3/12 and greater.

AREA DIAGRAM

Total Area = 31,129 sq ft, with 20 facets.

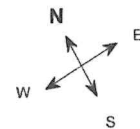
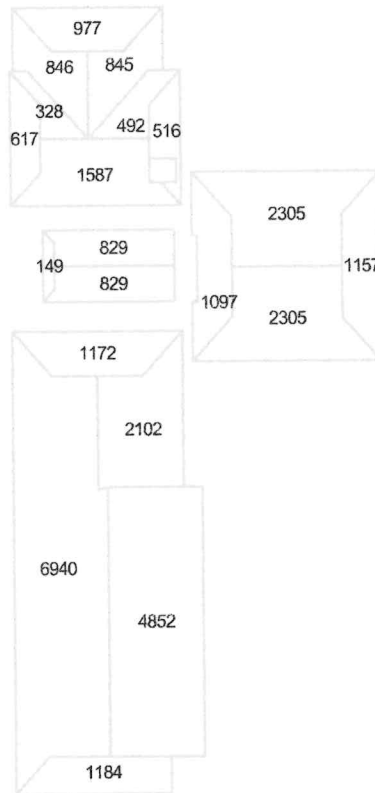

Note: This diagram shows the square feet of each roof facet (rounded to the nearest Foot). The total area in square feet, at the top of this page, is based on the non-rounded values of each roof facet (rounded to the nearest square foot after being totaled).

NOTES DIAGRAM

Roof facets are labeled from smallest to largest (A to Z) for easy reference.

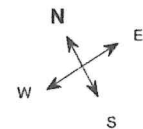
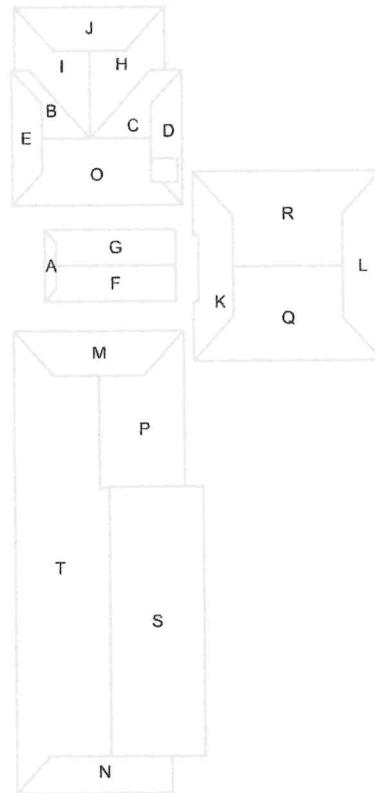

PENETRATIONS NOTES DIAGRAM

Penetrations are labeled from smallest to largest for easy reference.

Total Penetrations = 22

Total Penetrations Perimeter = 150 ft

Total Penetrations Area = 72 sq ft

Total Roof Area Less Penetrations = 31,057 sq ft

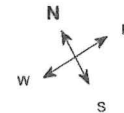
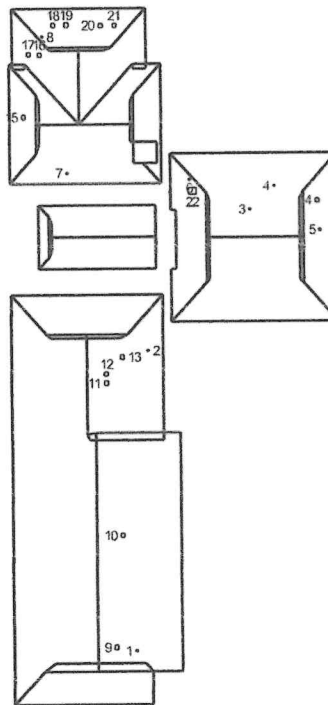

REPORT SUMMARY

All Structures

Areas per Pitch	
Roof Pitches	4/12
Area (sq ft)	31128.8
% of Roof	100%

The table above lists each pitch on this roof and the total area and percent (both rounded) of the roof with that pitch.

Waste Calculation Table							
Waste %	0%	10%	12%	15%	17%	20%	22%
Area (sq ft)	31,129	34241.9	34864.5	35798.4	36420.9	37354.8	37977.4
Squares	311.3	342.4	348.6	358.0	364.2	373.5	379.8

This table shows the total roof area and squares (rounded up to the nearest decimal) based upon different waste percentages. The waste factor is subject to the complexity of the roof, individual roofing techniques and your experience. Please consider this when calculating appropriate waste percentages. Note that only roof area is included in these waste calculations. Additional materials needed for ridge, hip, valley, and starter lengths are not included.

Penetrations	1-8	9-21	22						
Area (sq ft)	1	4	12						
Perimeter (ft)	4	8	14						

Any measured penetration smaller than 3.0x3.0 Feet may need field verification. Accuracy is not guaranteed. The total penetration area is not subtracted from the total roof area.

All Structures Totals

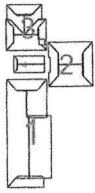

Lengths, Areas and Pitches

Ridges = 320 ft (6 Ridges)
 Hips = 317 ft (15 Hips).
 Valleys = 79 ft (2 Valleys)
 Rakes[†] = 381 ft (24 Rakes)
 Eaves/Starter[‡] = 1,306 ft (22 Eaves)
 Drip Edge (Eaves + Rakes) = 1,687 ft (46 Lengths)
 Parapet Walls = 0 (0 Lengths).
 Flashing = 249 ft (12 Lengths)
 Step flashing = 171 ft (22 Lengths)
 Total Penetrations Area = 72 sq ft
 Total Roof Area Less Penetrations = 31,057 sq ft
 Total Penetrations Perimeter = 150 ft
 Predominant Pitch = 4/12
Total Area (All Pitches) = 31,129 sq ft

Property Location

Longitude = -89.6605102
 Latitude = 44.8244954

Notes

This was ordered as a commercial property. There were no changes to the structure in the past four years.

Total Roof Facets = 20
 Total Penetrations = 22

[†] Rakes are defined as roof edges that are sloped (not level).

[‡] Eaves are defined as roof edges that are not sloped and level.

Measurements by Structure									
Structure	Area (sq ft)	Ridges (ft)	Hips (ft)	Valleys (ft)	Rakes (ft)	Eaves (ft)	Flashing (ft)	Step Flashing (ft)	Parapets (ft)
1	16250	154	74	0	149	507	80	92	0
2	6864	49	103	0	96	322	73	7	0
3	6208	62	124	79	86	330	83	64	0
4	1807	54	15	0	50	146	12	7	0

All values in this table are rounded up to the nearest Foot for each separate structure. Measurement totals displayed elsewhere in this report are added together before rounding which may cause totals to differ.

The table above lists each pitch on this roof and the total area and percent (both rounded) of the roof with that pitch.

Online Maps

Online map of property

http://maps.google.com/maps?f=q&source=s_q&hl=en&geocode=&q=1582+Kronenwetter+Dr,Kronenwetter,WI,54455

Directions from Walk by Faith Roofing and Remodeling to this property

http://maps.google.com/maps?f=d&source=s_d&saddr=2932+W+Creek+Valley+Ln,Appleton,WI,54914&daddr=1582+Kronenwetter+Dr,Kronenwetter,WI,54455

1582 Kronenwetter Dr, Kronenwetter, WI 54455

Report: 52697230

IMPORTANT LEGAL NOTICE AND DISCLAIMER**Notice and Disclaimer**

No Warranty: The Copyrighted Materials are provided to you "as is," and you agree to use it at your own risk.

EagleView Technologies makes no guarantees, representations or warranties of any kind, express or implied, arising by law or otherwise, including but not limited to, content, quality, accuracy, completeness, effectiveness, reliability, fitness for a particular purpose, usefulness, use or results to be obtained from the Copyrighted Materials.

Contractors agree to always conduct a preliminary site survey to verify Roof Report ordered. In the event of an error in a Report, your sole remedy will be a refund of the fees paid by you to obtain this Report.

C&C Services, LLC
PO Box 317
Schofield, WI 54476
(715) 203-3696



October 14, 2023

23-135
Village of Kronenwetter
Attn: Leonard Ludi
1582 I-39 Frontage Road
Kronenwetter, WI 54455

RE: Municipal Center Roof Repair & Replacement Project

To Whom It May Concern:

The undersigned bidder hereby offers, in the amount stated below, to furnish all labor, materials, tools, equipment, apparatus, facilities, transportation and permits for the construction and installation of the roofing systems for the property at 1582 I-39 Frontage Road in Kronenwetter, WI, based on a site visit. C&C Services, LLC hereby agrees to enter contract if this offer is accepted.

TOTAL AMOUNT OF BASE BID: See Schedule

The above amount is the total amount bid for the entire contract work including all applicable taxes. Any alteration, erasure, or change must be clearly indicated and initialed by the bidder.

CLARIFICATIONS:

1. Proposal is based on all work to be performed on a straight time basis.
2. Proposal has not included a budget for engineering cost.
3. Proposal is based strictly on the site visit, and the RFP packet.
4. This proposal includes the use of C&C Services, LLC cranes and lifts.

PROJECT DESCRIPTIONS:

1. The asphalt shingles (1 Layer), underlayment and fasteners from the 1582 I-39 Frontage Road in Kronenwetter, WI will be removed from the building and hauled to a local recycling center in a dumpster trailer.
2. The roof substrate will be inspected for damage or deterioration. If any damage is found, it will be documented and brought to the owner's attention immediately, and a plan will be discussed to correct the damage, changes will be documented via change order.
3. New edge metal will be installed around the perimeter of the roof, eave metal will be installed prior to any underlayment and the rake edge will be installed after the underlayment.
4. New GAF Stormguard™ Ice and Water barrier will be installed two (2) rows up from the eave; and one row (1) in the valleys, around all roof penetrations and along any side wall flashings.
5. New Feltex™ synthetic underlayment will be installed over the entire roof deck including the newly installed ice and water barrier. Membranes will be installed with 1" cap nails according to manufacturer specifications.

C&C Services, LLC
PO Box 317
Schofield, WI 54476
(715) 203-3696



6. New Ultimate Pipe Flashings™ will be installed at each soil stack.
7. New Decra Shingle XD™ panels will be installed, according to manufacturer's specifications.
8. New flashings will be installed.
9. **New Decra Shingle XD Hip** and Ridge panels will be installed at the hips and ridges of the building.

** Existing wall panels will have to be removed, trimmed and reinstalled to accommodate the new Decra Shingle XD system, included in this bid.

Alternate 1: Payment and Performance Bond

1. A Payment and Performance bond can be provided for this project at the cost of 3.5% of total project value.

Alternate 2: Sheeting Replacement

1. Replacement of decking will be subject to owner approval, base price listed below.

TERMS AND CONDITIONS:

Bid Pricing will only be valid for 30 days.

C&C Services, LLC will require a payment of 50% to begin the work, and the remaining balance is due upon completion.

No work outside of the scope of this contract will be performed without the written authorization of the owner or a designated representative.

Terms of payment on this contract are net 30. To cover the interest cost of payroll money, we will add one and a half percent (1.5%) per month to all unpaid invoices.

PLEASE NOTE:

The jobsite will be cleaned thoroughly at the end of each workday, and all work is to be performed in a manner consistent with OSHA guidelines. Also, all demolition will be performed with extreme caution as to protect the owner's property and employees.

Any permits will be acquired by C&C Services, LLC and will be displayed at the jobsite.

C&C Services, LLC will accept the use of all major credit cards; these payments will be subject to a four percent (4%) fee.

C&C Services, LLC
PO Box 317
Schofield, WI 54476
(715) 203-3696



Please indicate your acceptance by signing and returning one copy or by issuing your purchase order referring to this proposal.

Scheduling: This project is expected to take 30 days to complete and can be started within 30 days of contract finalization. This project will receive an official schedule at contract signing / material ordering.

TOTAL AMOUNT OF BASE BID: **See Schedule**

Roof Replacement Base Bid: \$346,500.00

Alternate 1: Add \$12,127.50

Alternate 2: Add \$2.00/SF

Acceptance of this proposal: I hereby accept the above prices, specifications and conditions. I authorize C&C Services, LLC, its employees and sub-contractors to perform the work specified above at the location above. I agree to make the payments as outlined above.

You have the right to cancel this contract with no penalty within 4 days. Cancellation of this contract after will result in the forfeiture of 15% of the value.

ACCEPTANCE:

Village of Kronenwetter
1582 I-39 Frontage Road
Kronenwetter, WI 54455

C&C Services, LLC
PO Box 317
Schofield, WI 54476
(715) 203-3696

(Signature)

(Cody Dement – President)

(Name & Title)

(Date)

October 14, 2023

(Date)

C&C Services, LLC
PO Box 317
Schofield, WI 54476
(715) 203-3696



October 14, 2023

23-135

Village of Kronenwetter
Attn: Leonard Ludi
1582 I-39 Frontage Road
Kronenwetter, WI 54455

RE: Recent Similar Projects

I have put together a list of similar projects (size and scope) for the Villages review in consideration of our bid to replace the Municipal Center's Roof.

Project 1: Pattison State Park, Superior Wisconsin.

This project was offered by the Wisconsin Department of Administration on behalf of the Wisconsin Department of Natural Resources. C&C Services installed a Decra Shake XD roofing system on this project.

Project 2: Mosquito Hill Nature Center, New London Wisconsin.

This project was offered by Outagamie County. C&C Services installed a Decra Shingle XD system on this project.

Project 3: South Fork Suites, UWRF, River Falls Wisconsin.

This project was offered by the Wisconsin Department of Administration on behalf of the University of Wisconsin System. C&C Services installed a Decra Shingle XD system on this project.

Thank you for your consideration,

A handwritten signature in black ink, appearing to read 'Cody Dement', is written over a faint, circular watermark or stamp.

Cody Dement, President
C&C Services, LLC
PO Box 317
Schofield, WI 54476
(715) 203-3696



CERTIFICATE OF LIABILITY INSURANCE

DATE (MM/DD/YYYY)
10/10/2023

THIS CERTIFICATE IS ISSUED AS A MATTER OF INFORMATION ONLY AND CONFERS NO RIGHTS UPON THE CERTIFICATE HOLDER. THIS CERTIFICATE DOES NOT AFFIRMATIVELY OR NEGATIVELY AMEND, EXTEND OR ALTER THE COVERAGE AFFORDED BY THE POLICIES BELOW. THIS CERTIFICATE OF INSURANCE DOES NOT CONSTITUTE A CONTRACT BETWEEN THE ISSUING INSURER(S), AUTHORIZED REPRESENTATIVE OR PRODUCER, AND THE CERTIFICATE HOLDER.

IMPORTANT: If the certificate holder is an ADDITIONAL INSURED, the policy(ies) must have ADDITIONAL INSURED provisions or be endorsed. If SUBROGATION IS WAIVED, subject to the terms and conditions of the policy, certain policies may require an endorsement. A statement on this certificate does not confer rights to the certificate holder in lieu of such endorsement(s).

PRODUCER FEDERATED MUTUAL INSURANCE COMPANY HOME OFFICE: P.O. BOX 328 OWATONNA, MN 55060	CONTACT NAME: CLIENT CONTACT CENTER PHONE (A/C, No, Ext): 888-333-4949 FAX (A/C, No): 507-446-4664 E-MAIL ADDRESS: CLIENTCONTACTCENTER@FEDINS.COM
	INSURERS AFFORDING COVERAGE INSURER A: FEDERATED MUTUAL INSURANCE COMPANY NAIC # 13935 INSURER B: INSURER C: INSURER D: INSURER E: INSURER F:

INSURED: C & C SERVICES, LLC 407-338-3
 PO BOX 317
 SCHOFIELD, WI 54476-0317

COVERAGES CERTIFICATE NUMBER: 6 REVISION NUMBER: 0

THIS IS TO CERTIFY THAT THE POLICIES OF INSURANCE LISTED BELOW HAVE BEEN ISSUED TO THE INSURED NAMED ABOVE FOR THE POLICY PERIOD INDICATED. NOTWITHSTANDING ANY REQUIREMENT, TERM OR CONDITION OF ANY CONTRACT OR OTHER DOCUMENT WITH RESPECT TO WHICH THIS CERTIFICATE MAY BE ISSUED OR MAY PERTAIN, THE INSURANCE AFFORDED BY THE POLICIES DESCRIBED HEREIN IS SUBJECT TO ALL THE TERMS, EXCLUSIONS AND CONDITIONS OF SUCH POLICIES. LIMITS SHOWN MAY HAVE BEEN REDUCED BY PAID CLAIMS.

INSR TYPE	TYPE OF INSURANCE	ADDL INSR	SUBR WVD	POLICY NUMBER	POLICY EFF (MM/DD/YYYY)	POLICY EXP (MM/DD/YYYY)	LIMITS
A	<input checked="" type="checkbox"/> COMMERCIAL GENERAL LIABILITY CLAIMS-MADE <input type="checkbox"/> OCCUR GEN'L AGGREGATE LIMIT APPLIES PER: <input checked="" type="checkbox"/> POLICY <input type="checkbox"/> PROJECT <input type="checkbox"/> LOC OTHER:	N	N	1824735	01/15/2023	01/15/2024	EACH OCCURRENCE \$1,000,000 DAMAGE TO RENTED PREMISES (Ea. Occurrence) \$100,000 MED EXP (Any one person) EXCLUDED PERSONAL & ADV INJURY \$1,000,000 GENERAL AGGREGATE \$2,000,000 PRODUCTS & COMP/OP AGG \$2,000,000
A	AUTOMOBILE LIABILITY <input checked="" type="checkbox"/> ANY AUTO <input type="checkbox"/> OWNED AUTOS ONLY <input type="checkbox"/> SCHEDULED AUTOS <input type="checkbox"/> HIRED AUTOS ONLY <input type="checkbox"/> NON-OWNED AUTOS ONLY	N	N	1824735	01/15/2023	01/15/2024	COMBINED SINGLE LIMIT (Ea. Occurrence) \$1,000,000 BODILY INJURY (Per Person) BODILY INJURY (Per Accident) PROPERTY DAMAGE (Per Accident)
A	<input checked="" type="checkbox"/> UMBRELLA LIAB <input checked="" type="checkbox"/> OCCUR <input type="checkbox"/> EXCESS LIAB <input type="checkbox"/> CLAIMS-MADE OED RETENTION	N	N	1824751	01/15/2023	01/15/2024	EACH OCCURRENCE \$2,000,000 AGGREGATE \$2,000,000
A	WORKERS COMPENSATION AND EMPLOYERS' LIABILITY ANY PROPRIETOR/PARTNER/EXECUTIVE OFFICER/MEMBER EXCLUDED? (Mandatory in NH) If yes, describe under DESCRIPTION OF OPERATIONS below	N/A	N	1824750	01/15/2023	01/15/2024	<input checked="" type="checkbox"/> PER STATUTE <input type="checkbox"/> OTHER E.L EACH ACCIDENT \$500,000 E.L DISEASE EA EMPLOYEE \$500,000 E.L DISEASE POLICY LIMIT \$500,000

DESCRIPTION OF OPERATIONS / LOCATIONS / VEHICLES (ACORD 101, Additional Remarks Schedule, may be attached if more space is required)

CERTIFICATE HOLDER	CANCELLATION
60	SHOULD ANY OF THE ABOVE DESCRIBED POLICIES BE CANCELLED BEFORE THE EXPIRATION DATE THEREOF, NOTICE WILL BE DELIVERED IN ACCORDANCE WITH THE POLICY PROVISIONS. AUTHORIZED REPRESENTATIVE: <i>Nicholas R. Zaver</i>



October 10, 2023

C & C Services, LLC

Re: Owner Project Title: Municipal Center Roof Repair

To whom it may concern,

C & C Services, LLC is an approved contractor and has installed DECRA Roofing Systems previously. Provided the installation is per DECRA's Installation Guide, DECRA will honor the provisions of our Lifetime Limited Warranty.

If you have further questions, please call @ (951) 272-8180 X210.

Sincerely,

A handwritten signature in black ink, appearing to read "David Eldredge".

David Eldredge
Technical and Quality Manager



StormGuard[®] Film-Surfaced Leak Barrier

Help protect your home and roof system from
wind-driven rain and damaging ice dams



- Helps prevent leaks at the most vulnerable areas of your asphalt shingle or metal roofing system
- Reduces the risk of costly repairs due to wall or ceiling staining from leaks
- Meets code requirements where local building codes require the use of leak barriers¹

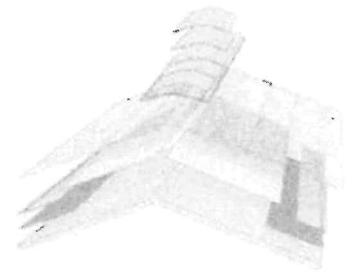

StormGuard® Film-Surfaced Leak Barrier

Benefits:

- **Strong protection** at the eave and rakes, in valleys, and around chimneys and skylights
- **Self-seals** around fasteners to help avoid leaks
- **High-temperature compound** for use with asphalt shingles and most metal roofing systems²
- **Blue synthetic patterned surface** provides excellent wet/dry traction and is cooler to work on (vs. typical black underlayments)
- **Integral surface channels** help guide moisture away from the walking surface
- **Fiberglass-reinforced construction**
- **Eligible for up to a Lifetime limited warranty** when used on Lifetime Shingle roofs³ and it's an eligible component of GAF residential enhanced warranties. It's also covered by up to a 10-year limited warranty⁴ when used with other approved non-asphaltic roof coverings.

In the "North," most building codes require the use of leak barriers at the eaves:⁵

- Protection against ice dams is required by most building codes¹ at the eaves where the January average temperature is 25°F (-4°C) or lower or where there is a possibility of ice forming in the eaves — i.e., areas labeled "North"⁵ (see map)
- Ice dams can still occur in areas where the average temperature is above 25°F (-4°C)
- In warmer/Southern climates, leak barriers provide critical protection against wind-driven rain

Meets or exceeds the following requirements of ASTM D1970

Property	Method	Requirement
Thickness (mils)	D5147	Min. 40
Tensile strength MD (lbf/in)	D2523	Min. 25
Tensile strength CMD (lbf/in)	D2523	Min. 25
Elongation at break, modified bitumen Portion – MD and CMD (%)	D2523	Min. 10
Adhesion to plywood at 75°F (24°C) (lbf/ft-width)	D903	Min. 12
Adhesion to plywood at 40°F (4°C) (lbf/ft-width)	D903	Min. 2
Thermal stability (mm)	D1204	Max. 3
Low temperature flexibility -20°F (-29°C)	D1970	Pass
Tear resistance MD (lbf)	D4073	Min. 20
Tear resistance CMD (lbf)	D4073	Min. 20
Moisture vapor permeance (U.S. perms)	E96 A	Max 0.1
Sealability around nail	D1970	Pass
Waterproof integrity after low temperature flexibility	D1970	Pass
Waterproof integrity of lap seam	D1970	Pass



To learn more about the Lifetime Roofing System visit gaf.com/Lifetime



Product Details:

Nominal Specifications:

For asphalt shingles and most metal roofing systems²

- Roll size: 2 squares (200 ft² [18.58 sq. m]) excludes laps
- Roll width: 36" (0.914 m)
- Roll length: 66.7' (20.33 m)
- High-temp rating: 250°F (121.1°C)²
- UV exposure: Up to 90 days, if necessary
- Shelf life: Best if used within 1 year from date of manufacture

Code Approvals:

- Meets or exceeds the performance criteria of ASTM D1970
- State of Florida approved
- Miami-Dade County Product Control approved
- Component of a UL Listed ANSI/UL 790 Class A system when used with UL Class A shingles⁶
- ICC-ES Evaluation Report (ESR-1322)

¹ Check local building codes for requirements in your area

² The high-temperature compound is suitable for most metal roofing system applications. For use under copper and zinc or for information on other approved non-asphaltic roofing systems, contact GAF Technical Support at 1-800-766-3411.

³ Lifetime refers to the length of warranty coverage provided and means as long as the original individual owner(s) of a single-family detached residence (or eligible second owner(s)) owns the property where the qualifying GAF products are installed. For other owners/structures, Lifetime coverage is not applicable. Lifetime coverage on shingles requires the use of GAF Lifetime Shingles only. Lifetime coverage on shingles and accessories requires the use of any GAF Lifetime Shingle and any 3 qualifying GAF Accessories. See GAF Roofing System Limited Warranty for complete coverage and restrictions. Visit gaf.com/LRS for qualifying GAF products. For installations not eligible for the GAF Roofing System Limited Warranty, see the GAF Shingle & Accessory Limited Warranty.

⁴ See StormGuard® Film-Surfaced Leak Barrier Limited Warranty for Non-Asphaltic Roofing Systems for complete coverage and restrictions.

⁵ Source: International Building Code (IBC) and International Residential Code (IRC)

⁶ Refer to UL Online Certification Directory for actual assemblies



We protect what matters most™



Lifetime Limited Warranty for wind \leq 120 mph and hailstone \leq 2.5 inches penetration 30 year limited warranty on finish

This Limited Warranty is intended to provide the owner of the structure on which DECRA Roofing Systems Inc. (the "Company") roofing panels (the "Panels") are installed certain remedies in the event a manufacturing defect causes the specific damages hereinafter set out. This Limited Warranty is NOT a guarantee of performance.

Please note that all disputes relating to this Limited Warranty must be resolved by mandatory binding arbitration and no claims may be filed on a consolidated or class action basis. Some jurisdictions do not allow for mandatory arbitration, so this requirement may not apply to you. Please see below for further details.

You may return all Panels to the Company's authorized dealer, no later than 30 days after purchase, for a full refund if you are unsatisfied with any of the terms and conditions of this Limited Warranty, provided that such Panels remain in their original and marketable condition and that all Panels purchased for the job are returned.

Remedy in the event of leaks, blow-off or hailstone penetration: In the event the Panels are determined to have a manufacturing defect which (a) directly results in leaks, (b) results in blow off of the Panels by winds of up to 120 mph (193 kph); or (c) results in damage to the Panels caused by the penetration of hailstones of 2.5 inches (6 cm) or less completely through the Panels, the Company will, at its option, either repair or replace the defective Panel(s), provided that the Company's liability will be limited (i) during the first 20 years following the original installation, to the reasonable replacement cost (labor and materials) of the particular defective Panel(s), as determined by the Company; (2) during years 21 through 40 following the original installation, to the reasonable replacement cost (materials only) of the particular defective Panel(s), prorated at 1/600 per month elapsed since the original installation; and (3) for years 41 and beyond, to 20% of the reasonable replacement cost (materials only) of the particular defective Panel(s), as determined by the Company.

Remedy in the event of deterioration of finish: In the event the Panels are determined to have a manufacturing defect which has caused the material deterioration of the Panels such that the appearance of the roof is substantially affected in areas of the roof that are visible from the ground, the Company will, during the first 15 years following the original installation, at its option, either repair or replace the defective Panels, at the Company's cost, including labor costs, as determined by the Company; and thereafter during the next 15 years, the Company's liability will be limited to the reasonable replacement cost (materials only) of the defective Panels only, prorated at 1/360 per month elapsed since the original installation, as determined by the Company. Coverage hereunder will terminate 360 months from the original installation of the Panels. Specifically excluded from coverage is normal weathering and aging, including minor granule loss, as well as deterioration of the finish resulting from improper use, handling and cleaning. Please see Exclusions for further details.

Warranty Period: This Limited Warranty provides coverage to the original owner of the single family detached residential dwelling on which the Panels were originally installed (the "Owner") for the following periods: (1) in respect of coverage for leaks, blow-off and hailstone penetration, for the lifetime of the Owner while the Owner owns the dwelling; and (2) in respect of coverages for the finish, for a period of 30 years from the date of the original installation of the Panels.

The coverage in respect of leaks, blow-off and hailstone penetration for any type of property other than a single family detached residential dwelling shall be 50 years from the date of original installation, and shall be limited to the reasonable replacement cost

(labor and materials) of the particular defective Panel(s) during the first 20 years and during years 21 through 50, to the reasonable replacement cost (materials only) of the particular defective Panel(s), prorated at 1/600 per month elapsed since the original installation.

Transferability; Coverage and Warranty Period on Transfer: The Owner may transfer this Limited Warranty to a subsequent owner of the dwelling during the first twenty (20) years after the Panels' original installation. To be effective, the transfer information (property address, original owner, new owner and a copy of the original proof of purchase) must be mailed to the Company by certified mail at the address noted below within 30 days from the change of ownership. Further transfers or transfers not in compliance with this notice provision will void the warranty.

The coverage extended to such subsequent owner in respect of the finish shall be as set out above.

The coverage extended to such subsequent owner in respect of leaks, blow-off a nd hailstone penetration shall be as set out above for the first 20 years since the original installation of the Panels, but shall thereafter be limited to a 50 year warranty, with the liability of the Company in years 21-50 being limited to the reasonable replacement cost (materials only) of the particular defective Panel(s), prorated at 1/600 per month elapsed since the original installation.

Exclusions: This Limited Warranty does not cover damages arising from any cause or circumstances other than those detailed above, and accordingly causes or circumstances not covered under this Limited Warranty include, but are not necessarily limited to: (a) damage resulting from improper installation, or inadequate roof pitch, or the failure to follow the Company's installation instructions, or failure to follow applicable building codes; (b) damage resulting from defects, movement or subsidence in the structure on which the Panels were installed; (c) damage caused by improper foot traffic, misuse, improper handling or neglect of or on the Panels; (d) damage or change in appearance resulting from application of cleaning solutions, paints or coatings not specifically approved in writing by the Company; (e) shading or discoloration or damage caused by fungus, mold, lichen or algae, or other contaminants; (f) color fading or color changes due to normal weathering and aging, including minor granule loss or (g) damages resulting from modifications or change in design and function of the Panels without the Company's prior written consent.

Claims Procedure: In order to make a valid claim under this Limited Warranty, the claim must be submitted within thirty (30) days from discovery of the facts on which the claim is based. The claim may only be submitted by the Owner and will not be accepted if it does not include the following: (a) name and contact information of the Owner (b) the date of original installation (c) documented proof of purchase, (d) the date of discovery of the damage, and (e) a detailed description of the defect, including the number of affected Panels and photographs. You may be required to supply additional information and samples of the affected Panels, if so requested by the Company. The claim can be submitted via email to claims@decra.com or in writing by certified mail to the address of the Company noted below.

All warranty repair and replacement work will be at the sole discretion of the Company. Decisions on warranty claims will be made only through the Company's Office of Warranty Claims and will be communicated in writing. No other representative of the Company shall have authority to bind the Company in respect of this Warranty, and

50 years Limited Warranty

any oral communications will not be binding on the Company. Work done prior to a submitted claim or not authorized in writing by the Company or by a contractor not chosen by the Company may be subject to denial or limited claim reimbursement.

Limitation of Liability: If the Company elects to replace Panels, the Company will attempt to replace the Panels with Panels of the same color and design, but does not guarantee that such replacement Panels will be available, and accordingly, the Company bears no responsibility for variations in color or appearance by reason of the use of a different color and design, as well as by reason of progressive fading of the remaining Panels. The Limited Warranty term on repaired or replacement Panels will be the remaining term of the original Panels, which commenced on the date of installation of the original Panels, except if otherwise required by law. The reasonable cost of repair or replacement of any defective Panels shall be determined by the Company in its sole discretion. **THE REMEDIES SET OUT IN THIS LIMITED WARRANTY ARE THE OWNER'S SOLE AND EXCLUSIVE REMEDIES, AND THE COMPANY'S OBLIGATIONS CONTAINED IN THIS LIMITED WARRANTY ARE EXPRESSLY IN LIEU OF ANY OTHER OBLIGATIONS, GUARANTEES, WARRANTIES, AND CONDITIONS EXPRESSED OR IMPLIED, INCLUDING ANY IMPLIED WARRANTY OR CONDITION OF MERCHANTABILITY OR FITNESS FOR A PARTICULAR PURPOSE, AND OF ANY OTHER OBLIGATIONS OR LIABILITY ON THE PART OF THE COMPANY. THE COMPANY SHALL IN NO EVENT HAVE ANY LIABILITY FOR INJURY OR DAMAGE TO ANY PROPERTY OR PERSON, LOSS OF BUSINESS OR PROFITS, DIRECT OR INDIRECT ECONOMIC DAMAGES, CONSEQUENTIAL, INCIDENTAL, ECONOMIC, INDIRECT, SPECIAL OR PUNITIVE DAMAGES OR LOSSES OF ANY KIND WHATSOEVER, WHETHER TO THE OWNER OR THIRD PARTIES. THE FOREGOING LIMITATIONS WILL NOT APPLY IN ANY JURISDICTION WHICH DOES NOT ALLOW FOR SUCH LIMITATIONS AS A MATTER OF LAW.**

MANDATORY BINDING ARBITRATION AND WAIVER OF CLASS ACTION: BY PURCHASING THE PANELS, YOU HAVE AGREED THAT EVERY CLAIM, CONTROVERSY OR DISPUTE (EACH AN "ACTION") BETWEEN YOU AND THE COMPANY ARISING OUT OF OR RELATING TO THIS LIMITED WARRANTY OR THE BREACH THEREOF OR RELATING TO THE PANELS SHALL BE SETTLED BY FINAL AND BINDING ARBITRATION. **YOU AND THE COMPANY AGREE THAT ANY ACTION WILL BE ARBITRATED ON AN INDIVIDUAL BASIS AND THAT NO CLAIM(S) WILL BE CONSOLIDATED OR AGGREGATED WITH THE CLAIM(S) OF ANY OTHER PERSON BY CLASS ACTION, CLASS ARBITRATION, IN A REPRESENTATIVE CAPACITY OR OTHERWISE.** TO ARBITRATE AN ACTION AGAINST THE COMPANY, YOU MUST INITIATE THE ARBITRATION, FOR U.S. CLAIMS, IN ACCORDANCE WITH THE FEDERAL ARBITRATION ACT, TO BE CONDUCTED BY A SINGLE ARBITRATOR IN ACCORDANCE WITH THE RULES OF THE AMERICAN ARBITRATION ASSOCIATION, AND FOR CANADIAN CLAIMS, IN ACCORDANCE WITH THE ARBITRATION ACT, R.S.A. 2000, c.A-43, ALBERTA, AS MAY BE AMENDED, AND YOU MUST COMMENCE THE ARBITRATION AND PROVIDE WRITTEN NOTICE TO THE COMPANY BY CERTIFIED MAIL AT THE ADDRESS NOTED BELOW WITHIN THE TIME PERIOD SET OUT BELOW.

IF YOU PREVAIL ON YOUR CLAIMS IN THE ARBITRATION, THE COMPANY WILL REIMBURSE YOU FOR ANY FILING AND ADMINISTRATIVE FEES PAID BY YOU TO THE ARBITRATION ORGANIZATION.

YOU AND THE COMPANY AGREE THAT THE ARBITRATION, ALL PROCEEDINGS THEREUNDER AND THE RULING OR AWARD OF THE ARBITRATOR SHALL BE AND REMAIN CONFIDENTIAL AND SHALL NOT BE DISCLOSED TO ANY THIRD PARTIES. You and the Company acknowledge and agree that a breach of confidentiality by a party may cause irreparable harm to the other party. The party who breaches this confidentiality provision agrees that money damages would not be a sufficient remedy, and that in addition to all other remedies, the non-breaching party shall be entitled to injunctive or other equitable relief as a remedy for any such breach, and the breaching party further agrees to waive any requirement for the securing or posting of any bond in connection with such remedy. In the event of litigation or arbitration relating to this confidentiality provision, if an arbitrator or a court of competent jurisdiction determines that any party has breached this confidentiality provision, such breaching party shall be liable for and shall pay to the other party the reasonable legal fees and other costs incurred by the Disclosing Party in connection with such arbitration or litigation, including any appeal therefrom.

Some jurisdictions do not allow mandatory arbitration, so the above arbitration provision may not apply to you in those jurisdictions. An Action may also be referred to another arbitration organization if you and the Company agree in writing. The Company will not elect arbitration for any Action you file in court in which you agree not to seek to recover more than \$25,000, including attorney's fees and costs, so long as the claim is individual and pending only in that court. You may also reject this arbitration provision by notifying the Company in writing within 45 days of the installation of the Panels or the valid transfer of this Limited Warranty to you. If any portion of this arbitration provision is not enforced in the arbitration, then either you or the Company can file a lawsuit in court to adjudicate the arbitrability of the Action and the enforceability of the portion of the arbitration provision at issue.

ONE YEAR LIMITATION: ACTION FOR BREACH OF THIS LIMITED WARRANTY OR ANY OTHER ACTION AGAINST THE COMPANY ARISING OUT OF OR RELATING TO THE PANELS SHALL **NOT** BE BROUGHT LATER THAN ONE YEAR AFTER ANY CAUSE OF ACTION HAS ACCRUED. IN JURISDICTIONS WHERE STATUTORY CLAIMS OR IMPLIED WARRANTIES AND CONDITIONS CANNOT BE EXCLUDED, ALL SUCH STATUTORY CLAIMS, IMPLIED WARRANTIES AND CONDITIONS AND ALL RIGHTS TO BRING ACTIONS FOR BREACH THEREOF EXPIRE ONE YEAR (OR SUCH LONGER PERIOD OF TIME IF MANDATED BY APPLICABLE LAWS) AFTER THE DATE OF PURCHASE. SOME JURISDICTIONS DO NOT ALLOW LIMITATIONS ON HOW LONG AN IMPLIED WARRANTY OR CONDITION LASTS, SO THE ABOVE LIMITATION MAY NOT APPLY TO YOU.

If any provision of this Limited Warranty if determined by a court of competent jurisdiction to be invalid, void or unenforceable, the remaining provisions shall continue in full force and effect.

This Limited Warranty applies to Panels purchased in the US or Canada on or after September 10, 2020 and supersedes any previously published warranties. The Company may from time to time amend the terms of this Limited Warranty, and the terms and conditions of the Limited Warranty in effect at the time of your purchase of the Panels shall govern your Panels. Dealers and installers of the Panel(s) are not authorized to extend or modify the terms of this Limited Warranty in any manner.



Highest Performance/Lightweight - #30 Felt Replacement



PRODUCT OVERVIEW

FelTex® synthetic roof underlayments is the safest, strongest, and best performing roof underlayment on the market. Woven of heavyweight polymer fabric, FelTex offers superior strength and durability, steep-slope traction, water resistance, a wrinkle free surface and resistance to UV-breakdown. The textured Fiber Claw™ woven fabric surface offers dynamic traction and is ideal for steep slopes in a variety of weather conditions. FelTex is rated for commercial and residential applications using roofing nails (3/8" head), and is an ideal roof underlayment for asphalt shingle, metal, tile, slate, and a variety of other sloped roofing materials.

FEATURES

Safest: Skid-resistant polymer coating underneath and proprietary Fiber Claw™ walking surface offers dynamic steep slope traction.
Hail Rated: FelTex has a Class 4 hail rating (UL 2218) and may help reduce insurance costs.

Strongest: FelTex is designed for high traffic and high winds with the most strength and durability available.

Lighter: FelTex is lighter than #15 or #30 felt and easier to handle during all stages of installation.

Simpler to Apply: FelTex installs quickly and easily. It is lighter, stronger, and covers more area than traditional underlayments.

More Coverage: FelTex offers five times more coverage per roll than Type 30 felt.

Advertise: Bigger and bolder with BROADCAST Custom Print – the easiest way to get leads or earn paid advertising revenue during your project. With Broadcast Custom Print your individual logo, phone number, web address and any other advertisements can be featured on the same roll, with individual images more than 2 feet tall and 10 feet wide. BROADCAST Custom Print offers the largest, most vivid job site advertising in the industry.

Gray Color: Provides a comfortable working surface in all temperatures and an excellent background for your extra large (up to 30" tall/unlimited width) full color custom printed logo, phone number, web site or other advertisement.

Won't Buckle, Warp or Crack: Superior lay-flat properties and water resistance keeps FelTex from wrapping, wrinkling, and cracking in cold weather.

UV Exposure Rating: FelTex is treated to resist excessive degradation from normal UV exposure for up to six months. See published installation guidelines for details.

Meets Building Codes: FelTex is rated for residential and commercial projects.

Asphalt Free: FelTex is 100% inorganic and will not rot or mold.

Sustainable: FelTex is environmentally responsible and may contribute to your LEED and NGBP ratings.

Warranty: Limited Lifetime Warranty.

Visit feltex-underlayment.com for more details.

TYPICAL PHYSICAL PROPERTIES

PROPERTY	TEST METHOD	TYPICAL PROPERTY
Tensile Strength (MD/CD)	ASTM D 882	MD 126/ CD 92
Tear Resistance	ASTM D 4533	MD 41/ CD 37
Rupture Resistance	ASTM D 3462-02 (LBF)	87
Beach Puncture	ICC AC-08	Pass
Long Term Sag	ICC AC-08	Pass
Liquid Water Transmission	ASTM D 4869-02	Pass
Ultra Violet Aging	ICC-ES AC 188	Pass
Accelerated Aging	ICC-ES AC 188	Pass

Test data is based on average results and should not be considered or interpreted as minimum or maximum values. Values are typical data and not limiting specifications.

FELTEX PACKAGE SPECIFICATIONS

- Roll Dimensions 48"x 250'
- Weight per Roll 30 lbs
- Coverage per Roll 10 sq
- Rolls per Pallet 36
- Pallet Weight 1595 lbs

CODE & STANDARD COMPLIANCE

- ICC-ES AC188 (ESR-1293)
- ASTM D226 Type I & II
- ASTM D4869
- CSA A 123.3 Type 1 & 2
- FBC #17873
- Texas Dept. of Insurance (TDI)

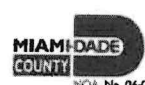

NOA No. 06-0919.01



©2015 System Components Corporation. All rights reserved.
 FelTex is a registered trademark of System Components Corporation.

Phone: 425-392-5150 (West) | 330-528-0255 (East)
 Email: support@systemcomponents.net
 Web: www.systemcomponents.net

System Components Corporation
 P.O. Box 2432
 Issaquah, WA 98027

FelTex® PRODUCT INFORMATION
 LAST UPDATED 6/22/2016

DECRA® Shake XD® & Shingle XD® INSTALLATION GUIDE

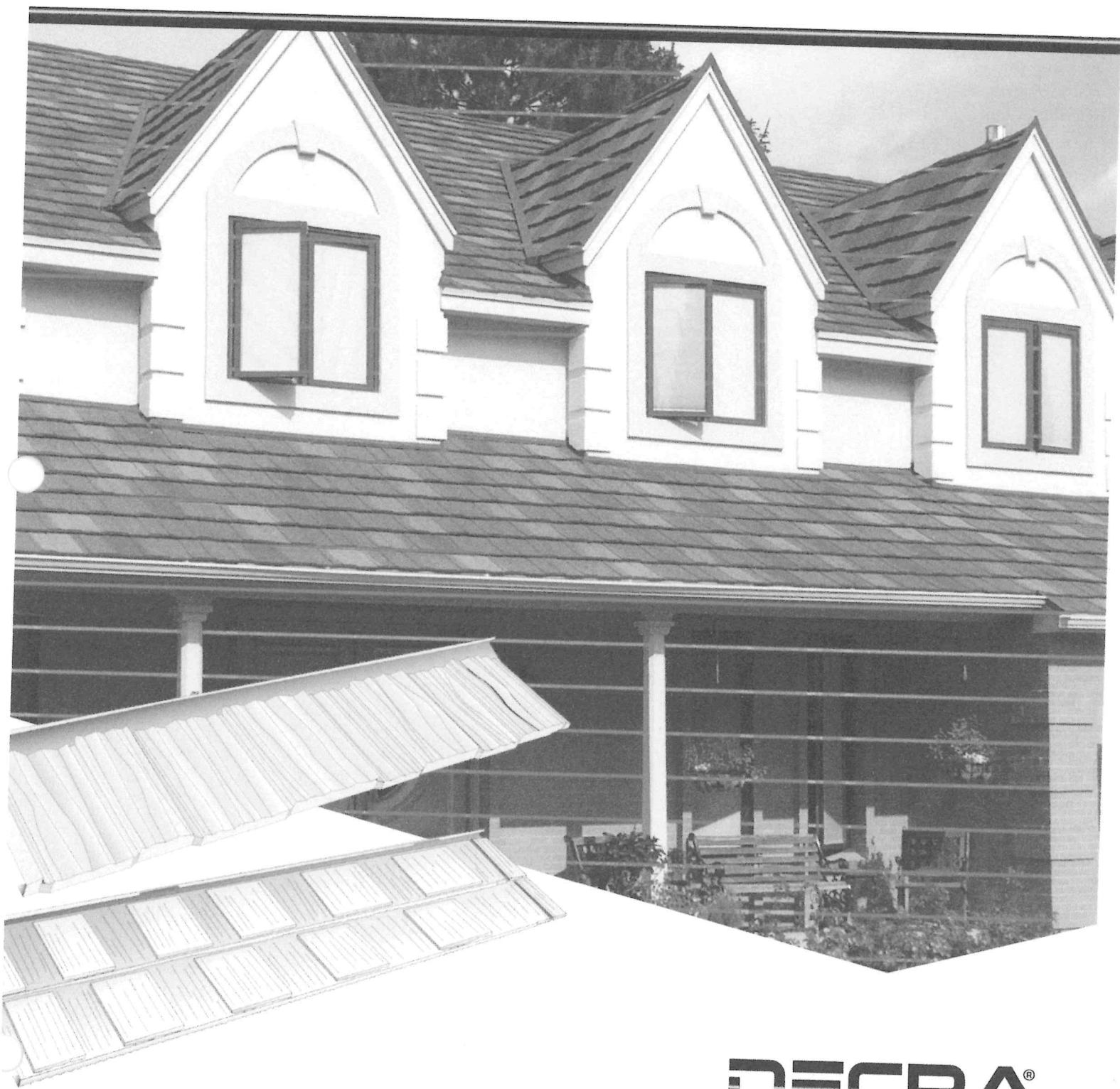

LEARN MORE AT DECRA.COM

DECRA®
METAL ROOFING

Table of Contents

DECRA Shake XD Roof Overview.....	2	Roof Penetration - Pipes & Vents.....	10
DECRA Shingle XD Roof Overview.....	3	Chimneys, Skylights and Dormers.....	11
Introduction.....	4	Panel Layout, Panel Overlap & Fastening...12	
Safety.....	4	<i>Panel Layout</i>	12
Tools.....	4	<i>Panel Overlap</i>	12
Estimating Sheet.....	4	<i>Panel Fastening</i>	13
Codes & Requirements.....	4	Panel Installation.....	14
Roof Slope.....	4	<i>Panels at Rake/Gable, Hips and Valley</i>	14
Underlayment.....	5	<i>Panels at Rake/Gable</i>	14
Deck Preparation.....	5	<i>Panels at Hips</i>	14
<i>New Construction</i>	5	<i>Panels at Valley</i>	14-15
<i>Tear-off (Solid Deck)</i>	5	<i>Installing Small Cut Panels</i>	15
<i>Re-Roof Tear-off (Skip/Space Sheathing)</i>	5	<i>Panels at Ridge</i>	16
<i>Re-Roof Over Asphalt Shingles</i>	5	Venting.....	16
Fasteners.....	5	<i>Panel Vents</i>	16
Venting Preparation.....	5	<i>Ridge Venting - Shake XD</i>	17
Measuring and Cutting Panels.....	5	<i>Ridge Venting - Shingle XD</i>	17
<i>Measuring</i>	5	Hip & Ridge Installation - Shake XD.....	18
<i>Panels</i>	5	Hip & Ridge Installation - Shingle XD.....	19
<i>DECRA Shake XD Panel</i>	6	Alt. Install Method-XD Panel Bend-Ups...	20
<i>DECRA Shingle XD Panel</i>	6	Pitch Change.....	21
Preparation for Panel Installation.....	7	Short Course.....	22
<i>Starter Clip w/ Drip Edge</i>	7	Roof Jacks/Steep Pitch Roof.....	22
<i>XD Rake/Gable Channel</i>	7	High Wind.....	22
<i>Valley</i>	8	Freeze/Thaw.....	22
<i>DECRA Channel (Hips)</i>	8	Foot Traffic.....	22
<i>Roof to Side Wall w/ Side Flashing</i>	9	Sealants.....	22
<i>Roof to Head Wall w/ Side Flashing</i>	9	Cleaning & Repairs.....	22

DECRA Shake XD® Direct-to-Deck

Install Shake XD on roof slopes of 3:12 and greater.

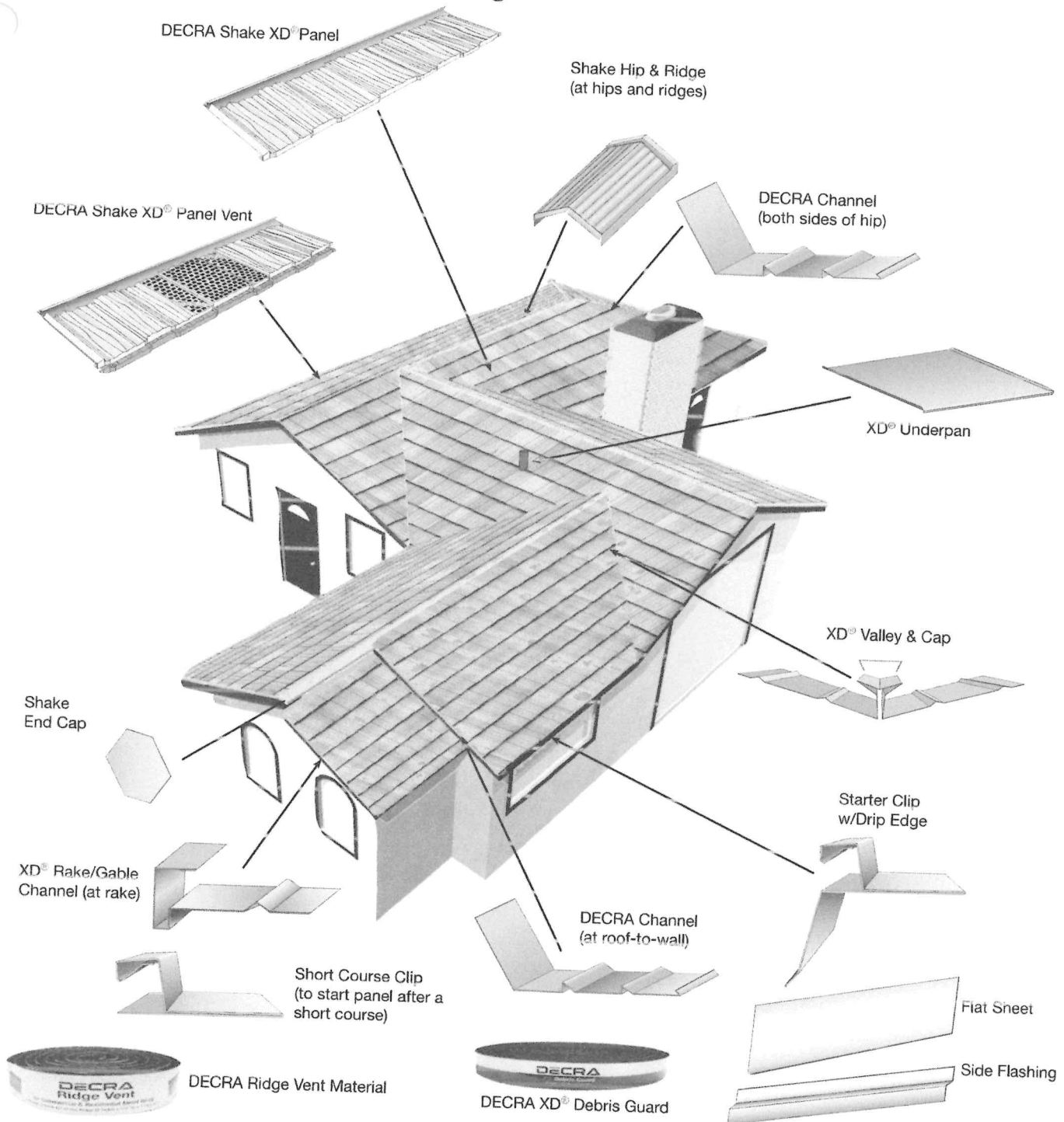

***Use 2 x 2s and / or 1 x 2s at hips and ridges.
Additional build up may be required depending on roof slope.***

DECRA panel vents should be installed on the last full course below the ridge, and no more than 4 feet down from the peak of the roof facet. Panel vents should NOT be used for air intake.

DECRA Shingle XD® Direct-to-Deck

Install Shingle XD on Standard Roof Slopes of 4:12 and greater.

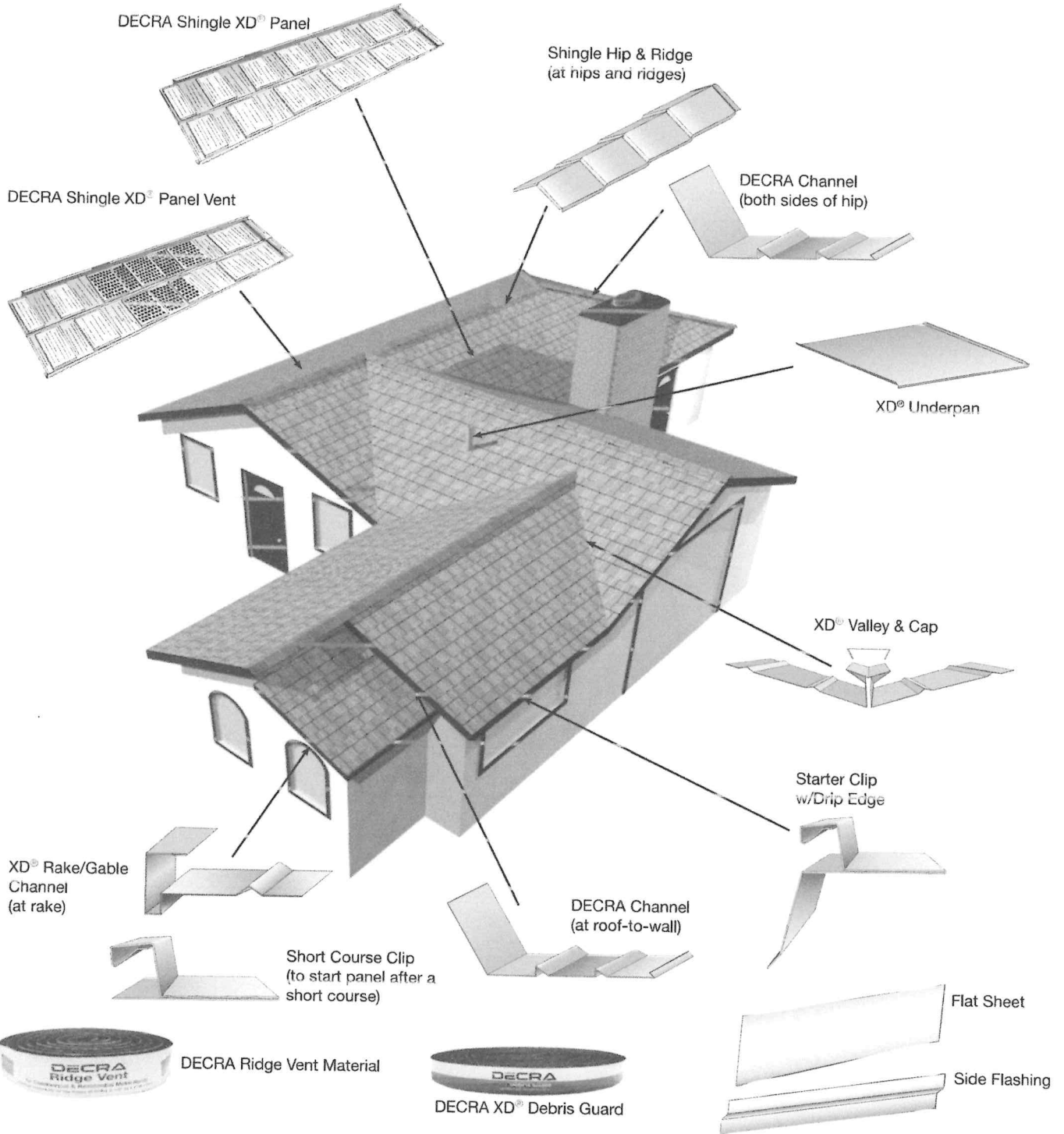

***Use 2 x 2s and / or 1 x 2s at hips and ridges.
Additional build up may be required depending on roof slope.***

DECRA panel vents should be installed on the last full course below the ridge, and no more than 4 feet down from the peak of the roof facet. Panel vents should NOT be used for air intake.

Introduction

The instructions and drawings included here are intended only as a guide for the installation of DECRA Roofing Systems' XD profiles. The materials and methods specified help maintain the overall integrity of the roofing system. These instructions are not intended to address all aspects of roofing installation; a quality installation is ultimately dependent upon the workmanship of the roofing contractor. Information regarding alternative situations not covered in these instructions can be obtained by contacting DECRA Roofing Systems.

Safety

Adhere to recommended safe roofing practices. Wear appropriate clothing and use safety equipment, such as protective eyewear. Light, soft-soled shoes are recommended. Use proper tools and keep the roof clear of debris as you work.

Tools

DECRA panels and components are best cut with tin/aviation snips, a steel roof panel cutter shear, or a power saw with a 'cool cut' metal-cutting blade.

In all cases, wear eye protection!



Cordless Drill



Aviation or Tin Snips



Circular Saw

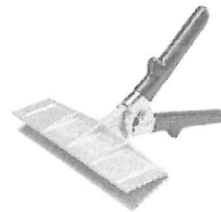

Hand Bender



Table Saw

Estimating Sheet

The DECRA Shake XD and DECRA Shingle XD Estimating Sheets are available at DECRA.com.

Codes & Requirements

Refer to local codes and/or ICC Reports. A link to DECRA ICC reports is available at DECRA.com.

Roof Slope

Install Shake XD on roof slopes of at least 3:12 or install Shingle XD on roof slopes of at least 4:12. Roof slopes less than 3:12 for Shake XD or 4:12 for Shingle XD are considered decorative and panels must be applied over a roof system complying with local codes. Anything below 2:12 should be prohibited even though it is considered decorative.

Underlayment

One layer of Underlayment is required before installing ALL DECRA products in both New Construction and Reroofing applications.

Underlayment shall comply with ASTM D 226, Type I or Type II, ASTM D 4869, Type I or II or ASTM D 1970. Check local code requirements as ice and water shield and additional requirements may apply.

Deck Preparation

The deck must be level and square for proper installation. If it is not, shim to make any adjustments. It is required that a layer of underlayment be used before applying the XD panels.

New Construction: Prepare roof deck to meet local building codes.

Re-Roof Tear-off (Skip/Spaced Sheathing) or Over Asphalt Shingles: If tearing off old roof, clean and prepare deck to meet local building codes.

Panels may be installed over existing asphalt shingle or applied over existing spaced sheathing provided the space between the boards is filled as necessary to provide a base for fastening.

If installed over existing asphalt shingles, cut shingles back from the eaves and rake/gable edges approximately 8" or enough to allow for the Starter Clip w/Drip Edge and XD Rake/Gable Channel to be installed properly. Remove existing hip and ridge material. In situations where code allows re-roofing over 2 layers of asphalt shingles, follow the local code.

Fasteners

Screws: Use a minimum of at least 5 corrosion resistant screws minimum #9 Hex (1/4" hex head) x 1-1/2" long. Use fasteners of sufficient length to penetrate through the sheathing (deck) by at least 1/2". Recommended length is 1-1/2" long. High Wind details, see website.

Venting Preparation

If using DECRA Ridge Vent material, prepare the deck for ridge venting (without center beam) by cutting both sides of the plywood 3/4" from the center of the ridge to expose attic space, or as required by local codes. Refer to Venting section or DECRA Ridge Venting wrapper for additional installation details. If DECRA Panel Vents will be used, *See Panel Installation - Installing Panel Vents and Venting.*

Measuring and Cutting Panels

Measuring: Measurements are made on the roof, however, the panels are normally marked and cut on the ground. Panels may be cut with a table saw or circular saw with a 'cool-cut' metal-cutting blade or tin snips. Cut roof panels and accessories must have residue and all metal shavings completely removed, especially metal shavings on the roof.

Panels: The DECRA panels are formed from corrosion resistant aluminum-zinc alloy coated steel with a protective coating of ceramic coated stone granules that provide an attractive appearance. The Shake XD and Shingle XD stone coated accessory/components are produced in a similar manner. The other accessories/components are also produced in the same manner, but are not stone coated.

DECRA Shake XD® Panel

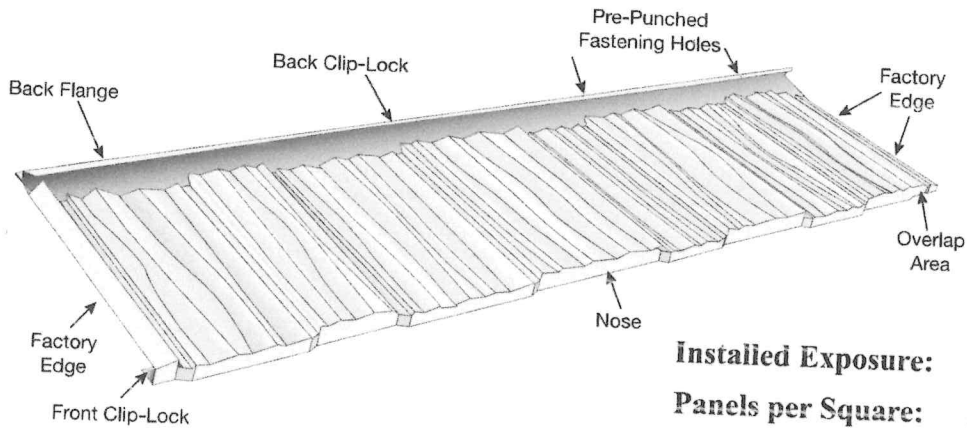

Installed Exposure: 12-3/8" x 49-7/8"

Panels per Square: 23.4

Installed Weight: 150 lbs./square

DECRA Shingle XD® Panel

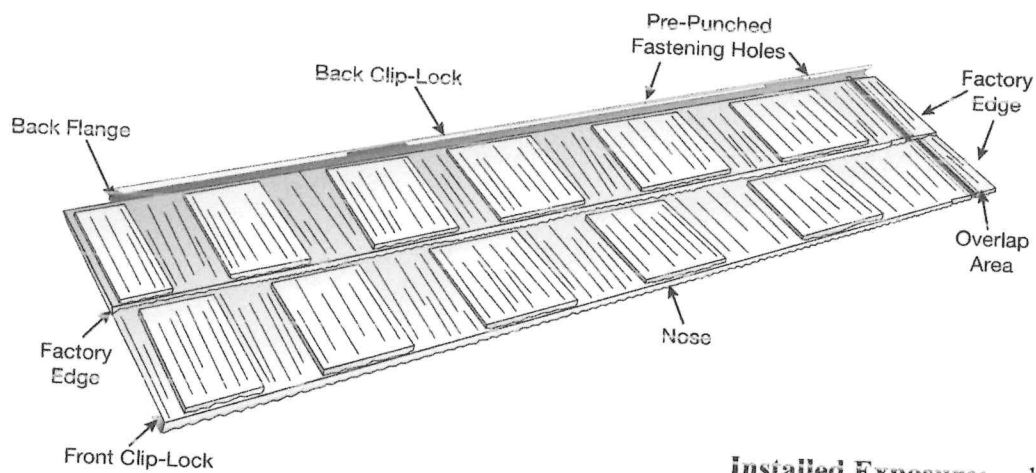

Installed Exposure: 12-1/4" x 49-1/2"

Panels per Square: 23.8

Installed Weight: 150 lbs./square

XD panels are not designed to be installed over irregular surfaces.

Use a random pattern from course to course for best overall appearance.
Avoid creating a pattern with the light or dark color patches unless it is aesthetically pleasing.
Do not rack panels. Do not create a pattern.

***Do not use LEAD or COPPER with this steel roofing system because they are dissimilar metals and are not compatible.
Do not use pressure treated lumber i.e. decking or batten.***

Preparation for Panel Installation

Pre-paint vertical/exposed portion of DECRA Channel, XD Valley and Shake XD or Shingle Rake/Gable Channels as needed prior to installing panels..

Starter Clip with Drip Edge: Use the Starter Clip with Drip Edge along the eaves. Paint along drip edge area of Starter Clip with Drip Edge to match fascia.

Prior to fastening the Starter, cut the top clip where it meets the rake/gable, valley, roof-to-wall and hips to allow for installation of the channels and valley. Cut back the top clip approximately 4" for XD Rake/Gable Channel, 6-1/2" for DECRA Channel at roof-to-wall and hips and cut back clip enough to accommodate XD Valley. All channels and valleys must be installed over the Starter Clip and extend 1" over fascia or onto the panel below.

Notch and overlap Starter pieces 1" when joining two pieces together. Fasteners should be spaced 6" on center. Do not screw through overlap (see diagrams below).

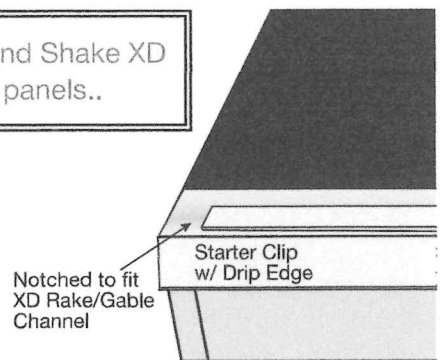

Starter Clip Notching, Cut-Back Top Clip at:

- Rake/gable
- Valley
- Roof-to-wall and hips

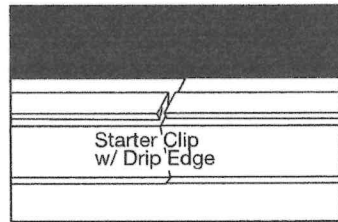
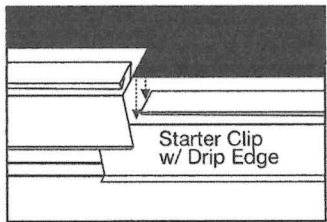
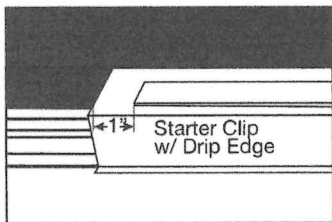

Rake/Gable Channel: Standard metal drip edge should be installed along all rake/gable edges. Position and fasten the XD Rake/Gable Channel directly over the existing drip edge.

Cut the XD Rake/Gable Channel so that it installs over the Starter Clip with Drip Edge and hangs 1" past the eave. Notch and overlap XD Rake/Gable Channel pieces 1-1/2" when joining two pieces together. Notch the top channel to allow it to slide into the lower channel. The top channel should lay on top of the lower channel. Fasteners should be spaced 6" on center. Do not screw through overlap (see diagram).

In areas where debris is present, install DECRA XD Debris Guard prior to installing XD panels. Roll the XD Debris Guard into the XD Rake/Gable Channel. Remove the white paper while unrolling to expose the adhesive dots and press into place.

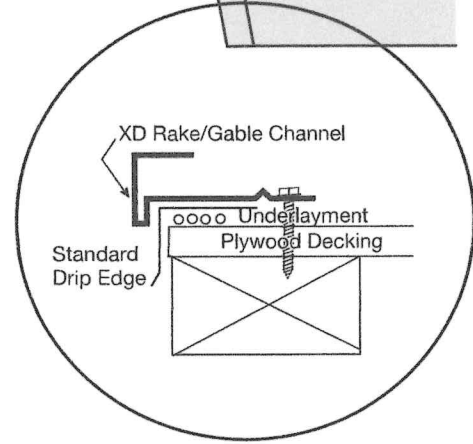
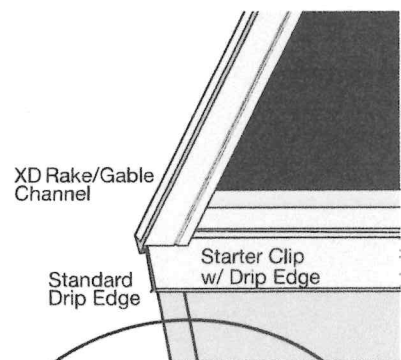

XD Valley: The XD Valley must be positioned along the center line of each valley area. Place the valley so that a minimum 1" runs past the edge of the eave. Continue to install the valley metal overlapping the pieces a minimum of 6". Fasteners should be positioned outside the last turn-up on each side. Finish with Valley Cap. The Valley Cap (stone coated) can be installed by snapping or sliding into place either before or after the valley pieces have been installed. Fasten the first Valley Cap with a stitch screw to Valley at the 1" overhang along eave. Additional Valley Caps will tuck into one another moving up the Valley.

In areas where debris is present, install DECRA XD Debris Guard prior to installing the XD panels. Roll the Debris Guard into both sides of the XD Valley. Remove the white paper while unrolling to expose the adhesive dots and press into place.

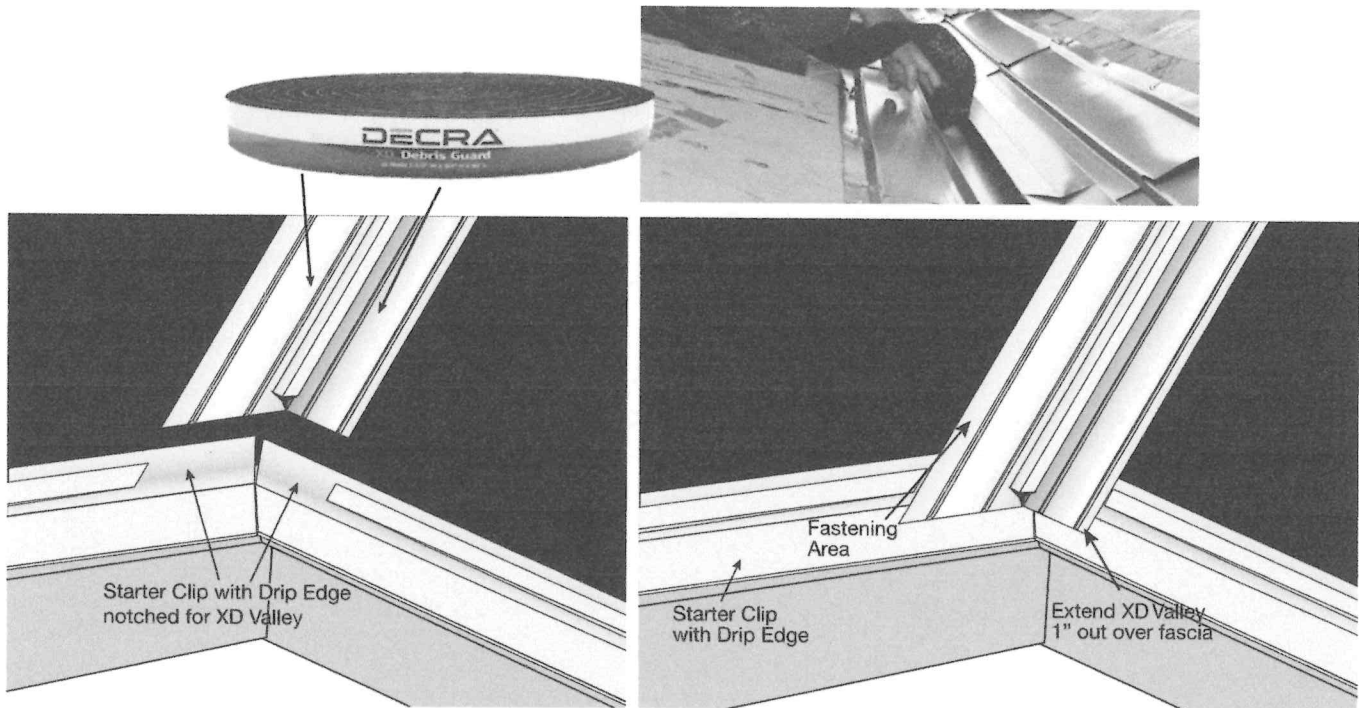

DECRA Channel (Along Both Sides of Hips): Install one 2 x 2 along the center of the hip line. Attach the DECRA Channel on either side of the 2 x 2's. Fasten the DECRA Channel on the outside of the outer bump with fasteners every 12". **Recommendation:** apply roof sealant to fastener heads. Make sure the end of the DECRA Channel extends a minimum of 1" past the eave line. The top of the Starter Clip w/ Drip Edge will also need to be cut back to allow the DECRA Channel to lay flat onto the deck. Overlap Channel pieces a minimum of 6".

Pre-paint visible vertical/exposed portion of DECRA Channel as needed prior to installing panels.

Use 2 x 2s and 1 x 2s as needed at hips. Additional build up may be required depending on roof slope.

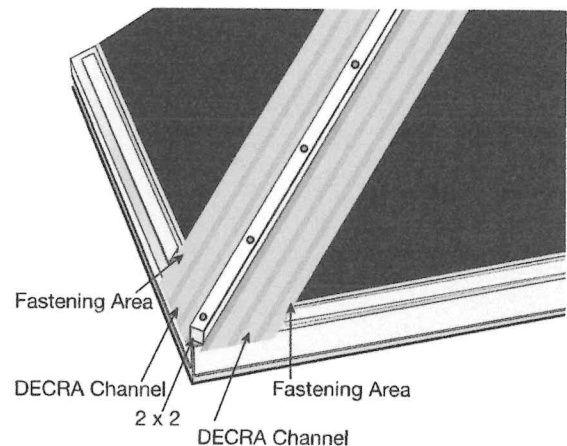

Roof to Side Wall w/Side Flashing: Starting at the eave, extend the DECRA Channel 1" past the eave over the Starter Clip. Work the DECRA Channel behind stucco or wood siding whenever possible or surface mount to the wall for surfaces like brick and seal with wall flashing. Stone coated counter flashing can also be used. Overlap the DECRA Channel at least 6" working up the roof. Screws should be spaced every 12". **Recommendation:** apply roof sealant to the fastener heads.

If standard wall flashing is present, tuck DECRA Channel behind existing flashing. If no existing flashing is present, counter flash with Side Flashing. Seal DECRA Channel to the wall with roofing grade sealant/adhesive. Apply sealant to the Side Flashing before attaching to the wall.

Cut the XD panel to length and fit into the DECRA Channel flashing at the roof-to-wall. Make a 2" notch at the front and back Clip-Locks where the panel fits into the DECRA Channel.

Lock the panel into place and screw down outside the second water channel.

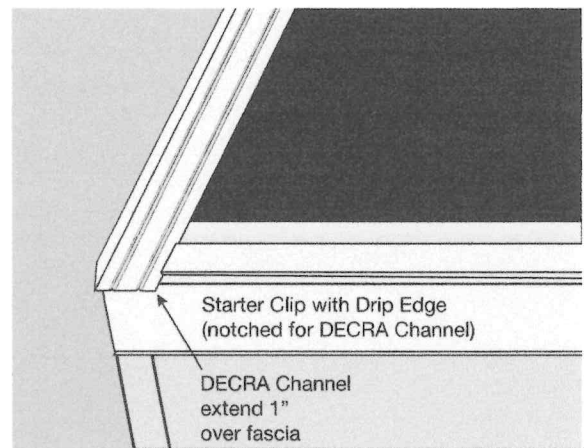
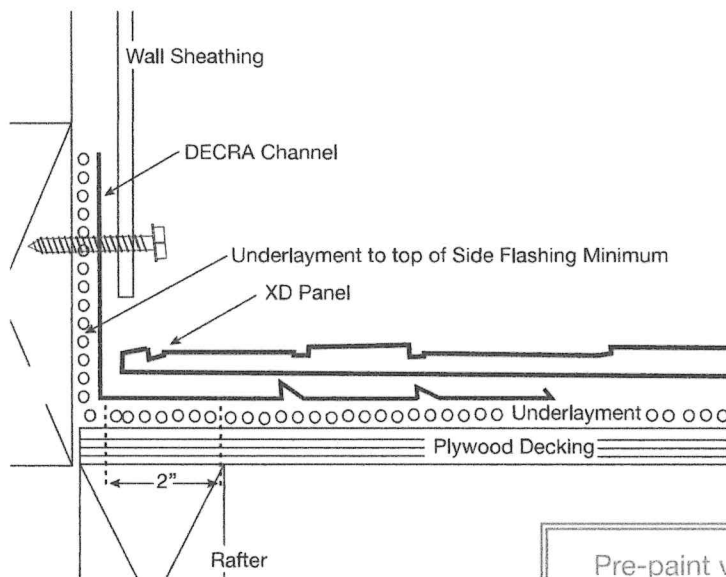

Pre-paint vertical/exposed portion of DECRA Channel as needed prior to installing panels.

Roof to Head Wall: Start by measuring from the full panel below the wall. Cut panels to fit this area allowing for a minimum of a 1" bend up at the top. Using a hand bender, bend each panel up against the head wall and fasten the panel to the head wall.

For brick and stucco, counter flash and seal across the head wall. For siding, tuck the panel metal underneath the siding and seal with roofing grade sealant/adhesive.

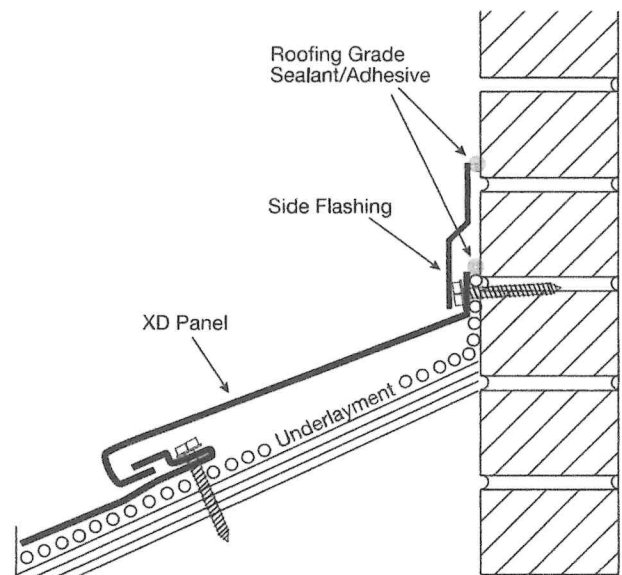

Roof Penetrations – Pipes & Vents

Roof penetrations should be flashed by installing standard roof jacks over a corrosion resistant DECRA Underpan which drains over the panel immediately below or as required by code.

Use the Shingle/XD Underpan to properly flash pipe penetrations. Cut the Underpan to fit tightly around the plumbing stack. The Underpan must fit tight over the lower field panel when positioned around the pipe.

Install the pipe-flashing apron so it fits onto the Underpan. Apply roofing grade sealant/adhesive on top and both sides. Finish with field panel by measuring and cutting panel to fit tight around pipe flashing. Make a 2" wide notch along the front Clip-Lock of the XD panel covering the jack.

Cut hole in panel according to flashing profile. Align roofing panel and seal around base using a roofing grade sealant/adhesive and finish with Touch-Up Kit.

Care should be taken to adequately weatherproof the flashings and to support them with additional blocking or roof framing as necessary.

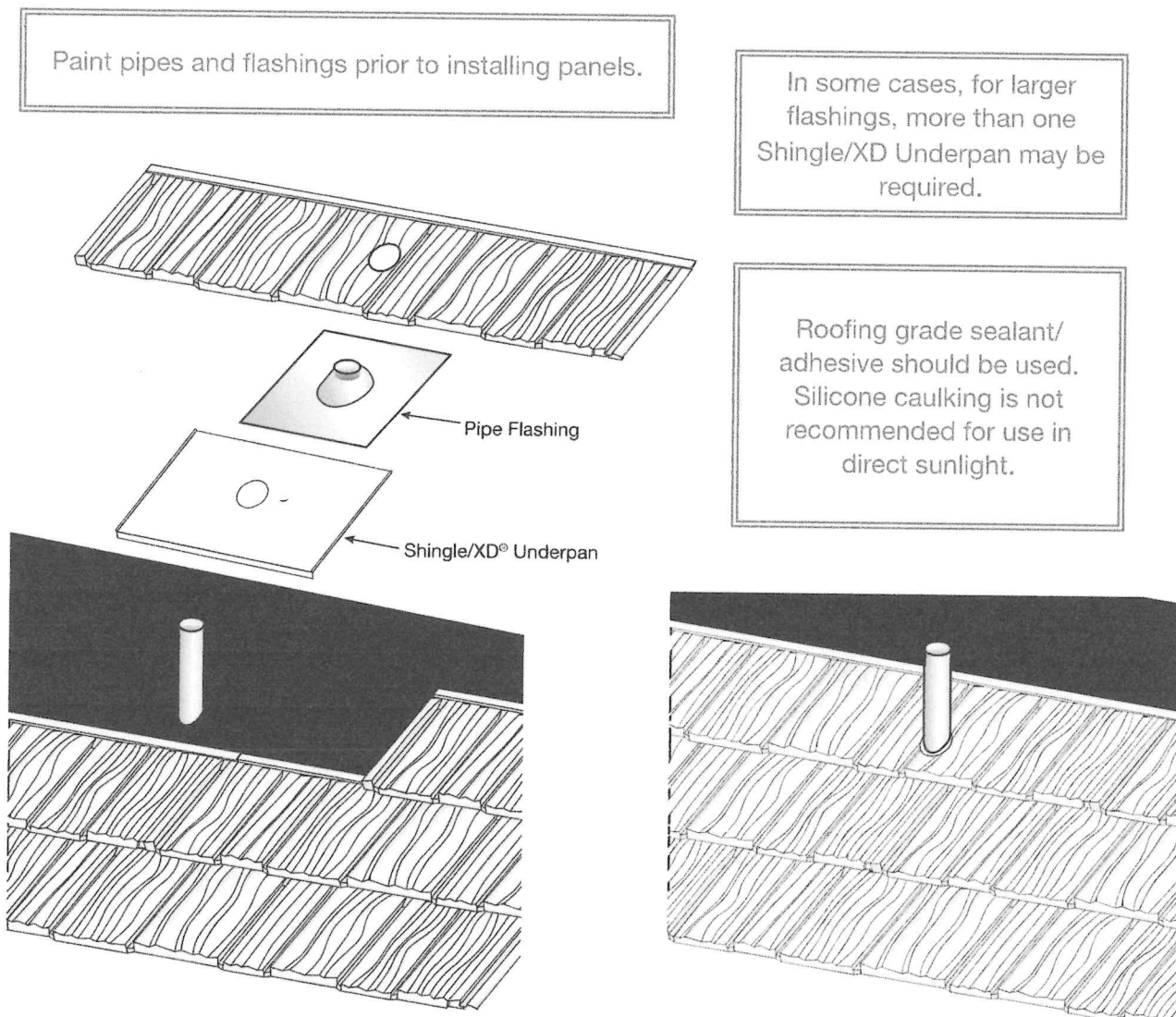

Do not use LEAD or COPPER with this steel roofing system.

Chimneys, Skylights & Dormers

The following steps detail the procedure for installation around a chimney, skylight or dormer. Run full panels up to the bottom of the penetration. All the open areas will be filled in with cut panels.

1 Start by measuring from the full panel below the chimney. Cut panels to fit this area and install like at roof to head wall. *See Roof to Head Wall.*

2 **3** Use the DECRA Channel along the left and right of the chimney and counter flash with Side Flashing. Extend the DECRA Channel 2-3" out over the top of the first panel below the chimney. *See Roof to Side Wall*

Panels to fit the left and right sides of the chimney will be measured, cut and fit into the DECRA Channel, similar to the roof to side wall. Be sure to notch out the top and bottom clip as was done for the Roof to Side Wall detail. *See Roof to Side Wall.*

4 The area directly above the chimney must be flashed and counter flashed. Measure the width of the chimney. Use a chimney saddle (**do not use lead or copper**) or a piece of flat metal can be cut and bent to fit around the chimney. Cut, conform and install the chimney saddle to fit above the chimney.

In the case of a cricket above the chimney, finish like valley. *See Valley.*

Next, cut a piece of the Short Course Clip to fit the length of the top of the chimney with an added 6" on either side. Attach the Short Course Clip on either side of the top of the chimney so the clip will allow the XD panel to engage into the clip as close to the top of the chimney as possible.

For brick and stucco, counter flash over the top of the chimney saddle. For siding, tuck the chimney saddle up under the siding. Use closure foam to fill gaps as needed (see diagram above).

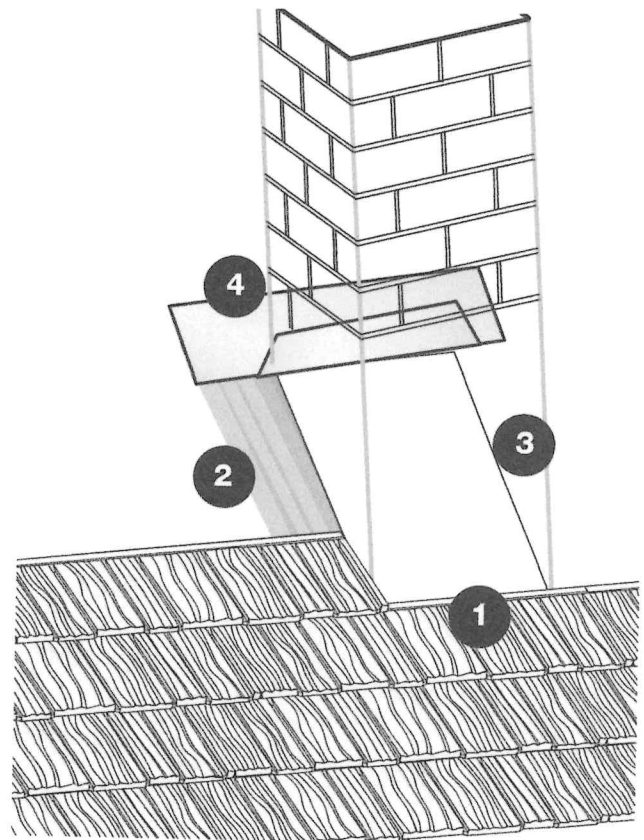
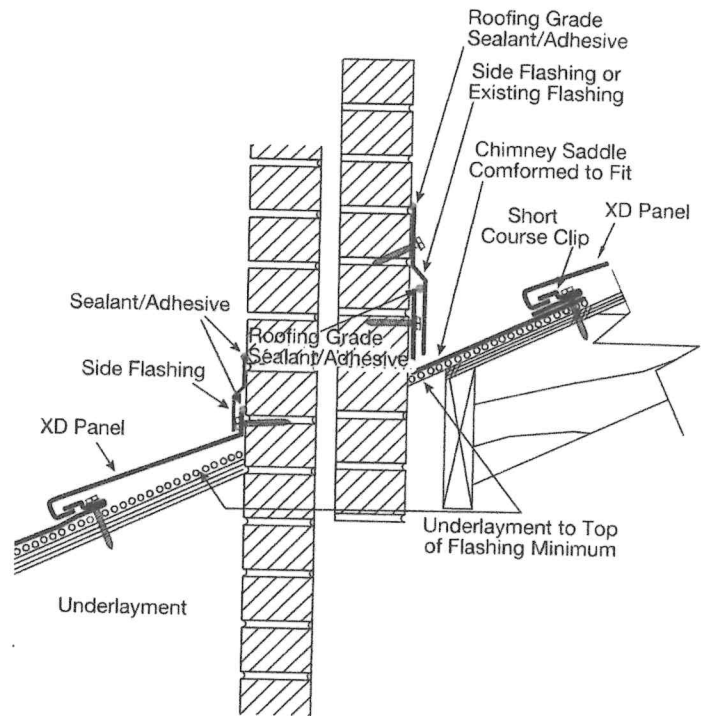

Panel Layout, Panel Overlap & Fastening

Panel Layout: XD Panels (Shake XD and Shingle XD) install left to right. For first course, start with a full panel at the left side rake edge, valley or hip and continue with full panels locking them into the Starter Clip w/ Drip Edge. For second and subsequent courses, randomly install panels. **Do not create a pattern.** All subsequent courses of panels simply lock into place by sliding the nose of each panel onto the clip that is formed at the top back edge of each panel in the row below.

The side of each panel must be pushed into position to engage the Side-Lap locking mechanism.

Install the 4 screws into the predrilled fastening positions on the left of the panel leaving the 5th fastening position, on the far right of the panel, without a fastener. Properly lap the next panel to the right of the panel and insert at least one fastener. Now go back and insert the fifth fastener in the panel to the left.

Panel Overlap:

Shake XD: Shake XD panels overlap 2-1/2". Ensure that top left corner of installing panel is butted up tight into upper clip of installed panel. Do not install the last screw on the far right until the next panel has been properly lapped and at least one screw attached.

Shake XD Panel Overlap:

DECRA Shake XD Panels install from LEFT to RIGHT. Install panels randomly, staggering sidelaps. Avoid creating a pattern with the light or dark color areas unless it is aesthetically pleasing.

Panels install left to right. The installing panel (on right) will overlap the installed panel (on left).

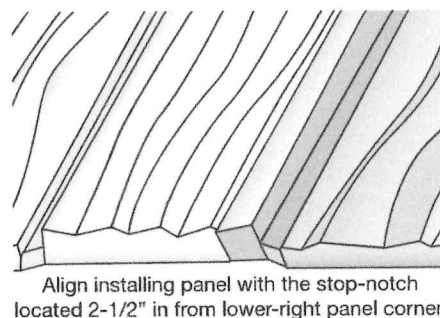
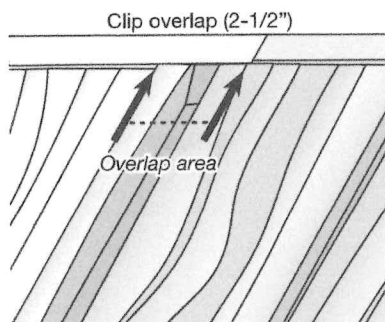
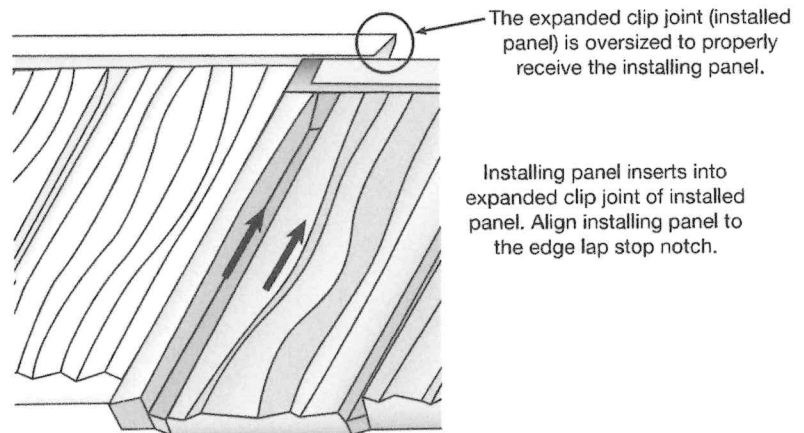
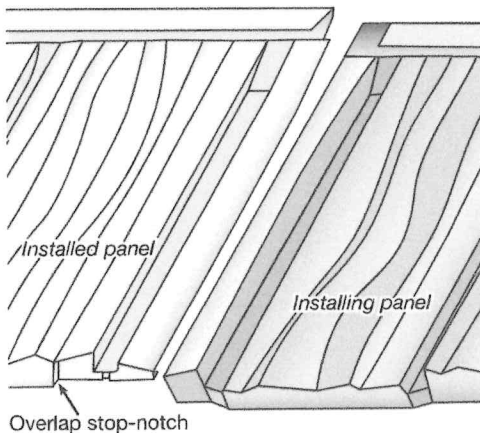

Shingle XD Panel Overlap:

Shingle XD: There should not be a gap between Shingle XD panels. Do not install the last screw on the far right until the next panel has been properly lapped and at least one screw attached.

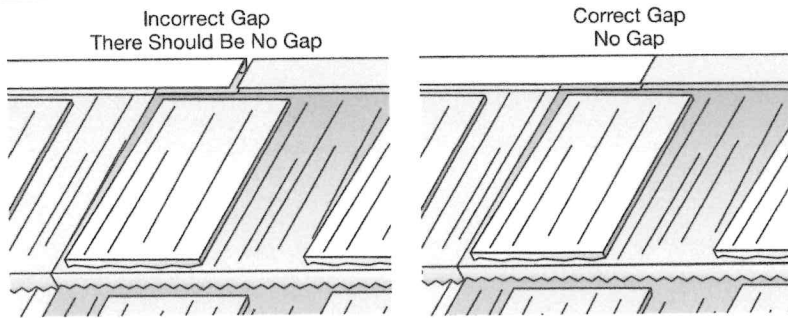

DECRA Shingle XD Panels install from LEFT to RIGHT. Install panels randomly, staggering sidelaps. Avoid creating a pattern with the light or dark color patches unless it is aesthetically pleasing.

Panel Fastening: Install the four screws on the left side of the panel first, then lay the next panel to the right overlapping the panel to the left. Install at least one screw into the panel on the left prior to installing the fifth screw into the right side of the panel (*see diagrams below*).

Shake XD Panel Fastening:

FASTENERS:

Shake XD Panels - Min #9 Hex (1/4" hex head) x 1-1/2" long Corrosion Resistant Screws

Shake Hip & Ridge - Min #9 Hex (1/4" hex head) x 1-1/2" long Corrosion Resistant Screws
(color coordinated)

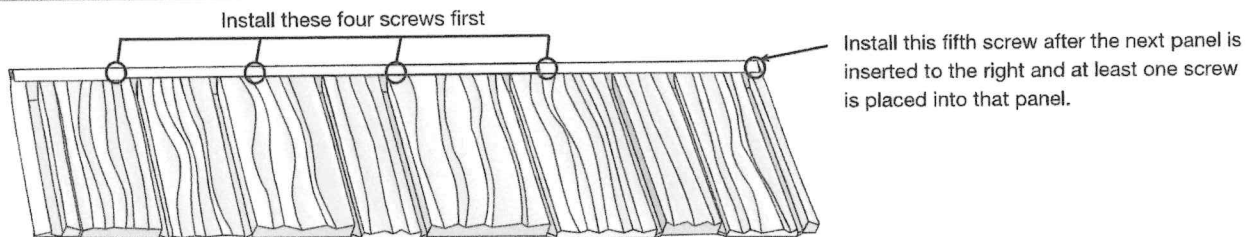

Shingle XD Panel Fastening:

FASTENERS:

Shingle XD Panels - Min #9 Hex (1/4" hex head) x 1-1/2" long Corrosion Resistant Screws

Shingle Hip & Ridge - Min #9 Hex (1/4" hex head) x 1-1/2" long Corrosion Resistant Screws

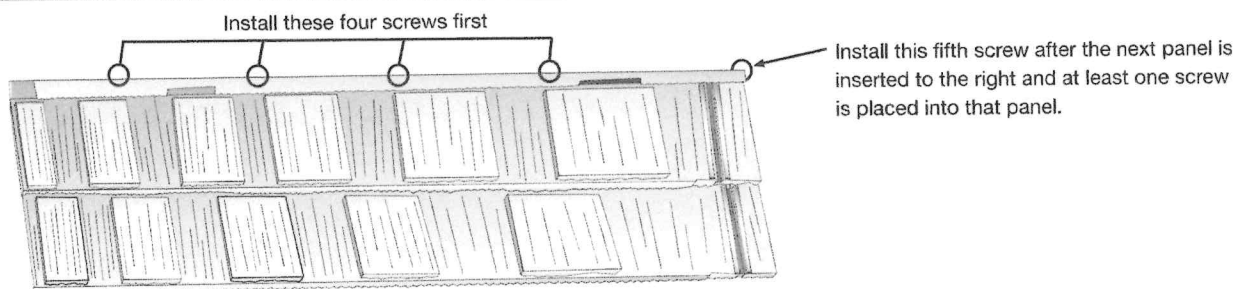

Panel Installation

Panels at Rake/Gable, Hips and Valley:

Where the panels fit into the Shake XD or Shingle Rake/Gable Channel, DECRA Channel or XD Valley, proper drainage will be attained by removing a portion of the front and back Clip-Locks on each XD Panel as noted below. Panels should be installed from left to right starting to the left of the Rake/Gable Channel, XD Valley or DECRA Channel. Cut and fit panels into Rake/Gable Channel, XD Valley or DECRA Channel as needed to create random stagger.

Panels at Rake/Gable: Where the XD panels fit into the XD or Rake/Gable Channel, proper drainage will be attained by removing 2" from the front and back Clip-Locks on each panel. Make a 2" notch at the front and back Clip-Locks where the panel fits into the DECRA Channel. Lock the panel into place and screw down.

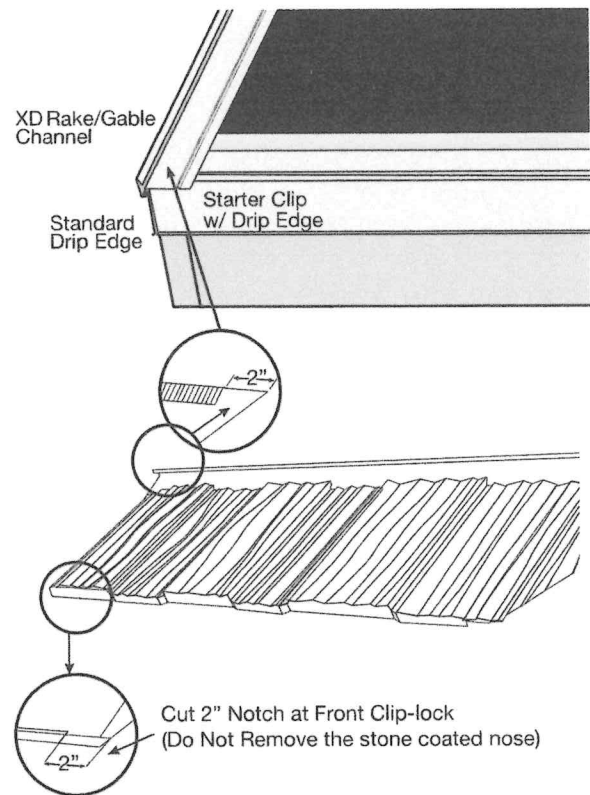

Do not fasten panels into the inner-water channel on the Rake/Gable Channel, DECRA Channel or XD Valley.

Panels at Hips: Along both sides of the hips, cut XD Panels to fit into the DECRA Channel. Make a 2" notch at the front and back Clip-Locks where the panel fits into the DECRA Channel. Lock the panel into place and screw down.

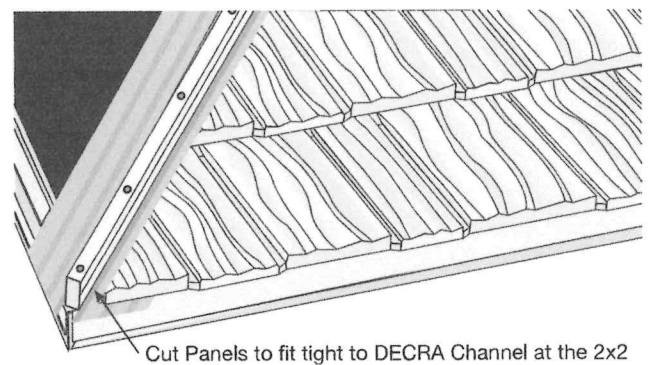

Alternative Installation Method for Panels at Hips, Rakes/Gables and Sidewalls on pg. 20

Panels at Valley: At the XD Valley, cut panels to length and make a 4" notch at the front and back Clip-Locks where the panels fit into the Valley piece.

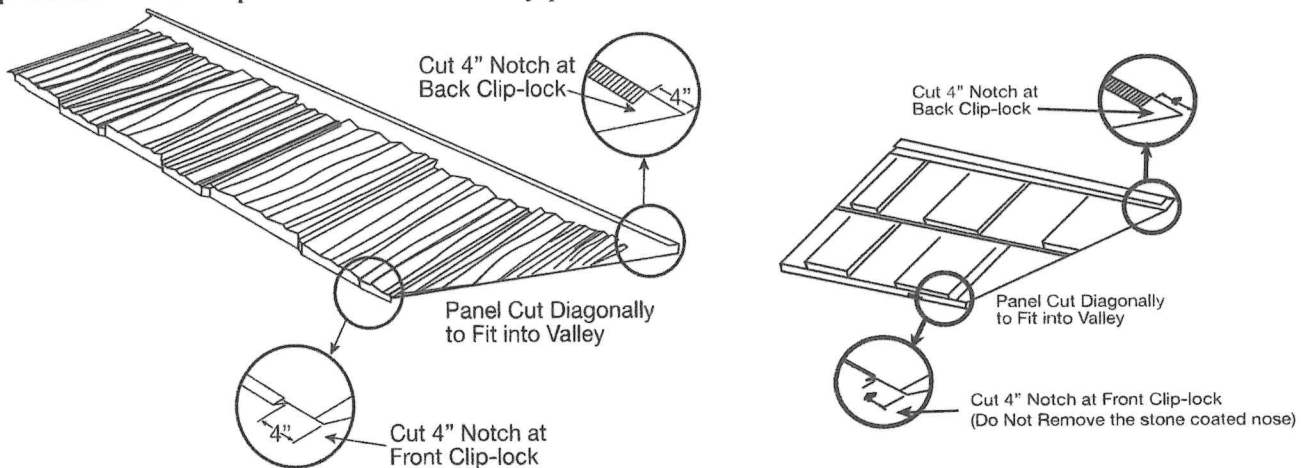

Do not remove the stone coated nose.

Panels at Valley (con't):

Shake XD - Use XD Valley & Cap

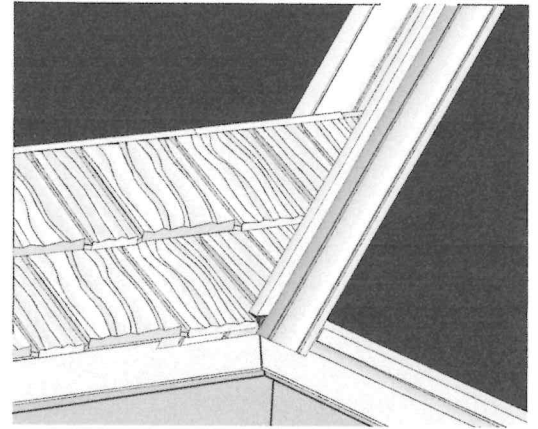
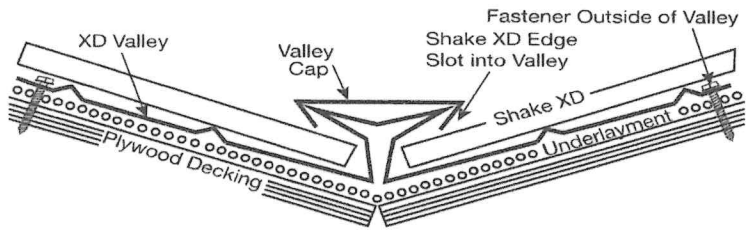

Shingle XD - Use XD Valley & Cap

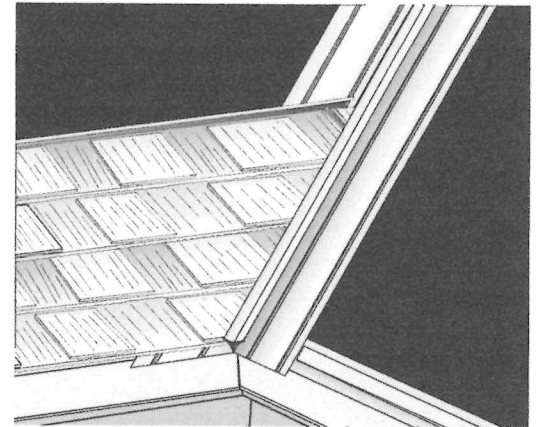
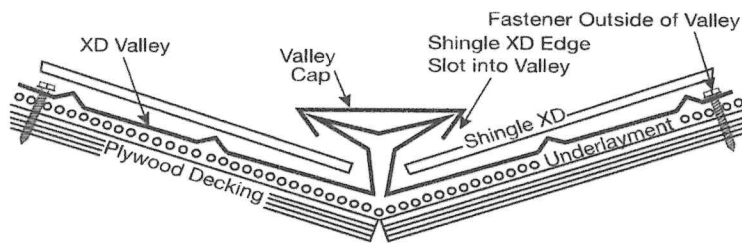

Installing Small Cut Panels: In this situation, cut the last full panel down to 29" to allow you to finish the course run with a longer panel. On the 29" panel, you must use the factory left edge as shown in the diagram below. **For Shingle XD:** on the 29" left panel that has just been shortened, cut out the right side bottom clip 2-1/2". Install the right side panel into the left panel clip as is normally done. **For Shake XD:** on the 29" left panel that has just been shortened, cut the right side bottom clip 2-1/2". An additional 2" cut must be made to the right side top clip lock on the 29" panel to allow the panel clip locks to butt together and form the overlap joint. Install the right side panel into the left panel clip as is normally done.

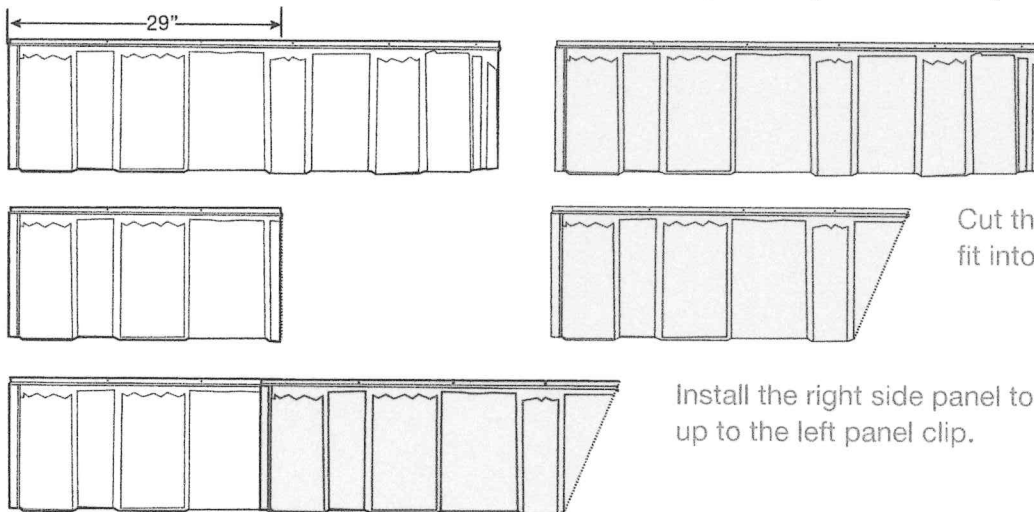

Cut the right side panel to fit into valley, hip or rake.

Install the right side panel to butt up to the left panel clip.

Panels at Closed Ridge: Install XD panels up to the top of the ridge, cutting off excess panel that extends higher than the ridge. Use fasteners to attach panels 1" below the ridge line. On the other side of the ridge, run the top panel 2" past the top of the ridge line. Attach panel with fasteners 1" below the ridge line. Use a heavy hammer or mallet to fold and overlap the extra 2" down over the top of the ridge onto the opposite panel.

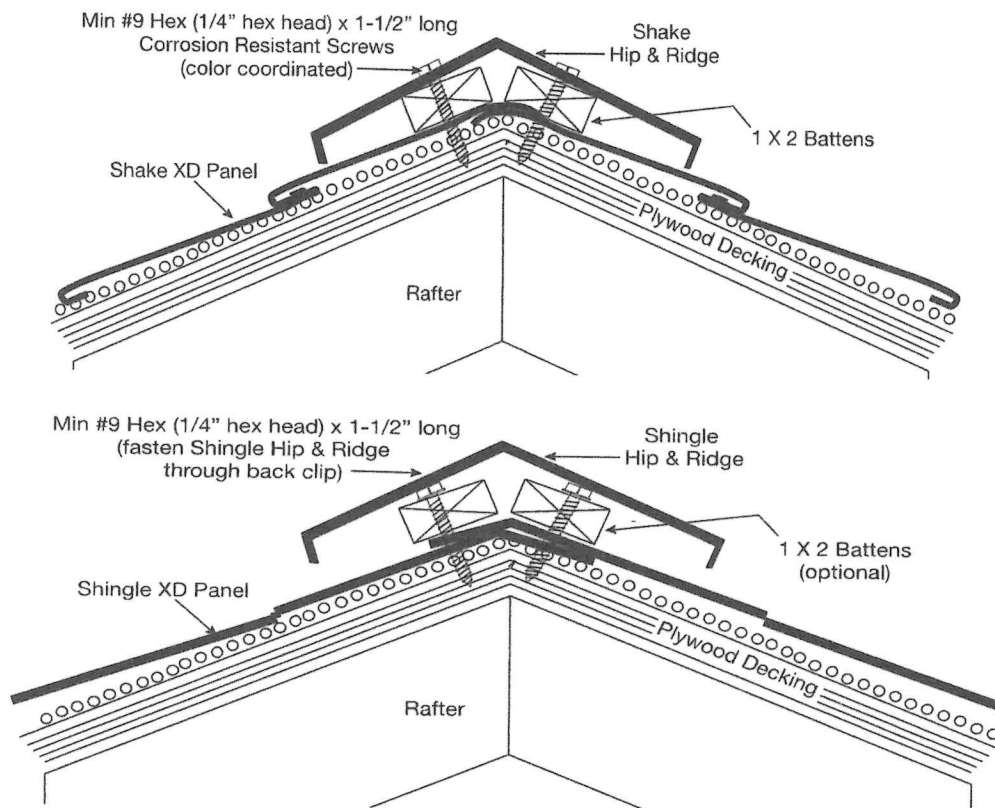

Venting

Panel Vents: If DECRA Panel Vents will be used, calculate the number of Panel Vents and select the proper location for each Panel Vent. Install DECRA panels up to Panel Vent location. Install the XD panel vent per the DECRA Roof Panel Vent Installation Guide found inside the panel vent carton, or available at DECRA.com.

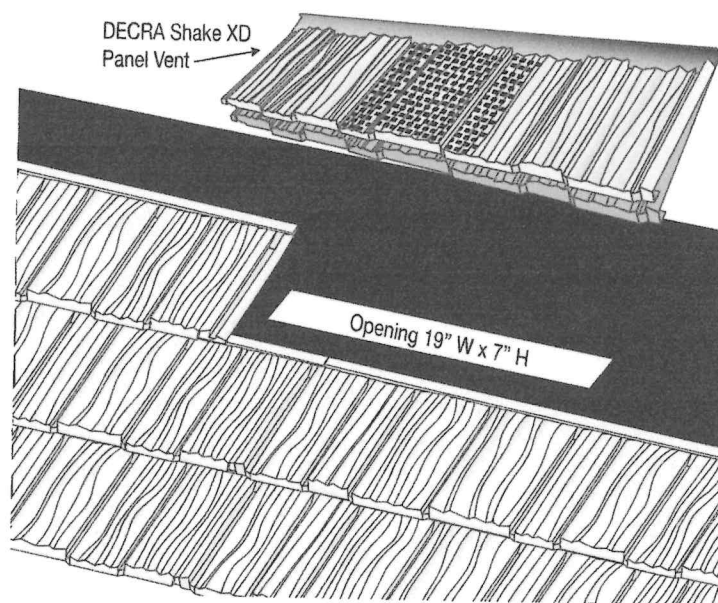

DECRA panel vents should be installed on the last full course below the ridge, and no more than 4 feet down from the peak of the roof facet. Panel vents should NOT be used for air intake.

Ridge Venting - Shake XD: Install Shake XD panels up the last full course before the ridge to the edge of the opening that has been cut for the ridge vent. Install 2 x 2 wood battens along the ridge. Ridge vent can also be installed with stacked 2 x 2's on the center ridge beam. Please see our website for alternative installation details. Align the top edge of the 2 x 2 along the edge of the plywood on both sides of the ridge to expose the attic opening. Measure, cut, bend, and install the final course of panels. Roll out the vent material along the tops of the battens. Remove the white paper while unrolling to expose the adhesive dots. Apply pressure over the adhesive dots to hold the material in place during installation (see diagram below).

Install Shake Hip & Ridge pieces over the vent material. Fasten the screws through the vent material into the battens. See *Hip & Ridge Install at Hips & Ridges for Shake Hip & Ridge Installation*.

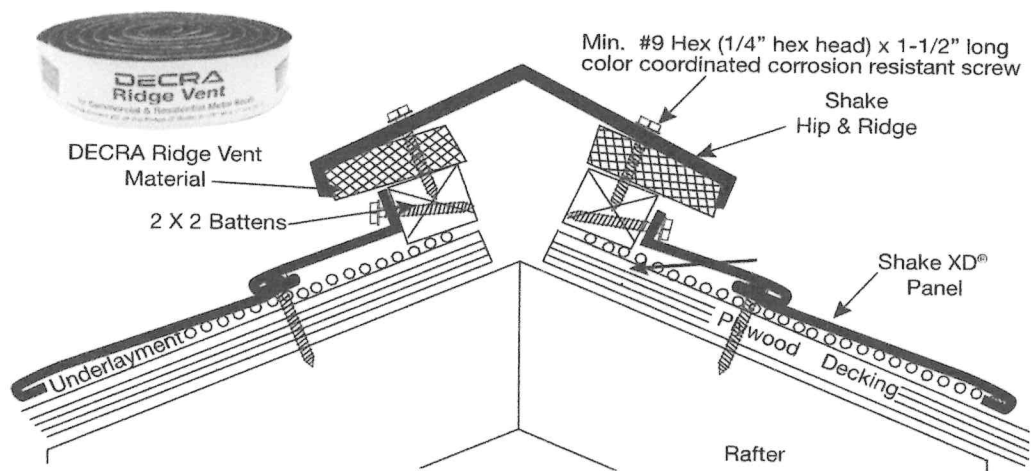

Ridge Venting - Shingle XD: Install Shingle XD panels up to the last full course before ridge. Install (optional) a 2 x 2 on top of the ridge beam. Note, the 2 x 2 will provide a firm fastening location for the ridge cap and ensure adequate opening for the ridge vent. Install panels up the ridge opening. Measure, cut, install, and fasten the panels so that a 3/4 inch opening is maintained between the top course of panels and the edge of ridge beam / 2 x 2. Roll out the vent material along the tops of the last panel course and ridge opening. Position the ridge vent material just inside the Hip & Ridge caps. Remove the white paper while unrolling to expose the adhesive dots. Apply pressure over the adhesive dots to hold the material in place during installation. (see diagram below).

Install Shingle Hip & Ridge pieces over the vent material. Fasten the screws through the vent material into the batten or plywood decking. See *Hip & Ridge Install at Hips & Ridges for Shingle Hip & Ridge Installation*).

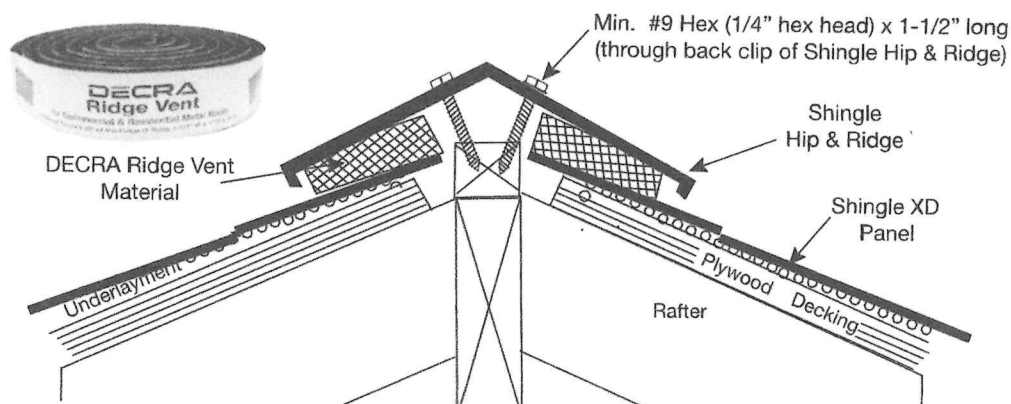

Hip & Ridge Installation at Hips & Ridges - Shake XD

Hip: The Shake Hip & Ridge piece should be attached directly into the 2 x 2 battens at the hips. Hip & Ridge pieces are overlapped and fastened through the sloped side using color coordinated minimum #9 Hex (1/4" hex head) x 1-1/2" long corrosion resistant screws.

Ensure that the fastener is long enough to penetrate into the 2 x 2. Finish the end of the hip or ridge with a Shake End Cap.

Ridge: At the ridge install a 1 x 2 wood batten directly over the Shake XD Panels on both sides of the ridge using fasteners sufficient to penetrate the roof deck. Apply roofing grade sealant/adhesive in-between the wood battens and the Shake XD panels. Note, do not use copper based pressure treated wood with any DECRA roofing system. However, composite deck board can be used as alternative for the wood batten once cut down to the needed size.

The Shake Hip & Ridge pieces are overlapped and fastened through the sloped side of the cap into the 1 x 2 as described above.

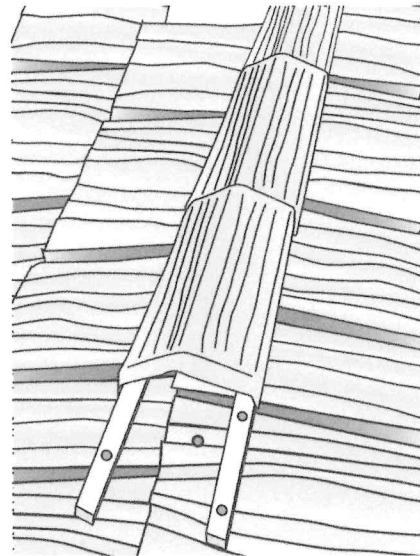
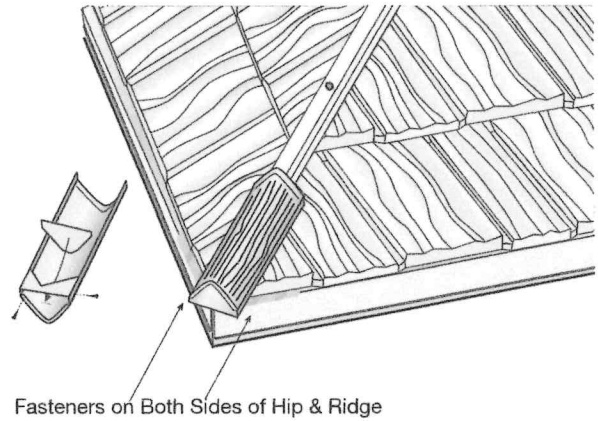

Install Shake Hip & Ridge up the hips to where it meets the ridge.
Trim and notch the first piece of Shake Hip & Ridge where it meets on top of the hips.
Finish with Shake End Cap and Touch-Up Kit.

Running Hips into a Ridge: Add the top pieces of Shake Hip & Ridge at the hip and the first piece at the ridge. Trim the last pieces of Hip & Ridge where they meet the ridge. Add a piece of Hip & Ridge at the ridge and cut it to fit with Hip & Ridge on the hips. Finish with Touch-Up Kit as needed. Continue on with the ridge installation. Finish the end of the hip or ridge with a Shake End Cap. Use minimum #9 Hex (1/4" hex head) x 1-1/2" long color coordinated screws.

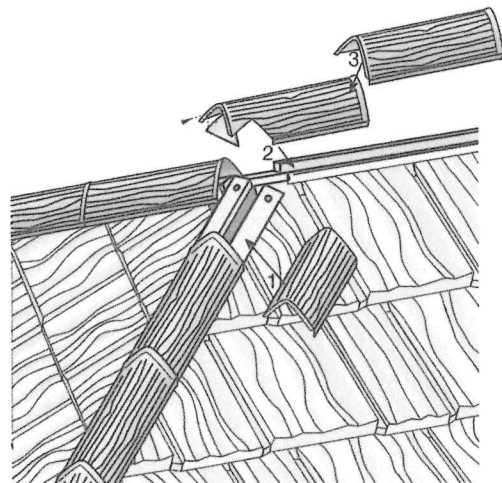

Hip & Ridge Installation at Hips & Ridges - Shingle XD

Hip: The Shingle Hip & Ridge piece should be attached directly into the 2 x 2 battens. Hip/Ridge pieces are overlapped and fastened through the back clip using minimum #9 Hex (1/4" hex head) x 1-1/2" long corrosion resistant screws. Ensure that the fastener is long enough to penetrate into the 2 x 2. The fasteners will be hidden by the next Shingle Hip & Ridge piece. No end cap is needed with the Shingle Hip & Ridge.

Ridge: Install a 1 x 2 wood batten (optional) directly over the Shingle XD Panels on both sides of the ridge using fasteners sufficient to penetrate the roof deck. Apply roofing grade sealant/adhesive in-between the wood battens and the Shingle XD panels. Note, do not use copper based pressure treated wood with any DECRA roofing system. However, composite deck board can be used as alternative for the wood batten once cut down to the needed size.

The Shingle Hip & Ridge pieces are overlapped and fastened through the back clip using minimum #9 Hex (1/4" hex head) x 1-1/2" long corrosion resistant screws. Fasteners should penetrate thru the decking or optional 1x2 wood batten.

Install Shingle Hip & Ridge up the hips to where it meets the ridge.
Trim and notch the first piece of Shingle Hip & Ridge where it meets on top of the hips.
Finish with Touch-Up Kit.

Running Hips into a Ridge: Add the top pieces of Shingle Hip & Ridge at the hip and the first piece at the ridge. Trim the last pieces of Hip & Ridge where they meet the ridge. Add a piece of Hip & Ridge at the ridge and cut it to fit with Hip & Ridge on the hips. Finish with Touch-Up Kit as needed. Continue on with the ridge installation. No end cap is needed with the Shingle Hip & Ridge.

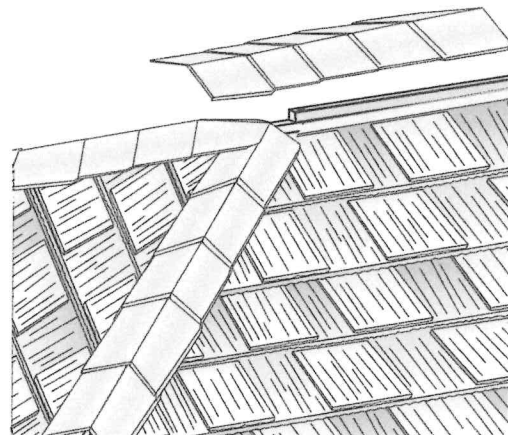
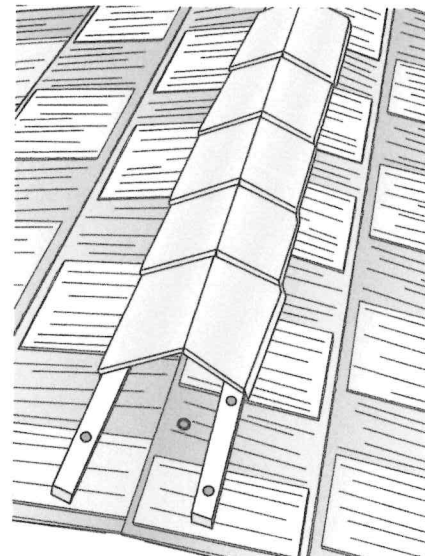
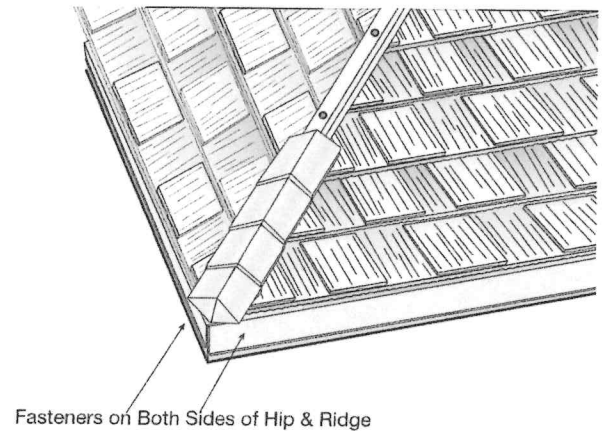

Alternative Installation Method: XD Panel Bend-Ups

Bend-Up at Hips:

Mark the XD panel to length and add minimum 1" for bend-up. Remove Top and Bottom Clip Locks (including nose) to the bend line. Next, measure in from the bend line 2" and snip away a 1/2" wide V-Notch in Bottom Clip Lock return. Bend panel up minimum 1" and install the panel with bend-up against the 2x2. Proceed with the next row.

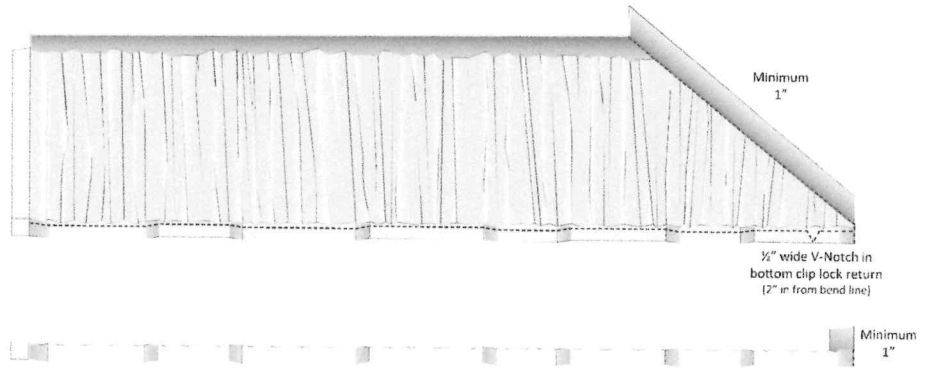

Bend-Up at Rake/Gable:

Mark the XD panel to length and add minimum 1" for bend-up. Remove Top and Bottom Clip Locks (including nose) to the bend line. Next, measure in from the bend line 2" and snip away a 1/2" wide V-Notch in Bottom Clip Lock return. Bend panel up minimum 1" and install the panel with bend-up against the 2x2. Proceed with the next row.

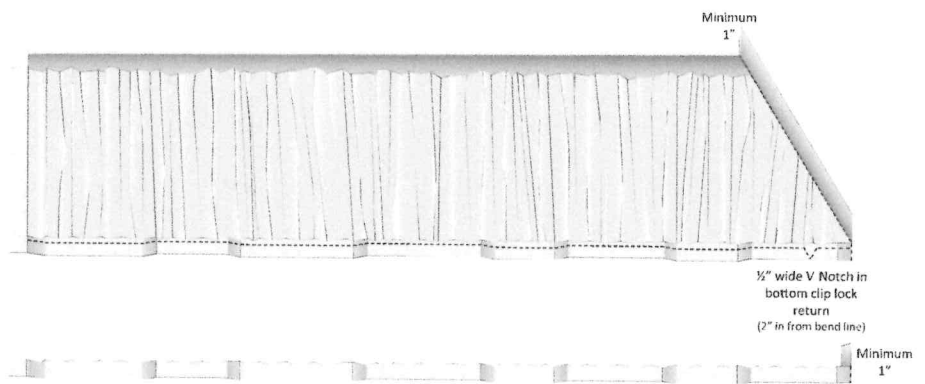

Bend-Up at Sidewalls:

Mark the XD panel to length and add a minimum of 2" for bend-up. Snip the Top Clip Lock 4" in from bend line, fold up and flatten down. **DO NOT** remove the Top Clip Lock. Snip and remove the Bottom Clip Lock (including nose) at the bend line. Next, measure in from the bend line 2" and snip away a 1/2" wide V-Notch in Bottom Clip Lock return. Bend panel up at the bend line. Flatten out bend-up and install the panel tight to the wall. Proceed with the next row.

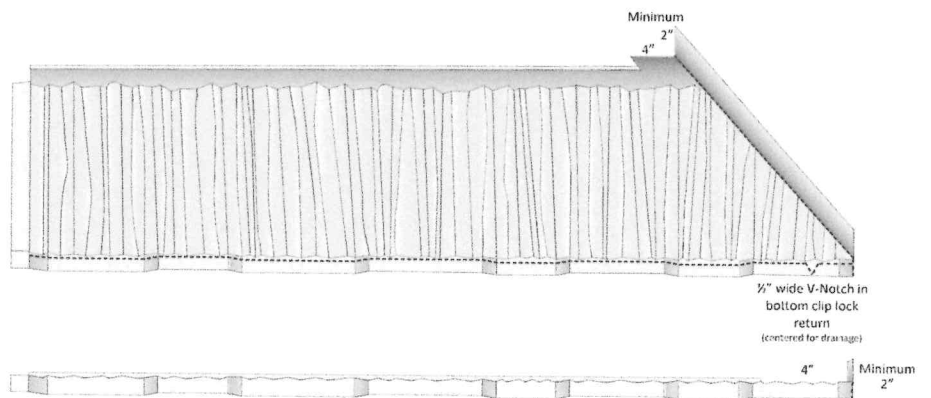

Pitch Change

Pitch Change - Low to High:

In instances where the roof pitches changes from low to high, run the XD Rake/Gable Channel up to the pitch change, cut bend and notch the channel to extend past the change in pitch approximately 3". Overlap the next piece of Rake/Gable Channel over the Rake/Gable Channel below the pitch change.

Install XD panels up to the area where the change occurs. Cut the back of the XD panel to extend 3" past the change in pitch. Bend the panel forward at the pitch change to conform to the deck. In lieu of bending panel at transition, an apron or transition metal may be installed from the upper slope down over the lower slope. The apron or transition metal should be bent to fit tight and provide adequate coverage over the lower slope.

Install the next panel using the Short Course Clip as a starter.

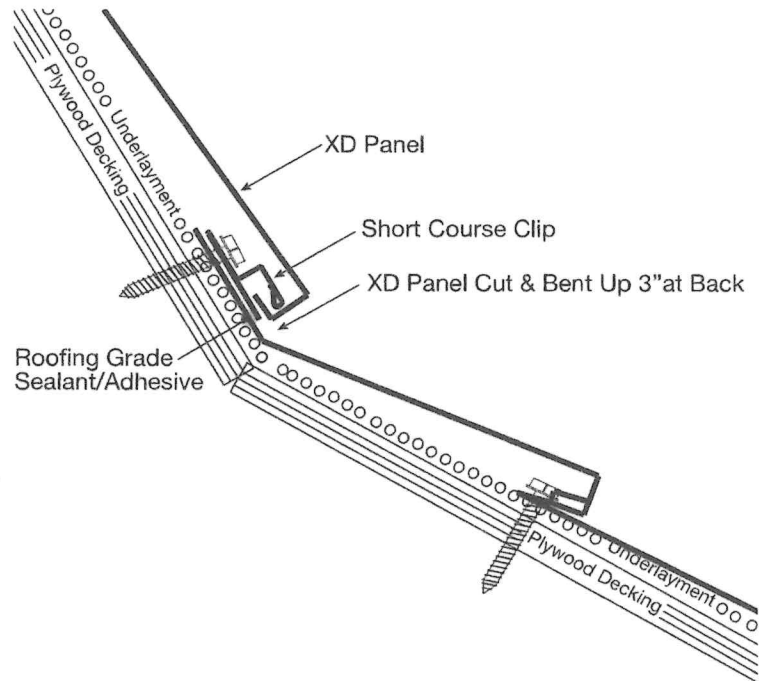

Pitch Change - High to Low:

In instances where the roof pitches changes from high to low, run the XD Rake/Gable Channel up to the pitch change, cut bend and notch the channel to extend past the change in pitch approximately 3". Overlap the next piece of Rake/Gable Channel over the Rake/Gable Channel below the pitch change.

Apply a roofing grade sealant/adhesive along the panel above the bend and below the cut edge. Install a Short Course Clip on top of the sealant above the change in pitch (see diagram to the right). If an apron or transition metal is used, apply a roofing grade sealant/adhesive along the upper slope over the apron or transition metal. Install a Short Course Clip on top of the sealant above the change in pitch.

Install the next panel using the Short Course Clip as a starter.

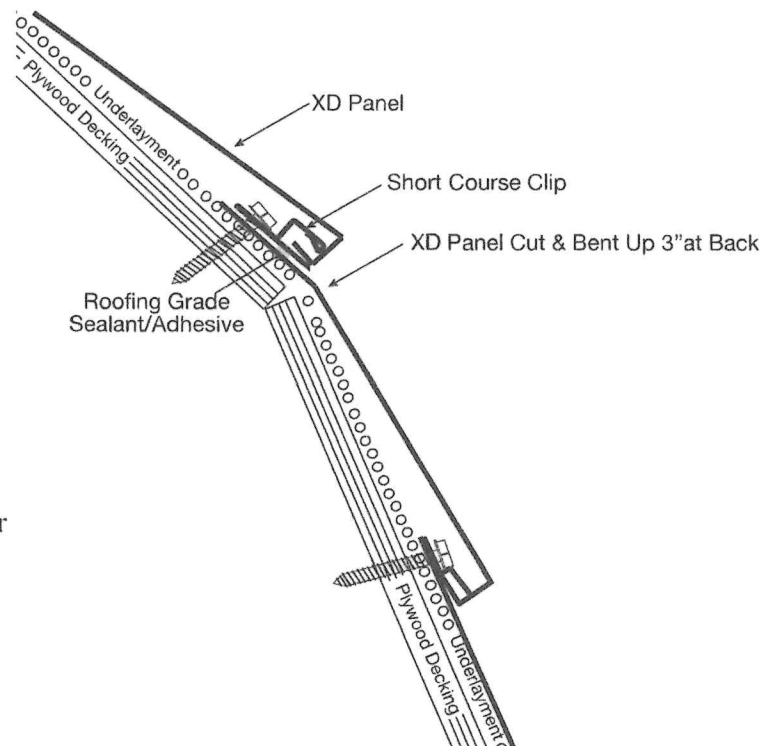

Short Course

In some instances, a short course will be necessary. A short course is needed when a section of the fascia steps out and is not an even panel width difference from the main fascia.

A short course is inserted by fastening the Short Course Clip over the panel in the course below at the point where the next full panel above will align with the panels to the right and left in the course above. Once the Short Course Clip is secured into the panel below, clip the next course of full panels into it.

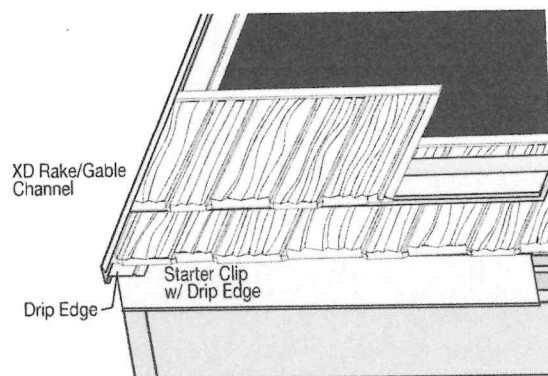

Alternative Short Course detail: Align for full panels to be used along longest run of eave. Adjust for shorter run by cutting off bottom portion of panel and creating a bottom lock in the field. This is done by measuring up or down in panel exposure increments (Shake XD 12 3/8" and Shingle XD 12 1/4") and chalking lines. To measure for short course panel(s), measure from chalk line to edge of starter clip at the short eave then add 3/4-1" to be used for short panel bottom lock. Using hand seamer's crimp modified bottom lock to the starter.

Roof Jacks/Steep Pitch Roof

To use roof jacks, remove a portion of the top Clip Lock of panel to allow roof jack to lay flat on the deck and on top of the panel. Place padding between jack and panel to avoid scuffing. Install the next course of panels by notching out the bottom Clip-Lock of the panel at the jack location and folding it up (do not completely remove the piece). When removing the roof jack, fold the nose of the panel back into place and finish using a roofing grade sealant/adhesive and a Touch-Up Kit.

High Wind

In areas prone to high winds, installation must meet local codes. Reference International Code Council (ICC) **ESR-1754** for DECRA direct to roof deck roof system installations, section 4.4 Wind Resistance and Table 1 detail on wind uplift pressures and panel fastening procedures. **ESR-1754** code compliance document is available on DECRA.com.

Freeze Thaw

Ice and water shield is recommended in all areas susceptible to freeze/thaw conditions.

Foot Traffic

Avoid walking on side laps. See walking instructions at DECRA.com.

Sealants

A roofing grade sealant/adhesive should be used with this roofing system. Where possible, the sealant should be covered by the roofing system or with matching stone granules. Sealant should not be used to refinish damaged panel surfaces. Touch-Up Kits are available in colors matching the various stone coated panel finishes.

Cleaning & Touch-Up (During Installation)

After installation is complete, be sure to clean all debris off of the roof, especially any metal shavings.

In cases where it is necessary to touch up a panel during the installation process or finish a roofing penetration or other detail, DECRA Touch-Up Kits are available in all of the colors matching the stone coated panel finishes. For answers to questions or more details not covered in this guide, call (877) 463-3272 or visit DECRA.com. Architectural Details and Product Specs are available at DECRA.com.



DECRA[®]
METAL ROOFING
877-GO-DECRA [463-3272] | DECRA.COM



CW CUSTOM EXTERIORS.COM * 143789 PACKER DR, WAUSAU, WI 54401 * 715-870-1892

Roofing Proposal #6027

Client: Village of Kronenwetter

Phone: 715-432-2351

Address: 1582 Kronenwetter Drive, Kronenwetter, WI 54455

Job Description: Commercial Metal Roof replacement and Tower EPDM roof repair or replace.



CW CUSTOM EXTERIORS.COM * 143789 PACKER DR, WAUSAU, WI 54401 * 715-870-1892

Scope of Work:

CW Custom Exteriors.com proposes to perform labor and supply all necessary materials for the completion of the roof replacement as follows:

Building address: 1582 Kronenwetter Drive, Kronenwetter, WI 54455

Description of roofs to be completed: Remove existing 2 layers of Asphalt shingles and underlayment, on sloped areas and install new asphalt shingle roofing system. Repair or replace Tower EPDM rubber roofing.

Building breakdown is depicted in the attached aerial commercial report, page 3:

Pitched area = 31,237 total square feet, with 10% waste = 34360 sq ft.

Tower Flat roof area is 336 square feet. With 5 feet up side walls =690 sq. Ft

SCOPE OF WORK:

Remove all existing shingles down to the deck

Re-nail any loose wood

Install 3' of ice and water shield at all gutter lines, rakes edges, and valleys.

Install Synthetic underlayment to keep the roof dry

Install **Decra** Starter Course along all gutter lines and Stone Coated rake edges as required.

Install Decra Stone Coated Impact Resistant Lifetime Shingles per specifications using Decra screws.

Install all required accessories for the selected Decra Stone Coated Metal Roofing System.

Install Decra Hip & Ridge Stone Coated Shingles.



CW CUSTOM EXTERIORS.COM * 143789 PACKER DR, WAUSAU, WI 54401 * 715-870-1892

Install new ridge vent.

Install new pipe and chimney flashings.

Cover all bushes, shrubs and flowers for protection.

Clean up all job related debris.

Provide 50 year workmanship warranty and Decra Manufacturer Warranty.

INSURANCE & SAFETY

CWCustomExteriors.com LLC, shall provide general liability insurance as detailed on our certificate of insurance. Maximum liability is the limit of this insurance. A certificate of insurance will be issued upon request.

Safety is of primary importance to CWCustomExteriors.com LLC

We will set up required safety equipment at site needed to comply with OSHA construction guidelines including barricades, safety lines, ect.

We hereby propose to furnish material and labor – complete in accordance with



CW CUSTOM EXTERIORS.COM * 143789 PACKER DR, WAUSAU, WI 54401 * 715-870-1892

the above specifications dated this 25th day of September, 2023 for the sum of

Three hundred eighty-two thousand, ninety-two and ninety-two cents, (\$382,092.92)

With payments to be made as follows:

Scheduled Payments: **65%/35%**

\$ 248,360.40 Initial down payment

\$ 133,732.52 upon completion

ADDITIONAL WORK:

1/2" OSB REPLACEMENT @ \$80/sheet, \$280/square

Reflash and seal other Tower flashing: \$25/lf

Other rubber roof repairs on main building: \$350+ depending on issues found. Change Order would then be addressed and completed to update.

Note: this proposal may be withdrawn by us if not accepted within 30 days.

All material is guaranteed to be as specified. All work to be completed in a workmanlike manner according to standard practices. Any alteration or deviation from above specifications involving extra costs will be executed only with approval.

All agreements contingent upon strikes, accidents, or delays beyond our control. Owner is to carry fire, tornado, and other necessary insurance.

Acceptance of Proposal – The above prices, specifications and conditions are satisfactory and are hereby accepted. Payment will be made as outlined above. A service charge of 1.5% per month will be charged to balance if not paid within 10 days. Replacement of any damaged or deteriorated decking discovered after removing existing roofing will be an additional cost of \$2.50 per square ft. of decking as needed after owner's approval. New decking will meet or exceed local building code requirements and H-clips will be used between all rafters.



CW CUSTOM EXTERIORS.COM * 143789 PACKER DR, WAUSAU, WI 54401 * 715-870-1892

Projected Start Date: Between 11-1-2023 to 11-10-2023. (Open window as dates can vary depending when the contract is signed and weather permitting.)

Acceptance of Proposal

Customer

_____ Date _____

_____ Date _____

CW Custom Exteriors.com

_____ Date _____

“CUSTOMER’S RIGHT TO CANCEL” You may cancel this agreement by mailing a written notice to CW Custom Exteriors.com before midnight of the third business day after you signed



CW CUSTOM EXTERIORS.COM * 143789 PACKER DR, WAUSAU, WI 54401 * 715-870-1892

this agreement. If you wish, you may use this page as that notice by writing "I hereby cancel" and adding your name and address. A duplicate of this is provided by CW Custom Exteriors.com for your records.

DECRA[®]

METAL ROOFING

DECRA Villa Tile

Capri Clay

BEAUTY THAT CAPTIVATES.
STRENGTH THAT PROTECTS.

The #1 Performing Roof to Protect Your Home.



ROOFING WITH STYLE AND SUBSTANCE

A perfect blend of over 60 years of research and practical experience, DECRA's product lines offer the ultimate in style, performance and engineering design. You'll be the absolute envy of your neighborhood.



ENGINEERED TO PROTECT

The strength and durability of a DECRA roof is combined with the versatile good looks of a tile, shake or shingle style, all aimed at providing the optimal roof solution. DECRA panels have a unique interlocking design to withstand high winds while adding shear strength.

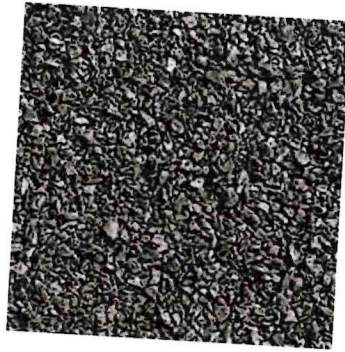
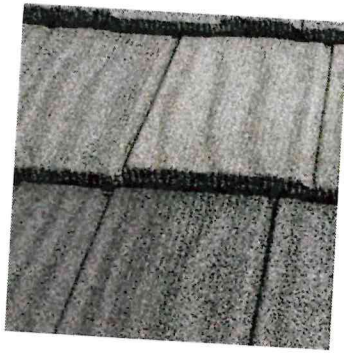

PEACE OF MIND

Breathtaking designs are what you see at first glance, but underneath are layers of pure protection. A DECRA roof is a piece of beauty that offers peace of mind.

- ✓ Protective Layers Deliver Long Life Performance
- ✓ Lifetime Limited Warranty
- ✓ Class A Fire Rated Material
- ✓ Best In Class Weight-To-Strength Ratio
- ✓ Severe Weather Resistance
- ✓ Class 4 Impact Resistance (Highest Rating)

“DECRA is not only a beautiful, durable roof that can withstand storms, but it is an investment into the value of our home. I am proud to be a DECRA roof owner.”

— Steven Sigler, Fairhope, Alabama

DECRA Villa Tile

Capri Clay



DECRA Villa Tile

Rustico Clay

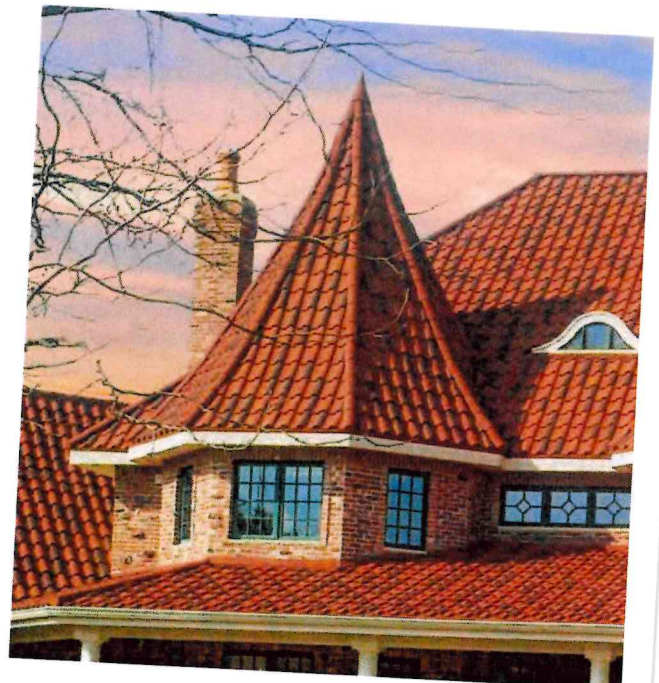
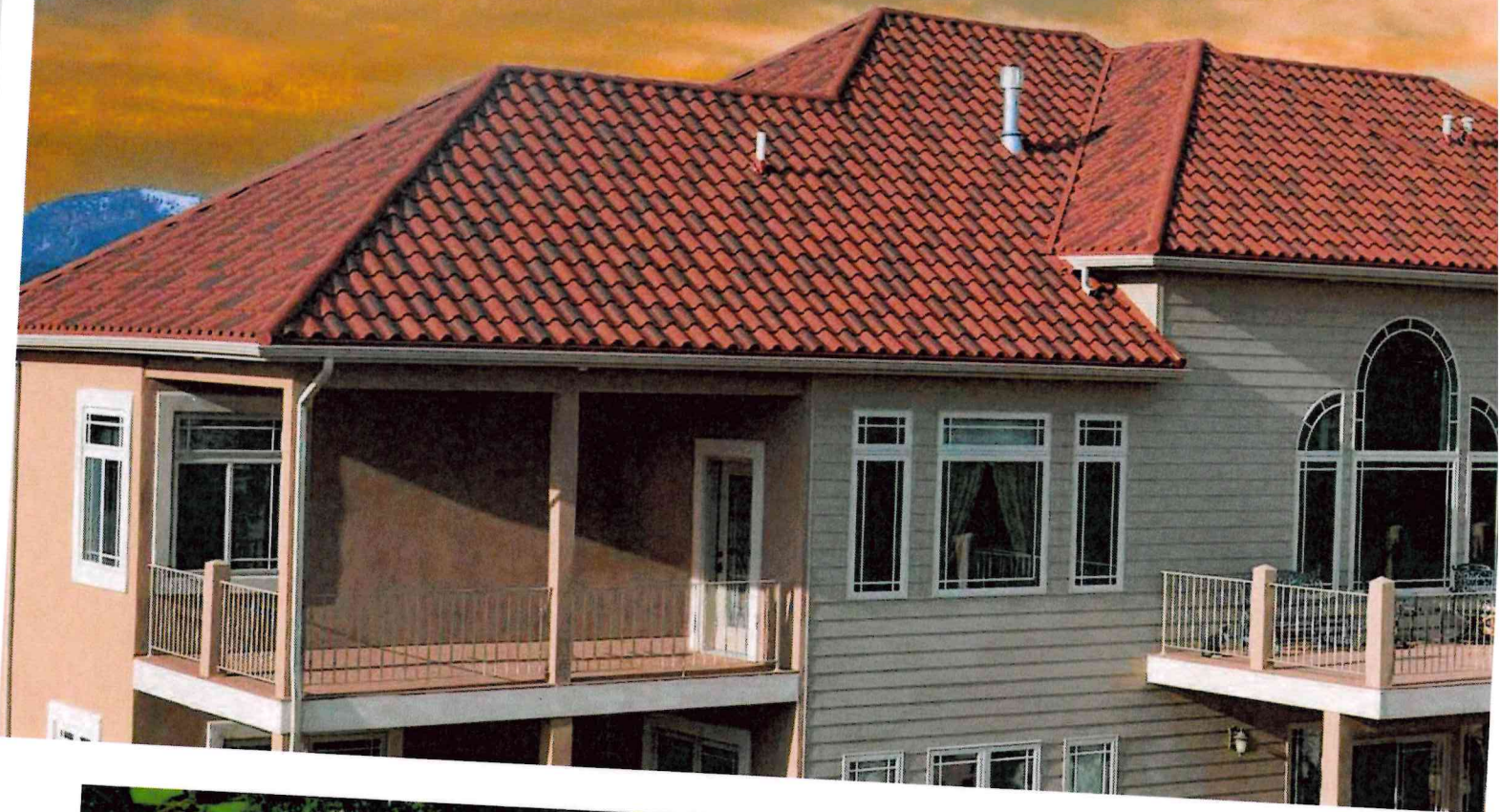

DECRA VILLA TILE

Classic Elegance of Old Barrel Tile

A unique and premium offering, DECRA Villa Tile features the classic beauty, elegance and architectural detail of an old-world Italian tile. Durable, lightweight and a true barrel tile, Villa Tile outclasses the competition. It's an excellent alternative to clay and concrete tiles, which crack easily and are vulnerable to hail and storm debris impact.

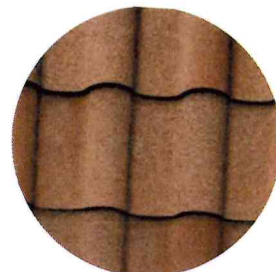
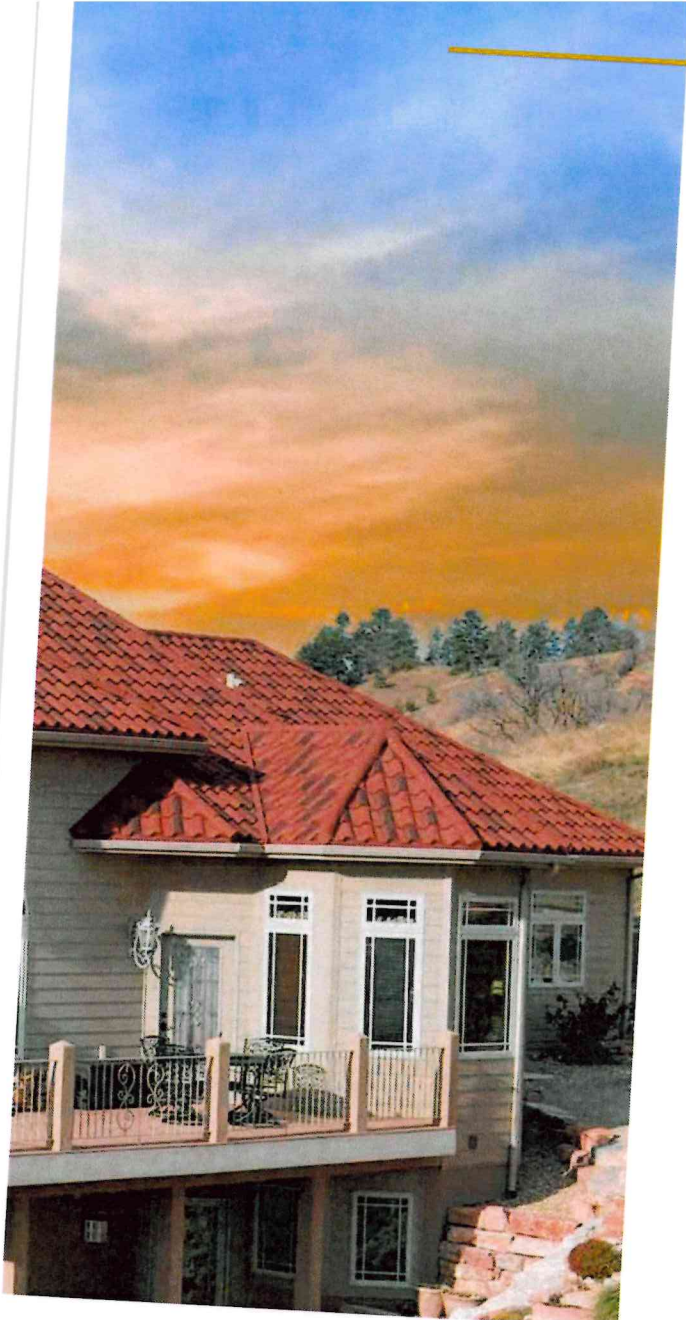

AMALFI SAND

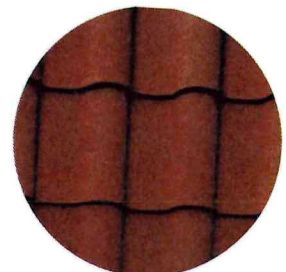

CAPRI CLAY



POMPEII ASH

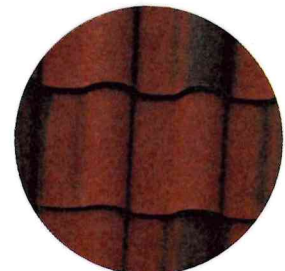

RUSTICO CLAY

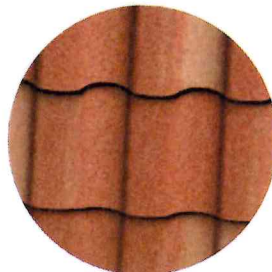

VENETIAN GOLD



CHARCOAL*



WOODLAND GREEN*

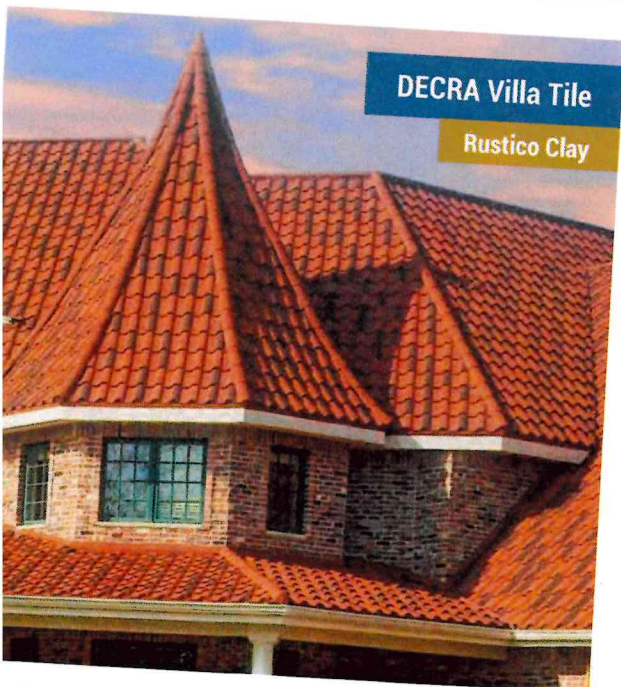

*Please note these colors are MTO (made to order) and production times may be extended.



DECRA TILE

Beauty and Style of Mediterranean Tile

DECRA Tile, offering the beauty and style of Mediterranean tile, adds a unique elegance to any home. With a long-standing reputation for performance, longevity and versatility, it is an ideal, lightweight alternative to traditional tile products.



CHARCOAL



CHESTNUT

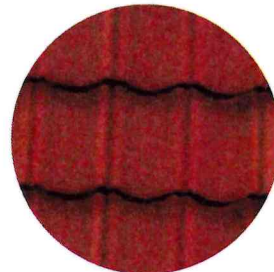

GARNET



TERRACOTTA



WEATHERED TIMBER

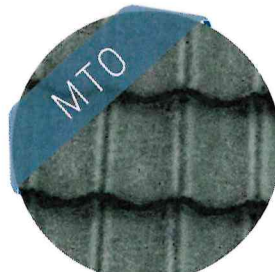

GRANITE GREY*



SHADOWOOD*



WOODLAND GREEN*



*Please note these colors are MTO (made to order) and production times may be extended.

DECRA Tile

Charcoal



DECRA Tile

Terracotta



DECRA Tile

Garnet



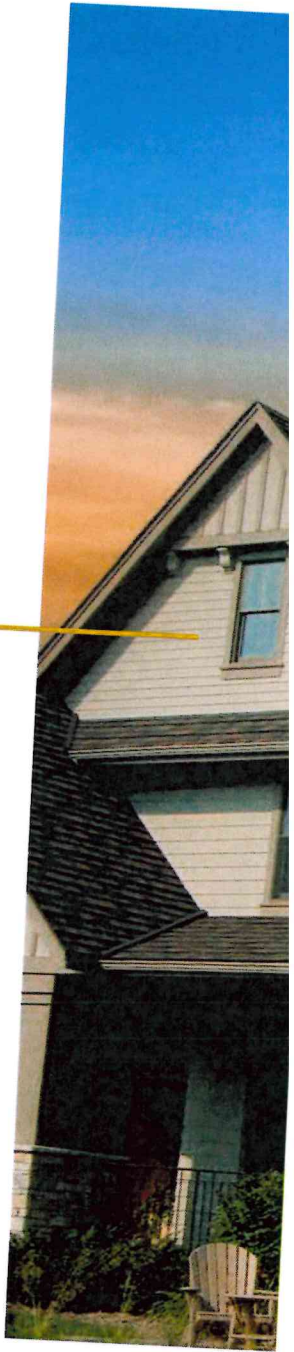
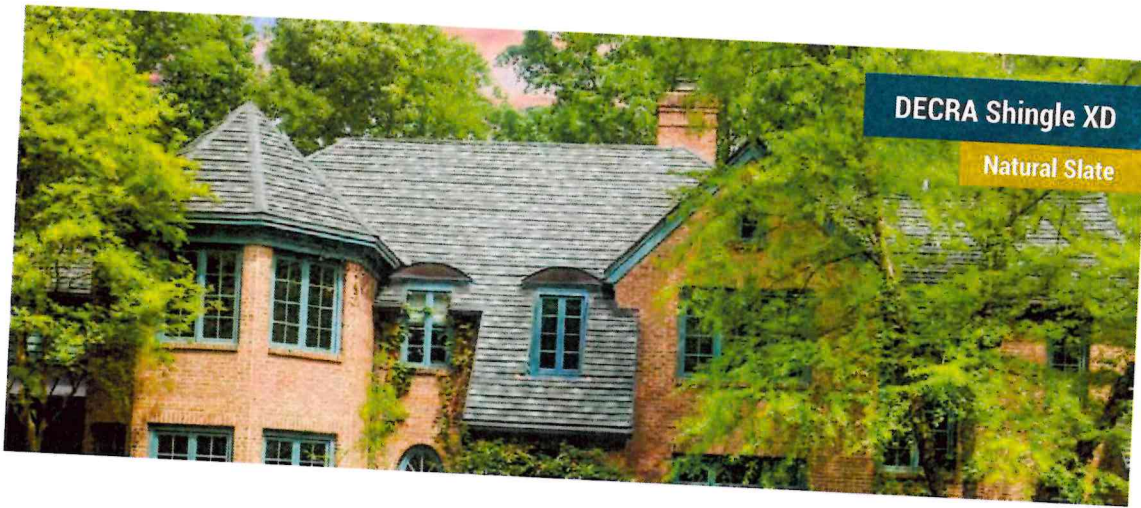

DECRA SHINGLE XD[®]

Shingle at a Fraction of the Weight

DECRA Shingle XD has the rich, bold appearance of a heavyweight architectural shingle at a fraction of the weight. With its thick-cut edges and deep, distinctive shadow lines, DECRA Shingle XD provides greater dimensionality and a robust appearance. This profile adds the aesthetics of wood shingles without the ongoing maintenance that comes with a conventional wood roof.



CLASSIC
COBBLESTONE



MIDNIGHT ECLIPSE

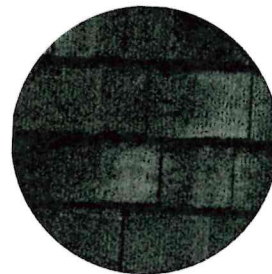

NATURAL SLATE

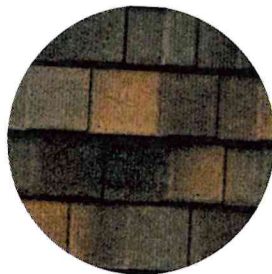

OLD HICKORY



WOODLAND GREEN*

*Please note these colors are MTO (made to order) and production times may be extended.

DECRA Shingle XD

Old Hickory

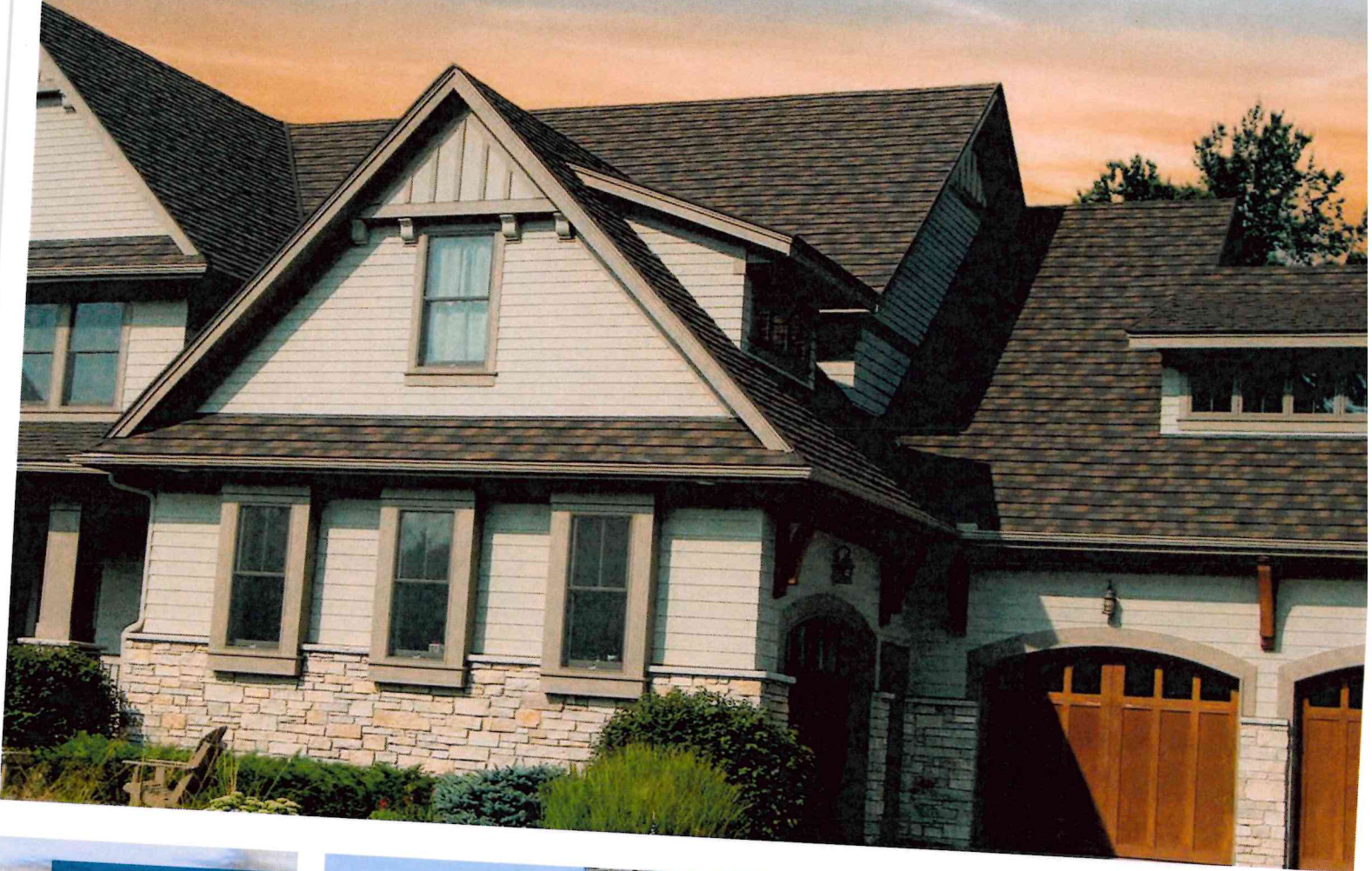

DECRA Shingle XD

Old Hickory

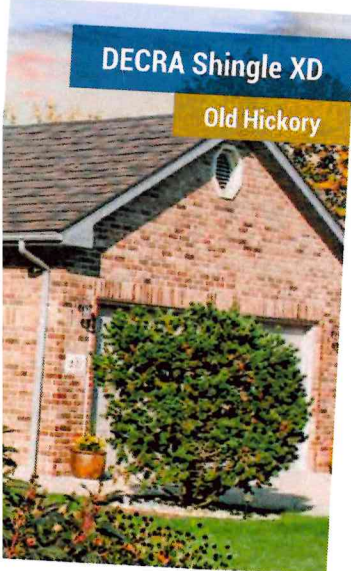

DECRA Shingle XD

Classic Cobblestone

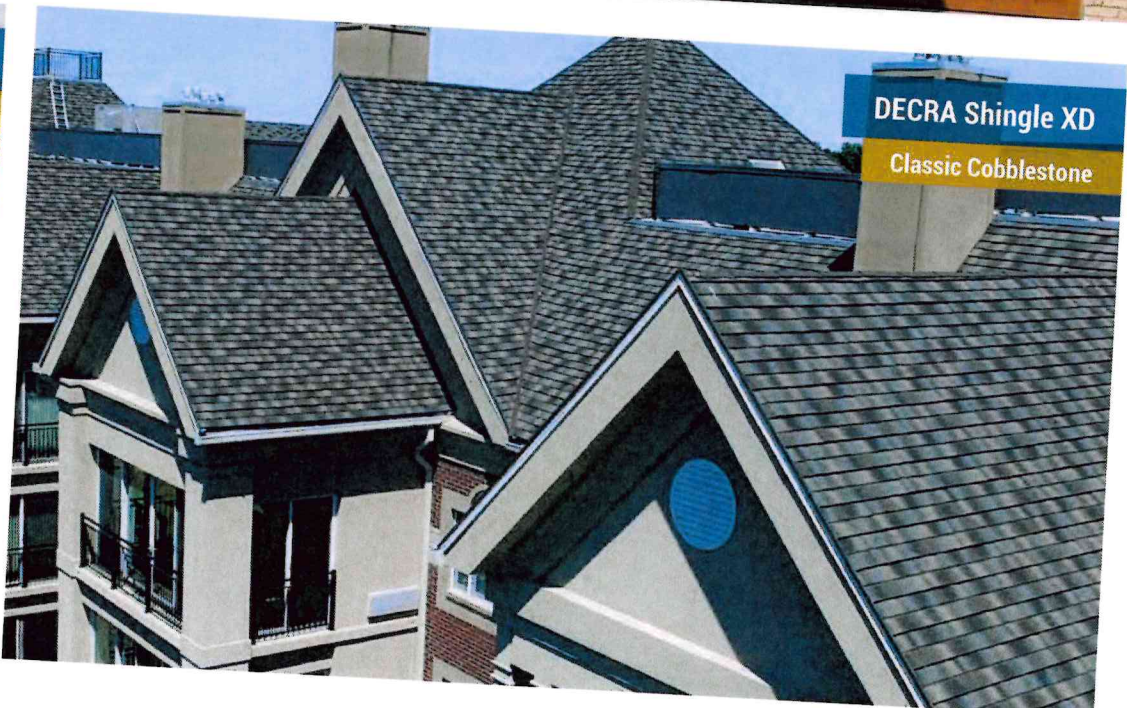

DECRA Shake XD

Pinnacle Grey



DECRA SHAKE XD®

Classic Beauty of Hand-Split Wood Shake

DECRA Shake XD, emulating the classic beauty and architectural detail of a rustic, hand-split wood shake, has a unique hidden fastening system and is installed direct-to-deck.



PINNACLE GREY

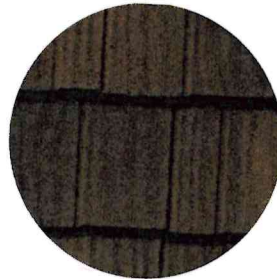

ANTIQUE CHESTNUT



MIDNIGHT ECLIPSE*



WOODLAND GREEN*

*Please note these colors are MTO (made to order) and production times may be extended.

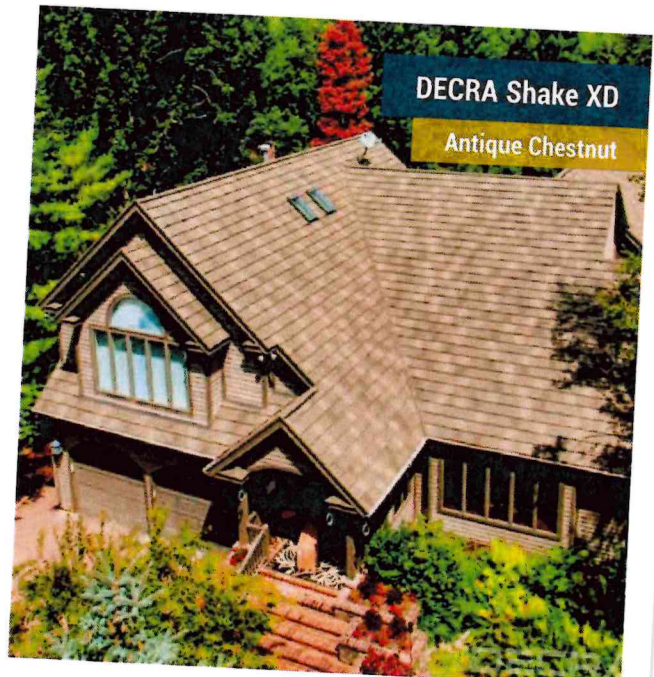

DECRA Shake

Charcoal



DECRA Shake

Chestnut





DECRA SHAKE

Beauty and Richness of Cedar Shake

DECRA stone-coated steel shakes provide the same distinctive rich beauty of cedar shakes with the durability to handle anything Mother Nature dishes out.

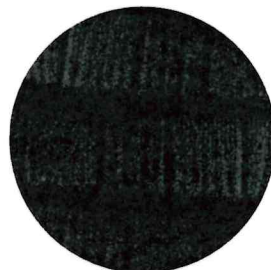

CHARCOAL

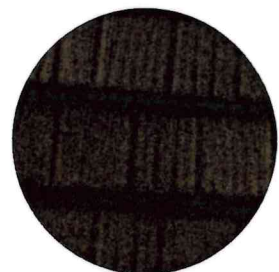

CHESTNUT

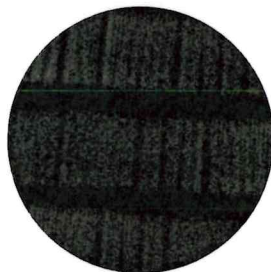

GRANITE GREY



WEATHERED TIMBER

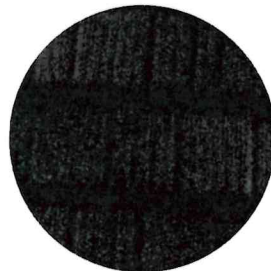

SHADOWWOOD



WOODLAND GREEN*

DECRA Shake
Granite Grey

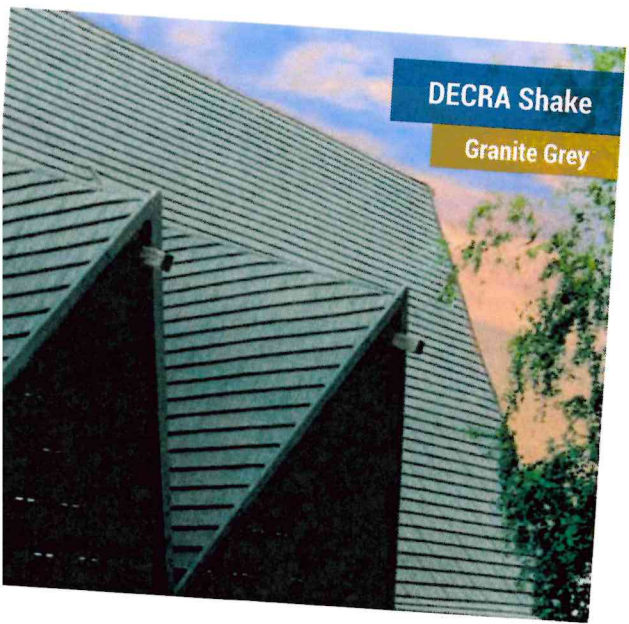

*Please note these colors are MTO (made to order) and production times may be extended.



PRODUCT COMPARISON

Traditional roofs are temporary when compared to DECRA.

In an average lifetime, a homeowner will need to replace a traditional roof at least two-and-a-half times. With DECRA, there's no worrying about costly, unexpected expenses. Plus, DECRA's Lifetime Limited Warranty eliminates the hassle.



=



PROVEN HISTORY OF SURVIVING HARSH CONDITIONS

DECRA's roofing systems have excelled through some of the harshest weather conditions around the world for over 60 years. DECRA's interlocking panels are strong and non-combustible (Class A fire-rated), and they are covered by a transferable Lifetime Limited Warranty, including peace-of-mind coverage for winds up to 120 mph and is class IV impact resistant.



A DECRA roof is durable, freeze-thaw resistant, and will offer richness and beauty to enhance your home. For style and protection, DECRA is the obvious choice.





BENEFIT FROM ABOVE SHEATHING VENTILATION (ASV): DECRA Metal Roofing panels create an airspace between the panel and the roof deck thereby mitigating the amount of heat transferred into the structure so it remains cooler in the summer and reduces ice damming in the winter.

COOL ROOFING — LITERALLY

A DECRA family lowered its kilowatt use by 15%, simply by installing a DECRA Villa Tile roofing system.

ENERGY SAVED BY SWITCHING FROM CONCRETE TILE TO DECRA VILLA TILE

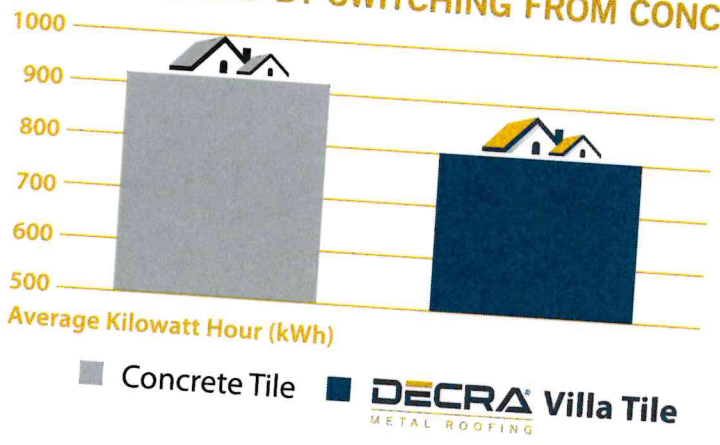

DECRA'S COOL ROOF COLORS



ROYAL OAK

MIST GREY

SPANISH CLAY

Cool Colors qualify for Title 24 Cool Roof requirements. Available on all DECRA Metal Roofing Profiles.

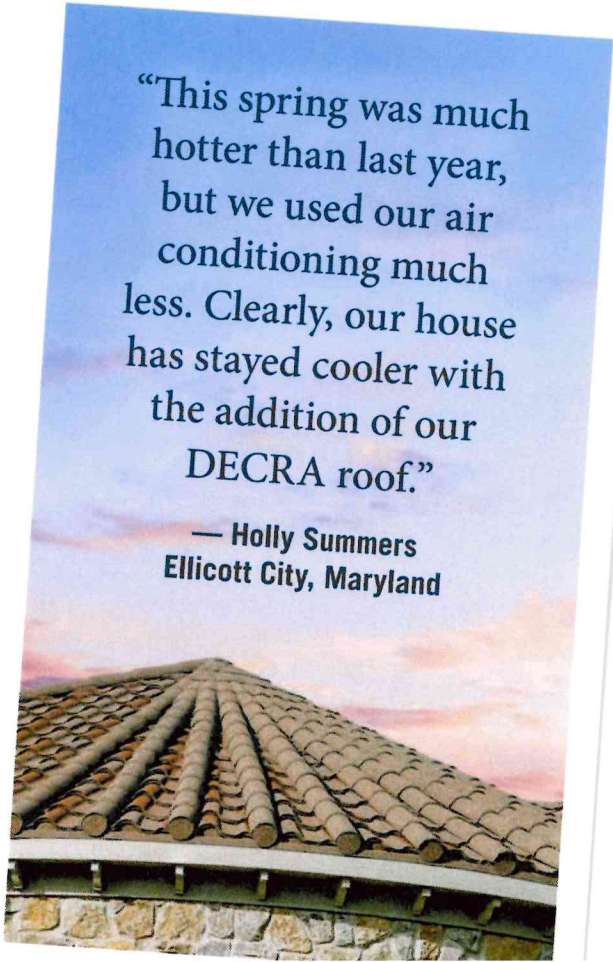

“This spring was much hotter than last year, but we used our air conditioning much less. Clearly, our house has stayed cooler with the addition of our DECRA roof.”

— Holly Summers
Ellicott City, Maryland



YOU'LL KNOW WHEN IT'S A DECRA ROOF

What is DECRA's warranty?

DECRA roofs carry a Lifetime Limited Warranty, covering 120 mph winds and manufacturing defects, including excessive granule loss. In addition, material and labor are covered for the first 20 years; after that time, material is covered for the remaining warranty period.



Can I get a discount on my homeowners insurance?

In many states, the Class 4 Impact Resistance rating can earn a discount on homeowners insurance. Ask your local insurance agent for details.

Is a DECRA roofing system more expensive?

A DECRA roof offers more value for your money. You would have to purchase and install two-and-a-half shingle roofs for the cost of one DECRA roof. Similar to most products you buy – you get what you pay for. A DECRA roof offers more for your money and can last a lifetime.

DECRA[®]
METAL ROOFING

877-GO-DECRA [463-3272] | DECRA.COM

Due to lighting and the printing process, roof colors and color swatches may vary from the actual product.
DECRA Roofing Systems, Inc., Corona, CA | © 2022 DECRA Roofing Systems, Inc. 0620

**Lifetime Limited Warranty for wind \leq 120 mph and hailstone \leq 2.5 inches penetration
30 year limited warranty on finish**

This Limited Warranty is intended to provide the owner of the structure on which DECRA Roofing Systems Inc. (the "Company") roofing panels (the "Panels") are installed certain remedies in the event a manufacturing defect causes the specific damages hereinafter set out. This Limited Warranty is NOT a guarantee of performance.

Please note that all disputes relating to this Limited Warranty must be resolved by mandatory binding arbitration and no claims may be filed on a consolidated or class action basis. Some jurisdictions do not allow for mandatory arbitration, so this requirement may not apply to you. Please see below for further details.

You may return all Panels to the Company's authorized dealer, no later than 30 days after purchase, for a full refund if you are unsatisfied with any of the terms and conditions of this Limited Warranty, provided that such Panels remain in their original and marketable condition and that all Panels purchased for the job are returned.

Remedy in the event of leaks, blow-off or hailstone penetration: In the event the Panels are determined to have a manufacturing defect which (a) directly results in leaks, (b) results in blow off of the Panels by winds of up to 120 mph (193 kph); or (c) results in damage to the Panels caused by the penetration of hailstones of 2.5 inches (6 cm) or less completely through the Panels, the Company will, at its option, either repair or replace the defective Panel(s), provided that the Company's liability will be limited (i) during the first 20 years following the original installation, to the reasonable replacement cost (labor and materials) of the particular defective Panel(s), as determined by the Company; (2) during years 21 through 40 following the original installation, to the reasonable replacement cost (materials only) of the particular defective Panel(s), prorated at 1/600 per month elapsed since the original installation; and (3) for years 41 and beyond, to 20% of the reasonable replacement cost (materials only) of the particular defective Panel(s), as determined by the Company.

Remedy in the event of deterioration of finish: In the event the Panels are determined to have a manufacturing defect which has caused the material deterioration of the Panels such that the appearance of the roof is substantially affected in areas of the roof that are visible from the ground, the Company will, during the first 15 years following the original installation, at its option, either repair or replace the defective Panels, at the Company's cost, including labor costs, as determined by the Company; and thereafter during the next 15 years, the Company's liability will be limited to the reasonable replacement cost (materials only) of the defective Panels only, prorated at 1/360 per month elapsed since the original installation, as determined by the Company. Coverage hereunder will terminate 360 months from the original installation of the Panels. Specifically excluded from coverage is normal weathering and aging, including minor granule loss, as well as deterioration of the finish resulting from improper use, handling and cleaning. Please see Exclusions for further details.

Warranty Period: This Limited Warranty provides coverage to the original owner of the single family detached residential dwelling on which the Panels were originally installed (the "Owner") for the following periods: (1) in respect of coverage for leaks, blow-off and hailstone penetration, for the lifetime of the Owner while the Owner owns the dwelling; and (2) in respect of coverages for the finish, for a period of 30 years from the date of the original installation of the Panels.

The coverage in respect of leaks, blow-off and hailstone penetration for any type of property other than a single family detached residential dwelling shall be 50 years from the date of original installation, and shall be limited to the reasonable replacement cost

(labor and materials), of the particular defective Panel(s) during the first 20 years and during years 21 through 50, to the reasonable replacement cost (materials only) of the particular defective Panel(s), prorated at 1/600 per month elapsed since the original installation.

Transferability; Coverage and Warranty Period on Transfer: The Owner may transfer this Limited Warranty to a subsequent owner of the dwelling during the first twenty (20) years after the Panels' original installation. To be effective, the transfer information (property address, original owner, new owner and a copy of the original proof of purchase) must be mailed to the Company by certified mail at the address noted below within 30 days from the change of ownership. Further transfers or transfers not in compliance with this notice provision will void the warranty.

The coverage extended to such subsequent owner in respect of the finish shall be as set out above.

The coverage extended to such subsequent owner in respect of leaks, blow-off and hailstone penetration shall be as set out above for the first 20 years since the original installation of the Panels, but shall thereafter be limited to a 50 year warranty, with the liability of the Company in years 21-50 being limited to the reasonable replacement cost (materials only) of the particular defective Panel(s), prorated at 1/600 per month elapsed since the original installation.

Exclusions: This Limited Warranty does not cover damages arising from any cause or circumstances other than those detailed above, and accordingly causes or circumstances not covered under this Limited Warranty include, but are not necessarily limited to: (a) damage resulting from improper installation, or inadequate roof pitch, or the failure to follow the Company's installation instructions, or failure to follow applicable building codes; (b) damage resulting from defects, movement or subsidence in the structure on which the Panels were installed; (c) damage caused by improper foot traffic, misuse, improper handling or neglect of or on the Panels; (d) damage or change in appearance resulting from application of cleaning solutions, paints or coatings not specifically approved in writing by the Company; (e) shading or discoloration or damage caused by fungus, mold, lichen or algae, or other contaminants; (f) color fading or color changes due to normal weathering and aging, including minor granule loss or (g) damages resulting from modifications or change in design and function of the Panels without the Company's prior written consent.

Claims Procedure: In order to make a valid claim under this Limited Warranty, the claim must be submitted within thirty (30) days from discovery of the facts on which the claim is based. The claim may only be submitted by the Owner and will not be accepted if it does not include the following: (a) name and contact information of the Owner (b) the date of original installation (c) documented proof of purchase, (d) the date of discovery of the damage, and (e) a detailed description of the defect, including the number of affected Panels and photographs. You may be required to supply additional information and samples of the affected Panels, if so requested by the Company. The claim can be submitted via email to claims@decra.com or in writing by certified mail to the address of the Company noted below.

All warranty repair and replacement work will be at the sole discretion of the Company. Decisions on warranty claims will be made only through the Company's Office of Warranty Claims and will be communicated in writing. No other representative of the Company shall have authority to bind the Company in respect of this Warranty, and

50 years Limited W.

any oral communications will not be binding on the Company. Work done prior to a submitted claim or not authorized in writing by the Company or by a contractor not chosen by the Company may be subject to denial or limited claim reimbursement.

Limitation of Liability: If the Company elects to replace Panels, the Company will attempt to replace the Panels with Panels of the same color and design, but does not guarantee that such replacement Panels will be available, and accordingly, the Company bears no responsibility for variations in color or appearance by reason of the use of a different color and design, as well as by reason of progressive fading of the remaining Panels. The Limited Warranty term on repaired or replacement Panels will be the remaining term of the original Panels, which commenced on the date of installation of the original Panels, except if otherwise required by law. The reasonable cost of repair or replacement of any defective Panels shall be determined by the Company in its sole discretion. **THE REMEDIES SET OUT IN THIS LIMITED WARRANTY ARE THE OWNER'S SOLE AND EXCLUSIVE REMEDIES, AND THE COMPANY'S OBLIGATIONS CONTAINED IN THIS LIMITED WARRANTY ARE EXPRESSLY IN LIEU OF ANY OTHER OBLIGATIONS, GUARANTEES, WARRANTIES, AND CONDITIONS EXPRESSED OR IMPLIED, INCLUDING ANY IMPLIED WARRANTY OR CONDITION OF MERCHANTABILITY OR FITNESS FOR A PARTICULAR PURPOSE, AND OF ANY OTHER OBLIGATIONS OR LIABILITY ON THE PART OF THE COMPANY. THE COMPANY SHALL IN NO EVENT HAVE ANY LIABILITY FOR INJURY OR DAMAGE TO ANY PROPERTY OR PERSON, LOSS OF BUSINESS OR PROFITS, DIRECT OR INDIRECT ECONOMIC DAMAGES, CONSEQUENTIAL, INCIDENTAL, ECONOMIC, INDIRECT, SPECIAL OR PUNITIVE DAMAGES OR LOSSES OF ANY KIND WHATSOEVER, WHETHER TO THE OWNER OR THIRD PARTIES. THE FOREGOING LIMITATIONS WILL NOT APPLY IN ANY JURISDICTION WHICH DOES NOT ALLOW FOR SUCH LIMITATIONS AS A MATTER OF LAW.**

MANDATORY BINDING ARBITRATION AND WAIVER OF CLASS ACTION: BY PURCHASING THE PANELS, YOU HAVE AGREED THAT EVERY CLAIM, CONTROVERSY OR DISPUTE (EACH AN "ACTION") BETWEEN YOU AND THE COMPANY ARISING OUT OF OR RELATING TO THIS LIMITED WARRANTY OR THE BREACH THEREOF OR RELATING TO THE PANELS SHALL BE SETTLED BY FINAL AND BINDING ARBITRATION. **YOU AND THE COMPANY AGREE THAT ANY ACTION WILL BE ARBITRATED ON AN INDIVIDUAL BASIS AND THAT NO CLAIM(S) WILL BE CONSOLIDATED OR AGGREGATED WITH THE CLAIM(S) OF ANY OTHER PERSON BY CLASS ACTION, CLASS ARBITRATION, IN A REPRESENTATIVE CAPACITY OR OTHERWISE.** TO ARBITRATE AN ACTION AGAINST THE COMPANY, YOU MUST INITIATE THE ARBITRATION, FOR U.S. CLAIMS, IN ACCORDANCE WITH THE FEDERAL ARBITRATION ACT, TO BE CONDUCTED BY A SINGLE ARBITRATOR IN ACCORDANCE WITH THE RULES OF THE AMERICAN ARBITRATION ASSOCIATION, AND FOR CANADIAN CLAIMS, IN ACCORDANCE WITH THE ARBITRATION ACT, R.S.A. 2000, c.A-43, ALBERTA, AS MAY BE AMENDED, AND YOU MUST COMMENCE THE ARBITRATION AND PROVIDE WRITTEN NOTICE TO THE COMPANY BY CERTIFIED MAIL AT THE ADDRESS NOTED BELOW WITHIN THE TIME PERIOD SET OUT BELOW.

IF YOU PREVAIL ON YOUR CLAIMS IN THE ARBITRATION, THE COMPANY WILL REIMBURSE YOU FOR ANY FILING AND ADMINISTRATIVE FEES PAID BY YOU TO THE ARBITRATION ORGANIZATION.

YOU AND THE COMPANY AGREE THAT THE ARBITRATION, ALL PROCEEDINGS THEREUNDER AND THE RULING OR AWARD OF THE ARBITRATOR SHALL BE AND REMAIN CONFIDENTIAL AND SHALL NOT BE DISCLOSED TO ANY THIRD PARTIES. You and the Company acknowledge and agree that a breach of confidentiality by a party may cause irreparable harm to the other party. The party who breaches this confidentiality provision agrees that money damages would not be a sufficient remedy, and that in addition to all other remedies, the non-breaching party shall be entitled to injunctive or other equitable relief as a remedy for any such breach, and the breaching party further agrees to waive any requirement for the securing or posting of any bond in connection with such remedy. In the event of litigation or arbitration relating to this confidentiality provision, if an arbitrator or a court of competent jurisdiction determines that any party has breached this confidentiality provision, such breaching party shall be liable for and shall pay to the other party the reasonable legal fees and other costs incurred by the Disclosing Party in connection with such arbitration or litigation, including any appeal therefrom.

Some jurisdictions do not allow mandatory arbitration, so the above arbitration provision may not apply to you in those jurisdictions. An Action may also be referred to another arbitration organization if you and the Company agree in writing. The Company will not elect arbitration for any Action you file in court in which you agree not to seek to recover more than \$25,000, including attorney's fees and costs, so long as the claim is individual and pending only in that court. You may also reject this arbitration provision by notifying the Company in writing within 45 days of the installation of the Panels or the valid transfer of this Limited Warranty to you. If any portion of this arbitration provision is not enforced in the arbitration, then either you or the Company can file a lawsuit in court to adjudicate the arbitrability of the Action and the enforceability of the portion of the arbitration provision at issue.

ONE YEAR LIMITATION: ACTION FOR BREACH OF THIS LIMITED WARRANTY OR ANY OTHER ACTION AGAINST THE COMPANY ARISING OUT OF OR RELATING TO THE PANELS SHALL **NOT** BE BROUGHT LATER THAN ONE YEAR AFTER ANY CAUSE OF ACTION HAS ACCRUED. IN JURISDICTIONS WHERE STATUTORY CLAIMS OR IMPLIED WARRANTIES AND CONDITIONS CANNOT BE EXCLUDED, ALL SUCH STATUTORY CLAIMS, IMPLIED WARRANTIES AND CONDITIONS AND ALL RIGHTS TO BRING ACTIONS FOR BREACH THEREOF EXPIRE ONE YEAR (OR SUCH LONGER PERIOD OF TIME IF MANDATED BY APPLICABLE LAWS) AFTER THE DATE OF PURCHASE. SOME JURISDICTIONS DO NOT ALLOW LIMITATIONS ON HOW LONG AN IMPLIED WARRANTY OR CONDITION LASTS, SO THE ABOVE LIMITATION MAY NOT APPLY TO YOU.

If any provision of this Limited Warranty if determined by a court of competent jurisdiction to be invalid, void or unenforceable, the remaining provisions shall continue in full force and effect.

This Limited Warranty applies to Panels purchased in the US or Canada on or after September 10, 2020 and supersedes any previously published warranties. The Company may from time to time amend the terms of this Limited Warranty, and the terms and conditions of the Limited Warranty in effect at the time of your purchase of the Panels shall govern your Panels. Dealers and installers of the Panel(s) are not authorized to extend or modify the terms of this Limited Warranty in any manner.

Manufactured by **DECRA Roofing Systems, Inc.**
1230 Railroad Street, Corona, CA 92882