

SOIL EVALUATION REPORT

in accordance with SPS 385, Wis. Adm. Code

Attach complete site plan on paper not less than 8 1/2 x 11 inches in size. Plan must include, but not limited to: vertical and horizontal reference point (BM), direction and percent slope, scale or dimensions, north arrow, and location and distance to nearest road.

Please print all information.

Personal information you provide may be used for secondary purposes (Privacy Law, s. 15.04 (1) (m)).

| | |
|-------------|-------------------|
| County | Marathon |
| Parcel I.D. | 145-2707-095-0994 |
| Reviewed by | Date |

| | | | | | | | |
|---|-------|----------|--------------|--|---|---|-----------------------|
| Property Owner John Ciulla | | | | Property Location Gov't Lot 4 S 9 T 27 N R 7 E (or) W | | | |
| Property Owner's Mailing Address 5200 Hampton Road | | | | Lot # | Block # | Subd. Name or CSM# PCL 2 CSM VOL 9 PG 77 (#2293) (DOC #757591) | |
| City | State | Zip Code | Phone Number | <input type="checkbox"/> City | <input checked="" type="checkbox"/> Village | <input type="checkbox"/> Town | Nearest Road |
| Stevens Point | WI | 54482 | 715-321-4838 | | Kronenwetter | | 896 Gardner Park Road |

New Construction Use: Residential/Number of bedrooms 3 Code derived design flow rate 450 GPD

Replacement Public or commercial-Describe: _____

Parent Material Loamy deposits over sandy outwash Flood Plain elevation if applicable _____ ft.

General Comments and recommendations: The area between soil pits 1, 2, and 3 is suitable for an in ground conventional septic system. The plot plan shows 2-70' cells consisting of 17 - 4' Quick 4 Standard Chambers with 1' endcaps. Recommended system bottom El. = 94.5 if installed as shown.

1 Boring # Boring
 Pit Ground surface elev. 96.59 ft Depth to limiting factor 123 in.

| Horizon | Depth in. | Dominant Color Munsell | Redox Description Qu. Sz. Cont. Color | Texture | Structure Gr. Sz. Sh. | Consistence | Boundary | Roots | Soil Application Rate GPD/ft ² | |
|---------|-----------|------------------------|---------------------------------------|---------|-----------------------|-------------|----------|-------|---|--------|
| | | | | | | | | | *Eff#1 | *Eff#2 |
| 1 | 0-7 | 10YR 3/3 | - | SL | 2MGR | MVFR | AW | 3VF-C | 0.6 | 1.0 |
| 2 | -19 | 7.5YR 4/4 | - | LS | 1MABK | MFR | CW | 3VF-M | 0.7 | 1.6 |
| 3 | -40 | 10YR 4/6 | - | S | SG | ML | CW | 2VF-F | 0.7 | 1.6 |
| 4 | -123 | 10YR 6/6 | - | GRS | SG | ML | - | 1VF | 0.7 | 1.6 |
| | | | | | | | | | | |
| | | | | | | | | | | |
| | | | | | | | | | | |

2 Boring # Boring
 Pit Ground surface elev. 98.0 ft Depth to limiting factor 119 in.

| Horizon | Depth in. | Dominant Color Munsell | Redox Description Qu. Sz. Cont. Color | Texture | Structure Gr. Sz. Sh. | Consistence | Boundary | Roots | Soil Application Rate GPD/ft ² | |
|---------|-----------|------------------------|---------------------------------------|---------|-----------------------|-------------|----------|-------|---|--------|
| | | | | | | | | | *Eff#1 | *Eff#2 |
| 1 | 0-7 | 10YR 3/3 | - | SL | 2MGR | MVFR | AS | 3VF-C | 0.6 | 1.0 |
| 2 | -21 | 7.5YR 4/4 | - | LS | 1MABK | MFR | CW | 3VF-M | 0.7 | 1.6 |
| 3 | -45 | 10YR 4/6 | - | S | SG | ML | CW | 2VF-F | 0.7 | 1.6 |
| 4 | -119 | 10YR 6/6 | - | GRS | SG | ML | - | 1VF | 0.7 | 1.6 |
| | | | | | | | | | | |
| | | | | | | | | | | |
| | | | | | | | | | | |

* Effluent #1 = BOD₅>30<220 mg/L and TSS >30≤150 mg/L

* Effluent #2 = BOD₅≤30 and TSS ≤30 mg/L

| | | |
|---|---|------------------------------------|
| CST Name (Please Print) Isaac Barber | Signature  | CST Number 1552010 |
| Address PO Box 434 Marathon WI 54448 | Date Evaluation Conducted 12/19/2022 | Telephone Number (715) 443-6115 |

Boring # 3 Boring Pit
 Ground surface elev. 98.26 ft Depth to limiting factor 120 in.

| Horizon | Depth in. | Dominant Color Munsell | Redox Description Qu. Sz. Cont. Color | Texture | Structure Gr. Sz. Sh. | Consistence | Boundary | Roots | Soil Application Rate | |
|---------|-----------|------------------------|---------------------------------------|---------|-----------------------|-------------|----------|-------|-----------------------|--------|
| | | | | | | | | | GPD/ft ² | |
| | | | | | | | | | *Eff#1 | *Eff#2 |
| 1 | 0-6 | 10YR 3/3 | - | SL | 2MGR | MVFR | AS | 3VF-C | 0.6 | 1.0 |
| 2 | -24 | 7.5YR 4/4 | - | LS | 1MABK | MFR | CW | 3VF-M | 0.7 | 1.6 |
| 3 | -49 | 10YR 4/6 | - | S | SG | ML | CW | 2VF-F | 0.7 | 1.6 |
| 4 | -120 | 10YR 6/6 | - | GRS | SG | ML | - | 1VF | 0.7 | 1.6 |
| | | | | | | | | | | |
| | | | | | | | | | | |
| | | | | | | | | | | |

Boring # Boring Pit
 Ground surface elev. _____ ft Depth to limiting factor _____ in.

| Horizon | Depth in. | Dominant Color Munsell | Redox Description Qu. Sz. Cont. Color | Texture | Structure Gr. Sz. Sh. | Consistence | Boundary | Roots | Soil Application Rate | |
|---------|-----------|------------------------|---------------------------------------|---------|-----------------------|-------------|----------|-------|-----------------------|--------|
| | | | | | | | | | GPD/ft ² | |
| | | | | | | | | | *Eff#1 | *Eff#2 |
| | | | | | | | | | | |
| | | | | | | | | | | |
| | | | | | | | | | | |
| | | | | | | | | | | |
| | | | | | | | | | | |
| | | | | | | | | | | |
| | | | | | | | | | | |

Boring # Boring Pit
 Ground surface elev. _____ ft Depth to limiting factor _____ in.

| Horizon | Depth in. | Dominant Color Munsell | Redox Description Qu. Sz. Cont. Color | Texture | Structure Gr. Sz. Sh. | Consistence | Boundary | Roots | Soil Application Rate | |
|---------|-----------|------------------------|---------------------------------------|---------|-----------------------|-------------|----------|-------|-----------------------|--------|
| | | | | | | | | | GPD/ft ² | |
| | | | | | | | | | *Eff#1 | *Eff#2 |
| | | | | | | | | | | |
| | | | | | | | | | | |
| | | | | | | | | | | |
| | | | | | | | | | | |
| | | | | | | | | | | |
| | | | | | | | | | | |
| | | | | | | | | | | |

* Effluent #1 = BODs>30<220 mg/L and TSS >30≤150 mg/L

* Effluent #2 = BODs≤30 and TSS ≤30 mg/L

Project:

John Ciulla
Govt. Lot 4, Sec. 9, T.27N-R.7E,
Village of Kronenwetter, Marathon County
PIN#: 145-2707-095-0994
Date Map Created: 12-21-22

Created By:

Star Environmental, Inc.
PO Box 434 Marathon, WI 54448
Phone: (715) 443-6115
Email: Starenvironmental@hotmail.com

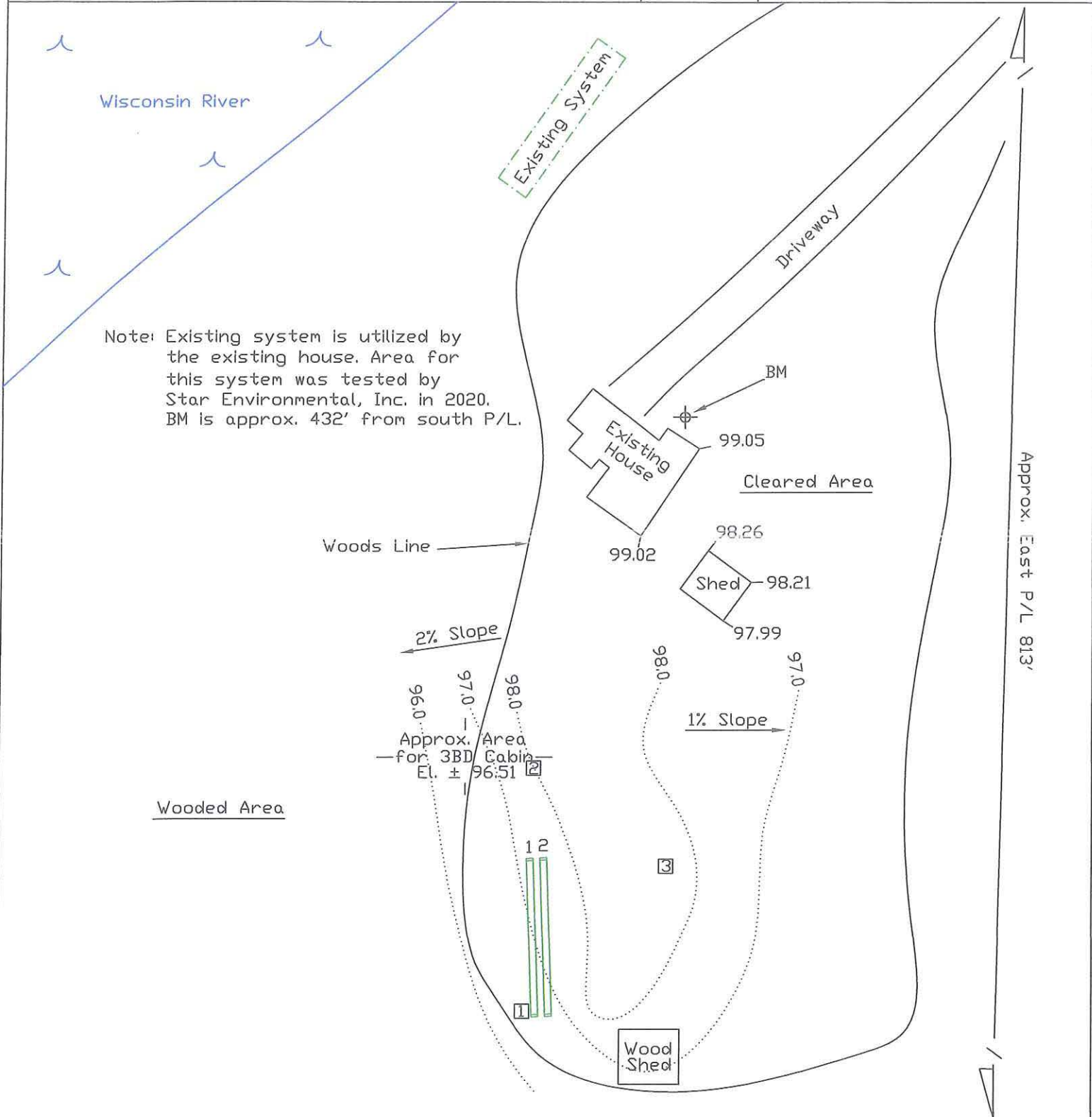

Scale: 1" = 60' Unless Noted



This is not a certified survey map

Legend:

- Flags
- BM - Top of Well El. = 100.0
- Soil Pits

