

LOCATION MAP
N.T.S.

ALL AS-BUILT INFORMATION IS BASED UPON A COMBINATION OF VISIBLE ITEMS MADE DURING FIELD OBSERVATION (I.E. MANHOLES VALVES, HYDRANTS, ETC.). LOCATIONS OF UNDERGROUND ITEMS ARE APPROXIMATE AND BASED UPON A COMBINATION OF UTILITY COMPANY FIELD MARKINGS AND DESIGN PLANS.

I, BENJAMIN W. JENKINS (TN PE #119843), HEREBY CERTIFY THAT I AM AN ENGINEER LICENSED IN THE STATE OF TENNESSEE. I HAVE REVIEWED THE INFORMATION BASED ON FIELD SURVEY DATA PROVIDED TO ME BY BRYAN SAUCEMAN, A STATE OF TENNESSEE REGISTERED LAND SURVEYOR (TN RLS #2846).

BASED ON THE AFOREMENTIONED SURVEY AND TO THE BEST OF MY KNOWLEDGE, INFORMATION, AND BELIEF, THE SANITARY SEWER, WATERLINE, & STORM SEWER IMPROVEMENTS SHOWN ON THIS PLAN FUNCTION AS INTENDED ON THE APPROVED DESIGN FOR THIS DEVELOPMENT.

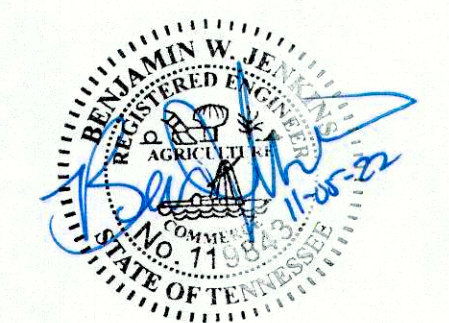

BENJAMIN W. JENKINS, P.E.

I, BRYAN SAUCEMAN (RLS #2846), HEREBY CERTIFY THAT I AM A LAND SURVEYOR REGISTERED IN THE STATE OF TENNESSEE. I HAVE LOCATED ALL VISIBLE, MANMADE WATERLINE AND SANITARY SEWER FEATURES SHOWN ON THIS PLAN ON NOVEMBER 5, 2022. I CERTIFY THE LOCATION, ELEVATION AND DESCRIPTION OF THESE FEATURES.

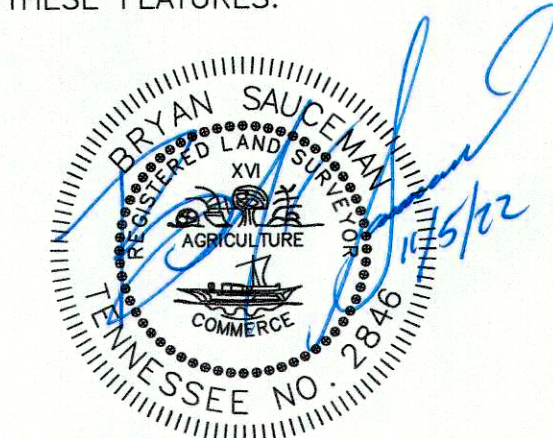

BRYAN SAUCEMAN, PLS
ALLEY & ASSOCIATES, INC.

- LEGEND**
- MH MANHOLE
 - PVC POLYVINYL CHLORIDE PIPE
 - CI CURB INLET
 - WV WATER VALVE
 - FH FIRE HYDRANT
 - INV INVERT
 - WM WATER METER
 - HDPE HIGH-DENSITY POLYETHYLENE PIPE
 - CB CATCH BASIN
 - P.B. PLAT BOOK
 - D.B. DEED BOOK
 - PG. PAGE
 - EP EDGE OF PAVEMENT
 - CONC CONCRETE
 - SAN SEWER LINE
 - RIP RAP
 - CLEAN OUT

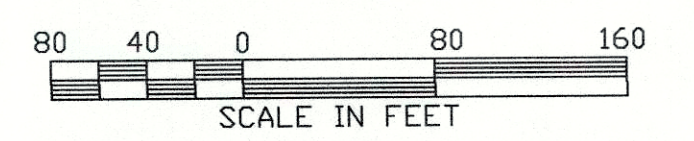

DATE:	
REVISIONS:	

**STORM, SANITARY SEWER & WATER AS-BUILT
MILLER PARKE PHASE 2
KINGSPORT, TENNESSEE**

ALLEY & ASSOCIATES, INC.
SURVEYORS
243 E. MARKET STREET KINGSPORT, TENNESSEE 37660
TELEPHONE (423) 392-8806
FAX (423) 392-8899
E-Mail: bsauceman@alleyassociates.com