



**City of Ketchum
Planning & Building**

IN RE:)
)
TNT Taproom) **KETCHUM HISTORIC PRESERVATION COMMISSION**
Request to Alter a Historic Structure) **FINDINGS OF FACT, CONCLUSIONS OF LAW, AND**
) **DECISION**
)
Date: February 7, 2023)
)
File Numbers: H22-051)

PROJECT: TNT Taproom Historic Building Alteration Request

FILE NUMBER: H22-065

APPLICATION TYPE: Request to Alter a Historic Structure

REPRESENTATIVE: Joey Stevenson, Architect

PROPERTY OWNER: PM Lemman Investments LLC (Max Lemman)

REQUEST: Proposal to modify existing 2nd floor balcony to allow for patron use

LOCATION: 271 E Sun Valley Rd (Ketchum Townsite S W 23' x 30' of Lot 4 Blk 17)

ZONING: Retail Cor Subdistrict of the Community Core (CC-1)

NOTICE: The public hearing notice was published in the Idaho Mountain Express on December 14th, 2022. A public hearing notice was mailed to adjacent properties within 300 feet of the project site on December 14th, 2022. A public hearing notice was posted on the project site on December 14th, 2022. A public hearing notice was posted on the City website on December 14th, 2022.

REVIEWER: Adam Crutcher, Associate Planner

RECORD OF PROCEEDINGS

The Historic Preservation Commission held a public hearing and considered the Request to Alter a Historic Structure for the proposed alteration of the TNT Taproom, historically known as the Dynamite Shed, located at 271 E Sun Valley Road during their meeting on January 4th, 2023. After considering the project plans, staff's analysis, and the applicant's presentation and holding the required public hearing, the Historic Preservation Commission unanimously approved the request.

FINDINGS OF FACT

The Historic Preservation Commission having reviewed the project record, provided notice, and conducted the required public hearing does hereby make and set forth these Findings of Fact, Conclusions of Law, and Decision as follows:

Findings Regarding Project Background

The applicant, PM Lemman Investments LLC, has submitted a Request to Alter a Historic Structure located at 271 E Sun Valley Rd (Ketchum Townsite Lot S W 23' x 30' of 4 Blk 17) within the Retail Core Subdistrict of the Community Core (CC-1) Zone. The building is currently occupied and known as TNT Taproom, a bar establishment, but has been referred to historically as the Dynamite Shed. The request proposes to modify the existing second floor balcony by raising the height of the existing railing, adding a backsplash and two proposed light fixtures as shown in Attachment B.

The project is subject to Historic Preservation Commission (HPC) review pursuant to KMC 17.20.010.B. HPC review is required for all requests for partial or total demolitions, exterior alterations, and additions to all structures on the Historic Building List.

Findings Regarding Review Criteria for Requests to Alter or Demolish a Historic Structure

17.20.030.C.1 - Is the structure of historic or architectural value or significance and does it contribute to the historic significance of the property within the Community Core?

The Dynamite Shed is one of the 24 structures on the Historic Building List adopted by the HPC on October 19, 2021. The 2005 Walsworth Associates Windshield Survey identified the Dynamite Shed as a historic building due to its themes of commerce/trade and culture. As mentioned above, the existing structure was built in 1880 for the purpose of storing explosives sold by the Gillette & Evans hardware store on Main Street and is a rare example in Ketchum of a stone building from the 1800's.

The Dynamite Shed building has social and cultural value to the community and architectural significance within downtown Ketchum. The original structure is an example of Ketchum's mining history in the 1880's and early 1890's. The building was also occupied by Bobbie Burns who is a key figure of Ketchum's ski industry in the 1970's & 1980's. The use of stone is one of the few remaining examples of that style of architecture in the 1800's. Many of the other stone buildings constructed in the 1800's are no longer present within the community.

Due to the building being situated in its original location and the stone architecture still remaining on the ground floor, staff believes the structure is still of historic and architectural significance.

17.20.030.C.2 - Would the loss, alteration of, or addition to, the structure adversely affect the historic integrity of the structure, impact the significance of the structure within the Community Core, impact the architectural or aesthetic relationship to adjacent properties, or conflict with the Comprehensive Plan?

Historic integrity measures how effectively a building's materials, design, feeling, location, association, workmanship, and setting convey the property's historic significance. The Dynamite Shed has been heavily altered since its original construction in 1880. While the structure has remained in its same location and retained its original stone materiality, additions and alterations have changed the appearance of the building.

The proposed project includes the elevation of the existing guardrail, installation of a backsplash, as well as two exterior lighting fixtures. The alteration of the guardrail does not negatively impact the historic or architectural integrity of the structure as the deck was an addition to the original structure and has been altered multiple times over the past 60 years. The proposed deck alteration raises the height of the existing guardrail for patron safety and will keep the same architectural style which currently exists. The deck alteration follows standard #9 of the Secretary of the Interior Standards for Rehabilitations which states,

"New additions, exterior alteration, or related new construction shall not destroy historic materials that characterize the property. The new work shall be differentiated from the old and shall be compatible with the massing, size, scale and architectural features to protect the historic integrity of the property and its environment".

The proposed alteration to the guardrail will be compatible with the existing building as it only raises the height of the railing and does not propose to redesign the guardrail system to a different architectural style. The proposal will keep the same coloration of the existing deck and the proposal is minor in nature. The alteration does not impact the historic stone elements of the building on the ground floor which is the primary historic and architecturally significant aspect of the structure.

One of the vision statements located within Chapter 4 of the 2014 Ketchum Comprehensive Plan states, "Protect and support our architectural heritage through appropriate historic preservation standards and guidelines". This vision statement is being met as the HPC has identified the building as historic and is reviewing the proposed alteration against the criteria determined by the HPC.

As the proposed alteration does not impact the stone material on the ground floor, staff believes the project does not adversely affect the historic integrity of the structure, impact the significance of the structure or is in conflict with the Comprehensive Plan.

17.20.030.C.3 - Does the structure retain the requisite integrity to convey its historic and/or architectural significance?

Staff believes the Dynamite Shed retains its historic integrity through the feeling and association conveyed through the stone materials used to house mining supplies in the 1880's. The building is in good condition and contains the same stone materials from the original construction. Many alterations have occurred after the original construction and have changed the architectural characteristics of the building, primarily on the second floor. As many of the alterations have occurred on the second floor, the buildings still retains the stone material on the ground floor which makes the building architecturally significant.

17.20.030.C.4 - Does the proposed demolition or alteration adversely affect the historic significance or architectural distinction of the structure or the Community Core?

The proposed alteration/addition does not adversely affect the historic significance or architectural distinction of the structure. The alterations/additions won't detract from the existing historical qualities which make the existing building significant (original stone structure being used for mining supplies). The architectural significance of the Dynamite Shed is it being one of the few remaining stone structures from the 1800's. This architectural significance will not be negatively impacted due to the proposed additions/alterations as they are focused around the second-floor deck.

Findings Regarding Commissioner Deliberations

The Commission requested the applicant revise elevations to correctly reflect the size of the 2nd floor windows as well as provide a manufacturers sheet of the proposed exterior lighting. Otherwise, the Commission found that the project met all the criteria for alterations to a historic structure and approved to the project with a vote of 5-0.

CONCLUSIONS OF LAW

1. The City of Ketchum is a municipal corporation established in accordance with Article XII of the Constitution of the State of Idaho and Title 50 Idaho Code and has exercised its authority pursuant to Chapter 46 of Title 67 of Idaho Code to establish a historic preservation program and enact ordinances, special conditions, or restrictions for the protection and preservation of historic properties. The regulations adopted through Interim Historic Preservation Ordinance No. 1216 are identified in the Findings of Fact and are herein restated as Conclusions of Law by reference.
2. The Historic Preservation Commission has the authority to hear the applicant's Request to Alter a Historic Structure application pursuant to KMC 17.20.010.B. HPC review is required for all requests for partial or total demolitions, exterior alterations, and additions to all structures on the Historic Building List.
3. The City of Ketchum Planning Department provided notice for the review of this application in accordance with Section 17.20.030.B and Ketchum Municipal Code § 17.96.080.
4. This Request to Alter a Historic Structure application is governed under the regulations and review criteria specified in Ketchum Municipal Code 17.20.030.C.

DECISION

THEREFORE, the Ketchum Historic Preservation Commission **approves** the Request to Alter a Historic Structure (Application File No. H22-065) at 271 E Sun Valley Road.

CONDITIONS OF APPROVAL

1. This approval is based upon the project plan set dated February 1st, 2023, as seen in Attachment A. Building Permit plans for all on-site improvements must conform to the above mentioned Historic Alteration plans unless otherwise approved in writing by the Historic Preservation Commission.
2. The term of Historic Alteration request shall be twelve (12) months from the date that the Findings of Fact, Conclusions of Law, and Decision are adopted by the Commission or upon appeal, the date the approval is granted by the Council subject to changes in zoning regulations.

Findings of Fact **adopted** this 7th day of February 2023.

Spencer Cordovano, Chair
City of Ketchum
Historic Preservation Commission

Attachment A:
271 E Sun Valley Road Historic Alteration
Plans

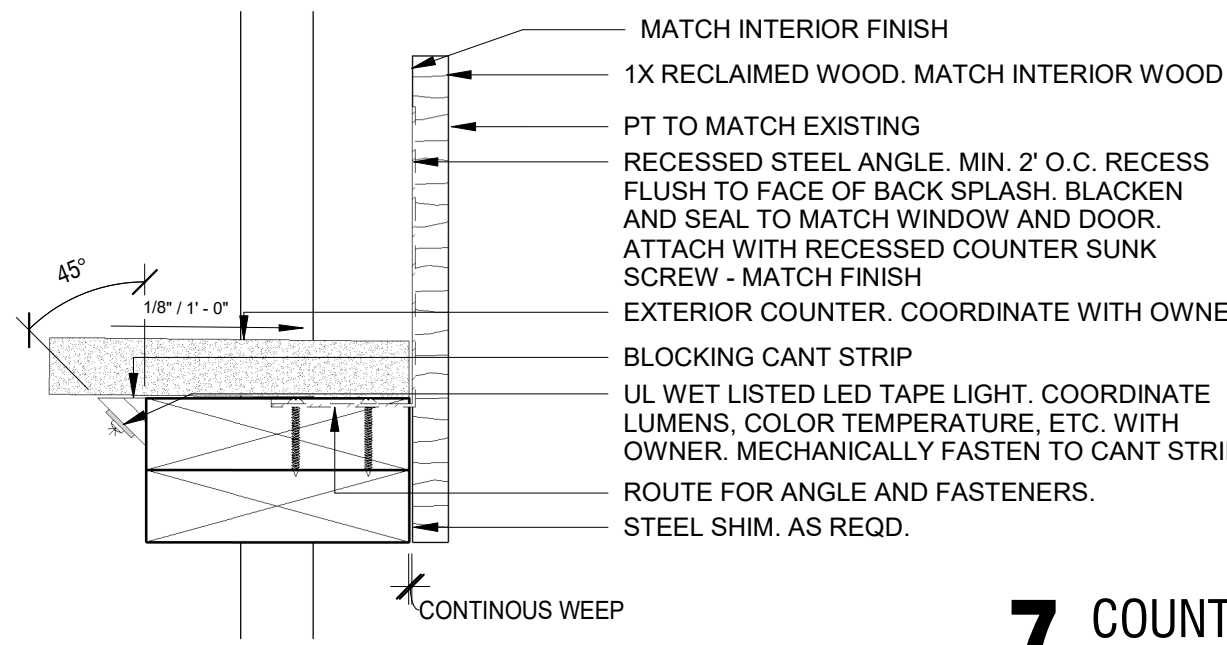

7 COUNTER DETAIL
SCALE: 3" = 1'-0"

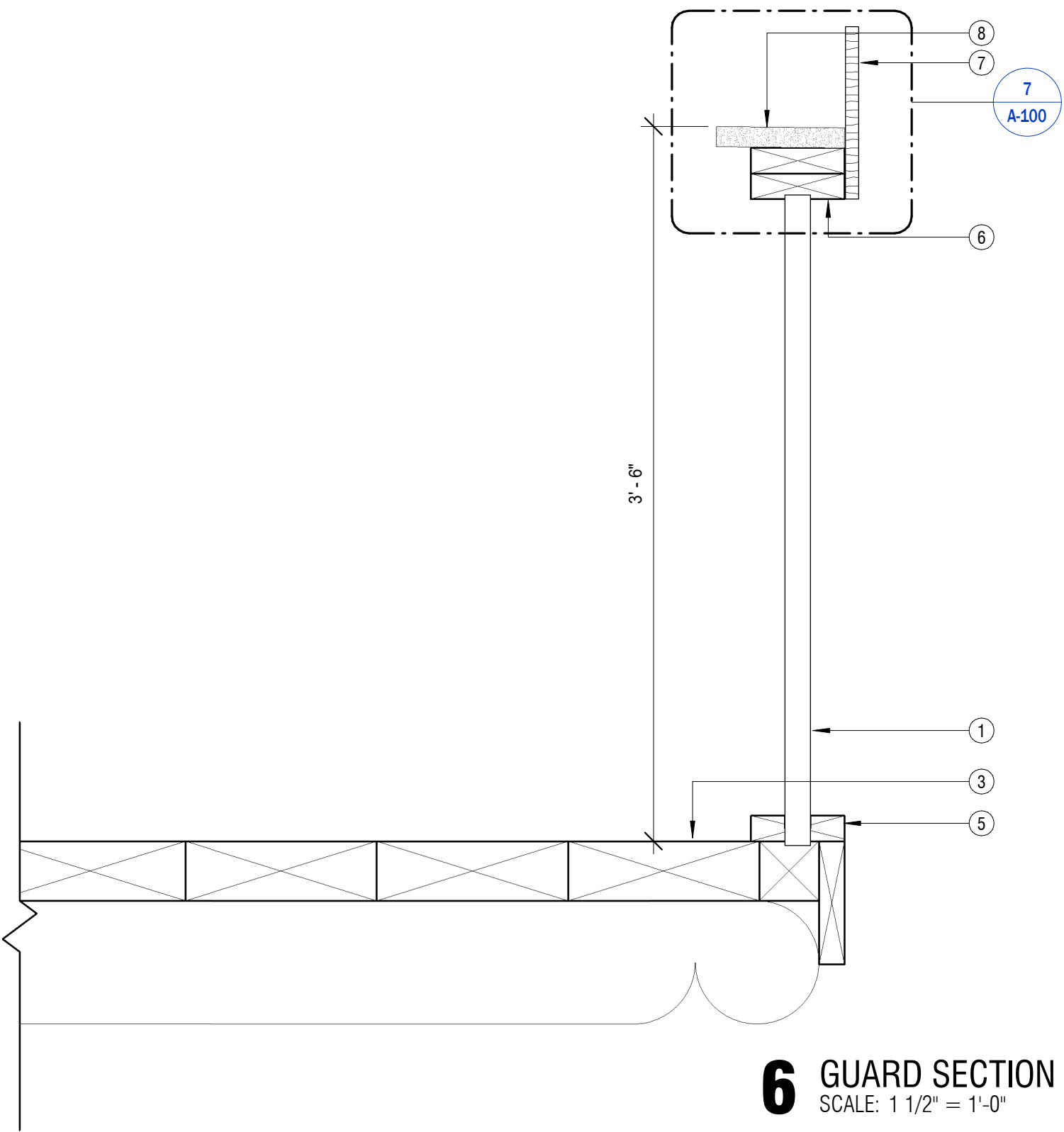

6 GUARD SECTION
SCALE: 1 1/2" = 1'-0"

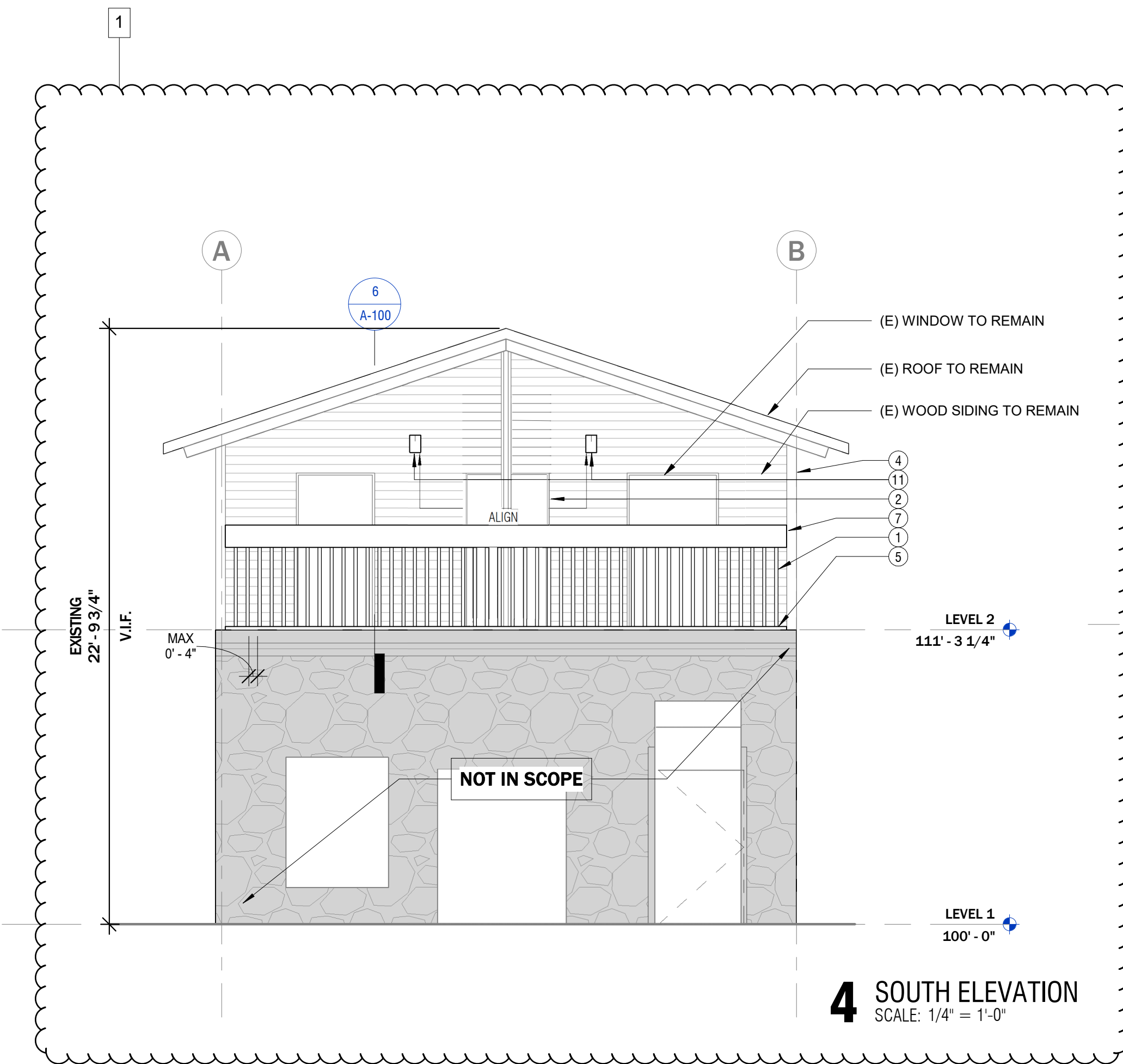

4 SOUTH ELEVATION
SCALE: 1/4" = 1'-0"

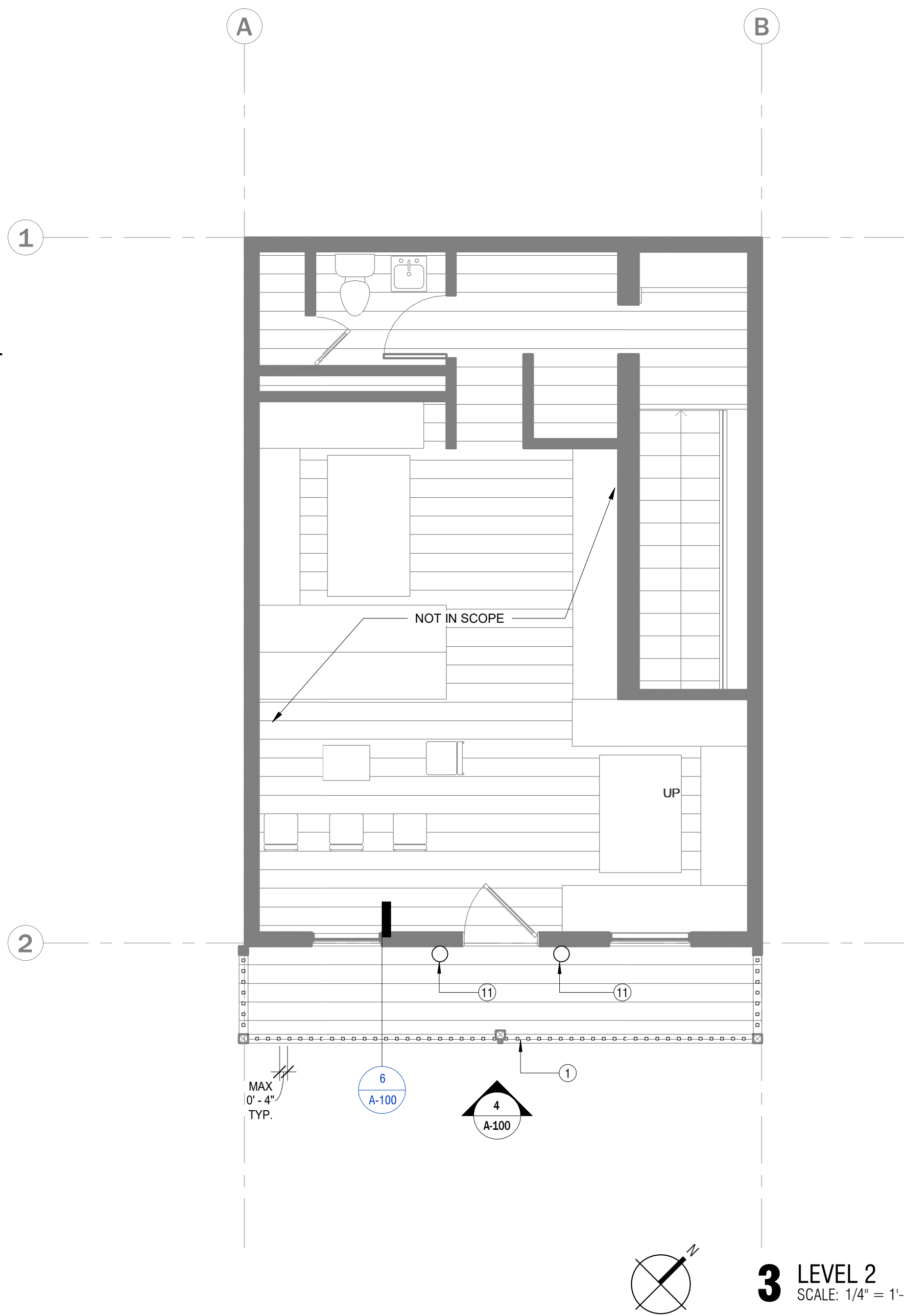

3 LEVEL 2
SCALE: 1/4" = 1'-0"

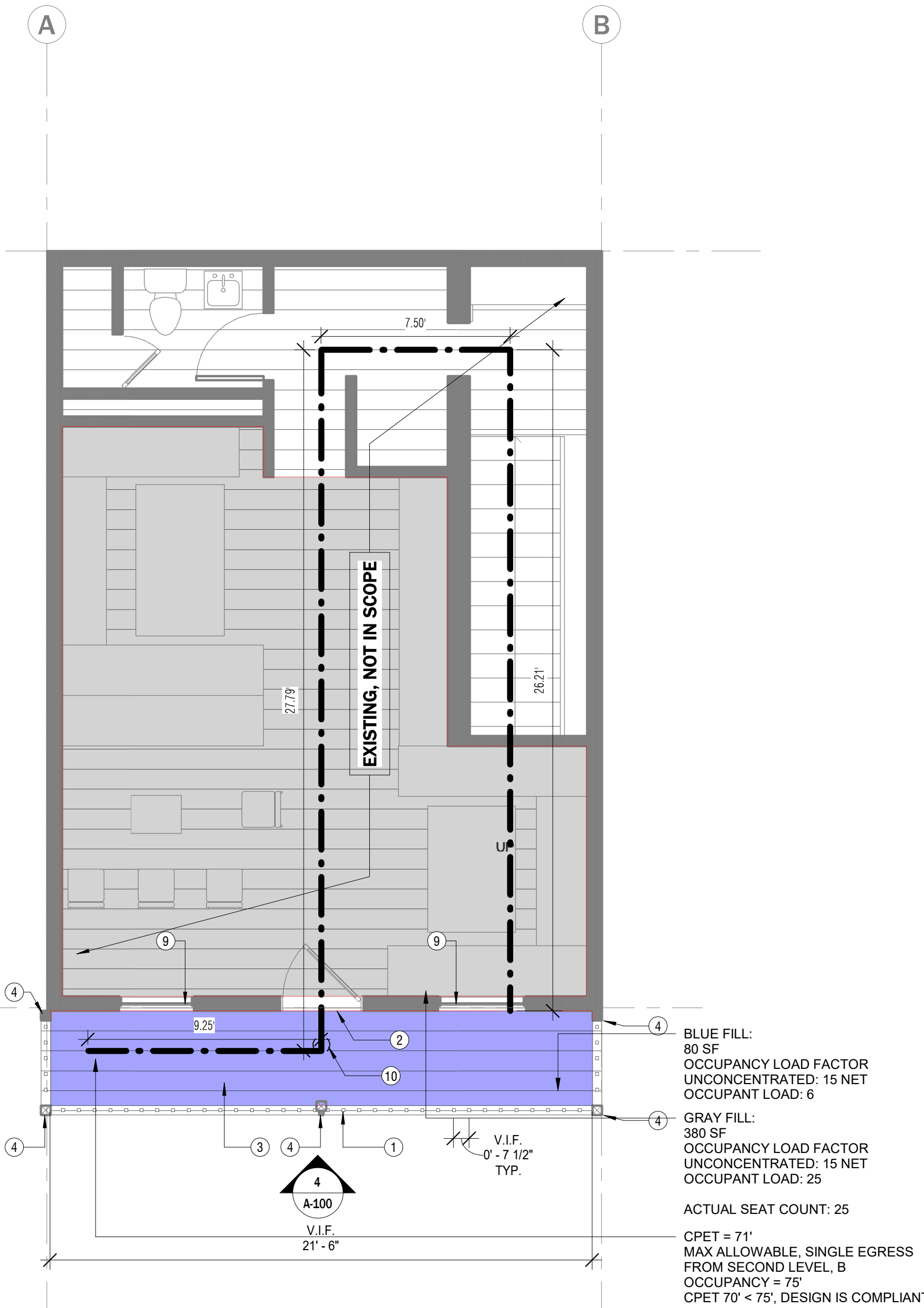

2 LEVEL 2 - DEMO
SCALE: 1/4" = 1'-0"

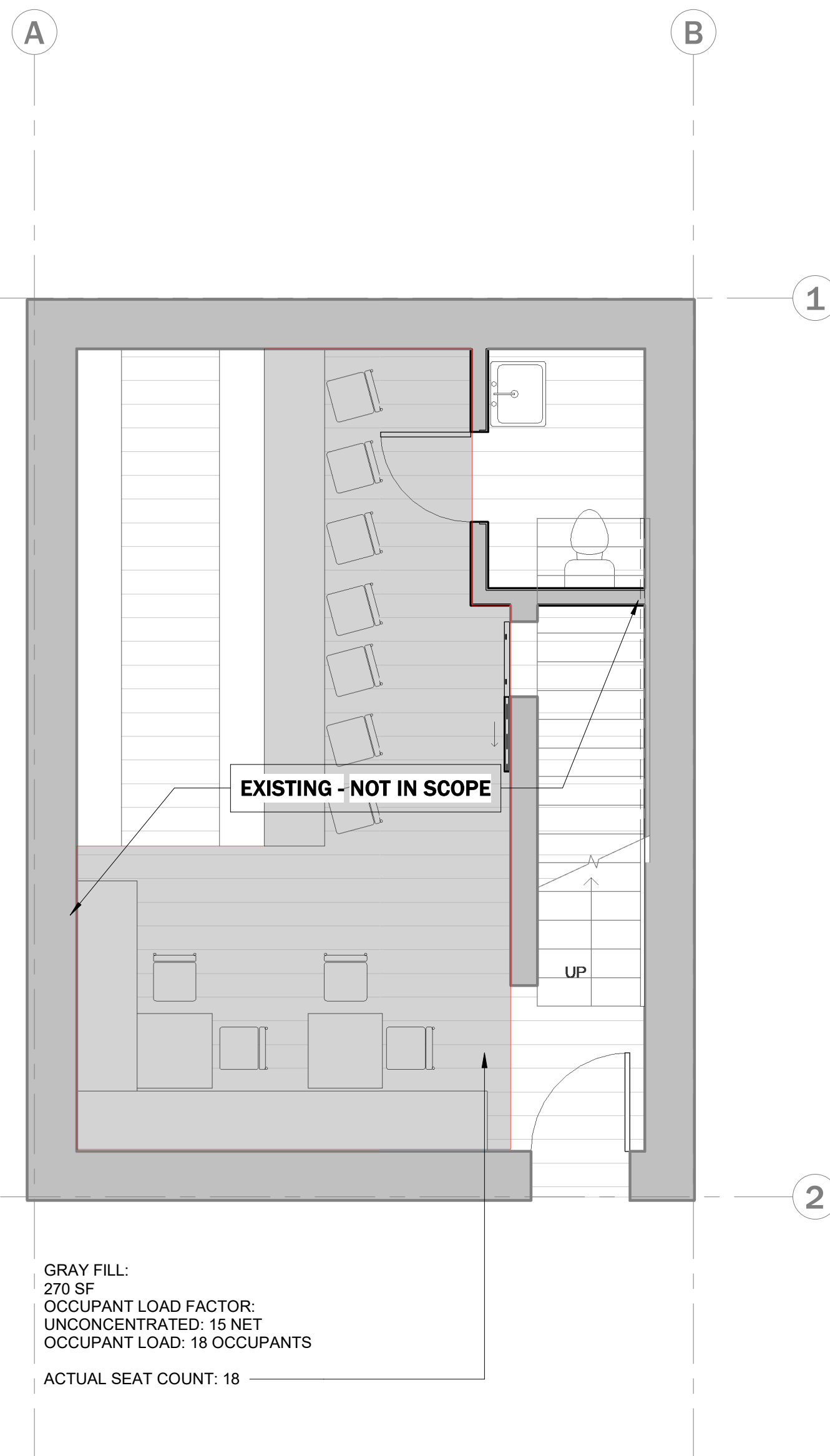

1 LEVEL 1 - EXISTING
SCALE: 1/4" = 1'-0"

PROJECT DATA

PROJECT ADDRESS
271 E SUN VALLEY RD., KETCHUM, IDAHO 83340

PARCEL #
RPK0000017004A

LEGAL DESCRIPTION
KETCHUM LOT 5 W 23' X 30' OF 4 BLK 17

APPLICABLE CODES
AS ADOPTED AND AMENDED BY THE CITY OF KETCHUM
2018 INTERNATIONAL EXISTING BUILDING CODE
IDAHO BUILDING CODE (2018 IBC)
2018 IECC
MECHANICAL CODE OF 2018 OF IDAHO (IMC 2018)
FUEL GAS CODE 2018 OF IDAHO (IFGC 2018)
2018 IFGC WITH AMENDMENTS
NEC 2017 OF IDAHO

ZONE DISTRICT
CC-1: COMMERCIAL CORE - RETAIL CORE

AUTHORITY HAVING JURISDICTION
CITY OF KETCHUM

PROJECT DESCRIPTION
PERMITTING AND ALTERATION TO ALLOW USE OF THE EXISTING SECOND LEVEL BALCONY. STRUCTURE IS DESIGNATED AS HISTORIC PER HPC 10.19.2021. ALTERATIONS ARE LIMITED TO LOCATIONS REQUIRING MODIFICATIONS TO BE CODE COMPLIANT. ALTERATIONS AND ADDITIONS INCLUDE GUARD RAIL, LIGHTING, AND DOOR(S).

USE & OCCUPANCY
GROUP B OCCUPANCY PER IBC 2018 303.1.1. OCCUPANT LOAD IS LESS THAN 50.

FIRE AND LIFE SAFETY
CONTRACTOR TO COORDINATE MODIFICATIONS TO FIRE AND LIFE SAFETY SYSTEMS WITH THE AHJ, AS REQUIRED.

BUILDING METRICS

AREA	GROSS	NET
1ST FLOOR	675 GSF	527 NSF
2ND FLOOR	637 GSF	589 NSF
TOTALS:	1,312 GSF	1,116 NSF

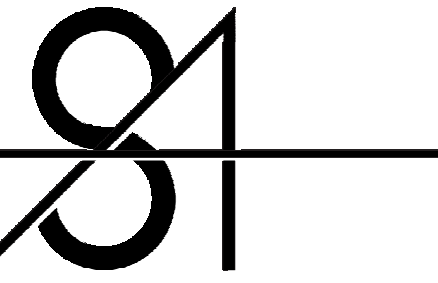

Project:

**TNT
TAPROOM**

271 SUN VALLEY ROAD,
KETCHUM, ID 83340

Client:

TNT TAPROOM

Copyright 2022
Stevenson Architecture LLC
all rights reserved

Project Team:

Owner:
PM Lemman Investments LLC
Max Lemman
208.295.6468
maxamulemman@gmail.com

Architect:
Stevenson Architecture
Joey Stevenson
208-720-3025
joey@stevensonarchitecture.com

GENERAL NOTES

- CONTRACTOR TO VERIFY ALL EXISTING CONDITIONS PRIOR TO COMMENCING WORK.
- CONTRACTOR TO ENSURE NEW GUARD RAIL COMPLIES WITH IBC 2018 - 1607.8.1 IN ACCORDANCE WITH ASCE 7, SECTION 4.5.1.1. PROVIDE VERIFICATION AS REQUIRED.
- DIMENSIONS TAKE PRECEDENCE OVER DRAWN INFORMATION.
- THE GENERAL CONTRACTOR SHALL IMMEDIATELY NOTIFY THE ARCHITECT IN WRITING IF DISCREPANCIES IN DRAWINGS AND/OR THE SPECIFICATIONS ARE DISCOVERED. COORDINATE WITH THE ARCHITECT BEFORE CONSTRUCTION PROCEEDS.
- ALL WORK PERFORMED SHALL COMPLY WITH ALL APPLICABLE LOCAL, STATE AND NATIONAL BUILDING CODES, ORDINANCES, AND REGULATIONS, AND ALL OTHER AUTHORITIES HAVING JURISDICTION.
- ALL WORK TO COMPLY WITH ANSI 117.1 2003
- ALL MANUFACTURED ITEMS, MATERIALS, AND EQUIPMENT SHALL BE APPLIED, INSTALLED, ERECTED, USED, CLEANED AND CONDITIONED IN STRICT ACCORDANCE WITH THE MANUFACTURER'S RECOMMENDATIONS.
- THE CONTRACTOR SHALL BE RESPONSIBLE FOR THE CONTENT OF THE DRAWINGS AND SPECIFICATIONS.
- CONTRACTOR TO PROVIDE SUBMITTALS TO THE ARCHITECT AND/OR THE OWNER FOR REVIEW AND APPROVAL PRIOR TO PROCEEDING WITH THE WORK.

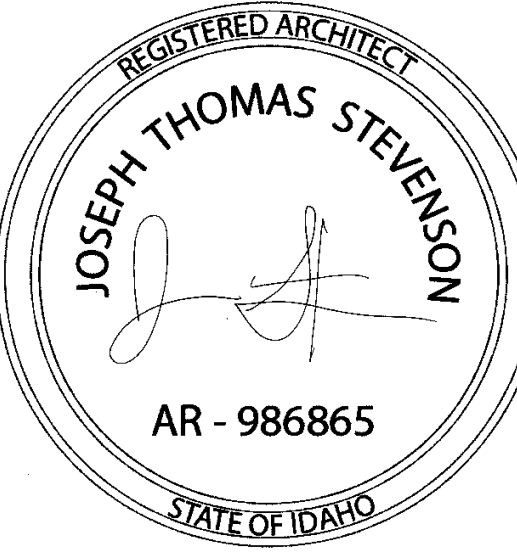

Issue:

**HPC PERMIT
SET**

ISSUES:

- HPC PERMIT SET 9/28/2022

SHEET NOTES

MARK	Note Text
1	1-1/2" SQUARE WOOD BALUSTERS, REMOVE AND REPLACE WITH NEW BALUSTERS TO MATCH, PROVIDE TIGHTER SPACING PER PLANS TO MEET CODE.
2	EXISTING DOOR, PROVIDE NEW CLOSER, PULL AND PUSH HANDLE, SIGNAGE CLEARLY STATING 'DOOR IS TO REMAIN UN LOCKED DURING BUSINESS HOURS', DOOR CLEAR DIMENSIONS ARE 39 1/2" WIDE AND 68 1/2"
3	(E) DECKING, REMOVE AND REPLACE AS NECESSARY, MATCH EXISTING, RELACE FASTENERS AS NEEDED.
4	EXISTING PATIO TIMBER STRUCTURE TO REMAIN, NO PROPOSED MODIFICATIONS. REMOVE AND REPLACE GUARDRAIL CONNECTIONS. 1. EXISTING PATIO TIMBER STRUCTURE TO REMAIN, NO PROPOSED MODIFICATIONS
5	EXISTING 2X6 ROUTED BASE PLATE FOR RAIL CONSTRUCTION, REMOVE AND REPLACE TO MATCH EXISTING.
6	DBL. TOP PLATE, MATCH EXISTING
7	BACKSPLASH, RECLAIMED WOOD, PT EXTERIOR TO MATCH EXISTING, INTERIOR FACE TO MATCH INTERIOR PANELING
8	EXTERIOR COUNTERTOP
9	(E) WINDOW TO REMAIN, NOT IN SCOPE
10	DEMO (E) LIGHT
11	WALL SCONCE, BASIS OF DESIGN DMF DCC WITH SNOOT, COORDINATE LUMEN, COLOR TEMPERATURE AND ACCESSORIES WITH OWNER, B.O. SCONCE TO ALIGN WITH T.O. DOOR.

REVISIONS:

REV 1: 02/01/2023

Scale:

As indicated

Date Printed:

9/28/2022

REMODEL

A-100



Modern Cylinder System

Project:

Type:

Product Code:

Date:

V012523

wall mount like this



- Customize your cylinder with over one million configurations
- Powered by DMF's advanced LED downlight technology
- Modular Twist & Lock trims and Plug & Play light engines for easy maintenance and on-site modifications
- Shadowless pendant upright allows for direct and indirect lighting from a single cylinder
- Die-cast aluminum with no visible hardware for a sleek, symmetrical design

Lumen Output

750 lm (10W), 1000 lm (12W), 1250 lm (14W), 1500 lm (20W), 2000 lm (28W), 2500 lm (37W), 3000 lm (40W)

Mount

Surface, Cord, Stem, Wall

Color Quality

90+ CRI, 2-step SDCM

Size

Diameter: 4" | Length: Small (4"), Medium (8"), Large (12")

Color Temperature

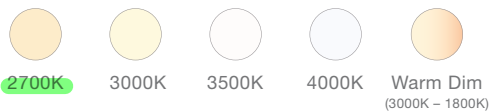

Finish

White, Black, Brushed Aluminum, Bronze, Custom Color

Stem/Cord Length

Standard: 24" or 48", Custom: Up to 156" (Cord), 96" (Stem)

Lighting Type

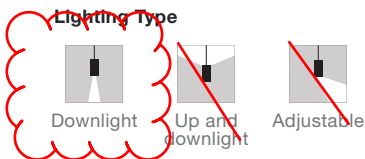

Optics

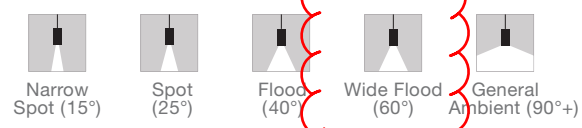

Input

120/277V

1% Dimming

TRIAC/ELV, 0-10V, Lutron EcoSystem

Emergency Lighting

Optional Remote Inverter or Emergency LED Driver for lighting up to 90 minutes in event of power failure

Trims and Shades

Round Beveled Trim, Hyperbolic Trim, Snoot, Decorative Trim, Low-Profile Decorative Trim, Round Shade, Flat Shade

Standards



Ratings

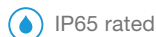

Guarantee

50,000 hrs | 5 years

PRODUCT BUILDER

CYLINDER	DC4	DC4 4" Cylinder			
MOUNT	WM	C2 Cord Mount, 24" C4 Cord Mount, 48" CC Cord Mount, Custom ¹ T2 Stem Mount, 24" T4 Stem Mount, 48" TC Stem Mount, Custom ¹ SM Surface Mount WM Wall Mount ²			
MOISTURE RATING	W	S Standard (Damp Location) W Wet Location ³			
LENGTH	M	S Small (4") M Medium (8") L Large (12")			
LIGHT OPTIONS	D	D Fixed A Adjustable ⁴			
LUMENS DOWN ⁵	10	07 750 lm 10 1000 lm 12 1250 lm ⁶ 15 1500 lm ^{6,7} 20 2000 lm ^{6,7} 25 2500 lm ^{6,7} 30 3000 lm ^{6,7}			
BEAM SPREAD DOWN	WF	GA General Ambient (90°+) ^{6,8} NS Narrow Spot (15°) SP Spot (25°) FL Flood (40°) WF Wide Flood (60°) ⁹			
SPECIALTY LENS OPTIONS DOWN	0	0 None			
LUMENS UP ^{5,9}	00	00 None 07 750 lm 10 1000 lm 12 1250 lm ¹⁰ 15 1500 lm ^{7,10} 20 2000 lm ^{7,10}			
BEAM SPREAD UP ⁹	00	00 None GA General Ambient (90°+) ^{8,10} NS Narrow Spot (15°) SP Spot (25°) FL Flood (40°) WF Wide Flood (60°) ¹⁰			
CCT	27	27 2700K 30 3000K 35 3500K 40 4000K 3W Warm Dim ¹¹			
FINISH	BK	WH White BK Black BA Brushed Aluminum BZ Bronze CC Custom Color			
DIMMING	0	O 0-10V (1%) T TRIAC/ELV (1%) C Lutron EcoSystem LDE1 (1%) ¹²			
EMERGENCY LIGHT	EM	00 None EM EM, Remote Test Switch ¹³			
TRIM / SHADE DOWN	R	R Round Beveled Trim H Hyperbolic Trim S Snoot D Decorative Trim ^{8,14} L Low Profile Decorative Trim ^{8,14} RWC Round Shade: White, Clear ¹⁵ RWW Round Shade: White, Warm ¹⁵ RBC Round Shade: Black, Clear ¹⁵ RBW Round Shade: Black, Warm ¹⁵ RAC Round Shade: Aluminum, Clear ¹⁵ RWW Round Shade: White, Warm ¹⁵ FBC Flat Shade: Black, Clear ¹⁵ FBW Flat Shade: Black, Warm ¹⁵ FAC Flat Shade: Aluminum, Clear ¹⁵ FWW Flat Shade: White, Warm ¹⁵			
TRIM UP ¹⁶		[Blank] N/A R Round Beveled Trim H Hyperbolic Trim S Snoot D Decorative Trim ^{8,14} L Low Profile Decorative Trim ^{8,14}			

¹ Requires DCCX-CC/TC Custom Length Cord/Stem, minimum length 3", maximum length 156" (Cord), 96" (Stem)

² Only available in Medium or Large size

³ Only available in Surface, Downlight Stem, or Wall Mount: 750, 1000, 1250, 1500 or 2000 lm; with Round Beveled, Decorative, or Low Profile Trim

⁴ Only available in 750 or 1000 lm; Damp Location moisture rating; Round Beveled or Hyperbolic trim

⁵ Sum of Lumens cannot be greater than 1250 lm for Small size, 2000 lm for Medium size, 3000 lm for Large size; not available in 1500 lm up & 1500 lm down

⁶ Not available in Adjustable

⁷ Only available in 0-10V or Lutron driver

⁸ Only available in 750 lm, 1000 lm, or 1250 lm

⁹ Only applicable to Medium or Large size Cord or Stem mounts, Large size Wall mounts; Otherwise, select None; Uplight for Cord and Stem Mount cannot be Adjustable

¹⁰ Not available in Adjustable Wall Mount

¹¹ Only available in 1000 lm; not available in Narrow Spot optics

¹² Only available in Large size or Medium with 750 lm, 1000 lm, or 1250 lm total

¹³ Not available in Uplight; TRIAC/ELV driver utilizes micro inverter; 0-10V or EcoSystem drivers utilize EM Kit mounted above ceiling with emergency LED driver & remote test switch

¹⁴ Only available in General Ambient beam spread

¹⁵ Not available in Wall Mount

¹⁶ Only applicable to Wall Mount Up and Downlight, Cord and Stem Mount Uplight utilize specialty trim



PRODUCT BUILDER

ACCESSORIES

DCCX-CC	Custom Length Cord Mount (up to 156")
DCCX-TC	Custom Length Stem Mount (up to 96")
DCCX-RW	Round Beveled Trim, White
DCCX-RB	Round Beveled Trim, Black
DCCX-RA	Round Beveled Trim, Brushed Aluminum
DCCX-RZ	Round Beveled Trim, Bronze
DCCX-RC	Round Beveled Trim, Custom
DCCX-HW	Hyperbolic Trim, White
DCCX-HB	Hyperbolic Trim, Black
DCCX-HA	Hyperbolic Trim, Brushed Aluminum
DCCX-HZ	Hyperbolic Trim, Bronze
DCCX-HC	Hyperbolic Trim, Custom
DCCX-S	Snoot
DCCX-RWC	Round Shade: White Outside, Clear Diffused Inside
DCCX-RWW	Round Shade: White Outside, Warm Diffused Inside
DCCX-RBC	Round Shade: Black Outside, Clear Diffused Inside
DCCX-RBW	Round Shade: Black Outside, Warm Diffused Inside
DCCX-RAC	Round Shade: Brushed Aluminum Outside, Clear Diffused Inside
DCCX-FWC	Flat Shade: White Outside, Clear Diffused Inside
DCCX-FWW	Flat Shade: White Outside, Warm Diffused Inside
DCCX-FBC	Flat Shade: Black Outside, Clear Diffused Inside
DCCX-FBW	Flat Shade: Black Outside, Warm Diffused Inside
DCCX-FAC	Flat Shade: Brushed Aluminum Outside, Clear Diffused Inside
DCCX-JW	Junction Box Cover, White
DCCX-JB	Junction Box Cover, Black
DCCX-JA	Junction Box Cover, Brushed Aluminum
DCCX-JZ	Junction Box Cover, Bronze
DCCX-JC	Junction Box Cover, Custom Color

PRODUCT SUMMARY



Large, black, stem mount with
Junction Box Cover shown

SUMMARY

LED: Cree® LED

DELIVERED LUMENS: 750 lm (10.8W), 1000 lm (12.8W), 1500 lm (20W), 2000 lm (28W), 3000 lm (40W)

EFFICACY: 80 lm/W, 85 lm/W, 97 lm/W, 86 lm/W, 79 lm/W, 82 lm/W

COLOR QUALITY: 90+ CRI, 2-step SDCM

CCT: 2700K, 3000K, 3500K, 4000K, Warm Dim

DIMMING: Down to 1% for TRIAC/ELV at 120V, 1% for 0-10V or Lutron Hi-lume® 1% at 120/277V

INPUT VOLTAGE: 120/277V, 50/60Hz

MAX INPUT CURRENT (120V): 0.10 amps, 0.13 amps, 0.13 amps, 0.35 amps, 0.35 amps

MAX INPUT CURRENT (277V): 0.04 amps, 0.05 amps, 0.05 amps, 0.15 amps, 0.15 amps

POWER FACTOR: Greater than 0.9

TOTAL HARMONIC DISTORTION: Less than 20%

AMBIENT OPERATING TEMPERATURE: -20°C to 40°C

EMERGENCY LIGHTING: Optional installer mounted Remote Inverter or Emergency LED Driver for lighting up to 90 minutes in event of power failure

PHOTOMETRIC TESTING: Tested in accordance to IESNA LM-79-2008

LISTINGS: ENERGY STAR® qualified*, California Title 24 2019 JA8 compliant, UL Listed for Wet Location (option), IP65 rated (option), UL Certified US-CA, Declare

LIFETIME: 50,000 hours at 70% lumen maintenance

CYLINDER: Extruded aluminum; 4" (small), 8" (medium), 12" (large)

FINISH: White, Black, Bronze, Brushed Aluminum, Custom Color

PENDANT: 24" or 48" standard. Cord: Custom length up to 156". White, black or silver with round canopy. Stem: Custom length up to 96". Painted steel stem with round canopy and hanging straight endpoint with up to 30° tilt (meets CA IR 16-9).

MOUNT: Surface, Cord, Stem: Installs in most 3" octagonal, 4" octagonal, 3" round and 4" round boxes. Wall Mount: Installs in most one-gang switch boxes. Wet Location Wall Mount: Installs in most two-gang switch, 3" octagonal, 4" octagonal, 3" round, 4" round and 4" square boxes.

JUNCTION BOX COVERS: Allows up to 4 solid metal conduit branches. Compatible with 4" octagonal and 4" square boxes.

WARRANTY: 5 year limited warranty

* Refer to ENERGY STAR Certified light fixtures database

CYLINDER DIMENSIONS

**Surface Mount
LED Cylinder**
DC4SM

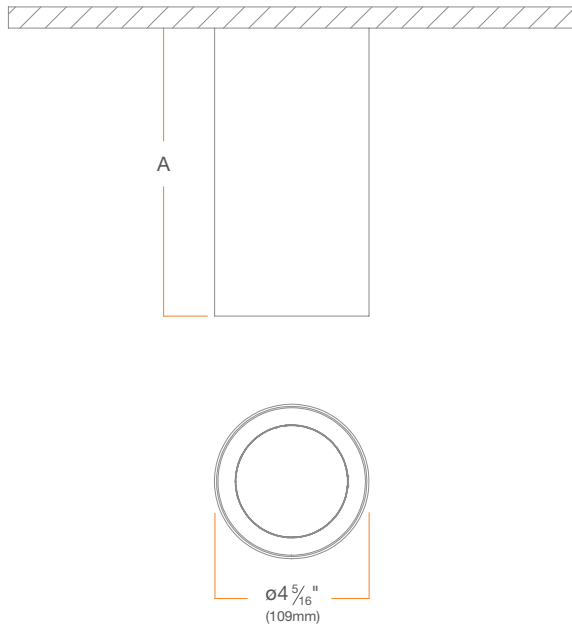

**Cord Mount
LED Cylinder**
DC4C

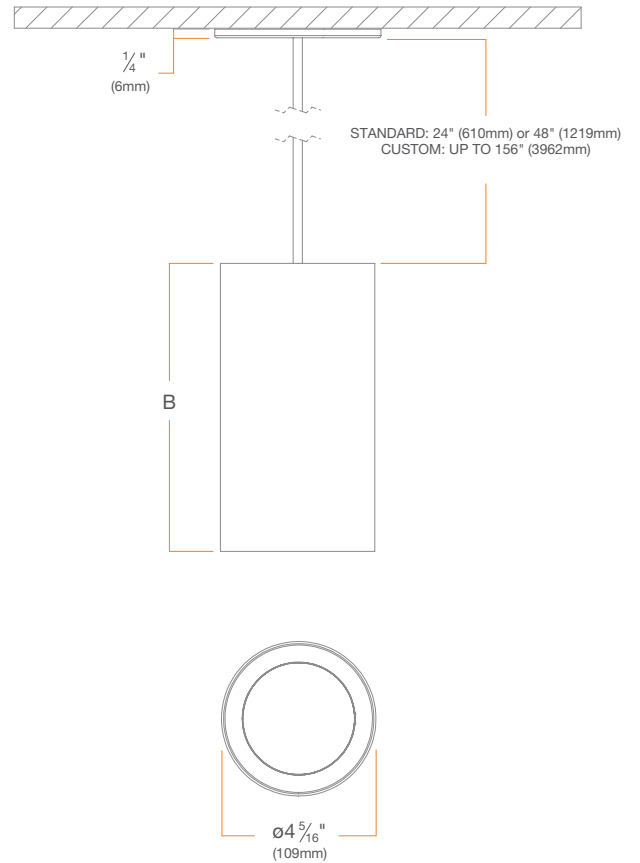

CYLINDER SIZE	A
Small	4" [102 mm]
Medium	8" [203 mm]
Large	12" [305 mm]

CYLINDER SIZE	B
Small	4" [102 mm]
Medium	8" [203 mm]
Large	12" [305 mm]

CYLINDER DIMENSIONS

Stem Mount
LED Cylinder

DC4T

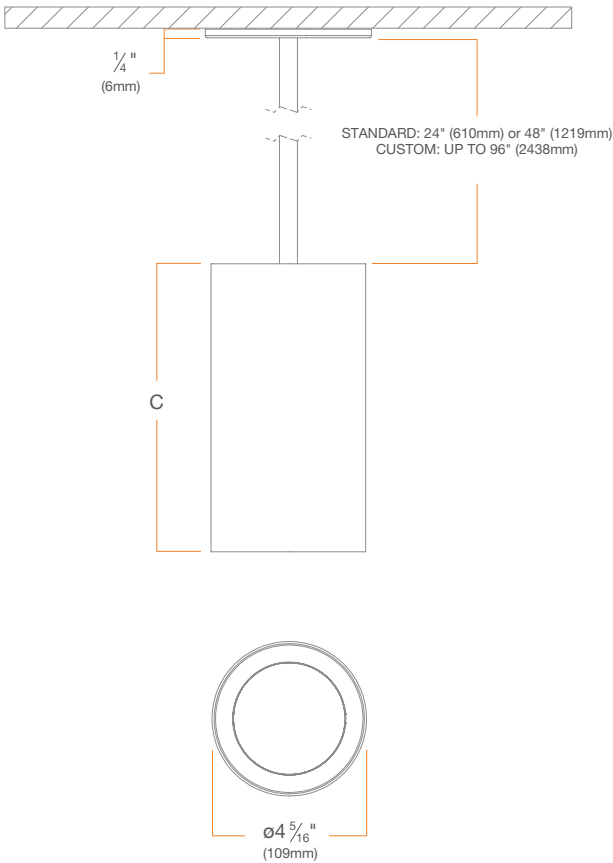

Stem Mount, Wet Location
LED Cylinder

DC4TxW

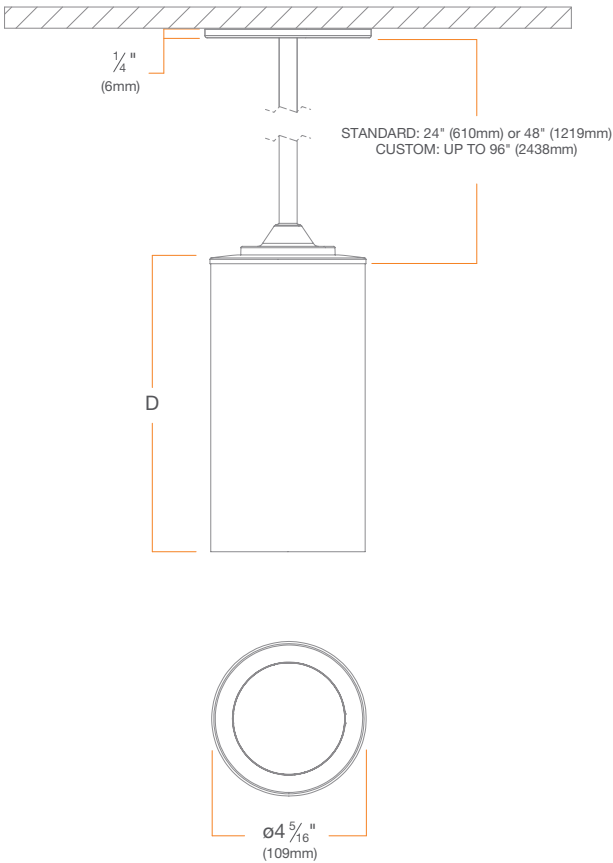

CYLINDER SIZE	C
Small	4" [102 mm]
Medium	8" [203 mm]
Large	12" [305 mm]

CYLINDER SIZE	D
Small	4 1/4" [108 mm]
Medium	8 1/4" [210 mm]
Large	12 1/4" [311 mm]

CYLINDER DIMENSIONS

Wall Mount Downlight LED Cylinder

DC4WM

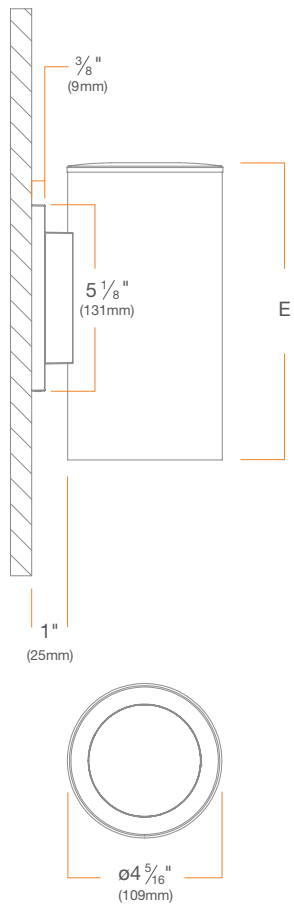

CYLINDER SIZE	E
Medium	8 1/4" [210 mm]
Large	12 1/4" [311 mm]

Wall Mount Downlight, Wet Location LED Cylinder

DC4WMW

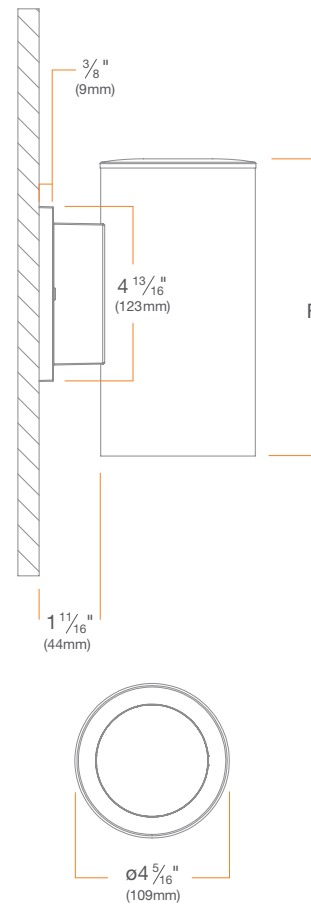

CYLINDER SIZE	F
Medium	8 1/4" [210 mm]
Large	12 1/4" [311 mm]

CYLINDER DIMENSIONS

Wall Mount Up and Downlight
LED Cylinder
DC4WM

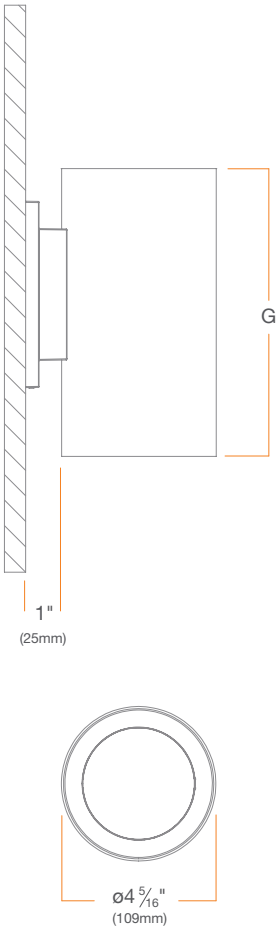

Decorative
Trim
DCCX-D

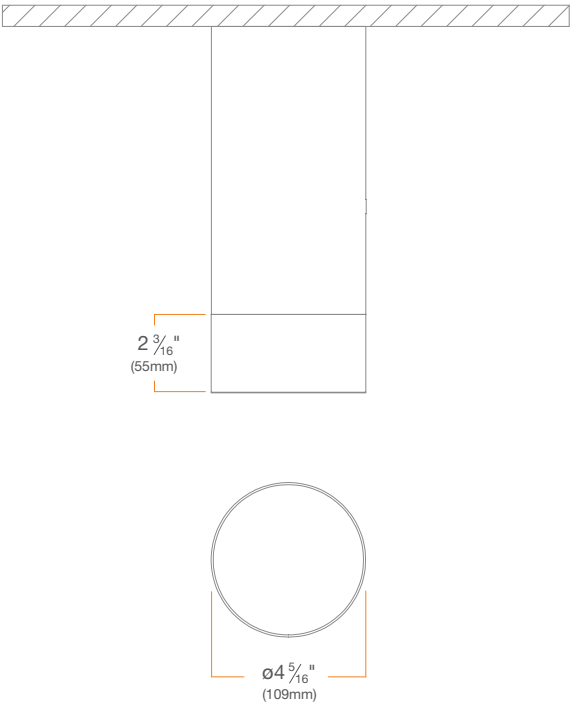

CYLINDER SIZE	G
Medium	8" [203 mm]
Large	12" [305 mm]

CYLINDER ACCESSORY DIMENSIONS

**Low-Profile
Decorative Trim**
DCCX-L

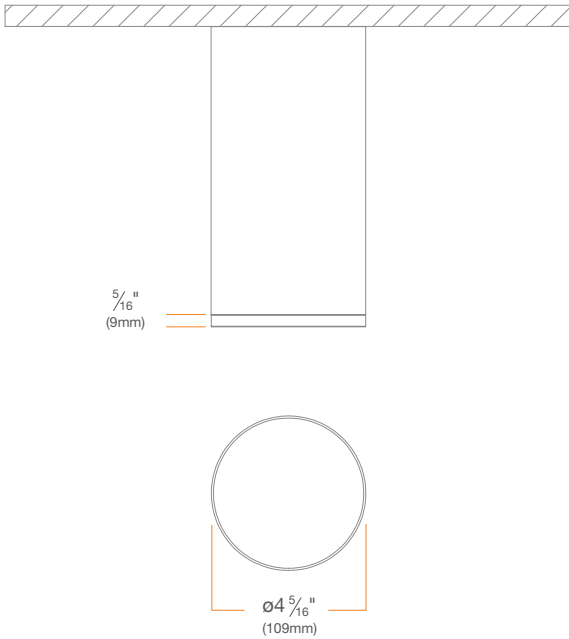

Snoot
DCCX-S

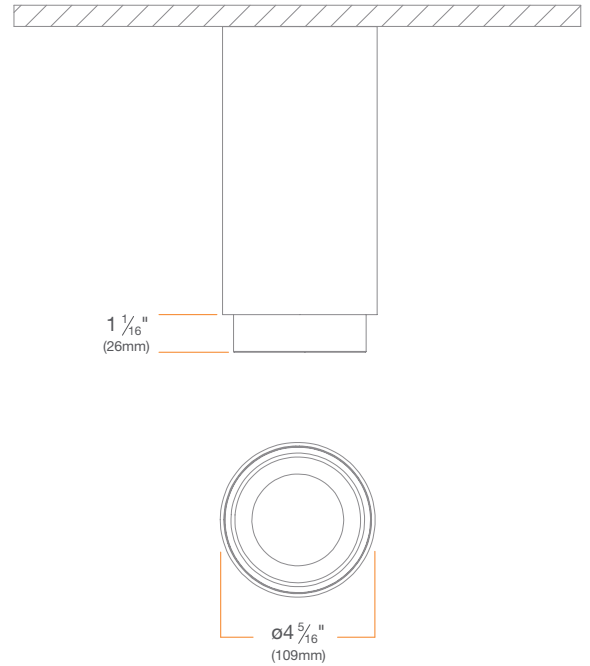

CYLINDER ACCESSORY DIMENSIONS

Round Shade

DCCX-R

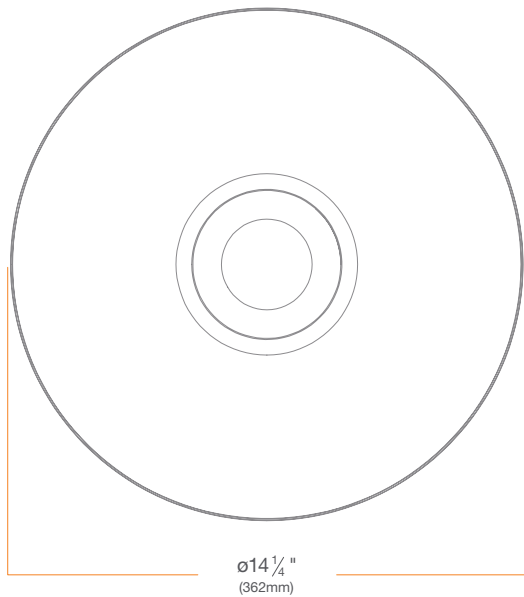
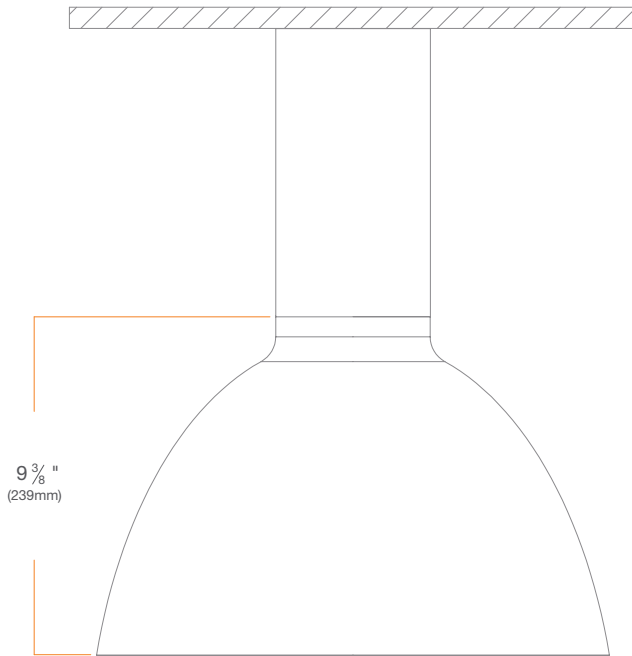

Flat Shade

DCCX-F

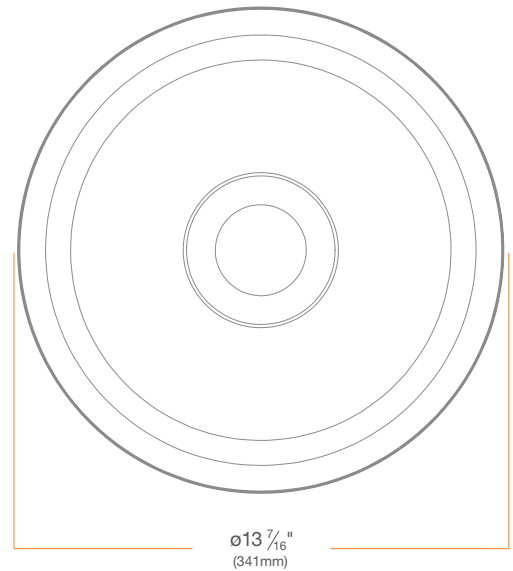
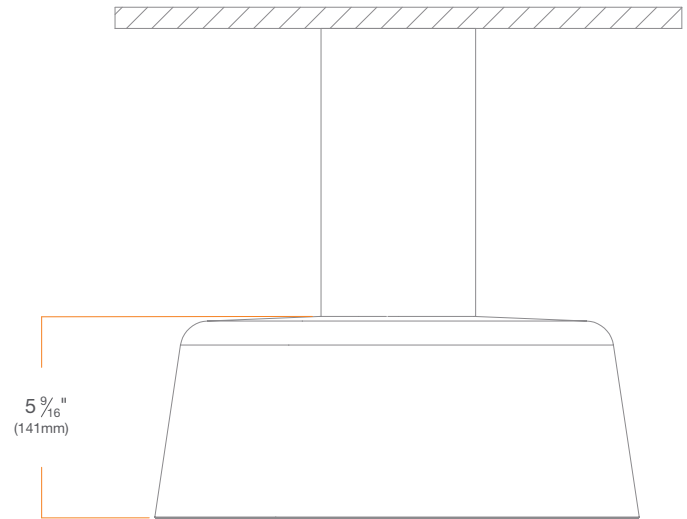

CYLINDER ACCESSORY DIMENSIONS

Junction Box Cover

DCCX-J

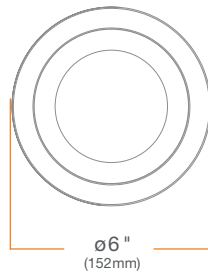
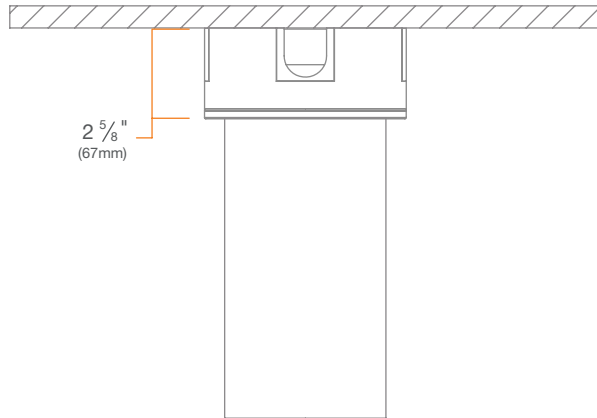

CYLINDER ACCESSORY DIMENSIONS

Emergency Lighting Kit

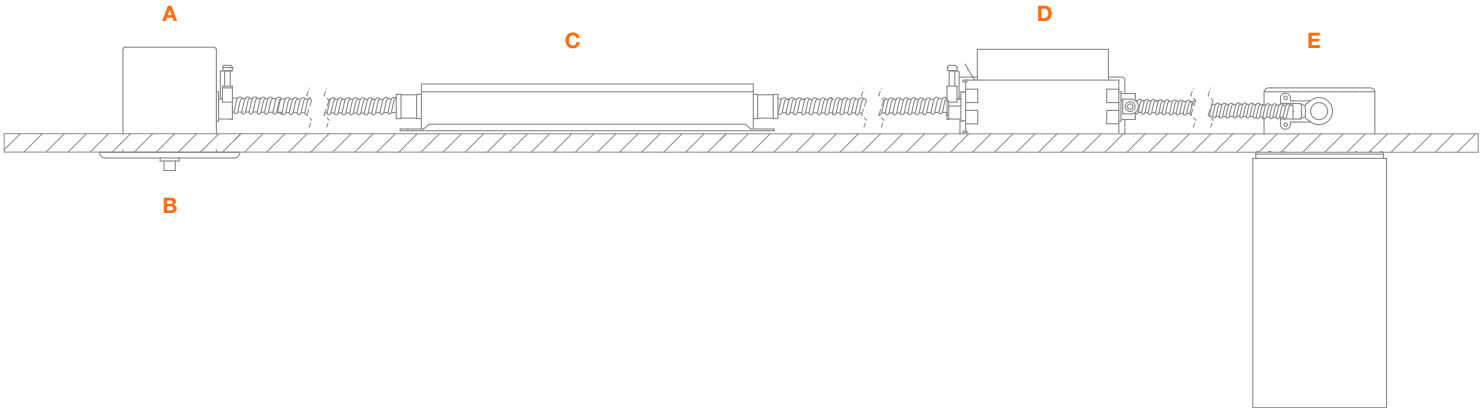

	ITEM	LENGTH	WIDTH	HEIGHT
A	Junction Box (not included)	N/A	N/A	N/A
B	Remote Test Switch	4 1⁄2" [114 mm]	2 3⁄4" [70 mm]	9⁄16" [15 mm]
C	Emergency LED Driver (Battery)	10 5⁄8" [271 mm]	2 5⁄16" [58 mm]	1 1⁄2" [38 mm]
D	Cylinder Driver	4 15⁄16" [126 mm]	3 3⁄8" [85 mm]	2 11⁄16" [68 mm]
E	Junction Box (not included)	N/A	N/A	N/A

PHOTOMETRY

DCC Fixed, 1000 lm, 3000K, Narrow Spot

DC4xxxxD10NSxxxxx30

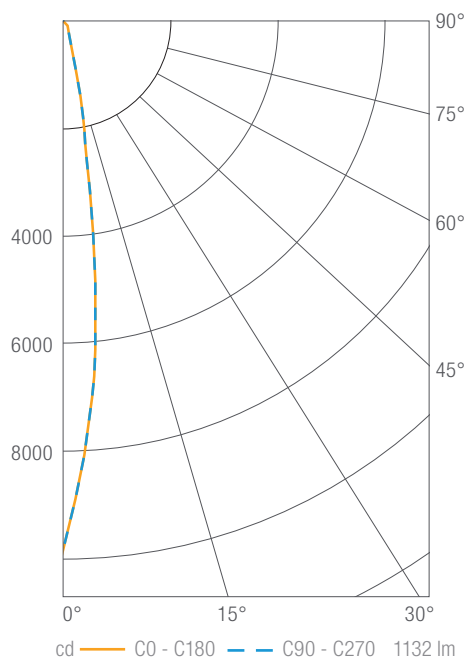

Luminous Intensity

Gamma	C 0°
0°	9823
5°	6600
10°	2335
15°	734
20°	357
25°	244
30°	195
35°	159
40°	116
45°	85
50°	61
55°	42
60°	28
65°	16
70°	7
75°	4
80°	2
85°	1
90°	0

Values in candela

Zonal Lumen Summary

Zone	Lumens	Luminaire %
0-30	906	80
0-40	1004	89
0-60	1110	98
0-90	1131	100
0-180	1132	100

Illuminance Chart

Distance from LED	Foot Candles	Diameter
3'	1091	0.7'
6'	273	1.5'
9'	121	2.2'
12'	68	2.9'

Beam Angle: 14°

DCC Fixed, 1000 lm, 3000K, Spot

DC4xxxxD10SPxxxxx30

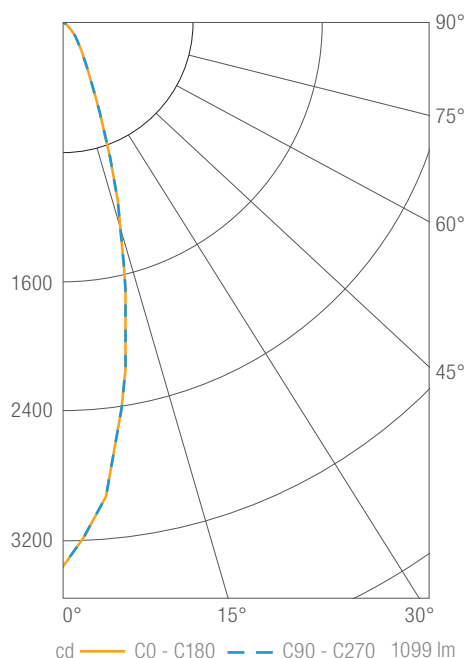

Luminous Intensity

Gamma	C 0°
0°	3366
5°	2967
10°	2203
15°	1391
20°	775
25°	419
30°	248
35°	167
40°	119
45°	87
50°	62
55°	43
60°	26
65°	15
70°	7
75°	4
80°	2
85°	1
90°	0

Values in candela

Zonal Lumen Summary

Zone	Lumens	Luminaire %
0-30	862	78
0-40	971	88
0-60	1078	98
0-90	1098	100
0-180	1099	100

Illuminance Chart

Distance from LED	Foot Candles	Diameter
3'	374	1.4'
6'	93	2.8'
9'	42	4.2'
12'	23	5.6'

Beam Angle: 26°

PHOTOMETRY

DCC Fixed, 1000 lm, 3000K, Flood

DC4xxxxD10FLxxxxx30

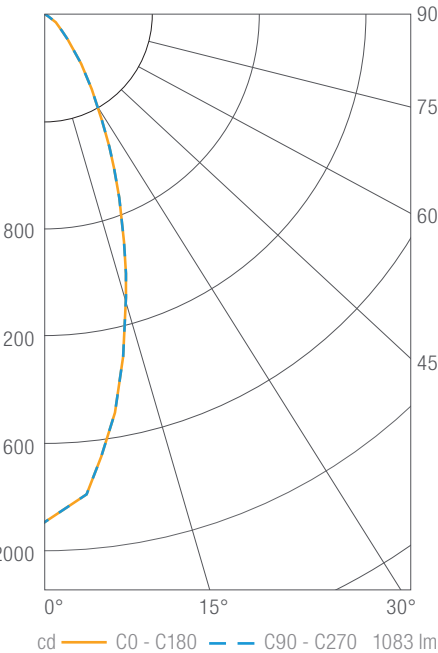

Luminous Intensity

Gamma	C 0°
0°	1890
5°	1792
10°	1503
15°	1161
20°	849
25°	589
30°	391
35°	256
40°	162
45°	107
50°	74
55°	51
60°	30
65°	18
70°	8
75°	5
80°	3
85°	1
90°	0

Values in candela

Zonal Lumen Summary

Zone	Lumens	Luminaire %
0-30	760	70
0-40	925	85
0-60	1058	98
0-90	1081	100
0-180	1083	100

Illuminance Chart

Distance from LED	Foot Candles	Diameter
3'	210	2.0'
6'	52	4.0'
9'	23	6.0'
12'	13	8.0'

Beam Angle: 37°

DCC Fixed, 1000 lm, 3000K, Wide Flood

DC4xxxxD10WFxxxxx30

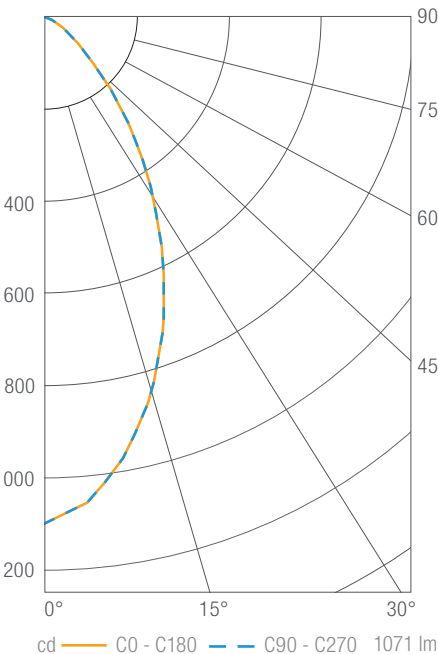

Luminous Intensity

Gamma	C 0°
0°	1100
5°	1058
10°	973
15°	866
20°	743
25°	609
30°	478
35°	361
40°	252
45°	161
50°	102
55°	68
60°	41
65°	24
70°	11
75°	6
80°	4
85°	2
90°	0

Values in candela

Zonal Lumen Summary

Zone	Lumens	Luminaire %
0-30	620	58
0-40	845	79
0-60	1037	97
0-90	1069	100
0-180	1071	100

Illuminance Chart

Distance from LED	Foot Candles	Diameter
3'	122	3.1'
6'	31	6.2'
9'	14	9.3'
12'	8	12.3'

Beam Angle: 55°

PHOTOMETRY

DCC Fixed, 1000 lm, 3000K, General Ambient

DC4xxxxD10GAxxxxx30

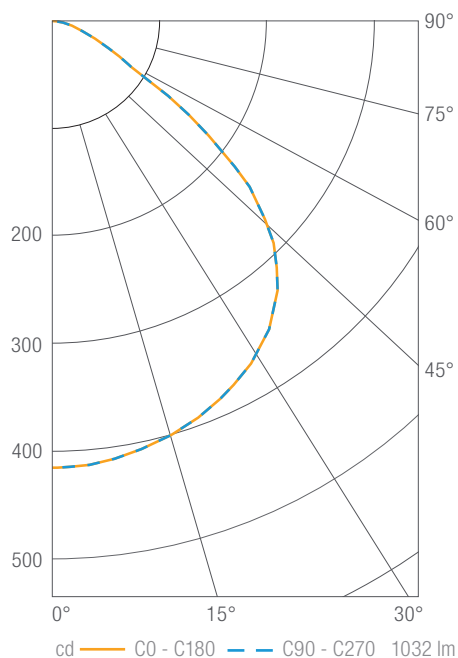

Luminous Intensity

Gamma	C 0°
0°	416
5°	415
10°	410
15°	403
20°	394
25°	382
30°	369
35°	351
40°	327
45°	291
50°	240
55°	162
60°	84
65°	54
70°	33
75°	21
80°	12
85°	6
90°	1

Values in candela

Zonal Lumen Summary

Zone	Lumens	Luminaire %
0-30	333	32
0-40	557	54
0-60	942	91
0-90	1024	99
0-180	1032	100

Illuminance Chart

Distance from LED	Foot Candles	Diameter
3'	46	7.8'
6'	12	15.5'
9'	5	23.3'
12'	3	31.1'

Beam Angle: 100°

DCC Adjustable, 750 lm, 3000K, Narrow Spot

DC4xxxxA07NSxxxxx30

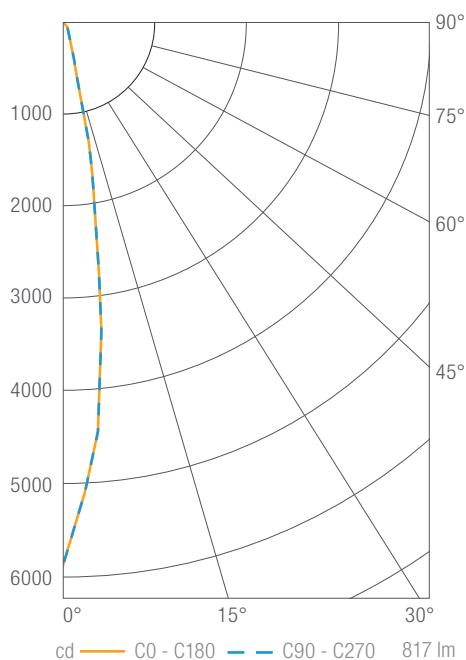

Luminous Intensity

Gamma	C 0°
0°	5897
5°	4418
10°	1911
15°	561
20°	280
25°	165
30°	117
35°	87
40°	69
45°	57
50°	47
55°	38
60°	31
65°	23
70°	16
75°	10
80°	4
85°	1
90°	0

Values in candela

Zonal Lumen Summary

Zone	Lumens	Luminaire %
0-30	645	79
0-40	701	86
0-60	781	96
0-90	817	100
0-180	817	100

Illuminance Chart

Distance from LED	Foot Candles	Diameter
3'	655	0.8'
6'	164	1.7'
9'	73	2.5'
12'	41	3.3'

Beam Angle: 16°

PHOTOMETRY

DCC Adjustable, 750 lm, 3000K, Spot

DC4xxxxA07SPxxxx30

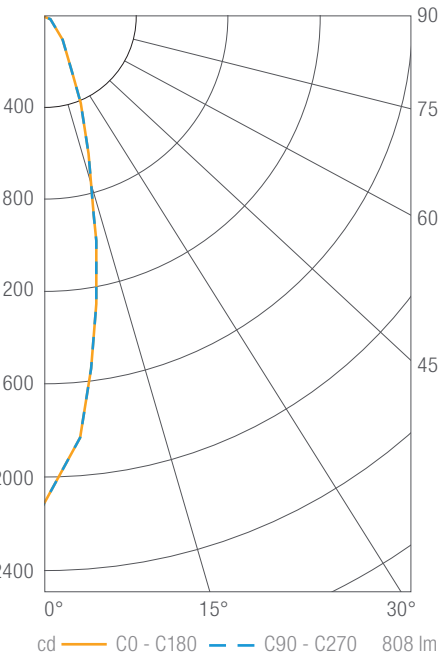

Luminous Intensity

Gamma	C 0°
0°	2105
5°	1826
10°	1282
15°	800
20°	497
25°	310
30°	201
35°	137
40°	98
45°	73
50°	57
55°	45
60°	35
65°	23
70°	12
75°	5
80°	3
85°	2
90°	0

Values in candela

Zonal Lumen Summary

Zone	Lumens	Luminaire %
0-30	573	71
0-40	668	83
0-60	773	96
0-90	808	100
0-180	808	100

Illuminance Chart

Distance from LED	Foot Candles	Diameter
3'	234	1.3'
6'	58	2.6'
9'	26	3.9'
12'	15	5.2'

Beam Angle: 28°

DCC Adjustable, 750 lm, 3000K, Flood

DC4xxxxA07FLxxxx30

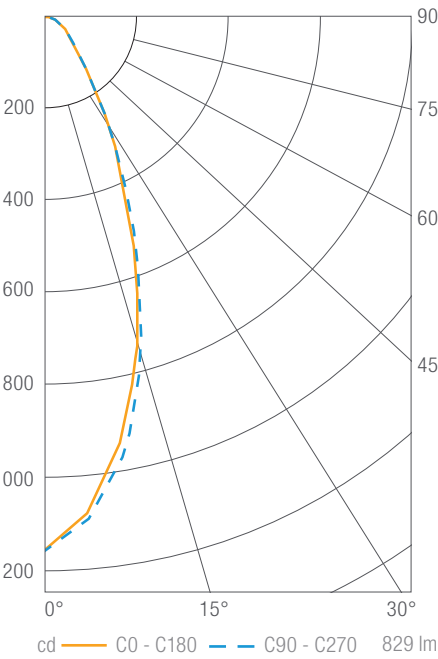

Luminous Intensity

Gamma	C 0°
0°	1158
5°	1081
10°	941
15°	765
20°	576
25°	414
30°	288
35°	192
40°	130
45°	96
50°	76
55°	61
60°	49
65°	38
70°	28
75°	18
80°	10
85°	4
90°	0

Values in candela

Zonal Lumen Summary

Zone	Lumens	Luminaire %
0-30	510	62
0-40	633	76
0-60	766	92
0-90	829	100
0-180	829	100

Illuminance Chart

Distance from LED	Foot Candles	Diameter
3'	129	2.2'
6'	32	4.5'
9'	14	6.7'
12'	8	9.0'

Beam Angle: 41°