

**UPRR/CALIFORNIA AVENUE  
BICYCLE AND PEDESTRIAN  
ROUTE MASTER PLAN**

**Legend**

- Rest Area
- Pedestrian/Bicycle Path (10' Wide Sidewalk)
- Pedestrian/Bicycle Trail (10' Wide Meandering Trail)
- Existing Sidewalk & Bike Lane
- ■ ■ ■ Alternate Route (To Be Determined by Location of RR Crossing)
- City Park
- City Limits

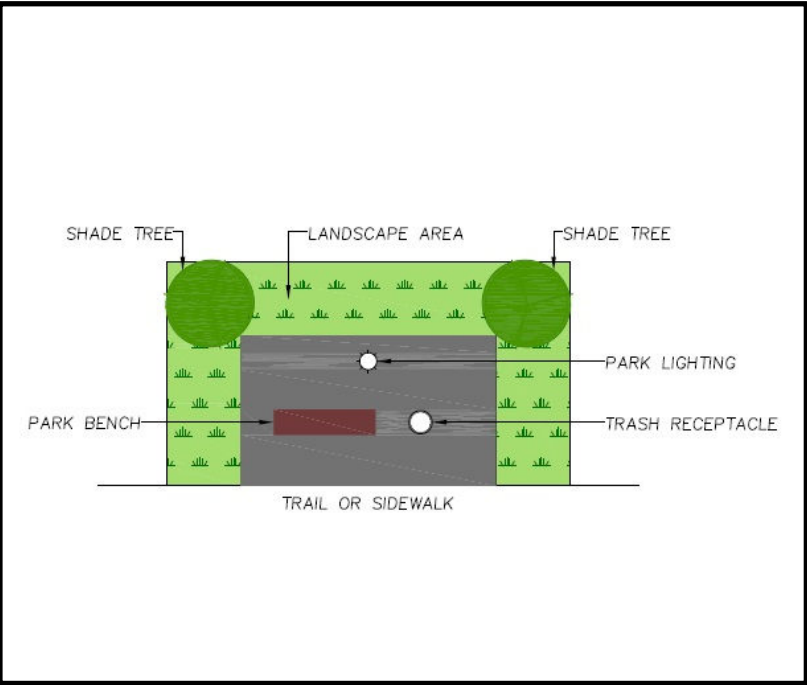

**CONCEPTUAL REST AREA**

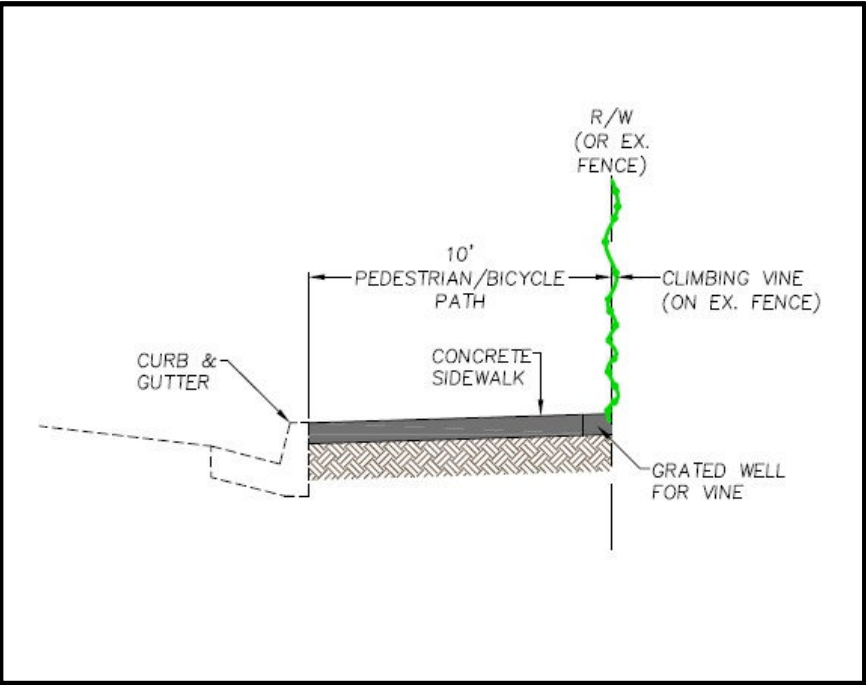

**10' WIDE SIDEWALK**

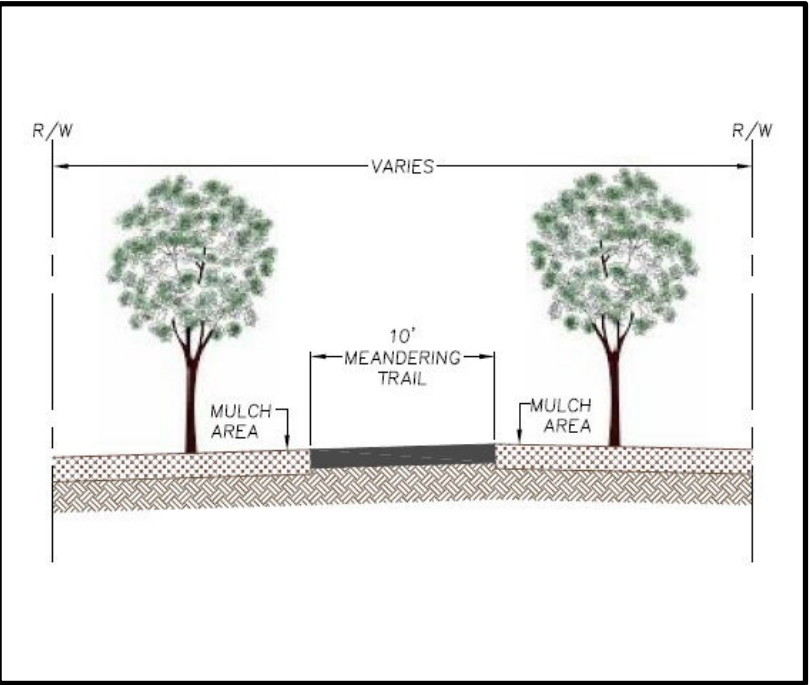

**10' WIDE MEANDERING TRAIL**

