



SITE NOTES

300 E KELSO ROAD

1.

ADDRESS: ELECTRIC CITY BOULEVARD, KAUKAUNA, WI 54130

2.

PARCEL NUMBERS: 2-1128 (322112800) & 2-1129 (322112900)

3.

PARCEL AREA:
A. 2-1128 (NORTH LOT): 6.59 ACRES
B. 2-1129 (SOUTH LOT): 3.13 ACRES
C. TOTAL: 9.72 ACRES (423,557 S.F.)

4.

LEGAL DESCRIPTION:
A. 2-1128: CSM 6242 LOT 2 (PLATTED OUT OF PRT LOT 12 PROSPERITY CENTER SEC7-21-19) 6.59AC M/L #1709791 THRU #1709794
B. 2-1129: NEW PROSPERITY CENTER LOT 13 #1709791 THRU #1709794

5.

MUNICIPALITY: CITY OF KAUKAUNA

6.

ZONED: INDUSTRIAL

1

Site Plan FOR SPA REVIEW OF CHANGES TO PREVIOUSLY APPROVED PLAN

1" = 40'-0"

DESIGN / BUILD
GENERAL CONTRACTING
STEEL FABRICATION
METAL BUILDINGS
Established 1976

SCHUH
CONSTRUCTION, INC.

T.920.833.6465 SCHUHCONSTRUCTION.COM

Notice: These plans/electronic files are the exclusive property of Schuh Construction, Inc., and are loaned with that understanding. Plans/electronic files may not be copied, reproduced, or other use may not be made without the consent of Schuh Construction, Inc. Return upon request.

Sheet Issue Date:
5/9/23

Revision History

Revision Number	Revision Date
1	03/22/23
2	05/19/23
3	09/11/23
4	12/26/23
5	1/15/24
6	06/03/24
7	07/11/24

PROJECT:

STRAIGHTLINE REFRIGERATION
OFFICE & FABRICATION SHOP
300 E KELSO RD
KAUKAUNA, WI 54130

PROJECT NO.:

23-310

SHEET NO.:

C1

SITE PLAN

C:\Users\jason\Documents\23-310 Office & Fab Shop Schuh Corp. 2/24/2024\23-310.dwg

0 R.V. 7/11/2024 9:27:59 AM



1 SITE RENDER (FRONT DRIVEWAY)
1/16" = 1'-0"

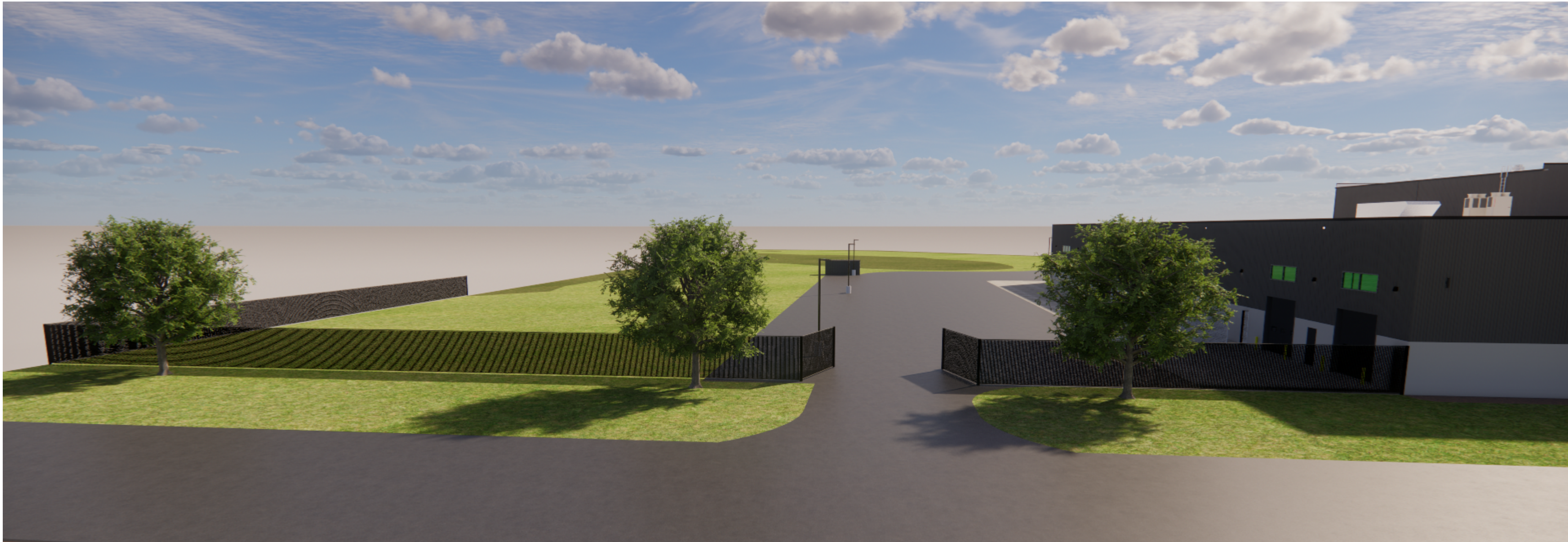

2 SITE RENDER (REAR DRIVEWAY)
1/16" = 1'-0"

DESIGN / BUILD
GENERAL CONTRACTING
STEEL FABRICATION

Schuh
CONSTRUCTION, INC.

CONSTRUCTION.COM
T.920.833.6465

METAL BUILDINGS
ESTABLISHED 1976

Notice: These plans/electronic files are the exclusive property of Schuh Construction, Inc., and are loaned with that understanding. Plans/electronic files may not be copied, reproduced, or other use may not be made without the consent of Schuh Construction, Inc. Return upon request.

Sheet Issue Date:
07/11/24

Revision History	
Revision Number	Revision Date

PROJECT:
**STRAIGHTLINE REFRIGERATION
OFFICE & FABRICATION SHOP**
300 E. KELSO RD.
KAUKAUNA, WI 54130

PROJECT NO.:
23-310

SHEET NO.:
SITE

SITE RENDERS

C:\Users\Schuh\Documents\23-310 Office & Fab Shop Schuh Corp. 240626027.rvt Author: 7/11/2024 9:27:59 AM