



Change Order Request

Date: 03/07/2024
To: Terri Vosters
 City of Kaukauna
 144 W 2nd St
 Kaukauna, WI 54130

Re: Kaukauna Pool Renovation
 Kaukauna, WI 54130
Project: 231020

Reference Document: PCI0020

Change Description: Costs associated with the revised Waterslide footings design. Miron Construction needs an executed change order by 03/28/2024 in order to avoid a day-by-day schedule impact at a cost of \$2,177.00 per work day

Contractor	Description	Amount
Ostrenga Excavating	ALT 1 WATERSLIDE	\$5,810.35
Miron Construction Co., Inc.	ALT A-1 CONCRETE WORK WATERSLIDE	\$20,746.82
* SUB-TOTAL *		26,557.17
Insurance - 0.65%		\$172.62
Management Fee		\$290.52
* SUB-TOTAL *		27,020.31
Bond - 1.00%		\$270.20
** TOTAL **		27,290.51

Impacted Calendar Days: 0

All terms of our agreement apply and preclude Miron Construction Co., Inc. from performing any extra work without approval. Please provide your approval by signing this request.

Naman Yagnik
Miron Construction Co., Inc.

Date:

Owner Representative
City of Kaukauna

Date:

This quote expires on: 03/28/2024

File: P:\1.039 Kaukauna Pool_CAD\1_P-SLIDE.dwg User: katie Plotted: Oct 01, 2023 - 1:58pm

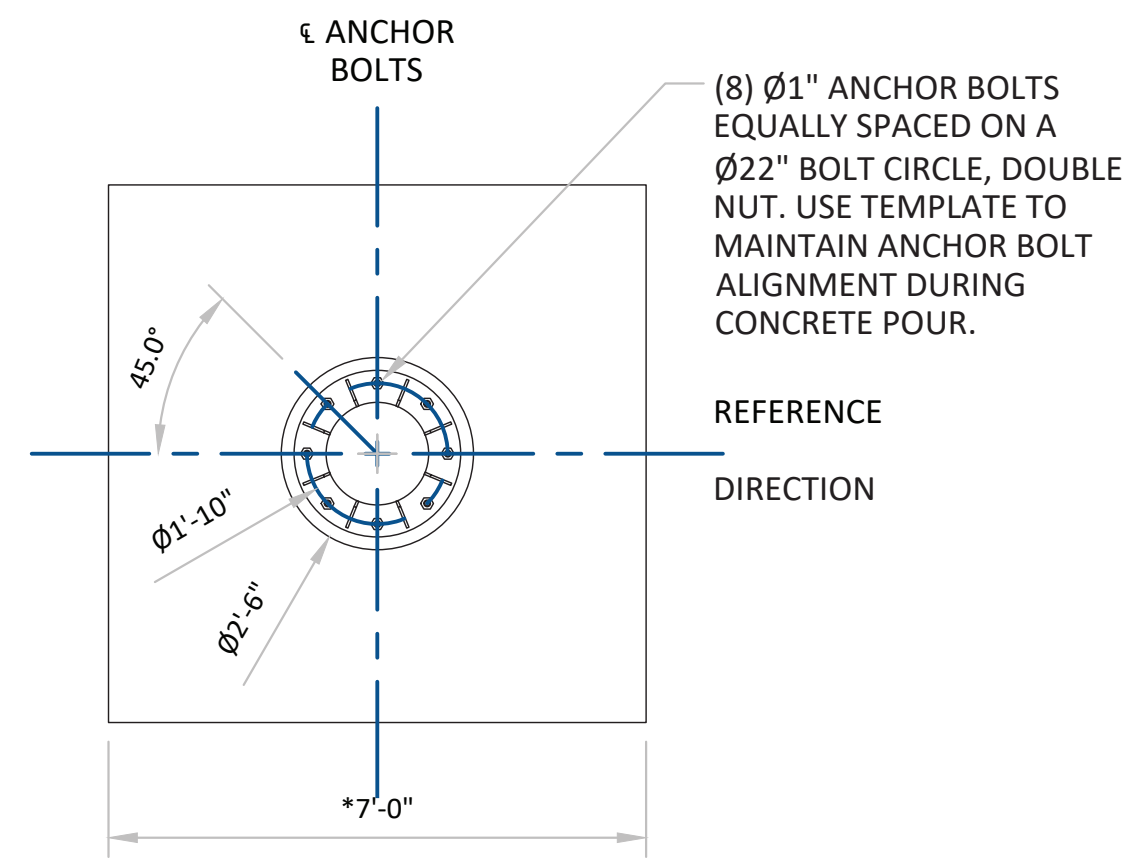

* NOTE: FOOTING SIZE, DEPTH, AND CONFIGURATION SHOWN ARE APPROXIMATE, AND ARE USED FOR ESTIMATING PURPOSES ONLY. ACTUAL DIMENSIONS ARE SUBJECT TO FINAL DESIGN, SITE SPECIFIC SOIL CONDITIONS, AND RIDE CONFIGURATION.

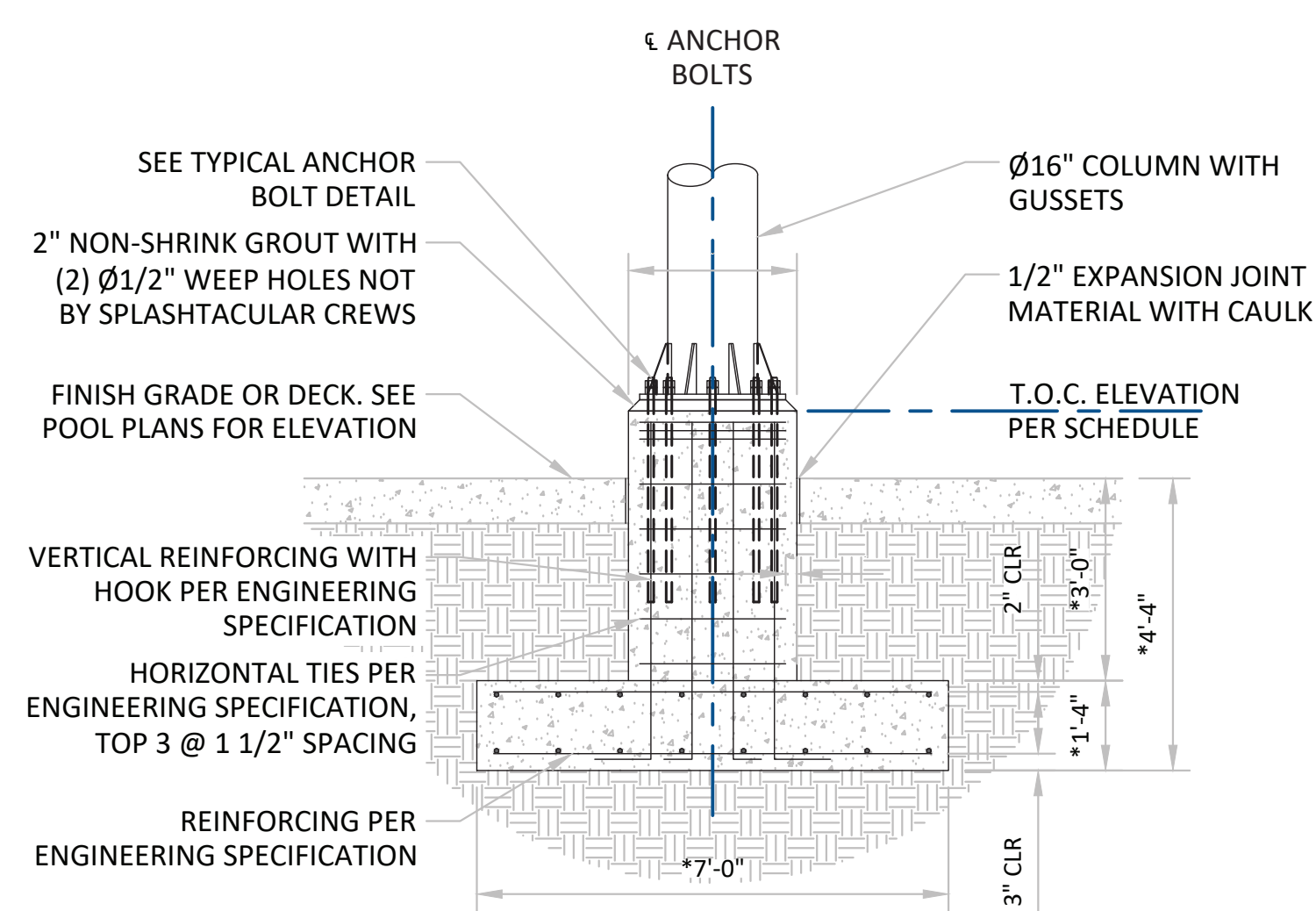

4 PIER DETAIL
C600 SCALE: N.T.S.



3 WATERSLIDE PERSPECTIVE
C600 SCALE: N.T.S.

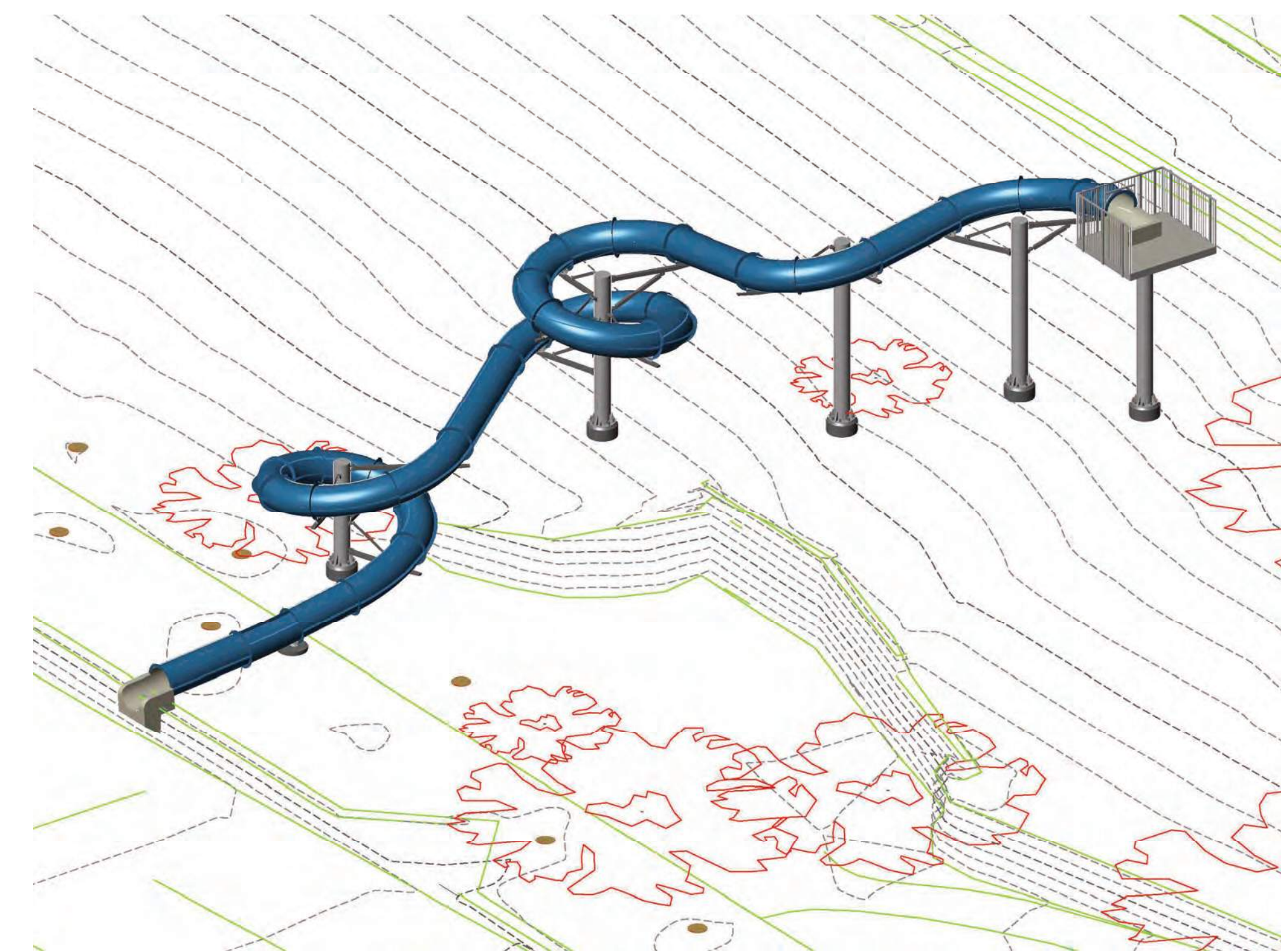

2 WATERSLIDE PERSPECTIVE
C600 SCALE: N.T.S.

NEW WATERSLIDE SUCTION LINE COVERS. SEE SHEET SP102 FOR DETAILS.



MARK	SLIDE TYPE	GPM	HEIGHT (ft)	LENGTH (ft)
A	32" ENCLOSED BODY SLIDE	300-500	29.70'	190.66'
TOTAL LENGTH:				190.66'

Slide height is from finished pool/runout deck to finished start deck. Water level is assumed to be (6) inches BELOW finished pool deck.

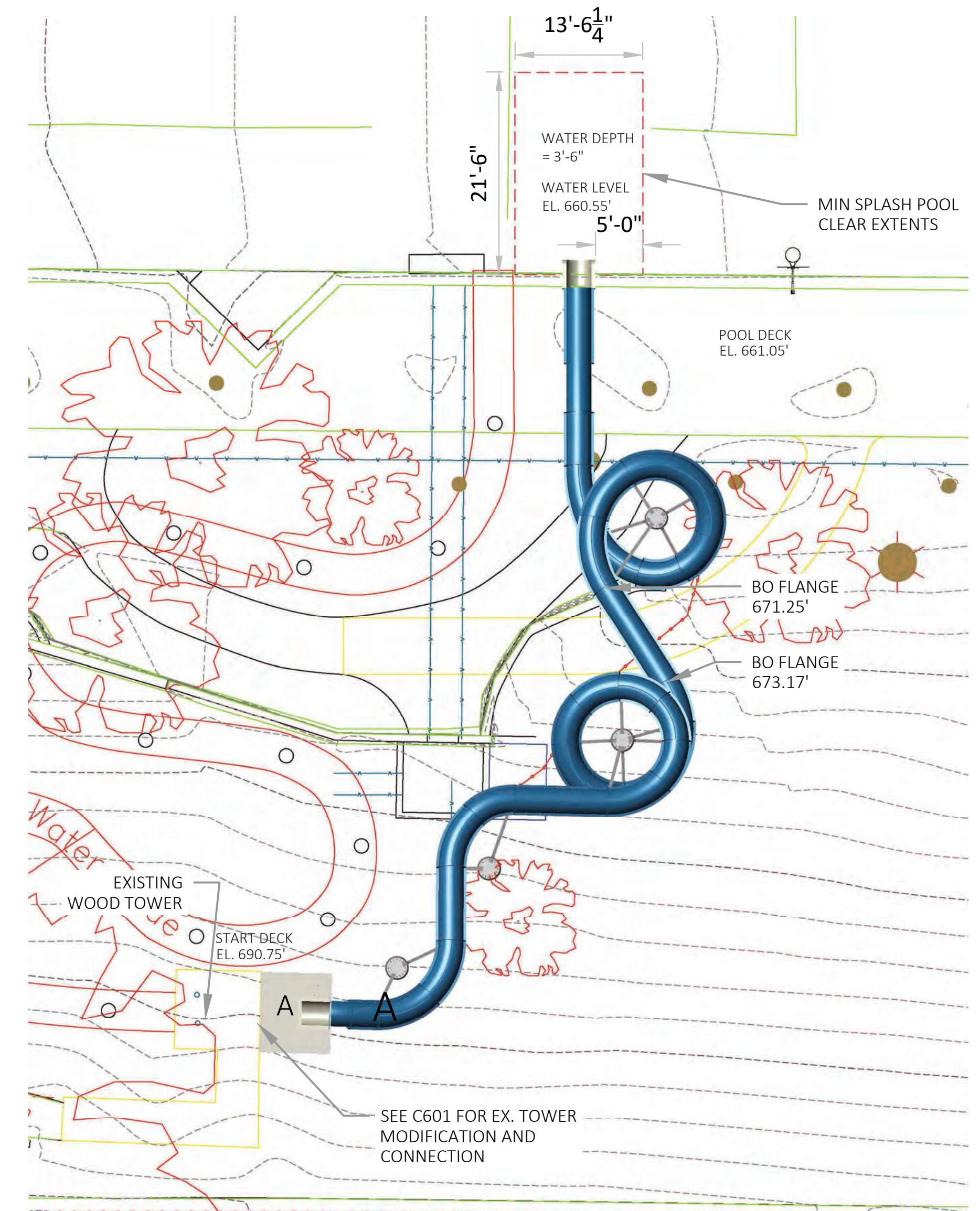

1 WATERSLIDE PLAN VIEW
C600 SCALE: N.T.S.

Revisions:

--	--

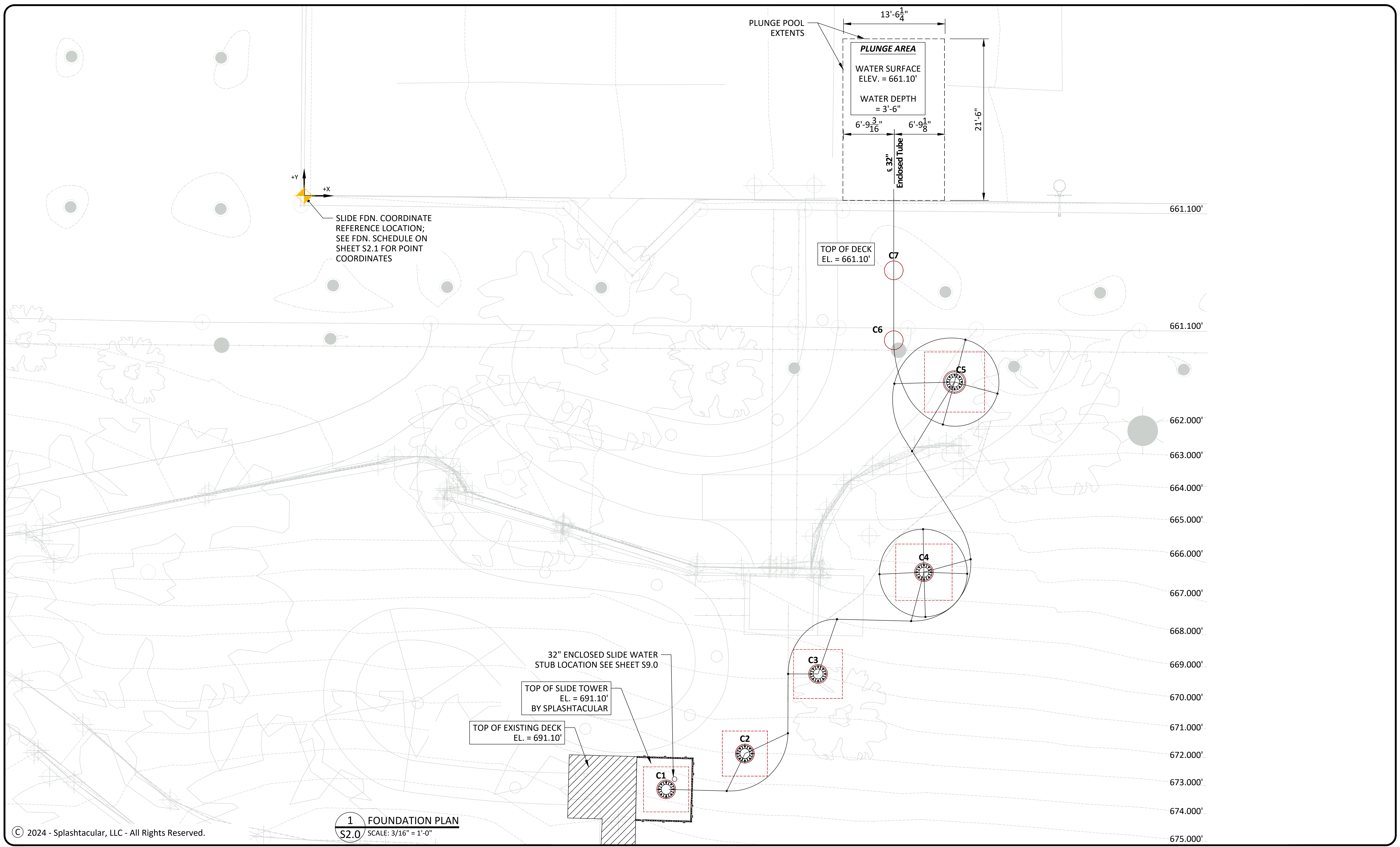

© 2024 - Splashtacular, LLC - All Rights Reserved.

This document is the intellectual property of Splashtacular, LLC, which has exclusive rights to proprietary trade secrets and confidential information contained herein. Receipt of permission to use this document does not convey any rights to use the information contained herein without prior written consent of Splashtacular, LLC.

MARK	DATE	REVISION HISTORY	APPROVED
△	01/03/2024	ISSUED FOR APPROVAL	
△	01/15/2024	ISSUED FOR APPROVAL - REVISE & RESUBMIT 1	
△	02/12/2024	ISSUED FOR APPROVAL - REVISE AND RESUBMIT 2	
△			
△			

The Structural Support System depicted on these drawings was designed under the direction of the Professional Engineer who's seal and signature are affixed to this drawing. This Professional Engineer did not perform any design or review of the other non-structural systems shown on these drawings and therefore assumes no responsibility for their adequacy.

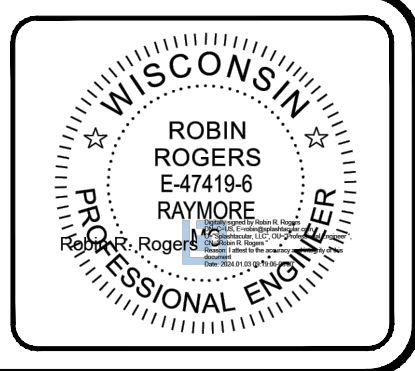

TITLE: FOUNDATION LAYOUT		
PROJECT: MUNICIPAL POOL RENOVATION		
DATE: 11/06/2023	PROJECT NUMBER: 13923	COUNTRY: USA
SCALE: AS NOTED	DESIGNER: GLC	STATE: WI
CHECKED: RRR	APPROVED: RRR	CITY: KAUKAUNA, WI

S2.0

FOUNDATION SCHEDULE

Col No.	Foundation Type	Detail	T.O. First Pour (ft)	T.O.C. Elev (ft)	T.O.D. or T.O.G. Elev (ft)	F.B.E. Elev (ft)	Footing Dimensions (A x B x Thickness)	Footing Reinforcement	Concrete Pedestal Dia (in)	Vertical Reinf.		Vertical Ties		X Coord	Y Coord	Notes
										Size	Qty	Size	Spc			
C1	Spread Footing	01S2.1	-	675.500'	674.500'	669.500'	6'-0" x 6'-0" x 18.00"	8 - #6 Equal Spacing - Each Way - Top & Bottom	30"	#6	18	#3	8" o.c.	48.166'	-78.970'	-
C2	Spread Footing	01S2.1	-	674.000'	673.000'	668.000'	6'-0" x 6'-0" x 18.00"	8 - #6 Equal Spacing - Each Way - Top & Bottom	30"	#6	18	#3	8" o.c.	58.643'	-74.211'	-
C3	Spread Footing	01S2.1	-	672.000'	671.000'	666.000'	6'-6" x 6'-6" x 18.00"	8 - #6 Equal Spacing - Each Way - Top & Bottom	30"	#6	18	#3	8" o.c.	68.381'	-63.617'	-
C4	Spread Footing	01S2.1	-	668.000'	667.000'	662.000'	7'-6" x 7'-6" x 18.00"	10 - #6 Equal Spacing - Each Way - Top & Bottom	30"	#6	18	#3	8" o.c.	82.470'	-50.077'	-
C5	Spread Footing	01S2.1	-	662.500'	661.500'	656.500'	8'-0" x 8'-0" x 1.50"	10 - #6 Equal Spacing - Each Way - Top & Bottom	30"	#6	18	#3	8" o.c.	86.546'	-24.771'	-
C6	Concrete Pier	03S2.1	661.879'	662.546'	661.000'	656.000'	30"Ø x Depth	-	30"	#6	12	#3	8" o.c.	78.456'	-19.215'	5.
C7	Concrete Pier	03S2.1	660.648'	661.315'	661.000'	656.000'	30"Ø x Depth	-	30"	#6	12	#3	8" o.c.	78.455'	-9.922'	5.

- NOTES:**
1. COORDINATE CONCRETE PAD W/ SITE CONCRETE (NOT BY SPLASHTACULAR)
 2. F.B.E. = FOOTING BEARING ELEVATION
 3. T.O.C. = TOP OF CONCRETE PEDESTAL ELEVATION
 4. O.C. = ON CENTER
 5. **PROVIDE DELAY POUR.**

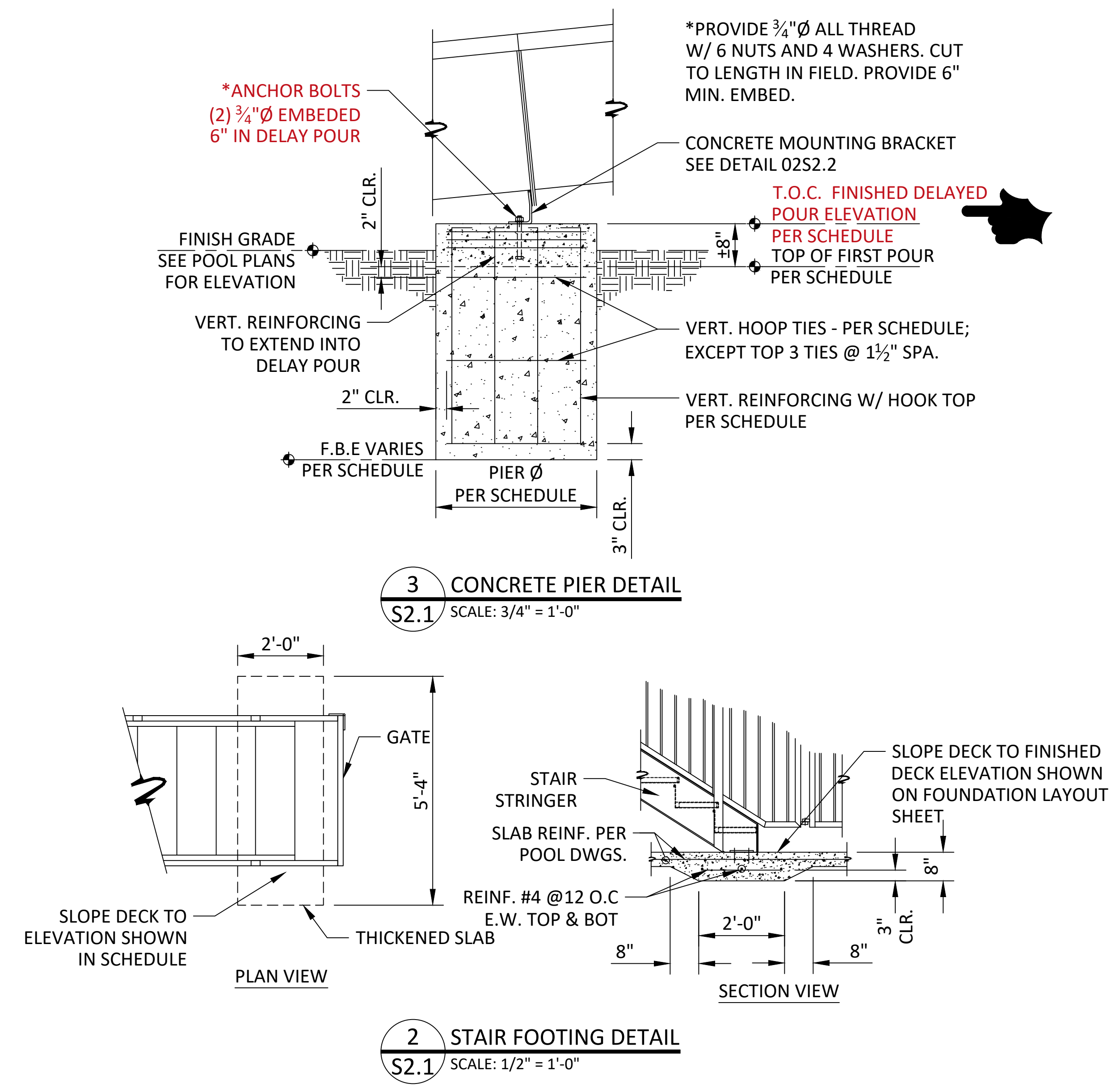
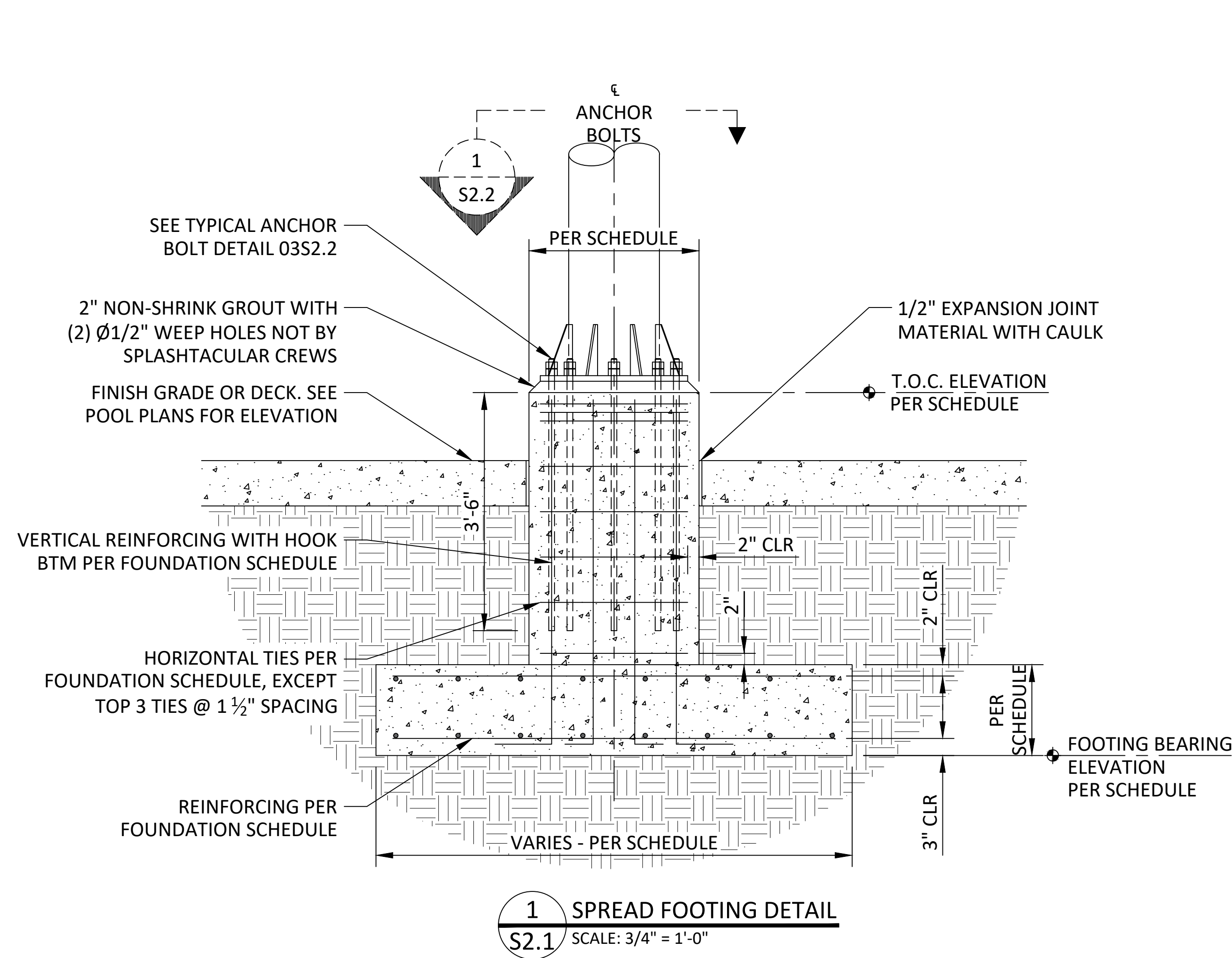

© 2024 - Splashtacular, LLC - All Rights Reserved.

This document is the intellectual property of Splashtacular, LLC, which has exclusive rights to proprietary trade secrets and confidential information contained herein. Receipt of permission to use this document does not convey any rights to use the information contained herein without prior written consent of Splashtacular, LLC.

MARK	DATE	REVISION HISTORY	APPROVED
△	01/03/2024	ISSUED FOR APPROVAL	
△	01/15/2024	ISSUED FOR APPROVAL - REVISE & RESUBMIT 1	
△	02/12/2024	ISSUED FOR APPROVAL - REVISE AND RESUBMIT 2	
△			
△			

The Structural Support System depicted on these drawings was designed under the direction of the Professional Engineer who's seal and signature are affixed to this drawing. This Professional Engineer did not perform any design or review of the other non-structural systems shown on these drawings and therefore assumes no responsibility for their adequacy.

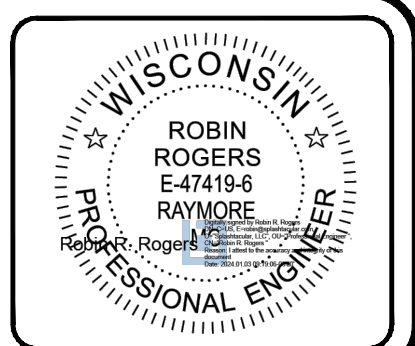

TITLE: FOUNDATION SCHEDULE & DETAILS		
PROJECT: MUNICIPAL POOL RENOVATION		
DATE: 11/06/2023	PROJECT NUMBER: 13923	COUNTRY: USA
SCALE: AS NOTED	DESIGNER: GLC	STATE: WI
CHECKED: RRR	APPROVED: RRR	CITY: KAUKAUNA, WI

S2.1

Subject: Kaukauna - Splashtacular waterslide soil borings

Date: 10/6/2023 11:17 AM

From: "Katie MacDonald" <katie@parkitecture.org>

To: "Reece Frederick" <Reece.Frederick@miron-construction.com>, "Naman Yagnik" <Naman.Yagnik@miron-construction.com>

I talked with several representatives from Splashtacular yesterday regarding the information that they say they need for footing designs. We don't think spread footings are the best option for this site due to the disturbance footprint and the existing slope of the site. They are looking at drilled piers.

Robin Roberts with Splashtacular says the info they'll need from the geotech is:

- allowable end bearing capacity
- skin friction resistance capacity
- uplift forces
- groundwater depth
- soil density
- seismic site design class
- L-pile parameters

I'd suggest having her review a proposal to confirm the geotech report will include what she needs prior to signing a contract.

During design, we reached out to two geotech companies for infiltration testing quotes. Their contact info is below. PSI Intertek was half the cost of ECS Midwest, were on site within a week, and have an existing working relationship with city staff.

Patrick Bray

Kaukauna Branch Manager

Building & Construction

Intertek-PSI

Office 920-735-1200

Email Patrick.bray@intertek.com

www.intertek.com/building

OSTRENGA

EXCAVATING, INC.

General Excavating
Demolition
Land Clearing
Site Preparation

February 22, 2024

The following is the additional cost breakdown for the waterslide footing redesign. I have included the cost that we have included in our quote, and also the revised cost..

Footing Excavation & Backfill (Base Bid) 72 CY @ \$63.85 = \$4,597.20

Footing Excavation & Backfill(Redesign) 163 CY @ \$63.85 = \$10,407.55

Total Add \$5,810.35

3361 Lily Lake Road • Green Bay, WI 54311
(920) 863-8389 • Fax (920)-863-2119
ostrengaex@gmail.com



Miron Self-Perform Concrete Quote Detail

Date: 03/07/2024
To: Parkitecture + Planning
901 Deming Way
Ste 201
Madison, WI 53717

Re: Kaukauna Pool Renovation-Concrete
Kaukauna, WI 54130
Project: 231023

Reference Document: PCI0003

Change Description: Costs associated with the revised Waterslide footings design: dimensions, depths and number of footings were changed.

Contractor	Description	Amount
Self-Perform		
Miron Construction Co., Inc	EQUIPMENT	3,300.00
Miron Construction Co., Inc	MATERIAL	9,115.70
Miron Construction Co., Inc	LABOR	5,625.01
* SUB-TOTAL *		18,040.71
Management Fee - Self Perform		2,706.11
* TOTAL *		20,746.82
** GRAND TOTAL **		20,746.82

Impacted Calendar Days: 0

All terms of our agreement apply and preclude Miron Construction Co., Inc. from performing any extra work without approval. Please provide your approval by signing this request.

Naman Yagnik
Miron Construction Co., Inc.

Date:



Building Excellence

POTENTIAL CHANGE ITEM (PCI) PROPOSAL REQUEST

PROJECT NAME:	Kaukauna Pool Renovation
ADDRESS:	607 Dodge Street, Kaukauna, WI 54130
PROJECT NUMBER:	231023
DATE:	3/5/2024
PCI #	

CHANGE DESCRIPTION:	Costs associated with the revised Waterslide footings design: dimensions, depths and number of footings were changed.
----------------------------	---

SELF-PERFORMED WORK:

TOTAL LABOR:		\$	5,625.01
TOTAL MATERIAL:		\$	9,115.70
SALES TAX @ 0%:		\$	-
TOTAL EQUIPMENT:		\$	3,300.00
	SUBTOTAL:	\$	18,040.71
OVERHEAD, PROFIT, & MARKUP	<input type="text" value="15.00%"/>	\$	2,706.11
TOTAL CONTRACTOR COST WITH MARKUP		\$	20,746.82

SUB-TIER SUBCONTRACTORS:	

	SUBTOTAL:	\$	-
SUBCONTRACTOR MARKUP	<input type="text" value="5.00%"/>	\$	-
TOTAL SUBCONTRACTOR COST WITH MARKUP		\$	-

Schedule Impact:	<input type="text" value=""/>	Calendar Days	TOTAL	\$	20,746.82
------------------	-------------------------------	---------------	--------------	----	------------------

Additional Comments:
Miron Construction needs an executed change order by 03/25/2024 in order to avoid a day-by-day schedule impact at a cost of \$2,177.00 per work day.

Project Manager / Project Accountant

Project No. 231023
Project Name: Kaukauna Pool Renovation
Desc of C/O: Costs associated with the revised Waterslide footings design: dimensions, depths and number of footings were changed.
Scope Description: Costs associated with the revised Waterslide footings design: dimensions, depths and number of footings were changed.
Prepared by: Naman Yagnik
Date: 3/5/24

Project Modification Pricing Worksheet

Labor Rate: Project Specific
Equip Rate: Equip



ID	Division	Cost Code	Item Description	Cost Type	Quantity	Unit of Measure	Labor Rate				Labor		Materials		Equipment				Total	
							Units Per Hour	Hours Per Unit	Hour Type	Total Hours	Rate Type	Hourly Rate	Total \$	Unit Cost	Total\$	Equipment Type	Billing Usage	Unit Cost		Total\$
1			Concrete Material - includes rebar, concrete, formwork, grout and testing	M	1.00	LS								\$ 15,510.00					\$ -	\$ 15,510.00
2			Footings & Foundations Installation	L	124.00	HR			Reg	124.00	CEMF	88.50	\$ 10,974.00						\$ -	\$ 10,974.00
3			Concrete Pump Truck	E	2.00	DA										CP - 128'-148' Boom Pump	DLY	\$ 1,650.00	\$ 3,300.00	\$ 3,300.00
4			(5) original spread footings	M	1.00	LS							\$ (6,394.30)	\$ (6,394.30)				\$ -	\$ (6,394.30)	
5			(5) original spread footings	L	1.00	LS	1.00						\$ (5,348.99)					\$ -	\$ (5,348.99)	
6																		\$ -	\$ -	
7																		\$ -	\$ -	
8																		\$ -	\$ -	
9																		\$ -	\$ -	
10																		\$ -	\$ -	
11																		\$ -	\$ -	
12																		\$ -	\$ -	
13																		\$ -	\$ -	
14																		\$ -	\$ -	
15																		\$ -	\$ -	
16																		\$ -	\$ -	
17																		\$ -	\$ -	
18																		\$ -	\$ -	
19																		\$ -	\$ -	

Effective June 1, 2023 through May 31, 2024

Total Labor:	\$ 5,625.01
Labor Inflation 0%	\$ -
Total Material:	\$ 9,115.70
Total Purchase Orders:	\$ -
Sales Tax@ 0.00%	\$ -
Total Equipment:	\$ 3,300.00
Total Miron C/O:	\$ 18,040.71