

Dzantik'i Heeni Playground - Options for Reducing Cost

Prepared by CBJ Engineering, January 2025

		Option A	Option B	Option C	Additive Alternates		
		Play Area, K-5, 1 Structure	Concrete Slab Only @ Pre-K & K-5 Play Areas.	Concrete Slab @ Pre-K and K-5 Areas, Safety Surfacing @ K-5 Play Area.	1	2	3
		\$367K	\$280K	\$367K	\$176	\$26K	\$72K
Grade K-5 (5-12 yrs) area							
1	Concrete Slab & Curb	* (50% of area only)	*	*			
2	Safety Surfacing	* (50% of area only)		*			
3	Composite Play Structure	*			*		
4	Swings						
5	Cone Spinner						
Grade Pre-K (2-5 years) area							
1	Concrete Slab & Curb		*	*			
2	Safety Surfacing						
3	Composite Play Structure						
4	Swings						
5	Cozy Dome						
General Elements							
1	Concrete ADA Side Walk		*			*	
2	New Fencing East side						*
3	Site Furnishings (Benches Etc.)						
4	Communication board						
5	Music Elements						
6	Leveling field for soccer at west end						

Key: * item is included in option.

See page 4 for Alternate descriptions.

Drawing: U:\CB\24-05 DH Playground2 - CAD\CorvusSheets.dwg last saved on 11/7/2024 4:57 PM was plotted by Brandy Little on 11/7/2024 5:20 PM

Option A: K-5 Structure Only

Install grade K-5 composite play structure & safety surfacing in its fall zone, reduce overall footprint of grade K-5 playground by 50%.

1. No ADA sidewalk.
2. Cost includes installing equipment at current design location, could move play area closer to building.
3. All existing fencing remains. No new gates nor fence panels.
4. Eliminates K-5 play equipment (swings and spinner) except for the composite play structure.

ROM* **\$367K**

*Rough Order of Magnitude

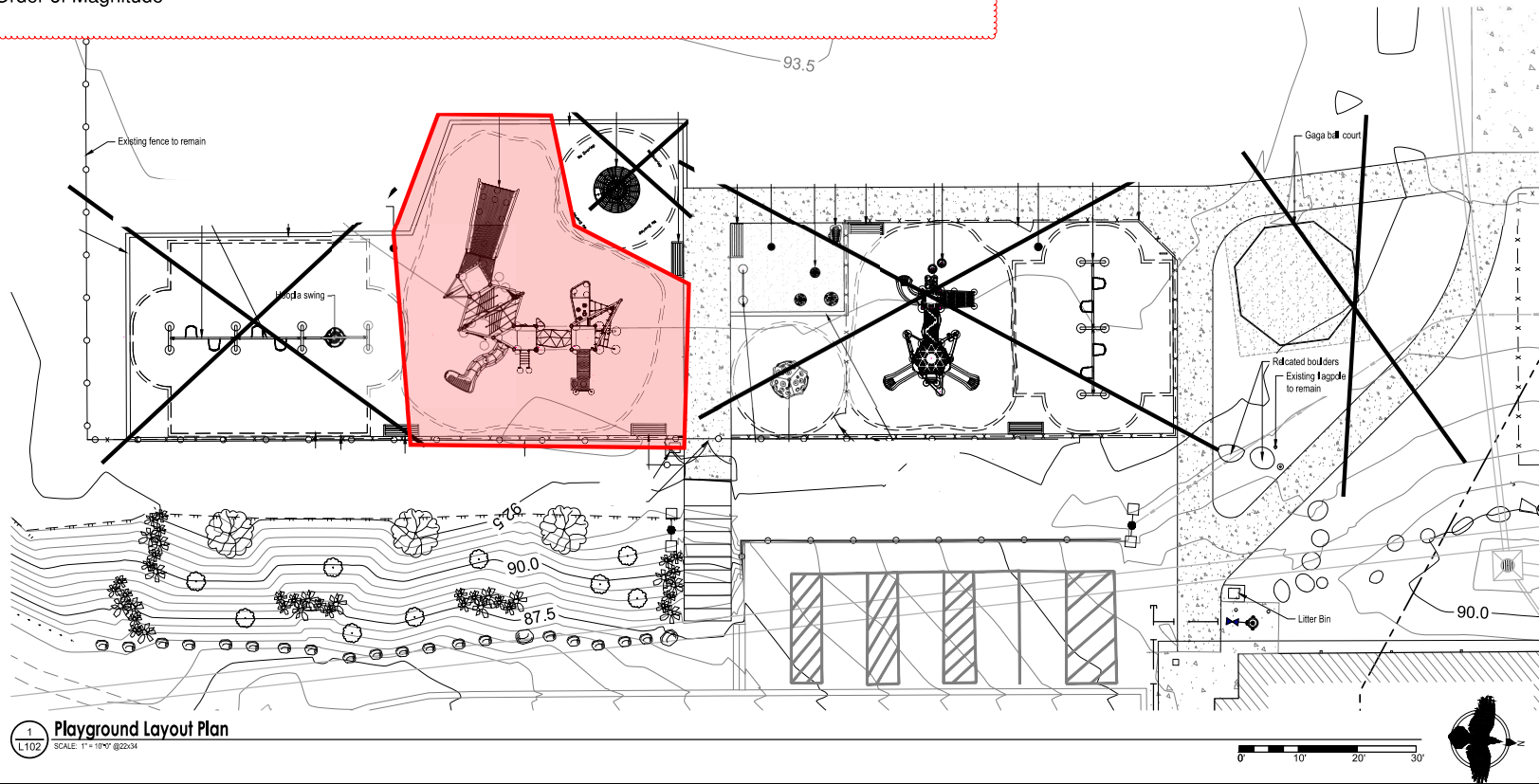

SEAL:
65% DESIGN

PROJECT NUMBER: BE25-188
CITY AND BOROUGH OF JUNEAU
DZANTIKI HEENI
PLAYGROUND
JUNEAU, ALASKA

If the above dimension does not measure exactly 1", this drawing has been enlarged or reduced, affecting all surfaces.

DATE: 11/07/2024
DRAWN BY: BL
CHECKED BY: CM
DELIVERABLE: 65%

PLAYGROUND
LAYOUT PLAN
SHEET #:
L102

©CORVUS DESIGN. ALL RIGHTS RESERVED.

Drawing: U:\CB\24-05 DH Playground2 - CAD\CorvusSheets.dwg, last saved on 11/7/2024 4:57 PM was plotted by Bradley Little on 11/7/2024 5:20 PM

Option B: Concrete Slab Only @ Pre-K & K-5 Play Areas.
Provide dirt work, concrete slab & curb for entire area of Pre-K and K-5 and ADA path to play area.

1. No equipment provided.
2. No safety surfacing provided.
3. All existing fencing remains. No new gates nor fence panels.

ROM* \$280K
*Rough Order of Magnitude

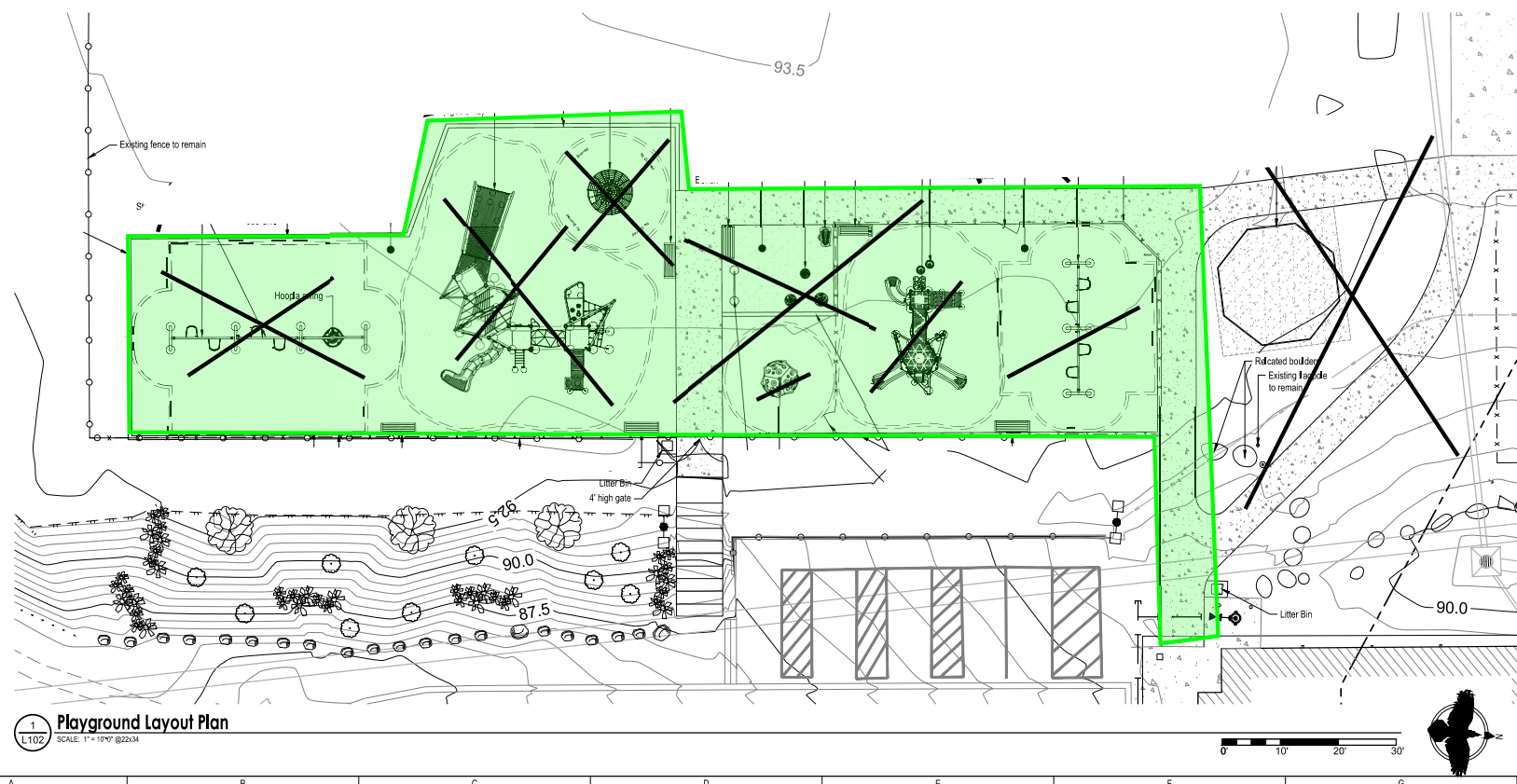

1
L102
Playground Layout Plan
SCALE: 1" = 10'-0" @ 22x34

**Corvus Design**
Landscape Architecture
www.corvus-design.com
Anchorage • 907.222.2859
7504-6 Fairbanks St. 99503
Juneau • 907.588.9000
119 Seward St. 99801
AEC# 11195



SEAL:
65% DESIGN

PROJECT NUMBER: BE25-188
CITY AND BOROUGH OF JUNEAU
DZANTIKI HEENI
PLAYGROUND
JUNEAU, ALASKA

If the above dimension does not measure exactly 1", this drawing has been enlarged or reduced, affecting all details.
DATE: 11/07/2024
DRAWN BY: BL
CHECKED BY: CM
DELIVERABLE: 65%

PLAYGROUND LAYOUT PLAN
SHEET #:
L102

©CORVUS DESIGN. ALL RIGHTS RESERVED

Option C: Concrete Slab @ Pre-K and K-5 Areas and Safety Surfacing @ K-5 playground.

Provide dirt work, concrete slab & curb for entire area and safety surfacing for 5–12-year-old play equipment area.

1. No equipment provided.
2. No ADA sidewalk provided
3. All existing fencing remains. No new gates nor fence panels.

ROM* \$367K

* Rough Order of Magnitude

Additive Alternate 1:

Provide 5–12-year-old play composite play structure.
ROM* \$176K

Additive Alternate 2:

Provide ADA concrete sidewalk to new play area.
ROM* \$26K

Additive Alternate 3:

Fencing. Remove 1 backstop and replace fencing @ plan east.

ROM* \$72K

* Rough Order of Magnitude

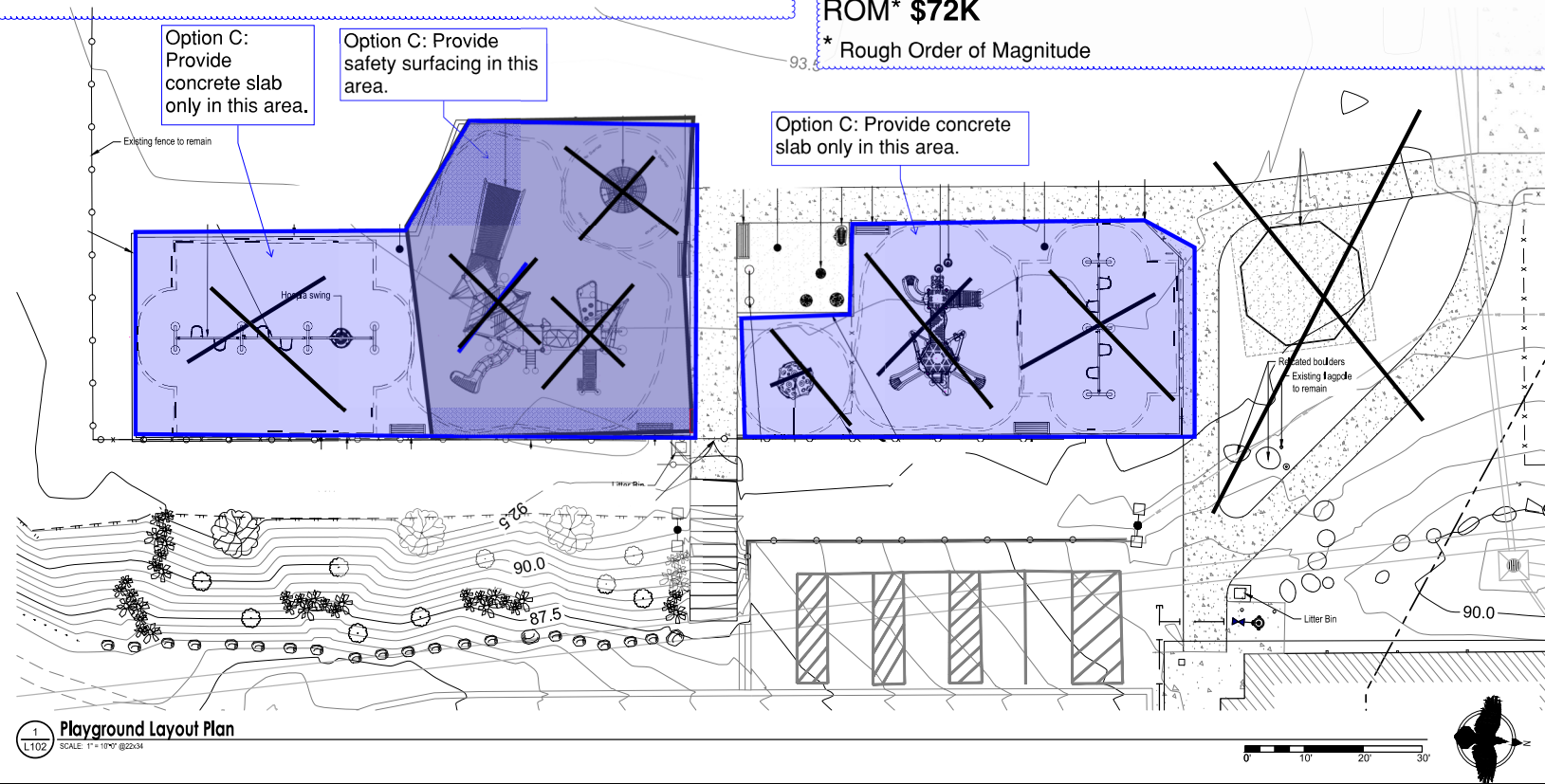

SEAL:

65% DESIGN

PROJECT NUMBER: BE25-188
CITY AND BOROUGH OF JUNEAU
DZANTIKI HEENI
PLAYGROUND
JUNEAU, ALASKA

If the above dimension does not measure exactly 1", this drawing has been enlarged or reduced, affecting all surfaces.

DATE: 11/07/2024
DRAWN BY: BL
CHECKED BY: CM
DELIVERABLE: 65%

PLAYGROUND
LAYOUT PLAN
SHEET #:

L102

©CORVUS DESIGN. ALL RIGHTS RESERVED.