

Dzantik'i Heeni Playground - Scope/Cost Options

Prepared by CBJ Engineering, February 2025

			TARGET BUDGETS BETWEEN \$575K - \$1.8M		
			\$880K TPC/\$590K CC	\$1.2M TPC/\$880K CC	\$1.5M TPC/\$1.07M CC
			K-5 Structure Only	K-5 & Pre-K Structures, Spinner, Dome, Music, Communication Board & Soccer	K-5 & Pre-K Structures, Dome, Music, Communication Board & Soccer
Grade K-5 (5-12 yrs) area					
1	Concrete slab & Safety Surfacing	Composite Structure Area	X	X	X
2		Swing area			X
3	Equipment	Play Composite Structure	X	X	X
4		Spinner		X	
5		Swings			
Grade Pre-K (2-5 yrs) area					
1	Concrete Slab & Safety Surfacing	Composite Structure Area	X	X	X
2		Swing area			X
3	Equipment	Play Composite Structure		X	X
4		Swings			
General Elements/Multi-Grade					
1	Concrete ADA Side Walk		X	X	X
2	Cozy Dome			X	X
3	Communication Board			X	X
4	Music Elements			X	X
5	Dirt Work to Rotate Soccer Field			X	X
Construction Cost (Target Construction Cost +/-)			\$630K (+40K)	\$834K (+\$4K)	\$1.05M (-\$20K)

Key: "X" item is included in option.

TPC: Total Project Cost

CC: Construction Cost

\$880K TPC/\$590K CC Option: K-5 Structure Only

Install grade K-5 composite play structure & safety surfacing in all areas except both Pre-K and K-5 swing areas.

1. ADA sidewalk.
2. K-5 Composite Play Structure and safety surfacing.
3. Safety surfacing for future Pre-K Structure.
4. All existing fencing remains. No new gates nor fence panels.

CC Estimation: \$630K CC (+40K)

CC- Construction Cost, TPC - Total Project Cost.

LEGEND:

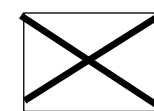

No concrete slab nor safety surfacing.

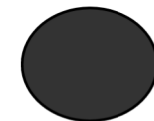

Future equipment location.

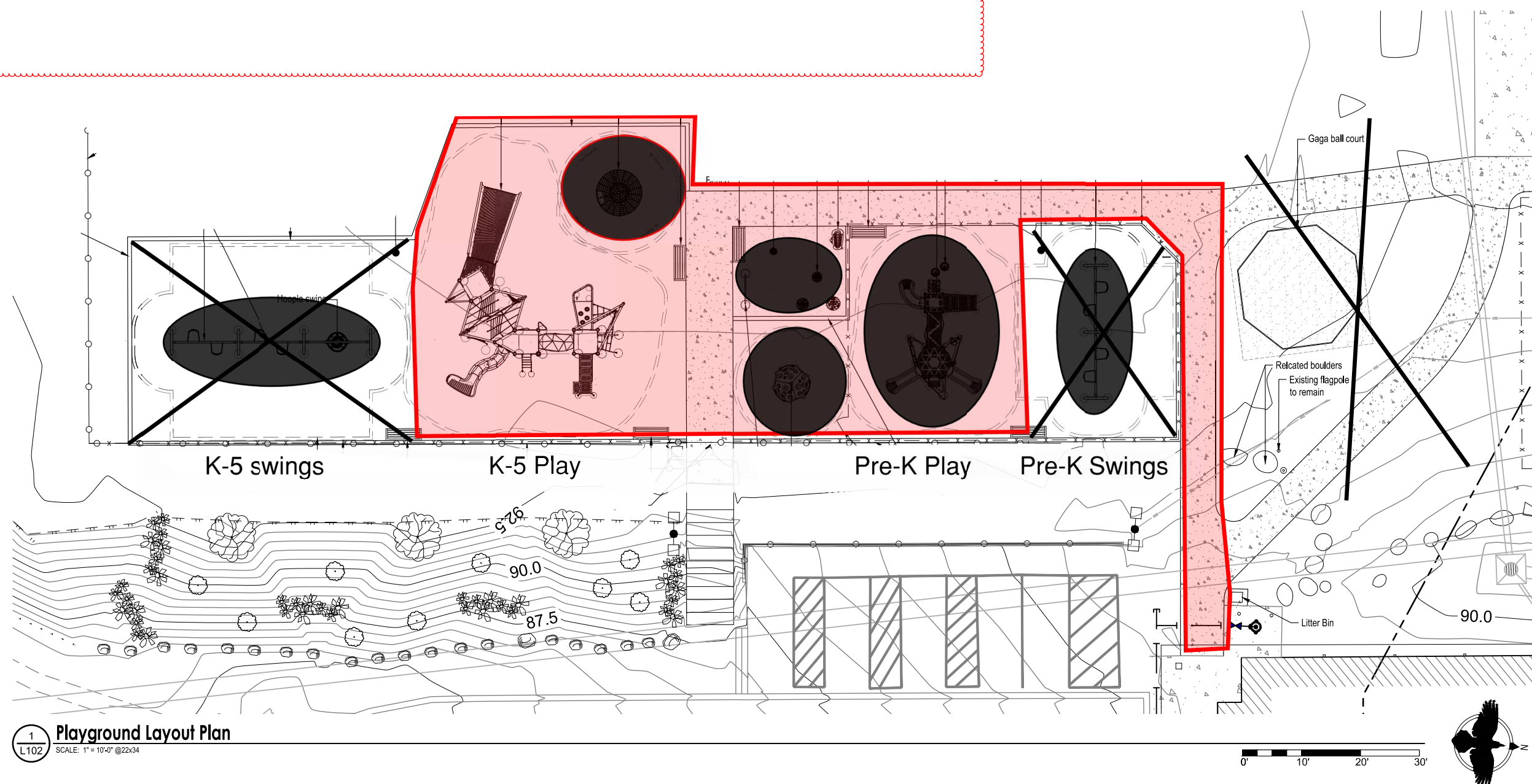

1
L102
Playground Layout Plan
SCALE: 1" = 10'-0" @ 22x34

\$1.2M TPC/\$830K CC Option: K-5 & Pre-K Structures, Spinner, Dome, Music & Communication Board

Install grade Pre-K & K-5 composite play structure, spinner, dome, music, and safety surfacing all areas except both swing areas.

1. ADA sidewalk.
2. K-5 Composite Play Structure, Spinner and safety surfacing.
3. Pre-K Composite Play Structure, and safety surfacing.
4. Multi-use(Pre-K to 5) Cozy Dome, Music Equipment, and Communication Board.
5. Clearing & Grubbing to **rotate soccer field**.
6. All existing fencing remains. No new gates nor fence panels.

CC Estimation: **\$834K (+\$4K)**

CC- Construction Cost, TPC - Total Project Cost.

LEGEND:

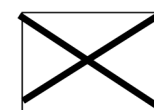

No concrete slab nor safety surfacing.

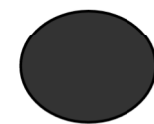

Future equipment location.

Cleaning & Grubbing in northwest corner of field to rotate soccer field.

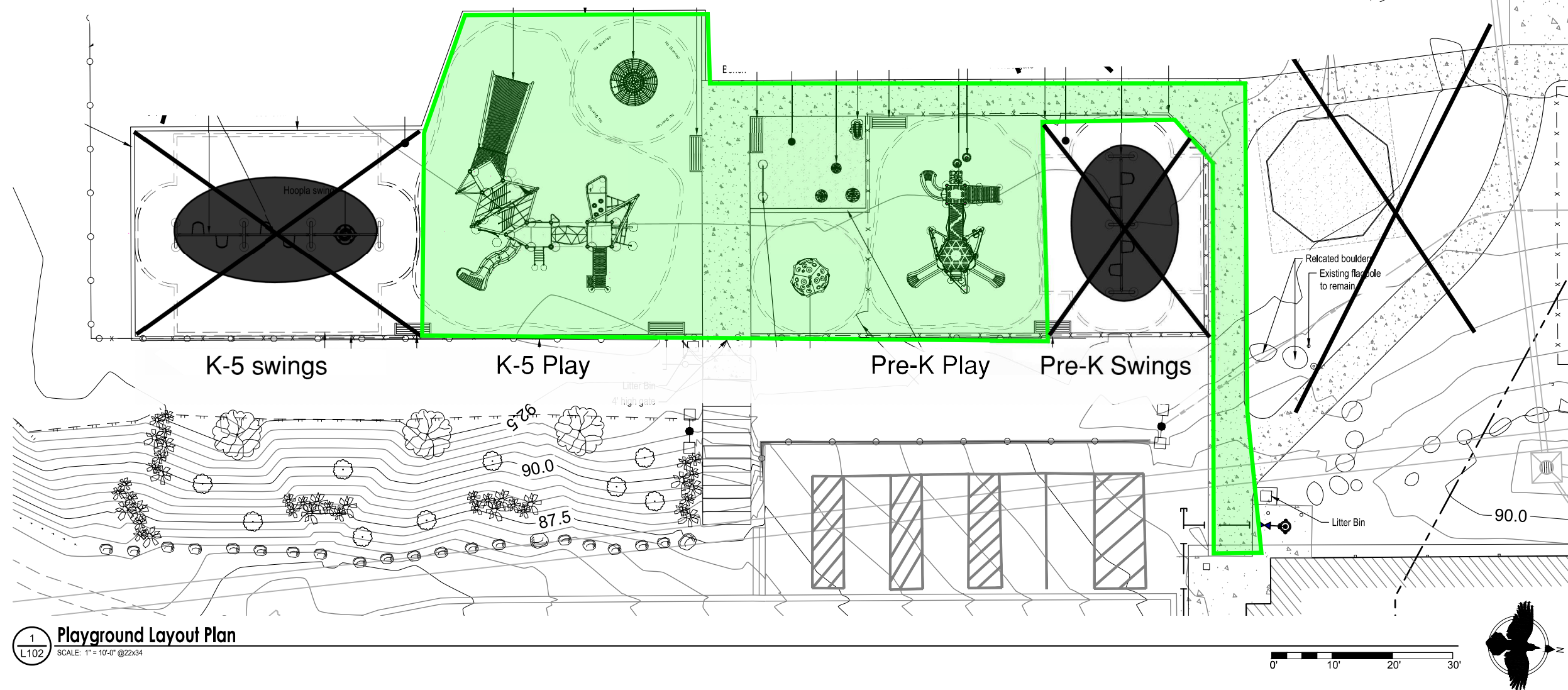

1
L102
Playground Layout Plan
SCALE: 1" = 10'-0" @ 22x34

\$1.5M TPC/\$1.07M CC Option: K-5 & Pre-K Structure, Dome, & Music

Install grade Pre-K & K-5 composite play structures, dome, music, communication board and safety surfacing all areas.

1. ADA sidewalk.
2. K-5 Composite Play Structure and safety surfacing.
3. Pre-K Composite Play Structure, and safety surfacing.
4. Safety surfacing at future Pre-K and K-5 Swing area.
5. Multi-use(Pre-K to 5) Cozy Dome, Music Equipment and Communication Board.
6. Clearing & grubbing to **rotate soccer field**.
7. All existing fencing remains. No new gates nor fence panels.

CC Estimation: **\$1.05M (-\$20K)**

CC- Construction Cost, TPC - Total Project Cost.

LEGEND:

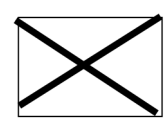

No concrete slab nor safety surfacing.

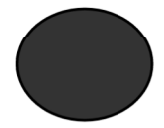

Future equipment location.

Cleaning & Grubbing in northwest corner of field to rotate soccer field.

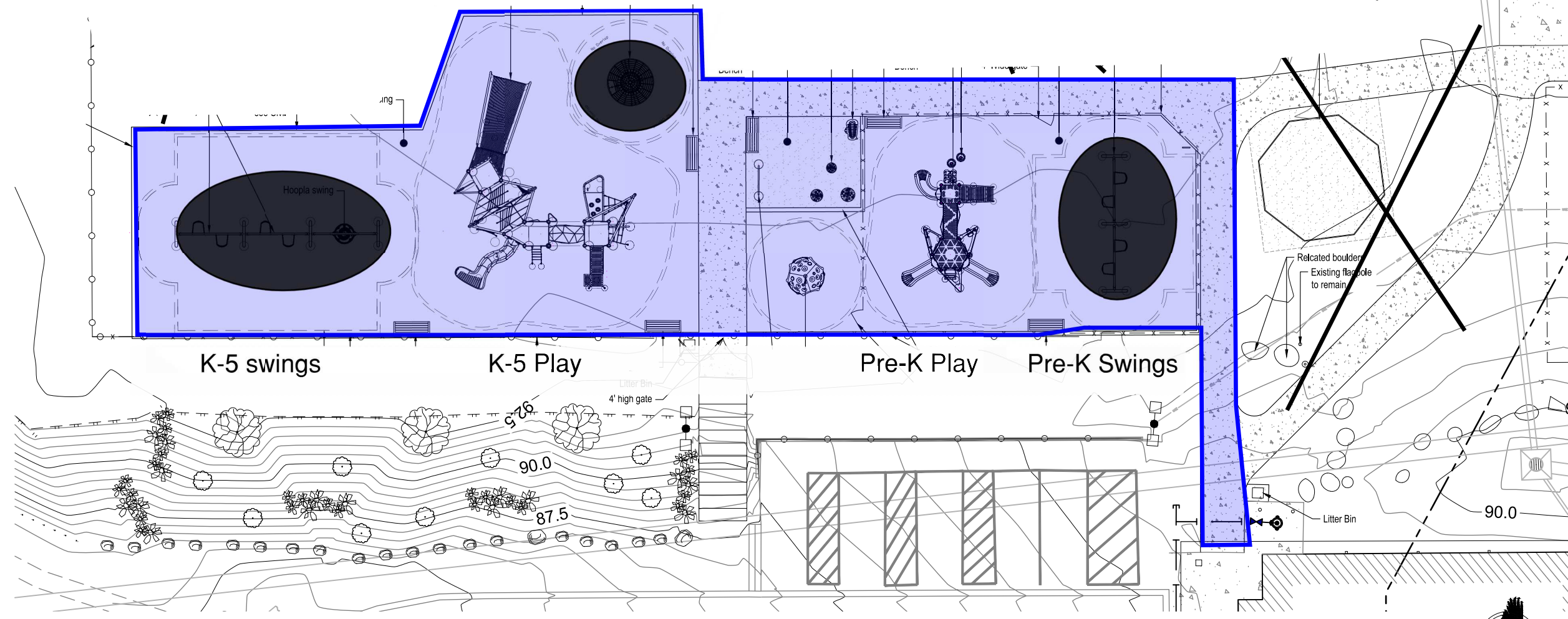

1
L102
Playground Layout Plan
SCALE: 1" = 10'-0" @ 22x34



Corvus Design
Landscape Architecture
www.corvus-design.com
Anchorage - 907.222.2859
2506-B Fairbanks St. 99503
Juneau - 907.988.9000
119 Seward St. 99801
AECC #1195



SEAL:

65% DESIGN

PROJECT NUMBER: BE25-188
CITY AND BOROUGH OF JUNEAU
DZANTIKI' HEENI
PLAYGROUND
JUNEAU, ALASKA

1" ACTUAL
If the above dimension does not measure exactly 1", this drawing has been enlarged or reduced, affecting all scales.

DATE: 11/07/2024
DRAWN BY: BL
CHECKED BY: CM
DELIVERABLE: 65%

PLAYGROUND
LAYOUT PLAN
SHEET #:
L102

Drawing J:\CB\24-05 DH Playground\2 - CAD\Corvus-Sheets.dwg last saved on 11/7/2024 4:57 PM was plotted by Bradley Little on 11/7/2024 5:20 PM