

Áak'w Landing

JUNEAU



The Ovoid

The Ovoid is the mother of Tlingit formline design. The shape is the building block that forms the visual center point from which all design patterns are created. From the Ovoid, all artwork develops and flows to establish movement and meaning.

Huna Totem
DEVELOPMENT GROUP



HUNA TOTEM



CORPORATION

HTC Development Team

Russell Dick

President and CEO
Huna Totem

Fred Parady

Chief Operating Officer
Huna Totem

Steve Moller

Chief Business Development
Officer
Huna Totem/Icy Strait Point

Architecture
Interiors
Construction
Management

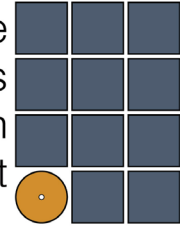

Tyler Hickman

SVP
Icy Strait Point

Mike Reimers

Sr. Director – Port Development
Huna Totem/Icy Strait Point

Mickey Richardson

VP of Creative Development
Huna Totem/Icy Strait Point

Wayne Jensen

President - Architect
Jensen Yorba Wall

Cory Wall

VP - Architect
Jensen Yorba Wall

Garth A. Schlemlein

Partner
Schlemlein Flick & Franklin

Bruce Walters

Construction Manager
Huna Totem



Jason Davis

President and CEO
Turnagain Marine

Josh Zellmer

Principle Engineer
Turnagain Marine



Huna Totem
DEVELOPMENT GROUP



ICY STRAIT



—POINT—
HOONAH, ALASKA



Global Port of the Year

 **SeatradeCruise**
Awards
Winner | 2020



Whittier

2024



Klawock

2024



Huna Totem
DEVELOPMENT GROUP





- Meets the Goals of VITF
- Supports the Long-Term Waterfront Plan
- Providing Additional Value to the City:
 - Park with Performance Areas
 - Connecting the Seawalk toward the Whale Statue
 - More Waterfront Restaurants Connected to Park
 - Increase views of Juneau & Waterfront
- Supports Future Developments of Willoughby District
- Open Year Round

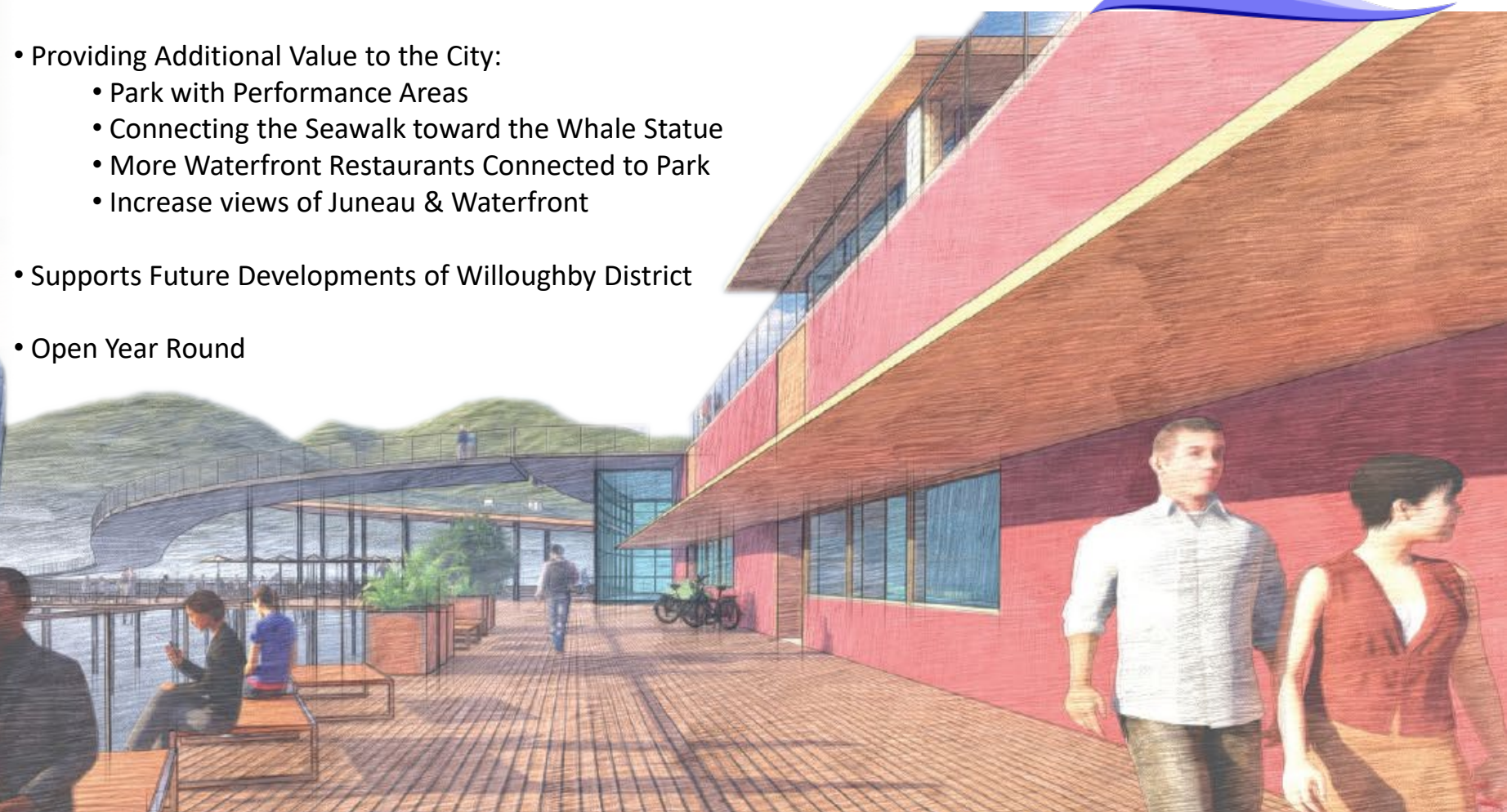

Huna Totem
DEVELOPMENT GROUP



Benefits of Separation of Buses & Turning Left – 1/5 Transfer

Conditional Use Concept
November 22, 2022

Seawalk Level & Site Plan with bus parking

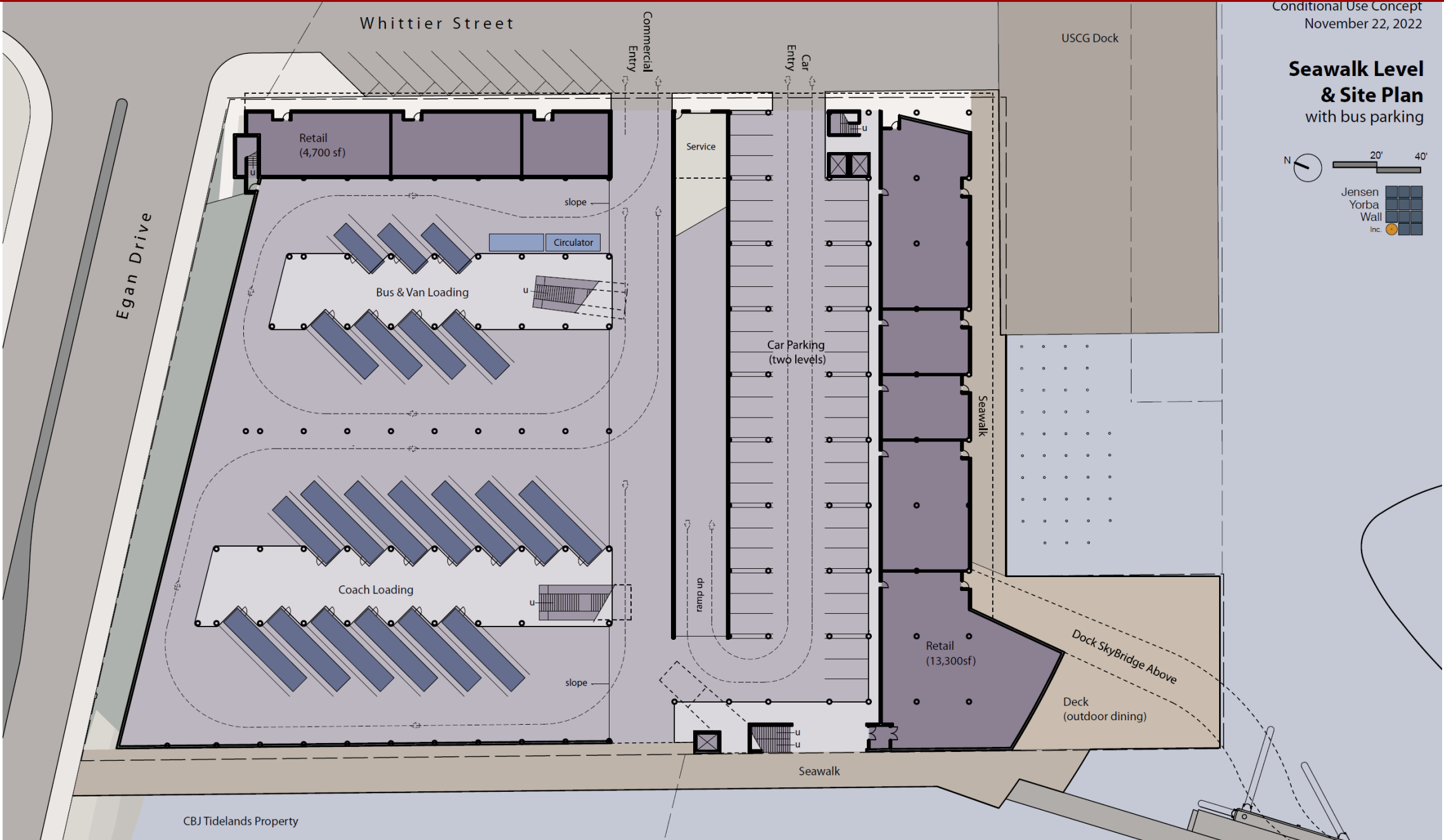
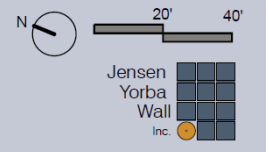

CBJ Tidelands Property

5. The dock owner will, at their own expense, provide shore power within 24 months after an appropriately[1]sized power line is within 25 feet of the property line. When shore power is provided, large ships using the dock will be required to use shore power instead of ship power.



Transformer availability may affect the timeline.

7. The dock is limited to one (1) large cruise ship (750 feet or more in length OR 950 or more passengers) each 24 hour period beginning at midnight.



Dock is designed with tour boat loading opposite side from the cruise ship.

9. The dock will not accommodate lightering from a cruise ship at anchor if that ship is over 750 feet in length or accommodates more than 950 passengers at full capacity.



HUNA TOTEM



CORPORATION

ICY STRAIT



—POINT—

HOONAH, ALASKA



ALASKA NATIVE VOICES

Huna Totem 
DEVELOPMENT GROUP

HUNA TOTEM



CORPORATION

