

Colorado Liquor Retail License Application

* Note that the Division will not accept cash Paid by Check Date Uploaded to MoveIt
 Paid Online

New License New-Concurrent Transfer of Ownership State Property Only Master file

- All answers must be printed in black ink or typewritten
- Applicant must check the appropriate box(es)
- Applicant should obtain a copy of the Colorado Liquor and Beer Code: SBG.Colorado.gov/Liquor

Applicant is applying as a/an Individual Limited Liability Company Association or Other
 Corporation Partnership (includes Limited Liability and Husband and Wife Partnerships)

Applicant Name If an LLC, name of LLC; if partnership, at least 2 partner's names; if corporation, name of corporation

WOODS SUPERMARKET INC.

FEIN Number State Sales Tax Number

Trade Name of Establishment (DBA) Business Telephone
WOODS SUPERMARKET 970-541-9080

Address of Premises (specify exact location of premises, include suite/unit numbers)
4320 LEDGE ROCK DR.

City County State ZIP Code
JOHNSTOWN WELD CO 80534

Mailing Address (Number and Street) City or Town State ZIP Code
703 EAST COLLEGE P.O. BOX 880 BOLIVAR MO 65611

Email Address
dshultz@woodssupermarket.com

If the premises currently has a liquor or beer license, you **must** answer the following questions.

Present Trade Name of Establishment (DBA)
New Business

Present State License Number Present Class of License Present Expiration Date

Section A Nonrefundable application fees*

- Application Fee for New License\$1,100.00
- Application Fee for New License with Concurrent Review\$1,200.00
- Application Fee for Transfer.....\$1,100.00

Section B Liquor License Fees*

- Add Optional Premises to H & R\$100.00 X Total
- Add Sidewalk Service Area.....\$75.00
- Arts License (City).....\$308.75
- Arts License (County)\$308.75
- Beer and Wine License (City).....\$351.25
- Beer and Wine License (County).....\$436.25
- Brew Pub License (City)\$750.00
- Brew Pub License (County).....\$750.00
- Campus Liquor Complex (City)\$500.00
- Campus Liquor Complex (County)\$500.00
- Campus Liquor Complex (State)\$500.00
- Club License (City)\$308.75
- Club License (County).....\$308.75
- Distillery Pub License (City).....\$750.00
- Distillery Pub License (County)\$750.00
- Hotel and Restaurant License (City).....\$500.00
- Hotel and Restaurant License (County)\$500.00
- Hotel and Restaurant License with one optional premises (City).....\$600.00
- Hotel and Restaurant License with one optional premises (County).....\$600.00

Section B Liquor License Fees* (Continued)

<input type="checkbox"/>	Liquor-Licensed Drugstore (City).....	\$227.50
<input type="checkbox"/>	Liquor-Licensed Drugstore (County).....	\$312.50
<input type="checkbox"/>	Lodging & Entertainment - L&E (City)	\$500.00
<input type="checkbox"/>	Lodging & Entertainment - L&E (County)	\$500.00
<input type="checkbox"/>	Manager Registration - H & R	\$30.00
<input type="checkbox"/>	Manager Registration - Tavern	\$30.00
<input type="checkbox"/>	Manager Registration - Lodging & Entertainment	\$30.00
<input type="checkbox"/>	Manager Registration - Campus Liquor Complex	\$30.00
<input type="checkbox"/>	Optional Premises License (City)	\$500.00
<input type="checkbox"/>	Optional Premises License (County).....	\$500.00
<input type="checkbox"/>	Racetrack License (City)	\$500.00
<input type="checkbox"/>	Racetrack License (County)	\$500.00
<input type="checkbox"/>	Resort Complex License (City).....	\$500.00
<input type="checkbox"/>	Resort Complex License (County).....	\$500.00
<input type="checkbox"/>	Related Facility - Campus Liquor Complex (City).....	\$160.00
<input type="checkbox"/>	Related Facility - Campus Liquor Complex (County)	\$160.00
<input type="checkbox"/>	Related Facility - Campus Liquor Complex (State)	\$160.00
<input type="checkbox"/>	Retail Gaming Tavern License (City).....	\$500.00
<input type="checkbox"/>	Retail Gaming Tavern License (County).....	\$500.00
<input type="checkbox"/>	Retail Liquor Store License - Additional (City).....	\$227.50
<input type="checkbox"/>	Retail Liquor Store License - Additional (County).....	\$312.50
<input checked="" type="checkbox"/>	Retail Liquor Store (City)	\$227.50

Section B Liquor License Fees* (Continued)

- Retail Liquor Store (County).....\$312.50
- Tavern License (City).....\$500.00
- Tavern License (County).....\$500.00
- Vintners Restaurant License (City).....\$750.00
- Vintners Restaurant License (County).....\$750.00

Questions? Visit: SBG.Colorado.gov/Liquor for more information

Do not write in this space - For Department of Revenue use only

Liability Information

License Account Number

Liability Date

License Issued Through (Expiration Date)

Total

\$

Application Documents Checklist and Worksheet

Instructions: This checklist should be utilized to assist applicants with filing all required documents for licensure. **All** documents must be properly signed and correspond with the name of the applicant exactly. **All** documents must be typed or legibly printed. Upon final State approval the license will be mailed to the local licensing authority. Application fees are nonrefundable.

Questions? Visit: SBG.Colorado.gov/Liquor for more information

Items submitted, please check all appropriate boxes completed or documents submitted

I. Applicant information

- Applicant/Licensee identified
- State sales tax license number listed or applied for at time of application
- License type or other transaction identified
- Return originals to local authority (additional items may be required by the local licensing authority)
- All sections of the application need to be completed
- Master file applicants must include the Application for Master File form DR 8415 and applicable fees to this Retail License Application

II. Diagram of the premises

- No larger than 8½" X 11"
- Dimensions included (does not have to be to scale). Exterior areas should show type of control (fences, walls, entry/exit points, etc.)
- Separate diagram for each floor (if multiple levels)
- Return originals to local authority (additional items may be required by the local licensing authority)
- Kitchen - identified if Hotel and Restaurant
- Bold/Outlined Licensed Premises

III. Proof of property possession (One Year Needed)

- Deed in name of the applicant (or) (matching Applicant Name provided on page 1) date stamped / filed with County Clerk
- Lease in the name of the applicant (or) (matching Applicant Name provided on page 1)
- Lease assignment in the name of the applicant with proper consent from the landlord and acceptance by the applicant
- Other agreement if not deed or lease. (matching Applicant Name provided on page 1)

IV. Background information (DR 8404-I) and financial documents

- Complete DR 8404-I for each principal (individuals with more than 10% ownership, officers, directors, partners, members)
- Fingerprints taken and submitted to the appropriate Local Licensing Authority through an approved State Vendor. Master File applicants submit results to the State
Do not complete fingerprint cards prior to submitting your application.
The Vendors are as follows:
IdentoGO
Appointment Scheduling Website: <https://uenroll.identogo.com/workflows/25YQHT>
Phone: 844-539-5539 (toll-free)
IdentoGO FAQs: <https://www.colorado.gov/pacific/cbi/identification-faqs>
State Liquor Code for IdentoGO: 25YQHT
Colorado Fingerprinting
Appointment Scheduling Website: <http://www.coloradofingerprinting.com/cabs/>
Phone: 720-292-2722 833-224-2227 (toll free)
State Liquor Code for Colorado Fingerprinting: C030LIQI

- Purchase agreement, stock transfer agreement, and/or authorization to transfer license
- List of all notes and loans (Copies to also be attached)

V. Sole proprietor/husband and wife partnership (if applicable)

- Form DR 4679 Lawful Presence Affidavit N/A
- Copy of State issued Driver's License or Colorado Identification Card for each applicant

VI. Corporate applicant information (if applicable)

- Certificate of Incorporation
- Certificate of Good Standing
- Certificate of Authorization if foreign corporation (out of state applicants only)

VII. Partnership applicant information (if applicable)

- Partnership Agreement (general or limited).
- Certificate of Good Standing

VIII. Limited Liability Company applicant information (if applicable)

- Copy of articles of organization N/A
- Certificate of Good Standing
- Copy of Operating Agreement (if applicable)
- Certificate of Authority if foreign LLC (out of state applicants only)

IX. Manager registration for Hotel and Restaurant, Tavern, Lodging & Entertainment, and Campus Liquor Complex licenses when included with this application

- \$30.00 fee N/A
- If owner is managing, no fee required

1. Is the applicant (including any of the partners if a partnership; members or managers if a limited liability company; or officers, stockholders or directors if a corporation) or managers under the age of twenty-one years?..... Yes No

2. Has the applicant (including any of the partners if a partnership; members or managers if a limited liability company; or officers, stockholders or directors if a corporation) or managers ever (in Colorado or any other state):

a. Been denied an alcohol beverage license?..... Yes No

b. Had an alcohol beverage license suspended or revoked?..... Yes No

c. Had interest in another entity that had an alcohol beverage license suspended or revoked?..... Yes No

If you answered yes to a, b or c above, explain in detail on a separate sheet.

3. Has a liquor license application (same license class), that was located within 500 feet of the proposed premises, been denied within the preceding two years?..... Yes No

If "yes", explain in detail.

4. Are the premises to be licensed within 500 feet, of any public or private school that meets compulsory education requirements of Colorado law, or the principal campus of any college, university or seminary?..... Yes No

or

Waiver by local ordinance? Yes No

Other

5. Is your Liquor Licensed Drugstore (LLDS) or Retail Liquor Store (RLS) within 1500 feet of another retail liquor license for off-premises sales in a jurisdiction with a population of greater than (>) 10,000? **NOTE:** The distance shall be determined by a radius measurement that begins at the principal doorway of the LLDS/RLS premises for which the application is being made and ends at the principal doorway of the Licensed LLDS/RLS..... Yes No

6. Is your Liquor Licensed Drugstore (LLDS) or Retail Liquor Store (RLS) within 3000 feet of another retail liquor license for off-premises sales in a jurisdiction with a population of less than (<) 10,000? **NOTE:** The distance shall be determined by a radius measurement that begins at the principal doorway of the LLDS/RLS premises for which the application is being made and ends at the principal doorway of the Licensed LLDS/RLS..... Yes No

For additional Retail Liquor Store only.

a. Was your Retail Liquor Store License issued on or before January 1, 2016?.... Yes No

b. Are you a Colorado resident?..... Yes No

7. Has a liquor or beer license ever been issued to the applicant (including any of the partners, if a partnership; members or manager if a Limited Liability Company; or officers, stockholders or directors if a corporation)? If yes, identify the name of the business and list any **current** financial interest in said business including any loans to or from a licensee..... Yes No
See Attachment

8. Does the applicant, as listed on line 2 of this application, **have legal possession of the premises by ownership, lease or other arrangement?**..... Yes No

Ownership Lease Other (Explain in detail) Lease Attached

a. If leased, list name of landlord and tenant, and date of expiration, **exactly** as they appear on the lease:

Landlord	Tenant	Expires
CARSON DEVELOPMENT	WOODS SUPERMARKET	2045

b. Is a percentage of alcohol sales included as compensation to the landlord? If yes, complete question on page 9..... Yes No

c. Attach a diagram that designates the area to be licensed in black bold outline (including dimensions) which shows the bars, brewery, walls, partitions, entrances, exits and what each room shall be utilized for in this business. This diagram should be no larger than 8½" X 11".

Question #7 DR8404 Woods Supermarket.

Woods Supermarket currently holds Liquor licenses in the state of Missouri.

Ten grocery store licenses including sampling licenses.

Two convenience store locations.

The Managing Officer for all locations is Daniel Shultz V.P. of Merchandising for Woods Supermarkets inc.

9. Who, besides the owners listed in this application (including persons, firms, partnerships, corporations, limited liability companies) will loan or give money, inventory, furniture or equipment to or for use in this business; or who will receive money from this business? Attach a separate sheet if necessary.

Last Name		First Name	
N/A			
Date of Birth (MM/DD/YY)	FEIN or SSN Number	Interest/Percentage	
Last Name		First Name	
Date of Birth (MM/DD/YY)	FEIN or SSN Number	Interest/Percentage	
Last Name		First Name	
Date of Birth (MM/DD/YY)	FEIN or SSN Number	Interest/Percentage	

Attach copies of all notes and security instruments and any written agreement or details of any oral agreement, by which any person (including partnerships, corporations, limited liability companies, etc.) will share in the profit or gross proceeds of this establishment, and any agreement relating to the business which is contingent or conditional in any way by volume, profit, sales, giving of advice or consultation.

10. Optional Premises or Hotel and Restaurant Licenses with Optional Premises: N/A
Has a local ordinance or resolution authorizing optional premises been adopted?... Yes No

Number of additional Optional Premise areas requested. (See license fee chart) N/A

For the addition of a Sidewalk Service Area per Regulation 47-302(A)(4), include a diagram of the service area and documentation received from the local governing body authorizing use of the sidewalk. Documentation may include but is not limited to a statement of use, permit, easement, or other legal permissions.

11. Liquor Licensed Drugstore (LLDS) applicants, answer the following: N/A
a. Is there a pharmacy, licensed by the Colorado Board of Pharmacy, located within the applicant's LLDS premise?..... Yes No

If "yes" a copy of license must be attached.

N/A

12. Club Liquor License applicants answer the following: **Attach a copy of applicable documentation**

a. Is the applicant organization operated solely for a national, social, fraternal, patriotic, political or athletic purpose and not for pecuniary gain?..... Yes No

b. Is the applicant organization a regularly chartered branch, lodge or chapter of a national organization which is operated solely for the object of a patriotic or fraternal organization or society, but not for pecuniary gain?..... Yes No

c. How long has the club been incorporated?.....

d. Has applicant occupied an establishment for three years (three years required) that was operated solely for the reasons stated above?..... Yes No

13. Brew-Pub, Distillery Pub or Vintner's Restaurant applicants answer the following: N/A

a. Has the applicant received or applied for a Federal Permit? (Copy of permit or application must be attached)..... Yes No

14. Campus Liquor Complex applicants answer the following: N/A

a. Is the applicant an institution of higher education?..... Yes No

b. Is the applicant a person who contracts with the institution of higher education to provide food services?..... Yes No

If "yes" please provide a copy of the contract with the institution of higher education to provide food services.

15. For all on-premises applicants.

a. For all Liquor Licensed Drugstores (LLDS) the Permitted Manager must also submit an Manager Permit Application - DR 8000 and fingerprints.

Last Name of Manager

First Name of Manager

16. Does this manager act as the manager of, or have a financial interest in, any other liquor licensed establishment in the State of Colorado? If yes, provide name, type of license and account number..... Yes No

Name

Type of License

Account Number

17. Related Facility - Campus Liquor Complex applicants answer the following: N/A

a. Is the related facility located within the boundaries of the Campus Liquor Complex?..... Yes No

If yes, please provide a map of the geographical location within the Campus Liquor Complex.

If no, this license type is not available for issues outside the geographical location of the Campus Liquor Complex.

b. Designated Manager for Related Facility - Campus Liquor Complex

Last Name of Manager	First Name of Manager
N/A	

18. Tax Information.

a. Has the applicant, including its manager, partners, officer, directors, stockholders, members (LLC), managing members (LLC), or any other person with a 10% or greater financial interest in the applicant, been found in final order of a tax agency to be delinquent in the payment of any state or local taxes, penalties, or interest related to a business?..... Yes No

b. Has the applicant, including its manager, partners, officer, directors, stockholders, members (LLC), managing members (LLC), or any other person with a 10% or greater financial interest in the applicant failed to pay any fees or surcharges imposed pursuant to section 44-3-503, C.R.S.?..... Yes No

If applicant is a corporation, partnership, association or limited liability company, applicant must list all **Officers, Directors, General Partners, and Managing Members**. In addition, applicant must list any stockholders, partners, or members with **ownership of 10% or more in the applicant**. All persons listed below must also attach form DR 8404-I (Individual History Record), and make an appointment with an approved State Vendor through their website. See application checklist, Section IV, for details.

Name	Date of Birth (MM/DD/YY)
DON WOODS JR.	[REDACTED]

Street Address
[REDACTED]

City	State	ZIP Code	Position	%Owned
[REDACTED]	[REDACTED]	[REDACTED]	PRESIDENT	19.01%

Name	Date of Birth (MM/DD/YY)
JOAN WOODS	[REDACTED]

Street Address
[REDACTED]

City	State	ZIP Code	Position	%Owned
[REDACTED]	[REDACTED]	[REDACTED]	SECRETARY/TREASURER	21.58%

Name	Date of Birth (MM/DD/YY)
DONALD WOODS J	[REDACTED]

Street Address
[REDACTED]

City	State	ZIP Code	Position	%Owned
[REDACTED]	[REDACTED]	[REDACTED]	VICE PRESIDENT	8.32%

Name	Date of Birth (MM/DD/YY)

Street Address

City	State	ZIP Code	Position	%Owned

Name	Date of Birth (MM/DD/YY)

Street Address

City	State	ZIP Code	Position	%Owned

** If applicant is owned 100% by a parent company, please list the designated principal officer on above.

** Corporations - the President, Vice-President, Secretary and Treasurer must be accounted for above (Include ownership percentage if applicable)

** If total ownership percentage disclosed here does not total 100%, applicant must check this box:

Applicant affirms that no individual other than these disclosed herein owns 10% or more of the applicant and does not have financial interest in a prohibited liquor license pursuant to Article 3 or 5, C.R.S.

Oath Of Applicant

I declare under penalty of perjury in the second degree that this application and all attachments are true, correct, and complete to the best of my knowledge. I also acknowledge that it is my responsibility and the responsibility of my agents and employees to comply with the provisions of the Colorado Liquor or Beer and Wine Code which affect my license.

Printed Name	Title
DANIEL JAMES SHULTZ	V.P. MARKETING
Authorized Signature	Date (MM/DD/YY)
	7/24/24

Report and Approval of Local Licensing Authority (City/County)

Date application filed with local authority	Date of local authority hearing (for new license applicants; cannot be less than 30 days from date of application)

For Transfer Applications Only - Is the license being transferred valid?..... Yes No

The Local Licensing Authority Hereby Affirms that each person required to file DR 8404-I (Individual History Record) or a DR 8000 (Manager Permit) has been:

- Fingerprinted
- Subject to background investigation, including NCIC/CCIC check for outstanding warrants

That the local authority has conducted, or intends to conduct, an inspection of the proposed premises to ensure that the applicant is in compliance with and aware of, liquor code provisions affecting their class of license

(Check One)

- Date of inspection or anticipated date
- Will conduct inspection upon approval of state licensing authority

Is the Liquor Licensed Drugstore (LLDS) or Retail Liquor Store (RLS) within 1,500 feet of another retail liquor license for off-premises sales in a jurisdiction with a population of > 10,0000? Yes No

Is the Liquor Licensed Drugstore (LLDS) or Retail Liquor Store (RLS) within 3,000 feet of another retail liquor license for off-premises sales in a jurisdiction with a population of < 10,0000? Yes No

NOTE: The distance shall be determined by a radius measurement that begins at the principal doorway of the LLDS/RLS premises for which the application is being made and ends at the principal doorway of the Licensed LLDS/RLS.

Does the Liquor-Licensed Drugstore (LLDS) have at least twenty percent (20%) of the applicant's gross annual income derived from the sale of food, during the prior twelve (12) month period? Yes No

The foregoing application has been examined; and the premises, business to be conducted, and character of the applicant are satisfactory. We do report that such license, if granted, will meet the reasonable requirements of the neighborhood and the desires of the adult inhabitants, and will comply with the provisions of Title 44, Article 4 or 3, C.R.S., and Liquor Rules. **Therefore, this application is approved.**

Local Licensing Authority for Telephone Number Town, City
 County

Printed Name Title

Signature Date (MM/DD/YY)

Printed Name Title

Signature Date (MM/DD/YY)



STATE of MISSOURI

JAMES C. KIRKPATRICK, Secretary of State

Corporation Department

Certificate of Incorporation

WHEREAS, duplicate originals of Articles of Incorporation of
WOODS SUPER MARKETS, INC.

have been received and filed in the office of the Secretary of State and which Articles, in all respects, comply with the requirements of The General and Business Corporation Law:

NOW, THEREFORE, I, JAMES C. KIRKPATRICK, Secretary of State of the State of Missouri, by virtue of the authority vested in me by law, do hereby certify and declare
WOODS SUPER MARKETS, INC.

a body corporate, duly organized this day and that it is entitled to all rights and privileges granted corporations organized under The General and Business Corporation Law; that the address of its initial Registered Office in Missouri is
Main Street, Buffalo,

that its period of existence is perpetual; and that the amount of its Authorized Shares is FIVE HUNDRED THOUSAND Dollars.

IN TESTIMONY WHEREOF, I have hereunto set my hand and affixed the GREAT SEAL of the State of Missouri, at the City of Jefferson, this 18th day of June, 1970.



James C. Kirkpatrick
Secretary of State
T R Cloud
Deputy Secretary of State

RECEIVED OF: WOODS SUPER MARKETS, INC.
Two Hundred Eighty-eight and no/100 Dollars, \$ 288.00

For Credit of General Revenue Fund, on Account of Incorporation Tax and Fee.

NO. for DONALD C. WOODS SUPER MARKETS, INC. *Donohue Miller*
IS 142480.

No. 142479

Donohue Miller
Deputy Collector of Revenue

STATE OF MISSOURI



John R. Ashcroft
Secretary of State

CORPORATION DIVISION
CERTIFICATE OF GOOD STANDING

I, JOHN R. ASHCROFT, Secretary of State of the State of Missouri, do hereby certify that the records in my office and in my care and custody reveal that

WOODS SUPER MARKETS, INC.
00142479

was created under the laws of this State on the 18th day of June, 1970, and is in good standing, having fully complied with all requirements of this office.

IN TESTIMONY WHEREOF, I hereunto set my hand and cause to be affixed the GREAT SEAL of the State of Missouri. Done at the City of Jefferson, this 4th day of June, 2024.

Secretary of State

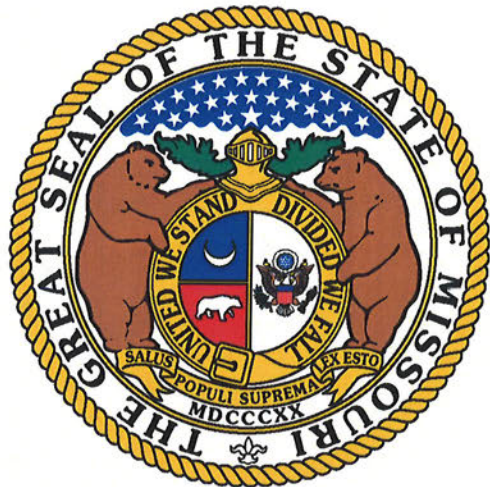

Certification Number: CERT-06042024-0064



PROJECT ADDRESS
 WOODS SUPERMARKET

PROJECT ADDRESS
 WOODS SUPERMARKET

DATE	2/2
ISSUE NO.	02/01/07
ISSUE BY	SS/PJH
ISSUE FOR	REVISED
DATE	
ISSUE NO.	
ISSUE BY	
ISSUE FOR	
DATE	
ISSUE NO.	
ISSUE BY	
ISSUE FOR	

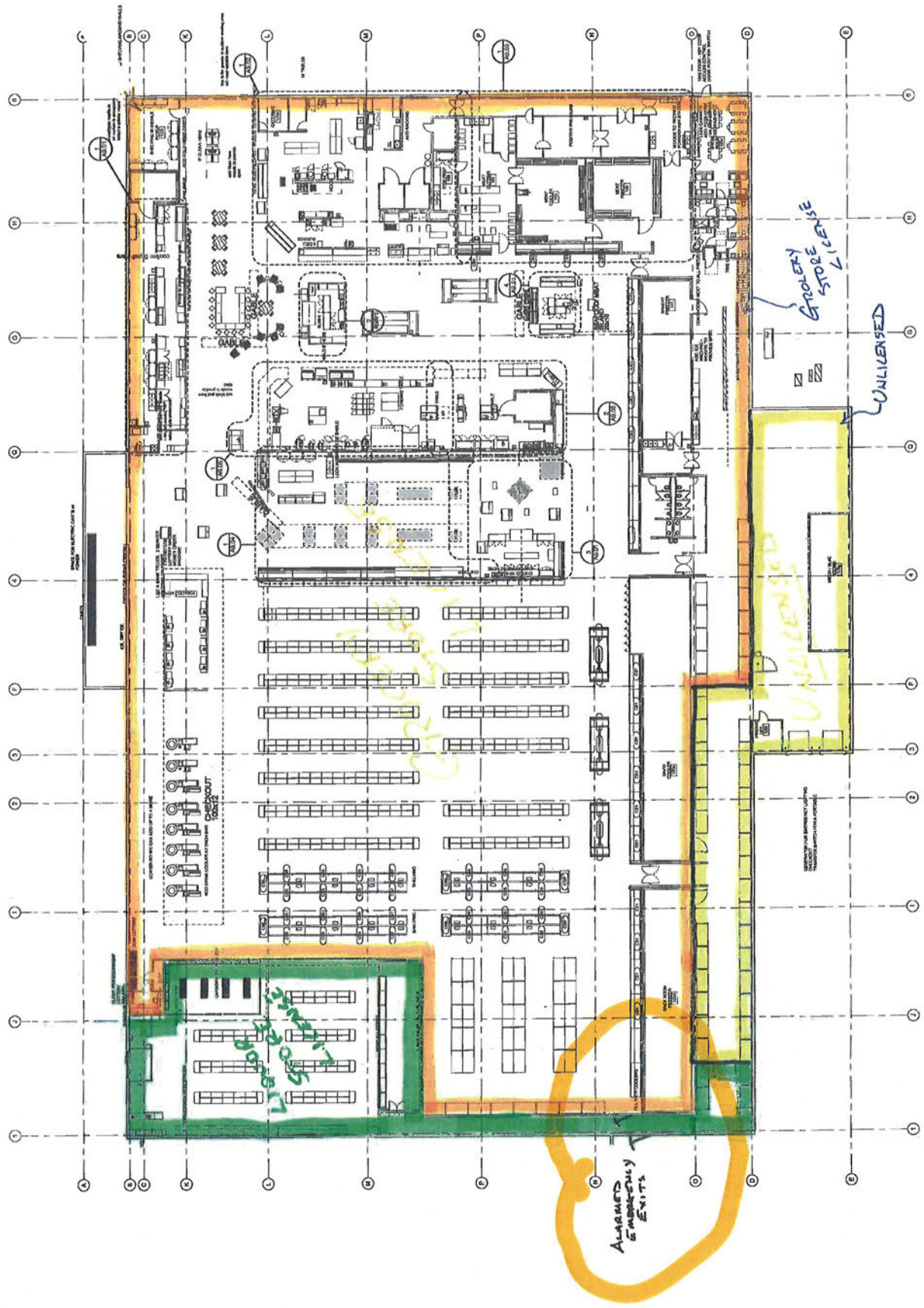

DATE: 11/20/06 11:00 AM

Tax Check Authorization, Waiver, and Request to Release Information

I, Donald C Woods, Jr am signing this Tax Check Authorization, Waiver and Request to Release Information (hereinafter "Waiver") on behalf of Wood Supermarket (the "Applicant/Licensee") to permit the Colorado Department of Revenue and any other state or local taxing authority to release information and documentation that may otherwise be confidential, as provided below. If I am signing this Waiver for someone other than myself, including on behalf of a business entity, I certify that I have the authority to execute this Waiver on behalf of the Applicant/Licensee.

The Executive Director of the Colorado Department of Revenue is the State Licensing Authority, and oversees the Colorado Liquor Enforcement Division as his or her agents, clerks, and employees. The information and documentation obtained pursuant to this Waiver may be used in connection with the Applicant/Licensee's liquor license application and ongoing licensure by the state and local licensing authorities. The Colorado Liquor Code, section 44-3-101. et seq. ("Liquor Code"), and the Colorado Liquor Rules, 1 CCR 203-2 ("Liquor Rules"), require compliance with certain tax obligations, and set forth the investigative, disciplinary and licensure actions the state and local licensing authorities may take for violations of the Liquor Code and Liquor Rules, including failure to meet tax reporting and payment obligations.

The Waiver is made pursuant to section 39-21-113(4), C.R.S., and any other law, regulation, resolution or ordinance concerning the confidentiality of tax information, or any document, report or return filed in connection with state or local taxes. This Waiver shall be valid until the expiration or revocation of a license, or until both the state and local licensing authorities take final action to approve or deny any application(s) for the renewal of the license, whichever is later. Applicant/Licensee agrees to execute a new waiver for each subsequent licensing period in connection with the renewal of any license, if requested.

By signing below, Applicant/Licensee requests that the Colorado Department of Revenue and any other state or local taxing authority or agency in the possession of tax documents or information, release information and documentation to the Colorado Liquor Enforcement Division, and its duly authorized employees, to act as the Applicant's/Licensee's duly authorized representative under section 39-21-113(4), C.R.S., solely to allow the state and local licensing authorities, and their duly authorized employees, to investigate compliance with the Liquor Code and Liquor Rules. Applicant/Licensee authorizes the state and local licensing authorities, their duly authorized employees, and their legal representatives, to use the information and documentation obtained using this Waiver in any administrative or judicial action regarding the application or license.

Name (Individual/Business) <u>Donald C Woods, Jr</u>		Social Security Number/Tax Identification Number [REDACTED]	
Address [REDACTED]			
City [REDACTED]		State [REDACTED]	Zip [REDACTED]
Home Phone Number [REDACTED]		Business/Work Phone Number	
Printed name of person signing on behalf of the Applicant/Licensee <u>Don Woods Jr</u>			
Applicant/Licensee's Signature (Signature authorizing the disclosure of confidential tax information) <u>Donald C Woods Jr</u>			Date signed <u>2-28-2024</u>

Privacy Act Statement

Providing your Social Security Number is voluntary and no right, benefit or privilege provided by law will be denied as a result of refusal to disclose it. § 7 of Privacy Act, 5 USCS § 552a (note).

IMPORTANT INFORMATION

Now that you have your license, here's what you need to know:

- Use the letter ID above and go to Colorado.gov/RevenueOnline to set up your online access, manage your account, file electronic returns and submit payments. Paper returns will NOT be mailed to you.
- Both your sales tax return AND payments are due by the 20th day of the month following the end date of the reporting period in order to avoid any penalty and/or interest. Be sure you know what your filing frequency is in order to avoid missing due dates.
 - *Monthly filer* due dates: On the 20th day of the month following the reporting period end date.
 - *Quarterly filer* due dates: April 20th, July 20th, October 20th and January 20th.
 - *Annual filer* due dates: January 20th following the reporting period end date.
- If no sales were made during the reporting period, you are still required to file a return to report zero sales were made during the reporting period. Otherwise, the Department of Revenue will assess a non-filer estimate for tax.
- All licensed retailers are required to collect and remit all state-collected sales taxes based on the location where their products are delivered.
- State law requires you to collect sales tax from your customers solely for the purpose of remitting those taxes to the Colorado Department of Revenue. Businesses are entrusted with collecting and remitting taxes that belong to the State of Colorado and local jurisdictions.
- Your Colorado Sales Tax License must be displayed in a conspicuous place at your physical location.
- Your license must be renewed and the renewal fee paid at the end of the license period ending December 31 of odd-numbered years in order to maintain a valid license. Failure to renew your license will invalidate your license, but it won't automatically close your account. In order to close your account and cease any future liability, you must file form DR 1102 with the Department of Revenue.
- Having a Colorado Sales Tax License gives you the privilege to purchase non-taxable items-for-resale. Items that you consume in the course of your business are not included in this privilege.

We strongly recommend that you set up your Revenue Online account as soon as possible in order to remain compliant. If you have any questions regarding sales tax in Colorado, then please visit our website Colorado.gov/tax and click on "Education and Legal Research" for helpful FYIs, Regulations, Letter Rulings and Statutes. While there, you can also sign up for free Public Sales Tax Classes.

Thank you for registering with the Colorado Department of Revenue.

Revenue
ONLINE

