



Weld RE-5J Johnstown-Milliken  
110 S. Centennial Drive  
Milliken, CO 80543

---

July 5, 2023

### Background

The playground equipment at Pioneer Ridge Elementary is in disrepair. Our facilities staff is doing all they can to keep it usable and relatively safe for students and the neighborhood, but it's lagging far behind where it should. Frankly, the equipment just needs to be replaced. Most of the community considers the school playground to be a town park, so we are hoping to work with the town to find a solution for the equipment.

### Cost

Our facilities team has reached out to a couple of different equipment suppliers, and they expect the total cost to be somewhere around \$800,000. Several bids from equipment suppliers are attached.

### Funding options

The district is working on a couple of grant options to fund the replacement of the playground equipment. One of them (GoCo) requires that the funds go to a municipality, not to a school district.

- If we apply for this grant, can the town and the district work together to administer the grant?

The other (Weld Trust) requires the district to have found partnerships with other entities to fund the request. Our PRE PTO has already raised about \$8,000 and is planning some other fundraisers, but you can imagine that would take more time than we realistically have.



- If we apply for this grant, are their funds available from the town to show commitment from community groups.

### Additional info

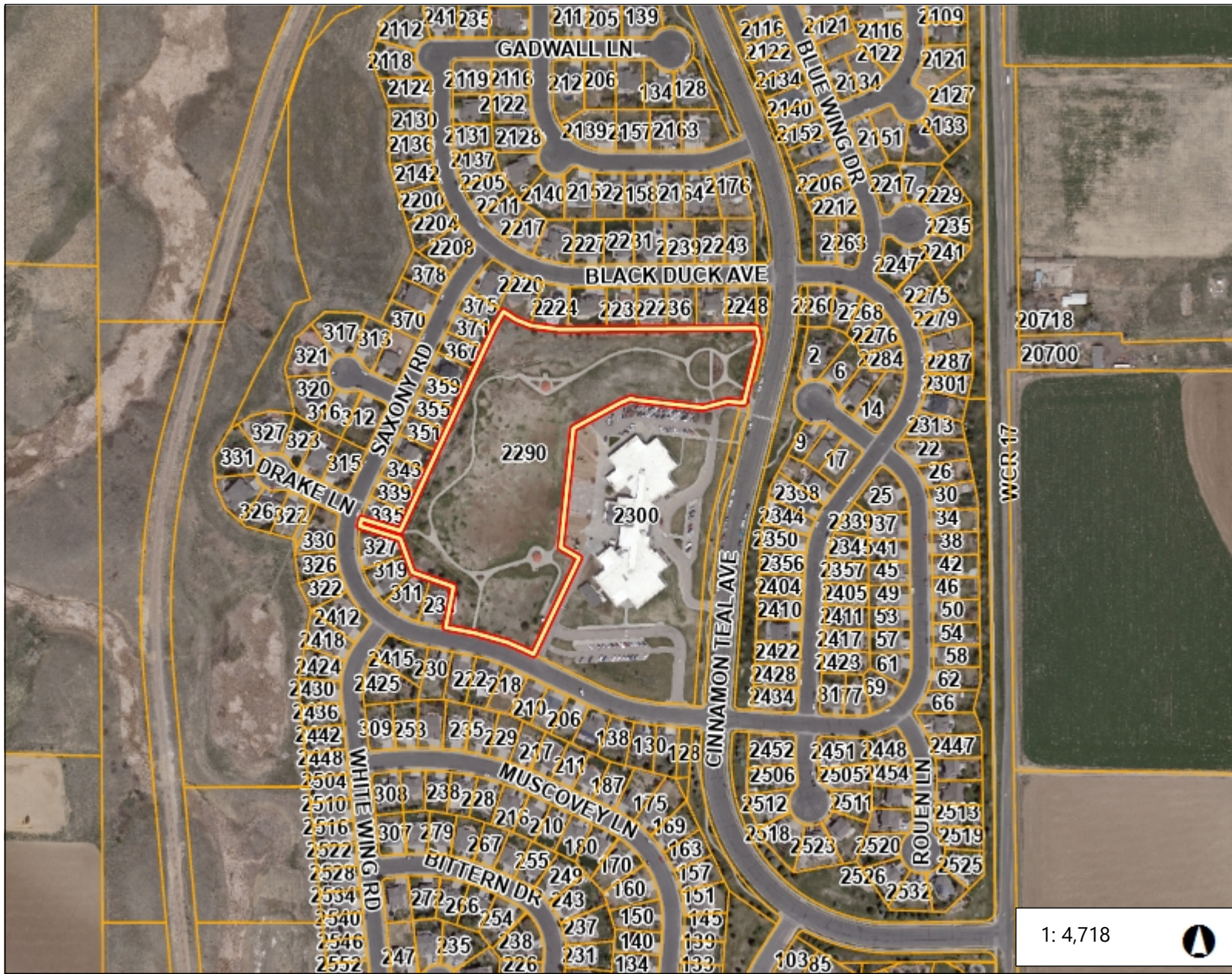
Currently there are no deadlines, as the district has not yet applied for grant funding. Both grants that we are considering have fall timelines, so applications would be placed in the next few months.



Legend

-  Parcels
-  Highway
-  County Boundary

1: 4,718





786.3 0 393.13 786.3 Feet

Notes

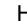

Legend

-  Parcels
-  Highway
-  County Boundary

1: 4,718



Notes

786.3 0 393.13 786.3 Feet



## FLAGSHIP GRANTS

### What does a Flagship Grant look like?

- Typically larger (\$750,000 and greater) although they can be smaller
- Used toward a significant community impact project
- Strongly aligns with The Weld Trust mission to promote excellence in health and education in Weld County
- Aligns within one of The Weld Trust's seven Key Funding Initiatives
- Addresses a fundamental cause with substantive solutions showing clear and measurable outcomes that will be demonstrated over a long period of time
- Demonstrates community- or county-wide partnerships focused on scaling innovative or proven solutions to clearly identified problems
- Demonstrates a business or revenue model for sustaining the initiative
- The organization must show an ability and willingness to pursue other funding sources to leverage additional resources.
- The flagship grant may be for capital needs.
  - In rare cases, a Flagship Grant may be used to support operational needs.
- The grant may be a one-year or multi-year grant.
- Strong consideration will be given to rural communities challenged with accessing resources that are more commonly available in larger communities.

### Guidelines

Eligible applicants must be tax-exempt organizations under Internal Revenue Service 501(c)(3) or operate under the fiscal sponsorship of a tax-exempt nonprofit, including schools and public organizations.

PLEASE NOTE: Only nonprofit organizations, schools and government agencies located in Weld County or whose program is exclusively for Weld County residents in the areas of health or education are eligible to apply.

### How to Apply

Please complete the Flagship Grant Idea on our website at: [www.WeldTrust.org/grants](http://www.WeldTrust.org/grants).

**Please do not submit a full application unless invited to do so.** If the Flagship Grant Idea is accepted, an application form will be made available.



**Contact Information**

For more information concerning The Weld Trust Flagship Grants, please contact:

**Jeff Carlson**

Chief Executive Officer

[Jeff.Carlson@weldtrust.org](mailto:Jeff.Carlson@weldtrust.org)

970-400-7827

**Mike Bond**

Chief Operating Officer

[Mike.Bond@weldtrust.org](mailto:Mike.Bond@weldtrust.org)

970-673-1158

**Kyle Holman**

Director of Health Grants

[Kyle.Holman@weldtrust.org](mailto:Kyle.Holman@weldtrust.org)

970-373-3426

**Doug Elliott**

Director of Education Grants

[Doug.Elliott@weldtrust.org](mailto:Doug.Elliott@weldtrust.org)

303-520-7278



**Superior**<sup>®</sup>

RECREATIONAL PRODUCTS

A PLAYCORE Company

# Grant & Stimulus *Resource Guide*



• IN THIS •

# Grant Guide

Superior Playgrounds is committed to providing challenging and exciting environments in which children can play. That's why we encourage and provide resources for funding your playground through national and state specific grants. You can also contact your SRP Certified Partner for questions or additional budgeting and planning information at [srpplayground.com/contact-a-rep](http://srpplayground.com/contact-a-rep).

## CONTENTS

National Grants .....	3
State-by-State Grants .....	11



## NATIONAL GRANTS

### **21ST CENTURY COMMUNITY LEARNING CENTERS** **U.S. Department of Education**

**Award Amount:** Varies  
**Deadline:** Rolling

[Learn More Information Here](#)

This program supports the creation of community learning centers that provide academic enrichment opportunities during non-school hours for children, particularly students who attend high-poverty and low-performing schools. The program helps students meet state and local student standards in core academic subjects, such as reading and math; offers students a broad array of enrichment activities that can complement their regular academic programs, including recreation and physical activity; and offers literacy and other educational services to the families of participating children. Awards are made to State Educational Agencies (SEAs). Local education agencies (LEAs) and nonprofit organization may apply to states for sub-grants.

### **BNSF FOUNDATION EDUCATIONAL GRANTS** **Burlington Northern Santa Fe Foundation**

**Award Amount:** Check website  
**Deadline:** Check website

[Learn More Information Here](#)

The BNSF Foundation offers grants to support youth organizations, educational institutions, health and human services, civic services, and cultural organizations. Your organization, or program, should exist in or serve a community near one of BNSF's rail lines to be eligible to apply for grants. Please refer to the BNSF system map on the Foundation website to determine whether you are located on a BNSF route.

### **CAPLAN FOUNDATION FOR EARLY CHILDHOOD** **Early Childhood Foundation**

**Award Amount:** Varies  
**Deadline:** January 31, 2023

[Learn More Information Here](#)

The Early childhood foundation offers grants to improve the quality of both early childhood teaching and learning, through the child's development, from an infant, to every learning age. The foundation employs a two-step grant application process that requires a Letter of Inquiry and a Full Proposal.

### **CHILD WELFARE FOUNDATION GRANTS** **Child Welfare Foundation**

**Award Amount:** Varies  
**Deadline:** January 1 - December 31 of the award year

[Learn More Information Here](#)

Grants are available to contribute to the physical, mental, emotional, and spiritual welfare of children through the dissemination of knowledge about new and innovative organizations and/or their programs designed to benefit youth. Grants must have the potential of helping American children in a large geographic area (more than one state). Grants are awarded only to nonprofit, tax-exempt organizations. All grants must be completed between the period of January 1 to December 31 of the award year.





## **COMMUNITY GRANTS**

### **Conagra Brands**

**Award Amount: Varies**

**Deadline: February 15, 2023**

[Learn More Information Here](#)

Conagra Brands help support select non-profits that align with focus areas that include healthy and active lifestyles. The Conagra Brands Foundation requires a letter of Intent application that is due between January 1 and February 15. Upon approval, the foundation staff will extend a full application to request comprehensive project information and documentation via email.

## **COMMUNITY GRANTS**

### **Henry E. Niles Foundation**

**Award Amount: \$2,500 - \$100,000**

**Deadline: Rolling**

[Learn More Information Here](#)

The mission of the Henry E. Niles Foundation is to help in the nurturing and uplifting of people in need by strengthening education, fighting economic hardships through self-help opportunities, and enhancing public health. The Foundation is offering grants to organizations that promote partnerships and collaborative efforts among multiple groups and organizations. The majority of grant-making is focused in the northeast, but occasionally grants may be awarded in other regions of the country. Applicants must be a 501(c)(3) nonprofit organization.

## **COMMUNITY GRANTS**

### **Wells Fargo**

**Award Amount: Varies**

**Deadline: Check website**

[Learn More Information Here](#)

Wells Fargo offers grants in the areas of community development, education, and human services. Non-profit organizations and educational programs in the Wells Fargo service area are eligible to apply. To learn how to apply for a grant or sponsorship, visit the Wells Fargo website and click on your state for specific guidelines.

## **COMMUNITY SUPPORT PROGRAM**

### **The Coca-Cola Foundation**

**Award Amount: Varies**

**Deadline: Rolling**

[Learn More Information Here](#)

The Coca-Cola Foundation aims to make a greater impact on the communities Coca-Cola serves around the world by being responsive to the citizenship priorities of the communities in which we live and work. The Coca-Cola Foundation is interested in funding organizations in these areas: Water stewardship, healthy active living, community recycling, and education. Healthy active living includes providing access to exercise, physical activity and nutritional education programs.



## **DoDEA GRANT PROGRAM**

### **U.S. Department of Defense Education Activity**

**Award Amount: Varies**  
**Deadline: Check website**

[Learn More Information Here](#)

The DoDEA Partnership Grant Program supports research-based programs to increase student achievement and ease the challenges that military children face due to their parents' military service. The grant program provides resources to military-connected local educational agencies (LEAs) to develop and implement projects that are designed to:

- Enhance and expand instructional supports to help students meet the requirements of rigorous curriculum
- Provide structures to support the social and emotional needs of military students
- Increase advanced placement and virtual learning opportunities
- Improve educator knowledge and skills through professional development
- Increase opportunities for students to study strategic languages
- Provide enhanced services for students with disabilities
- Enhance and integrate technology in the classroom
- Engage parents in supporting students' college and career readiness

## **DONORS CHOOSE**

### **DonorsChoose.org**

**Award Amount: Varies**  
**Deadline: Rolling**

[Learn More Information Here](#)

Don't see a grant that fits your needs? Try posting a project on DonorsChoose.org. Public school teachers nationwide are eligible to participate.

## **DR. SCHOLL FOUNDATION ANNUAL GRANT**

### **Dr. Scholl Foundation**

**Award Amount: Varies**  
**Deadline: Between October 1 and March 1 of the following year**

[Learn More Information Here](#)

The Dr. Scholl Foundation is dedicated to providing financial assistance to organizations committed to improving our world. Applications for grants are considered in the following areas: Education, Social Service, Healthcare, Civic and cultural, Environmental. Grants are considered on an annual basis. The Dr. Scholl Foundation application form can be submitted between October 1 and March 1 of the following year.

## **EDUCATION GRANTS**

### **The Charles Stewart Mott Foundation**

**Award Amount: Varies**  
**Deadline: Rolling**

[Learn More Information Here](#)

The Charles Stewart Mott Foundation supports initiatives around the U.S. that promote learning beyond the classroom especially for traditionally under-served children and youth -- as a strategy for improving public education. Grant making under this objective seeks to provide optimum opportunities for academic support and enrichment for young people to learn and develop both in school, summer, and after school. Central to this effort



are partnerships between school and community-based organizations and other local institutions. Search the grant listings for funding opportunities that best fit the needs of your organization and submit a Letter of Inquiry Form for more information.

### **EDWARD E. FORD FOUNDATION GRANT** **Edward E. Ford Foundation**

**Award Amount:** Up to \$250,000  
**Deadline:** April 1

[Learn More Information Here](#)

The foundation awards grants annually to the National Assn. of Independent Schools-member independent secondary schools and to NAIS member associations to improve high school achievement. Proposals from associations must support programs affecting the work of students and faculty in independent secondary schools. Support is not provided for administrative costs. It is open to a variety of needs and priorities, including buildings (including libraries), curriculum. All school grant awards require a matching component.

### **FOUNDATION GRANT** **Funding Factory**

**Award Amount:** Varies  
**Deadline:** Rolling

[Learn More Information Here](#)

The funding Factory helps organizations raise money through recycling toner and ink jet printer cartridges. Through this, the funding factory is able to turn the cartridges into cash for organizations and projects. Schools will collect empty cartridges and send them to the factory. In addition, the funding factory provides the shipping cartons and the labels at no cost for schools.

### **FOUNDATION GRAN** **Harry Chapin Foundation**

**Award Amount:** Up to \$10,000  
**Deadline:** Rolling

[Learn More Information Here](#)

The Harry Chapin Foundation will fund only 501(c)(3) not for profit programs that operate in the United States that will fall within the areas of: Community Education Programs, Arts-In-Education Programs or Agricultural and Environmental Programs. Grant sizes range from a few hundred dollars to our maximum of \$10,000. The Foundation Board meets three times per year on an as needed basis.

### **FUEL UP TO PLAY 60** **National Dairy Council and the National Football League**

**Award Amount:** Up to \$4,000  
**Deadline:** Check website

[Learn More Information Here](#)

Funding is available to K-12 schools enrolled in Fuel Up to Play 60. The competitive, nationwide funding program can help your school jump-start and sustain healthy nutrition and physical activity improvements. Funds can be used to conduct in-school promotions focused on creating a healthier school and to implement Healthy Eating and Physical Activity Plays. Funds can also be used for professional development, nutrition education materials, and



physical education equipment and materials.

## **HEALTH AND EDUCATION GRANTS**

### **Michael and Susan Dell Foundation**

**Award Amount: Varies**

**Deadline: Vary by location**

[Learn More Information Here](#)

The Michael and Susan Dell Foundation's primary goal is to support and initiate programs that directly serve the needs of children living in urban poverty. Priority is given to initiatives addressing children's health, education, and micro-finance, as well as initiatives in India and Central Texas that specifically address the needs of children. The Foundation is determined to reverse the trend in childhood obesity by supporting national school-based programs that engage teachers, students and their community in healthy eating choices and regular physical activity. To apply for a grant, go to [www.MSDF.org](http://www.MSDF.org) and then to the Grants tab.

## **JAMES M. COX FOUNDATION GRANT**

### **James M. Cox Foundation**

**Award Amount: Varies**

**Deadline: February 15, June 15, October 15**

[Learn More Information Here](#)

The James M. Cox Foundation provides funding for capital campaigns and special projects in communities where Cox Enterprises Inc. does business. The Foundation is concentrating its community support in several priority areas: Conservation and Environment; Early Childhood Education; Empowering Families and Individuals for Success; Health. Organizations must be federally tax-exempt under Section 501(c)(3) of the IRS Code with non-private foundation status, or an equivalent government entity under section 170 (c)(1); and located in the United States and in an area where Cox Enterprises, Inc. does business. The deadlines for receipt of applications are February 15, June 15, and October 15.

## **LEARNING AND LEADERSHIP GRANTS**

### **The NEA Foundation**

**Award Amount: Varies**

**Deadline: Varies**

[Learn More Information Here](#)

In an effort to ensure that each child attends a great public school and that we continue to build strong affiliates, NEA provides partnership funding to state and local affiliates. Check website for funding opportunities.

## **MINI-GRANTS**

### **Ezra Jack Keats Foundation**

**Award Amount: Check website**

**Deadline: Check website**

[Learn More Information Here](#)

The Ezra Jack Keats Foundation created Mini-Grants: awards given to public schools and public libraries for projects that foster creative expression, working together and interaction with a diverse community. EJK Mini-Grants give educators, whose efforts are often inadequately funded or recognized, a opportunity to design and implement a great program.



## **NATIONAL GRANTS**

### **Kaiser Permanente**

**Award Amount:** Varies by state

**Deadline:** Varies by state

[Learn More Information Here](#)

Kaiser Permanente National grants are made to programs that serve multiple Kaiser Permanente regions and/or have a national impact on health and policy. Complete details on the national grant program eligibility as well as the program application are available through Kaiser Permanente's website. Applications are reviewed on a quarterly basis throughout the year.

## **NEA STUDENT ACHIEVEMENT GRANT**

### **National Education Foundation**

**Award Amount:** \$2,000 - \$5,000

**Deadline:** Varies

[Learn More Information Here](#)

Learning and Leadership grants support public school teachers, public education support professionals, and/or faculty and staff in public institutions of higher education to fund participation in high-quality professional development experiences, such as summer institutes or action research. All professional development must improve practice, curriculum, and student achievement.

## **NEWMAN'S OWN AWARDS**

### **Newman's Own, Fisher House Foundation, and Military Times**

**Award Amount:** Up to \$200,000

**Deadline:** Check website

[Learn More Information Here](#)

Newman's Own, Fisher House Foundation, and Military Times (Gannett Government Media Corporation) join together in presenting \$200,000 in grants to the most creative military quality of life improvement plans. Every day, service members, Veterans, and their families rise to the challenge of maintaining a healthy lifestyle while facing the unique trials that come with having dedicated their lives in service to our nation.

## **RICHARD DAVOUD DONCHIAN FOUNDATION GRANTS**

### **Richard Davoud Donchian Foundation**

**Award Amount:** Up to \$25,000

**Deadline:** Rolling

[Learn More Information Here](#)

With an interest in rethinking and reconfiguring curriculum, pedagogy, and the other academic resources in schools and communities, the Foundation focuses on programs that work toward long-term improvement in all aspects of education, but with an emphasis on literacy. The majority of the Richard Donchian Foundation's grantmaking is focused in the northeastern United States, although grants may be made in other regions of the country.

## **REIMAN FOUNDATION GRANT**

### **Reiman Foundation**

**Award Amount:** Varies



**Deadline: Rolling**

**[Learn More Information Here](#)**

The Reiman Foundation focuses its giving in four main areas: Health Care, Education, The Arts and Children. Nonprofit organizations are eligible to apply. We review and make decisions on applications received on an ongoing basis throughout the year.

## **SCHOOL GRANTS FOR HEALTHY KIDS**

### **Action for Healthy Kids**

**Award Amount: Varies**

**Deadline: Check website**

**[Learn More Information Here](#)**

Schools need resources to implement health and wellness practices that help students eat better and be physically active. Thanks to our partners, Action for Healthy Kids has provided \$6.6 million in grants to schools since 2009. Our School Grants for Healthy Kids can help your school health team achieve its goal to make every kid healthy and ready to learn. Check the Action for Healthy Kids website for grants.

## **TEAM NUTRITION**

### **USDA Food and Nutrition Service**

**Award Amount: Varies**

**Deadline: Varies**

**[Learn More Information Here](#)**

The Healthier US School Challenge (HUSSC) is a voluntary certification initiative established in 2004 to recognize those schools participating in the National School Lunch Program that have created healthier school environments through promotion of nutrition and physical activity. Monetary incentive awards are available for each HUSSC award level: Bronze, Silver, Gold, and Gold Award of Distinction. Schools can submit an application at any time during the year.

## **VOICES FOR HEALTHY KIDS REQUEST FOR AWARD**

### **Robert Wood Johnson Foundation, American Heart Association**

**Award Amount: Varies**

**Deadline: Rolling**

**[Learn More Information Here](#)**

Voices for Healthy Kids is a new collaboration between the American Heart Association and the Robert Wood Johnson Foundation working to engage, organize and mobilize people to improve the health of their communities and reverse the childhood obesity epidemic. Voices for Healthy Kids Strategic Campaign Fund is awarding grants with a mix of lobbying and non-lobbying resources to support strategic issue advocacy campaigns focused on fighting childhood obesity through state, local, and tribal public policy campaigns aligned with the Voices for Healthy Kids policy priorities. There are various types of grant opportunities. See website for detailed information on qualifications, amounts, and deadlines.

## **VOYA UNSUNG HEROES AWARDS PROGRAM**

### **Voya Financial**

**Award Amount: Up to \$25,000**

**Deadline: Check website**



### [Learn More Information Here](#)

The Voya Unsung Heroes program annually provides grants to K-12 educators utilizing new teaching methods and techniques that improve learning. Each year, educators submit applications for a Voya Unsung Heroes grant by describing projects they have initiated or would like to pursue. Each year, 100 educators are selected to receive \$2,000 to help fund their innovative class projects. Three of those are chosen to receive an additional \$5,000 for third place, \$10,000 for second place, and \$25,000 for first place.

### **W.K. KELLOGG FOUNDATION GRANTS**

#### **W.K. Kellogg Foundation**

**Award Amount: Varies**

**Deadline: Varies**

### [Learn More Information Here](#)

The Kellogg Foundation makes grants to organizations that embrace a similar mission of creating communities, systems, and nations in which all children have an equitable and promising future; one in which all children thrive. Our grants will fund programs and projects that support children, families, and communities as they strengthen and create conditions that propel children to achieve success as individuals and as contributors to the larger community and society. Promising ventures throughout the country are eligible to apply.

### **WORLD OF DIFFERENCE GRANT**

#### **Cigna Foundation**

**Award Amount: Varies**

**Deadline: Varies**

### [Learn More Information Here](#)

Voices for Healthy Kids is a new collaboration between the American Heart Association and the Robert Wood Johnson Foundation working to engage, organize and mobilize people to improve the health of their communities and reverse the childhood obesity epidemic. Voices for Healthy Kids Strategic Campaign Fund is awarding grants with a mix of lobbying and non-lobbying resources to support strategic issue advocacy campaigns focused on fighting childhood obesity through state, local, and tribal public policy campaigns aligned with the Voices for Healthy Kids policy priorities. Six awards for up to a maximum of \$90,000 per award is available for 501(c)(3) organizations to support strategic issue advocacy campaigns focused on fighting childhood obesity aligned with six advocacy priorities.

# State Grants

Alabama .....	12
Alaska .....	13
Arizona .....	14
Arkansas .....	15
California .....	16
Colorado .....	22
Connecticut .....	24
Delaware .....	26
District of Columbia .....	26
Florida .....	27
Georgia .....	29
Hawaii .....	32
Idaho .....	34
Illinois .....	35
Indiana .....	38
Iowa .....	41
Kansas .....	43
Kentucky .....	44
Louisiana .....	45
Maine .....	46
Maryland .....	48
Massachusetts .....	49
Michigan .....	53
Minnesota .....	56
Mississippi .....	58
Missouri .....	59
Montana .....	60
Nebraska .....	60
Nevada .....	61
New Hampshire .....	61
New Jersey .....	62
New Mexico .....	64
New York .....	65
North Carolina .....	69
North Dakota .....	71
Ohio .....	72
Oklahoma .....	74
Oregon .....	74
Pennsylvania .....	77
Rhode Island .....	82
South Carolina .....	83
South Dakota .....	85
Tennessee .....	85
Texas .....	86
Utah .....	91
Vermont .....	92
Virginia .....	93
Washington .....	95
West Virginia .....	99
Wisconsin .....	99
Wyoming .....	101







Angeles area youth, our fundraising directly supports these initiatives by providing financial assistance to children and local youth programs. The Los Angeles Lakers Youth Foundation is a 501(c)(3). Reviews are done quarterly with the following deadlines: March 15, June 15, September 15 and December 15.

## **COLORADO**

### **ADOLPH COORS FOUNDATION YOUTH AND EDUCATION GRANTS** **Adolph Coors Foundation**

**Award Amount: Varies**  
**Deadline: Check website**

[Learn More Information Here](#)

Rose Community Foundation provides grants to nonprofit organizations that are working to improve the quality of life in the seven-county Denver community primarily in the areas of Aging, Child and Family Development, Education, Health and Jewish Life. Applicants should be either a charitable nonprofit organization with tax-exempt classification from the Internal Revenue Service or a tax-supported institution such as a school or government agency.

### **GRANTS PROGRAM** **Daniels Fund**

**Award Amount: Varies**  
**Deadline: Check website**

[Learn More Information Here](#)

The Daniels Fund provides grants to support highly effective nonprofit organizations in Colorado, New Mexico, Utah, and Wyoming through the Daniels Fund Grants Program. Bill Daniels helped a tremendous number of people during his lifetime, and continues to do so in extraordinary ways through the foundation he established. The Daniels Fund honors Bill's direction and carries forward his legacy of generosity. We strive to be compassionate, approachable, and responsive. The Daniels Fund focuses on supporting highly effective and ethical nonprofit organizations that achieve significant results in the community. The geographic regions we serve, as well as our grant funding areas, were personally defined by our founder, and they do not change.

### **FOUNDATION GRANT** **Rose Community Foundation**

**Award Amount: Varies**  
**Deadline: Check website**

[Learn More Information Here](#)

Rose Community Foundation provides grants to nonprofit organizations that are working to improve the quality of life in the seven-county Denver community primarily in the areas of Aging, Child and Family Development, Education, Health and Jewish Life. Applicants should be either a charitable nonprofit organization with tax-exempt classification from the Internal Revenue Service or a tax-supported institution such as a school or government agency.

### **FOUNDATION GRANT** **Temple Hoyne Buell Foundation**

**Award Amount: Varies**  
**Deadline: Check website**



### [Learn More Information Here](#)

The Buell Foundation seeks programs that have demonstrated success in helping children thrive. It is our goal to partner with outstanding organizations to improve the systems that serve children. Particular focus will be placed on programs that target under-served communities. The Foundation will consider proposals that directly support the healthy development of very young children. Grants will be given only to public charities that are tax-exempt under section 501(c)(3) of the Internal Revenue Code and “not a private foundation” under section 509(a) of the Code.

### **HEALTHY SCHOOLS** **Colorado Health Foundation**

**Award Amount: Varies**  
**Deadline: Check website**

### [Learn More Information Here](#)

The focus of the Healthy Schools program is to expand the number of public schools and preschools that have health and nutrition education, physical education, healthy food in cafeterias and vending machines, opportunities for physical activity and health care services.

### **HUMANA FOUNDATION GRANTS** **Humana Foundation**

**Award Amount: Check website**  
**Deadline: Check website**

### [Learn More Information Here](#)

The purpose of this funding is to support an organization that is focused on initiatives in Childhood health - supporting efforts that improve physical activity and nutritional habits of children and families; Intergenerational health - fostering shared, healthy activities between generations or Active lifestyles - promoting fun, physically active living as a way of life. We accept proposals from nonprofit 501(c)(3) organizations in areas where Humana has business presence. Check website for info.

### **COMMUNITY GRANTS** **Denver Foundation**

**Award Amount: Varies**  
**Deadline: Check website**

### [Learn More Information Here](#)

The sponsor provides grants to nonprofit organizations serving residents in Adams, Arapahoe, Boulder, Broomfield, Denver, Douglas and/or Jefferson counties for projects in the areas of arts and culture, civic and education, health, and human services. The Foundation has recently updated grant guidelines and is now using the Colorado Common Grant Application with minor modifications.

### **PROJECTS FOR YOUTH** **LibertyGives Foundation**

**Award Amount: Varies**  
**Deadline: Check website**

### [Learn More Information Here](#)



The LibertyGives Foundation supports causes benefiting underprivileged and at-risk youth in Colorado, focused on proactive and preventative services. Grants of up to \$150,000 will be awarded to select applicants. Nonprofit organizations based in Colorado are eligible to apply.

## CONNECTICUT

### AMERICAN SAVINGS FOUNDATION GRANTS

#### American Savings Foundation

Award Amount: Varies

Deadline: Check website

[Learn More Information Here](#)

This Foundation provides support in the field of human services, education, arts and culture to non-profit, tax-exempt organizations in select towns in the service area. Previous grant recipients include Early Childhood intervention programs, after-school enrichment programs, dance classes and various youth and family services.

### COMMUNITY GRANTS FOR EDUCATION, HEALTH AND EMERGENCY RELIEF

#### The Ledyard Rotary Foundation

Award Amount: Varies

Deadline: Check website

[Learn More Information Here](#)

The purpose of this funding is to support programs and initiatives that enhance educational opportunities, improve quality of life, improve access to or quality of health care, address social problems in the community, advance charitable giving, or provide emergency relief.

### EDUCATION AND YOUTH DEVELOPMENT GRANTS

#### Fairfield County Community Foundation

Award Amount: Varies

Deadline: Check website

[Learn More Information Here](#)

The Foundation supports non-profit organizations benefiting the residents of Fairfield County, CT. Grantmaking priorities include Education and Youth Development. The primary goals for these grants include reducing the achievement gap between low-income and upper-income children, improving the quality and affordability of after-school and youth development programs, and increasing the quality of early childhood and school readiness programs. Foundation grants are made to 501(c)(3) organizations with current I.R.S. documentation.

### FOUNDATION GRANT

#### The Prudential Foundation

Award Amount: Varies

Deadline: Rolling

[Learn More Information Here](#)

The Prudential Foundation provides funding in the areas of Education, including Youth Development and out-of-school-time programs for young people, Economic Development, and Arts and Civic Infrastructure. Vulnerable

# Superior<sup>®</sup>

RECREATIONAL PRODUCTS

A PLAYCORE Company

1050 Columbia Drive  
Carrollton, GA 30117

866.699.4339

[srplayground.com](http://srplayground.com)







Go Play, Inc  
Jennifer and David VanWormer  
9916 County Road 48 1/2  
Milliken, CO 80543

PRE  
South Playground

**Proposal**

Customer	
Name	Weld RE-5J School District - Joshua Roseberry
Address	110 Centennial Drive A
City	Milliken State CO ZIP 80543
Phone	(970)587-6096

Misc	
Date	2/15/2023
Order No.	SRP255773
Rep	JVW
FOB	

Qty	Description	Unit Price	TOTAL
<b>PLAYGROUND EQUIPMENT</b>			
1	Superior PS5-72012 custom Active Course structure, 5" OD posts, ages 5-12 	\$ 115,894.00	\$ 115,894.00
1	Superior 4-Bay, 3.5" OD Arch Swing frame, 8' pivot, (8) belts seats on uncoated chains 	\$7,956.00	\$ 7,956.00
1	<i>Go Play discount on Superior Playgrounds equipment as quoted above. May not be combined with other discounts or promotions.</i>	30%	\$ (37,155.00)
1	Superior Ascend 10' Web Whirl Spinner Net 	\$18,295.00	\$ 18,295.00
1	<i>Go Play discount on Superior Ascend equipment as quoted above. May not be combined with any other discounts or promotions.</i>	20%	\$ (3,659.00)
<b>SITE PREPARATION</b>			
1	Removal and disposal of existing 500 sf @ 12" depth breeze material from north side of play area, push back (and replace at completion) 5627 sf existing wood fiber surfacing, remove and dispose of 150 LF of black plastic border timbers, and removal and disposal of existing playground structures and 3-bay swing..	\$10,375.00	\$ 10,375.00
<b>EQUIPMENT INSTALLATION:</b>			
1	Completed installation of new playground equipment listed above by CPSI certified installer.		\$ 46,907.85
<b>SURFACING:</b>			
1	Form and pour 150 LF of grey concrete borders, 12" H x 6" wide, square corners, does not include facing, includes pump truck.		\$ 11,265.00
6077	sf engineered wood fiber replenishment materials, 2" average depth, includes material, delivery and installation.	\$0.65	\$ 3,950.05
140	sf supply and install compacted poured-in-place sub-base material and sub-surface retaining border, 9" compacted depth, includes materials, materials, delivery, installation and compaction.	\$35.00	\$ 4,900.00
324	sf Poured-in-place safety surfacing (under swing seats only) 50% black/ 50% color mix, standard binder, 8' fall hieght attenuation, beveled edges down into surrounding wood fiber, includes material, delivery and install.	\$17.15	\$ 5,556.60
<b>NOTES:</b> Please see attached terms and conditions for project notes.			

*Signed proposal and 50% deposit or PO required to proceed with order.*

SubTotal	\$ 184,285.50
Freight	\$ 11,125.00
Tax Rate(s)	TBD
<b>TOTAL</b>	<b>\$ 195,410.50</b>

Date: \_\_\_\_\_

Authorizing Signature: \_\_\_\_\_

Colorado Retail Sales Tax Exempt # \_\_\_\_\_

Tax Rate(s)

Office Use Only



Contact: Go Play Phone (970) 420-6796  
Go Play Email [jennifer@goplayplaygrounds.com](mailto:jennifer@goplayplaygrounds.com)



Thank you for your consideration! Pricing is valid for 30 days.

# Pioneer Ridge South Playground Site Plan



Proposed by Jennifer Van Wormer  
 (970)420-6796  
 jennifer@goplayplaygrounds.com

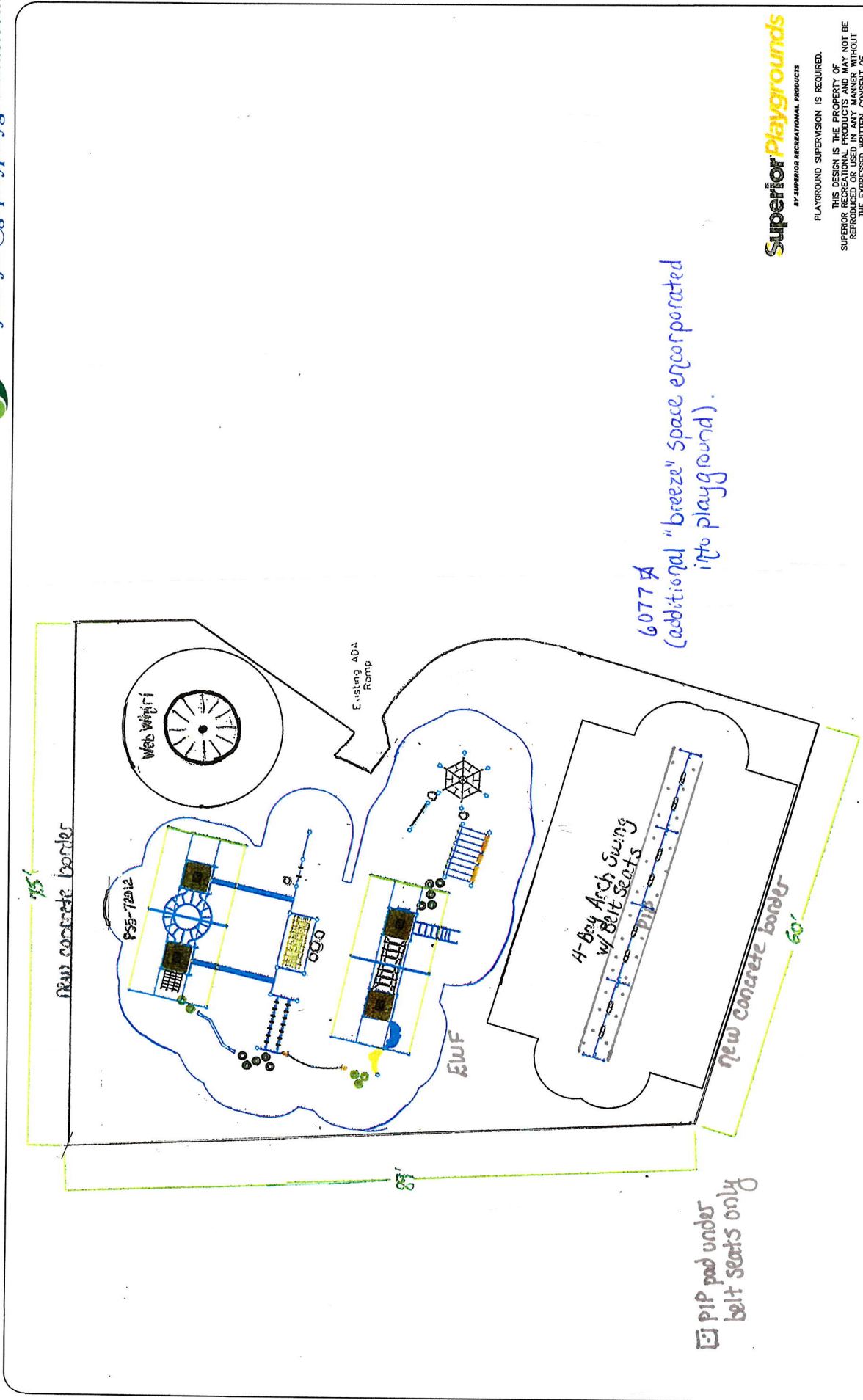

**SuperiorPlaygrounds**  
 BY SUPERIOR RECREATIONAL PRODUCTS

PLAYGROUND SUPERVISION IS REQUIRED.

THIS DESIGN IS THE PROPERTY OF SUPERIOR RECREATIONAL PRODUCTS. IT MAY NOT BE REPRODUCED OR USED IN ANY MANNER WITHOUT THE EXPRESSED WRITTEN CONSENT OF SUPERIOR RECREATIONAL PRODUCTS.



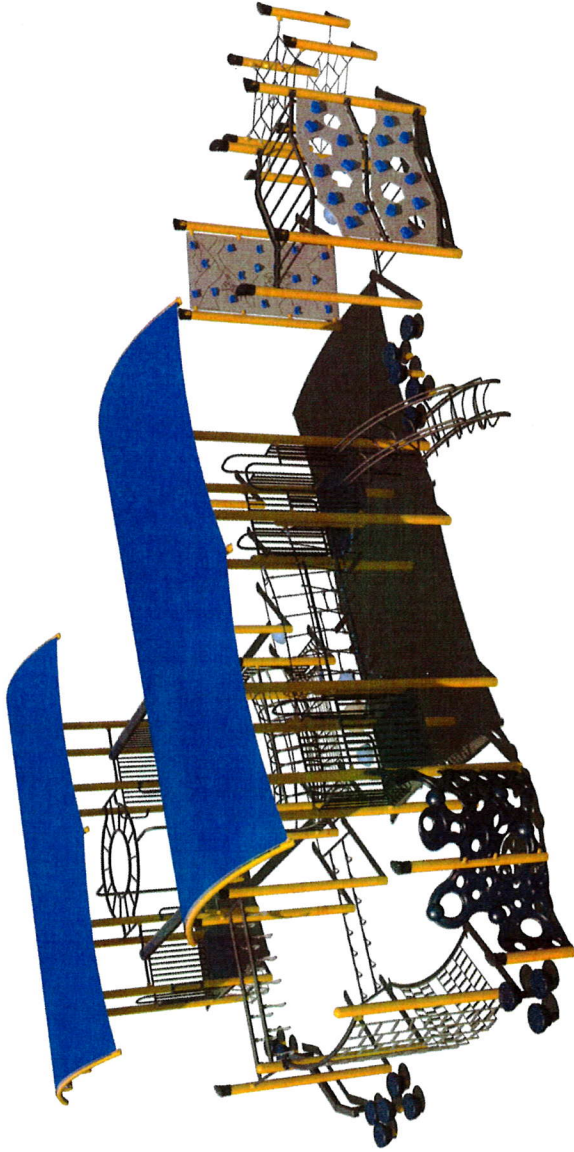
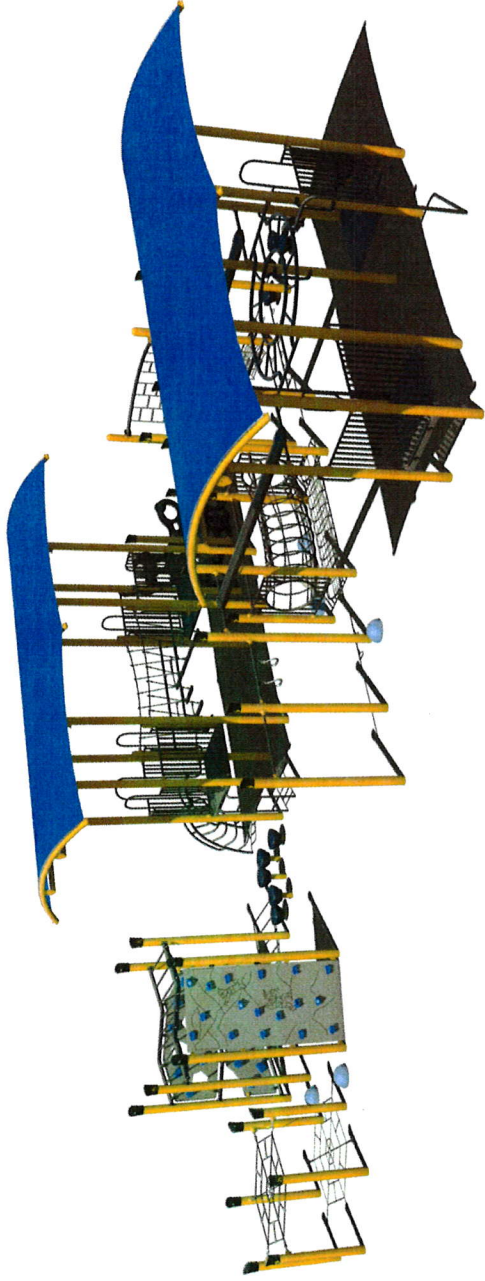

**Go Play**

Proposed by Jennifer Van Wormer  
(970)420-6796

[jennifer@goplayplaygrounds.com](mailto:jennifer@goplayplaygrounds.com)

## Pioneer Ridge Elementary South Playground

STRUCTURE PSS-72012 • QUOTE QU00255773

*Design is for illustration purposes only and colors may vary.*

Color Key

Post: Butterscotch  
Post Cap: Black  
Metal: Starry Night  
Plastic: Dark Blue

Panel: Champagne  
San. Panel: Gray/Black  
Deck: Brown  
Fabric: True Blue

# PS5-72012 Active Course Structure Detail



Proposed by Jennifer VanWormer  
 (970)420-6796  
 jennifer@goplayplaygrounds.com

**Superior Playgrounds**  
 BY SUPERIOR RECREATIONAL PRODUCTS

REFERENCE NUMBER  
 PSS-72012  
 5" STEEL STRUCTURE DESIGN  
 EQUIPMENT SIZE  
 52' X 45'  
 AGE GROUP  
 5-12  
 USE ZONE  
 64' X 57'  
 SURFACE AREA  
 2,324 S.F.

USER CAPACITY  
 NA  
 4' TIMBER COUNT  
 60

FALL HEIGHT  
 7 FT.

ADA ACCESSIBILITY

ELEVATED  
 PLAY ACTIVITIES  
 NA

REQUIRED	PROVIDED	GROUND LEVEL ACCESSIBLE PLAY ACTIVITIES	GROUND LEVEL ACCESSIBLE ACTIVITY TYPES
	NA	NA	NA
	NA	NA	NA

THIS STRUCTURE MEETS OR EXCEEDS CPSC #325 AND ASTM F1487 UNLESS OTHERWISE NOTED.

DATE  
 2/01/2023  
 SCALE  
 1/8" = 1'-0"  
 DRAWN/SAVED BY  
 BL / BONNIE LEAGUE  
 SHEET  
 1 OF 3  
 PAGE  
 PLAN\_VIEW

WE RECOMMEND THIS PLAN BE PRINTED ON 11" x 17" PAPER

PLAYGROUND SUPERVISION IS REQUIRED.  
 THIS DESIGN IS THE PROPERTY OF SUPERIOR RECREATIONAL PRODUCTS AND MAY NOT BE REPRODUCED OR COPIED IN ANY MANNER WITHOUT THE EXPRESSED WRITTEN CONSENT OF SUPERIOR RECREATIONAL PRODUCTS.

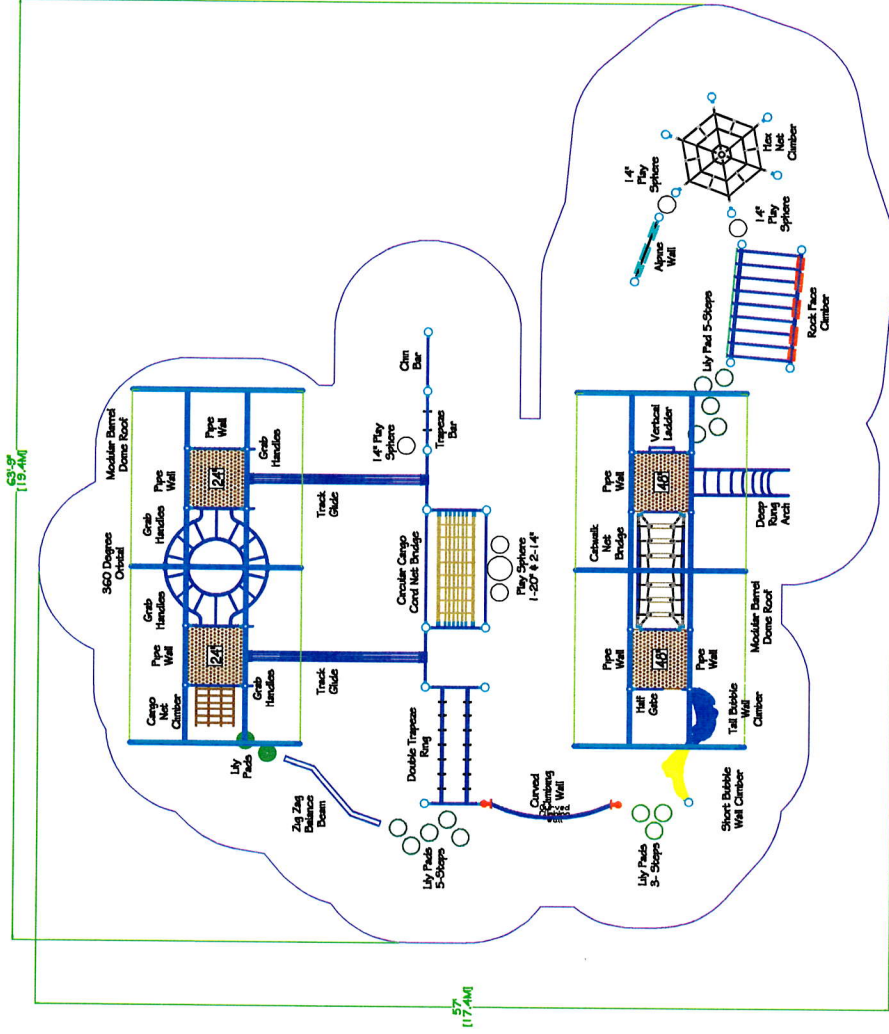





## Pioneer Ridge Elementary South Playground

STRUCTURE SP022023-001 • QUOTE QUO0255773

*Design is for illustration purposes only and colors may vary.*

**Color Key**

Post: Butterscotch  
Post Cap: Black  
Metal: Starry Night  
Plastic: Dark Blue

Panel: Champagne  
San. Panel: Gray/Black  
Deck: Brown  
Fabric: True Blue



## Pioneer Ridge Elementary South Playground

STRUCTURE SP022023-001 • QUOTE QU00255773

*Design is for illustration purposes only and colors may vary.*

**Color Key**

Post: Butterscotch  
Post Cap: Black  
Metal: Starry Night  
Plastic: Dark Blue

Panel: Champagne  
San. Panel: Gray/Black  
Deck: Brown  
Fabric: True Blue







Go Play, Inc  
Jennifer and David VanWormer  
9916 County Road 48 1/2  
Milliken, CO 80543

PRE  
Kindergarten/  
Inclusive Area

**Proposal**

Customer				
Name	Weld RE-5J School District - Joshua Roseberry			
Address	110 Centennial Drive A			
City	Milliken	State	CO	ZIP 80543
Phone	(970)587-6096			

Misc	
Date	2/13/2023
Order No.	SRP255747
Rep	JVW
FOB	

Qty	Description	Unit Price	TOTAL
<b>PLAYGROUND EQUIPMENT</b>			
1	Superior PS5-72005 custom inclusive ramped 5" OD post structure for ages 5-12 	\$137,760.00	\$ 137,760.00
1	Superior 2-Bay, 3.5" OD Arch Swing with (2) belt seats and (2) ADA seats on uncoated chains. 	\$6,115.00	\$ 6,115.00
1	Superior Spin-About 		
1	Superior Harmony Park set of (4) Flower Chimes: (1) Orange, (1) Yellow, (1) Indigo and (1) Turquoise 	\$5,998.00	\$ 5,998.00
1	Superior Amenities 6' standard Buddy Bench with back, 'All Smiles' perforated design, in-ground mount 	\$1,100.00	\$ 1,100.00
1	<b>Go Play discount on Superior Playgrounds equipment above. May not be combined with any other discounts or promotions.</b>	30%	\$ (45,291.90)
<b>SITE PREPARATION</b>			
1	Removal and disposal of existing 440 sf @ 6" depth breeze material from south side of play area (breeze to remain around tree base), 3760 sf @ 12" depth of wood fiber surfacing, 190 LF of black plastic border timbers, concrete ADA ramp, and existing playground structure and swing..	\$13,500.00	\$ 13,500.00
<b>EQUIPMENT INSTALLATION:</b>			
1	Completed installation of new playground equipment listed above by CPSI certified installer.		\$ 49,821.09
<b>SURFACING:</b>			
1	Form and pour 190 LF of grey concrete borders, 12" H x 6" wide, square corners, does not include facing, includes pump truck.		\$ 12,250.00
4200	sf supply and install compacted poured-in-place sub-base material, 3760 sf @ 10" compacted depth (installed in lifts) and 440 sf @ 4" compacted depth, includes materials, delivery, installation and compaction.	\$5.00	\$ 21,000.00
4200	sf Poured-in-place safety surfacing, 50% black / 50% color speckle mix, standard binder, variable 4' - 8' fall height attenuation, includes material, delivery and installation.	\$15.80	\$ 66,360.00
<b>NOTES:</b> Please see attached terms and conditions for project notes.			

Signed proposal and 50% deposit or PO required to proceed with order.

SubTotal	\$ 268,612.19
Freight	\$ 9,995.00
Tax Rate(s)	TBD
<b>TOTAL</b>	<b>\$ 278,607.19</b>

Date: \_\_\_\_\_

Authorizing Signature: \_\_\_\_\_

Colorado Retail Sales Tax Exempt # \_\_\_\_\_

Office Use Only

	<b>Contact: Go Play Phone (970) 420-6796</b> <b>Go Play Email <a href="mailto:jennifer@goplayplaygrounds.com">jennifer@goplayplaygrounds.com</a></b>		
	<small>A PLAYCORE Company</small>		

Thank you for your consideration! Pricing is valid for 30 days.

# PRE Kindergarten/Inclusive Playground Site Plan



Proposed by Jennifer Van Wormer  
 (970)420-6796  
 jennifer@goplayplaygrounds.com

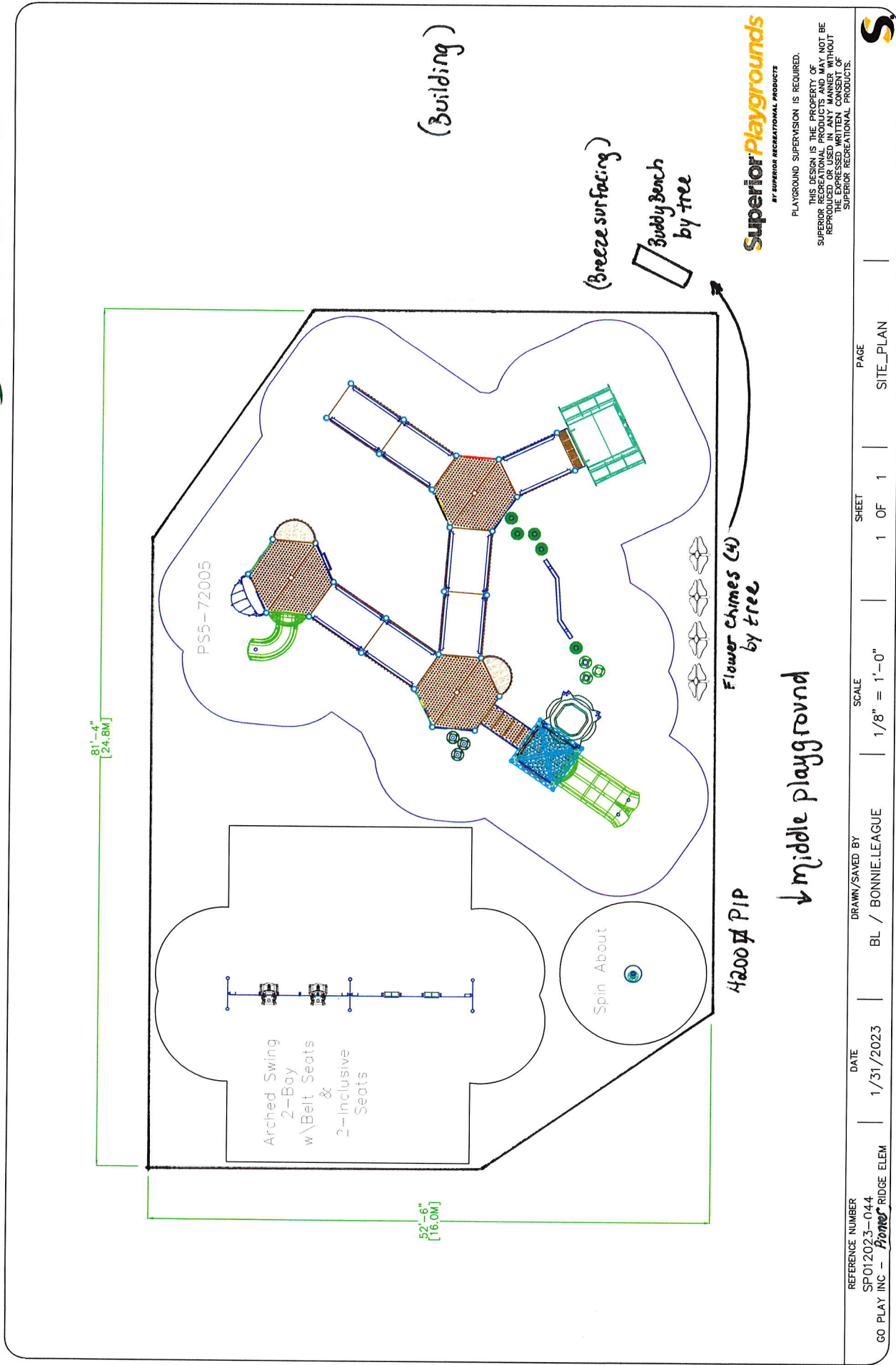

**Superior Playgrounds**  
 BY SUPERIOR RECREATIONAL PRODUCTS

PLAYGROUND SUPERVISION IS REQUIRED.  
 THIS DESIGN IS THE PROPERTY OF  
 SUPERIOR RECREATIONAL PRODUCTS AND MAY NOT BE  
 REPRODUCED OR USED IN ANY MANNER WITHOUT  
 THE EXPRESSED WRITTEN CONSENT OF  
 SUPERIOR RECREATIONAL PRODUCTS.



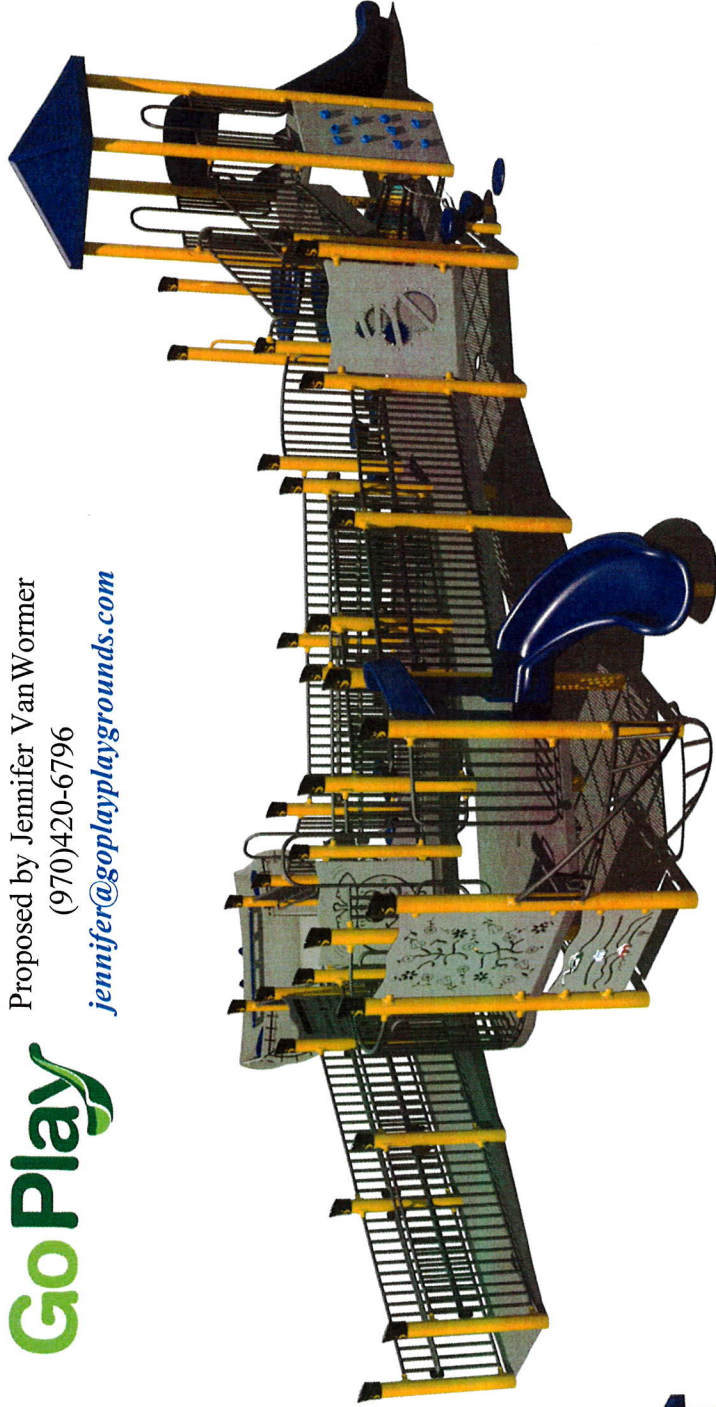

**PRE Kindergarten / Inclusive Playground**  
Kindergarten Inclusive structure



Color Key

Post: Butterscotch	Panel: Champagne
Post Cap: Black	San. Panel: Grey/Black
Metal: Midnight	Deck: Grey
Plastic: Blue	Fabric: N/A

# PS5-72005 Inclusive Ramped Structure Detail



Proposed by Jennifer VanWormer  
 (970)420-6796  
 jennifer@goplayplaygrounds.com

**Superior Playgrounds**  
 BY SUPERIOR RECREATIONAL PRODUCTS

REFERENCE NUMBER  
 PSS-72005  
 5" STEEL STRUCTURE DESIGN  
 EQUIPMENT SIZE  
 46'X41'  
 AGE GROUP  
 5-12  
 SURFACE AREA  
 1914 S.F.

USER CAPACITY  
 68  
 4' TIMBER COUNT  
 51

FALL HEIGHT  
 5 FT.

ADA ACCESSIBILITY

ELEVATED  
 PLAY ACTIVITIES  
 13

GROUND LEVEL ACCESSIBLE PLAY ACTIVITIES	REQUIRED	PROVIDED
4	4	4
3	3	3
4	4	4

THIS STRUCTURE MEETS OR EXCEEDS CPSC #325 AND ASTM F1487 UNLESS OTHERWISE NOTED.

DATE  
 1/30/2023  
 SCALE  
 1/8" = 1'-0"  
 DRAWN/SAVED BY  
 BL / BONNIE LEAGUE  
 SHEET  
 1 OF 3  
 PAGE  
 PLAN\_VIEW

WE RECOMMEND THIS PLAN BE PRINTED ON 11" x 17" PAPER

PLAYGROUND SUPERVISION IS REQUIRED.

THIS DESIGN IS THE PROPERTY OF SUPERIOR RECREATIONAL PRODUCTS AND MAY NOT BE REPRODUCED OR USED IN ANY MANNER WITHOUT THE EXPRESSED WRITTEN CONSENT OF SUPERIOR RECREATIONAL PRODUCTS.

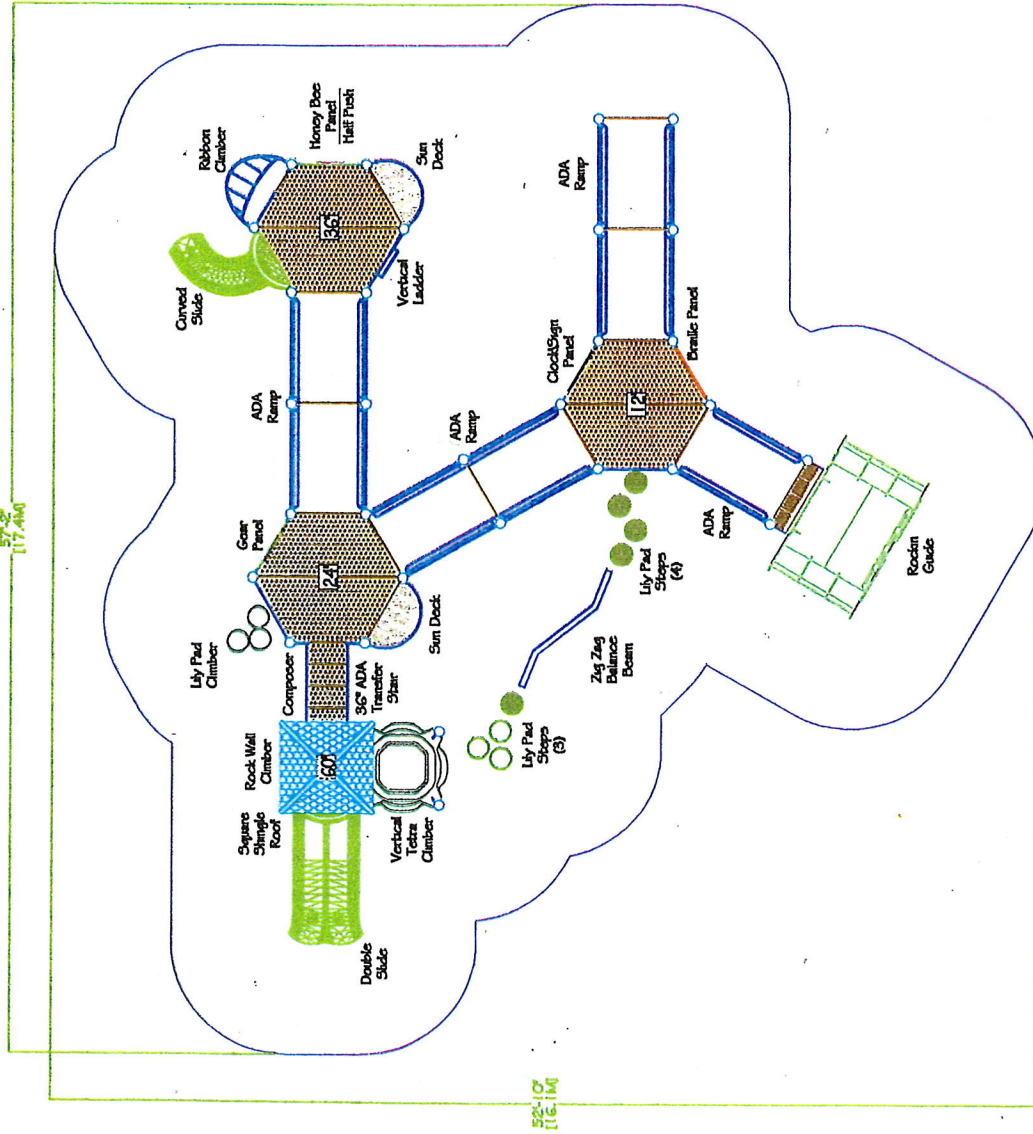



## The Sound Playground

STRUCTURE SP012023-044 • QUOTE QUO0255747

Design is for illustration purposes only and colors may vary.

**Color Key**

Post: Butterscotch  
Post Cap: Black  
Metal: Midnight  
Plastic: Blue

Panel: Champagne  
San. Panel: Grey/Black  
Deck: Grey  
Fabric: N/A



## The Sound Playground

STRUCTURE SP012023-044 • QUOTE QUO0255747

Design is for illustration purposes only and colors may vary.

Color Key

Post: Butterscotch  
Post Cap: Black  
Metal: Midnight  
Plastic: Blue

Panel: Champagne  
San. Panel: Grey/Black  
Deck: Grey  
Fabric: N/A











Go Play, Inc  
Jennifer and David VanWormer  
9916 County Road 48 1/2  
Milliken, CO 80543

PRE  
Middle Playground

**Proposal**

Customer			
Name	Weld RE-5J School District - Joshua Roseberry		
Address	110 Centennial Drive A		
City	Milliken	State	CO ZIP 80543
Phone	(970)587-6096		

Misc	
Date	2/13/2023
Order No.	SRP255791
Rep	JVW
FOB	

Qty	Description	Unit Price	TOTAL
<b>PLAYGROUND EQUIPMENT</b>			
1	Superior FXT-50018 custom tower structure, 5" OD posts for ages 5-12 	\$181,460.00	\$ 181,460.00
1	Superior 1-Bay, 3.5" OD Arch 	\$6,520.00	\$ 6,520.00
1	Inclusive Team Swing with (1) inclusive team seat.		
2	Superior Surf Bounce/Balance Riders 	\$1,725.00	\$ 3,450.00
2	Superior Whirl-N-Twirl Spinner Seats 	\$896.00	\$ 1,792.00
1	Superior PlayDale Rota-Rock Balance Spring Rider 	\$9,746.00	\$ 9,746.00
1	Superior Inclusive Atom 	\$7,240.00	\$ 7,240.00
1	<b>Go Play discount on Superior Playgrounds equipment as quoted above. May not be combined with any other discounts or promotions.</b>	30%	\$ (63,062.40)
<b>SITE PREPARATION</b>			
1	Removal and disposal of existing 440 sf @ 12" depth breeze material from south side of play area, push back (and replace at completion) 5950 sf existing wood fiber surfacing, remove and dispose of 180 LF of black plastic border timbers, and removal and disposal of existing playground structures and 4-bay swing..	\$10,450.00	\$ 10,450.00
<b>EQUIPMENT INSTALLATION:</b>			
1	Completed installation of new playground equipment listed above by CPSI certified installer.		\$ 69,368.64
<b>SURFACING:</b>			
1	Form and pour 190 LF of grey concrete borders, 12" H x 6" wide, square corners, does not include facing, includes pump truck.		\$ 12,250.00
4960	sf engineered wood fiber replenishment materials, 2" average depth, includes material, delivery and installation.	\$0.65	\$ 3,224.00
1430	sf supply and install compacted poured-in-place sub-base material and sub-surface retaining border, 10" compacted depth, includes materials, materials, delivery, installation and compaction.	\$6.55	\$ 9,366.50
1698	sf Poured-in-place safety surfacing (under team seat and inclusive atom) 50% black / 50% color mix, standard binder, variable 4' - 8' fall height attenuation, beveled edges down into surrounding wood fiber, includes material, delivery and installation.	\$16.25	\$ 27,592.50
<b>NOTES:</b> Please see attached terms and conditions for project notes.			

Signed proposal and 50% deposit or PO required to proceed with order.

SubTotal	\$ 279,397.24
Freight	\$ 12,725.00
Tax Rate(s)	TBD
<b>TOTAL</b>	<b>\$ 292,122.24</b>

Date: \_\_\_\_\_

Authorizing Signature: \_\_\_\_\_

Colorado Retail Sales Tax Exempt # \_\_\_\_\_

Office Use Only



Contact: Go Play Phone (970) 420-6796  
Go Play Email jennifer@goplayplaygrounds.com



Thank you for your consideration! Pricing is valid for 30 days.

**Pioneer Ridge Elementary  
Middle Playground Area  
Site Plan**



Proposed by Jennifer Van Wormer  
(970)420-6796  
jennifer@goplayplaygrounds.com

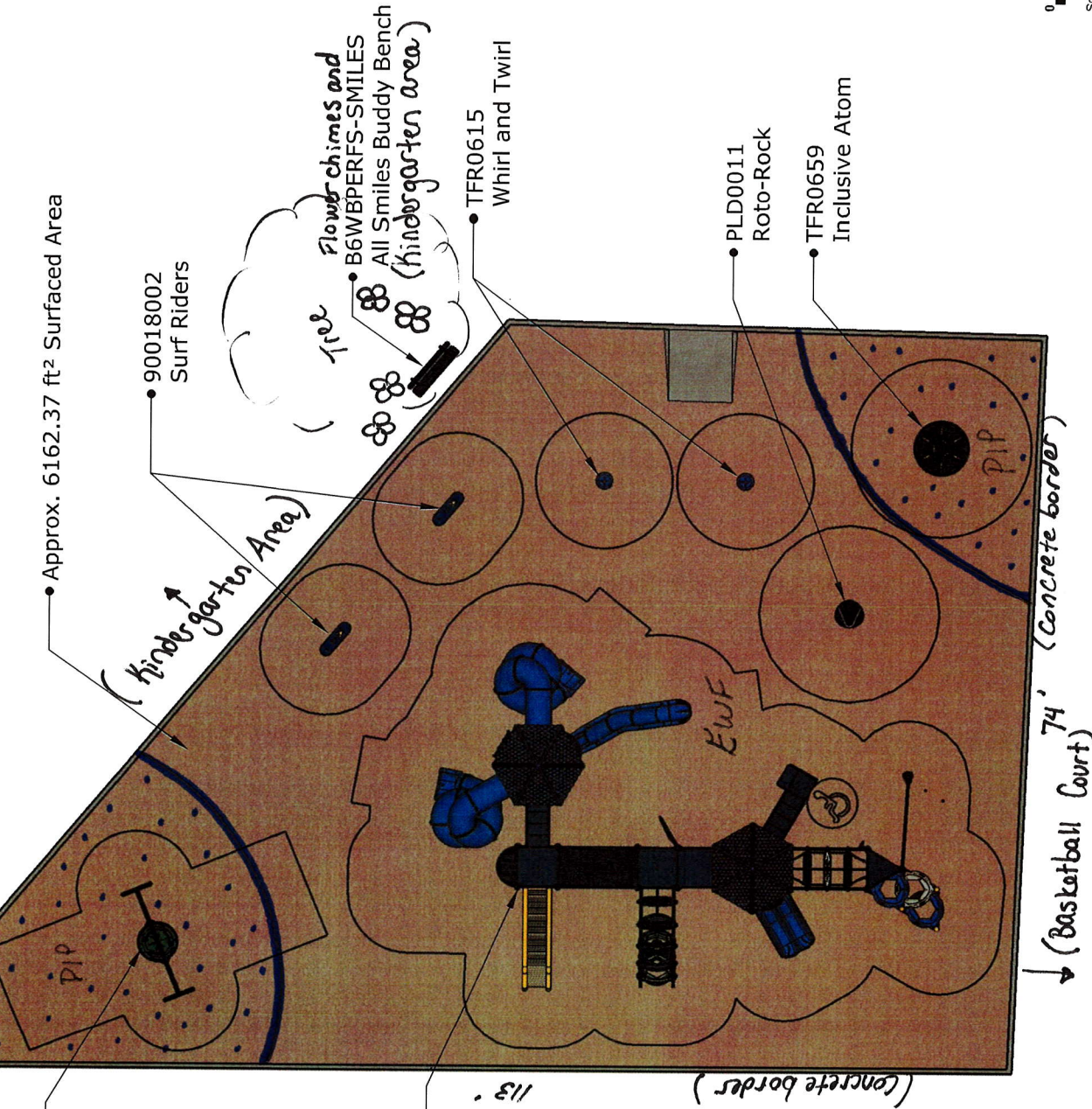

FXT-50018  
Tower Structure  
Steel Play  
5/12 y/o

6390 ~~ft~~ total  
4960 ~~ft~~ wood fiber  
1430 ~~ft~~ poured-in-place





**Project:  
Pioneer Ridge**

**Quote:  
QUO0255791**

**Preliminary Concept Design**

*Conceptual Renderings Only. Subject to change without notice at SRP's Discretion*

**14ft Hex Tower**



**Transfer**



**Steel**



**Age Group**

**Designer: B.Huffard**

**Date: 1/26/2023**

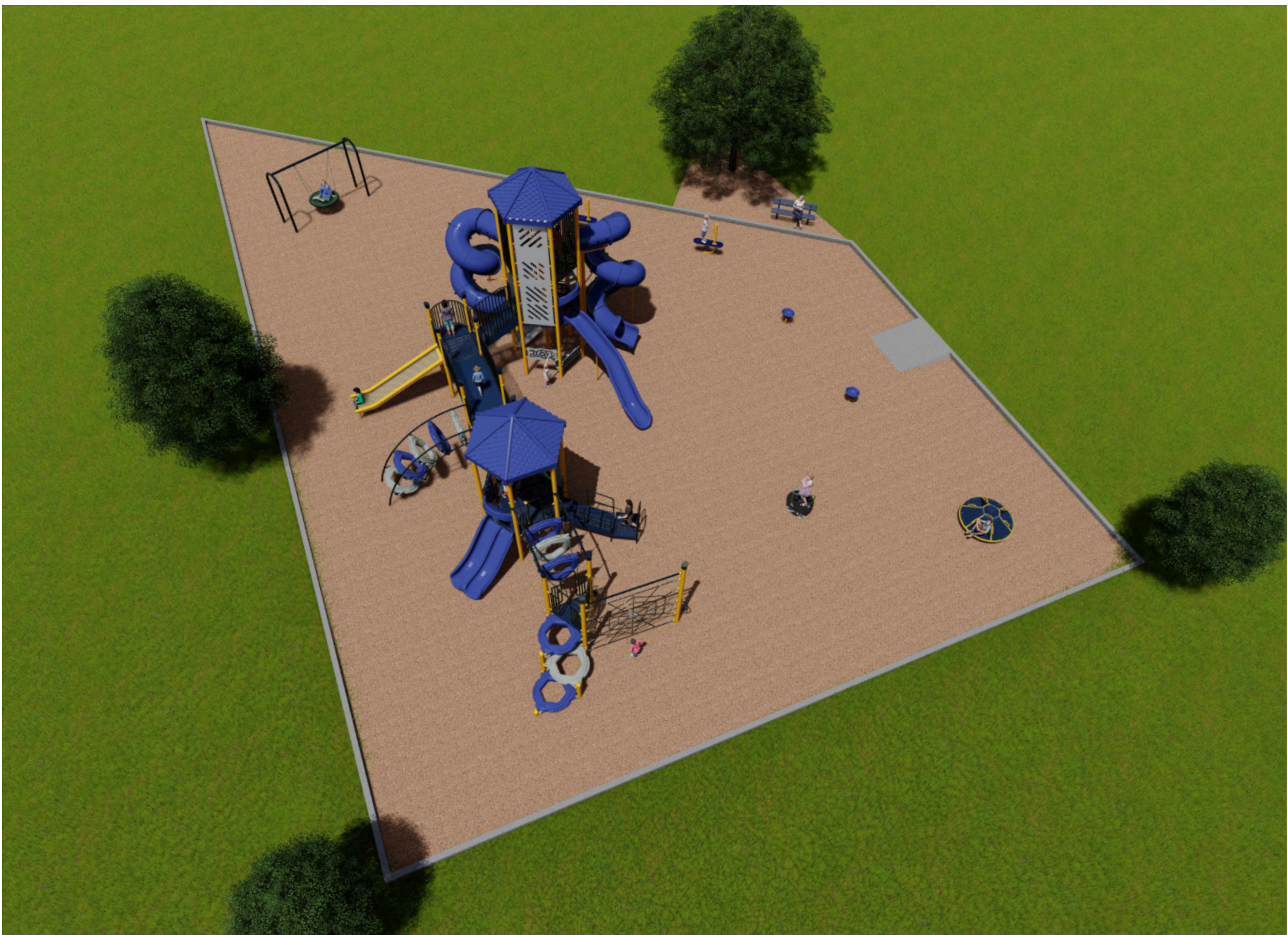

Quote: QU00255791- Pioneer Ridge Elementary  
Age: 5-12 Series: Towers Access: Transfer Max Height: 14ft

**Preliminary Concept Design**

*Conceptual Renderings Only. Subject to change without notice at SRP's Discretion*





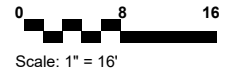
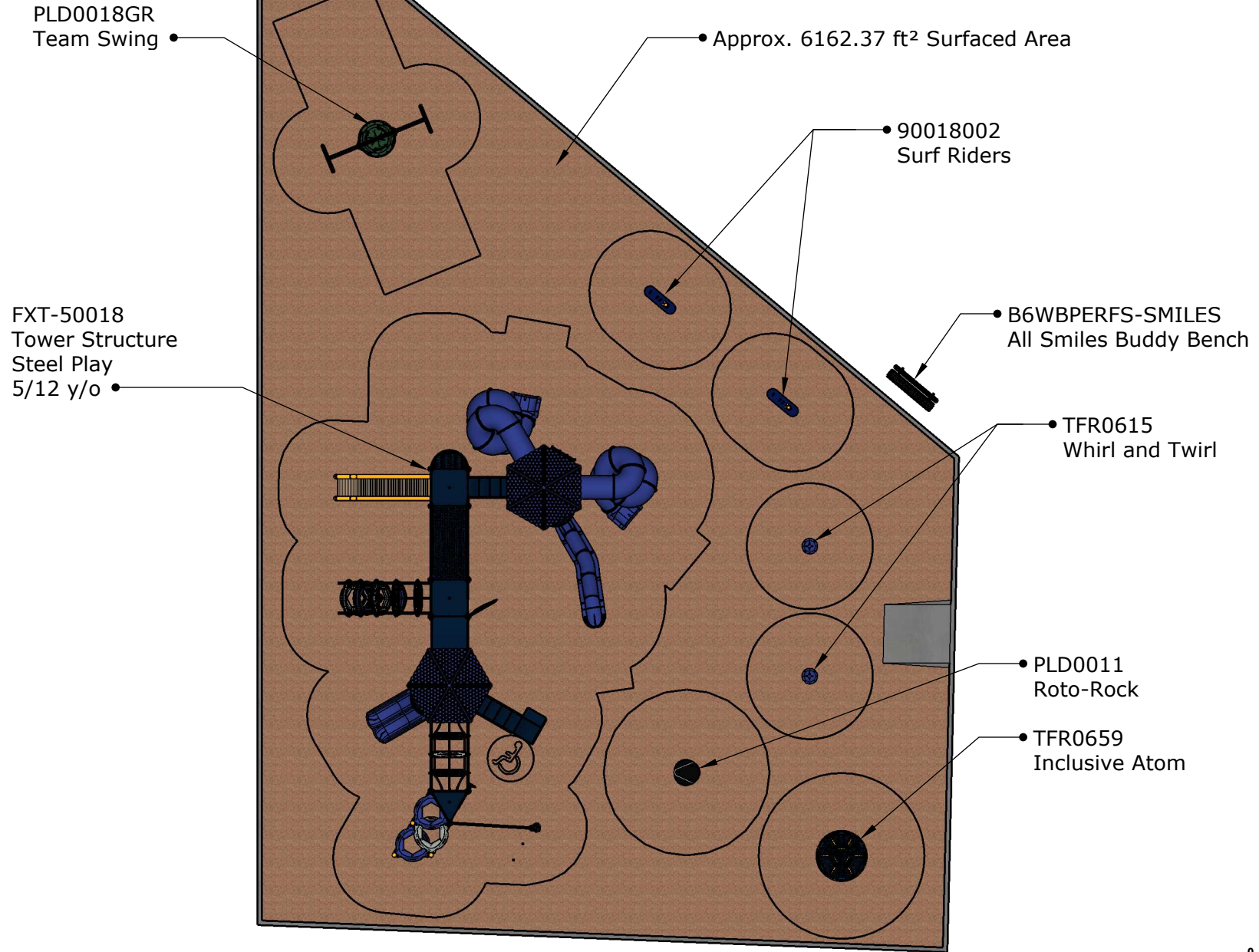



Quote: QUO0255791- Pioneer Ridge Elementary  
Age: 5-12

Series: Towers

Access: Transfer

Max Height: 14ft

**Preliminary Concept Design**

*Conceptual Renderings Only. Subject to change without notice at SRP's Discretion*





Quote: QUO0255791- Pioneer Ridge Elementary  
Age: 5-12

Series: Towers

Access: Transfer

Max Height: 14ft

**Preliminary Concept Design**

*Conceptual Renderings Only. Subject to change without notice at SRP's Discretion*



Quote: QU00255791- Pioneer Ridge Elementary  
Age: 5-12

Series: Towers

Access: Transfer

Max Height: 14ft

**Preliminary Concept Design**

*Conceptual Renderings Only. Subject to change without notice at SRP's Discretion*



Quote: QUO0255791- Pioneer Ridge Elementary  
Age: 5-12

Series: Towers

Access: Transfer

Max Height: 14ft

**Preliminary Concept Design**

*Conceptual Renderings Only. Subject to change without notice at SRP's Discretion*



Quote: QUO0255791- Pioneer Ridge Elementary  
Age: 5-12 Series: Towers Access: Transfer Max Height: 14ft

**Preliminary Concept Design**

*Conceptual Renderings Only. Subject to change without notice at SRP's Discretion*

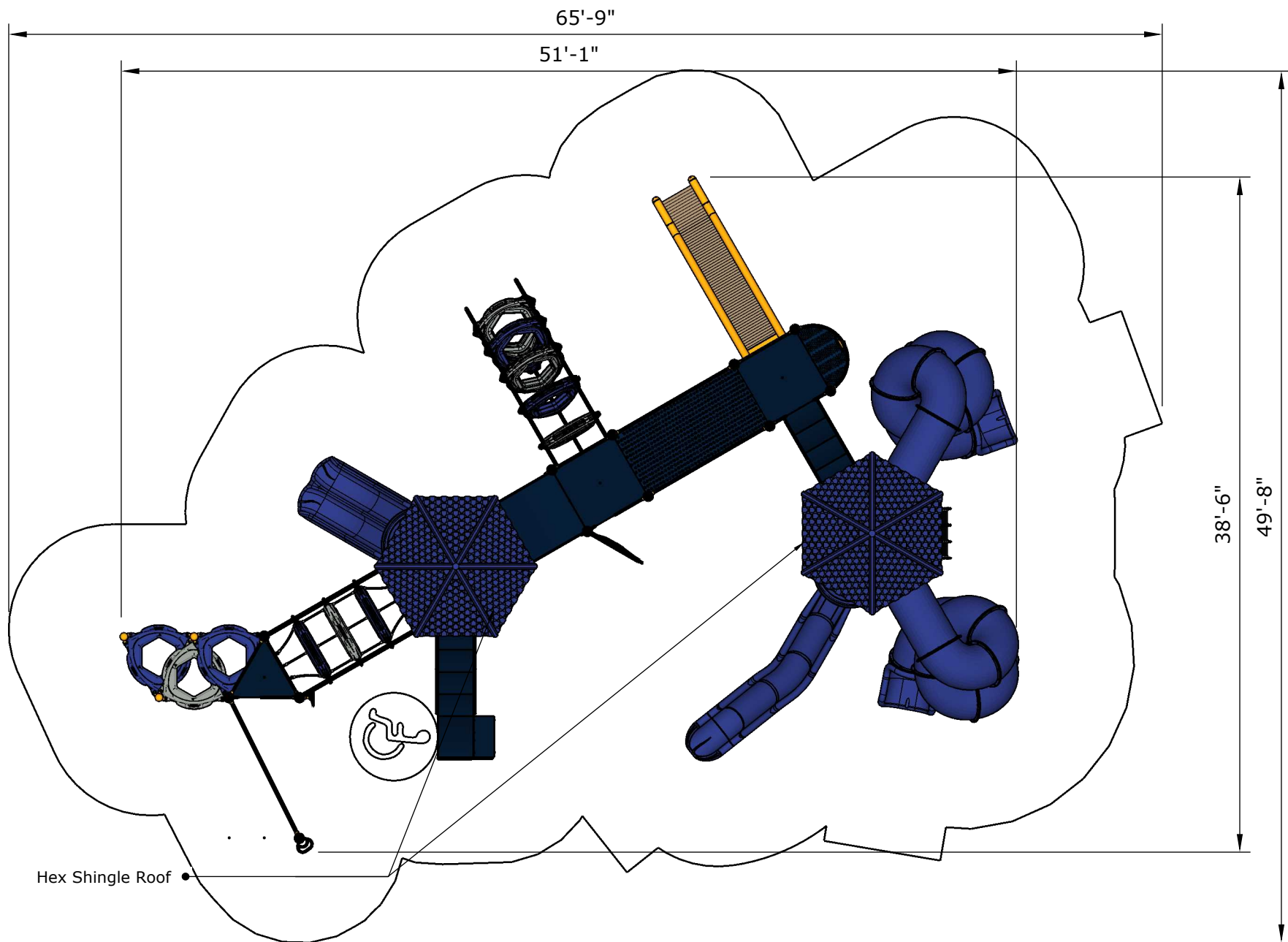

Hex Shingle Roof

Ages	Capacity	Use Zone	Max Deck Height	Actual Size	Timber Count	Elevated Activities
5-12	91	56'x46'	14'	41'x33'	51	14

Scale: 1/8" = 1'



	Accessible Play Activities	Accessible Activity Types
Required	5	3
Provided	6	4



Quote: QUO0255791- Pioneer Ridge Elementary  
 Age: 5-12 Series: Towers Access: Transfer Max Height: 14ft

**Preliminary Concept Design**

Conceptual Renderings Only. Subject to change without notice at SRP's Discretion

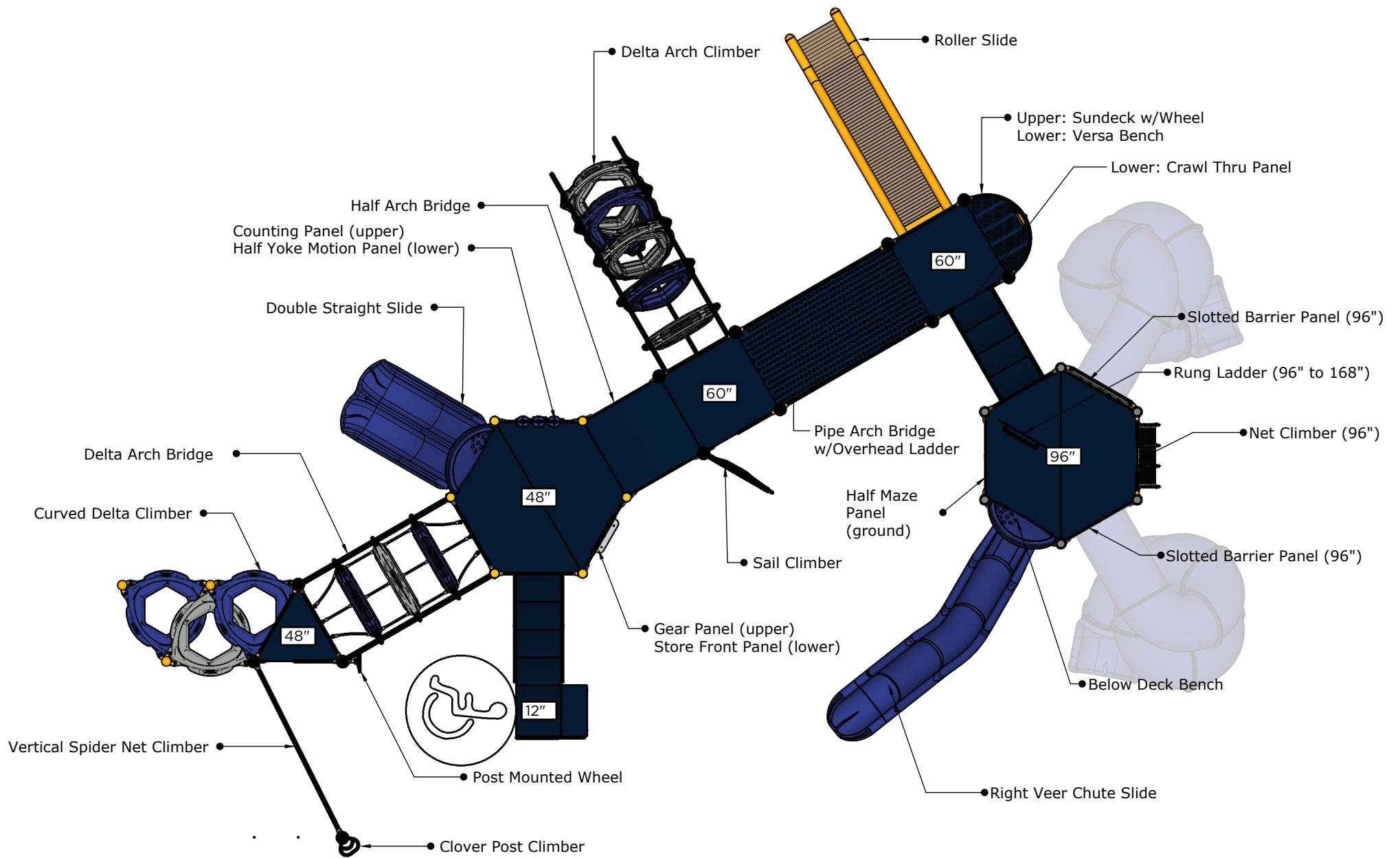

### Lower Levels

Ages	Capacity	Use Zone	Max Deck Height	Actual Size	Timber Count	Elevated Activities
5-12	91	56'x46'	14'	41'x33'	51	14

Scale: 1/6" = 1'



	Accessible Play Activities	Accessible Activity Types
Required	5	3
Provided	6	4



Quote: QU00255791- Pioneer Ridge Elementary  
 Age: 5-12 Series: Towers Access: Transfer Max Height: 14ft

**Preliminary Concept Design**

*Conceptual Renderings Only. Subject to change without notice at SRP's Discretion*

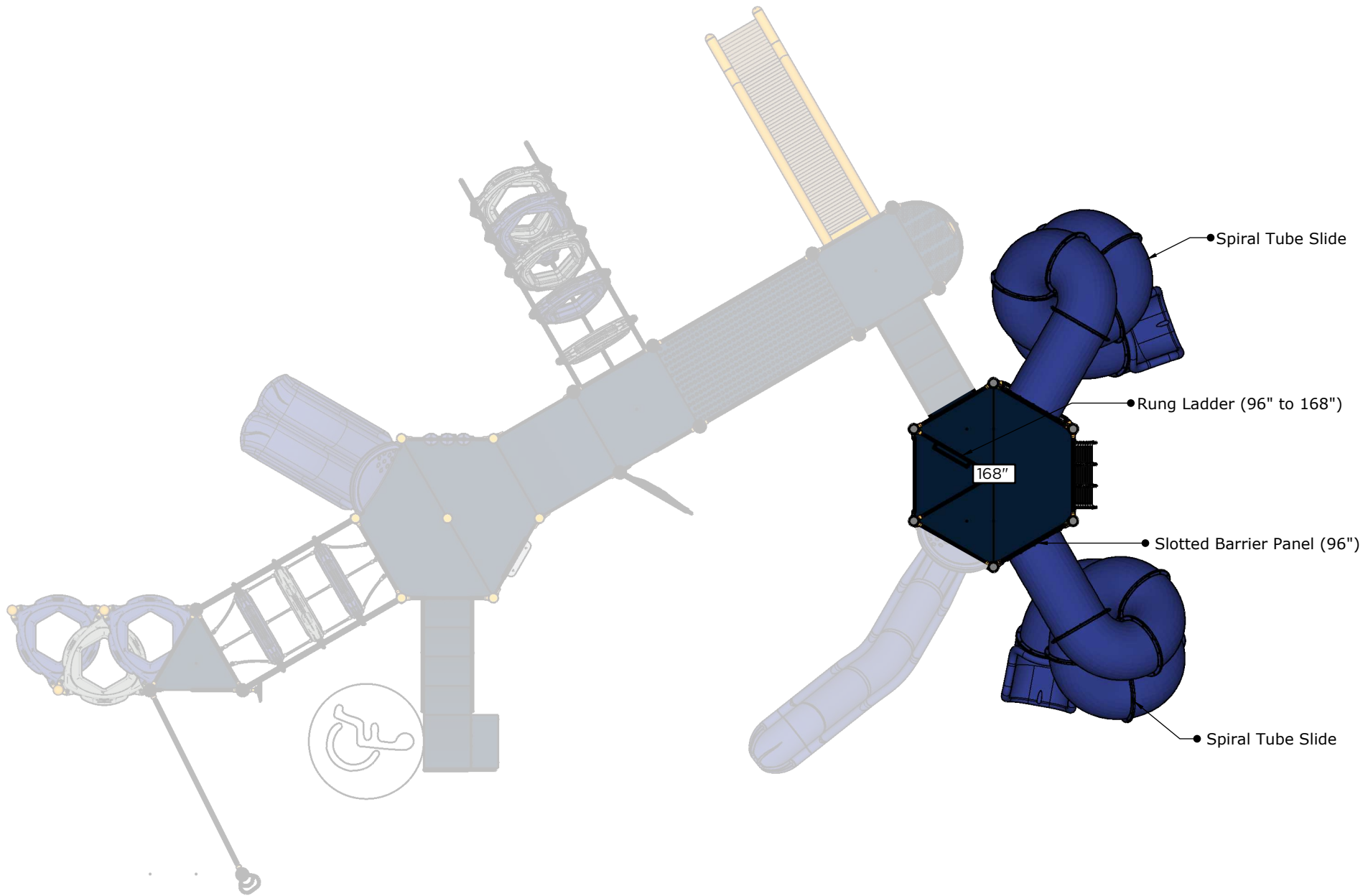

**Tower Level**

Ages	Capacity	Use Zone	Max Deck Height	Actual Size	Timber Count	Elevated Activities
5-12	91	56'x46'	14'	41'x33'	51	14

Scale: 1/6" = 1'



	Accessible Play Activities	Accessible Activity Types
Required	5	3
Provided	6	4



Quote: QU00255791- Pioneer Ridge Elementary  
 Age: 5-12 Series: Towers Access: Transfer Max Height: 14ft

**Preliminary Concept Design**

*Conceptual Renderings Only. Subject to change without notice at SRP's Discretion*

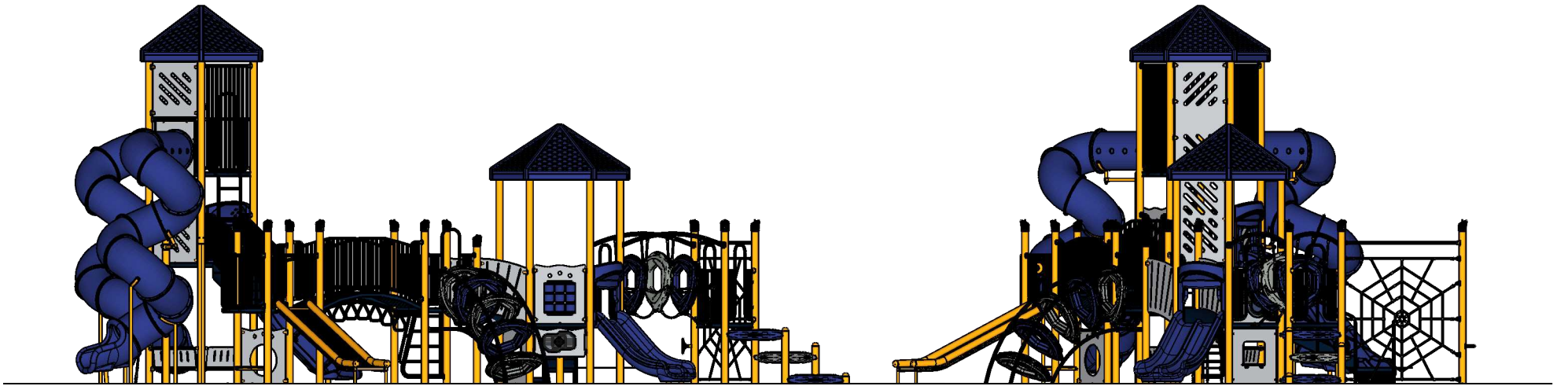
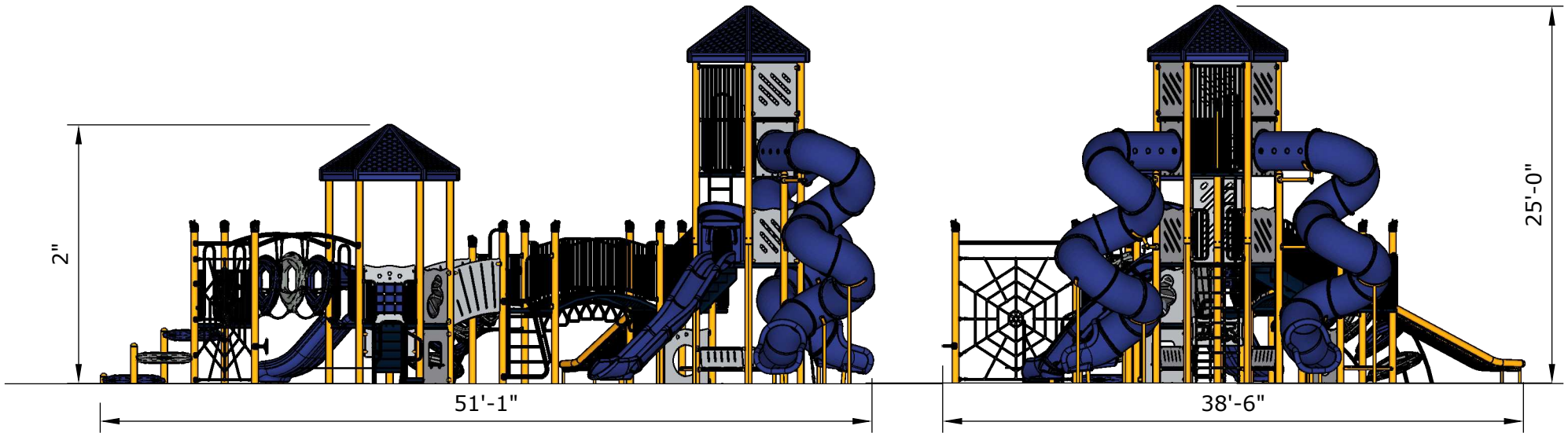

**All Elevations from Finished Surfacing**

Ages	Capacity	Use Zone	Deck Height	Actual Size	Timber Count	Elevated Activities
5-12	91	56'x46'	14'	41'x33'	51	14

Scale: 1/10" = 1'

	Accessible Play Activities	Accessible Activity Types
Required	5	3
Provided	6	4



**Partner**

**Superior**<sup>®</sup>  
RECREATIONAL PRODUCTS  
A PLAYCORE Company

<https://srpplayground.com/>



srpplayground.com  
866-795-7545