

LOCATION MAP  
NOT TO SCALE

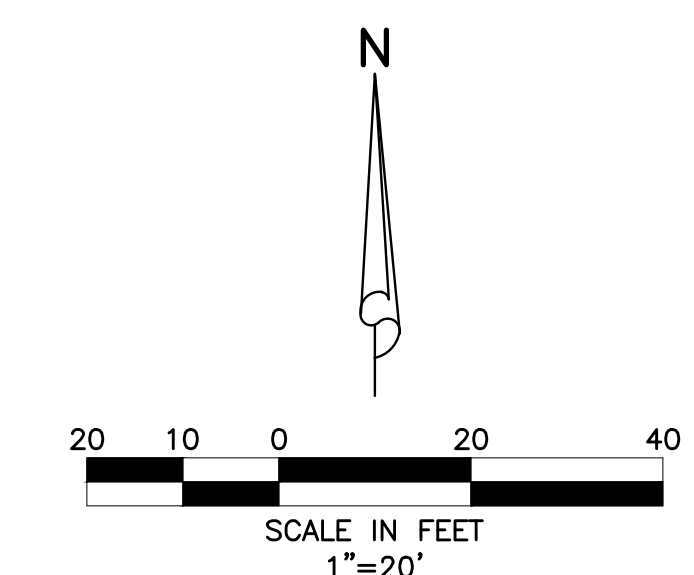

ALTERNATIVE 1  
PEDESTRIAN PATH ON  
SOUTH SIDE OF ROAD

7/13/2023

					<b>OCEAN RIDGE</b> SECTION 28, TOWNSHIP 41S., RANGE 43E. TOWN OF JUNO BEACH, FLORIDA <b>PEDESTRIAN PATH IMPROVEMENTS</b>		
					DESIGN B.K.	DRAWN D.B.	CHECKED

Y:\AUTOCAD\_FILES\2022\22-045\EXHIBITS\202\_Pedestrian Path Alt 1.dwg 7/13/2023 1:45 PM Daniel Brunet

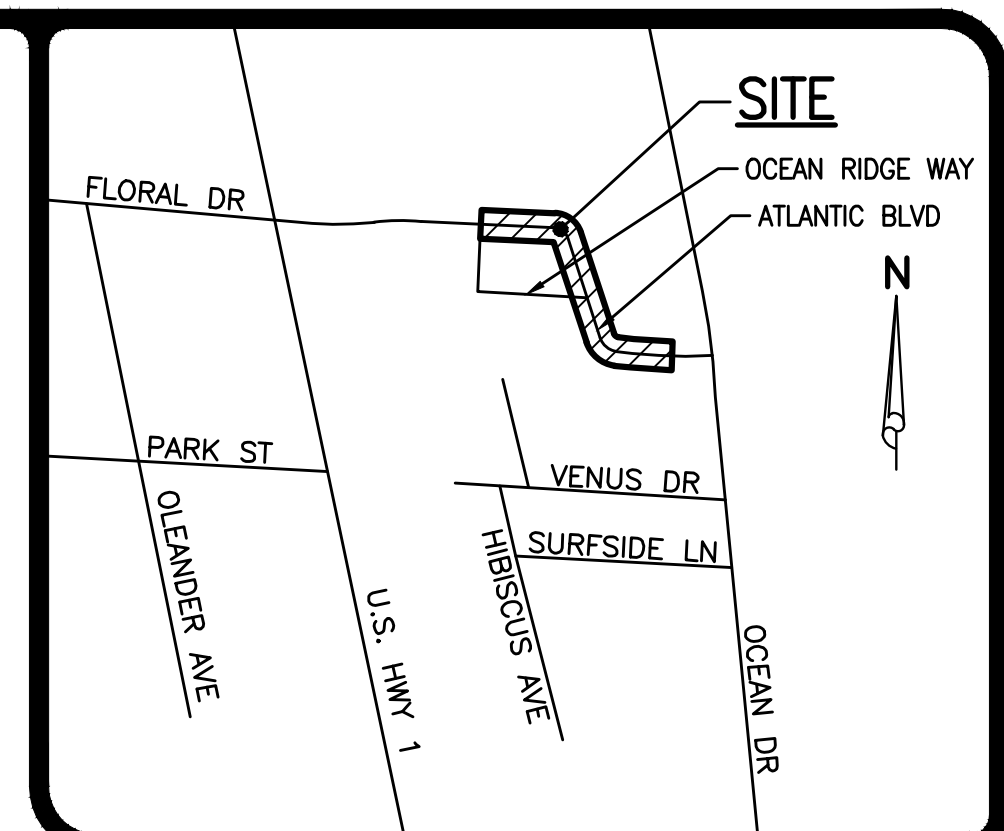

LOCATION MAP  
NOT TO SCALE

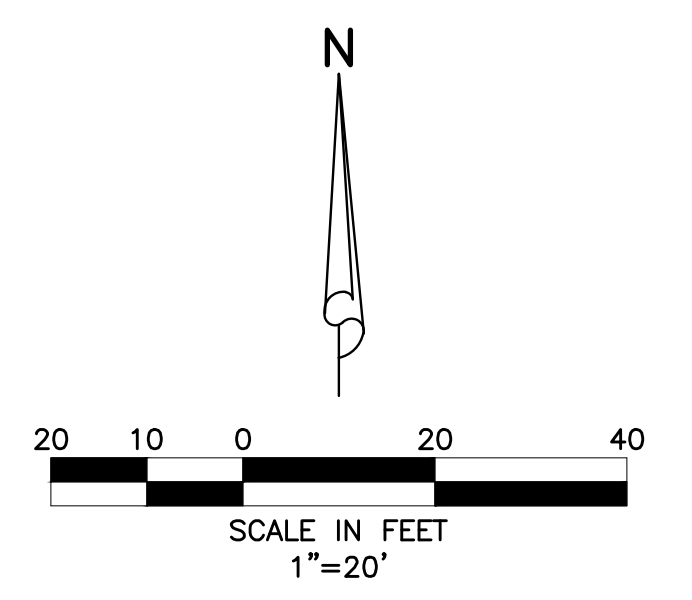

**ALTERNATIVE 2**  
PEDESTRIAN PATH ON  
NORTH SIDE OF ROAD.  
MID BLOCK CROSSING

7/13/2023

					<b>OCEAN RIDGE</b> SECTION 28, TOWNSHIP 41S., RANGE 43E. TOWN OF JUNO BEACH, FLORIDA <b>PEDESTRIAN PATH IMPROVEMENTS</b>			
					DESIGN B.K.	DRAWN D.B.	CHECKED	APPROVED

Y:\AUTOCAD\_FILES\2022\22-045\EXHIBITS\202\_Pedestrian Path Alt 2.dwg 7/13/2023 1:45 PM Daniel Brunet

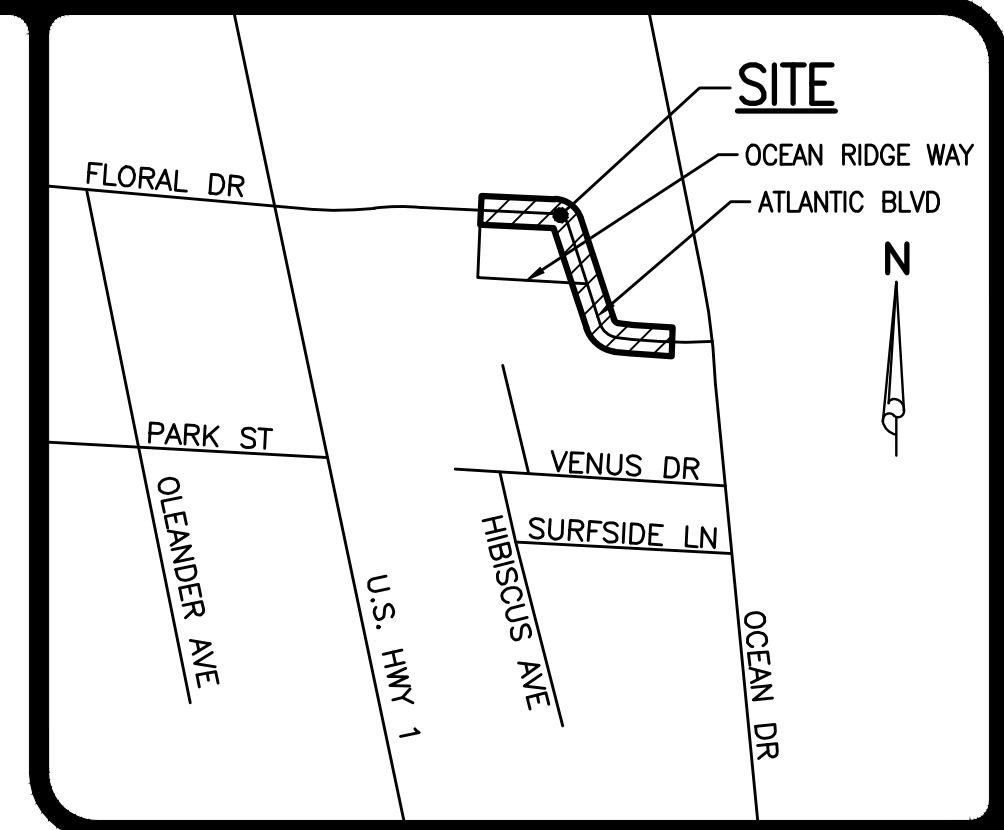

LOCATION MAP  
NOT TO SCALE

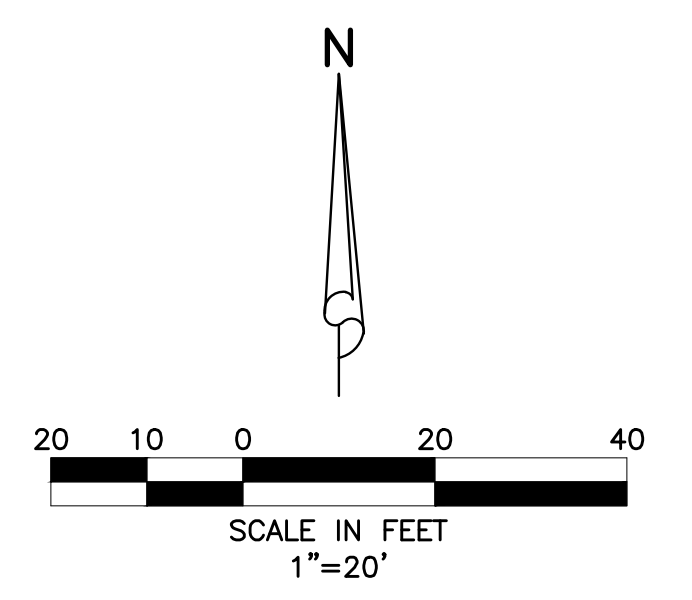

**ALTERNATIVE 3**  
PEDESTRIAN PATH ON  
NORTH SIDE OF ROAD.  
CROSSING AT OCEAN DR.

7/13/2023

					<b>OCEAN RIDGE</b> SECTION 28, TOWNSHIP 41S., RANGE 43E. TOWN OF JUNO BEACH, FLORIDA <b>PEDESTRIAN PATH IMPROVEMENTS</b>			
					DESIGN B.K.	DRAWN D.B.	CHECKED	APPROVED

Y:\AUTOCAD\_FILES\2022\22-045\EXHIBITS\Z02\_Pedestrian Path Alt 3.dwg 7/13/2023 1:45 PM Daniel Brunet