

ROADWAY IMPROVEMENT PLANS

ATLANTIC BOULEVARD

SECTION 28, TOWNSHIP 41S., RANGE 43E.
TOWN OF JUNO BEACH, FLORIDA

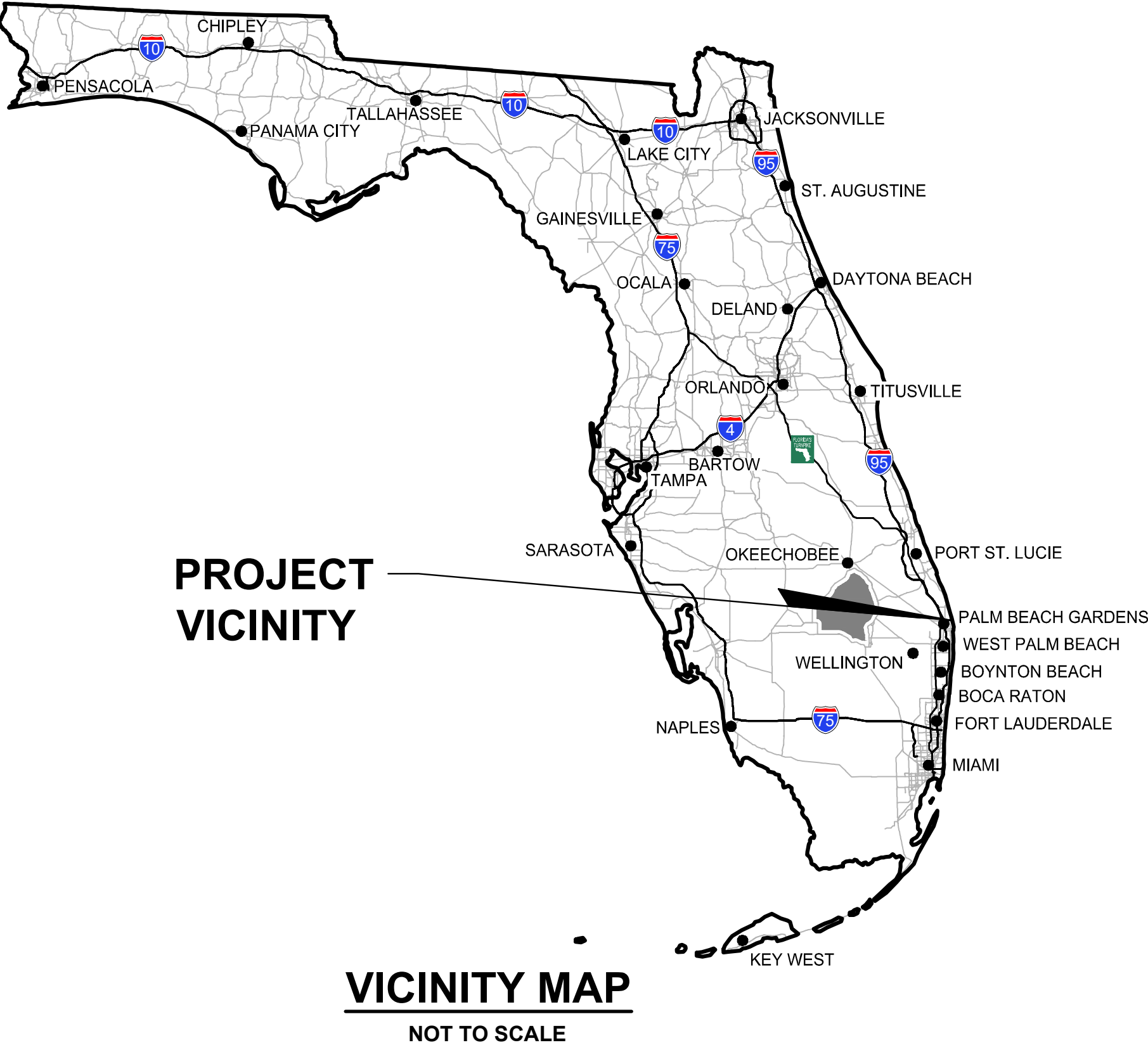

INDEX OF SHEETS

SHEET NO.:	DESCRIPTION:
1	TITLE SHEET
2-3	PAVING AND STRIPING PLAN
4	PAVING AND STRIPING DETAILS
5	POLLUTION PREVENTION PLAN

THIS ITEM HAS BEEN DIGITALLY SIGNED AND SEALED BY PAUL ANTON BURI, P.E. ON 11/22/2024.

PRINTED COPIES OF THIS DOCUMENT ARE NOT CONSIDERED SIGNED AND SEALED AND THE SIGNATURE MUST BE VERIFIED ON ANY ELECTRONIC COPIES.

PAUL ANTON BURI
 LICENSE
 No. 68291
 STATE OF FLORIDA
 PROFESSIONAL ENGINEER

DESIGN J.U.	DRAWN R.W.	CHECKED	APPROVED	DATE
REVISIONS				

SIMMONS & WHITE
 2581 Metrocentre Blvd West, Ste 3 | West Palm Beach, FL 33407
 Authorization # 3452 | 561.478.7848

ATLANTIC BOULEVARD
 SECTION 28, TOWNSHIP 41S., RANGE 43E.
 TOWN OF JUNO BEACH, FLORIDA
 TITLE SHEET

JOB NO. 24-004.9	DRAWING NO. 24004.9S01	SHEET 1 OF 5
---------------------	---------------------------	-----------------

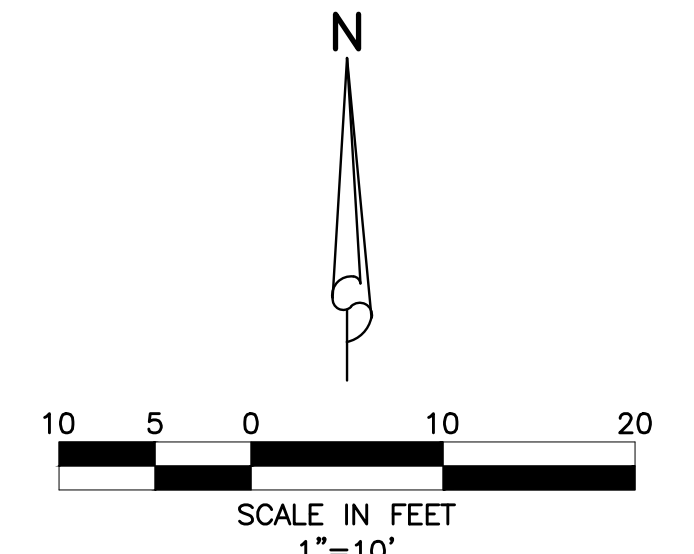
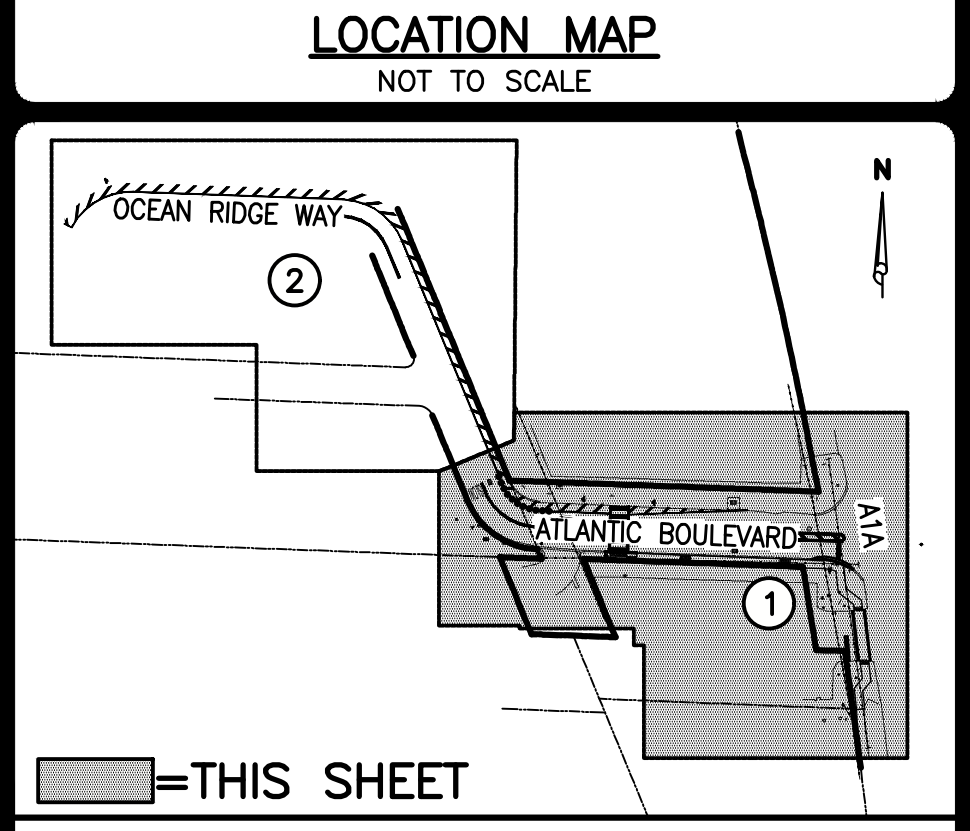
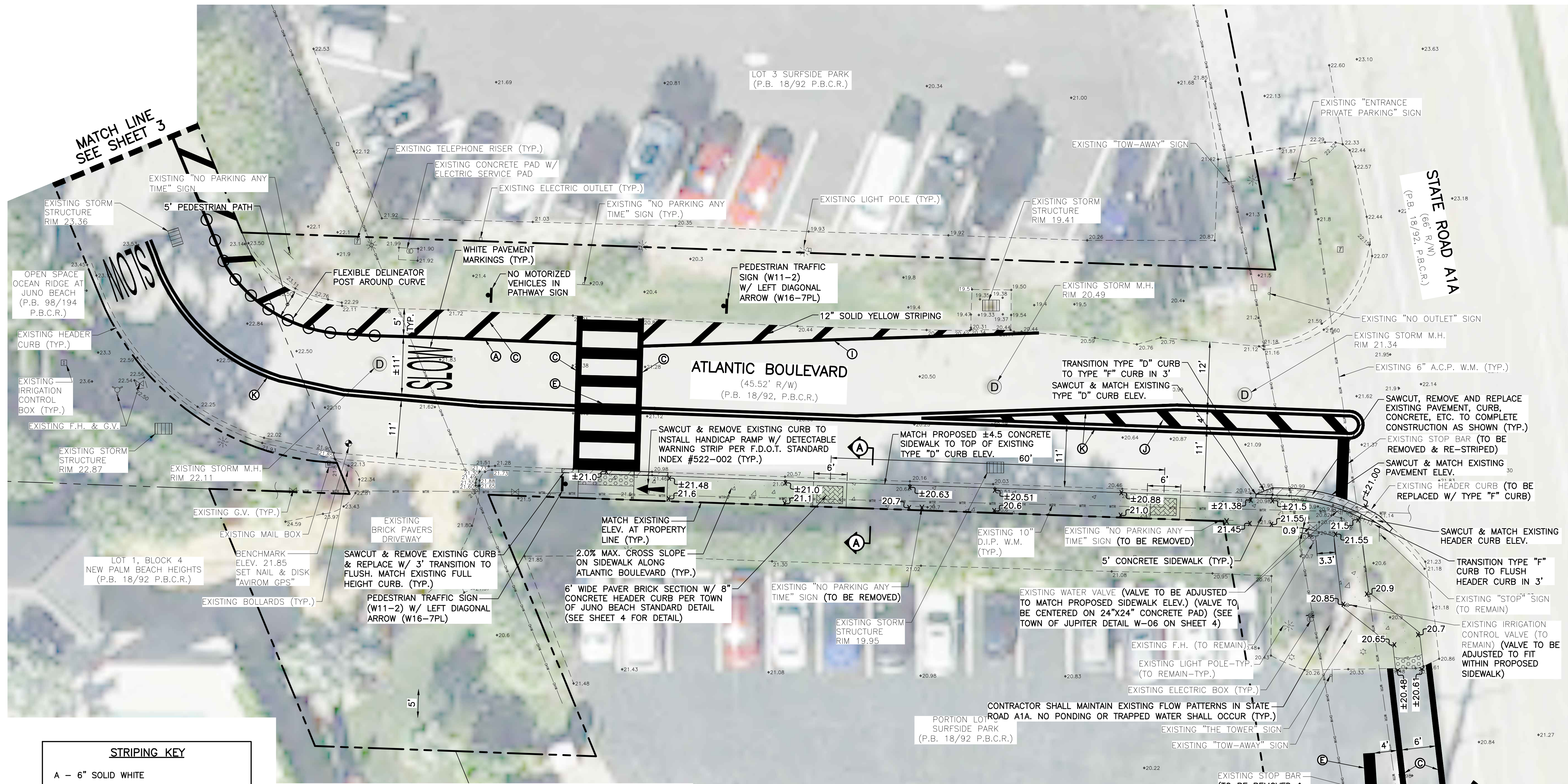

LEGEND

- PROPOSED GRADE ELEVATION
- EXISTING GRADE ELEVATION
- CONCRETE
- PAVER BRICK
- DETECTABLE WARNING SURFACE
- SAWCUT, REMOVE, & REPLACE EXISTING PAVEMENT, CONCRETE, CURB, ETC.
- EXISTING OVERHEAD POWER LINE & POWER POLE
- EXISTING STORM DRAINAGE PIPE (TO REMAIN)
- EXISTING WATER MAIN (TO REMAIN)
- EXISTING SEWER MAIN (TO REMAIN)
- EXISTING FORCE MAIN (TO REMAIN)

STRIPING KEY

- A - 6" SOLID WHITE
- B - 8" SOLID WHITE
- C - 12" SOLID WHITE
- D - 18" SOLID WHITE
- E - 24" SOLID WHITE
- F - 6" SKIP WHITE TYP. (10'-30')
- G - 6" SKIP WHITE TYP. (6'-10')
- H - 6" SKIP WHITE TYP. (2'-4')
- I - 6" SOLID YELLOW
- J - 18" SOLID YELLOW
- K - 6" DOUBLE YELLOW
- L - 6" SKIP YELLOW TYP. (10'-30')
- M - 6" SKIP YELLOW TYP. (6'-10')
- N - 6" SKIP YELLOW TYP. (2'-4')
- P - R.P.M. BI-DIRECTIONAL AMBER/AMBER
- R - F.D.P. WHITE
- S - F.D.P. YELLOW
- T - R.P.M. BI-DIRECTIONAL WHITE/RED
- U - R.P.M. BI-DIRECTIONAL RED/YELLOW

NOTES:

- 1.) CONTRACTOR TO FIELD VERIFY LOCATION AND DEPTH OF ALL EXISTING UTILITIES PRIOR TO CONSTRUCTION AND NOTIFY ENGINEER OF ANY CONFLICTS. IT SHALL BE THE CONTRACTOR'S RESPONSIBILITY TO COORDINATE ALL EXISTING UTILITY LOCATES, SUPPORT, RELOCATIONS AND NOTIFICATIONS REQUIRED WITH ALL APPLICABLE UTILITY SERVICE PROVIDERS.
- 2.) ALL STRIPING SHALL BE THERMOPLASTIC.
- 3.) SWALE BOTTOM ELEVATION SHALL BE ADJUSTED AS NEEDED TO MAINTAIN 6" MINIMUM DEPTH TO INVERT AS MEASURED FROM ADJACENT EDGE OF PAVEMENT. CONTRACTOR SHALL NOTIFY ENGINEER OF ANY CONFLICTS PRIORI TO CONSTRUCTION.
- 4.) CONTRACTOR SHALL BE RESPONSIBLE FOR RESTORING ALL ON-SITE & OFF-SITE AREAS DISTURBED DURING CONSTRUCTION TO EXISTING OR BETTER CONDITIONS.
- 5.) CONTRACTOR SHALL BE RESPONSIBLE FOR ALL N.P.D.E.S. REQUIREMENTS INCLUDING FILING OF N.O.I., N.O.T., WEEKLY & MONTHLY MONITORING REPORTS, ETC.
- 6.) CONTRACTOR SHALL BE RESPONSIBLE TO REPAIR/REPLACE EXISTING IRRIGATION LIGHTING OR OTHER PRIVATE UTILITIES IMPACTED BY PROPOSED IMPROVEMENTS. CONTRACTOR SHALL BE RESPONSIBLE TO LOCATE EXISTING FACILITIES.

48 HOURS BEFORE DIGGING
BROWARD • PALM BEACH • INDIAN RIVER
COUNTIES
1-800-432-4770
SUNSHINE STATE 1 CALL
UNDERGROUND UTILITIES
NOTIFICATION CENTER

NOTE: ALL ELEVATIONS SHOWN HEREON ARE RELATIVE TO THE NORTH AMERICAN VERTICAL DATUM (N.A.V.D.) OF 1988 BASED ON A SURVEY PREPARED BY AVIROM & ASSOCIATES, INC. (772) 781-6266

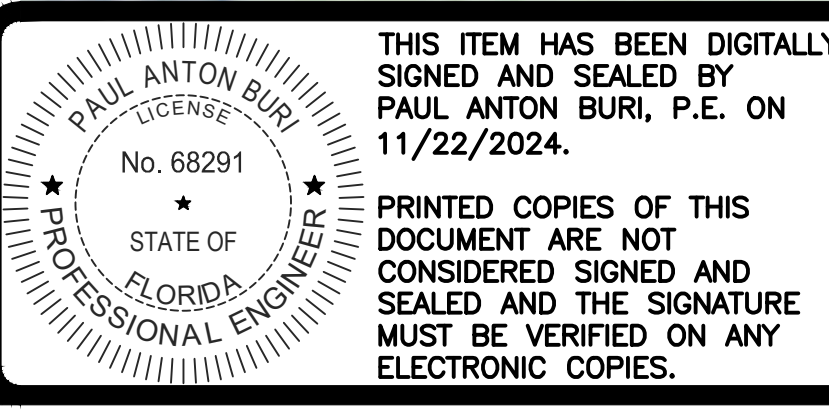

THIS ITEM HAS BEEN DIGITALLY SIGNED AND SEALED BY PAUL ANTON BUR I, P.E. ON 11/22/2024.
PRINTED COPIES OF THIS DOCUMENT ARE NOT CONSIDERED SIGNED AND SEALED AND THE SIGNATURE MUST BE VERIFIED ON ANY ELECTRONIC COPIES.

1.) ADDED PAVER BRICK SECTIONS TO ATLANTIC BLVD. SIDEWALK PER TOWN OF JUNO BEACH COMMENTS, 11/22/24 D.B.



ATLANTIC BOULEVARD
SECTION 28, TOWNSHIP 41S., RANGE 43E.
TOWN OF JUNO BEACH, FLORIDA
PAVING AND STRIPING PLAN

REVISIONS	DESIGN	DRAWN	CHECKED	APPROVED	DATE	JOB NO.	DRAWING NO.	SHEET	OF
	J.U.	R.W.				24-004.9	24004.9S02	2	5

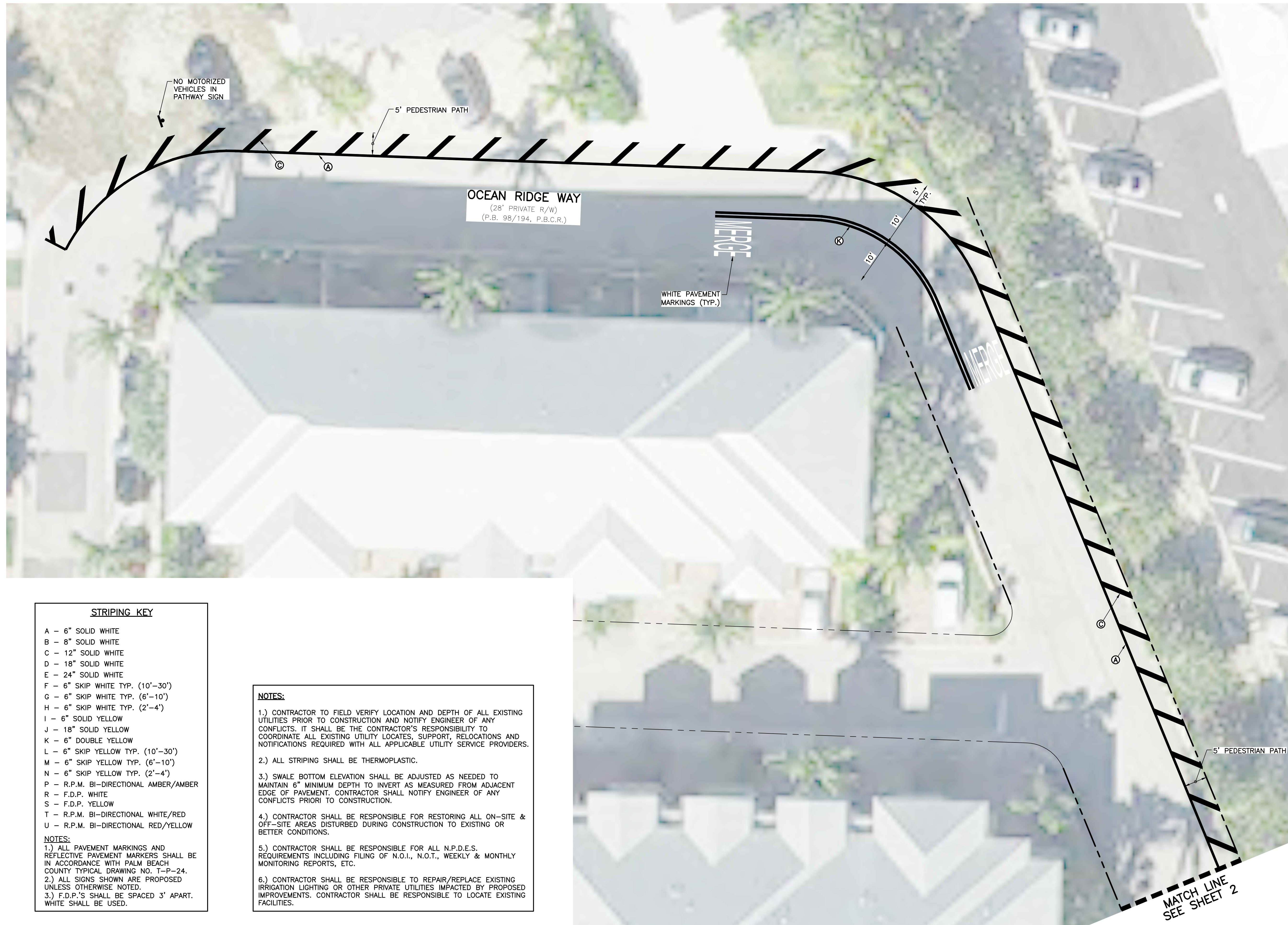

LOCATION MAP
NOT TO SCALE

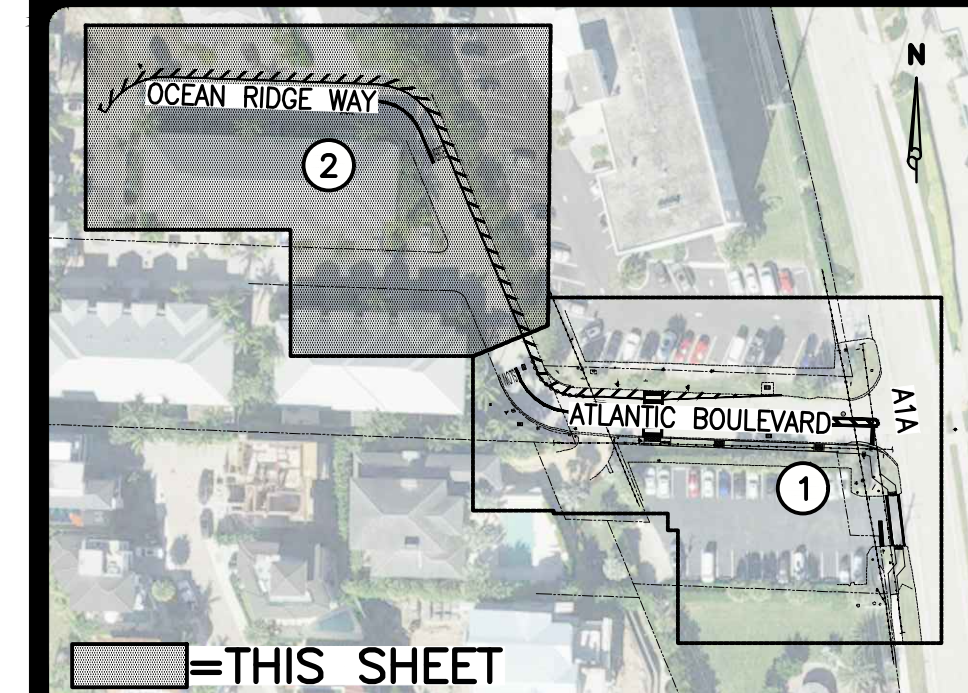

KEY MAP
NOT TO SCALE

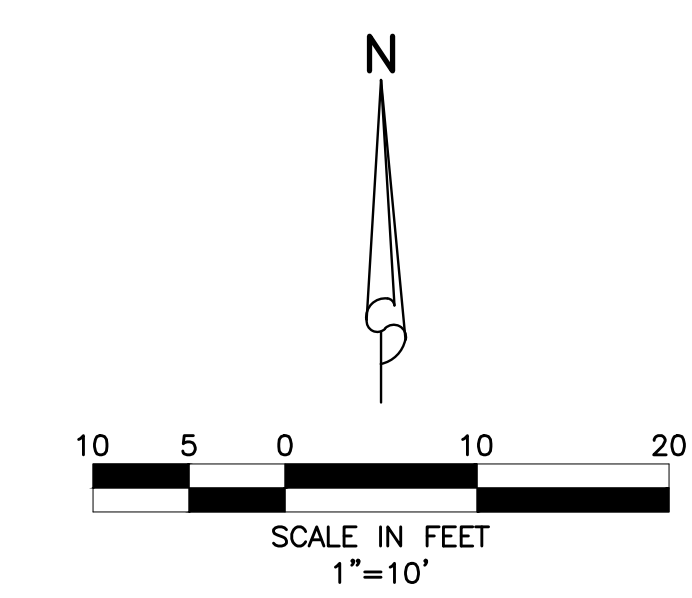

LEGEND

- *19.0 PROPOSED GRADE ELEVATION
- 13.96 EXISTING GRADE ELEVATION
- CONCRETE
- PAVER BRICK
- DETECTABLE WARNING SURFACE
- SAWCUT, REMOVE, & REPLACE EXISTING PAVEMENT, CONCRETE, CURB, ETC.
- EXISTING OVERHEAD POWER LINE & POWER POLE
- EXISTING STORM DRAINAGE PIPE (TO REMAIN)
- EXISTING WATER MAIN (TO REMAIN)
- EXISTING SEWER MAIN (TO REMAIN)
- EXISTING FORCE MAIN (TO REMAIN)

- STRIPING KEY**
- A - 6" SOLID WHITE
 - B - 8" SOLID WHITE
 - C - 12" SOLID WHITE
 - D - 18" SOLID WHITE
 - E - 24" SOLID WHITE
 - F - 6" SKIP WHITE TYP. (10'-30')
 - G - 6" SKIP WHITE TYP. (6'-10')
 - H - 6" SKIP WHITE TYP. (2'-4')
 - I - 6" SOLID YELLOW
 - J - 18" SOLID YELLOW
 - K - 6" DOUBLE YELLOW
 - L - 6" SKIP YELLOW TYP. (10'-30')
 - M - 6" SKIP YELLOW TYP. (6'-10')
 - N - 6" SKIP YELLOW TYP. (2'-4')
 - P - R.P.M. BI-DIRECTIONAL AMBER/AMBER
 - R - F.D.P. WHITE
 - S - F.D.P. YELLOW
 - T - R.P.M. BI-DIRECTIONAL WHITE/RED
 - U - R.P.M. BI-DIRECTIONAL RED/YELLOW
- NOTES:**
- 1.) ALL PAVEMENT MARKINGS AND REFLECTIVE PAVEMENT MARKERS SHALL BE IN ACCORDANCE WITH PALM BEACH COUNTY TYPICAL DRAWING NO. T-P-24.
 - 2.) ALL SIGNS SHOWN ARE PROPOSED UNLESS OTHERWISE NOTED.
 - 3.) F.D.P.'S SHALL BE SPACED 3' APART. WHITE SHALL BE USED.

- NOTES:**
- 1.) CONTRACTOR TO FIELD VERIFY LOCATION AND DEPTH OF ALL EXISTING UTILITIES PRIOR TO CONSTRUCTION AND NOTIFY ENGINEER OF ANY CONFLICTS. IT SHALL BE THE CONTRACTOR'S RESPONSIBILITY TO COORDINATE ALL EXISTING UTILITY LOCATES, SUPPORT, RELOCATIONS AND NOTIFICATIONS REQUIRED WITH ALL APPLICABLE UTILITY SERVICE PROVIDERS.
 - 2.) ALL STRIPING SHALL BE THERMOPLASTIC.
 - 3.) SWALE BOTTOM ELEVATION SHALL BE ADJUSTED AS NEEDED TO MAINTAIN 6" MINIMUM DEPTH TO INVERT AS MEASURED FROM ADJACENT EDGE OF PAVEMENT. CONTRACTOR SHALL NOTIFY ENGINEER OF ANY CONFLICTS PRIORI TO CONSTRUCTION.
 - 4.) CONTRACTOR SHALL BE RESPONSIBLE FOR RESTORING ALL ON-SITE & OFF-SITE AREAS DISTURBED DURING CONSTRUCTION TO EXISTING OR BETTER CONDITIONS.
 - 5.) CONTRACTOR SHALL BE RESPONSIBLE FOR ALL N.P.D.E.S. REQUIREMENTS INCLUDING FILING OF N.O.I., N.O.T., WEEKLY & MONTHLY MONITORING REPORTS, ETC.
 - 6.) CONTRACTOR SHALL BE RESPONSIBLE TO REPAIR/REPLACE EXISTING IRRIGATION LIGHTING OR OTHER PRIVATE UTILITIES IMPACTED BY PROPOSED IMPROVEMENTS. CONTRACTOR SHALL BE RESPONSIBLE TO LOCATE EXISTING FACILITIES.

48 HOURS BEFORE DIGGING
BROWARD • PALM BEACH • INDIAN RIVER
LUDDE • MARTIN COUNTIES
1-800-432-4770
SUNSHINE STATE 1 CALL
UNDERGROUND UTILITIES
NOTIFICATION CENTER

NOTE: ALL ELEVATIONS SHOWN HEREON ARE RELATIVE TO THE NORTH AMERICAN VERTICAL DATUM (N.A.V.D.) OF 1988 BASED ON A SURVEY PREPARED BY AVIROM & ASSOCIATES, INC. (772) 781-6266

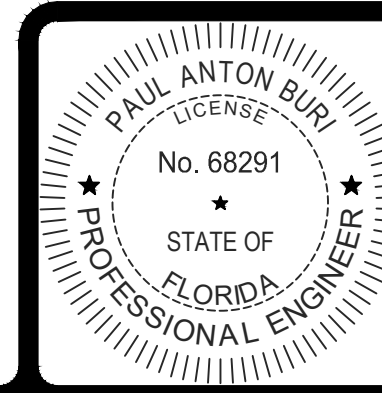

THIS ITEM HAS BEEN DIGITALLY SIGNED AND SEALED BY PAUL ANTON BUR I, P.E. ON 11/22/2024.
PRINTED COPIES OF THIS DOCUMENT ARE NOT CONSIDERED SIGNED AND SEALED AND THE SIGNATURE MUST BE VERIFIED ON ANY ELECTRONIC COPIES.

REVISIONS	
DESIGN	J.U.
DRAWN	R.W.
CHECKED	
APPROVED	
DATE	



ATLANTIC BOULEVARD
SECTION 28, TOWNSHIP 41S., RANGE 43E.
TOWN OF JUNO BEACH, FLORIDA
PAVING AND STRIPING PLAN

JOB NO.	DRAWING NO.	SHEET	OF
24-004.9	24004.9S03	3	5

GENERAL NOTES:

- NOTIFY ENGINEER OF IN-FIELD CONFLICTS OR DESIGN DISCREPANCIES PRIOR TO COMMENCEMENT OF WORK.
- EXISTING WATER, SEWER AND DRAINAGE SYSTEMS ARE REPRESENTED AS DASHED LINES AND SHALL BE VERIFIED BY CONTRACTOR.
- CONTRACTOR SHALL PROTECT ALL UTILITIES AND PUBLIC IMPROVEMENTS AND SHALL BE RESPONSIBLE FOR ALL DAMAGES CAUSED DURING CONSTRUCTION AND SHALL REPAIR SAID DAMAGES AT HIS EXPENSE. CONTRACTOR TO RESTORE ALL AREAS DISTURBED DURING CONSTRUCTION TO ORIGINAL OR BETTER CONDITION.
- SUPPORT OR THE RELOCATION OF EXISTING STREET LIGHT POLES, POWER OR TELEPHONE POLES, EXISTING UTILITIES, IRRIGATION SYSTEMS, SIDEWALKS, WALLS, ETC. NECESSARY FOR COMPLETION OF THIS WORK ARE THE RESPONSIBILITY OF THE CONTRACTOR AT HIS EXPENSE.
- INFORMATION SHOWN ON THESE DRAWINGS AS TO THE LOCATION OF EXISTING UTILITIES HAS BEEN PREPARED FROM THE MOST RELIABLE DATA AVAILABLE TO THE ENGINEER. THIS INFORMATION IS NOT GUARANTEED, HOWEVER, AND IT SHALL BE THE CONTRACTOR'S RESPONSIBILITY TO DETERMINE THE LOCATION, CHARACTER AND DEPTH OF ANY EXISTING UTILITIES. ALL "AS-BUILT" INFORMATION INCLUDING LOCATION AND ELEVATION OF UTILITY STUB-OUTS TO BE FIELD VERIFIED BY CONTRACTOR PRIOR TO COMMENCEMENT OF CONSTRUCTION OR ORDERING OF STRUCTURES. NOTIFY ENGINEER OF DISCREPANCIES/CONFLICTS.
- THE CONTRACTOR SHALL VERIFY ALL DIMENSIONS WITH IN FIELD PRIOR TO COMMENCEMENT AND NOTIFY THE ENGINEER OF ANY DEVIATIONS PRIOR TO COMMENCING CONSTRUCTION.
- SIDEWALKS TO BE FLUSH WITH YARD AREAS UNLESS OTHERWISE NOTED.
- ALL ELEVATIONS SHOWN HEREON REFER TO N.A.V.D. 1988 TOPOGRAPHIC AND BOUNDARY SURVEY PROVIDED BY AVIROM & ASSOCIATES, INC. (772) 781-6266.
- CONTRACTOR SHALL PROVIDE ADEQUATE EQUIPMENT FOR THE REMOVAL OF STORM, SURFACE AND/OR SUBSURFACE WATER WHICH MAY ACCUMULATE IN THE EXCAVATION AREAS SO THAT IT WILL BE SUITABLY DRY FOR WORK REQUIRED.
- NO OFF-SITE DISCHARGE FROM DEWATERING OPERATIONS SHALL BE PERMITTED UNLESS THE CONTRACTOR SECURES WRITTEN PERMISSION FROM THE GOVERNING AUTHORITIES.
- ALL SUB-BASE UNDER ROADWAYS, PARKING LOTS, CURBS, ETC. SHALL BE COMPACTED TO NOT LESS THAN 98% OF MAXIMUM DENSITY AS DETERMINED BY A.A.S.H.T.O. T-180 PROCTOR.
- WHERE ENCOUNTERED (OR SPECIFIED IN THE GEOTECHNICAL REPORT), MUCK/UNSUITABLE MATERIALS SHALL BE COMPLETELY REMOVED FROM PROPOSED PAVING AND BUILDING AREAS 10 FEET BEYOND THE EDGE OF PAVEMENT/BUILDING PAD EACH SIDE.
- CONTRACTOR TO PROVIDE TEST REPORTS FROM AN INDEPENDENT LABORATORY FOR PROCTORS AND DENSITIES ON BASE AND SUBGRADE.
- CONTRACTOR IS RESPONSIBLE FOR PROVIDING COMPLETE CONSTRUCTION RECORD INFORMATION TO THE ENGINEER.
- CONTRACTOR SHALL ARRANGE FOR THE ENGINEER TO OBSERVE:
 - STRINGLINING OF SUBGRADE.
 - STRINGLINING/BOARDING OF BASE.
- THE CONTRACTOR SHALL FILL AND FINE GRADE ALL PLANTING AREAS, LEAVING THE FINISHED GRADE SMOOTH AND READY TO RECEIVE SOD OR OTHER PLANTING MATERIAL. WHERE SOD IS DESIRED, THE FINISHED GRADES SHALL BE TWO (2) INCHES LOWER TO ALLOW FOR THICKNESS OF THE GRASS. SPECIAL ATTENTION SHALL BE GIVEN ALONG EDGE OF PAVEMENT AND SIDEWALKS SO AS NOT TO TRAP WATER.
- ANY SHELLROCK OR LIMESTONE PAVING BASE INSTALLED WITHIN PLANTING AREAS SHALL BE REMOVED IN ITS ENTIRETY PRIOR TO PLACING PLANTER AREA FILL.
- ALL SWALE, RIGHT OF WAY AREAS AND YARD AREAS SHALL BE GRADED AND SEEDED OR SODDED IN ACCORDANCE WITH GOVERNING AGENCY STANDARDS. NO AREAS SHALL BE LEFT BARREN OR SUBJECT TO EROSION.
- CONTRACTOR SHALL ENSURE NO SEDIMENT OR DEBRIS LEAVES THE SITE DURING CONSTRUCTION IN ACCORDANCE WITH N.P.D.E.S. REQUIREMENTS (SILT FENCE, HAY BALES OR SOD APRONS AT INLETS, WASH ROCK EXIT, ETC. MAY BE REQUIRED TO MEET SAID REQUIREMENTS). CONTRACTOR SHALL BE RESPONSIBLE FOR THE PREPARATION, IMPLEMENTATION AND CERTIFICATION OF ALL N.P.D.E.S. POLLUTION PREVENTION RELATED MEASURES (i.e. FILING OF AN N.O.I. POLLUTION PREVENTION PLAN MONITORING REPORTS, ETC.)
- CONTRACTOR SHALL CONTACT PALM BEACH COUNTY TRAFFIC OPERATIONS AT (561) 233-3900) 48 HOURS PRIOR TO CONSTRUCTION, IF ANY WORK IS BEING DONE WITHIN 10 FEET OF A SIGNALIZED INTERSECTION.
- ANY DAMAGE TO PBC-TRAFFIC I.T.S. FACILITIES CAUSED BY CONSTRUCTION OF THIS PROJECT MUST BE REPAIRED OR REPLACED TO ORIGINAL OR BETTER CONDITION BY THE PERMITEE AT NO COST TO PALM BEACH COUNTY.
- PALM BEACH COUNTY (PBC) RESERVES THE RIGHT TO DETERMINE IF DAMAGED PBC FACILITIES WILL BE REPAIRED OR REPLACED.
- CONSTRUCTION TESTING REQUIREMENTS:
 - DENSITY, THICKNESS AND F.B.V./L.B.R. FOR BASE AND SUBGRADE
 - ROADS - MAXIMUM SPACING = 500 L.F.
 - PARKING LOT - MAXIMUM SPACING = 6,000 S.F.
 - ASPHALT THICKNESS
 - ROADS - MAXIMUM SPACING = 600 L.F.
 - PARKING LOT - MAXIMUM SPACING = 2,000 S.F.

TESTING SHALL BE TAKEN IN A STAGGERED PATTERN, UNLESS OTHERWISE DIRECTED BY THE ENGINEER.
THERE SHALL BE A MINIMUM OF 4 EACH OF THE ABOVE TESTS FOR A PROJECT OR PORTION THEREOF.

- BASE - CHEMICAL AND SIEVE ANALYSIS, FROM SUPPLIER/PIT (DOT CERTIFICATION)
- ASPHALT - DESIGN MIX. IF REQUESTED BY THE ENGINEER, STABILITY TESTS WILL BE REQUIRED.

- PIPELINE BACKFILL DENSITY TESTS
 - ALL PIPE AND STRUCTURE TRENCHES SHALL BE BACKFILLED USING A MAX. OF 12" LIFTS. ALL BACKFILL MATERIAL SHALL BE CLEAN, DRY STRUCTURAL FILL, WITH NO DELETERIOUS OR ORGANIC MATERIAL PRESENT.
 - AT LEAST ONE TEST SHALL BE PERFORMED FOR EVERY 12" OF DEPTH, STARTING AT THE SPRINGLINE OF THE PIPE, COVERING THE 12" LAYER BELOW THE SPRINGLINE OF THE PIPE.
 - PIPE TRENCHES SHALL BE TESTED AT RANDOMLY SELECTED LOCATIONS ALONG THE LENGTH OF EACH PIPE RUN WITHIN EACH 300' INTERVAL (MAXIMUM) AND BETWEEN EACH SET OF TWO STRUCTURES IF A PIPE RUN SEPARATING THE TWO IS LESS THAN 300' IN LENGTH.
 - TESTS SHALL BE PERFORMED AT EVERY STRUCTURE BEGINNING AT THE BASE OF THE STRUCTURE (COVERING THE 12" BELOW THE BASE OF THE STRUCTURE) WITH ONE TEST FOR EVERY 12" LIFT. TESTS SHALL ALTERNATE FROM CORNER TO CORNER OR FROM SIDE TO SIDE AROUND THE STRUCTURE WITH EACH 12" LIFT.
 - WHERE OUTSIDE PAVED AREAS BY 10' OR MORE, ALL TESTS SHALL BE TAKEN WITHIN THE BOTTOM 3' OF TRENCH AND ONLY 1 TEST PER 300 L.F. IS REQUIRED.

MINIMUM SPACING REQUIREMENTS:

DEPTH OF CUT	SPACING OF TESTS
0 - 6'	1 PER 300 L.F.
6 - 9'	2 PER 300 L.F.
9 - 12'	3 PER 300 L.F.
12 - 15'	4 PER 300 L.F.
15 - 18'	5 PER 300 L.F.

THE ABOVE REQUIREMENTS ARE THE MINIMUM AND ARE SUBJECT TO INCREASE BY THE GOVERNING AGENCIES. ALL TESTS AND LOCATIONS ARE SUBJECT TO REVIEW BY ENGINEER AND/OR GOVERNING AGENCIES. ADDITIONAL TESTS MAY BE REQUIRED BASED ON FIELD OBSERVATIONS OF CONSTRUCTION TECHNIQUES OR MATERIALS USED ON SITE.

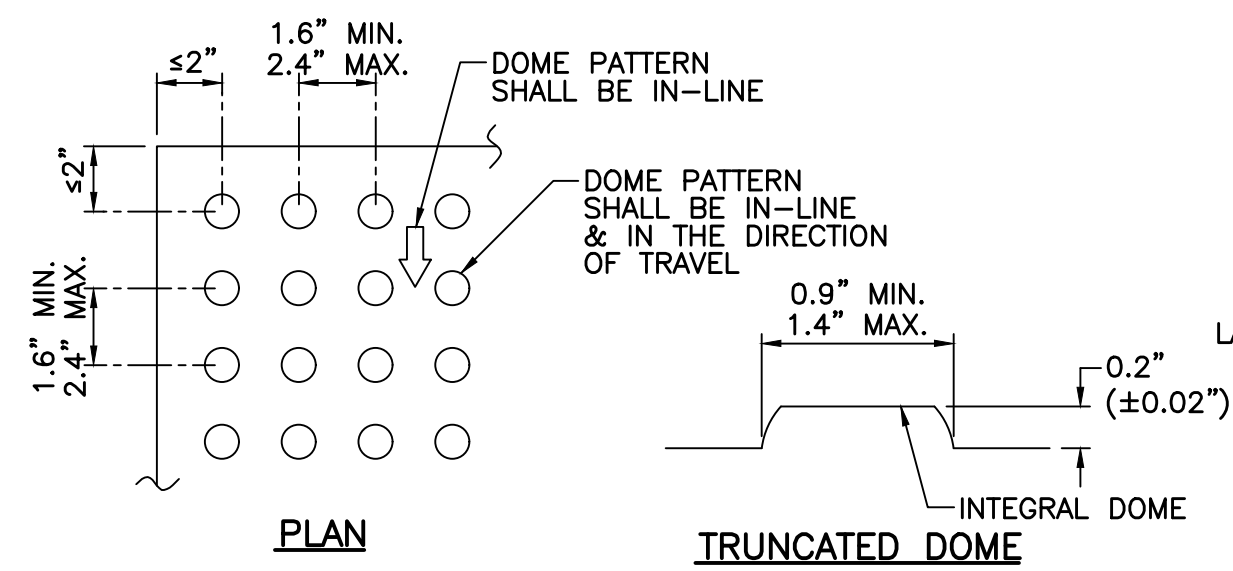

HANDICAP RAMP DETAIL (CR-C)
NOT TO SCALE

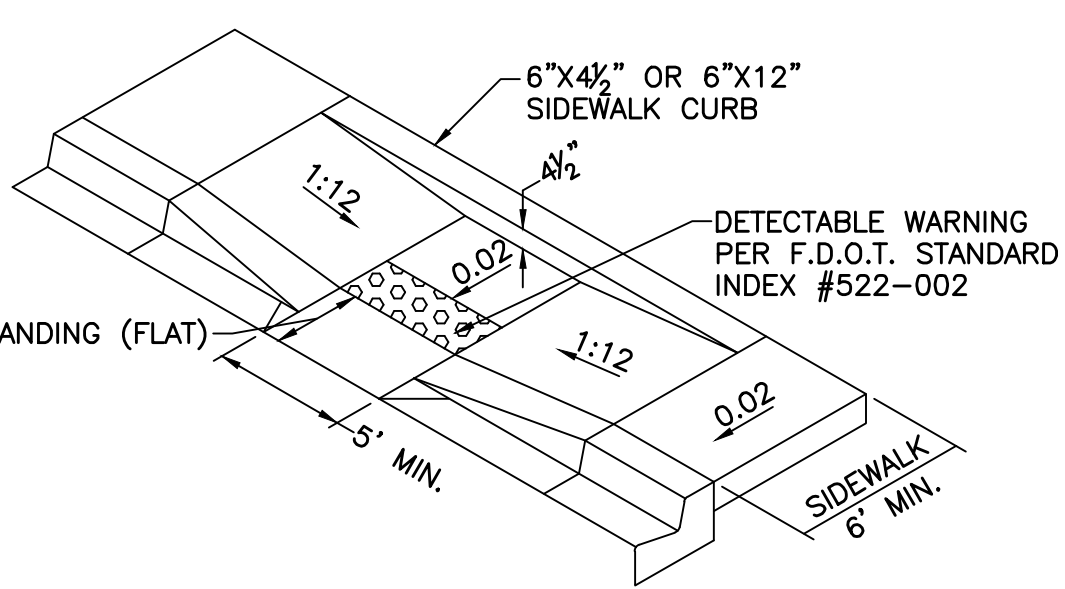

TYPICAL HANDICAP RAMP DETAILS
NOT TO SCALE

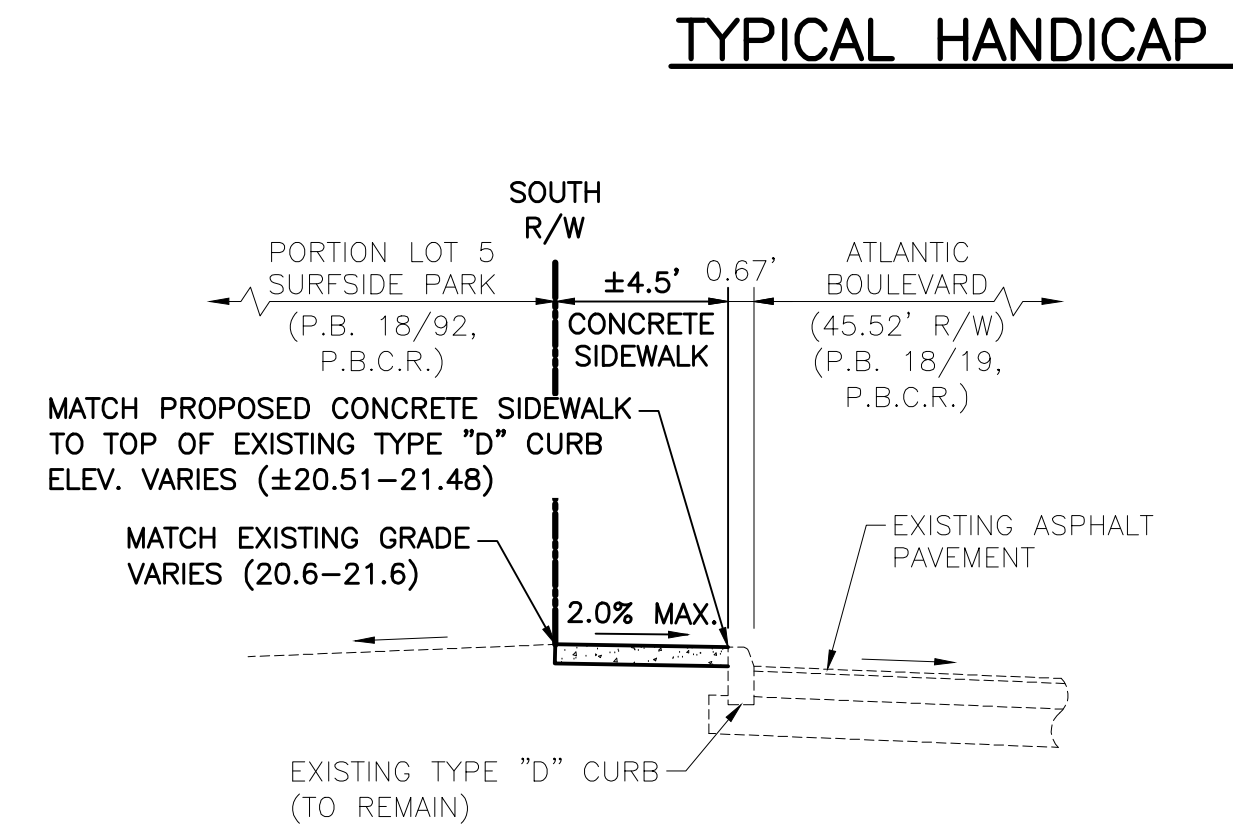

TYPICAL SECTION A-A
NOT TO SCALE

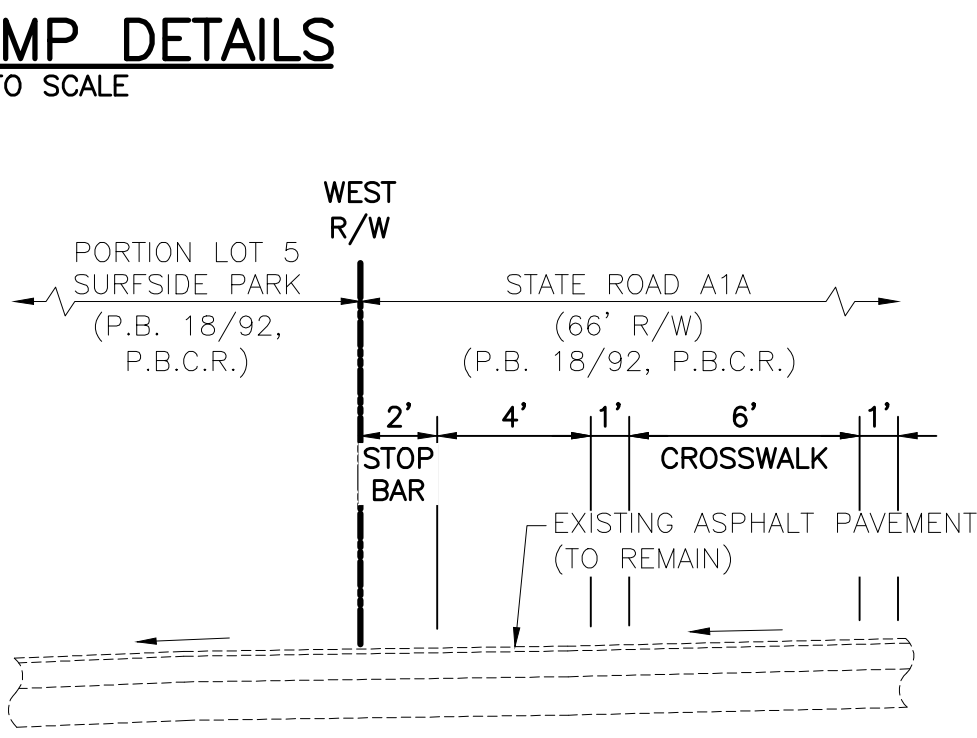

TYPICAL SECTION B-B
NOT TO SCALE

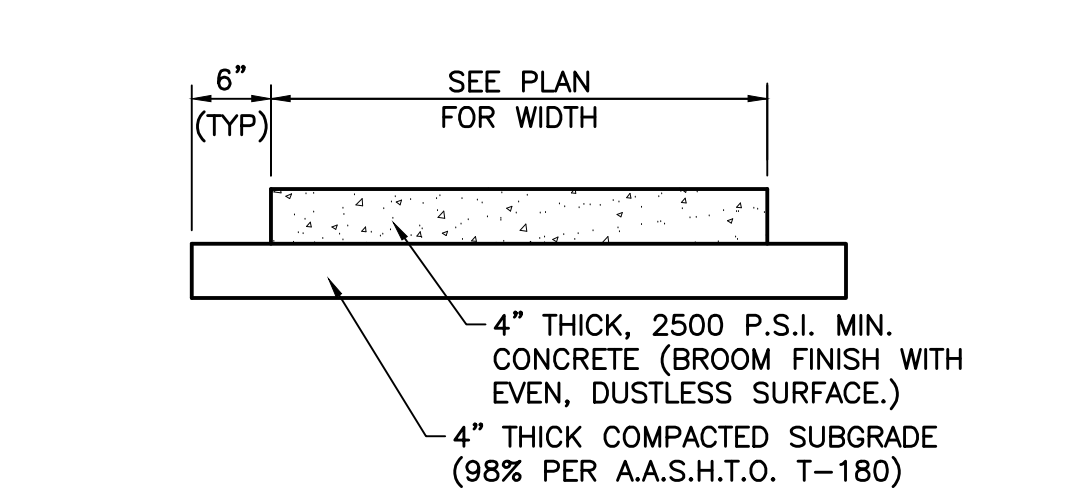

TYPICAL SIDEWALK DETAIL
NOT TO SCALE

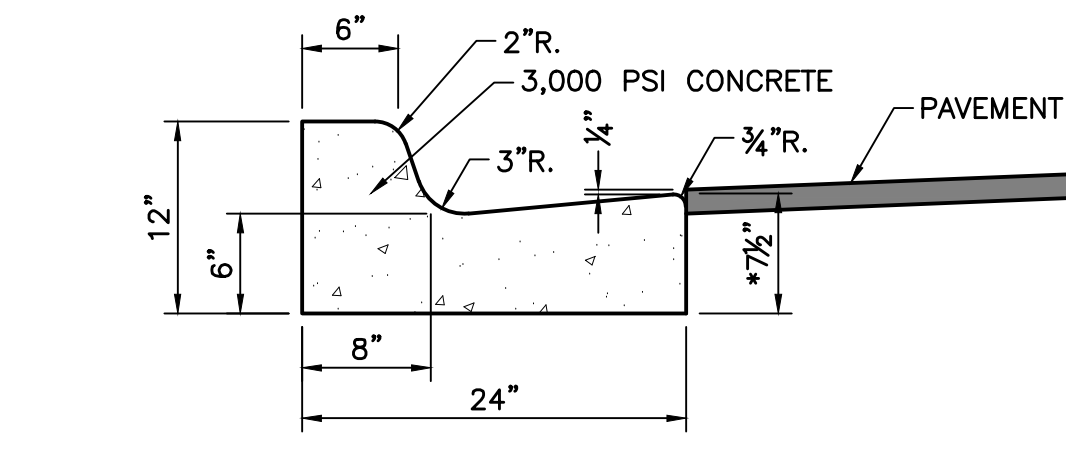

***NOTE:** WHEN USED ON HIGH SIDE OF ROADWAY, THE CROSS-SLOPE OF THE GUTTER SHALL MATCH THE CROSS-SLOPE OF THE ADJACENT PAVEMENT AND THE THICKNESS OF THE LIP SHALL BE 6", UNLESS OTHERWISE SHOWN ON PLANS

TYPE "F" CURB
NOT TO SCALE

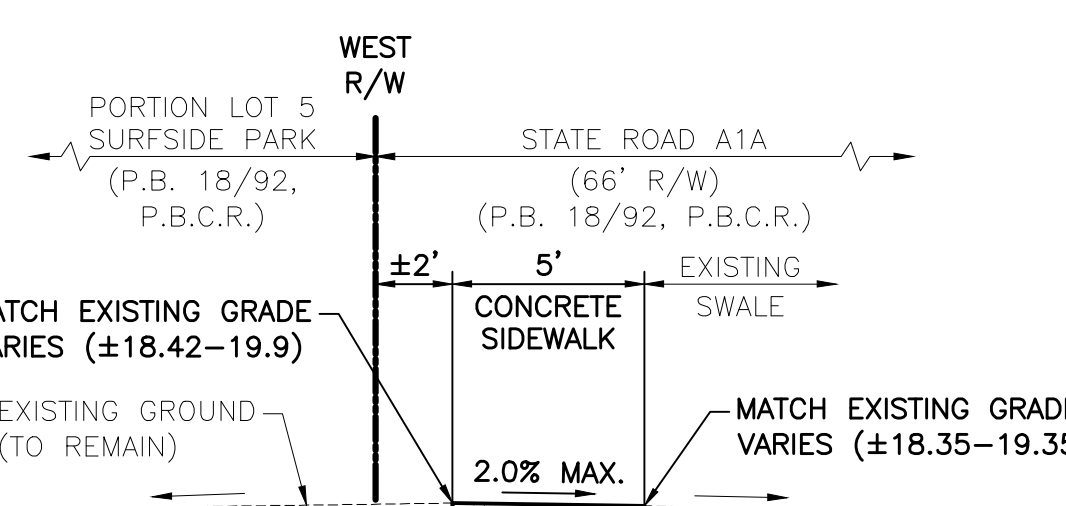

TYPICAL SECTION C-C
NOT TO SCALE

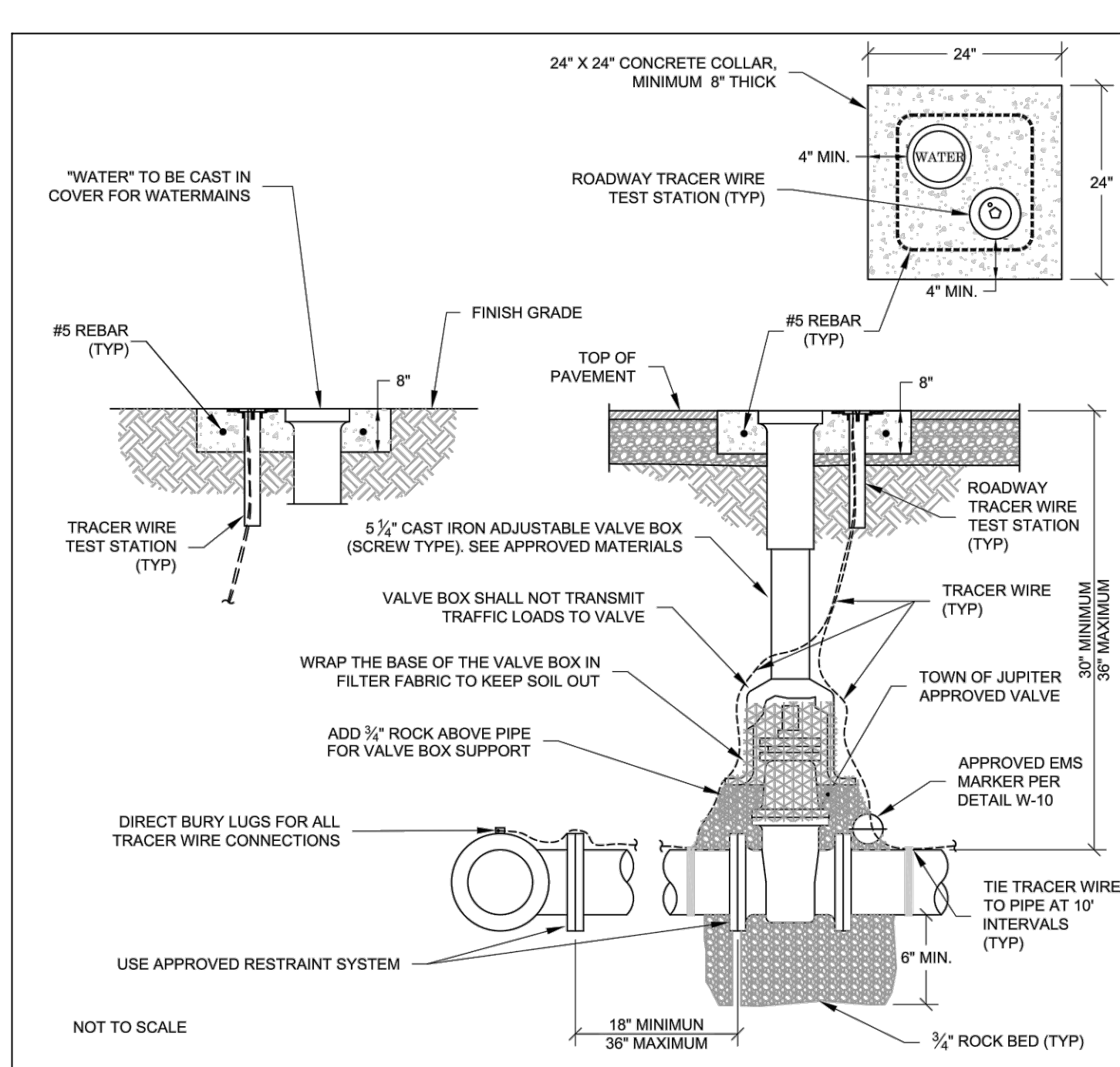

- NOTES:**
- CONCRETE COLLAR MAY NOT BE REQUIRED IN PAVED AREAS IF PAVEMENT SURFACE IS FINISHED PRIOR TO CONDITIONAL FINAL INSPECTION AND VALVE BOX LID IS AT FINISHED GRADE.
 - WHEN VALVE IS DEEPER THAN 36" AN EXTENSION WILL BE REQUIRED TO BRING OPERATING NUT TO +/- 24" OF FINISHED GRADE. EXTENSION MUST BE SET SCREW TYPE AND ATTACHED TO OPERATING NUT.
 - TRACER WIRE SHALL BE USED ON NON-DUCTILE PIPE ONLY. TRACER WIRE MATERIAL SHALL BE COPPERHEAD INDUSTRIES, LLC OR APPROVED EQUAL. INSTALLATION AND TESTING SHALL BE IN ACCORDANCE WITH THE MANUFACTURERS RECOMMENDATIONS. TRACER WIRE MATERIAL SHALL BE AS FOLLOWS:
 - ROADWAY TRACER WIRE TEST STATION SHALL BE COPPERHEAD PART NUMBER RB148TP OR APPROVED EQUAL.
 - TRACER WIRE TEST STATION SHALL BE COPPERHEAD PART NUMBER LD148TP OR APPROVED EQUAL.
 - DIRECT BURY LUGS SHALL BE COPPERHEAD SNAKEBITE DRYCON DIRECT BURY LUG AQUA OR APPROVED EQUAL.
 - TRACER WIRE SHALL BE COPPERHEAD INDUSTRIES, LLC PART NUMBER 1430-HS OR APPROVED EQUAL.
 - TRACER WIRE SHALL BE COPPERHEAD ANODE PART NUMBER ANO-1005 OR APPROVED EQUAL.
 - ABOVE GROUND TEST STATION SHALL BE COPPERHEAD INDUSTRIES, LLC PART NUMBER T1-B75 OR APPROVED EQUAL.

TYPICAL UNDERGROUND VALVE INSTALLATION
DATE: 12/2021
DRAWING NO.: W-06

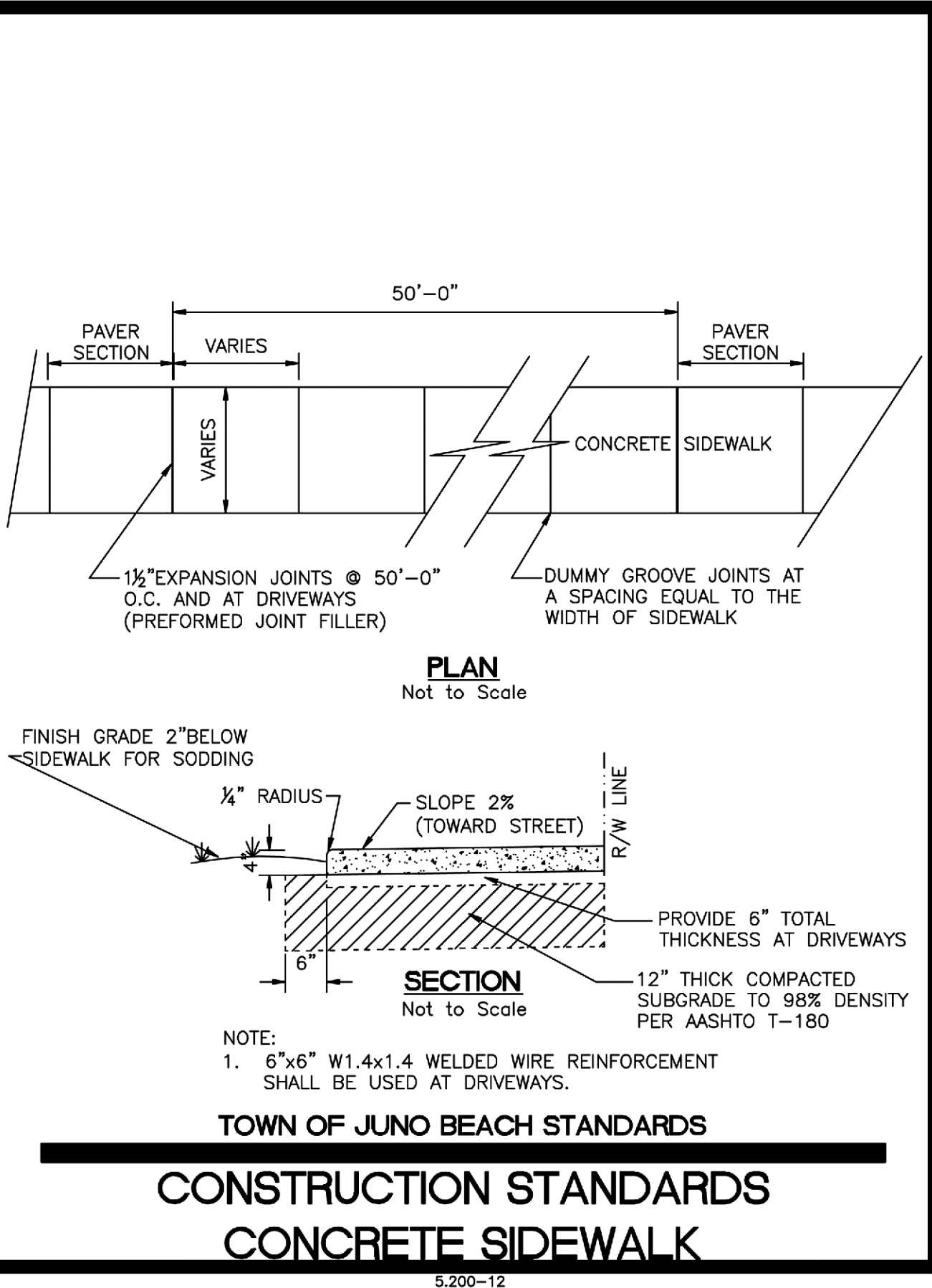

**CONSTRUCTION STANDARDS
CONCRETE SIDEWALK**

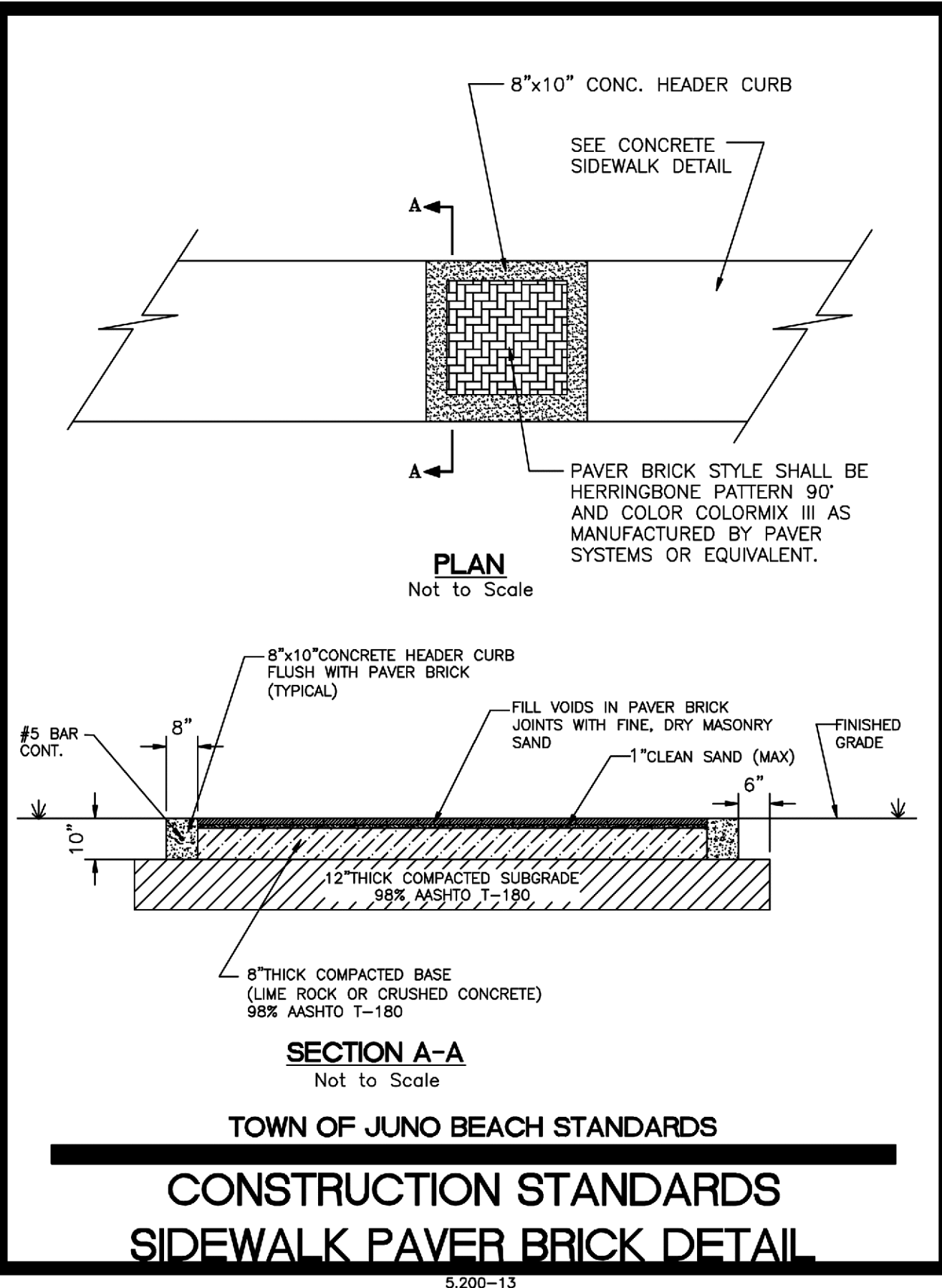

**CONSTRUCTION STANDARDS
SIDEWALK PAVER BRICK DETAIL**

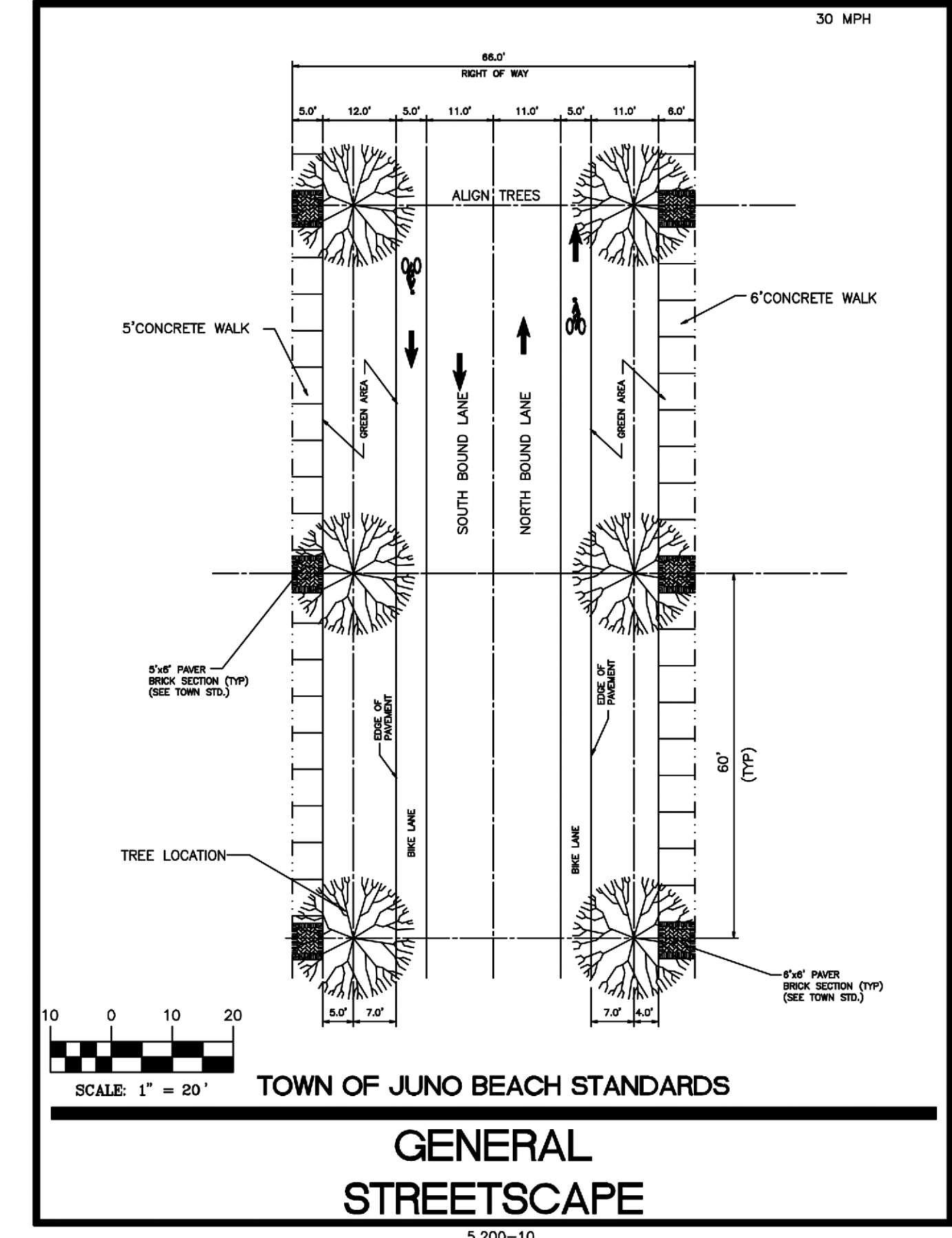

**GENERAL
STREETSCAPE**

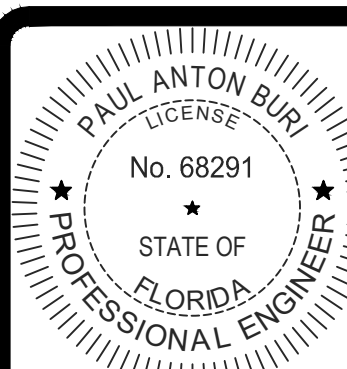

THIS ITEM HAS BEEN DIGITALLY SIGNED AND SEALED BY PAUL ANTON BUR I, P.E. ON 11/22/2024.
PRINTED COPIES OF THIS DOCUMENT ARE NOT CONSIDERED SIGNED AND SEALED AND THE SIGNATURE MUST BE VERIFIED ON ANY ELECTRONIC COPIES.

1.) ADDED "CONCRETE SIDEWALK", "SIDEWALK PAVER BRICK" & "STREETSCAPE" DETAILS PER TOWN OF JUNO BEACH COMMENTS, 11/22/24 D.B.



ATLANTIC BOULEVARD
SECTION 28, TOWNSHIP 41S., RANGE 43E.
TOWN OF JUNO BEACH, FLORIDA
PAVING AND STRIPING DETAILS

DESIGN	DRAWN	CHECKED	APPROVED	DATE	JOB NO.	DRAWING NO.	SHEET	OF
J.U.	R.W.				24-004.9	24004.9S04	4	5



LOCATION MAP
NOT TO SCALE

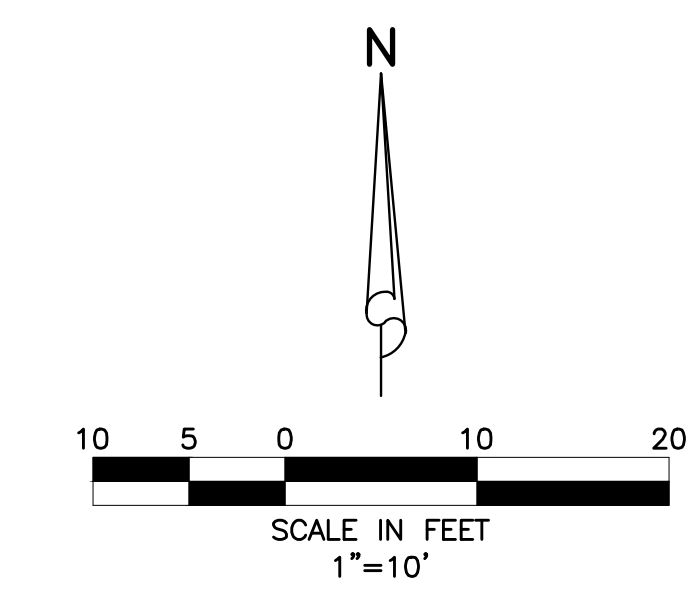

LEGEND

—○— SILT FENCE

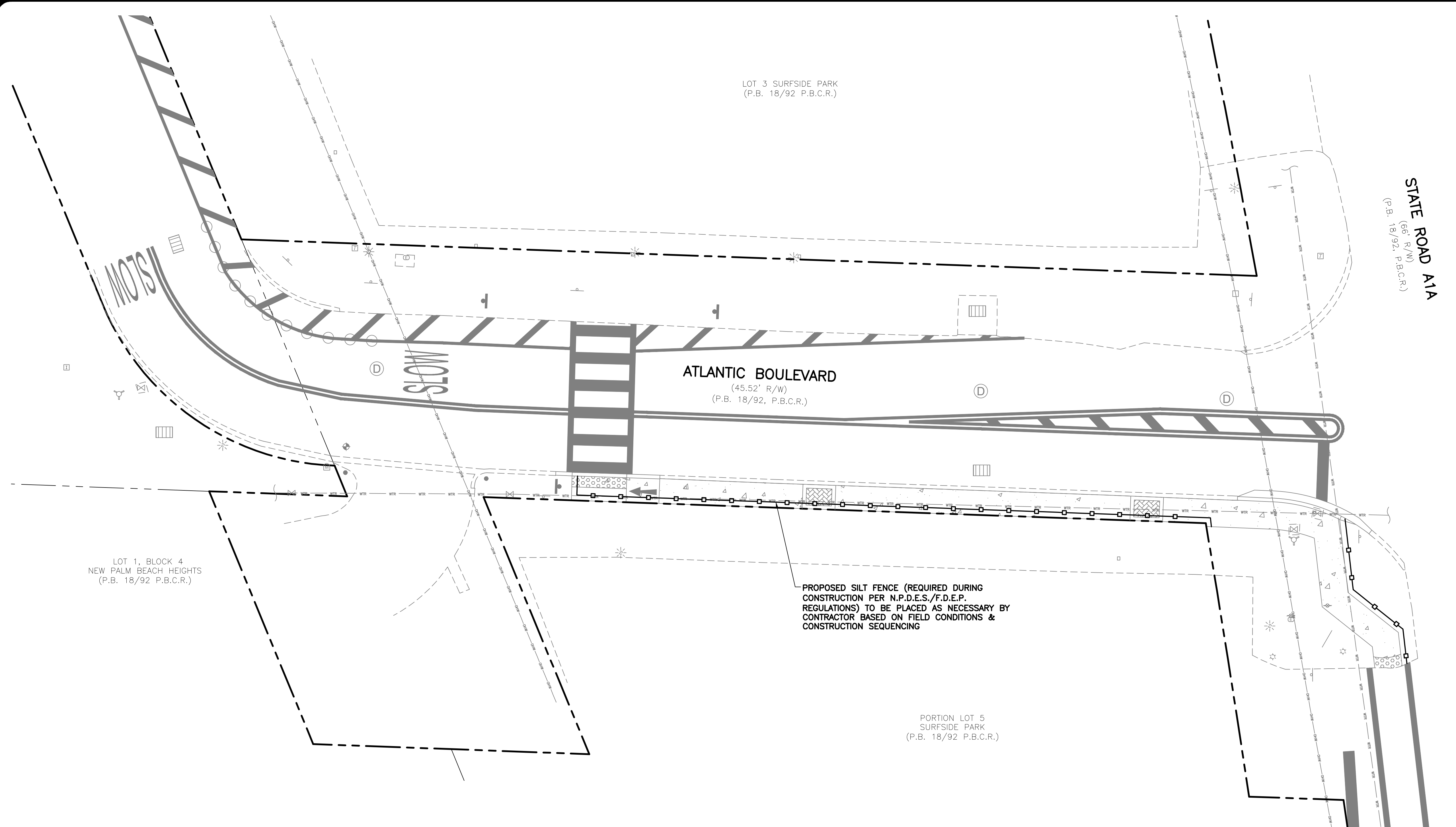

PROPOSED SILT FENCE (REQUIRED DURING CONSTRUCTION PER N.P.D.E.S./F.D.E.P. REGULATIONS) TO BE PLACED AS NECESSARY BY CONTRACTOR BASED ON FIELD CONDITIONS & CONSTRUCTION SEQUENCING

SILT FENCE (TYP.)

POLLUTION PREVENTION NOTES:

- 1.) THIS PLAN SHOULD BE USED AS A GUIDE, A COMPLETE STORMWATER POLLUTION PLAN SHOULD BE DEVELOPED BY THE CONTRACTOR TO MEET OR EXCEED F.D.E.P. REQUIREMENTS.
- 2.) CONTRACTOR IS RESPONSIBLE TO ENSURE THAT NO DIRT BE TRACKED OFF-SITE OR LEAVES THE SITE BY WIND, RUNOFF, OR OTHER MEANS.
- 3.) CONTRACTOR SHALL BE RESPONSIBLE FOR ALL N.P.D.E.S. REQUIREMENTS INCLUDING FILING OF N.O.I., MONITORING REPORTS AND N.O.T.
- 4.) POLLUTION PREVENTION MEASURES SHALL CONSIST OF, BUT NOT LIMITED TO, THE FOLLOWING:
 - A. CONSTRUCT WASHROCK PAD AT ALL POINTS EGRESS FOR WASHDOWN OF TRUCK TIRES.
 - B. CONSTRUCT EROSION CONTROL FENCE AND/OR TURBIDITY SCREENS ALONG PROPERTY LINES AS NEEDED.
 - C. NO AREA SHALL BE LEFT BARREN OR SUBJECT TO EROSION DURING CONSTRUCTION. SEEDING AND MULCHING IS REQUIRED FOR ANY AREAS ANTICIPATED TO BE BARREN DURING CONSTRUCTION FOR MORE THAN 15 DAYS.
 - D. TURBIDITY BARRIERS TO BE UTILIZED AT PROJECT OUTFALL.
 - E. OTHER MEASURES AS DIRECTED BY THE ENGINEER OR TOWN OF JUNO BEACH.
- 5.) IT IS THE CONTRACTORS RESPONSIBILITY TO COMPLY WITH ALL LOCAL, STATE AND FEDERAL POLLUTION PREVENTION REQUIREMENTS. FOR AFFECTED AREAS GREATER THAN 1 ACRE, COMPLIANCE SHALL INCLUDE (BUT IS NOT LIMITED TO) THE FOLLOWING:
 - A. PREPARATION OF A STORMWATER POLLUTION PREVENTION PLAN (S.W.P.P.) IN ACCORDANCE WITH THE D.E.P. "GENERIC PERMIT FOR STORMWATER DISCHARGE FROM LARGE AND SMALL CONSTRUCTION ACTIVITIES" (D.E.P. DOCUMENT NO. 62-621.300(4)(A))
 - B. SUBMITTAL OF THE NOTICE OF INTENT (N.O.I.) TO THE D.E.P.
 - C. MAINTENANCE AND INSPECTION OF THE ELEMENTS OF THE S.W.P.P.
 - D. MAINTENANCE OF RECORDS (INSPECTION REPORTS, N.O.I, S.W.P.P., ETC.)
 - E. SUBMITTAL OF THE NOTICE OF TERMINATION TO THE D.E.P. AT THE CONCLUSION OF THE PROJECT.
- 6.) PROPOSED SILT FENCE (REQUIRED DURING CONSTRUCTION PER N.P.D.E.S./F.D.E.P. REGULATIONS) TO BE PLACED AS NECESSARY BY CONTRACTOR BASED ON FIELD CONDITIONS & CONSTRUCTION SEQUENCING.

SILT FENCE NOTES:

- 1.) THE HEIGHT OF A SILT FENCE SHALL NOT EXCEED 36 INCHES (90 CM).
- 2.) THE FILTER FABRIC SHALL BE PURCHASED IN A CONTINUOUS ROLL CUT TO THE LENGTH OF THE BARRIER TO AVOID THE USE OF JOINTS.
- 3.) POSTS SHALL BE SPACED A MAXIMUM OF 10 FEET (3 M) APART AT THE BARRIER LOCATION AND DRIVEN SECURELY INTO THE GROUND A MINIMUM OF 12 INCHES (30 CM). WHEN EXTRA STRENGTH FABRIC IS USED WITHOUT THE WIRE SUPPORT FENCE, POST SPACING SHALL NOT EXCEED 6 FEET (1.8 M).
- 4.) A TRENCH SHALL BE EXCAVATED APPROXIMATELY 4 INCHES (10 CM) WIDE AND 4 INCHES (10 CM) DEEP ALONG THE LINE OF POSTS AND UPSLOPE FROM THE BARRIER.
- 5.) WHEN STANDARD STRENGTH FILTER FABRIC IS USED. A WIRE MESH SUPPORT FENCE SHALL BE FASTENED SECURELY TO THE UPSLOPE SIDE OF THE POSTS USING HEAVY DUTY WIRE STAPLES AT LEAST 1 INCH (25 MM) LONG, TIE WIRES, OR HOG RINGS. THE WIRE SHALL EXTEND INTO THE TRENCH A MINIMUM OF 2 INCHES (5 CM) AND SHALL NOT EXTEND MORE THAN 36 INCHES (90 CM) ABOVE THE ORIGINAL GROUND SURFACE.
- 6.) THE STANDARD STRENGTH FILTER FABRIC SHALL BE STAPLED OR WIRED TO THE FENCE, AND 8 INCHES (20 CM) OF THE FABRIC SHALL BE EXTENDED INTO THE TRENCH. THE FABRIC SHALL NOT EXTEND MORE THAN 36 INCHES (90 CM) ABOVE THE ORIGINAL GROUND SURFACE.
- 7.) THE TRENCH SHALL BE BACKFILLED AND THE SOIL COMPACTED OVER THE FILTER FABRIC.
- 8.) PROPOSED SILT FENCE (REQUIRED DURING CONSTRUCTION PER N.P.D.E.S./F.D.E.P. REGULATIONS) TO BE PLACED AS NECESSARY BY CONTRACTOR BASED ON FIELD CONDITIONS AND CONSTRUCTION SEQUENCING.

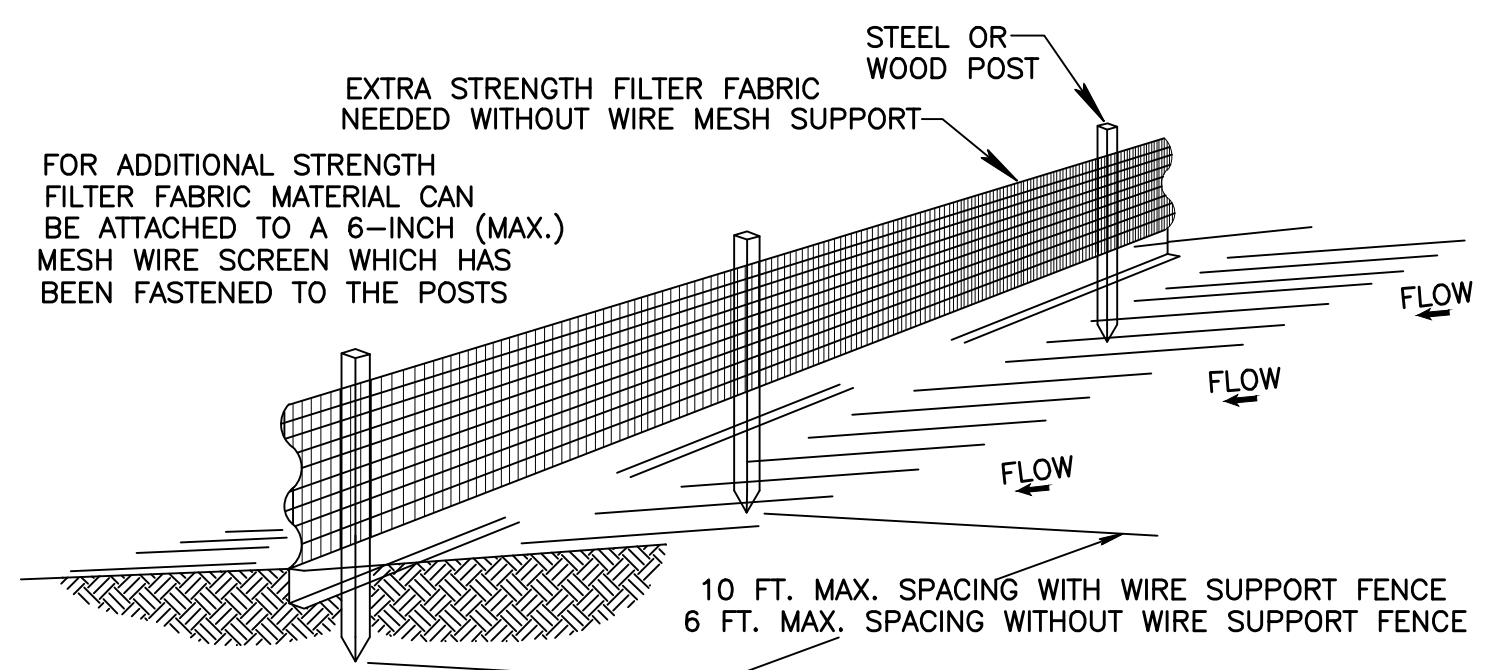

SILT FENCE INSTALLATION DETAIL
NOT TO SCALE.

48 HOURS BEFORE DIGGING
BROWARD • PALM BEACH • INDIAN RIVER
ST. LUCIE • MARTIN COUNTIES
CALL TOLL FREE
1-800-432-4770
SUNSHINE STATE 1 CALL
UNDERGROUND UTILITIES
NOTIFICATION CENTER

NOTE: ALL ELEVATIONS SHOWN HEREON ARE RELATIVE TO THE NORTH AMERICAN VERTICAL DATUM (N.A.V.D.) OF 1988 BASED ON A SURVEY PREPARED BY AVIROM & ASSOCIATES, INC. (772) 781-6266

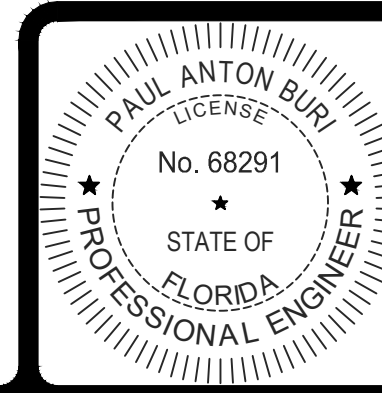

THIS ITEM HAS BEEN DIGITALLY SIGNED AND SEALED BY PAUL ANTON BUR I, P.E. ON 11/22/2024.
PRINTED COPIES OF THIS DOCUMENT ARE NOT CONSIDERED SIGNED AND SEALED AND THE SIGNATURE MUST BE VERIFIED ON ANY ELECTRONIC COPIES.

REVISIONS	
DESIGN	J.U.
DRAWN	R.W.
CHECKED	
APPROVED	
DATE	

SIMMONS & WHITE
2581 Metrocentre Blvd West, Ste 3 | West Palm Beach, FL 33407
Authorization # 3452 | 561.478.7848

ATLANTIC BOULEVARD	
SECTION 28, TOWNSHIP 41S., RANGE 43E.	
TOWN OF JUNO BEACH, FLORIDA	
POLLUTION PREVENTION PLAN	
JOB NO.	DRAWING NO.
24-004.9	24004.9S05
SHEET	OF
5	5