

CHARLES M. HAYS SURVEY,
SECTION NO. 2,
ABSTRACT NO. 531

CITY OF IOWA COLONY
ANNEXATION ORDINANCE NO. 73-C
VOL. 1199, PG. 804
B.C.C.O.

CITY OF IOWA COLONY
ANNEXATION ORDINANCE NO. 2021-37
CLERK'S FILE NO. 2021083573
B.C.C.O.

CITY OF IOWA COLONY
ANNEXATION ORDINANCE NO. 2021-37
CLERK'S FILE NO. 2021083573
B.C.C.O.

CITY OF IOWA COLONY
ANNEXATION ORDINANCE NO. 73-C
VOL. 1199, PG. 804
B.C.C.O.

EMIGRATION LAND COMPANY
SUBDIVISION
VOL. 2, PG. 113
B.C.P.R.

H.T. & B.R.R. CO. SURVEY,
SECTION NO. 50,
ABSTRACT NO. 512

CITY OF IOWA COLONY
ANNEXATION ORDINANCE NO. 2021-37
CLERK'S FILE NO. 2021083573
B.C.C.O.

CITY OF IOWA COLONY
ANNEXATION ORDINANCE NO. 2021-37
CLERK'S FILE NO. 2021083573
B.C.C.O.

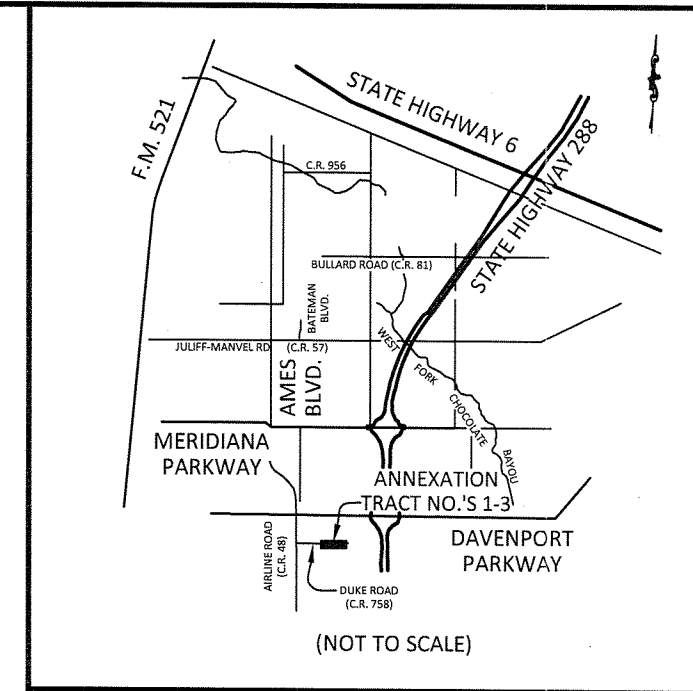
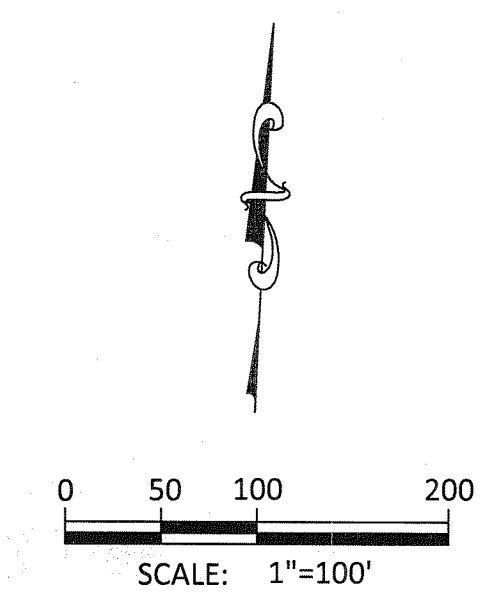

ABBREVIATIONS
B.C.C.O. BRAZORIA COUNTY CLERK'S OFFICE
B.C.P.R. BRAZORIA COUNTY PLAT RECORDS
R.O.W. RIGHT-OF-WAY

- NOTES:
1. THE BEARINGS SHOWN HEREON ARE BASED ON ORDINANCE NO. 73-C AS RECORDED IN VOLUME 1199, PAGE 804 IN THE BRAZORIA COUNTY DEED RECORDS.
 2. A SEPARATE METES AND BOUNDS DESCRIPTION HAS BEEN PREPARED IN CONNECTION WITH THIS SURVEY EXHIBIT.

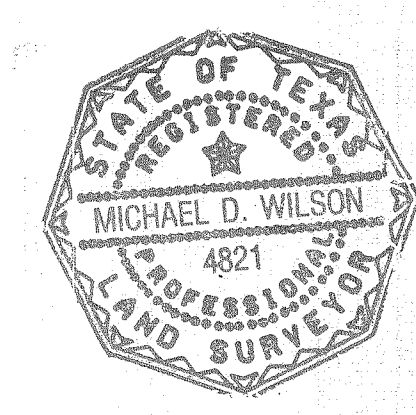

THIS DOCUMENT WAS PREPARED UNDER 22 TAC §663.21, DOES NOT REFLECT THE RESULTS OF AN ON THE GROUND SURVEY, AND IS NOT TO BE USED TO CONVEY OR ESTABLISH INTERESTS IN REAL PROPERTY EXCEPT THOSE RIGHTS AND INTERESTS IMPLIED OR ESTABLISHED BY THE CREATION OR RECONFIGURATION OF THE BOUNDARY OF THE POLITICAL SUBDIVISION FOR WHICH IT WAS PREPARED.

Michael D. Wilson
MICHAEL D. WILSON R.P.L.S.
TEXAS REGISTRATION NO. 4821
11/10/25

ANNEXATION TRACT NO. 1	
<p>THE WILSON SURVEY GROUP PROFESSIONAL LAND SURVEYORS 2006 E. BROADWAY PEARLAND, TEXAS (281) 485-3991 T.B.P.E.L.S. FIRM NO. 10014900</p>	<p>CAD FILE 25.126 (DUKE-1).dwg ORIGINAL PLOT DATE: 11/10/25 DWN C.L.H. CKD M.D.W. SCALE 1"=100' JOB NO. 25-126 SHEET 1 OF 2</p>
CITY OF IOWA COLONY	
EXHIBIT MAP OF A 0.341 ACRE DUKE ROAD (COUNTY ROAD 758) ANNEXATION TRACT IN THE H.T. & B.R.R. CO. SURVEY, SECTION 50, A-512 IN BRAZORIA COUNTY, TEXAS	