

**ABBREVIATIONS**  
 B.C.C.O. BRAZORIA COUNTY CLERK'S OFFICE  
 B.C.P.R. BRAZORIA COUNTY PLAT RECORDS  
 R.O.W. RIGHT-OF-WAY

CHARLES M. HAYS SURVEY,  
 SECTION NO. 2,  
 ABSTRACT NO. 531

H.T. & B.R.R. CO. SURVEY,  
 SECTION NO. 50,  
 ABSTRACT NO. 512

EMIGRATION LAND COMPANY  
 SUBDIVISION  
 VOL. 2, PG. 113  
 B.C.P.R.

**NOTES:**  
 1. THE BEARINGS SHOWN HEREON ARE BASED ON ORDINANCE NO. 73-C AS RECORDED IN VOLUME 1199, PAGE 804 IN THE BRAZORIA COUNTY DEED RECORDS.  
 2. A SEPARATE METES AND BOUNDS DESCRIPTION HAS BEEN PREPARED IN CONNECTION WITH THIS SURVEY EXHIBIT.

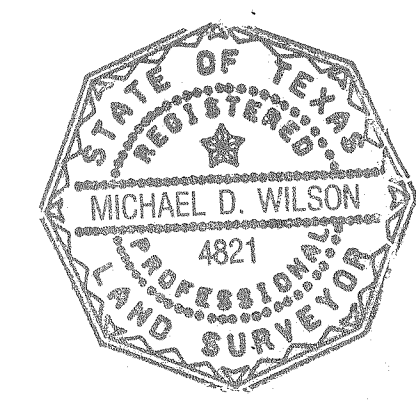

THIS DOCUMENT WAS PREPARED UNDER 22 TAC §663.21, DOES NOT REFLECT THE RESULTS OF AN ON THE GROUND SURVEY, AND IS NOT TO BE USED TO CONVEY OR ESTABLISH INTERESTS IN REAL PROPERTY EXCEPT THOSE RIGHTS AND INTERESTS IMPLIED OR ESTABLISHED BY THE CREATION OR RECONFIGURATION OF THE BOUNDARY OF THE POLITICAL SUBDIVISION FOR WHICH IT WAS PREPARED.  
*Michael D. Wilson*  
 MICHAEL D. WILSON R.P.L.S.  
 TEXAS REGISTRATION NO. 4821

11/10/25

<b>ANNEXATION TRACT NO. 1</b>	
THE WILSON SURVEY GROUP PROFESSIONAL LAND SURVEYORS 2006 E. BROADWAY PEARLAND, TEXAS (281) 485-3991 T.B.P.E.L.S. FIRM NO. 10014900	CAD FILE 25-126 (DUKE-2).dwg ORIGINAL PLOT DATE: 11/10/25 DWN C.L.H. CKD M.D.W. SCALE 1"=100' JOB NO. 25-126 SHEET <b>1</b> OF <b>2</b>
<b>CITY OF IOWA COLONY</b>	
EXHIBIT MAP OF A 0.342 ACRE DUKE ROAD (COUNTY ROAD 758) ANNEXATION TRACT IN THE H.T. & B.R.R. CO. SURVEY, SECTION 50, A-512 IN BRAZORIA COUNTY, TEXAS	