







































MARK	DATE	DESCRIPTION

PROJECT #: 23-321  
 DRAWN BY: L. WESTON  
 PROJECT MANAGER: M. TAYLOR  
 ISSUED: 1/8/2024



**PLAN & PROFILE**

**C403**

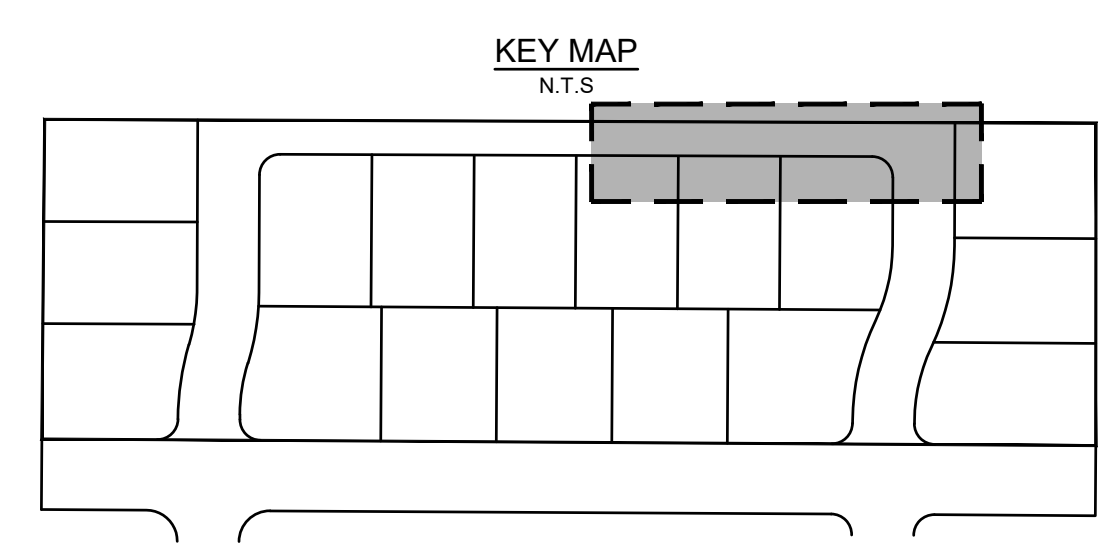
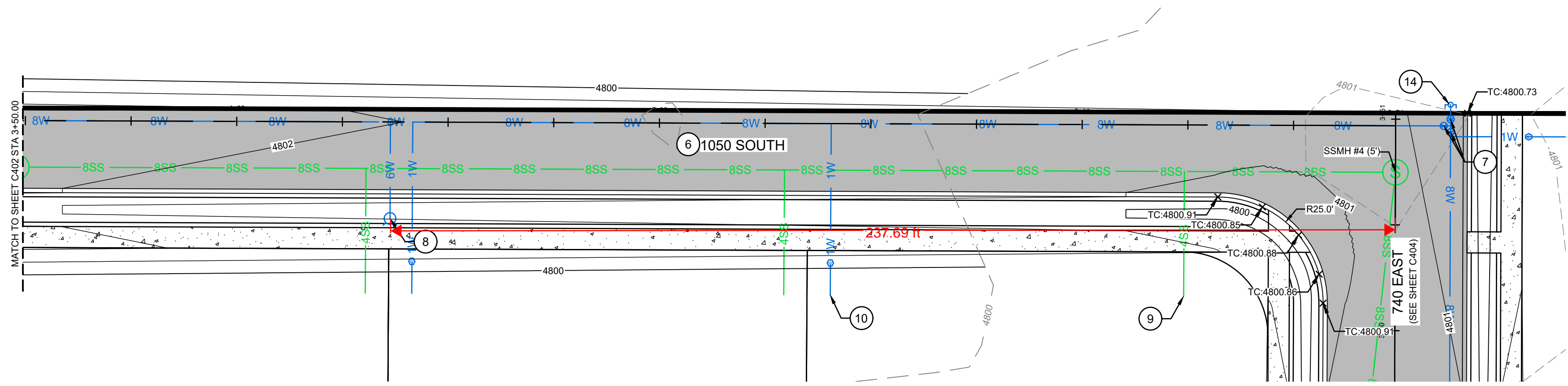

- ① SITE SHEET KEY NOTES:**  
 PROVIDE, INSTALL, AND/OR CONSTRUCT THE FOLLOWING PER THE SPECIFICATIONS GIVEN OR REFERENCED, THE DETAILS NOTED, AND/OR AS SHOWN ON THE CONSTRUCTION DRAWINGS:
- UTILITY STUB, CAP, BLOCK & MARK END OF LINE
  - RELOCATED POWER POLE
  - CONNECT TO EXISTING CULINARY WATER MAIN
  - 60-FT WIDENING ROW CROSS SECTION (1/C501)
  - 60-FT ROW CROSS SECTION (2/C501)
  - 60-FT PARTIAL WIDTH ROW CROSS SECTION (3/C501)
  - WATER VALVE (6/C501)
  - FIRE HYDRANT ASSEMBLY (3/C501)
  - 4" SANITARY SEWER SERVICE (TYP) (5/C501)
  - 1" CULINARY WATER SERVICE & METER (TYP) (2/C501)
  - CONNECT TO EXISTING SANITARY SEWER MANHOLE

- GRADING GENERAL NOTES:**
- MAINTAIN A MINIMUM OF 0.5% LONGITUDINAL SLOPE IN ALL GUTTERS.
  - MAINTAIN A MAXIMUM OF 2.0% CROSS-SLOPE ON ALL SIDEWALKS AND AT ALL BUILDING DOORWAY ENTRANCES AND EXITS.

- GRADING LEGEND:**
- FG = FINISHED GRADE
  - EG = EXISTING GRADE
  - ME = MATCH EXISTING
  - TA = TOP OF ASPHALT
  - TC = TOP OF CONCRETE
  - TBC = TOP BACK OF CURB
  - FL = FLOW LINE
  - GB = GRADE BREAK

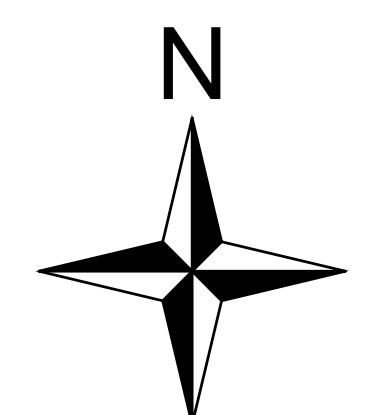

**Know what's below. 811**  
**Call 811 before you dig.**  
**BLUE STAKES OF UTAH**  
 UTILITY NOTIFICATION CENTER, INC.  
 www.bluestakes.org  
 1-800-662-4111

THESE PLANS AND SPECIFICATIONS ARE THE PROPERTY OF CIVIL SOLUTIONS GROUP, INC. AND SHALL NOT BE PHOTOCOPIED, RE-DRAWN, OR USED ON ANY OTHER PROJECT OTHER THAN THE PROJECT SPECIFICALLY DESIGNED FOR, WITHOUT WRITTEN PERMISSION. THE OWNERS AND ENGINEERS OF CIVIL SOLUTIONS GROUP, INC. DISCLAIM ANY LIABILITY FOR ANY CHANGES OR MODIFICATIONS MADE TO THESE PLANS OR THE DESIGN THEREON WITHOUT THEIR CONSENT. THESE PLANS ARE DRAWN TO SCALE WHEN PLOTTED ON A 24" X 36" SHEET OF PAPER. THESE PLANS ARE PRODUCED IN COLOR AND SHOULD BE PLOTTED AS SUCH.

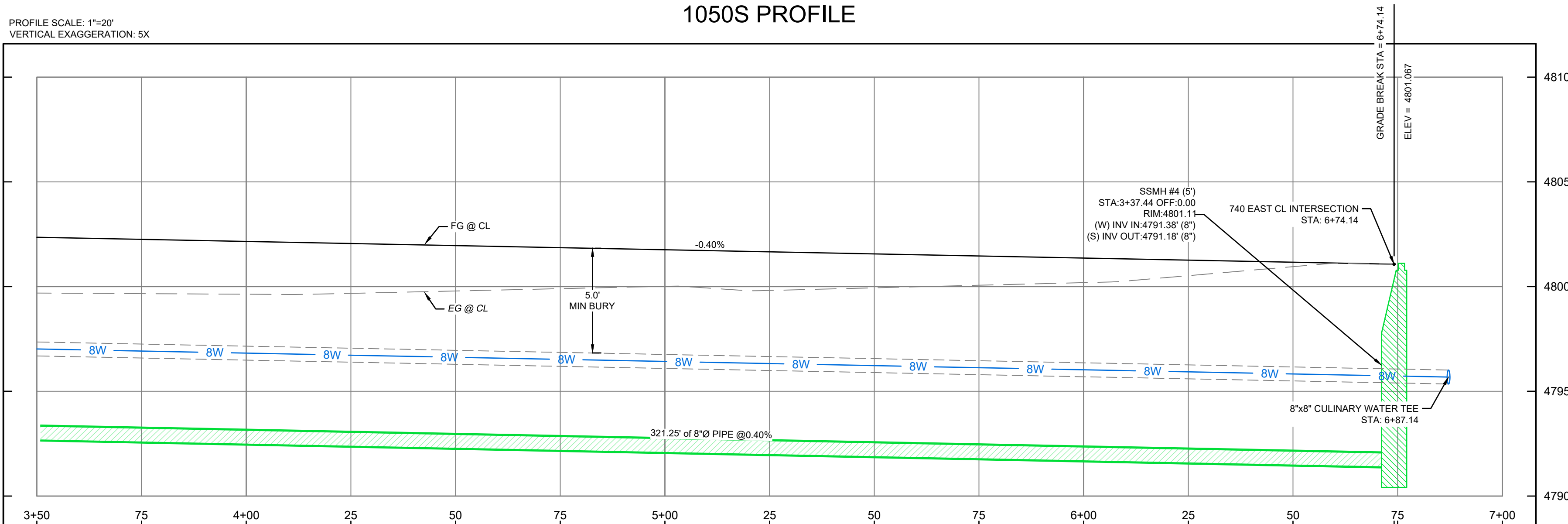















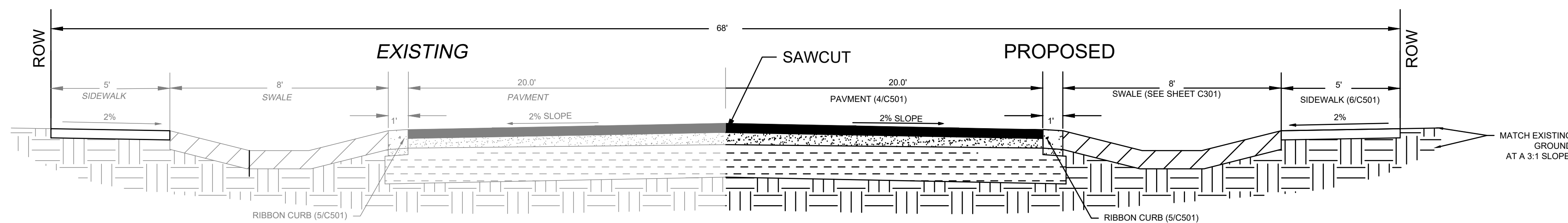

1 68' ROW CROSS SECTION  
C501  
NOT TO SCALE

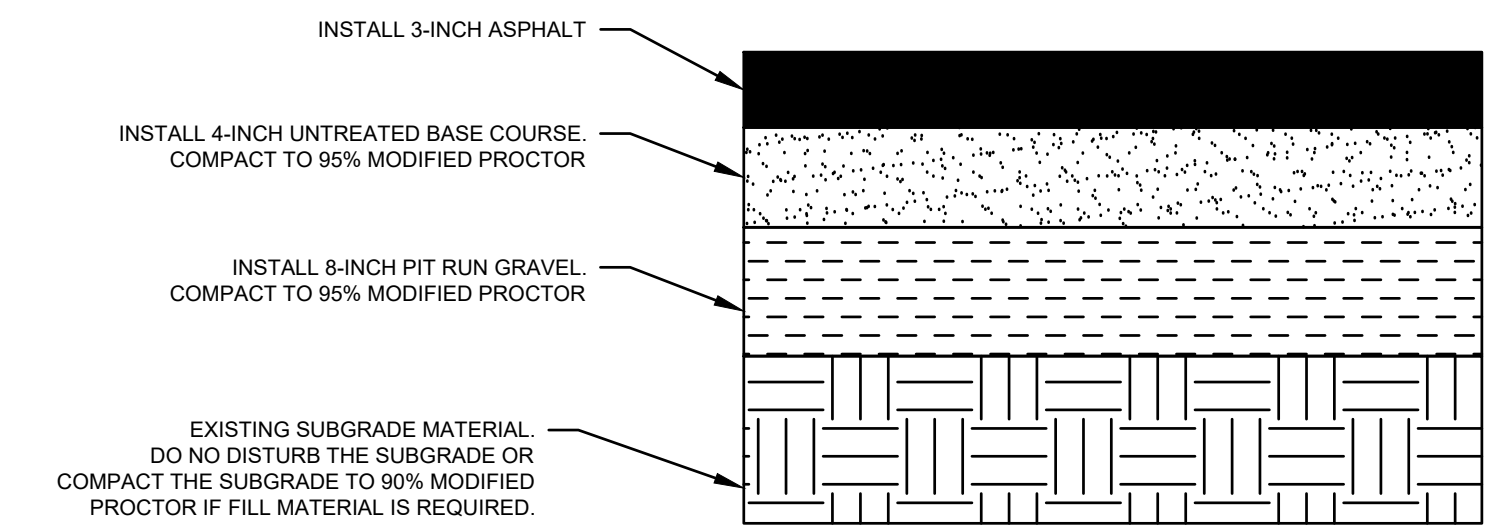

4 STANDARD DUTY ASPHALT PAVEMENT  
C501  
NOT TO SCALE

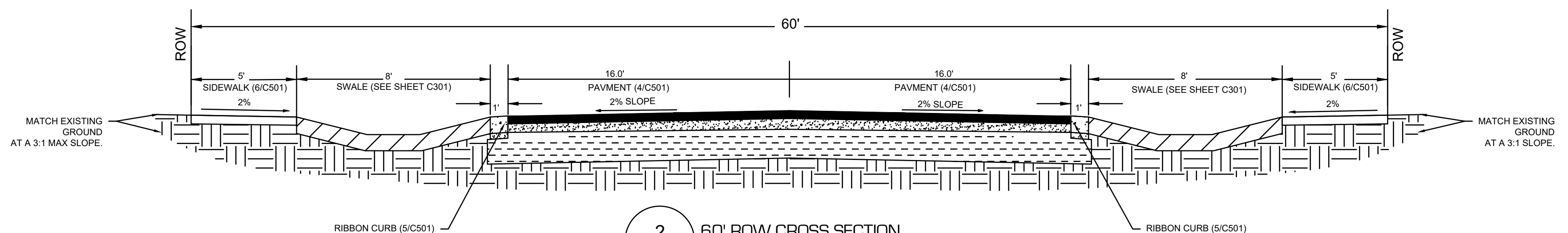

2 60' ROW CROSS SECTION  
C501  
NOT TO SCALE

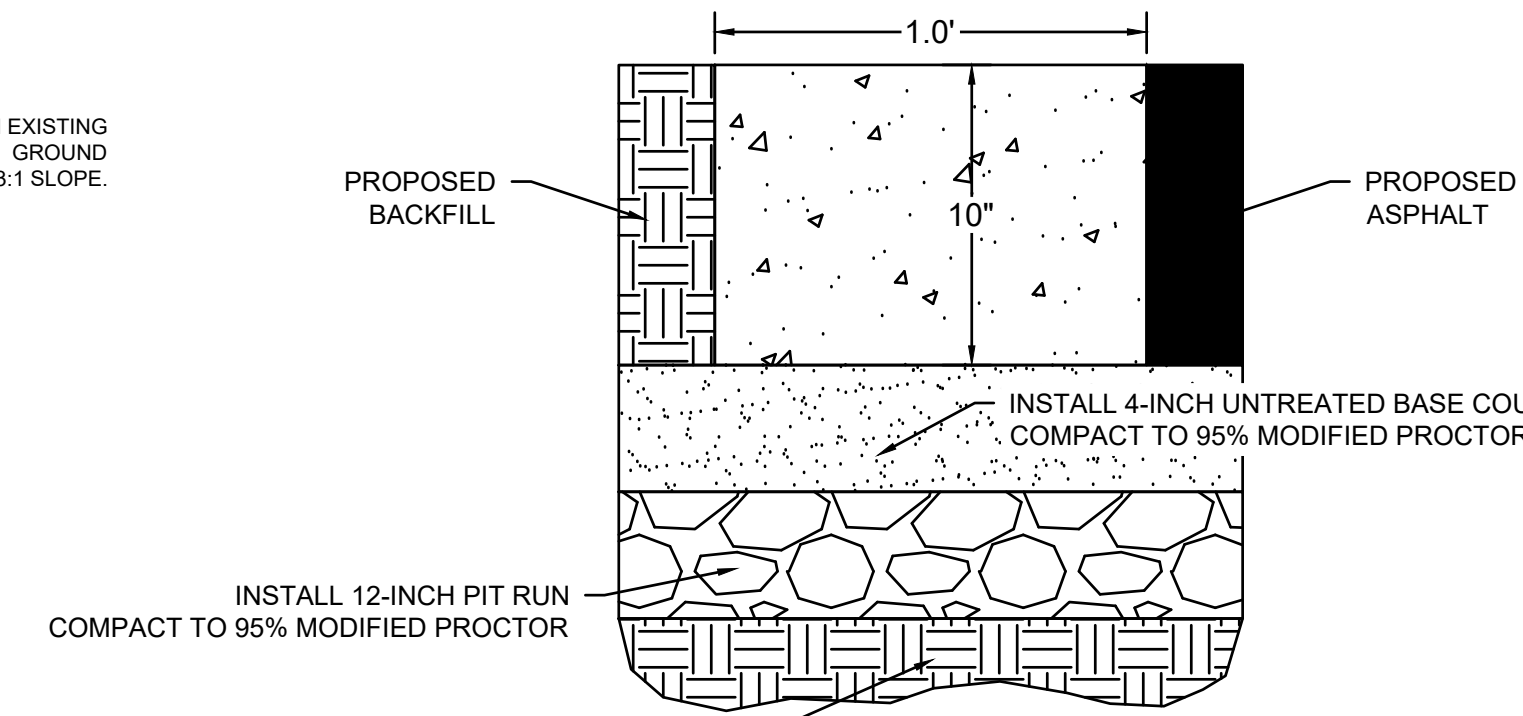

5 RIBBON CURB  
C501  
NOT TO SCALE

- NOTES:
1. CONCRETE SHALL BE 4000 PSI, 28 DAY STRENGTH.
  2. PROVIDE CONTRACTION JOINTS @ 10' - 0" O.C.
  3. PROVIDE EXPANSION JOINTS @ 50' - 0" O.C.
  4. BASE AND PIT RUN MATERIAL SHALL EXTEND 1 FOOT BEYOND CURB.

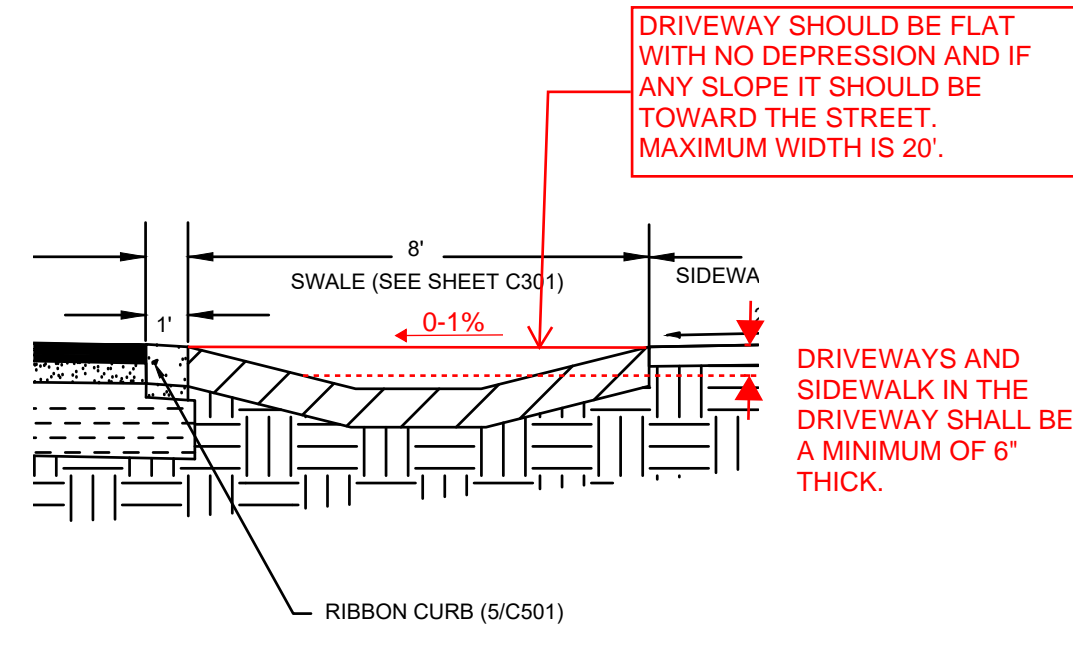

3 PARTIAL-WIDTH 60' ROW CROSS SECTION  
C501  
NOT TO SCALE

DRIVEWAY SHOULD BE FLAT WITH NO DEPRESSION AND IF ANY SLOPE IT SHOULD BE TOWARD THE STREET. MAXIMUM WIDTH IS 20'.

DRIVEWAYS AND SIDEWALK IN THE DRIVEWAY SHALL BE A MINIMUM OF 6" THICK.

NATIVE MATERIAL OR FILL AS REQUIRED (COMPACTED AS PER GEOTECHNICAL INVESTIGATION) SEE ROAD CROSS SECTION FOR MORE DETAILS.

SPELLING

ADA RAMPS SHALL BE PLACED PER THE MOST RECENT GUIDELINES

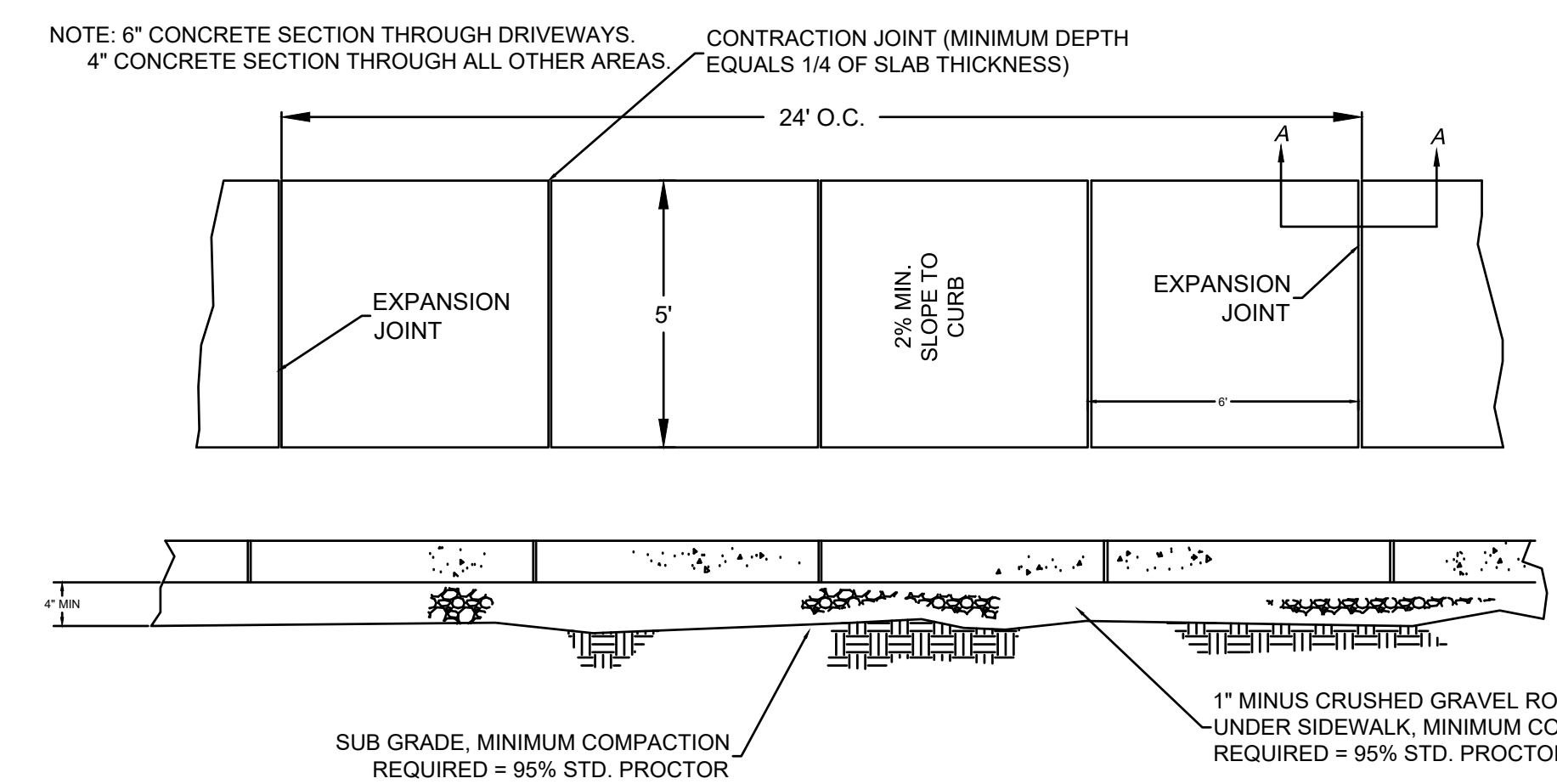

6 CONCRETE SIDEWALK  
C501  
NOT TO SCALE

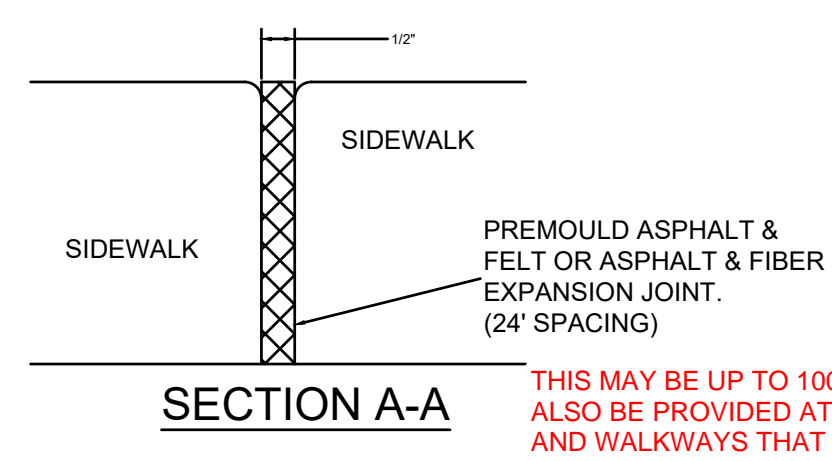

THIS MAY BE UP TO 100' AND MUST ALSO BE PROVIDED AT DRIVEWAYS AND WALKWAYS THAT INTERSECT THE SIDEWALK.

BASE SHALL BE 4" THICK OR MINIMUM OF 6" OF 3/4" MINUS GRAVEL. CONCRETE SHALL NOT BE PLACED ON NATIVE SOILS.

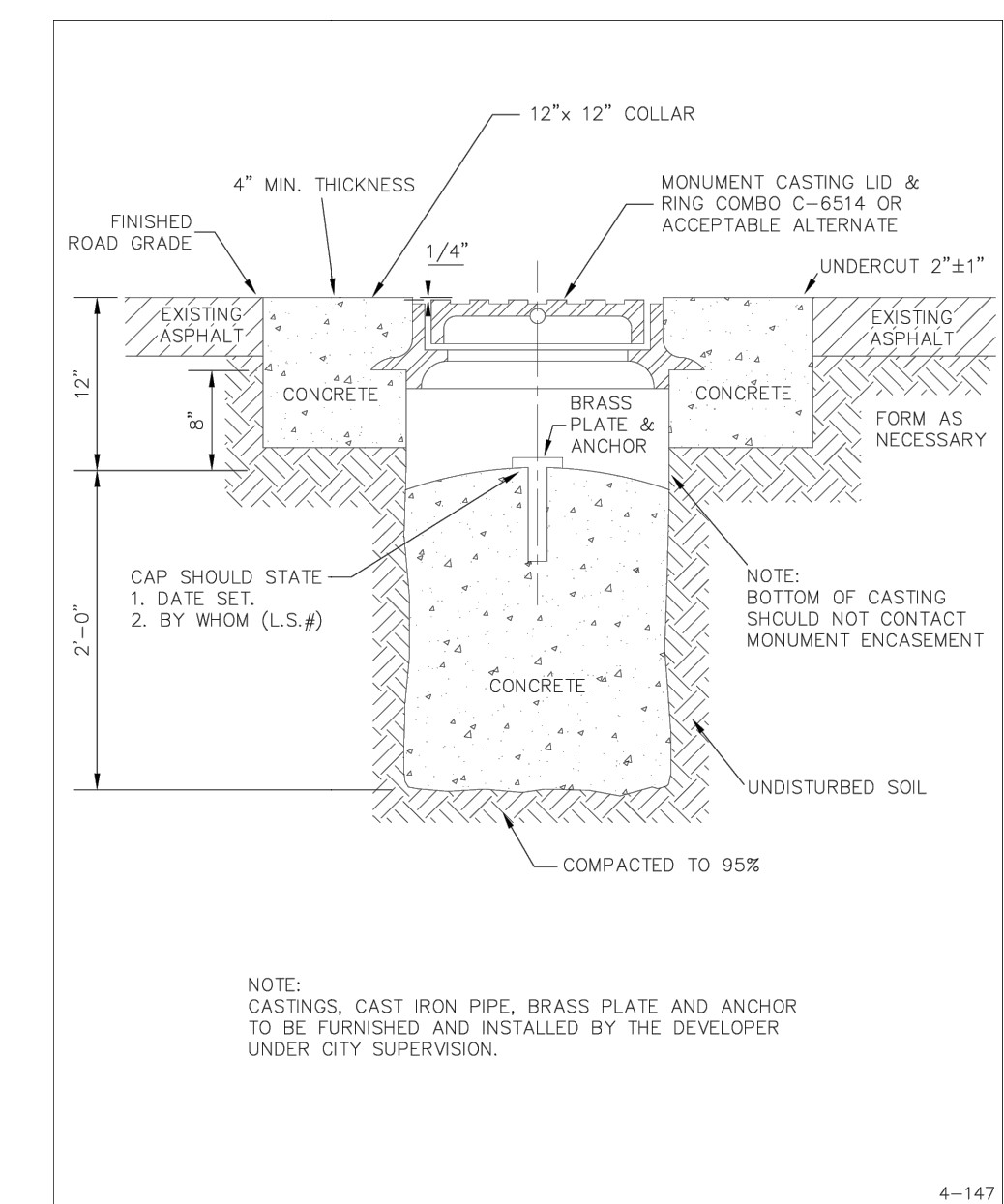

7 HYRUM CITY STREET MONUMENT  
C501  
NOT TO SCALE

MARK	DATE	DESCRIPTION

PROJECT #: 23-321  
 DRAWN BY: L. WESTON  
 PROJECT MANAGER: M. TAYLOR  
 ISSUED: 1/8/2024



**DETAILS**

**C501**



