

For informational purposes only:  
Site Plan Approved by Henderson County Planning Department

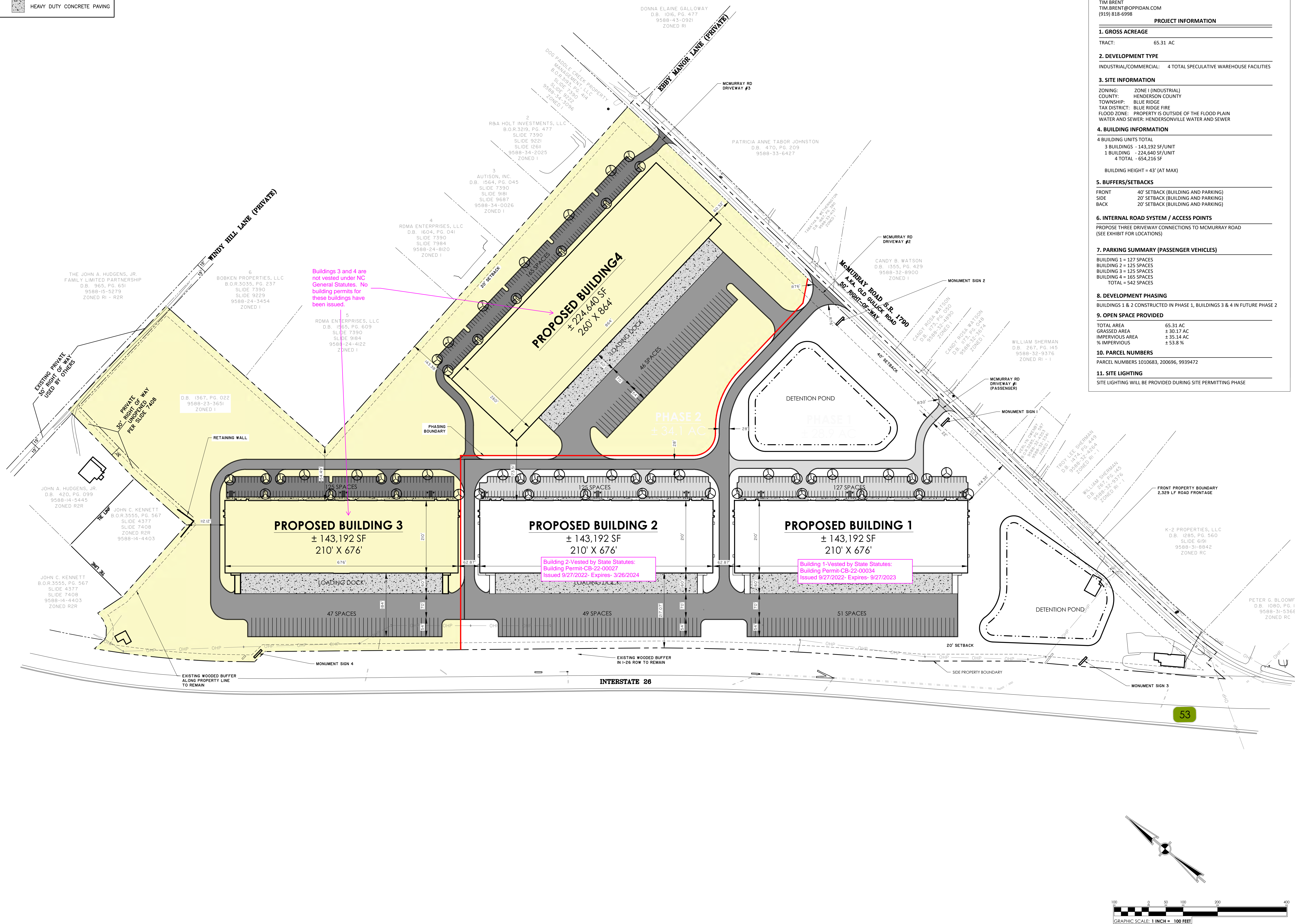

PROPOSED PROJECT / DEVELOPER									
OPPIDAN 2000 REGENCY PARKWAY, SUITE 435 CARY, NC 27518									
TIM BRENT TIM.BRENT@OPPIDAN.COM (919) 818-6998									
PROJECT INFORMATION									
<b>1. GROSS ACREAGE</b> <hr/> TRACT:                      65.31 AC									
<b>2. DEVELOPMENT TYPE</b> <hr/> INDUSTRIAL/COMMERCIAL:     4 TOTAL SPECULATIVE WAREHOUSE FACILITIES									
<b>3. SITE INFORMATION</b> <hr/> ZONING:            ZONE I (INDUSTRIAL) COUNTY:           HENDERSON COUNTY TOWNSHIP:        BLUE RIDGE TAX DISTRICT:    BLUE RIDGE FIRE FLOOD ZONE:     PROPERTY IS OUTSIDE OF THE FLOOD PLAIN WATER AND SEWER: HENDERSONVILLE WATER AND SEWER									
<b>4. BUILDING INFORMATION</b> <hr/> 4 BUILDING UNITS TOTAL 3 BUILDINGS - 143,192 SF/UNIT 1 BUILDING - 224,640 SF/UNIT 4 TOTAL - 654,216 SF  BUILDING HEIGHT = 43' (AT MAX)									
<b>5. BUFFERS/SETBACKS</b> <hr/> <table style="width: 100%; border: none;"> <tr> <td style="width: 25%;">FRONT</td> <td>40' SETBACK (BUILDING AND PARKING)</td> </tr> <tr> <td>SIDE</td> <td>20' SETBACK (BUILDING AND PARKING)</td> </tr> <tr> <td>BACK</td> <td>20' SETBACK (BUILDING AND PARKING)</td> </tr> </table>		FRONT	40' SETBACK (BUILDING AND PARKING)	SIDE	20' SETBACK (BUILDING AND PARKING)	BACK	20' SETBACK (BUILDING AND PARKING)		
FRONT	40' SETBACK (BUILDING AND PARKING)								
SIDE	20' SETBACK (BUILDING AND PARKING)								
BACK	20' SETBACK (BUILDING AND PARKING)								
<b>6. INTERNAL ROAD SYSTEM / ACCESS POINTS</b> <hr/> PROPOSE THREE DRIVEWAY CONNECTIONS TO MCMURRAY ROAD (SEE EXHIBIT FOR LOCATIONS)									
<b>7. PARKING SUMMARY (PASSENGER VEHICLES)</b> <hr/> BUILDING 1 = 127 SPACES BUILDING 2 = 125 SPACES BUILDING 3 = 125 SPACES BUILDING 4 = 165 SPACES TOTAL = 542 SPACES									
<b>8. DEVELOPMENT PHASING</b> <hr/> BUILDINGS 1 & 2 CONSTRUCTED IN PHASE 1, BUILDINGS 3 & 4 IN FUTURE PHASE 2									
<b>9. OPEN SPACE PROVIDED</b> <hr/> <table style="width: 100%; border: none;"> <tr> <td style="width: 40%;">TOTAL AREA</td> <td>65.31 AC</td> </tr> <tr> <td>GRASSED AREA</td> <td>± 30.17 AC</td> </tr> <tr> <td>IMPERVIOUS AREA</td> <td>± 35.14 AC</td> </tr> <tr> <td>% IMPERVIOUS</td> <td>± 53.8 %</td> </tr> </table>		TOTAL AREA	65.31 AC	GRASSED AREA	± 30.17 AC	IMPERVIOUS AREA	± 35.14 AC	% IMPERVIOUS	± 53.8 %
TOTAL AREA	65.31 AC								
GRASSED AREA	± 30.17 AC								
IMPERVIOUS AREA	± 35.14 AC								
% IMPERVIOUS	± 53.8 %								
<b>10. PARCEL NUMBERS</b> <hr/> PARCEL NUMBERS 1010683, 2006096, 9939472									
<b>11. SITE LIGHTING</b> <hr/> SITE LIGHTING WILL BE PROVIDED DURING SITE PERMITTING PHASE									