



# Whitmire Center & Toms Park Patton Park & Pool City Council Presentation

October 22<sup>nd</sup>, 2025



# How did we get here?





# Whitmire & Toms Park Existing Conditions

- 2.5 Acres
- 50 parking spots
- 14 Shuffleboard Courts
- 3200 sf large Flex Space
- 8250 sf overall footprint
- Park trails



**Estimated Construction  
Cost to Repair:  
\$4.3 Million**

**Estimated Construction  
Cost to Replace:  
\$4.6 Million**



# Patton Park Existing Conditions

- 18 Acres
- 145 Parking Spots
- 47,000 sf Pool Facilities (~7,000 sf Support Buildings)
- 50-meter 8 Lane Outdoor Pool with Diving Board
- Outdoor Kiddie Pool
- Playground
- 1 Tennis Court
- 4 Pickleball Courts
- Baseball Field
- Skate Park
- Basketball Court
- Open Field Area



**Estimated Construction**

**Cost to Repair: \$8.9 Million**

**Estimated Construction**

**Cost to Replace: \$18 Million**

# Design

- **Whitmire Community** **8,300 SF**  
Community Center, Trail Restrooms
- **50 Meter Patton Park** **45,280 SF**  
Outdoor Aquatics, 50 Meter Indoor Aquatics, Trail Restroom Building



# Whitmire Community

- A** (7) SHUFFLEBOARD COURTS
- B** COMMUNITY CENTER
- C** INTERACTIVE CREEK ELEMENTS
- D** BIORETENTION AREA
- E** PARKING LOT (38 SPACES)
- F** FLEXIBLE OPEN LAWN WITH NATURAL INTERACTIVE PLAY ELEMENTS
- G** SLOUGH



NATURAL  
INTERACTIVE PLAY  
EXAMPLES



# Community Layout

- A** FLEXIBLE RECREATION SPACE
- B** MULTI-PURPOSE ROOMS
- C** WARMING KITCHEN
- D** STAFF AREA
- E** LOBBY
- F** EXTERIOR RESTROOMS
- G** SHUFFLEBOARD COURTS
- H** RESTROOMS



**Total Building Square Footage: 8,300 sf**



# Patton Park 50M

- A EXISTING (2) BASKETBALL COURTS
- B RESTROOMS
- C PLAYGROUND
- D EXISTING CONSTRUCTED WETLANDS
- E PROPOSED CONSTRUCTED WETLANDS
- F FLEXIBLE OPEN SPACE
- G SLOUGH
- H SKATE PARK / PUMP TRACK
- I SOCIAL SWALES
- J INFORMAL STAGE
- K PLAZA
- L PARKING LOT (210 SPACES)
- M PICNIC SHELTER
- N EXISTING SCM
- O INDOOR AQUATICS
- P OUTDOOR AQUATICS
- Q (4) PICKLEBALL COURTS
- R BIORETENTION AREA

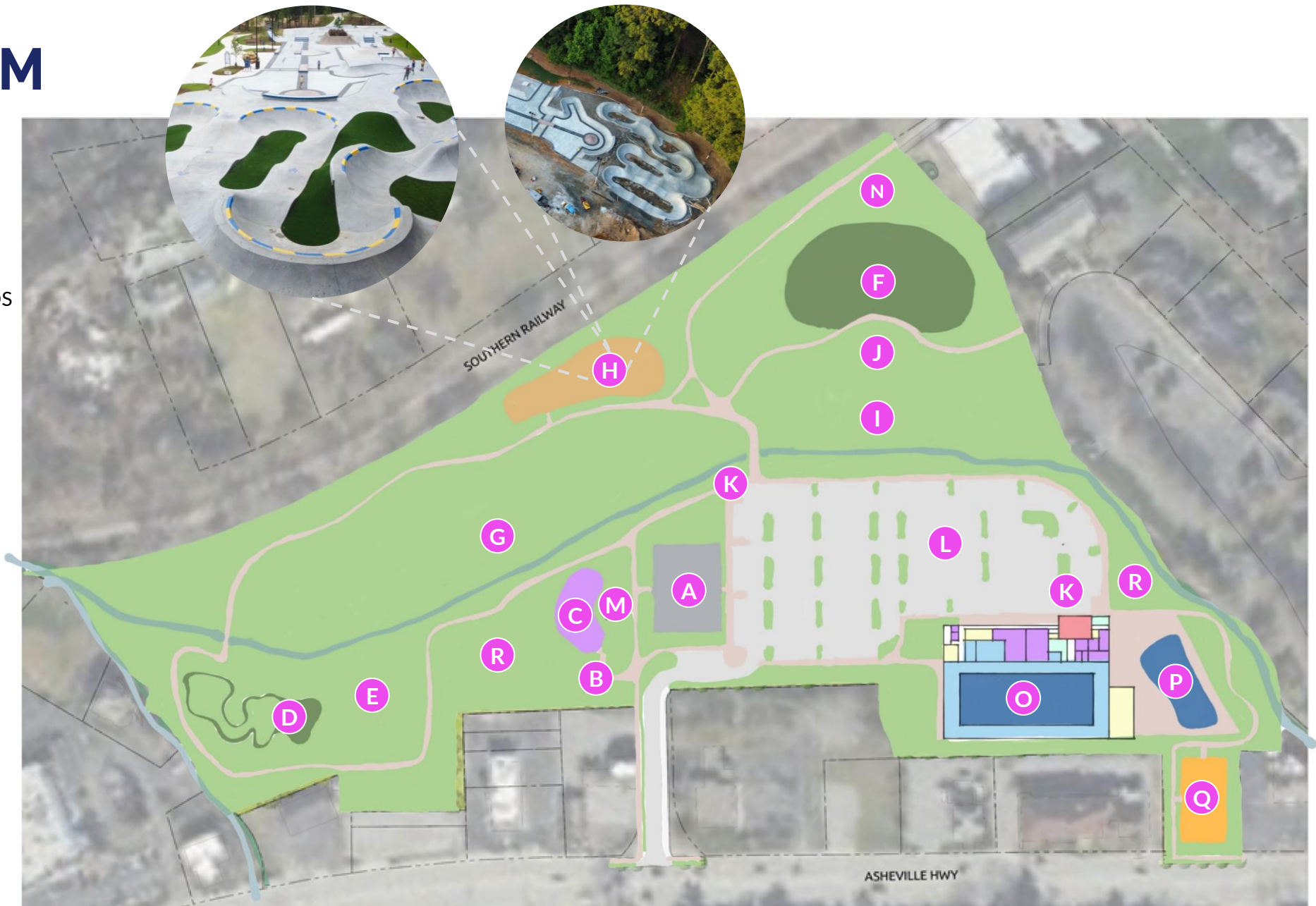



# Aquatic Support Layout

- A** INDOOR 50M POOL & DECK
- B** WET CLASSROOM
- C** MEET MANAGEMENT
- D** POOL STORAGE
- E** LIFEGUARD ROOM
- F** STAFF SPACE
- G** LOBBY
- H** CONCESSIONS
- I** RESTROOMS / LOCKERS
- J** MECHANICAL / CHEMICAL



**Total Building Square Footage: 45,280 SF**

# Aquatic Layout

## POOLS

- A** indoor 50 M competition pool | 11,029 SF
- C** outdoor activity pool | 5,295 SF

INDOOR FACILITY



INDOOR AQUATICS DECK



OUTDOOR AQUATIC AREA

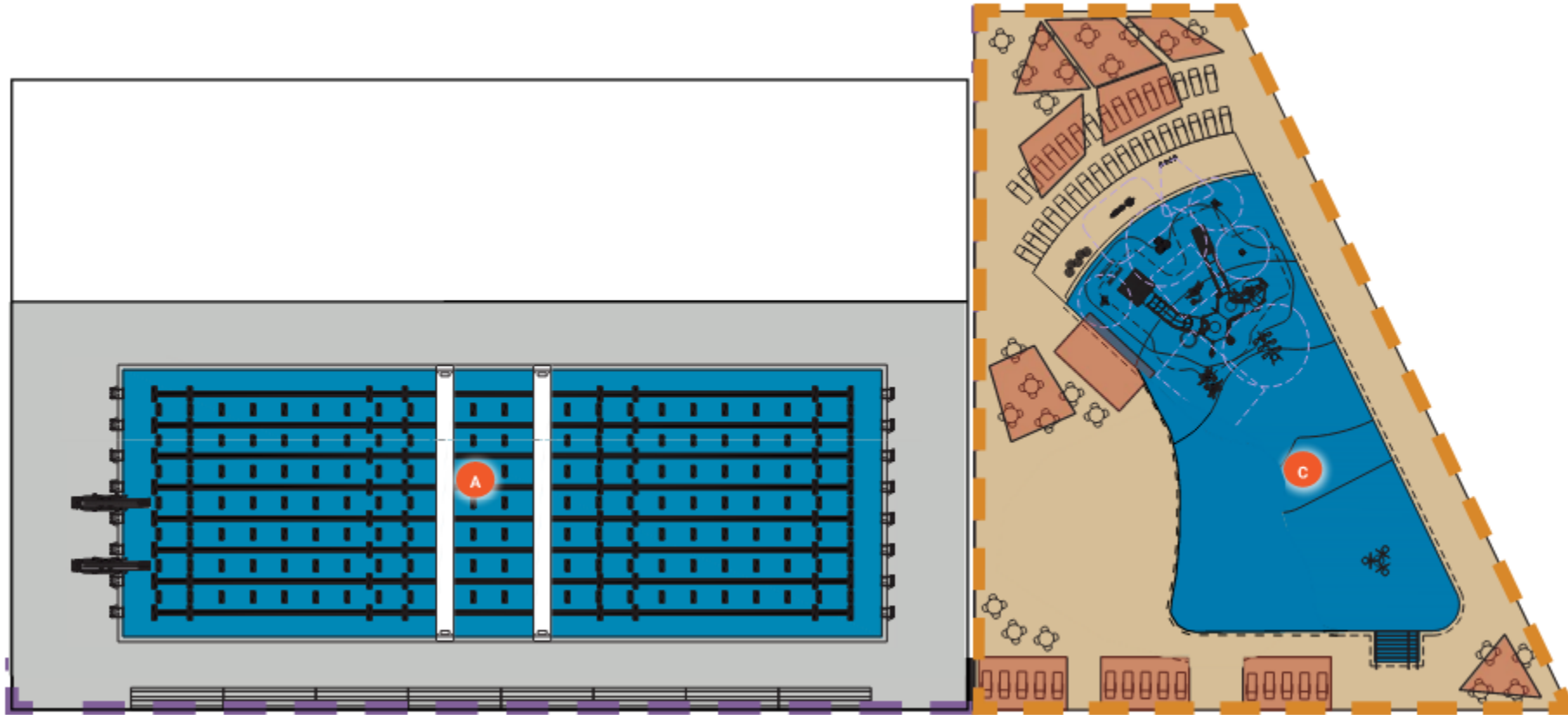



# Summary



**Community Center**  
**7 Shuffleboard Courts**  
**Interactive Creek Elements**  
**Parking**  
**Flex Lawn**  
**Bioretention Area**  
**Slough**

**Whitmire & Toms Park**



**50 M Indoor Pool**  
**Outdoor Aquatics with Zero Entry**  
**Outdoor Pool Restrooms / Admin**  
**Skate Park / Pump Track**  
**Flex Lawn**  
**Playground**  
**Pickleball Courts**  
**Basketball Courts**  
**Bioretention Area**  
**Constructed Wetlands**  
**Slough**  
**Social Swales**  
**Trail Restrooms**  
**Picnic Shelter**

**Patton Park & Pool**



**WithersRavenel**  
Our People. Your Success.

# Thank you!

