

501 WINDO PARK BOULEVARD, SUITE 200, MOUNT PLEASANT, SC 29564 | JUDSONVILLE BUILDING 600, 701 EAST F STREET, SUITE 200, GREENVILLE, SC 29611 | 201 PETERSON DR., SUITE 200, CHARLOTTE, NC 28207 | 101 N. CEDAR STREET, SUMMERVILLE, SC 29583 | 150 N. DANIEL MORGAN AVENUE, SUITE 200, SPARTANBURG, SC 29306 | 223 S. WEST ST. #200, RALEIGH, NC 27603

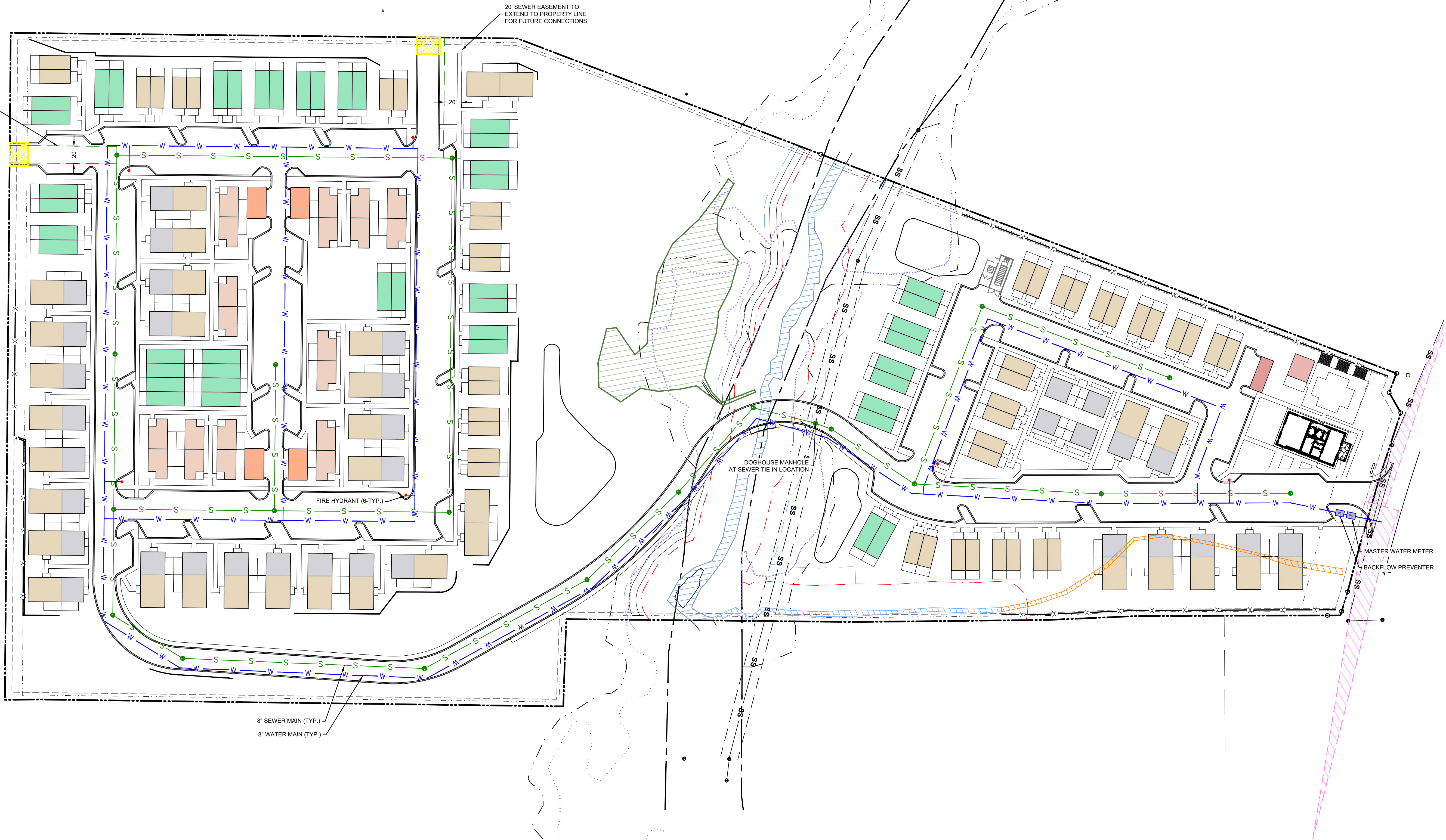

STANDARD SEWER PLAN NOTES:

1. FOR PROJECT SURVEY INFORMATION INCLUDING VERTICAL DATUM AND BENCHMARK LOCATIONS, SEE "PROJECT SURVEY INFORMATION AND CONTRACTOR VERIFICATION REQUIREMENTS" ON SHEET C1.0.
2. PRIOR TO STARTING CONSTRUCTION, THE CONTRACTOR IS RESPONSIBLE FOR VERIFYING EXISTING CONDITIONS, INCLUDING BUT NOT LIMITED TO TOPOGRAPHIC, TREE, STORM DRAINAGE FACILITIES, AND ALL UTILITIES. EXISTING UTILITIES SHOWN ARE APPROXIMATE AND HAVE NOT BEEN INDEPENDENTLY VERIFIED BY THE OWNER OR ENGINEER. THEREFORE, THE CONTRACTOR IS RESPONSIBLE FOR VERIFYING THE EXACT VERTICAL AND HORIZONTAL LOCATIONS OF ALL EXISTING UTILITIES. ANY DISCREPANCIES OR CONFLICTS IDENTIFIED DURING VERIFICATION OF EXISTING CONDITIONS AND UTILITIES SHALL BE REPORTED TO THE OWNER AND ENGINEER. ANY COSTS ASSOCIATED WITH CORRECTIVE WORK OR DAMAGES THAT ARE A RESULT OF THE CONTRACTOR NOT VERIFYING EXISTING CONDITIONS AND THE EXACT VERTICAL AND HORIZONTAL LOCATION OF ALL EXISTING UTILITIES WILL BE THE CONTRACTOR'S RESPONSIBILITY.
3. MANHOLE COVERS ARE NOT ALLOWED WITHIN CURB AND GUTTER AND ARE TO BE INSTALLED COMPLETELY WITHIN OR COMPLETELY OUT OF PAVED AREAS (INCLUDING SIDEWALKS).
4. SEWER MANHOLE CONES ADJACENT TO CURB AND/OR SIDEWALK RAMPS SHALL BE ROTATED TO LOCATE MANHOLE FRAME AND COVER AWAY FROM THE SIDEWALK RAMPS AND CURBS.
5. REFER TO THE SEWER AUTHORITY'S STANDARD NOTES, DETAILS, AND SPECIFICATIONS FOR ADDITIONAL REQUIREMENTS AND PROCEDURES, INCLUDING WATERTIGHT MANHOLE LOCATIONS.
6. REFER TO SEWER DETAIL SHEETS AND SEWER PROFILE SHEETS FOR DETAILS AND ANY ADDITIONAL SEWER SYSTEM INFORMATION.

EXISTING UTILITY NOTE:

THE LOCATION OF EXISTING UNDERGROUND UTILITIES ARE SHOWN IN AN APPROXIMATE WAY ONLY AND HAVE NOT BEEN INDEPENDENTLY VERIFIED BY THE OWNER OR ITS REPRESENTATIVE. THE CONTRACTOR SHALL DETERMINE THE EXACT LOCATION OF ALL EXISTING UTILITIES BEFORE COMMENCING ANY WORK, AND AGREES TO BE FULLY RESPONSIBLE FOR ANY AND ALL DAMAGES WHICH MIGHT OCCUR DUE TO THE CONTRACTOR'S FAILURE TO EXACTLY LOCATE AND PRESERVE ANY AND ALL UNDERGROUND UTILITIES.



Know what's below.
Call before you dig.

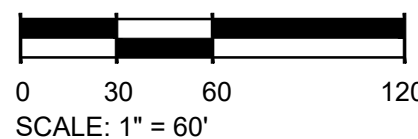
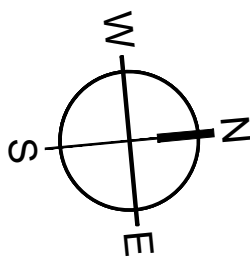

MOUNT PLEASANT, SC
843.884.1667
GREENVILLE, SC
864.298.0534
SUMMERVILLE, SC
843.972.0710
SPARTANBURG, SC
864.272.1272
CHARLOTTE, NC
980.312.5450
RALEIGH, NC
980.312.5450
WWW.SEAMONWHITESIDE.COM

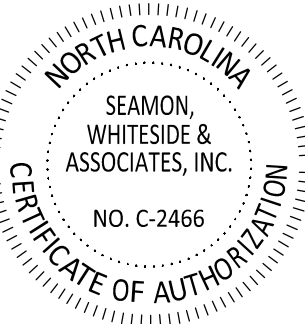

**NOT FOR
CONSTRUCTION**

**LEO LIVING
HENDERSONVILLE**
1741 HAYWOOD RD | TMS: 9569-22-9206
HENDERSONVILLE, NORTH CAROLINA

**SD SET
(NOT FOR CONSTRUCTION)**

SW+ PROJECT: 11808
DATE: 12/19/2025
DRAWN BY: AC | NH
CHECKED BY: AD | DM

REVISION HISTORY

NO.	DESCRIPTION	DATE

UTILITY PLAN