

PARTITION PLAT NO. _____
PARTITION PLAT OF A TRACT OF LAND, LOCATED
IN THE SW1/4 OF SECTION 11, T.4N., R.28E., W.M.,
UMATILLA COUNTY, OREGON
W. O. 26-6465

SURVEY FOR **SURVEY BY**
 OLMEDO EZEQUIEL A III ARMSTRONG SURVEYING, INC.
 600 SE 7TH STREET 1595 NE THIRD ST. STE. A2, BOX 13
 HERMISTON, OR 97838 PRINEVILLE, OR 97754
 (509) 643-1501 (541) 447-7791

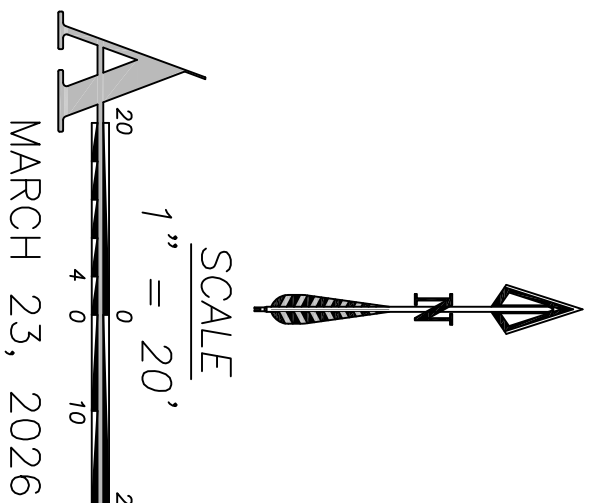

SURVEYOR'S CERTIFICATE
 I, TODD R. CATTERSON, A REGISTERED PROFESSIONAL LAND SURVEYOR IN THE STATE OF OREGON, HEREBY CERTIFY THAT I HAVE SURVEYED AND MARKED WITH PROPER MONUMENTS IN ACCORDANCE WITH OREGON REVISED STATUTES, CHAPTER 92, THE LANDS REPRESENTED ON THIS PLAT, SAID LANDS ARE LOCATED IN THE SOUTHWEST ONE-FOURTH (SW1/4) OF SECTION 11, T.4N., R.28E., W.M., UMATILLA COUNTY, OREGON, MORE PARTICULARLY DESCRIBED AS FOLLOWS: THE NORTH 131 FEET OF LOT 14, BLOCK 13, NEWPORT ADDITION TO THE CITY OF HERMISTON, UMATILLA COUNTY, OREGON

SUBJECT TO ANY EXISTING EASEMENTS & RIGHT-OF-WAYS.

BASIS OF BEARINGS
 BEARINGS ARE BASED ON GPS SURVEY MEASUREMENTS USING THE WGS 1984 ELLIPSOID AND A TRANSVERSE MERCATOR MAPPING PROJECTION WITH THE FOLLOWING PARAMETERS:
 ORIGIN OF LATITUDE = 45°55'23.77311"N
 ORIGIN OF LONGITUDE = 119°17'25.41906"W
 SCALE FACTOR = 1.000000000

SURVEY NARRATIVE
 WE WERE EMPLOYED BY THE OLMEDO EZEQUIEL A III TO COMPLETE THE SURVEY AND MAPPING REQUIREMENTS OF THIS APPROVED PARTITION. SUBJECT PROPERTY IS DESCRIBED AS THE NORTH 131 FEET OF LOT 14, BLOCK 13 OF NEWPORT ADDITION TO THE CITY OF HERMISTON. SUBJECT PROPERTY WAS PREVIOUSLY SURVEYED DURING SURVEY NO. 13-188-B BY KEITH P. PRIMM, LS 48490. SEARCH IN THE FIELD RECOVERED THE SOUTHWEST AND SOUTHEAST CORNER OF SUBJECT PROPERTY AND I HELD THEM AS FOUND. I SET THE NORTHWEST CORNER OF SUBJECT PROPERTY ON LINE BETWEEN SAID SOUTHWEST CORNER AND CORNER LOCATION 1 AND 16 FEET SOUTH OF CORNER LOCATION 1. I SET THE NORTHEAST CORNER OF SUBJECT PROPERTY AT SINGLE PROPORTIONATE POSITION BETWEEN SAID SOUTHWEST CORNER AND CORNER LOCATION 2 USING DIMENSIONS FROM SURVEY NO. 15-055-B AND 13-188-B. THE PARTITION LINES ARE FREE LINES AS DESIRED BY THE CLIENT. THIS SURVEY WAS PERFORMED USING A TRIMBLE R10 GPS SYSTEM IN RTK MODE.

TAX CERTIFICATES

I HEREBY CERTIFY THAT ALL AD VALOREM TAXES, SPECIAL ASSESSMENTS, FEES, AND OTHER CHARGES REQUIRED BY LAW TO BE PLACED ON THE 20____-20____ TAX ROLL WHICH BECAME A LIEN OR WILL BECOME A LIEN ON THIS PARTITION DURING THIS TAX YEAR BUT NOT YET CERTIFIED TO THE TAX COLLECTOR FOR COLLECTION HAVE BEEN PAID TO ME.

I HEREBY CERTIFY THAT ALL TAXES ARE PAID AS OF THIS DATE.

COUNTY TAX COLLECTOR _____ DATE _____

LOT 15
 BLOCK 13
 NEWPORT ADDITION
 -NOT A PART-

DECLARATION

KNOW ALL PEOPLE BY THESE PRESENTS THAT OLMEDO EZEQUIEL A III IS THE OWNER OF THE LANDS REPRESENTED ON THIS PLAT AND MORE PARTICULARLY DESCRIBED IN THE ACCOMPANYING SURVEYOR'S CERTIFICATE AND HAVE CAUSED SAID LANDS TO BE SURVEYED AND PLATED INTO PARCELS AND PUBLIC UTILITY EASEMENTS AS SHOWN HEREON IN ACCORDANCE WITH OREGON REVISED STATUTES, CHAPTER 92, AND DOES HEREBY DEDICATE TO THE PUBLIC THE PUBLIC UTILITY EASEMENT. THERE ARE NO IRRIGATION WATER RIGHT APPURTENANT TO THIS PROPERTY.

OLMEDO EZEQUIEL A III _____

ACKNOWLEDGEMENT

KNOW ALL PEOPLE BY THESE PRESENTS THAT ON THIS _____ DAY OF _____, 2026, BEFORE ME, A NOTARY PUBLIC IN AND FOR THE COUNTY OF UMATILLA, STATE OF OREGON, PERSONALLY APPEARED THE ABOVE NAMED OLMEDO EZEQUIEL A III, AND WHO ACKNOWLEDGED TO ME THAT HE EXECUTED THE FOREGOING DECLARATION FREELY AND VOLUNTARILY.

NOTARY PUBLIC FOR
 THE STATE OF OREGON _____

APPROVALS

UMATILLA COUNTY SURVEYOR _____ DATE _____
 CITY OF HERMISTON PLANNING COMMISSION _____ DATE _____
 HERMISTON IRRIGATION DISTRICT _____ DATE _____

RECEIVED BY
 UMATILLA COUNTY SURVEYOR
 DATE: _____
 REC'D BY: _____
 NO: _____

LEGEND

- SET 5/8" x 30" LONG IRON ROD WITH YELLOW PLASTIC CAP MARKED "ARMSTRONG S&E".
- ⊙ FOUND 5/8" IRON ROD WITH YELLOW PLASTIC CAP MARKED "PLS LS 48490" AS PER SURVEY NO. 13-188-B BY KEITH P. PRIMM, LS 48490, RECORDED JUNE 5, 2013.
- ⊕ FOUND 1-1/2" ALUMINUM CAP MONUMENT, INITIAL POINT FOR FINDER FIRST ADDITION.
- FOUND 3/4" IRON ROD WITH YELLOW PLASTIC CAP AS PER SURVEY NO. 15-055-B BY G. DENNIS EDWARDS, LS 951, RECORDED JUNE 22, 2015.
- 1 () RECORD AS PER THE MAP OF THE NEWPORT ADDITION TO HERMISTON OREGON, RECORDED MARCH 21, 1908.
- 2 () RECORD AS PER SURVEY NO. 01-124-B BY G. DENNIS EDWARDS, LS 951, RECORDED AUGUST, 2001.
- 3 () RECORD AS PER SURVEY NO. 13-188-B BY KEITH P. PRIMM, LS 48490, RECORDED JUNE 5, 2013.
- 4 () RECORD AS PER SURVEY NO. 15-055-B BY G. DENNIS EDWARDS, LS 951, RECORDED JUNE 22, 2015.
- CNS COMPUTED NOT SET
- ① CORNER IDENTIFICATION NUMBER

