

TREE PLANTING DETAIL

NOT TO SCALE

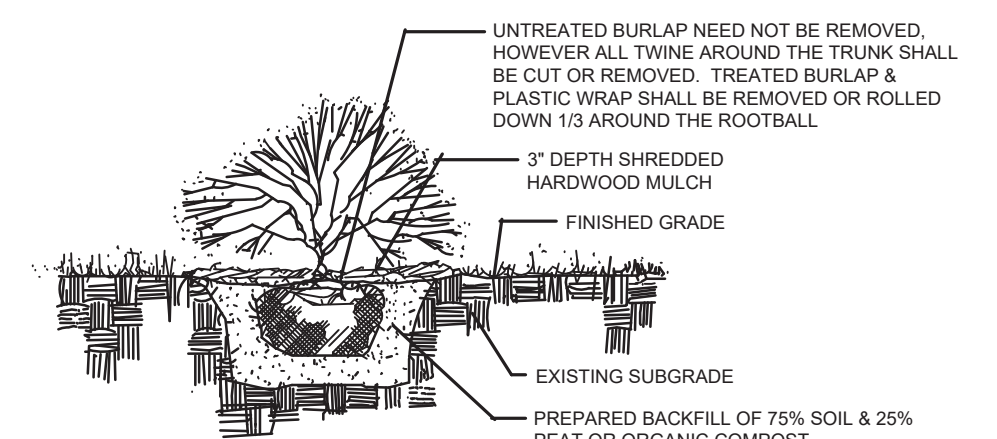

SHRUB PLANTING DETAIL

NOT TO SCALE

PLANTING NOTES

- LANDSCAPE CONTRACTOR (CONTRACTOR) SHALL MAKE A SITE VISIT PRIOR TO BIDDING/CONSTRUCTION TO INSPECT THE CURRENT SITE CONDITIONS AND REVIEW PROPOSED PLANTING PLAN AND RELATED WORK. CONTRACTOR SHALL REPORT ANY DISCREPANCIES IN THE FIELD TO THE LANDSCAPE ARCHITECT AND/OR OWNER.
- CONTRACTOR SHALL VERIFY LOCATIONS OF ALL UNDERGROUND UTILITIES PRIOR TO BEGINNING CONSTRUCTION ON HIS PHASE OF WORK. ELECTRIC, GAS, TELEPHONE, AND CABLE TELEVISION CAN BE LOCATED BY CALLING J.U.L.I.E. AT 811. FOR REGIONAL LOCATING, CONTACT "DIGGER'S HOTLINE". ANY DAMAGE OR INTERRUPTION OF SERVICES SHALL BE THE RESPONSIBILITY OF THE CONTRACTOR. CONTRACTOR TO COORDINATE ALL RELATED ACTIVITIES WITH OTHER TRADES ON THE JOB AND SHALL REPORT ANY UNACCEPTABLE JOB CONDITIONS TO OWNERS REPRESENTATIVE PRIOR TO COMMENCING WORK.
- CONTRACTOR IS RESPONSIBLE FOR APPLICATION AND COST OF ALL NECESSARY BUILDING PERMITS AND CODE VERIFICATIONS. SUBMIT COPIES OF ALL DOCUMENTS TO OWNER AND LANDSCAPE ARCHITECT.
- CONTRACTOR SHALL GRADE ENTIRE SITE TO CORRECT SURFACE IRREGULARITIES IN PREPARATION FOR SO/DSEED. ROTO-TIL, DISC, DRAG, HARROW OR HAND RAKE SUB GRADE IN ALL LAWN AREAS AND REMOVE CONSTRUCTION DEBRIS, FOREIGN MATTER OR STONES LARGER THAN 2". GRADING SHALL PROVIDE SLOPES WHICH ARE SMOOTH, CONTINUOUS, FREE FROM DEPRESSIONS OR RIDGES. LEVEL, RAKE AND ROLL AS NECESSARY TO AN EVEN AND TRUE CONDITION AND OBTAIN POSITIVE DRAINAGE IN ALL AREAS. FINISH GRADES SHALL MEET THE APPROVAL OF OWNER PRIOR TO LAWN INSTALLATION.
- ALL DISTURBED AREAS SHOULD BE BROUGHT TO GRADE WITH "TOPSOIL" TO A DEPTH OF 6 INCHES IN AREAS TO BE SEEDED OR SOODED, AND 12 INCHES FOR ALL INTERIOR (CURBED) LANDSCAPE ISLANDS. ALL LAWN AREAS ARE TO BE FINISHED WITH MULCH, STRAW MULCH, SEED, SOD, ETC. OR AS NOTED. ALL LAWN AREAS TO BE WATERED UNTIL A HEALTHY STAND OF GRASS IS ESTABLISHED. (SEE SEED/SOD NOTES FOR ACCEPTANCE DETAILS).
- QUANTITY LISTS ARE SUPPLIED AS A CONVENIENCE; HOWEVER, THE CONTRACTOR SHOULD VERIFY ALL QUANTITIES. THE DRAWINGS SHALL TAKE PRECEDENCE OVER THE LISTS.
- PLANTINGS MAY NEED TO BE ADJUSTED IN THE FIELD TO ACCOMMODATE UTILITIES, EASEMENTS, DRAINAGE WAYS, DOWNSPOUTS, ETC.; HOWEVER, QUANTITIES AND SIZES SHALL REMAIN CONSISTENT WITH THESE PLANS.
- SIZE & GRADING STANDARDS OF PLANT MATERIAL SHALL CONFORM TO THE LATEST ADDITION OF ANSI Z60.1 AMERICAN STANDARD OF NURSERY STOCK, BY THE AMERICAN NURSERY & LANDSCAPE ASSOCIATION. PLANT MATERIAL SHALL BE NURSERY GROWN AND BE EITHER BALLED AND BURLAP OR CONTAINER GROWN.
- ALL PLANT SPECIES SPECIFIED ARE SUBJECT TO AVAILABILITY. MATERIAL SHORTAGES IN THE LANDSCAPE INDUSTRY MAY REQUIRE SUBSTITUTIONS. ALL SUBSTITUTIONS MUST BE APPROVED BY THE LANDSCAPE ARCHITECT AND/OR OWNER.
- ANY PLANT MATERIALS WITH DAMAGED OR CROOKED/DISFIGURED LEADERS, BARK ABRASION, SUN SCALD, INSECT DAMAGE, ETC. ARE NOT ACCEPTABLE AND WILL BE REJECTED UNLESS CALLED FOR IN THE PLANT LIST AS MULTI-STEM OR CLUMP.
- ALL PLANT MATERIAL, ESPECIALLY TREES, MUST BE SOURCED WITHIN A ONE-HUNDRED FIFTY (150) MILE RADIUS OF THE SUBJECT PROPERTY CONSTRUCTION SITE.
- CONTRACTOR TO NOTIFY THE VILLAGE DEPARTMENT OF DEVELOPMENT SERVICES AT MINIMUM SEVEN (7) DAYS PRIOR TO THE BEGINNING OF PLANTING OR RESTORATION OPERATIONS ON SITE. PLANTING OPERATIONS SHALL BE PERFORMED ONLY DURING THE PERMITTED HOURS OF CONSTRUCTION ACTIVITY IN ACCORDANCE WITH THE VILLAGE MUNICIPAL CODE.
- UPON INSPECTION AND ACCEPTANCE OF ALL LANDSCAPE ITEMS BY LANDSCAPE ARCHITECT AND/OR OWNER THE CONTRACTOR SHALL ASSUME MAINTENANCE RESPONSIBILITIES FOR A PERIOD OF THIRTY (30) DAYS. FOR ALL PLANT MATERIAL, TO INCLUDE: WATERING, CULTIVATING, WEEDING, PRUNING, MULCHING AND SPRAYING AS NECESSARY TO KEEP PLANTS FREE OF INSECTS AND IN A HEALTHY, VIGOROUS CONDITION UNTIL RESPONSIBILITY IS TRANSFERRED TO THE OWNER (SEE BELOW).
- ALL PLANT MATERIAL SHALL BE GUARANTEED FOR ONE (1) YEAR AFTER ACCEPTANCE BY LANDSCAPE ARCHITECT AND/OR OWNER. AFTER THE FIRST THIRTY (30) DAYS, THE OWNER SHALL ASSUME MAINTENANCE RESPONSIBILITIES AS DESCRIBED (SEE ABOVE). CONTRACTOR SHALL REPLACE WITHOUT COST TO OWNER ANY DEAD OR UNACCEPTABLE PLANTS, AS DETERMINED BY THE LANDSCAPE ARCHITECT AT THE END OF ONE (1) YEAR GUARANTEE PERIOD. CONTRACTOR SHALL NOTIFY IMMEDIATELY, IN WRITING, ANY CONCERNS RELATED TO MAINTENANCE PRACTICES.
- ALL PLANTING BEDS AND TREE SAUCERS SHALL BE MULCHED CONTINUOUS WITH 3" DEPTH SHREDDED HARDWOOD MULCH. SEE PLANTING DETAILS. ALL DECIDUOUS TREES (SHADE / ORNAMENTAL) THAT ARE NOT LOCATED IN A PLANTING BED SHALL BE MULCHED WITH A 3'-0" DIAMETER CIRCLE. EVERGREEN TREES AND MULTI-STEMMED ORNAMENTAL TREES SHALL BE MULCHED TO OUTER-MOST BRANCHES AT THE TIME OF INSTALLATION.
- PLANTING EDGE DELINEATION AT ALL PLANTING BED LINES AND TREE SAUCERS SHALL REQUIRE A MINIMUM 4" DEPTH "V" SHAPED CULTIVATED, SPADED EDGE WITH A VERTICAL FACE ABUTTING ALL LAWN AREAS AND SLOPED TO INSIDE OF PLANT BED CONTINUOUS BETWEEN LAWN AND MULCHED AREAS AS INDICATED ON PLAN.
- CONTRACTOR TO SEED ALL DISTURBED LAWN AREAS. SEEDED LAWN TO BE A COMBINATION OF BLUEGRASS, PERENNIAL RYE AND RED FESCUE WITH THE SUGGESTED FOLLOWING ANALYSIS BY WEIGHT: 30% RUGBY KENTUCKY BLUEGRASS, 20% PARK KENTUCKY BLUEGRASS, 20% CREEPING RED FESCUE, 20% SCALDIS HARD FESCUE, AND 10% PERENNIAL RYEGRASS. SEED TO BE APPLIED AT A RATE OF 4 LBS. PER 1,000 S.F.. ALL SEEDED LAWN AREAS SHALL BE COVERED WITH STRAW MULCH OR EROSION CONTROL NETTING, CONSISTING OF HAND OR MACHINE APPLICATION AT A RATE OF 2 TON PER ACRE. MULCH SHALL BE COMPACT ENOUGH TO REDUCE EROSION OF SEED AND TOPSOIL BUT LOOSE ENOUGH TO ALLOW AIR TO CIRCULATE. INSTALL PER METHOD 1, SECTION 251, OF THE STANDARD SPECIFICATIONS FOR ROAD AND BRIDGE CONSTRUCTION.
- ALL SEEDED TURF AREAS SHALL BE FERTILIZED AT INSTALLATION WITH 21-22-4 ANALYSIS, AT A RATE OF 6 LBS. PER 1,000 S.F.. A SECOND APPLICATION OF 21-7-14 TO BE APPLIED AT RATE OF 6 LBS. PER 1,000 S.F. AFTER THE FIRST CUTTING. ACCEPTANCE AND GUARANTEE NOTES SHALL APPLY TO ALL SEEDED AREAS.
- ACCEPTANCE OF GRADING AND SEED SHALL BE BY LANDSCAPE ARCHITECT AND/OR OWNER. CONTRACTOR SHALL ASSUME MAINTENANCE RESPONSIBILITIES FOR A MINIMUM OF SIXTY (60) DAYS OR UNTIL SECOND CUTTING, WHICHEVER IS LONGER. MAINTENANCE SHALL INCLUDE WATERING, WEEDING, RE-SEEDING (WASH-OFFS) AND OTHER OPERATIONS NECESSARY TO KEEP LAWN IN A THRIVING CONDITION. UPON FINAL ACCEPTANCE, OWNER SHALL ASSUME ALL MAINTENANCE RESPONSIBILITIES. AFTER LAWN AREAS HAVE GERMINATED, AREAS WHICH FAIL TO SHOW A UNIFORM STAND OF GRASS FOR ANY REASON WHATSOEVER SHALL BE RE-SEEDED REPEATEDLY UNTIL ALL AREAS ARE COVERED WITH A SATISFACTORY STAND OF GRASS. MINIMUM ACCEPTANCE OF SEEDED LAWN AREAS MAY INCLUDE SCATTERED BARE OR DEAD SPOTS, NONE OF WHICH ARE LARGER THAN TWO (2) SQUARE FEET AND/OR WHEN COMBINED DO NOT EXCEED 2% OF TOTAL LAWN AREA.
- THE PROPOSED JUNIPER (LOW EVERGREEN) PLANT VARIETY (JH - JUNIPERUS CHINENSIS 'HUGHES') AT THE BASE OF THE MONUMENT SIGN ARE TO BE NO TALLER THAN 2'-0" IN HEIGHT, AND IN THE EVENT OF NEEDING REPLACEMENT MUST BE OF THE SAME VARIETY AND/OR MAINTAIN MINIMUM 3' SEPARATION FROM THE SIGN AND NOT OBSTRUCT VISIBILITY.

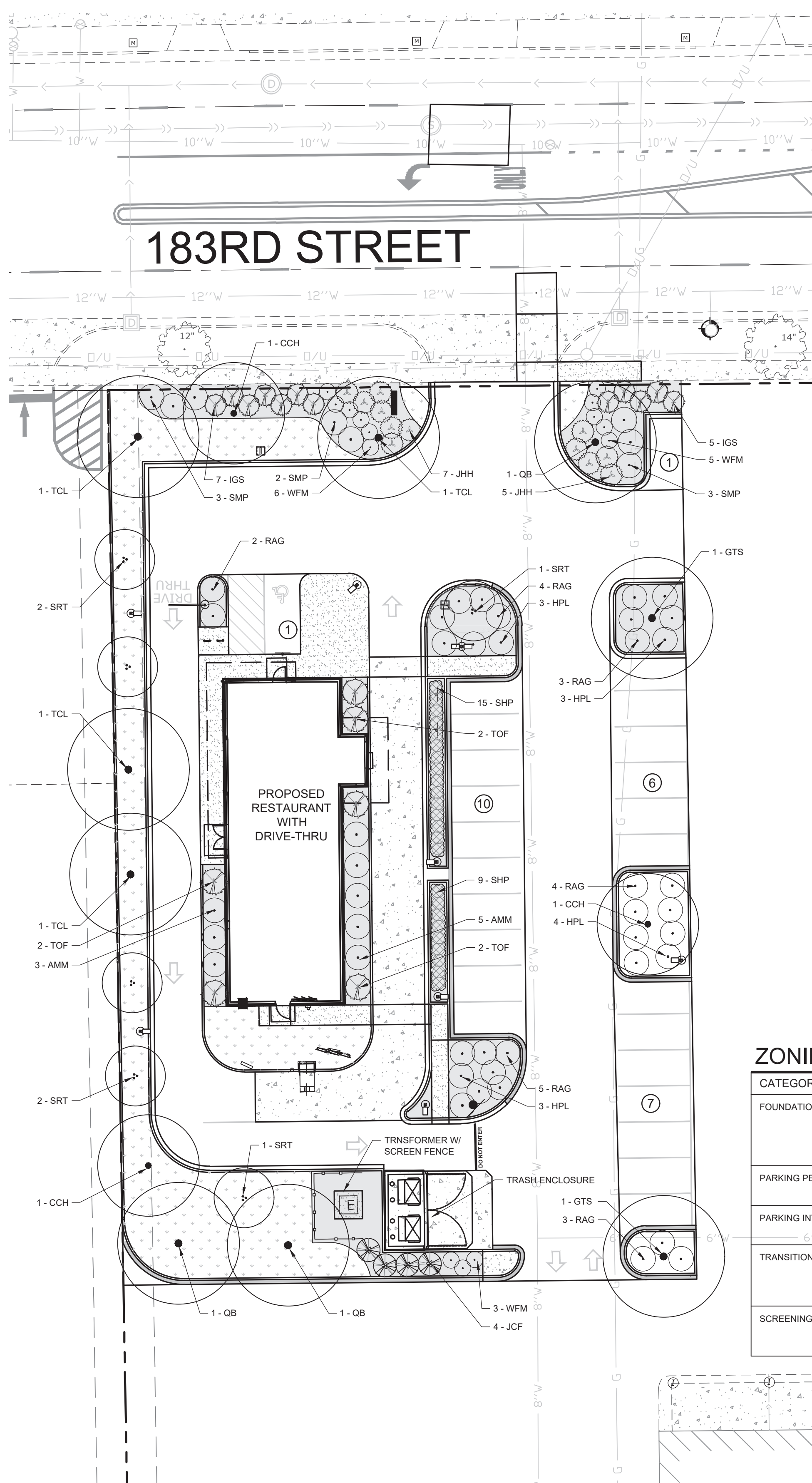

LEGEND

- EVERGREEN / DECIDUOUS SHRUBS
- NATIVE ORNAMENTAL GRASS
- DECIDUOUS ORNAMENTAL TREE
- LARGE DECIDUOUS SHADE TREE
- PROPOSED SEED/TURF AREA
- PROPOSED LANDSCAPE BED / MULCH AREA
- EXISTING VEGETATION

PLANT LIST

KEY	QTY	Botanical name COMMON NAME	SIZE	REMARKS
CCH	3	Carpinus caroliniana AMERICAN HORNBEEAM	2.5'	CANOPY TREE
GTS	2	Gleditsia triacanthos 'Skyline' SKYLINE HONEYLOCUST	3'	CANOPY TREE
QB	3	Quercus bicolor SWAMP WHITE OAK	2.5'	CANOPY TREE
SRT	6	Syringa reticulata x 'Ivory Silk' IVORY SILK JAPANESE TREE LILAC	2.5'	UPRIGHT ORNAMENTAL TREE
TCL	4	Tilia cordata LITTLE LEAF LINDEN	3'	CANOPY TREE
AMM	8	Aronia melanocarpa x 'Morton' IRIQUOIS BEAUTY CHOKEBERRY	24" / 5 GAL	DECIDUOUS SHRUB
JCF	4	Juniperus chinensis 'Fairview' FAIRVIEW UPRIGHT JUNIPER	5' / 5 GAL	EVERGREEN UPRIGHT SHRUB
JHH	12	Juniperus horizontalis 'Huges' HUGHES COMPACT JUNIPER	5 GAL	EVERGREEN LOW SHRUB
HPL	17	Hydrangea paniculata 'Limelight Prime' LIMELIGHT PRIME HYDRANGEA	5 GAL	DECIDUOUS SHRUB
IGS	12	Ilex glabra 'Shamrock' SHAMROCK INKBERRY HOLLY	5 GAL	EVERGREEN SHRUB
RAG	17	Rhus aromatica x 'Gro Lo' GRO LOW FRAGRANT SUMAC	5 GAL	DECIDUOUS SHRUB
WFM	14	Weigela florida 'Minuet' MINUET DWARF WEIGELA	5 GAL	DECIDUOUS SHRUB
SMP	8	Syringa meyeri 'Palibin' DWARF KOREAN LILAC	5 GAL	DECIDUOUS SHRUB
TOF	6	Thuja occidentalis 'Fire Chief' FIRE CHIEF ARBORVITAE	5 GAL	EVERGREEN ROUND
SHP	24	Sporobolus heterolepis 'Tara' PRAIRIE DROPSSEED	2 GAL	UPRIGHT FRAGRANT GRASS

ZONING DATA

CATEGORY	QUANTITY	REQUIREMENT	PROVISION
FOUNDATION PLANTING	FAÇADE: 214' TOTAL 104' - PLANTABLE AREA 110' - PAVED AREA	104' = 83' PLANTABLE AREA (80% OF PLANTABLE AREA) 110' = 2 TREES - 1 TREE PER 50' OF FAÇADE FOR AREAS OF PAVED, PROVIDED ON SITE	94' OF PLANTABLE AREA (90% AREA) 2 TREES PROVIDED AT PERIMETER
PARKING PERIMETER	183RD ST. = 102'	34 SHRUBS (1 SHRUB / GRASS PER 3 L.F. OF PARKING PERIMETER ADJ. TO STREET)	34 SHRUBS PROVIDED AT PERIMETER
PARKING INTERIOR	7 PARKING END CAPS OR ISLANDS	7 TREES + 21 SHRUBS (1 TREE + 3 SHRUBS PER PARKING END CAP OR ISLAND PROVIDED)	7 TREES + 21 SHRUBS PROVIDED AT EACH END CAP OR ISLAND
TRANSITION ZONE	WEST P.L. = 225 L.F. EAST P.L. = N/A NORTH P.L. = N/A SOUTH P.L. = N/A	WEST P.L. = 8 TREES (4 TREES PER 100 L.F.)	8 TREES PROVIDED
SCREENING	TRASH ENCLOSURE (1) 20 L.F. OF FAÇADE ELECTRIC TRANSF. (1)	7 SHRUBS / GRASS (1 SHRUB / GRASS PER 3 L.F. OF ENCLOSURE FAÇADE) NO MORE THAN 20% VISIBLE	7 SHRUBS PROVIDED 100% SCREENED (ALL SIDES)

ARC DESIGN RESOURCES INC.
 5281 ZENITH PARKWAY
 LOVES PARK, IL 61111
 VOICE: (815) 484-4300
 FAX: (815) 484-4303
 www.arcdesign.com
 Illinois Design Firm License No. 184-001334

PROJECT NAME
 OWNERS NAME
RESTAURANT WITH DRIVE-THRU
 3047 183RD STREET
 HOMEWOOD, IL
 COOK COUNTY
 ALRIG USA
 RACHEL DELANEY
 RACHEL@ALRIGUSA.COM
 (248) 909-7072

CONSULTANTS

ISSUED FOR

ITEM	DATE
1. SITE PLAN REVIEW	08/13/2024
2. AGENCY REVIEW	08/22/2024
3. AGENCY REVIEW	08/27/2024
4. ---	---
5. ---	---
6. ---	---
7. ---	---
8. ---	---
9. ---	---
10. ---	---
11. ---	---
12. ---	---

SHEET TITLE
LANDSCAPE PLAN

DRAWN MA
 CHECKED LND
 PM RCS

PROJECT NUMBER
 SHEET NUMBER
23129
L-01