

EXISTING SITE DATA

ADDRESS: 1313 175th STREET, HOMEWOOD, IL 60403

ZONING DISTRICT: M-1 LIMITED MANUFACTURING

SITE AREAS:
 PROPERTY 1 (LOT D, 1, 2, & 3): 187,500 SF 4.30 Acres
 PROPERTY 2 (HUEY PLAZA): 55,500 SF 1.27 Acres
 TOTAL AREA: 243,000 SF 5.58 Acres

EXISTING BUILDING AREAS:
 BASEMENT LEVEL: 4,705 SF

FIRST FLOOR LEVEL: 4,705 SF
 SECOND FLOOR LEVEL: 4,705 SF
 TOTAL AREA 1st & 2nd LEVEL: 9,410 SF

EXISTING PARKING: 65 SPACES (3 ADA)

PROPOSED SITE DATA

EXISTING PROPERTY - (LOT 1)

BUILDING AREAS (FOOTPRINT):
 EXISTING & PROPOSED BUILDING 4,999 SF

PARKING AREAS:
 EXISTING & PROPOSED PARKING: 71 SPACES (5 ADA)

REQUIRED PARKING (M-1 DISTRICT):
 OFFICE & SALES AREAS (9,998 SF): 21 SPACES

REQUIRED ACCESSIBLE SPACE: 2 SPACES

SITE AREAS:
 BUILDING FOOTPRINT: 4,999 SF
 PAVEMENT (IMPERVIOUS): 29,811 SF
 TOTAL IMPERVIOUS SURFACES: 34,810 SF 63%

LANDSCAPING (PERVIOUS): 20,690 SF
 TOTAL SITE AREA: 55,500 SF 1.27 ACRES

PROPOSED PROPERTY (LOT 2)

BUILDING AREAS (FOOTPRINT):
 PROPOSED BUILDING 45,992 SF

PARKING AREAS:
 PROPOSED PARKING: 39 SPACES

REQUIRED PARKING (M-1 DISTRICT):
 OTHER AREAS (44,992 SF): 45 SPACES

REQUIRED ACCESSIBLE SPACE: 3 SPACES

SITE AREAS:
 BUILDING FOOTPRINT: 45,992 SF
 PAVEMENT (IMPERVIOUS): 17,687 SF
 TOTAL IMPERVIOUS SURFACES: 63,679 SF 34%

LANDSCAPING (PERVIOUS): 123,710 SF
 TOTAL SITE AREA: 187,500 SF 4.30 ACRES

TOTAL - LOT 1 AND 2 COMBINED

BUILDING AREAS (FOOTPRINT):
 EXISTING OFFICE BUILDING 4,999 SF
 PROPOSED BUILDING 45,992 SF
 TOTAL BUILDING AREAS: 50,991 SF

PARKING AREAS:
 EXISTING & PROPOSED (LOT 1): 71 SPACES (5 ADA)
 PROPOSED PARKING (LOT 2): 39 SPACES (0 ADA)
 TOTAL PARKING AREAS: 109 SPACES (5 ADA)

REQUIRED PARKING (M-1 DISTRICT):
 OFFICE & SALES AREAS (10,410 SF): 21 SPACES
 OTHER AREAS (44,900 SF): 45 SPACES
 TOTAL REQUIRED PARKING: 66 SPACES

REQUIRED ACCESSIBLE SPACE: 5 SPACES

SITE AREAS:
 BUILDING FOOTPRINTS: 50,991 SF
 PAVEMENT (IMPERVIOUS): 47,489 SF
 TOTAL IMPERVIOUS SURFACES: 98,480 SF 41%

LANDSCAPING (PERVIOUS): 144,440 SF
 TOTAL SITE AREA: 243,000 SF 5.58 ACRES

BRUCE F. ROTH ARCHITECT

743 Selborne Road, Riverdale, Illinois 60544
 708.443.5195 (H), 708.443.8306 (C)
 email: brucefroth@gmail.com

web: brucefrotharchitect.wordpress.com

LIMITATION OF WARRANTY OF ARCHITECT'S WORK PRODUCT

THE ARCHITECT AND HIS CONSULTANTS DO NOT WARRANT OR GUARANTEE THE ACCURACY AND COMPLETENESS OF THE WORK PRODUCT THEREIN BEFORE REASONABLE DILIGENCE. IF ANY MISTAKES, OMISSIONS OR DISCREPANCIES ARE FOUND TO EXIST WITHIN THE WORK PRODUCT, THE ARCHITECT SHALL BE PROMPTLY NOTIFIED SO THAT HE MAY HAVE THE OPPORTUNITY TO TAKE WHATEVER STEPS ARE NECESSARY TO RESOLVE THEM. FAILURE TO NOTIFY THE ARCHITECT OF SUCH MATTERS SHALL ABSOLVE THE ARCHITECT FROM ANY RESPONSIBILITY FOR THE CONSEQUENCES OF SUCH FAILURE. ACTIONS TAKEN WITHOUT THE KNOWLEDGE OR CONSENT OF THE ARCHITECT, OR IN CONTRADICTION TO THE ARCHITECT'S WORK PRODUCT OR RECOMMENDATIONS, SHALL BECOME THE RESPONSIBILITY, NOT OF THE ARCHITECT, BUT OF THE PARTIES RESPONSIBLE FOR TAKING SUCH ACTION.



HEADQUARTERS FACILITY

1313 175th STREET
 HOMEWOOD, ILLINOIS 60430

SHEET

ARCHITECTURAL SITE PLAN

SEAL

REV	DATE	ISSUES FOR	ISSUE

BY

BFR

PROJECT

NUMBER

A-02

175th STREET

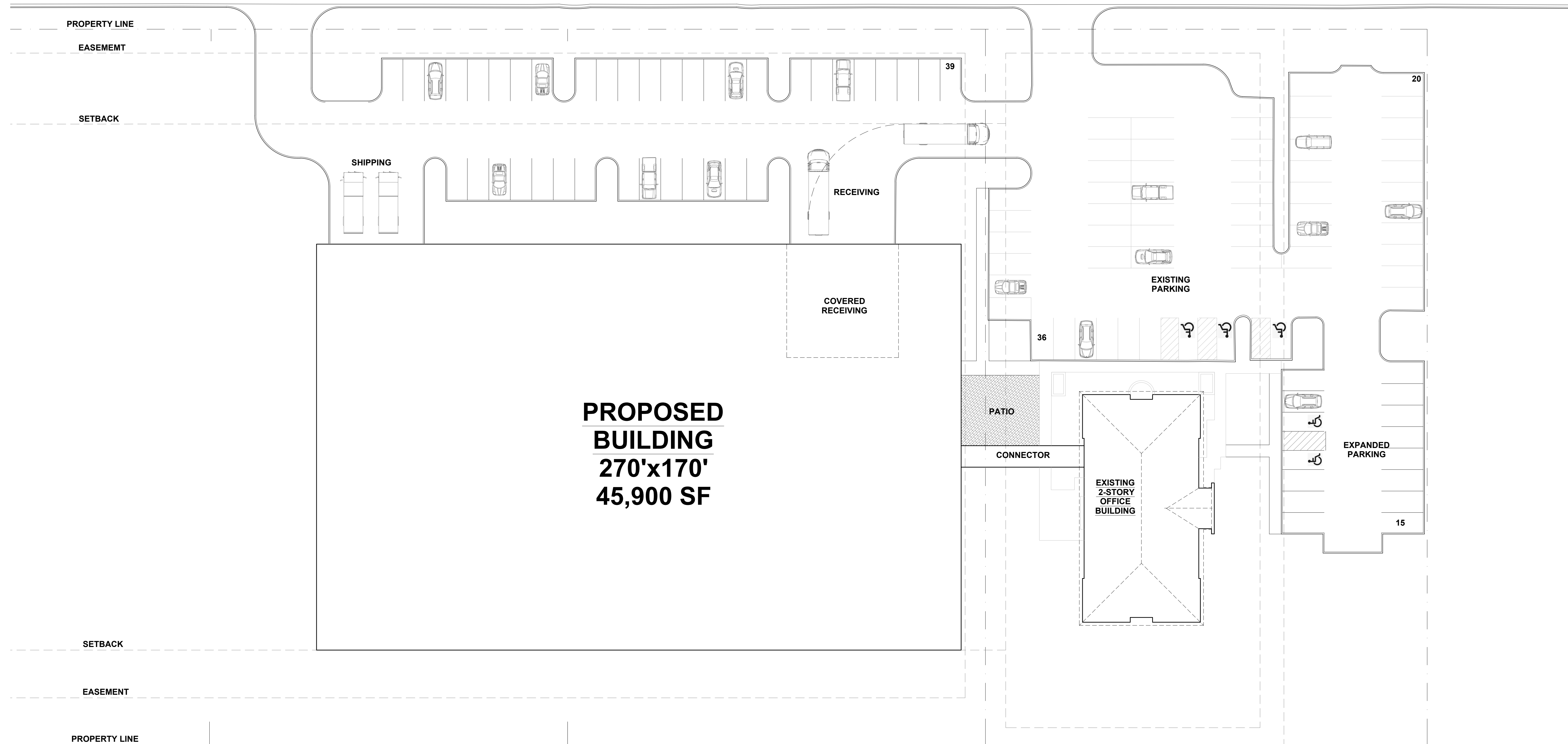

1 ARCHITECTURAL SITE PLAN
 SCALE: 1"=20'-0"

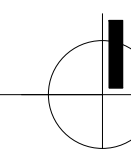

**LIMITATION OF WARRANTY OF
ARCHITECT'S WORK PRODUCT**

THE ARCHITECT AND HIS CONSULTANTS DO NOT WARRANT OR GUARANTEE THE ACCURACY AND COMPLETENESS OF THE WORK PRODUCT HEREIN BEYOND REASONABLE DILIGENCE. IF ANY MISFEASANCES OR DISCREPANCIES ARE FOUND TO EXIST WITHIN THE WORK PRODUCT, THE ARCHITECT SHALL BE PROMPTLY NOTIFIED SO THAT HE MAY HAVE THE OPPORTUNITY TO TAKE WHATEVER STEPS ARE NECESSARY TO RESOLVE THEM. FAILURE TO NOTIFY THE ARCHITECT OF SUCH CONDITIONS SHALL ABSOLVE THE ARCHITECT FROM ANY RESPONSIBILITY FOR THE CONSEQUENCES OF SUCH FAILURE. ACTIONS TAKEN WITHOUT THE KNOWLEDGE OR CONSENT OF THE ARCHITECT, OR IN CONTRADICTION TO THE ARCHITECT'S WORK PRODUCT OR RECOMMENDATIONS, SHALL BECOME THE RESPONSIBILITY, NOT OF THE ARCHITECT, BUT OF THE PARTIES RESPONSIBLE FOR TAKING SUCH ACTION.

PROJECT



**HEADQUARTERS
FACILITY**

1313 175th STREET
HOMERWOOD, ILLINOIS 60430

SHEET

**LANDSCAPE
CONCEPT PLAN**

SEAL

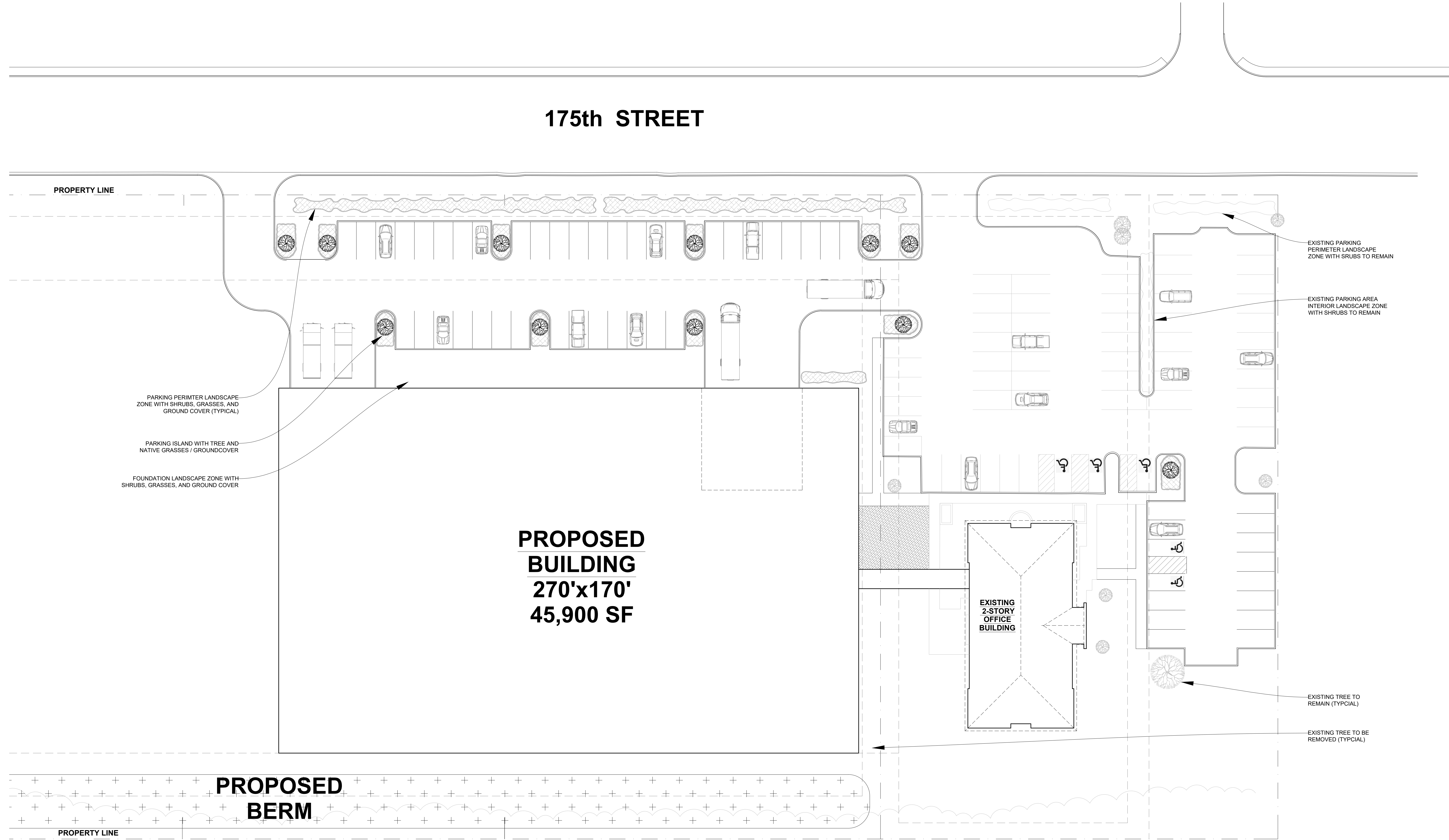

**PROPOSED
BUILDING
270'x170'
45,900 SF**

**EXISTING
2-STORY
OFFICE
BUILDING**

**PROPOSED
BERM**

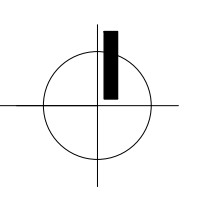

REV	DATE	ISSUES FOR

BY BFR	NUMBER A-03
PROJECT	

BRUCE F. ROTH ARCHITECT
 743 Selborne Road, Elvertide, Illinois 60544
 708.443.5195 (H), 708.443.8306 (C)
 email: brucefroth@gmail.com
 web: brucefrotharchitect.wordpress.com

LIMITATION OF WARRANTY OF ARCHITECTS WORK PRODUCT
 THE ARCHITECT AND HIS CONSULTANTS DO NOT WARRANT OR GUARANTEE THE ACCURACY AND COMPLETENESS OF THE WORK PRODUCT THEREIN BEYOND REASONABLE DILIGENCE. IF ANY MISTAKES, OMISSIONS OR DISCREPANCIES ARE FOUND TO EXIST WITHIN THE WORK PRODUCT, THE ARCHITECT SHALL BE PROMPTLY NOTIFIED SO THAT HE MAY HAVE THE OPPORTUNITY TO TAKE WHATEVER STEPS ARE NECESSARY TO RESOLVE THEM. FAILURE TO NOTIFY THE ARCHITECT OF SUCH CONDITIONS SHALL ABSOLVE THE ARCHITECT FROM ANY RESPONSIBILITY FOR THE CONSEQUENCES OF SUCH FAILURE. ACTIONS TAKEN WITHOUT THE KNOWLEDGE OR CONSENT OF THE ARCHITECT, OR IN CONTRADICTION TO THE ARCHITECT'S WORK PRODUCT OR RECOMMENDATIONS, SHALL BECOME THE RESPONSIBILITY, NOT OF THE ARCHITECT, BUT OF THE PARTIES RESPONSIBLE FOR TAKING SUCH ACTION.



PROJECT
APPAREL REDEFINED
HEADQUARTERS FACILITIES
 1313 175th Street
 Homewood, Illinois 60430

SHEET
PRODUCTION FACILITY FLOOR PLAN

SEAL

REV	DATE	ISSUE

BY	NUMBER
BFR	A-10
PROJECT	

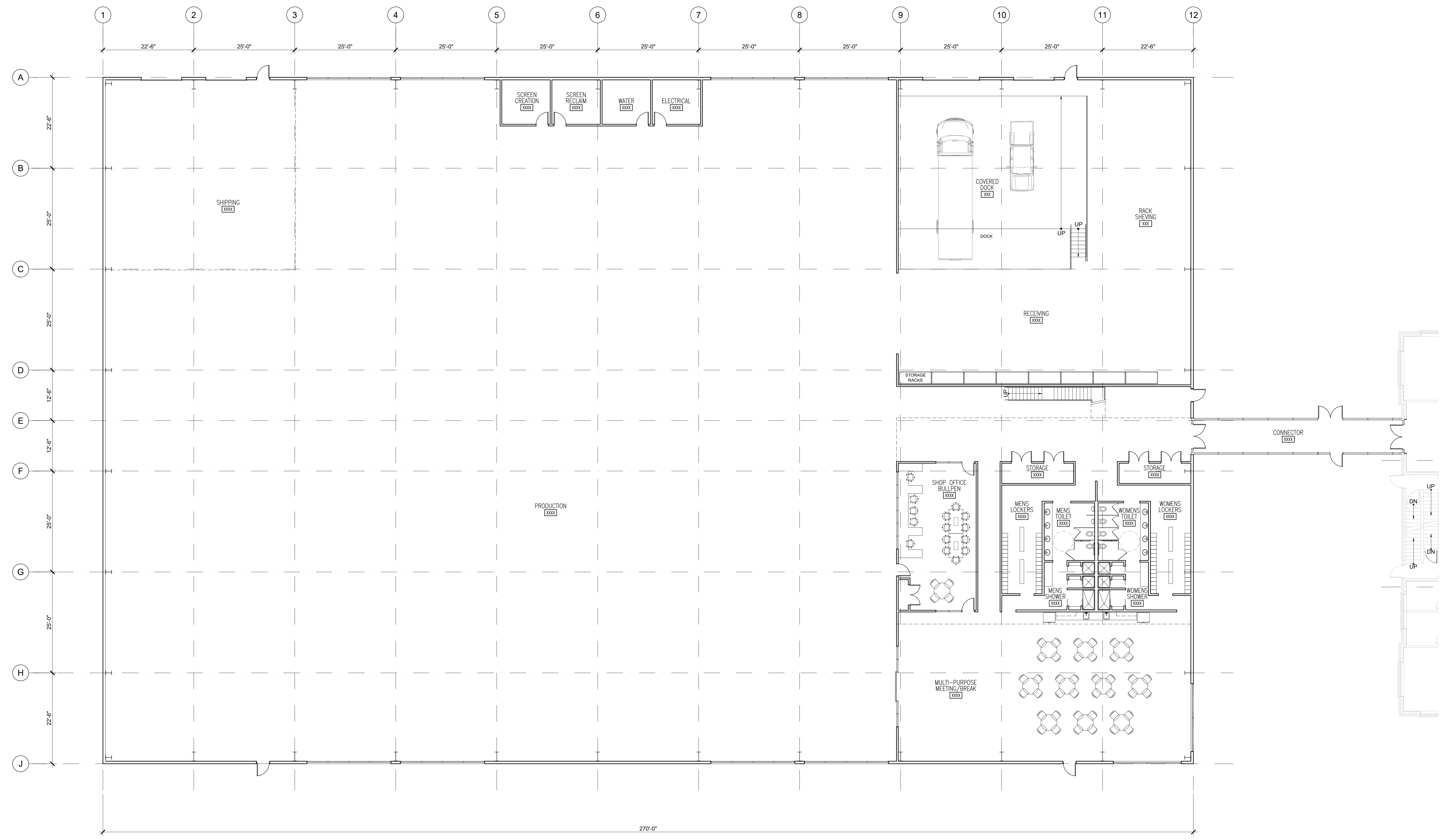

1 PRODUCTION FACILITY - GROUND FLOOR PLAN
 SCALE: 3/32" = 1'-0"

LIMITATION OF WARRANTY OF ARCHITECTS WORK PRODUCT

THE ARCHITECT AND HIS CONSULTANTS DO NOT WARRANT OR GUARANTEE THE ACCURACY AND COMPLETENESS OF THE WORK PRODUCT THEREIN BEYOND REASONABLE DILIGENCE. IF ANY MISTAKES, OMISSIONS OR DISCREPANCIES ARE FOUND TO EXIST WITHIN THE WORK PRODUCT, THE ARCHITECT SHALL BE PROMPTLY NOTIFIED SO THAT HE MAY HAVE THE OPPORTUNITY TO TAKE WHATEVER STEPS ARE NECESSARY TO RESOLVE THEM. FAILURE TO NOTIFY THE ARCHITECT OF SUCH CONDITIONS SHALL ABSOLVE THE ARCHITECT FROM ANY RESPONSIBILITY FOR THE CONSEQUENCES OF SUCH FAILURE. ACTIONS TAKEN WITHOUT THE KNOWLEDGE OR CONSENT OF THE ARCHITECT, OR IN CONTRADICTION TO THE ARCHITECT'S WORK PRODUCT OR RECOMMENDATIONS, SHALL BECOME THE RESPONSIBILITY, NOT OF THE ARCHITECT, BUT OF THE PARTIES RESPONSIBLE FOR TAKING SUCH ACTION.

PROJECT



HEADQUARTERS FACILITIES

1313 175th Street
Homewood, Illinois 60430

SHEET

PRODUCTION FACILITY FLOOR PLAN

SEAL

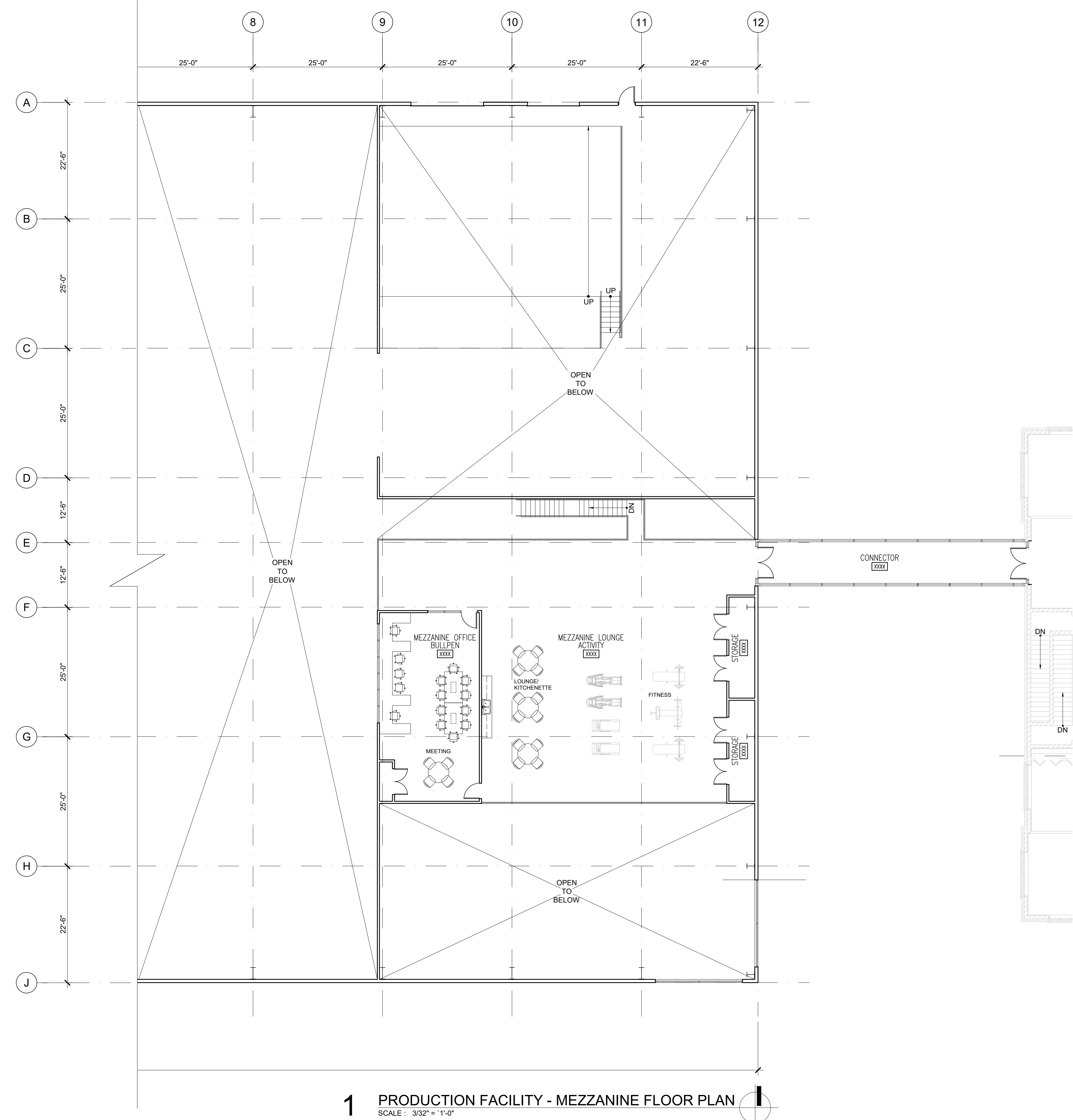

1 PRODUCTION FACILITY - MEZZANINE FLOOR PLAN
SCALE: 3/32" = 1'-0"

REV	DATE	ISSUE

BY
BFR

NUMBER
A-11

PROJECT

