



SPECIAL EVENT PERMIT APPLICATION

Please review the Event Policy Ordinance, Chapter 7 of the Town Code, to determine if your event requires a Special Event Permit. **The Permit Application must be received 60 days in advance of the event.**

Name of Event: Historic Hillsborough Half Marathon and 5K
 Event Location Address: Start/Finish: Eno River Farmers Market Pavilion
 Date(s) of event: 02OCT2022
 Event Set Up Time: 5.00AM Event Hours: 7-11AM Event Break Down: 1.00PM
 Date(s) of event: _____
 Event Set Up Time: _____ Event Hours: _____ Event Break Down: _____

EVENT ORGANIZER & CONTACT INFORMATION

Name of Organization/Company: Hillsborough Running Club
 Organization/Company mailing address: PO Box 5, Hillsborough
 Organization Status: ☐ Formal ☐ Informal ☐ For-profit ☒ Not-for-profit
 Event Organizer Name: Martin Wileman
 Event Organizer Phone: 919-536-2444 Event Organizer Email: wileman208@live.com

On-Site Contact(s) During the Day-of Event

Name: Lynda Wileman Cell Phone: 919-450-6321
 Name: Martin Wileman Cell Phone: 919-536-2444

GENERAL EVENT INFORMATION

Type of Event:

- ☐ Private Event on Private Property ☒ Public Event on Public Property
☐ Private Event on Public Property ☐ Public Event on Private Property
☒ Street or Greenway Event (Parades, Marches, Rallies, 5Ks, Bike Races)

General Event Description (Narrative outlining event purpose and elements including food trucks, car shows, races, vendors, etc):

Road race through Hillsborough, this is the 5th time holding this event. Start and finish at the Farmers Mkt Pavilion on Margaret Lane.

Race goes around town, onto the Riverwalk, then out on Dimmocks Mill and Ben Johnson Roads then returns via Riverwalk to the Speedway

track, one loop of track then finishes at the Farmers Mkt pavilion. No change in Half marathon course from past years.

Estimated total number of people that will attend the event: 700

Estimated peak time(s) of attendance: 7AM, 10AM

Maximum capacity of event location (number of persons, if applicable): 800

If the event is annual, the estimated attendance of the last event of this kind: 900

GENERAL EVENT QUESTIONNAIRE

Will tickets be sold or admission/fees be charged as part of the event? ☒ YES ☐ NO

Will there be alcohol sold or provided as a part of this event? ☒ YES ☐ NO

If yes, please indicate the vendor(s) and/or ABC permit holder(s) responsible for the alcohol sales/distribution and attach a copy of the ABC permit(s) for each vendor: TBD alcohol not for sale. Free drink with entry.

Please note: Alcohol may only be sold by vendors with an off-premise permit or by event organizers with a special one-time ABC sales permit. Alcohol sales may be subject to the prepared food & beverage tax.

Will vendors be on-site selling goods/crafts/wares during the event? ☐ YES ☒ NO

Will vendors be on-site selling food/beverages during the event? ☐ YES ☒ NO

Please note: All vendors without a physical location in town and/or food trucks that do not have Town of Hillsborough Food Truck Permits that are selling prepared food/beverage will need to [prepay the Food & Beverage Tax](#) with the Finance Department. Please list the name(s) of the food/beverage vendors:

Will you be soliciting donations as part of the event? ☒ YES ☐ NO

If yes, for what cause or organization? Local Schools/Charities Middle/High Schools, Kiwanis, Speedway Group

Will you bring additional equipment, stages, microphones, amplification, etc? ☒ YES ☐ NO

Please Explain: Timing equipment, Music, lights, barriers/tables, tents

Will any items be left at the event site overnight? ☒ YES ☐ NO

Please Explain: barriers/cones likely to be left in UHaul Truck

Will signs or banners be displayed on site or around Town? ☒ YES ☐ NO

*Please note: [Special event signage](#) must be applied for and permitted separately **BEFORE** signage is placed around town.*

Will tents be erected for the event? ☒ YES ☐ NO

If yes, how many and what size? 5-10 (all 10x10 tents)

Please note: Tents may require a permit and inspection by the Orange County Fire Marshal's office depending on size and number. Tents should be shown with location and dimensions on event map/layout.

Will you provide (portable) restroom facilities?

☒ YES ☐ NO

Please note: Restroom facilities are required to be provided by Special Event organizers depending on attendance numbers and duration. Local Business, Town, and County facility restrooms may compliment, but not become a substitute for, providing adequate restrooms for the event.

Will you provide (portable) handwashing facilities?

☐ YES ☒ NO

Please note: Handwashing facilities are required for events that include on site food preparation and/or sales without direct or immediate sink access.

Will the event require any street closures or change in traffic flow?

☒ YES ☐ NO

Will the event require additional trash and recycling facilities?

☒ YES ☐ NO

Will you request that the Town Board sponsor specific services

in conjunction with this event (i.e. Police Coverage, Road Closures, Traffic Control, Trash and Recycling Rollouts)?

☐ YES ☒ NO

Please note: Events requesting Town Sponsorship of events must apply at least 90 days in advance of the event to be considered. Event organizers who are able should make every necessary attempt to provide and pay for services at their events as the Town has limited staff and resources to cover the costs of event services.

EVENT MAP/LAYOUT REQUIREMENTS

With this application, you must attach a map of the area where the event is to take place and indicate the following:

- Traffic flow; including any streets requested to be closed or obstructed (locations of barriers and officers will be determined by Law Enforcement).
- If the event includes a parade, greenway closure, etc. then the route of the event should be clearly shown.
- Parking areas where event attendees will be directed that are adequate for event attendance. Please note: The Eno River deck has only 400 parking spaces.
- Pedestrian access and flow.
- The location of any concession stand, food truck(s), booth, or other temporary structures, tents, stages or facilities; and the location of proposed fences, stands, platforms, benches, or bleachers.
- The location of restroom and/or handwashing facilities.

A street map and a map of Gold Park are available on the Town's website. Google Maps is also an excellent resource and can be easily marked up. Contact Staff if you need assistance with providing an event layout or route map.

EVENT LIABILITY INSURANCE

Event organizers and/or property owners need to insure themselves from liability in case an event attendee injures themselves during the course of the event. Events occurring on Public Property (Town or County) are required to carry event liability insurance with the Public Property owner listed as 'additionally insured'.

Copy of event liability Certificate of Insurance is attached: ☐ YES ☒ NO

Name of insurance company providing liability coverage for the event:

Will be Road Runners Club of America, provided a few weeks prior to the event

Contact information for broker/agent providing coverage:

EVENT PROPERTY USE PERMISSION

If the event will be located on property that is not owned/managed by the event organizer then the property owner must indicate consent for the use of their property below:

TOH / OC

Name of Property Owner

Phone

N/A

Signature of Property Owner

Date

TOWN LIABILITY AGREEMENT

I, the applicant, agree to indemnify and hold harmless the Town of Hillsborough, its employees, and its agents from and against any and all liability for any injury which may be suffered in connection with this special event approval or park reservation. I also hold harmless the Town of Hillsborough, its employees, and its agents from and against any liability for any equipment or supplies lost, damaged, or stolen, that are stored or otherwise as a result of this special event.

Applicant Signature

Date

SUBMITTAL DIRECTIONS:

Please submit electronically to: Evan.Punch@hillsboroughnc.gov

Please submit via paper copy here:

Hillsborough Planning Department
ATTN: Evan Punch
P.O. Box 429
101 E. Orange Street
Hillsborough, NC 27278

FOR OFFICE USE ONLY:

Application received by: _____

Date: _____

Fee Paid: _____

Date information emailed out: _____

Permit StatusApproved ☐ YES ☐ NO Explanation: _____

Date Permit Issued: _____

Approved with any conditions: _____

By: _____

Town Staff Member

Date: _____

Forwarded to others for review/information:☐ OC Fire Marshal: _____☐ Hillsborough Police Department: _____☐ OC Sheriff's Department: _____☐ OC Fire Department: _____☐ Hillsborough Public Works: _____☐ Hillsborough Public Space Manager: _____☐ OC DEAPR (River Park): _____☐ OC AMS (Visitors Center, Library, Old or New Courthouse): _____☐ NCDOT (DOT Road Closures): _____☐ Hillsborough Finance (Food & Beverage Tax 1 Day): _____☐ Hillsborough Public Information Office: _____

4

EVENT LIABILITY INSURANCE

Event organizers and/or property owners need to insure themselves from liability in case an event attendee injures themselves during the course of the event. Events occurring on Public Property (Town or County) are required to carry event liability insurance with the Public Property owner listed as 'additionally insured'.

Copy of event liability Certificate of Insurance is attached: ☐ YES ☒ NO

Name of insurance company providing liability coverage for the event:

Will be Road Runners Club of America, provided a few weeks prior to the event

Contact information for broker/agent providing coverage:

EVENT PROPERTY USE PERMISSION

If the event will be located on property that is not owned/managed by the event organizer then the property owner must indicate consent for the use of their property below:

Name of Property Owner

Phone

Signature of Property Owner

Date

TOWN LIABILITY AGREEMENT

I, the applicant, agree to indemnify and hold harmless the Town of Hillsborough, its employees, and its agents from and against any and all liability for any injury which may be suffered in connection with this special event approval or park reservation. I also hold harmless the Town of Hillsborough, its employees, and its agents from and against any liability for any equipment or supplies lost, damaged, or stolen, that are stored or otherwise as a result of this special event.

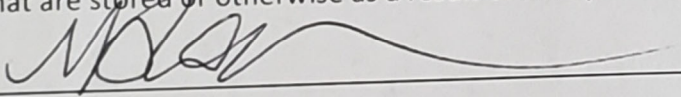

Applicant Signature

26 July 2012
Date

SUBMITTAL DIRECTIONS:

Please submit electronically to: Evan.Punch@hillsboroughnc.gov

Please submit via paper copy here:

Hillsborough Planning Department
ATTN: Evan Punch
P.O. Box 429
101 E. Orange Street
Hillsborough, NC 27278

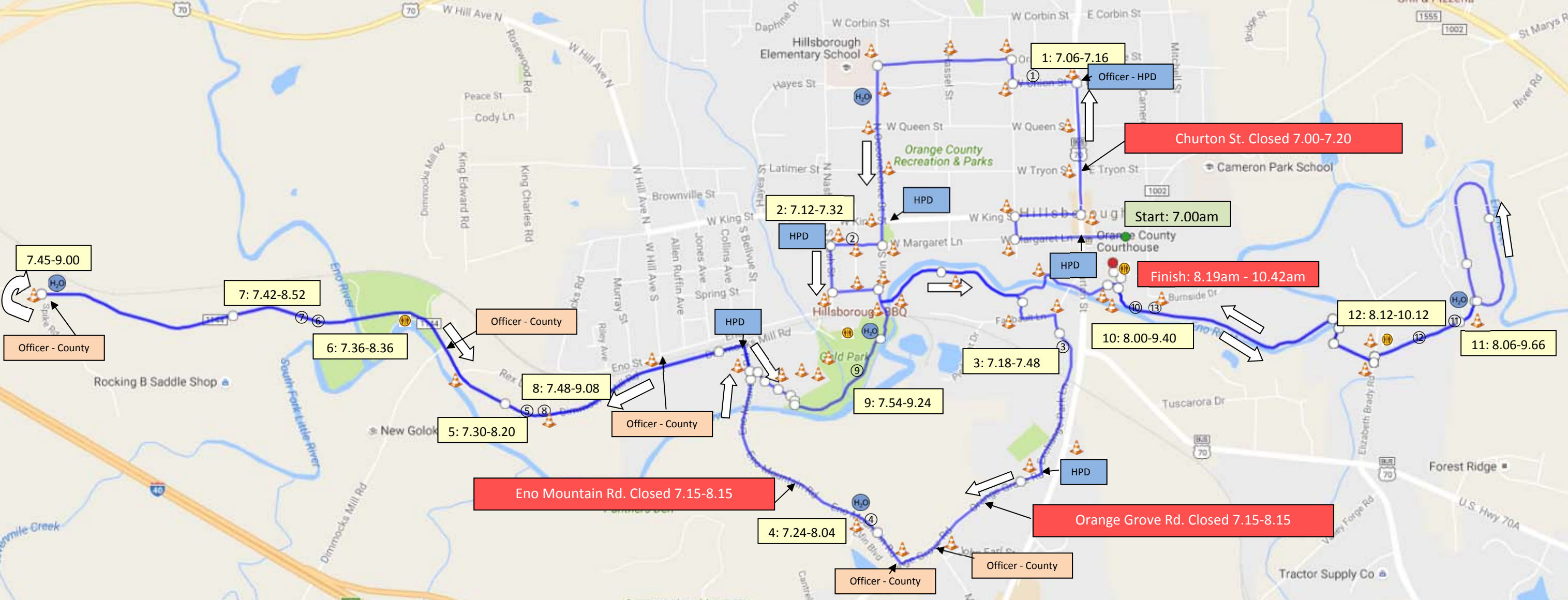

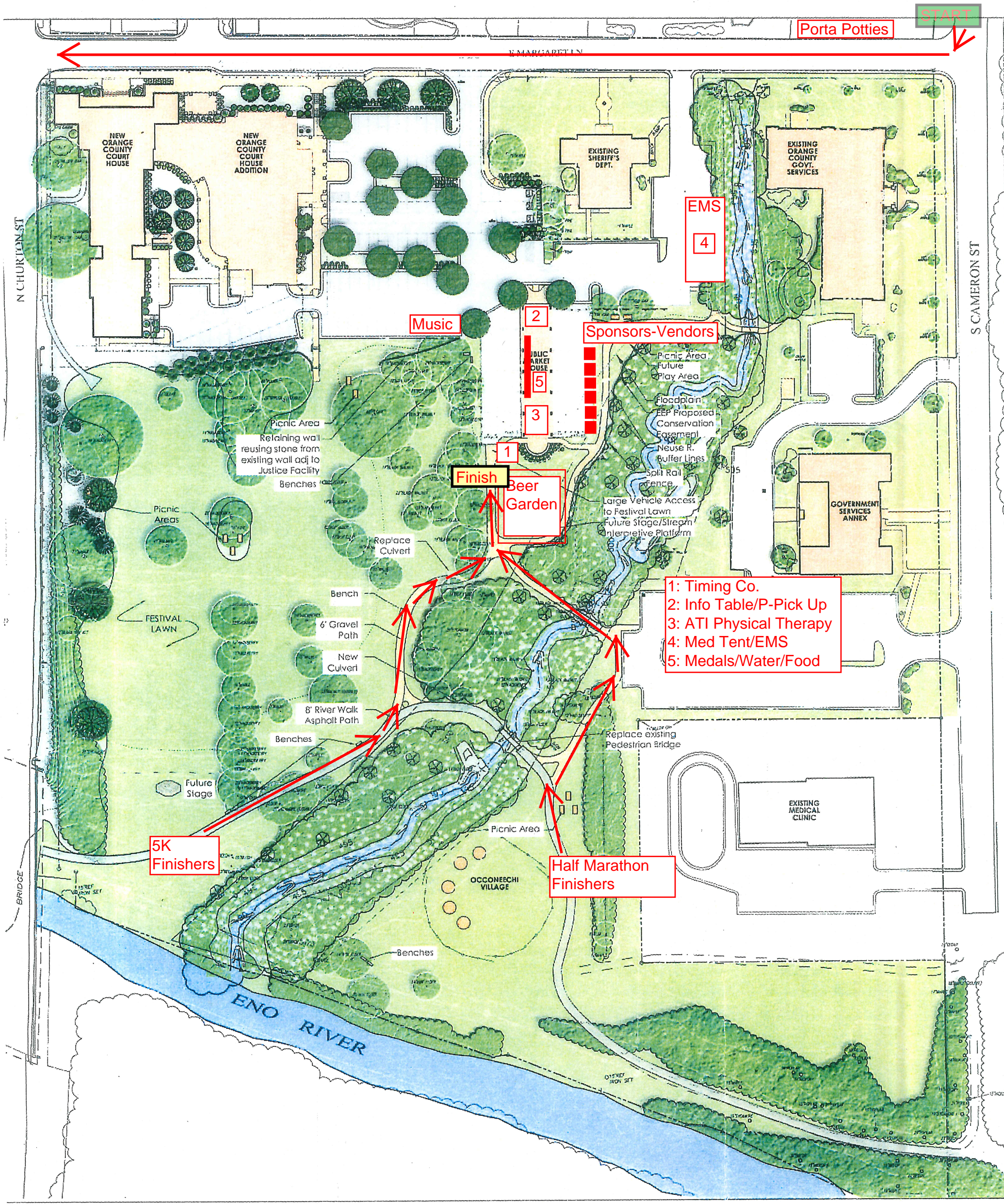

Porta Potties

START

NEW ORANGE COUNTY COURT HOUSE

NEW ORANGE COUNTY COURT HOUSE ADDITION

EXISTING SHERIFF'S DEPT.

EXISTING ORANGE COUNTY GOVT. SERVICES

EMS

4

Music

2

Sponsors-Vendors

5

3

Finish

Beer Garden

- 1: Timing Co.
- 2: Info Table/P-Pick Up
- 3: ATI Physical Therapy
- 4: Med Tent/EMS
- 5: Medals/Water/Food

5K Finishers

Half Marathon Finishers

ENO RIVER

From 70, 57, 86

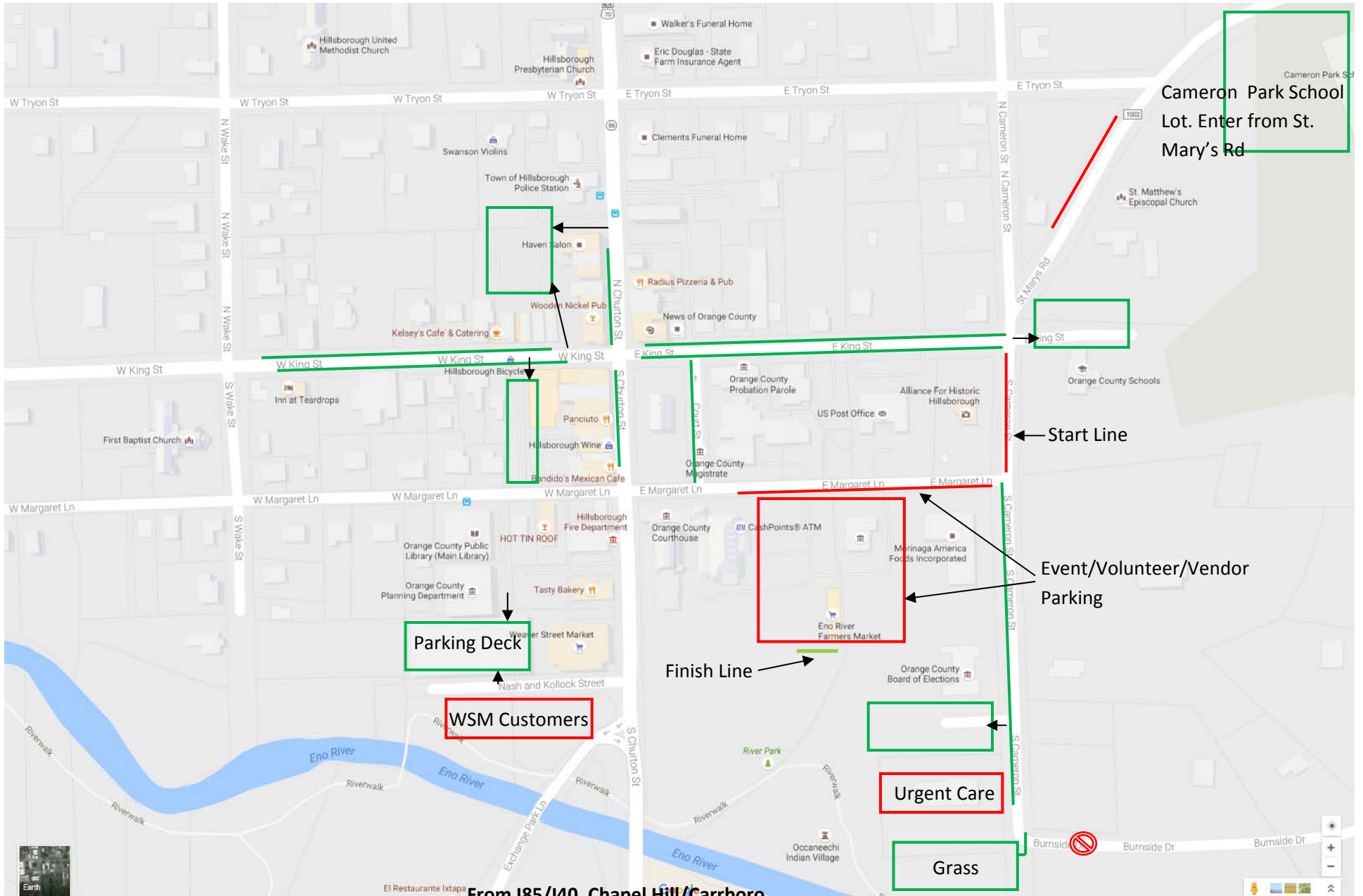

From 185/I40, Chapel Hill/Carrboro

☒ Check ☐ Cash ☐ Credit Card

059927

1163

TOWN OF HILLSBOROUGH

\$ 55.00 Hillsborough, NC, July 26, 20 22

Received of Hillsboro Running Club
FIFTY FIVE AND 00/100 Dollars

☐ Meter Deposit ☐ W/S Tap Fees ☒ Planning SPECIAL EVENT FEE ☐ Utility Donation
☐ Privilege License ☐ Park Rental ☐ Stormwater ☐ Connect Fee
☐ Other By SNC