

SECTION: 93060000
STATE ROAD: A1A
PERMIT: 2023-L-496-00005
COUNTY: PALM BEACH

**AMENDMENT NUMBER NINE (9) TO
FLORIDA DEPARTMENT OF TRANSPORTATION, DISTRICT FOUR (4)
LANDSCAPE INCLUSIVE MAINTENANCE MEMORANDUM OF AGREEMENT**

THIS AMENDMENT Number Nine (9) to the Agreement dated July 20, 2017, made and entered into this _____ day of _____ 20____ by and between the State of Florida Department of Transportation, hereinafter called the **DEPARTMENT**, and the **TOWN OF HIGHLAND BEACH**, a municipal corporation of the State of Florida, hereinafter called the **AGENCY**.

W I T N E S S E T H

WHEREAS, the parties entered into the Landscape Inclusive Maintenance Memorandum of Agreement dated, July 20, 2017 for the purpose of maintaining the landscape improvements by the AGENCY on State Road A1A (South Ocean Boulevard); and,

WHEREAS, the DEPARTMENT and the AGENCY have agreed to add additional landscape by permit to be installed on State Road A1A (South Ocean Boulevard) in accordance with the above referenced Agreement; and,

NOW THEREFORE, for and in consideration of mutual benefits that flow each to the other, the parties covenant and agree as follows:

1. Pursuant to Page 7, Paragraph 7 of the Landscape Inclusive Maintenance Memorandum of Agreement for State Road A1A (South Ocean Boulevard) dated July 20, 2017, the DEPARTMENT will allow an adjacent property owner to construct additional landscape improvements or to modify an improvement as indicated in **Exhibit "A"**, State Road A1A (South Ocean Boulevard) from M.P. 7.644 to M.P. 7.629, in accordance with the plans attached as **Exhibit "B"**.
2. The AGENCY shall agree to maintain the additional landscape improvements in the Agreement described above according to Part I of the Maintenance Plan, Exhibit "E" of the original agreement and Part II as follows:

Part II - Specific Project Site Maintenance Requirements and Recommendations:

1. Medjool Palms are intended to be maintained at mature height and spread. Prune once yearly, removing only those fronds that are dead or falling below 9 o'clock & 3 o'clock. Remove all fruit clusters.
2. Inspect groundcovers and shrubs on a bi-monthly basis for maintaining full ground coverage.
3. Groundcover and shrub lateral growth shall be maintained to prevent foliage from growing beyond the limits of the planting areas shown on the plan. Maintain a 2" setback from the foliage to the back of curb, pavement, and/or sidewalk.
4. Maintain the vertical height of:
 - Podocarpus between 30" and 36", full to ground
 - Muhly grass at mature height; trim down to 10" one time per year in winter
5. Evaluate plant material on a bi-monthly basis for pests and diseases. If required, follow the integrated pest management program established by the Agency to ensure healthy plants.
6. Joints and cracks in concrete, concrete pavers, concrete curbs, expansion joints, catch basins, gutter areas, etc. shall be inspected on a bi-monthly basis to keep those areas free of weeds.
7. Inspect the irrigation system performance on a bi-monthly basis to ensure the system's pressure is providing adequate coverage. Clean or replace any irrigation nozzles that are not properly functioning.
8. Inspect synthetic turf driveway banding twice a year and repair or replace as required per manufacturer's recommendations.

Except as modified by this Amendment, all terms and conditions of the original Agreement and all Amendments thereto shall remain in full force and effect.

LIST OF EXHIBITS

- Exhibit A - Landscape Improvements Maintenance Boundaries Limits
- Exhibit B - Landscape Improvement Plans

IN WITNESS WHEREOF, the parties hereto have executed this Agreement effective the day and year first written above.

TOWN OF HIGHLAND BEACH

By: _____ Date: _____
Chairperson / Mayor / Manager

Attest: _____ (SEAL)
Town Clerk

Legal Approval: _____

**STATE OF FLORIDA
DEPARTMENT OF TRANSPORTATION**

By: _____ Date: _____
Transportation Development Director

Attest: _____ (SEAL)
Executive Secretary

Legal Review: _____
Office of the District General Counsel

SECTION:	93060000
STATE ROAD:	A1A
PERMIT:	2023-L-496-00005
COUNTY:	PALM BEACH

EXHIBIT A

LANDSCAPE IMPROVEMENTS MAINTENANCE BOUNDARIES LIMITS

I. ORIGINAL INCLUSIVE LANDSCAPE MAINTENANCE AGREEMENT LIMITS:

State Road A1A (South Ocean Boulevard) from approximately ¼ mile North of Spanish River Blvd (M.P. 4.868) to approximately ½ mile South of Linton Blvd (M.P. 7.711)

II. LANDSCAPE PERMIT PROJECT LIMITS (THIS PROJECT)*:

State Road A1A (2362 South Ocean Boulevard) from M.P. 7.644 to M.P. 7.629

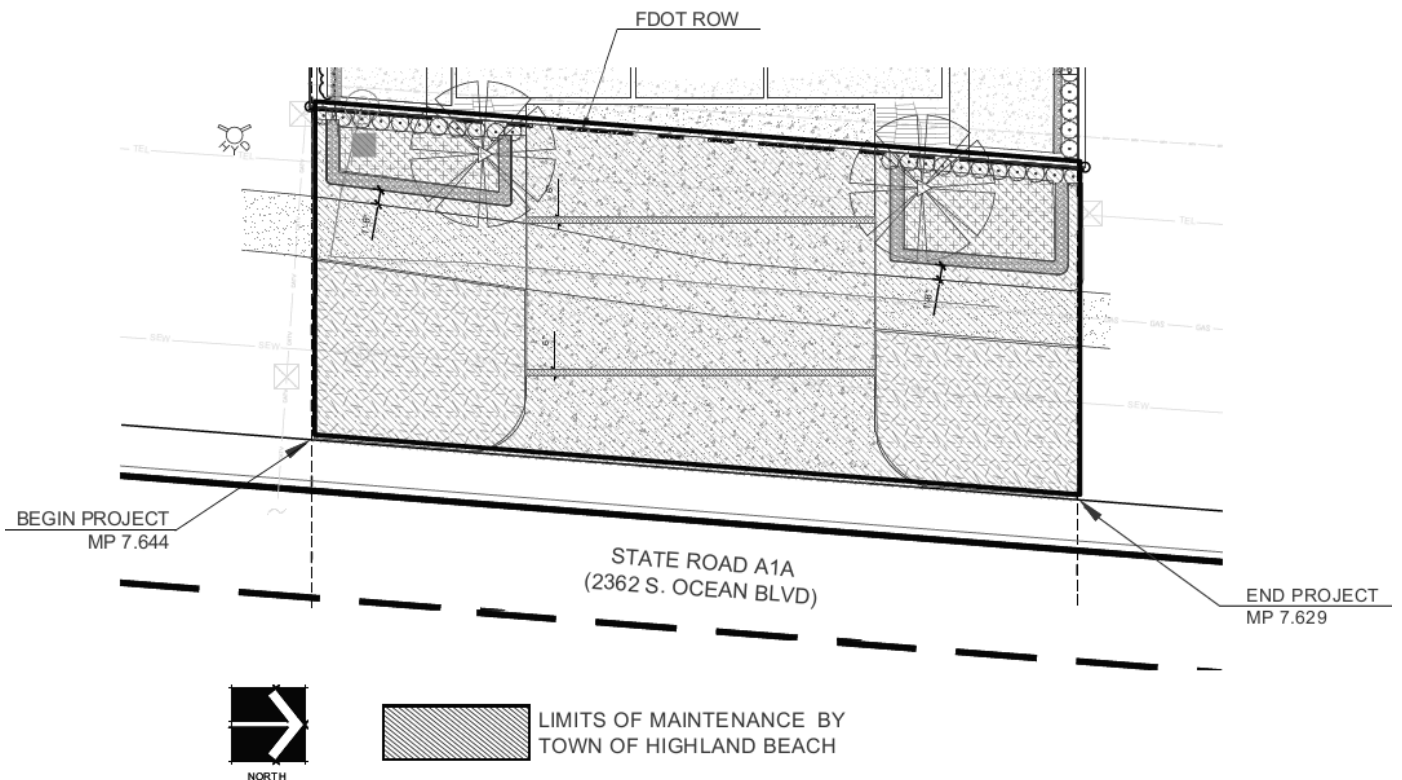

***All other limits of the original agreement and amendments shall apply**

SECTION:	93060000
STATE ROAD:	A1A
PERMIT:	2023-L-496-00005
COUNTY:	PALM BEACH

EXHIBIT B

LANDSCAPE IMPROVEMENT PLANS

The AGENCY agrees to install the landscape improvements in accordance with the plans and specifications attached hereto and incorporated herein.

Please see attached plans prepared by: James B. Euell, PLA
Suarez Engineering
October 30, 2023

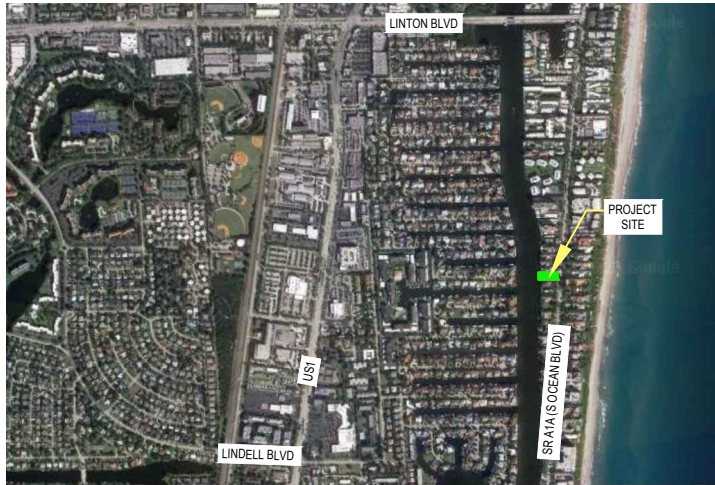

LOCATION MAP



PRIVATE RESIDENCE 2362 S. OCEAN BLVD HIGHLAND BEACH, FL

SCOPE OF WORK

STATE ROAD A1A (S. OCEAN BLVD)
MILE POST: 7.644 TO 7.629

FDOT SPECIFICATIONS AND DESIGN STANDARDS

Governing Standard Plans: Florida Department of
Transportation, FY 2022-23 Standard Plans for Road
and Bridge Construction and applicable Interim
Revisions (IRs)

Governing Standard Specifications: Florida Department
of Transportation, July 2022 Standard Specifications for
Road and Bridge Construction

ROADWAY DESIGN SPEED FOR A1A = 35 MPH

INDEX OF SHEETS

SHEET No.	TITLE
CS-1	COVER SHEET

LANDSCAPE ARCHITECTURE

LP-1	LANDSCAPE PLAN
LP-2	LIMITS OF CLEAR SIGHT PLAN
LP-3	NOTES & DETAILS

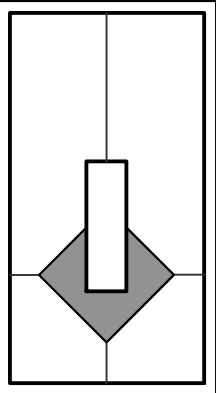

PROJECT NAME & LOCATION:

PRIVATE CLIENT

TWO STORY HOME ADDITION AND RENOVATION
2362 S. OCEAN BLVD.
HIGHLAND BEACH, FL 33487

DISTRIBUTION:	DATE:

DRAWING NAME:

**COVER SHEET
SHEET**

DRAWING NUMBER:

CS-1

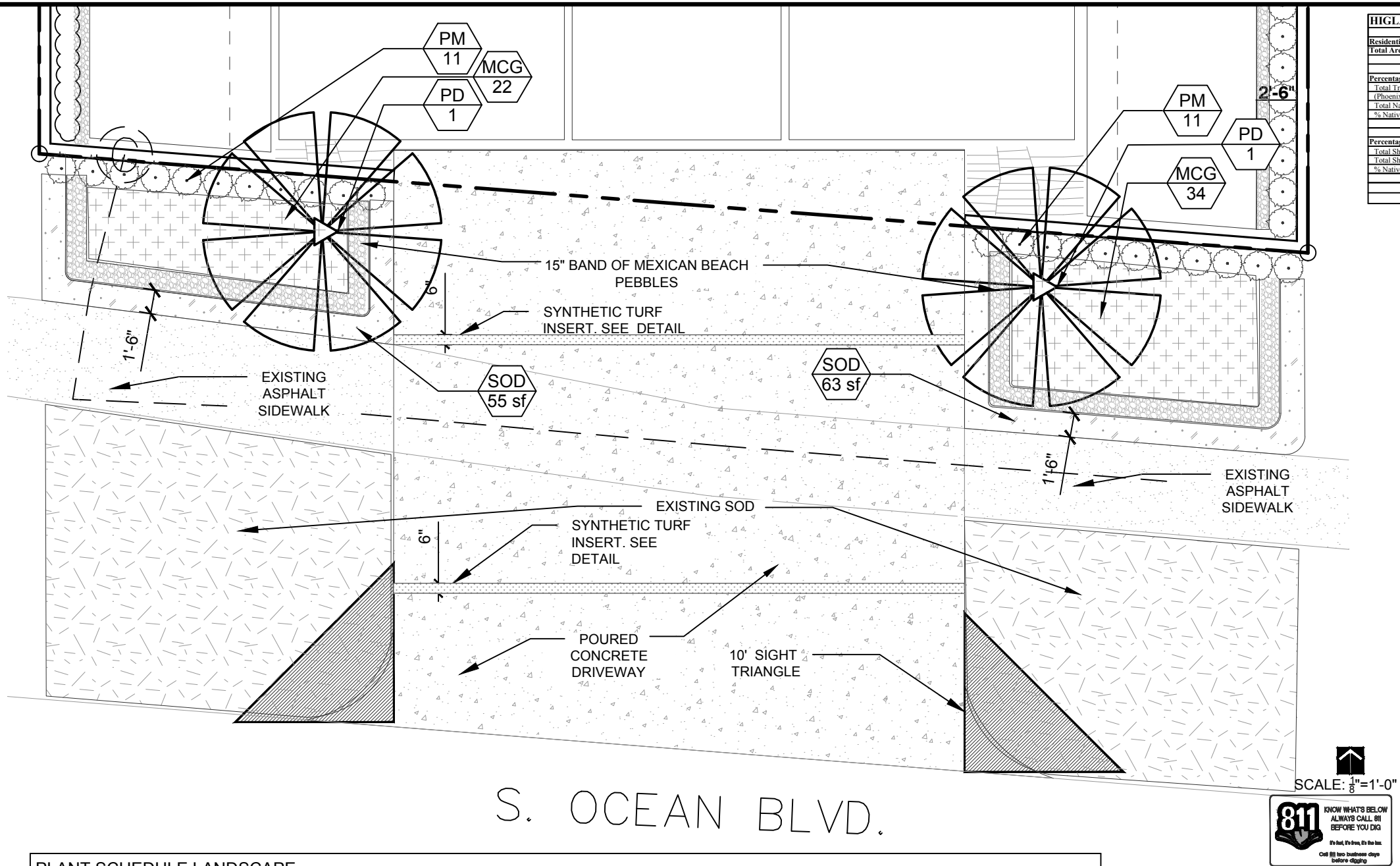

HIGHLAND BEACH PLANTING CALCULATIONS	
Residential Single Family	
Total Area: 14,652 S.F. 0.33AC:	Total Tree Requirement:
Percentage of Drought Tolerant / Native Trees	
Total Trees / Palms (Not including existing trees)	
(Phoenix & Roystonea elata counted 1:1 / All others counted 3:1)	
Total Native Trees / Palms	
% Native or Drought Tolerant Trees / Palms	
Percentage of Drought Tolerant Shrubs / Accents	
Total Shrubs / Accents @ 24" planted in or greater	
Total Shrubs / Accents	
% Native or Drought Tolerant Shrubs / Accents	
Landscape Area Provided	
Landscape Area Percentage	

GENERAL PLANTING REQUIREMENTS

All sizes shown for plant material on the plans are to be considered Minimum. All plant material must meet or exceed these minimum requirements for both height and spread. Any other requirements for specific shape or effect as noted on the plan(s) will also be required for final acceptance.

All plant material furnished by the landscape contractor shall be Florida #1 or better as established by "Grades and Standards for Florida Nursery Plants" and "Grades and Standards for Florida Nursery Trees". All material shall be installed as per CSI specifications.

All plant material (except SOD) as included herein shall be warranted by the landscape contractor for a minimum period of 12 months.

All plant material shall be planted in planting soil that is delivered to the site in a clean loose and friable condition. All soil shall have a well drained characteristic. Soil must be free of all rocks, sticks, and objectionable material including weeds and weed seeds as per CSI specifications.

Twelve inches (12") of planting soil 50/50 sand/topsoil mix is required around and beneath the root ball of all trees and palms, and 1 cubic yard per 50 bedding or groundcover plants.

All landscape areas shall be covered with Eucalyptus or sterilized seed free Melaleuca mulch to a minimum depth of three inches (3") of cover when settled. A four-inch clear space must be left for air between plant bases and the mulch. Cypress bark mulch shall not be used.

All plant material shall be thoroughly watered in at the time of planting; no dry planting permitted. All plant materials shall be planted such that the top of the plant ball is flush with the surrounding grade.

All landscape and lawn areas shall be irrigated by a fully automatic sprinkler system adjusted to provide 100% coverage of all landscape areas. All heads shall be adjusted to 100% overlap as per manufacturers specifications and performance standards utilizing a rust free water source. Each system shall be installed with a rain sensor.

It is the sole responsibility of the landscape contractor to insure that all new plantings receive adequate water during the installation and during all plant warranty periods. Deep watering of all new trees and palms and any supplemental watering that may be required to augment natural rainfall and site irrigation is mandatory to insure proper plant development and shall be provided as a part of this contract.

All plant material shall be installed with fertilizer, which shall be State approved as a complete fertilizer containing the required minimum of trace elements in addition to N-P-K, of which 50% of the nitrogen shall be derived from an organic source as per CSI specifications.

Contractors are responsible for coordinating with the owners and appropriate public agencies to assist in locating and verifying all underground utilities prior to excavation.

The plan takes precedence over the plant list.

SPECIAL INSTRUCTIONS

General site and berm grading to +/- 1 inch (1") shall be provided by the general contractor. All finished site grading and final decorative berm shaping shall be provided by the landscape contractor.

All sod areas as indicated on the planting plan shall receive Stenotaphrum secundatum, St. Augustine 'Palmetto' solid sod. It shall be the responsibility of the landscape contractor to include in the bid, the repair of any sod which may be damaged from the landscape installation operations.

PLANT SCHEDULE LANDSCAPE									
PALM TREES	QTY	BOTANICAL NAME	COMMON NAME	CONT	CAL	SIZE	NATIVE	DROUGHT	
PD	2	PHOENIX DACTYLIFERA 'MEDJOL'	MEDJOL DATE PALM	FG/B&B		14' CT, NUT INCLUDED, MATCHED	NO	HIGH	
SHRUBS	QTY	BOTANICAL NAME	COMMON NAME	CONT	CAL	SIZE	NATIVE	DROUGHT	SPACING
PM	11	PODOCARPUS MACROPHYLLUS	YEW PINE	-		30" HT. X 24" SPD	NO	HIGH	24" o.c.
SOD/SEED	QTY	BOTANICAL NAME	COMMON NAME	CONT	CAL	SIZE	NATIVE	DROUGHT	SPACING
SOD	118 SF	STENOTAPHRUM SECUNDATUM 'FLORITAM'	'FLORITAM' ST. AUGUSTINE SOD	SOD					
TALL GROUND COVERS	QTY	BOTANICAL NAME	COMMON NAME	CONT	CAL	SIZE	NATIVE	DROUGHT	SPACING
MCG	56	MUHLENBERGIA CAPILLARIS	PINK MUHLY GRASS	-	YES	24" HT. X 24" SPR.	YES	MEDIUM	24" o.c.

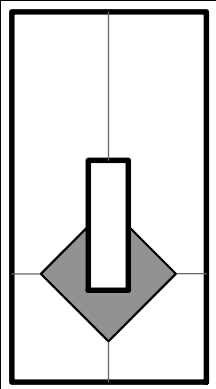

PROJECT NAME & LOCATION:
PRIVATE CLIENT
TWO STORY HOME ADDITION AND RENOVATION
2362 S. OCEAN BLVD.
HIGHLAND BEACH, FL 33487

DISTRIBUTION:	DATE:

DRAWING NAME:
LANDSCAPE PLAN

DRAWING NUMBER:
LP-1

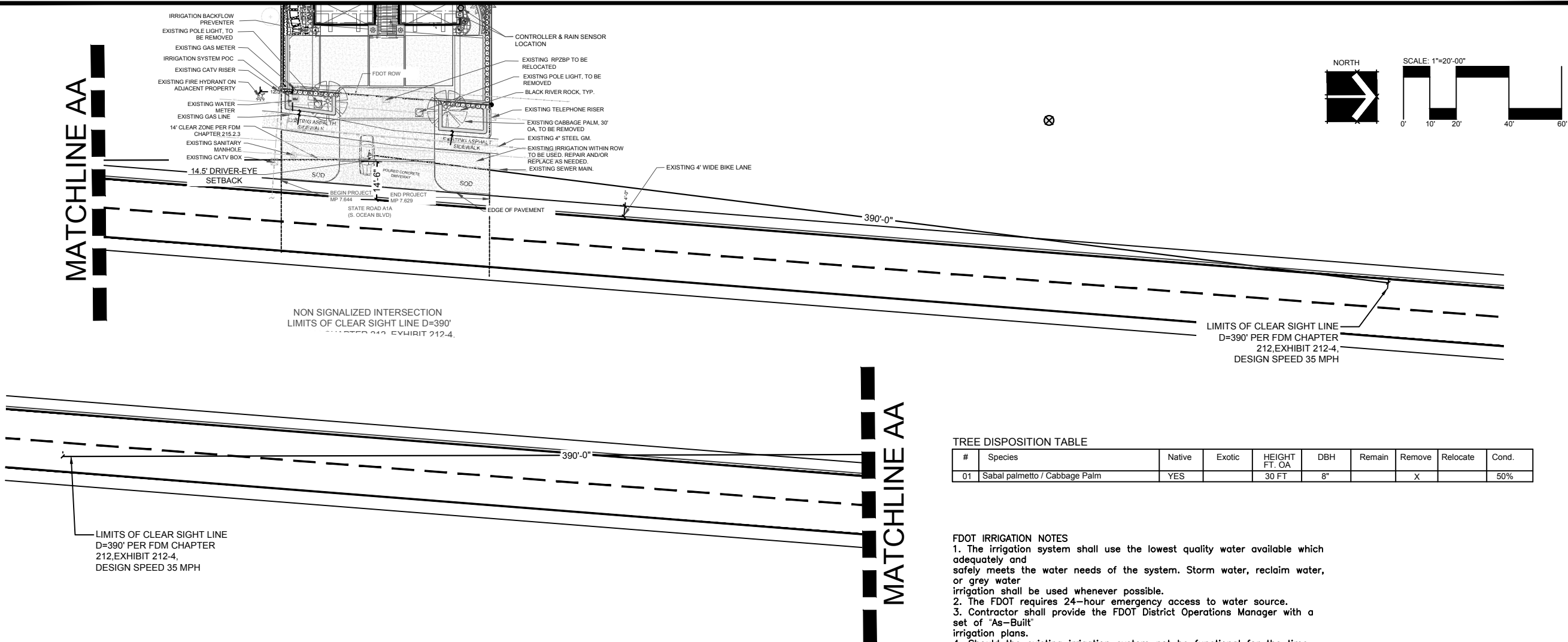

TREE DISPOSITION TABLE									
#	Species	Native	Exotic	HEIGHT FT. OA	DBH	Remain	Remove	Relocate	Cond.
01	Sabal palmetto / Cabbage Palm	YES		30 FT	8"		X		50%

FDOT IRRIGATION NOTES

- The irrigation system shall use the lowest quality water available which adequately and safely meets the water needs of the system. Storm water, reclaim water, or grey water irrigation shall be used whenever possible.
- The FDOT requires 24-hour emergency access to water source.
- Contractor shall provide the FDOT District Operations Manager with a set of 'As-Built' irrigation plans.
- Should the existing irrigation system not be functional for the time during construction, ensure that measures are taken to water the existing plant material and sod. This may include portions of the landscape areas outside the renovation area depending on how the system is zoned.
- Note that 100% coverage must be achieved in the landscape areas where existing irrigation modifications occur.
- To ensure the entire existing irrigation system is restored to fully functional condition, the contractor and maintaining agency are to perform a pre-construction visual inspection and performance test to document the condition of the existing system. Any repairs that are required to the existing system to remain will be performed by the maintaining agency prior to construction. Any existing or proposed components that are damaged during construction or the warranty period will be the responsibility of the contractor. The entire system must be restored to the same condition it was in before the start of construction.

- GOVERNING STANDARD PLANS: Florida Department of Transportation, FY 2022-23 Standard Plans for Road and Bridge Construction and applicable Interim Revisions. (IR's)
website: <https://www.fdot.gov/design/standardplans>
- GOVERNING STANDARD SPECIFICATIONS: Florida Department of Transportation, July 2022 Standard Specifications for Road and Bridge Construction.
website:

FDOT GENERAL NOTES

- Architectural Pavers installation for sidewalks, medians, driveways, or roadways within the FDOT right of way shall comply with current FDOT Standard Specification 526.
Online Reference: https://fdotwww.blob.core.windows.net/sitefinity/docs/default-source/programmanagement/implemented/specbooks/fy-2023-24/fy2023-24ebook.pdf?sfvrsn=6b69416d_6

FDOT PLANTING NOTES

- For the portion of landscape plant material that will be installed within the FDOT Right of Way, landscape installation shall comply with current applicable FDOT Maintenance Specification 580. Online Reference: [ssm5800000wd-722-i17992.pdf \(windows.net\)](https://fdotwww.blob.core.windows.net/sitefinity/docs/default-source/design/standardplans/2023/idx/580-001.pdf?)
- For the portion of landscape plant material that will be installed within the FDOT Right of Way refer to the FDOT Standard Plans Index 580-001 Landscape Installation.
Online Reference: <https://fdotwww.blob.core.windows.net/sitefinity/docs/default-source/design/standardplans/2023/idx/580-001.pdf?>
- Cypress Mulch is not permitted on FDOT right of way. Mulch permitted to be used are Hardwood Mulch (containing no Cypress products), Recycled Mulch or approved equal, certified by the Mulch and Soil Council (MSC). Submit proof of certification to the FDOT District Operations Permit Landscape Inspector upon inspection.
- Sodded areas will be in accordance with Standard Plans Index 570-010 and Standard Specifications Sections 162, 570, 981, 982, 983, 987 of the Department's latest edition of Governing Design Standards and Standard Specifications. All disturbed areas will be sodded within one (1) week of installation of said permitted work.

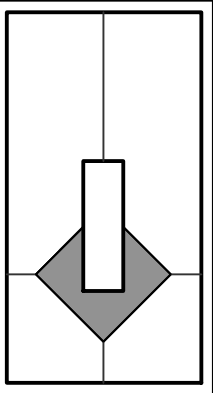

PROJECT NAME & LOCATION:

PRIVATE CLIENT

TWO STORY HOME ADDITION AND RENOVATION
2362 S. OCEAN BLVD.
HIGHLAND BEACH, FL 33487

DISTRIBUTION:	DATE:

DRAWING NAME:

LIMITS OF CLEAR SIGHT PLAN

DRAWING NUMBER:

LP-2

FDOT GENERAL NOTES

- GOVERNING STANDARD PLANS: Florida Department of Transportation, FY 2022-23 Standard Plans for Road and Bridge Construction and applicable Interim Revisions. (IR's)
website: <https://www.fdot.gov/design/standardplans>
- GOVERNING STANDARD SPECIFICATIONS: Florida Department of Transportation, July 2022 Standard Specifications for Road and Bridge Construction.
website: <https://www.fdot.gov/programmanagement/implemented/specbooks>
- Contractor shall repair any and all damage done to FDOT property during demolition, relocation &/or installation activities at his sole expense.
- Any plant material substitution within or impacting the FDOT Right of Way whether requested by the Contractor, Owner, Landscape Architect or other will need to get approval from the FDOT District Landscape Architect.
- Ownership of all suitable excavated materials, as determined by the Department, shall remain in the Department until a final acceptance of the permitted project is fulfilled. Excavated materials shall be hauled by the Permittee, at their cost and expense from the site to the Broward Operations Center or stockpiled in those areas as directed by the Department, including asphalt millings.
- Maintenance of Traffic (MOT) for this project will comply with FDOT Standard Plans Index (102 Series) and the latest edition of the Manual of Uniform Traffic Control Devices (MUTCD). Special attention will be given to FDOT Design Plans Standard Index 102-005, 102-010, 102-045, and 102-075.
- Permittee will restore the Right-Of-Way as a minimum, to its original condition or better in accordance w/ FDOT's latest Standard Specifications for Road and Bridge Construction or as directed by the Resident Operations Engineer.
- Restricted hours of operations will be from 9:00am to 3:30pm, (Monday-Friday), unless otherwise approved by the operations Engineer, or designee.
- Permittee will ensure that all locates have been performed prior to scheduling of any WORKING activities. This shall include soft digs to verify vertical and horizontal alignment.
- Permittee will coordinate all work with Asset Managment. Contact David Moore of Transfield Services at 954-317-8044, moore@transfieldservices.com. Coordination will include a Pre-Construction meeting.

FDOT PLANTING NOTES

- For the portion of landscape plant material that will be installed within the FDOT Right of Way landscape installation shall comply with current FDOT Maintenance Specifications 580-2.1. Online Reference: <http://www.fdot.gov/programmanagement/Maintenance/2022July/default.shtm>.
- For the portion of landscape plant material that will be installed within the FDOT Right of Way refer to FDOT Standard Plans Index 580-001 Landscape Installation. Online Reference: <http://www.fdot.gov/design/standardplans/current/IDx/580-001.pdf>
- No Category I or II invasive plants shall be planted on FDOT right of way.
- Cypress Mulch is not permitted on FDOT right of way. Mulch permitted to be used are Hardwood Mulch (containing no Cypress products), Recycled Mulch or approved equal, certified by the Mulch and Soil Council (MSC). Submit proof of certification to the FDOT District Operations Permit Landscape Inspector upon inspection.

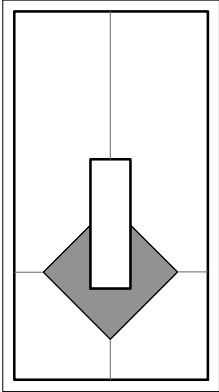
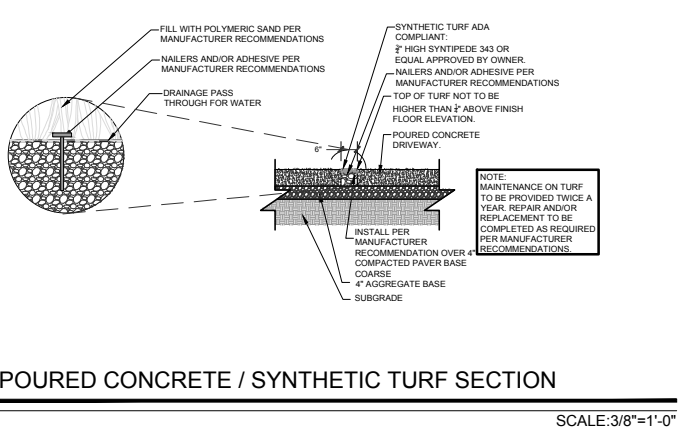
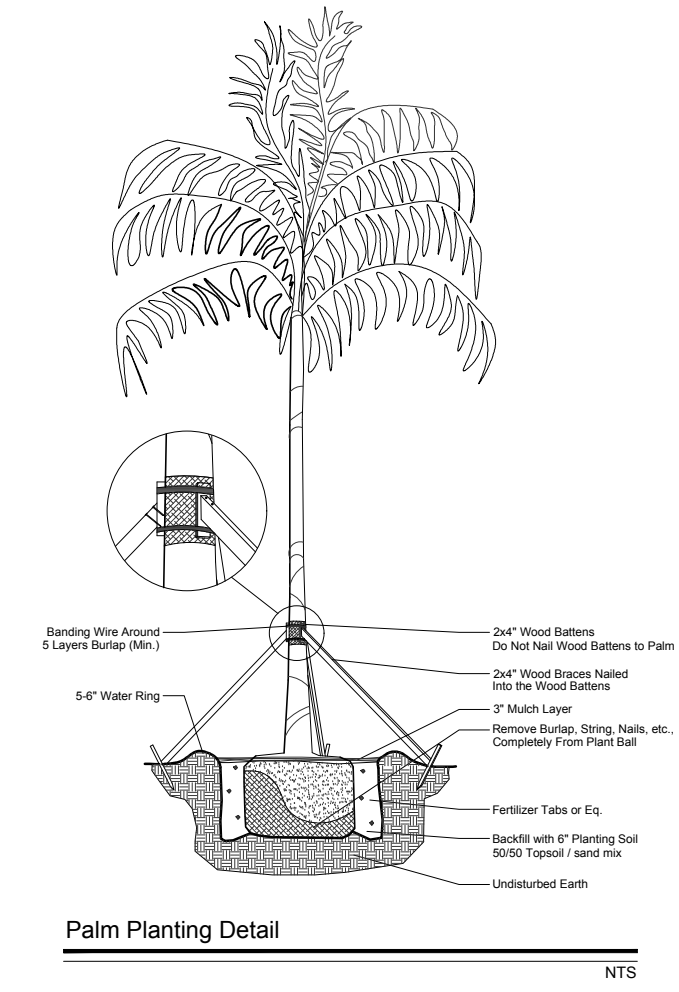
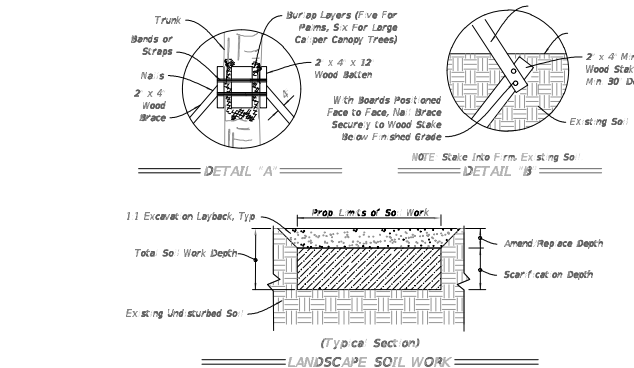
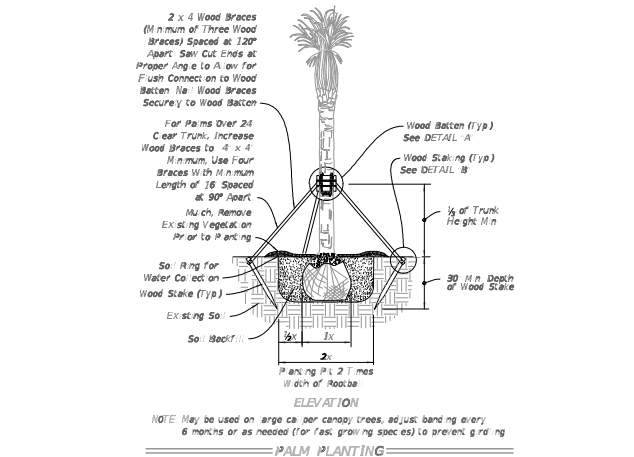
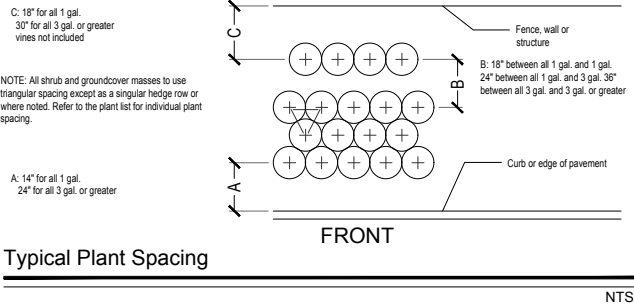
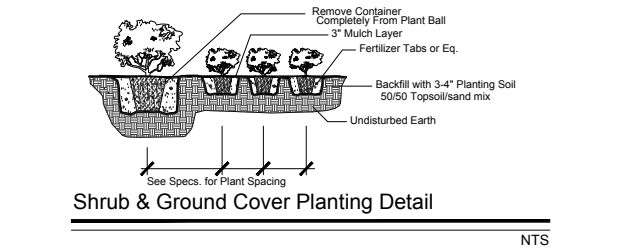

PROJECT NAME & LOCATION:
PRIVATE CLIENT
TWO STORY HOME ADDITION AND RENOVATION
2362 S. OCEAN BLVD.
HIGHLAND BEACH, FL 33487

DISTRIBUTION:	DATE:

DRAWING NAME:
**NOTES
& DETAILS**

DRAWING NUMBER:
LP-3