

RECEIVED

NOV 07 2023

HIGHLAND BEACH
BUILDING DEPARTMENT

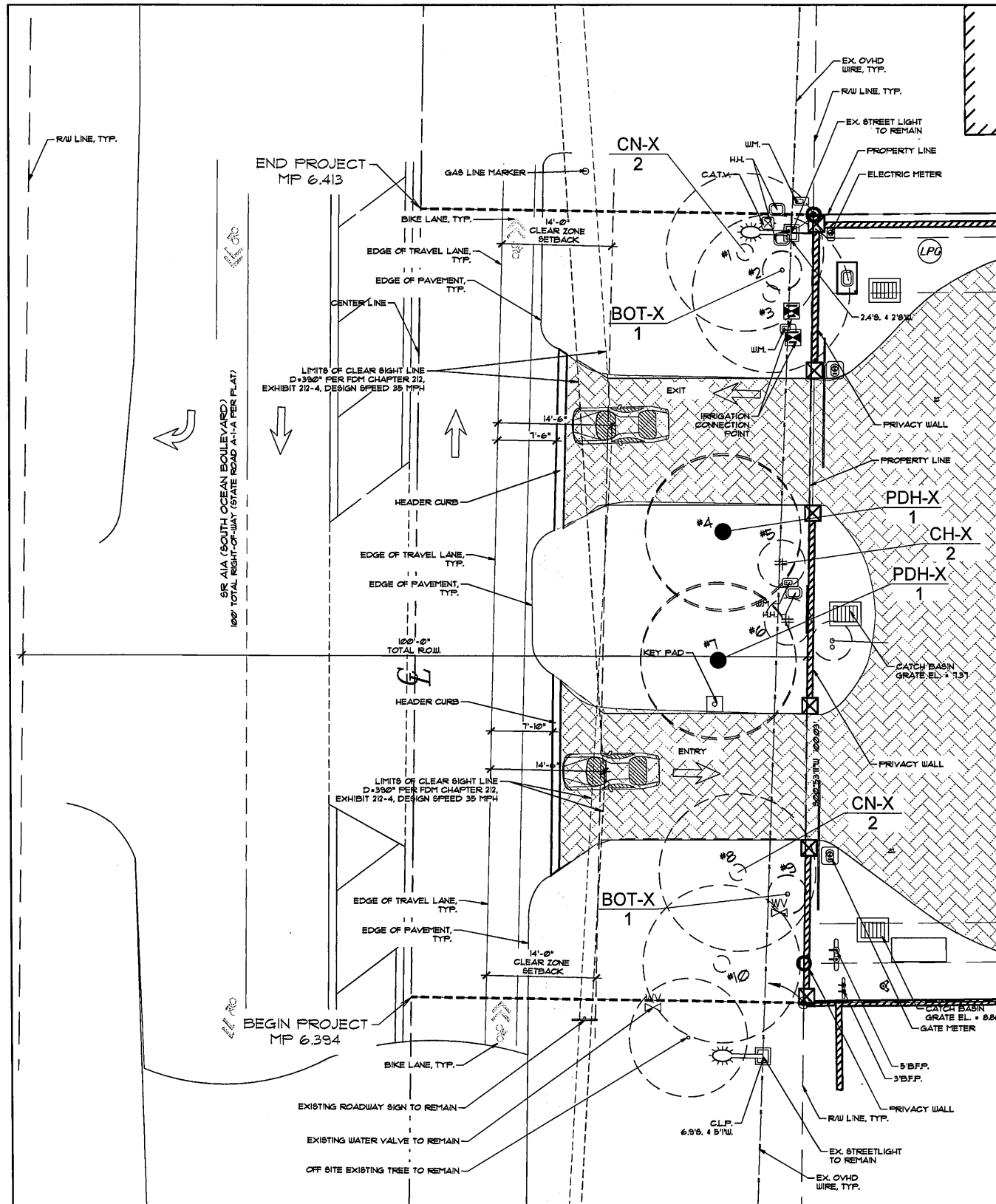

TREE DISPOSITION CHART										
SHEET NUMBER	TREE/PALM NO.	SYMBOL	BOTANICAL NAME	COMMON NAME	DBH (IN.) FOR TREES CTH (FT.) FOR PALMS	HEIGHT (FT.) (APPROX.)	CANOPY SPREAD (FT.) (APPROX.)	CONDITION	DISPOSITION	NOTES
L-2	1	CN-X	Cocus nucifera	Green Malayan Coconut	25	25 GW	18	FAIR	REMOVE	APPROVAL PERMIT TO BE PROVIDED
L-2	2	BOT-X	Hyphorbe lagenicaulis	Bottle Palm	6	6 GW	7	FAIR	REMOVE	APPROVAL PERMIT TO BE PROVIDED
L-2	3	CN-X	Cocus nucifera	Green Malayan Coconut	20	20 GW	18	FAIR	REMOVE	APPROVAL PERMIT TO BE PROVIDED
L-2	4	PDH-X	Phoenix dactylifera 'Medjool'	Medjool Date Palm	30	30 GW	20	FAIR	REMOVE	APPROVAL PERMIT TO BE PROVIDED
L-2	5	CH-X	Chamaerops humilis	Mediterranean Fan Palm	5	5 GW	3	POOR	REMOVE	APPROVAL PERMIT TO BE PROVIDED
L-2	6	CH-X	Chamaerops humilis	Mediterranean Fan Palm	10	10 GW	6	FAIR	REMOVE	APPROVAL PERMIT TO BE PROVIDED
L-2	7	PDH-X	Phoenix dactylifera 'Medjool'	Medjool Date Palm	30	30 GW	20	FAIR	REMOVE	APPROVAL PERMIT TO BE PROVIDED
L-2	8	CN-X	Cocus nucifera	Green Malayan Coconut	25	25 GW	18	FAIR	REMOVE	APPROVAL PERMIT TO BE PROVIDED
L-2	9	BOT-X	Hyphorbe lagenicaulis	Bottle Palm	6	6 GW	7	FAIR	REMOVE	APPROVAL PERMIT TO BE PROVIDED
L-2	10	CN-X	Cocus nucifera	Green Malayan Coconut	20	20 GW	18	FAIR	REMOVE	APPROVAL PERMIT TO BE PROVIDED

Le Sanctuaire
3425 South Ocean Boulevard
Highland Beach, Florida

10/19/2023 ROW Planting Only
06/14/2022 Rev. Per Comments
04/19/2023 Revised Per Comments
02/19/2023 For Submittal
ISSUE HISTORY
COMM NO. 22080R
PROJ MGR: KDW
DRAWN BY: EL
CHECKED BY: KDW

CAUTION: PLEASE NOTE

Contractor shall secure all permits required for the work from any state or local departments, utility companies or jurisdiction affected by the work. The Contractor shall have permits "in hand" prior to starting work. The Landscape Architect and/or Owner shall bear no responsibility for work performed without permitted drawings. The Contractor shall be responsible for all changes to Work, at no additional cost to Owner, as a result of unauthorized work prior to receipt of permit.

THIS DRAWING HAS NOT BEEN REVIEWED BY A STRUCTURAL ENGINEER. VERIFY WITH STRUCTURAL ENGINEER PRIOR TO CONSTRUCTION.

POOLS BARRIERS AND GATES
ALL POOL BARRIERS MUST MEET THE REQUIREMENTS OF 2020 F.B.C. 7TH EDITION, SECTIONS 454.2.17.1.1 THROUGH 454.2.17.1.7. ALL POOL GATES MUST MEET THE REQUIREMENTS OF 2020 F.B.C. 7TH EDITION, SECTION 454.2.17.1.8. ALL DOORS AND WINDOWS PROVIDING DIRECT ACCESS FROM A DWELLING TO A POOL MUST MEET THE REQUIREMENTS OF 2020 F.B.C. 7TH EDITION, SECTION 454.2.17.1.9.

FOR SUBMITTAL
10/19/2023
NOT FOR CONSTRUCTION

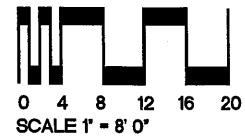

DRAWING TITLE
Existing Landscape Plan

Sheet
L-1

This drawing is an instrument of service copyright ©1984-2023 by Krent Wieland Design, Inc. d/b/a KWD Landscape Architecture. All rights reserved - Not to be reproduced in part or in whole without express written permission. Florida Registration LA 1039.

RECEIVED

NOV 07 2023

HIGHLAND BEACH
BUILDING DEPARTMENT



101 SE 2nd Avenue, Second Floor
Delray Beach, Florida 33444
studio@kwdesign.com
Telephone: 561-243-1873
Krant L. Wieland, FL Reg LA 1039
Cert. of Authorization LC26000275

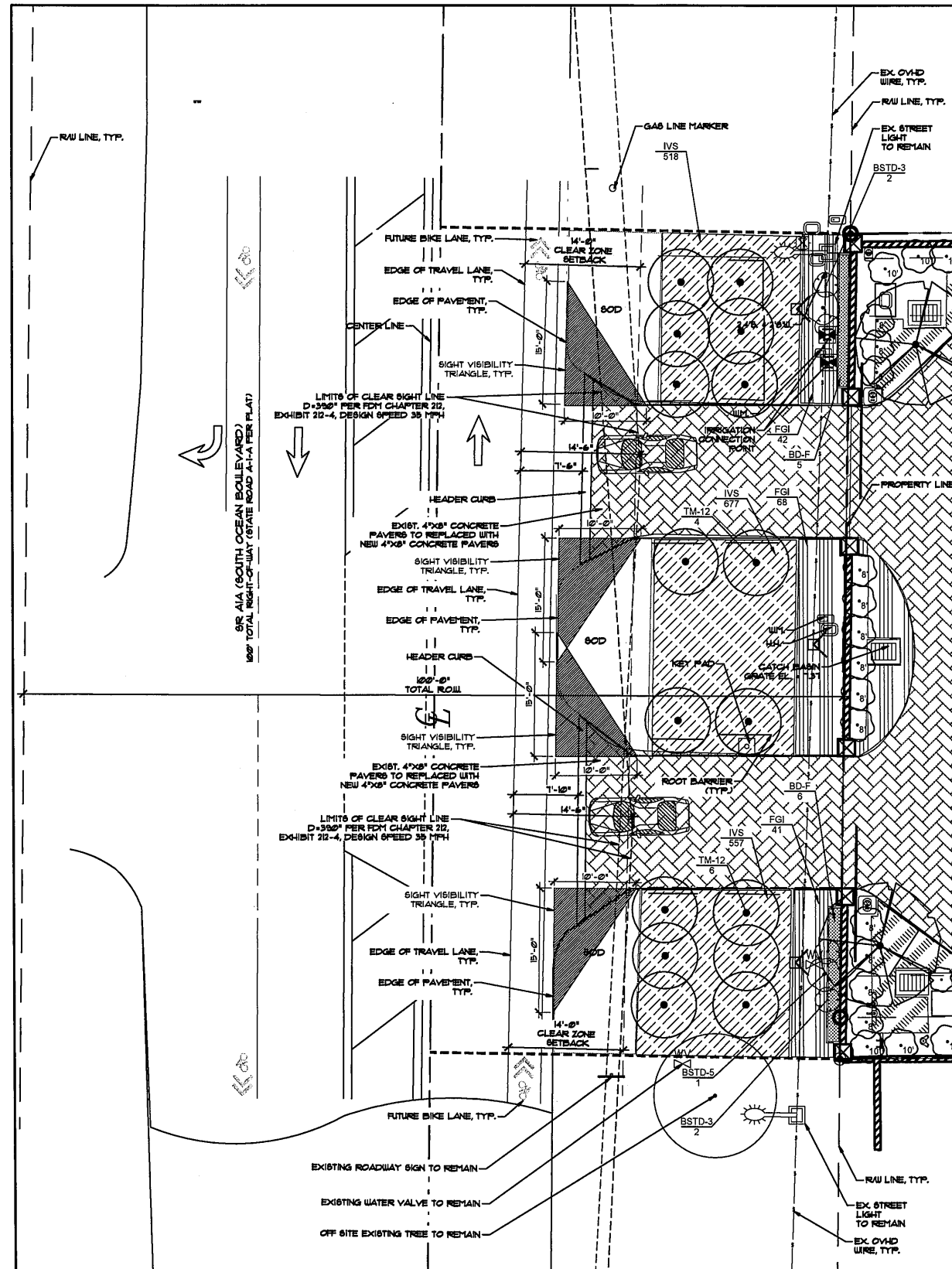

PROPOSED ROW PLANT SCHEDULE						
PALMS	BOTANICAL / COMMON NAME	CONT	CAL. IN.	SIZE	NATIVE	QTY
TM-12	Thinax mottoil / Key Thatch Palm - Single	B & B		12' GA	Yes	18
SHRUBS/ACCENT	BOTANICAL / COMMON NAME	CONT	HEIGHT	SPREAD	FIELDS	QTY
BSTD-3	Bougainvillea / Bougainvillea Standard, Straight Trunk, Full, Symmetrical Heads, ALTERNATE PURPLE AND FUCHSIA	Containerized	3-4'	3'		4
BSTD-5	Bougainvillea / Bougainvillea Standard, Straight Trunk, Full, Symmetrical Heads, ALTERNATE PURPLE AND FUCHSIA	Containerized	5'	3'-4'		2
SHRUB AREAS	BOTANICAL / COMMON NAME	CONT	HEIGHT	SPREAD	SPACING	QTY
BD-F	Bougainvillea Dwarf Fuchsia / Dwarf Fuchsia Bougainvillea Full, Dense Foliage To Base, Fuchsia	3 gal	20"	20"	24" o.c.	11
FGI	Ficus microcarpa 'Green Island' / Green Island Ficus Full, Dense Foliage To Base	Containerized	18"	18"	18" o.c.	151
IVS	Ilex vomitoria 'Dwarf Schellings' / Schellings Dwarf Ilex Full, Dense Foliage To Base	3 gal	10"-12"	10"-12"	10" o.c.	1,752
MISC.	NAME	COMMENTS			QTY	
BIO	Bio-Barrier	Root/Bio Barrier as required by utilities. Provide root barrier in planters adjacent to pool.			Verify Quantity In Field	
SOD - ST. AUGUSTINE PALMETTO MULCH - RECYCLED MULCH						

Le Sanctuaire
3425 South Ocean Boulevard
Highland Beach, Florida

10/19/2023 ROW Planting Only
01/19/2023 Rev. Per Comments
06/14/2023 REVISED
06/14/2023 Rev. Per Comments
01/29/2023 FOR SUBMITTAL
01/17/2023 PROGRESS REVIEW
ISSUE HISTORY
COMM NO. 22060R
PROJ MGR: KDW
DRAWN BY: EL
CHECKED BY: KDW

CAUTION: PLEASE NOTE

Contractor shall secure all permits required for the work from any state or local departments, utility companies or jurisdiction affected by the work. The Contractor shall have permits "in hand" prior to starting work. The Landscape Architect and/or Owner shall bear no responsibility for work performed without permitted drawings. The Contractor shall be responsible for all changes to Work, at no additional cost to Owner, as a result of unauthorized work prior to receipt of permit.

THIS DRAWING HAS NOT BEEN REVIEWED BY A STRUCTURAL ENGINEER AND/OR OWNER SHALL BEAR NO RESPONSIBILITY FOR WORK PERFORMED WITHOUT PERMITTED DRAWINGS. VERIFY WITH STRUCTURAL ENGINEER PRIOR TO CONSTRUCTION

POOLS BARRIERS AND GATES

ALL POOL BARRIERS MUST MEET THE REQUIREMENTS OF 2020 F.B.C. 7TH EDITION, SECTIONS 454.2.17.1.1 THROUGH 454.2.17.1.7. ALL POOL GATES MUST MEET THE REQUIREMENTS OF 2020 F.B.C. 7TH EDITION, SECTION 454.2.17.1.8. ALL DOORS AND WINDOWS PROVIDING DIRECT ACCESS FROM A DWELLING TO A POOL MUST MEET THE REQUIREMENTS OF 2020 F.B.C. 7TH EDITION, SECTION 454.2.17.1.9

This drawing is an instrument of service copyright ©1984-2023 by Krant Wieland Design, Inc. d/b/a KWD Landscape Architecture. All rights reserved - Not to be reproduced in part or in whole without express written permission. Florida Registration LA 1039.

FOR SUBMITTAL
10/19/2023
NOT FOR CONSTRUCTION

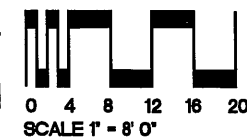

DRAWING TITLE
Proposed Landscape Plan
Sheet
L-2

RECEIVED
 NOV 07 2023
 HIGHLAND BEACH
 BUILDING DEPARTMENT



Le Sanctuaire
 3425 South Ocean Boulevard
 Highland Beach, Florida

[Handwritten signature]

10/19/2023 ROW Lighting Plan only
 04/17/2023-Rev. Per Comments
 02/28/2023-For Submittal
 ISSUE HISTORY
 PROJ NO: 22031A
 PROJ MGR: KDW
 DRAWN BY: ST
 CHECKED BY: KWD

DRAWING TITLE:
LANDSCAPE LIGHTING PLAN
 SHEET:
LLP-1

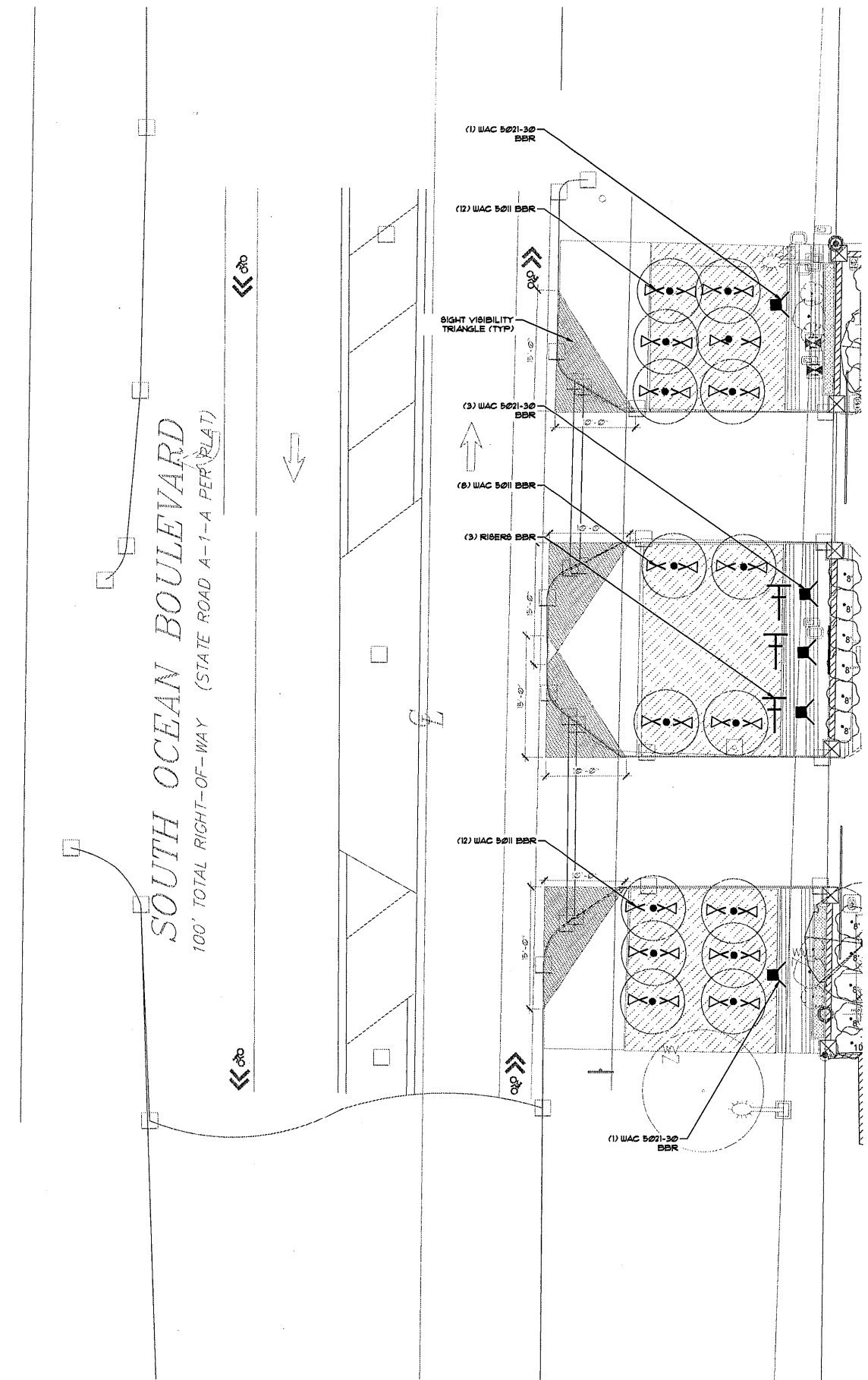

CAUTION: PLEASE NOTE
 Contractor shall secure all permits required for the work from any state or local departments, utility companies or jurisdiction affected by the work. The Contractor shall have permits "in hand" prior to starting work. The Landscape Architect and/or Owner shall bear no responsibility for work performed without permitted drawings. The Contractor shall be responsible for all changes to work, at no additional cost to Owner, as a result of unauthorized work prior to receipt of permit.

This drawing is an instrument of service, copyright © 1984-2023 by Krent Wieland Design, Inc., d/b/a KWD Landscape Architecture. All rights reserved - Not to be reproduced in part or in whole without express written permission. Florida Registration LA 1039.

FOR SUBMITTAL
 10/19/2023
 NOT FOR CONSTRUCTION

0 4 8 12 16 20
 SCALE 1" = 8' 0"

NORTH