



Design Concept

Prepared for:

**VILLAGE OF HARRISON
CUBICLE & PRIVATE OFFICE
HARRISON, WI**

Original Date: 10/29/2025

REV	DATE
1	11/24/2025

Drawing Details | CUBICLE

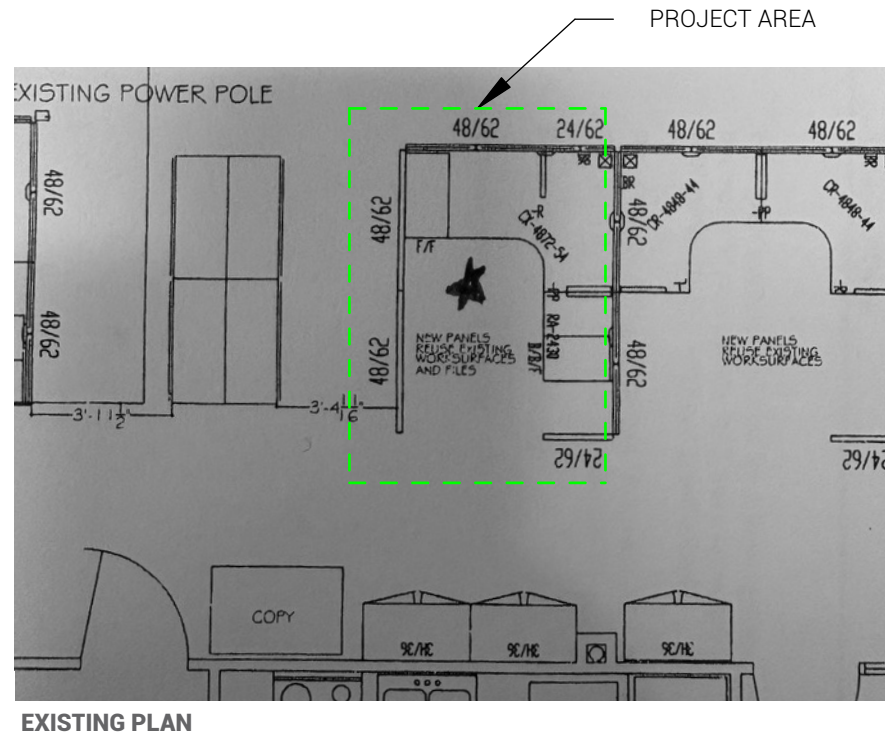
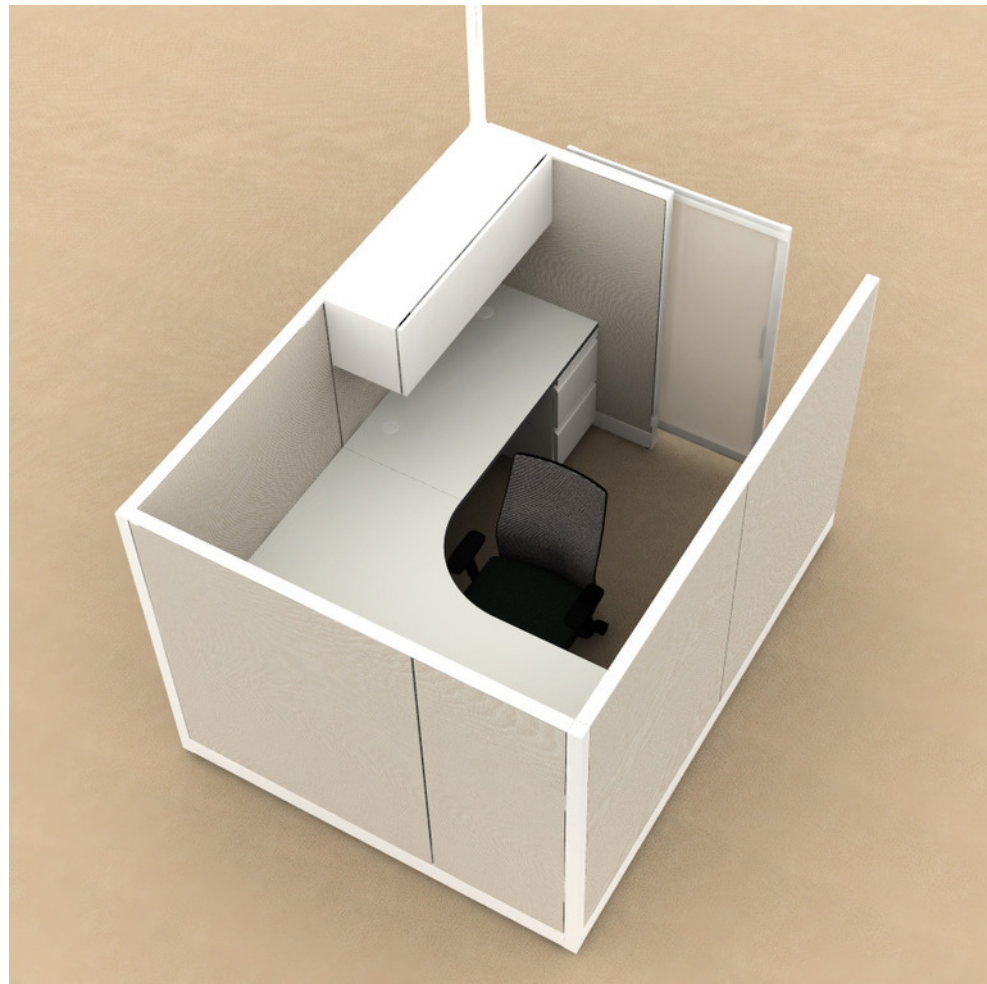
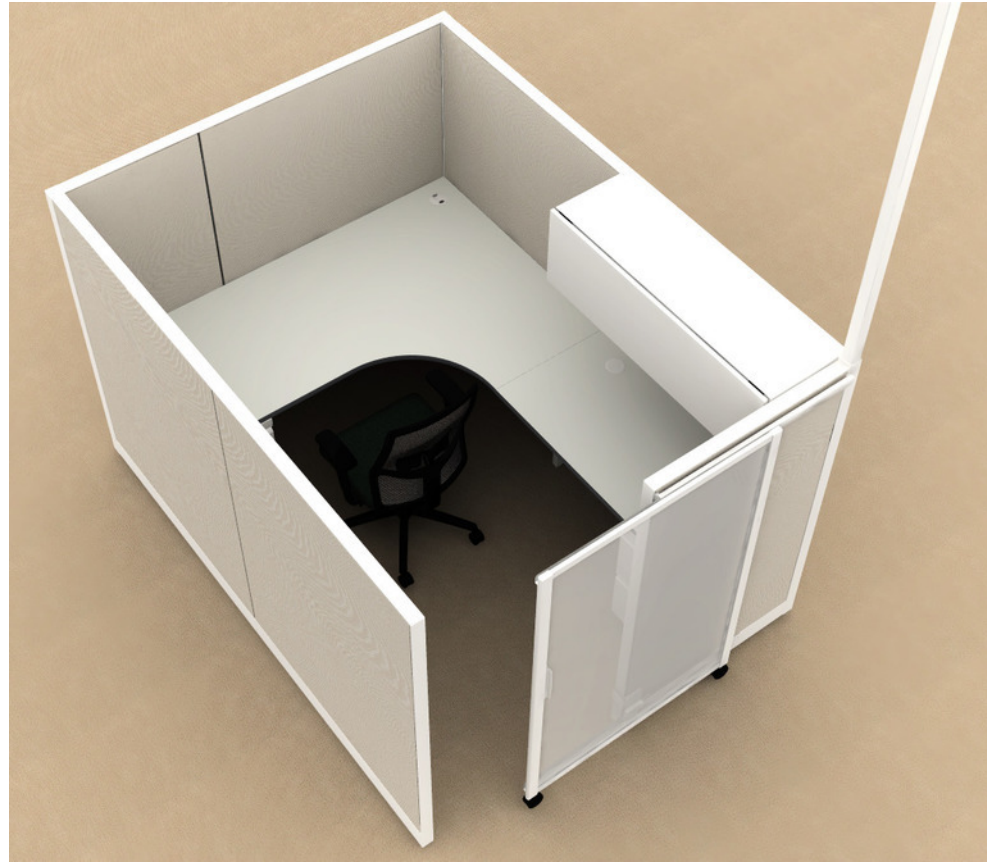

EXISTING PLAN

VERIFY ROOM DIMENSIONS FOR PROPER FIT OF FURNITURE

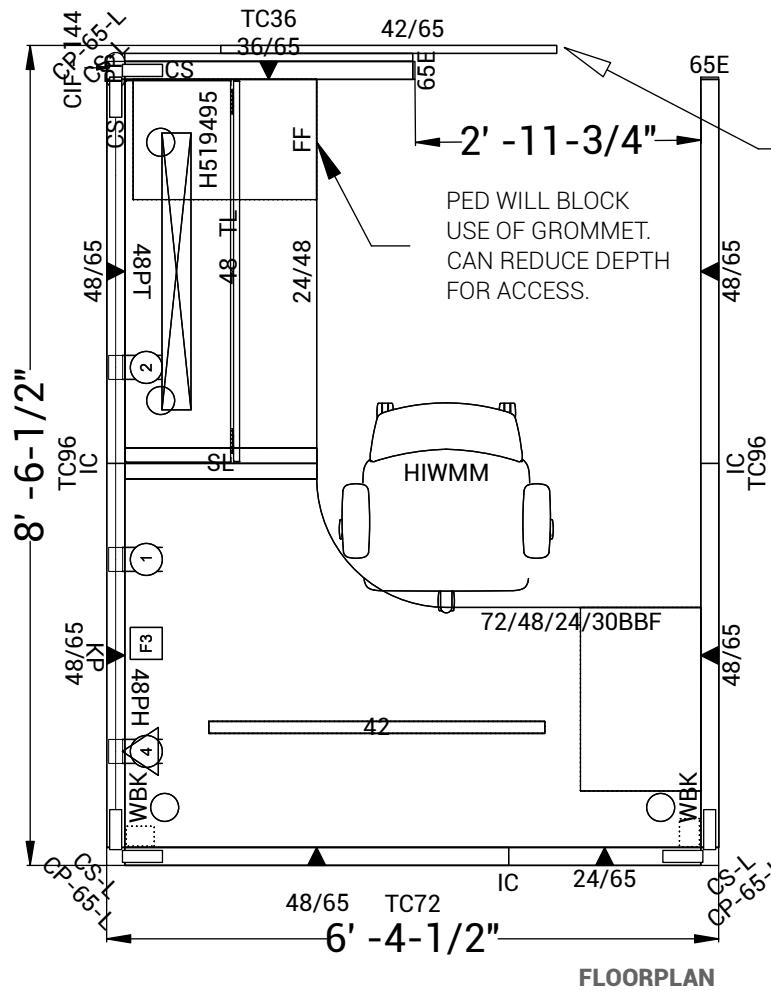

FLOORPLAN

VILLAGE OF HARRISON

11/24/2025

FINISHES



SPECIFICATIONS

- 65"H PANELS
- SLIDING DOOR
- FIXED CORNER COVE AND RETURN
- BOX BOX FILE, METAL LOCKING
- FILE FILE, METAL LOCKING
- OVERHEAD, METAL LOCKING
- TASK LIGHT
- TASK CHAIR WITH HEIGHT ADJUSTABLE ARMS



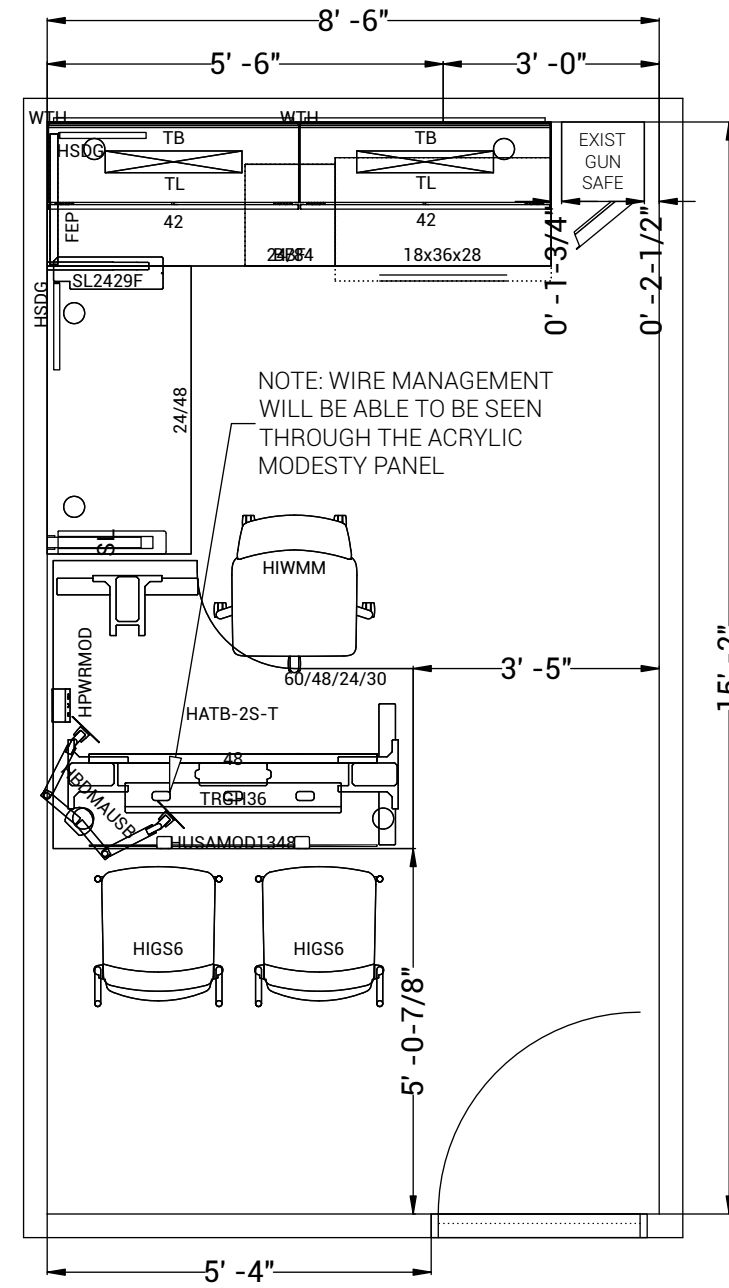

FLOORPLAN

FINISHES

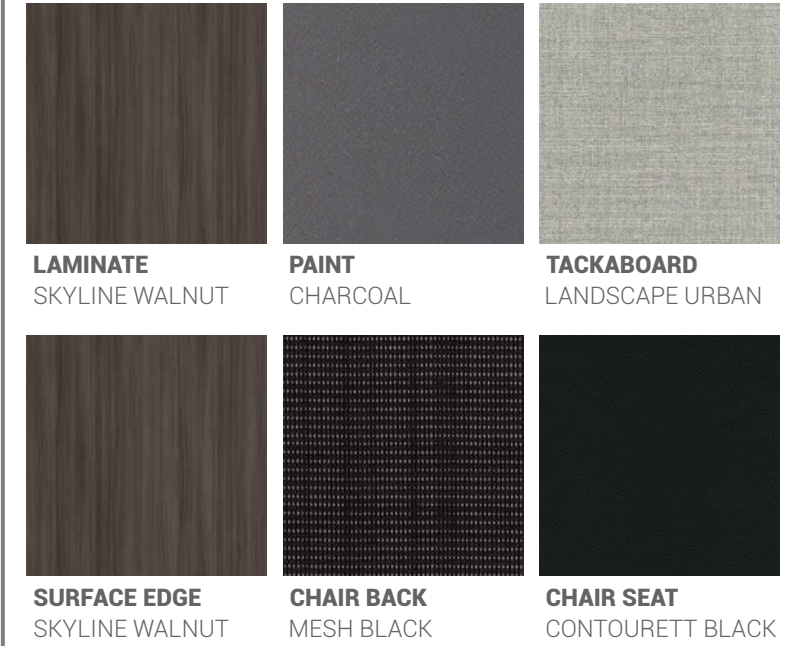

SPECIFICATIONS

- HEIGHT ADJUSTABLE DESK
- ACRYLIC HALF MODESTY
- DUAL MONITOR ARM
- DESK MOUNT POWER
- FIXED BRIDGE AND CREDENZA
- BOX BOX FILE, METAL LOCKING
- LATERAL FILE, METAL LOCKING
- OVERHEADS, METAL LOCKING
- TASK LIGHTS
- TACKBOARDS
- ARMLESS TASK CHAIR WITH REACTIV BACK
- ARMLESS GUEST CHAIR MESH BACK

*GUN SAFE IS EXISTING

Thank You

Presented by | **KYLE MATSEN**
Designed by | **KARA FREDERICK**
Project No | **191-211**

Approved Signature | _____

Notes |

All photographs, renderings and finish images are a visual representation only. Actual finish samples may vary from images included. Please use physical material samples when selecting and comparing finishes.

Written dimensions supersede scale in all cases. All dimensions are related to furniture only. Contractor shall verify all dimensions and conditions at the jobsite and notify EBi of any discrepancies prior to starting work.

Proprietary & Confidential |

Plans, drawings and specifications are the property of Complete Office of Wisconsin, dba Emmons Business Interiors (EBi) and may not be copied, reproduced or implemented, in whole or in part, without express written consent of EBi.

Any unauthorized use of these documents will result in payment due for services rendered by EBi.

