



January 19, 2026

Village of Harrison
W5298 State Road 114
Harrison, WI 54952

Subject: Invoice for V/Harrison Commerce Park, Electric

Dear Village of Harrison:

Thank you for your application for electric facilities. Please review the following information.

Cost details:

- **The cost for this project will be \$74,843.29.** Additional charges may apply if we encounter unusual conditions, delays in your construction schedule or other changes that you request.
- The cost has been reduced by \$0.00 as credit for zero meter(s) being set at the time of installation.
- The cost includes \$8,127.00 of seasonal charges for installation from Dec. 1 through March 31. Site must be ready and signed grade verification form submitted by Nov. 1 to avoid seasonal charges.
- The cost does not include electric service to sewer lift stations, community well pumps, lighting, etc.
- Installation cost must be paid in advance of construction.
- If an additional cost estimate is needed within 12 months, there will be a charge for preparing the new estimate.
- **This cost is valid for 90 days provided this letter and enclosed drawing are signed and returned with payment, the site is ready, and all other requirements are met.**

Payment remittance:

Remit payment, if applicable, using one of the following options. Reference the work request number shown below on your check or when paying via phone or online.

- Personal check
- Online at www.we-energies.com/payconstructionbill
- Phone at 855-570-0998

Facility location:

- To avoid damage to underground facilities, you are responsible for locating and marking (with stakes, spray paint or flags) any buried obstructions and private underground facilities like lighting, septic systems, wells, sprinkler systems, etc.
- It is very important that you mark these facilities as We Energies and/or its agents are not responsible for damage to your facilities that are not properly marked before our work begins.

Construction:

Please consider this information when developing your project timeline:

- Once all job requirements are met, allow us a minimum three-week lead time for scheduling the installation of electric facilities.
- The area along the route of our facilities must be graded to within four inches of final grade. Fill, if deeper than three feet, must be compacted prior to the installation of our facilities. If relocation or

repair of our facilities becomes necessary because of a grade change greater than four inches, you will be billed the full relocation or repair costs.

- Easements to install and maintain all We Energies facilities, including the right to cut out brush, shrubs and trees must be provided.
- Lot corner pipes are required to be clearly and visibly marked and must be identifiable along the entire installation route. These markings will be field verified by We Energies personnel and installation will not proceed if we determine this requirement is not complete.

Lawn and pavement repair:

- Repair in the public right-of-way, for facilities installed beyond your project limits, will be completed according to municipal guidelines.
- Repair within your development will include backfilling and compacting using existing soil.
- All cut brush, shrubs and trees will be left at the site along our trench route.

Refund details:

- Refunds may be available for up to five years after the energization date and will not exceed the amount of the original cost.
- Refunds in the amount of \$1,859.00 may be made for each single-phase residential/farm customer connecting to this extension.
- Additional refunds for larger services also may be available up to the original cost. The refund amounts vary based on the size of the meter set.
- Refunds will not exceed the amount of the original refundable cost of 66,488.80.

Your next step is to sign this letter and return it, along with a signed drawing and your payment. You may wish to make a copy of the letter for your records. Sign and return the enclosed Grade Verification Form only after all its provisions have been met. Please call me with any questions. I look forward to working with you to make your project a success.

Sincerely,

Mark Kofnetka
Energy Services Consultant
920-380-3549

Work Request #: 5146977

I certify the grade was confirmed by a surveying/engineering firm and lot corner stakes are installed.

Accepted by: _____

Title: _____ Date: _____

P.S. For more information on the application and construction process for new developments, visit www.we-energies.com/contractors.

Enclosure



ELECTRIC WORK REQUEST

5146977



CUST/PROJ NAME: HARRISON VILLAGE OF HARRISON COMMERCE
PROJECT LOCATION: CTH N AND MANITOWOC RD

PREPARED BY: HEATH HEMAUER (K)
E-MAIL: HEATH.HEMAUER@WE-ENERGIES.COM
OFFICE #: 920-931-3210 CELL #: 920-522-3676
PROJECT ID: WI5146977 IO #: 17141

OPERATING MAPS: 3924-8960-04
EXISTING FEEDER: FDBY64 DARBOY SS
PROPOSED FEEDER: FDBY64 DARBOY SS
T-R-S - 1/4Q: T20N R18E S11NW CGS#:

TYPE OF WORK:
[X] SUBDIVISION-UNDERGROUND FACILITIES
[] SUBDIVISION-OVERHEAD FACILITIES
[] SUBDIVISION STREET LIGHT - UNDERGROUND FACILITIES
[] SUBDIVISION STREET LIGHT - OVERHEAD FACILITIES
[] SUBDIVISION - RELOCATE FACILITIES
[] OTHER:

STAKING REQUIREMENTS:
[X] SURVEYOR [] STAKED
[] DESIGNER [] NOT NEEDED
RESTORE PRIVATE PROPERTY:
[] YES [] NO

JU COMPANY: JOB #
ENGINEERING CONTACT: CONSTRUCTION CONTACT:
PHONE # PHONE #
CONSTRUCTION EMAIL:
EXCEPTIONS/ JU SIGNATURES:

JU COMPANY: JOB #
ENGINEERING CONTACT: CONSTRUCTION CONTACT:
PHONE # PHONE #
CONSTRUCTION EMAIL:
EXCEPTIONS/ JU SIGNATURES:

CONTACT JU PARTNERS 3-5 DAYS PRIOR TO CONSTRUCTION.

JOINT USE KEY: RELATED WORK REQUESTS:
OH:
DB:
SLDB
SLOH:

[X] ROW TO OBTAIN EASEMENT / ADD EASEMENT. SURVEYOR TO STAKE C/L AND MARK WIDTH OF EASEMENT ON STAKE.
[] ROW TO CONTACT CST/DESIGNER FOR EASEMENT REQ'S.
[] NO NEW EASEMENTS REQUIRED

EROSION CONTROL NOTES

[X] IF DISTURBANCE OCCURS IN SUMMER, FINAL STABILIZATION SHALL BE PERMANENT SEED AND PROPERLY ANCHORED MULCH, UNLESS NOTED. IF DISTURBANCE OCCURS IN WINTER, TEMPORARY STABILIZATION SHALL BE SOIL STABILIZER, UNLESS NOTED. FINAL STABILIZATION IS REQUIRED IN SPRING.
[] IF DISTURBANCE OCCURS WITHIN THE SLOPE INTERCEPT, FINAL STABILIZATION SHALL BE SOIL STABILIZER, UNLESS NOTED. IF DISTURBANCE OCCURS OUTSIDE THE SLOPE INTERCEPT, FINAL STABILIZATION SHALL BE PERMANENT SEED AND PROPERLY ANCHORED MULCH, UNLESS NOTED.
[] IF DISTURBANCE OCCURS IN AGRICULTURAL FIELDS, SOIL SEGREGATION WILL NEED TO TAKE PLACE TO RETURN FIELDS TO PRE-CONSTRUCTION SOIL STRATIFICATION AND TO PRE-CONSTRUCTION ELEVATIONS.
[X] DEPENDING ON THE TIME OF YEAR AND WEATHER CONDITIONS, CONSIDER USING PLATES/MATS IN WETLANDS OR CROSSING DITCHES.
[] STOCKPILE MATERIALS SHALL BE PLACED UPSLOPE FROM EXCAVATION. IF STOCKPILE MATERIALS MUST BE PLACED DOWNSLOPE OF EXCAVATION, PROTECT STOCKPILES WITH 12" WATTLES.
[X] PROJECT SPECIFIC EROSION CONTROL NOTES:

DEVELOPER:
COMPANY NAME: VILLAGE OF HARRISON
ADDRESS: W5298 STH 114
CITY, STATE: HARRISON, WI
CONTACT NAME: CHAD PELISHEK
PHONE: 920-808-1598
EMAIL: CPELISHEK@HARRISON-WI.ORG
ENGINEERING:
COMPANY NAME: MCMAHON AND ASSOCIATES
CONTACT NAME: LEE REIBOLD
PHONE: 920-427-6020
EMAIL: LREIBOLD@MCMGRP.COM

TOTAL TRENCH LENGTH: 3,717'
TOTAL BORE LENGTH: 224'
TOTAL NUMBER OF TRANSFORMERS: 1
TOTAL NUMBER OF PEDESTALS: 0
DIMENSIONING NOTES: ALL CABLES TO BE INSTALLED 3' OFF PL UNLESS OTHERWISE NOTED

CONSTRUCTION REMARKS:

* UNLESS NOTED OTHERWISE IN CONJUNCTION WITH
- WR5146983 (GAS)
- WR5146981 (LIGHTING DB)
- WR5146982 (LIGHTING OH)
* DESIGN BASED ON TRENCHING AND BORING. IF ROCK IS ENCOUNTERED ADDITIONAL EQUIPMENT MAY BE REQUIRED AT ADDITIONAL COST.
* STORM, SANITARY, AND WATER WILL BE INSTALLED PRIOR TO INSTALLATION. DEPTH OF UTILITIES MUST BE VERIFIED ON SITE.
* LATERALS MAY BE ENCOUNTERED WHEN TRENCHING ALL LOTS HAVE INDIVIDUAL LATERALS. CAUTION MUST BE APPLIED WHEN CROSSING LATERALS.
* INSTALL AT STANDARD DEPTH UNLESS OTHERWISE NOTED.
* CABLES TO BE INSTALLED IN EASEMENT. VERIFY STATUS OF EASEMENT PRIOR TO CONSTRUCTION.
* TOTAL EXCAVATION = 3,941'
- SOLO TRENCH = 2,515'
- JOINT TRENCH = 1,202'
- BORE = 224'
INSTALL INLET PROTECTION TYPE D AT ALL CURB INLETS WITHIN PROJECT SITE IF NOT ACCOUNTED FOR BY DEVELOPER

NOTES:
* WE ENERGIES WILL NOT RESTORE OR HAUL SPOIL UNLESS OTHERWISE NOTED ON SKETCH
* CUSTOMER/DEVELOPER IS RESPONSIBLE FOR LOCATING ANY/ALL PRIVATE UNDERGROUND FACILITIES AND/OR OBSTRUCTIONS INCLUDING THOSE THAT HAVE NOT YET BEEN TURNED OVER TO THE MUNICIPALITY
* WE ENERGIES AND/OR ITS CONTRACTORS ARE NOT RESPONSIBLE FOR DAMAGE TO UNMARKED FACILITIES
* CUSTOMER/DEVELOPER AND THEIR CONTRACTORS/SUB-CONTRACTORS MUST KEEP WE ENERGIES EASEMENT AREAS FREE AND CLEAR OF OBSTRUCTIONS AND ENSURE ACCESS TO EASEMENT AREAS IS PROVIDED INCLUDING, BUT NOT LIMITED TO: DUMPSTERS, SPOIL, BACKFILL MATERIAL, ETC.
* CUSTOMER/DEVELOPER AND THEIR CONTRACTORS/SUB-CONTRACTORS MUST ENSURE THAT GRADE AT TIME OF WE ENERGIES INSTALLATION IS WITHIN 4" OF FINAL GRADE INCLUDING ANY PLANS FOR FUTURE LANDSCAPING
* ANY FIELD ADJUSTMENTS TO SIGNED/APPROVED SKETCH MAY RESULT IN ADDITIONAL COSTS INCURRED BY THE DEVELOPER
* WE ENERGIES IS NOT RESPONSIBLE FOR DAMAGE TO TREES AND/OR ROOTS LOCATED ALONG TRENCH ROUTE
* WE ENERGIES AND/OR ITS CONTRACTORS WILL CLEAN ANY MUD/DEBRIS THAT IS TRACKED ONTO EXISTING ROADS AS A RESULT OF THEIR CONSTRUCTION DAILY
* WE ENERGIES AND ITS CONTRACTORS ARE NOT RESPONSIBLE FOR COMPACTION ISSUES OR DAMAGES TO GRAVELED ROADS
* ANY ADDITIONAL SPECIAL NOTES OR PROVISIONS

CUSTOMER'S SIGNATURE OF APPROVAL DATE

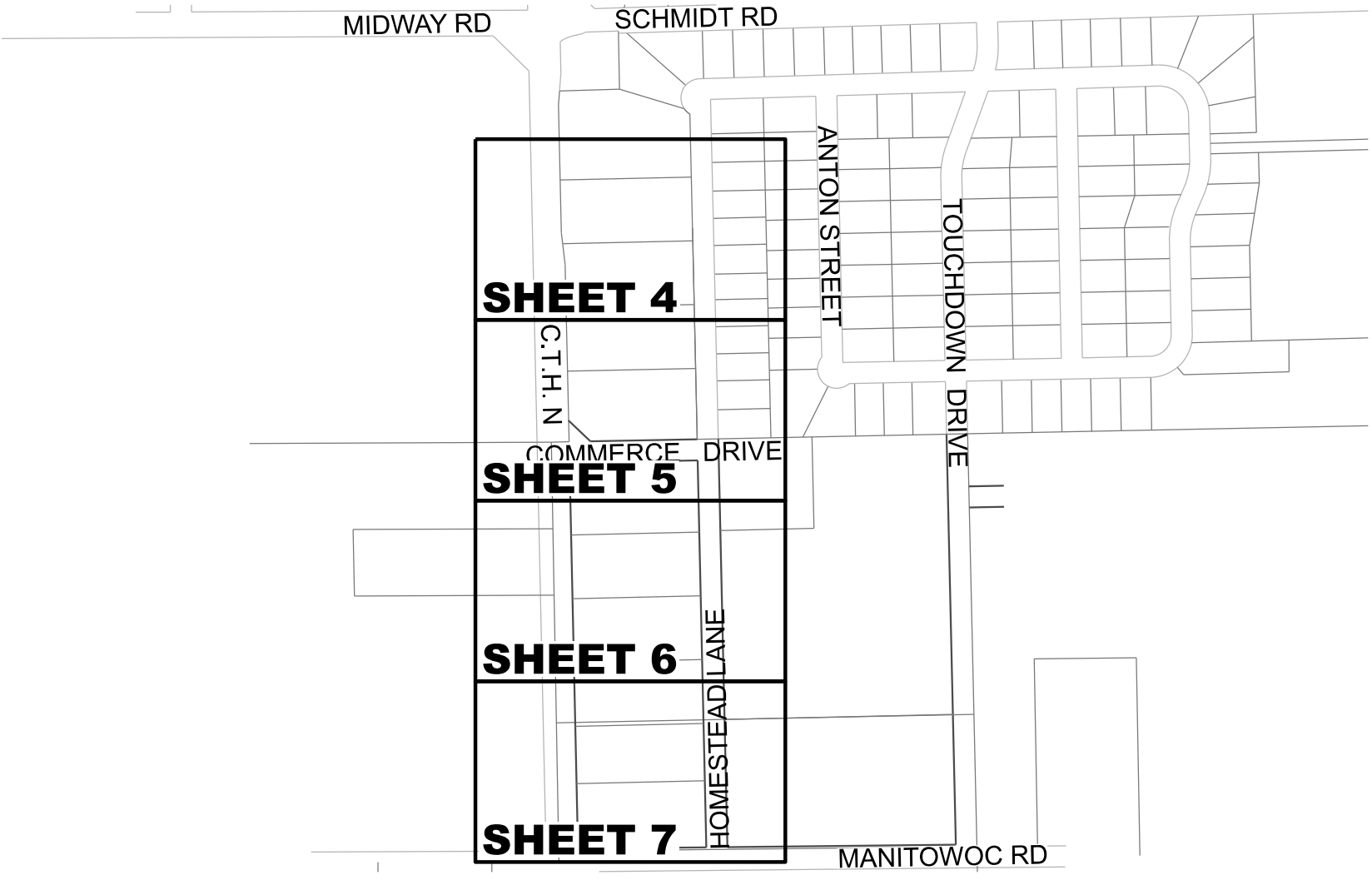
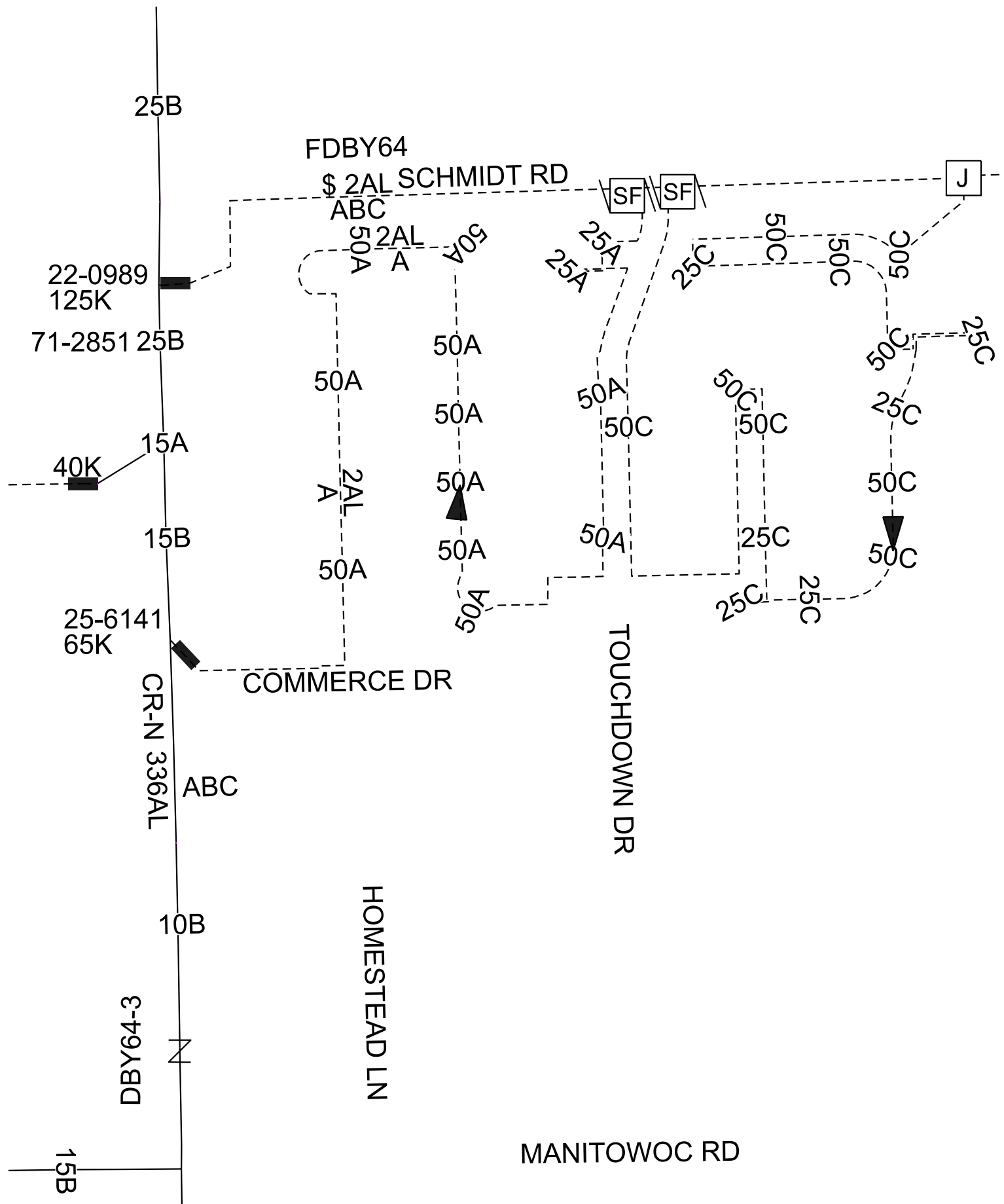

Table with 4 columns: REV., DESCRIPTION, BY, DATE. Row 0: DESIGN APPROVED FOR CONSTRUCTION, HH, 11/13/25. Includes 'WR 5146977' label and 'Printed 11/17/2025 2:28:41 PM SHEET 1 OF 7' footer.

U:\Data\@Work Management\Fox Valley Major Projects@FV Subdivisions@FV Subdivisions\5146977 - Harrison Commerce Park - Electric



EXISTING FEEDER FDBY64



PROPOSED FEEDER FDBY64

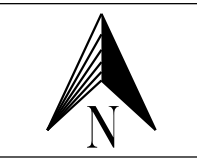
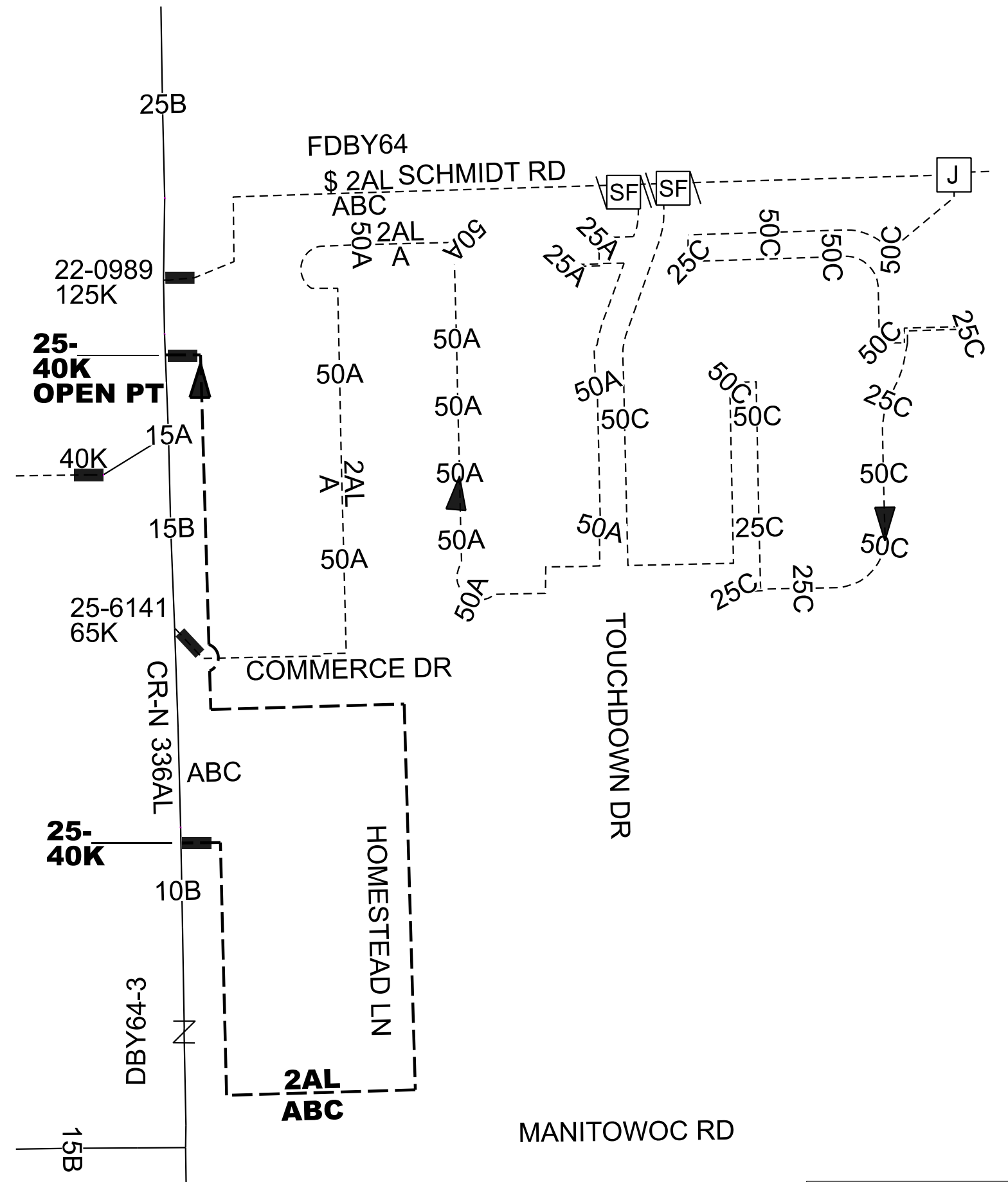



ACCEPTABLE INSTALLATIONS (ALL DIMENSIONS ARE MINIMUM SEPARATION REQUIREMENTS)

KEY

- (G) = GAS MAIN
- (C) = COMMUNICATIONS
(REPRESENTS ONE OR MORE CABLES)
- (E/C) = ELECTRIC AND/OR COMMUNICATIONS
(REPRESENTS ONE OR MORE CABLES)

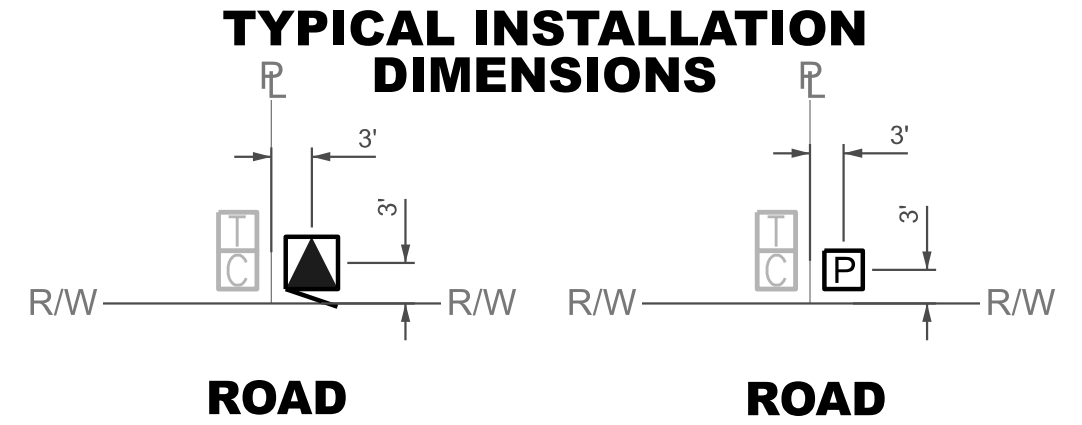
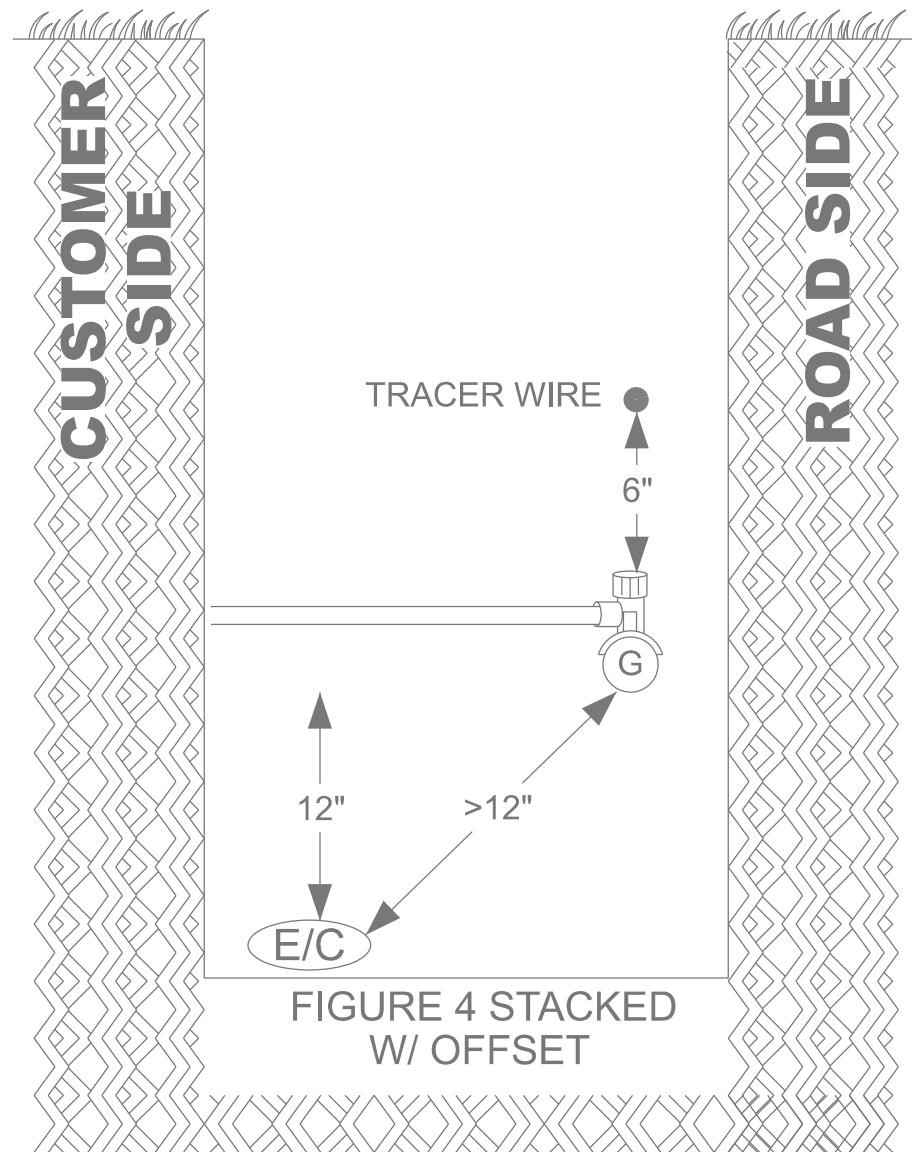

INSTALLATION IN EASEMENT

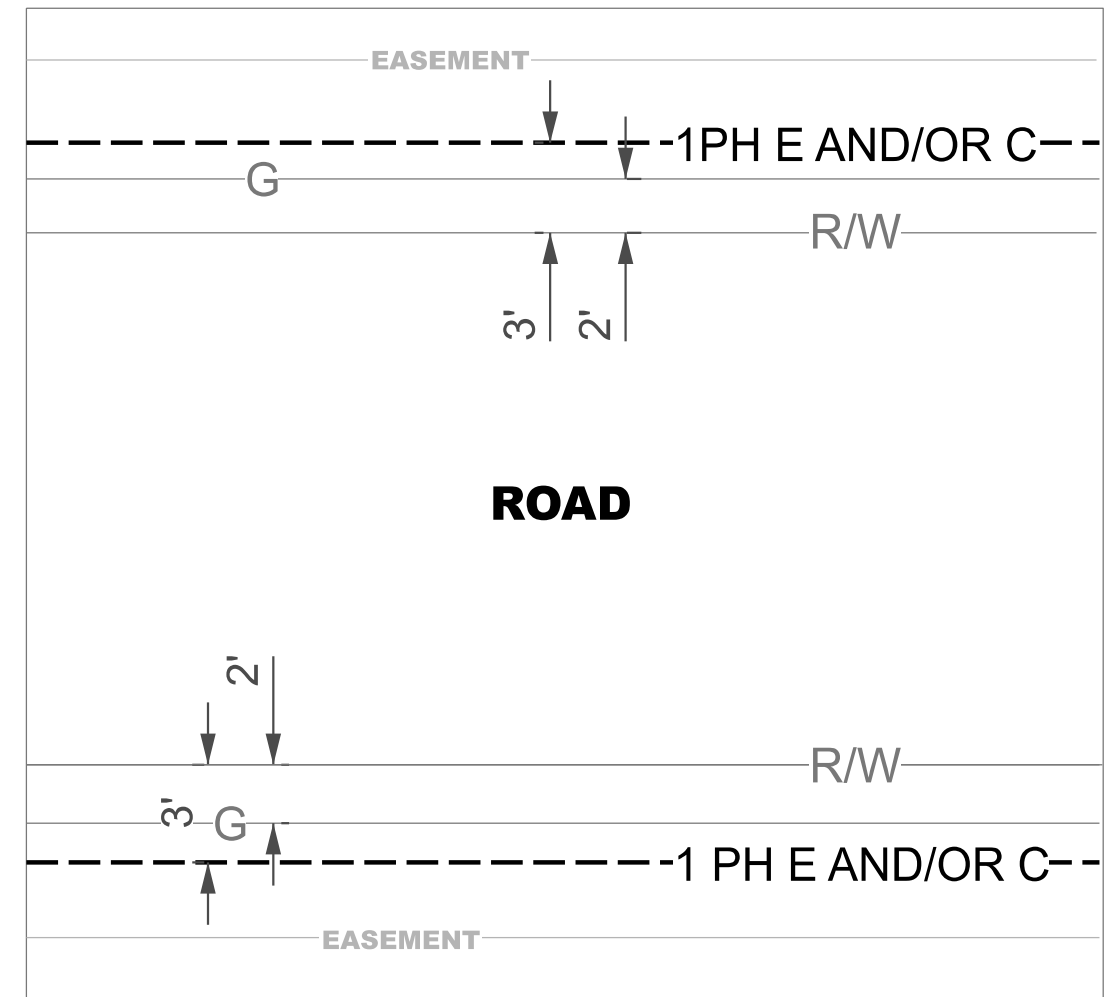

FIGURE 1



SHEET 7

S7
62-1105 35'

CTHN

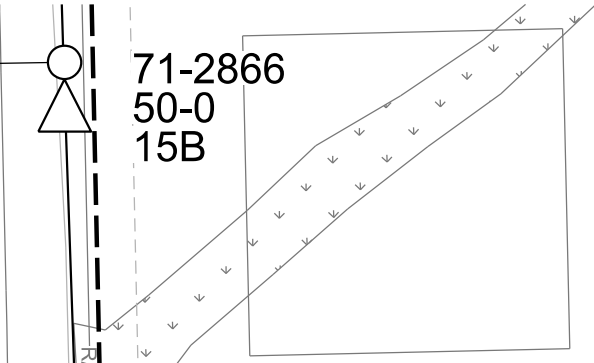

815'
F17
(SOLO)
PT 100-110

25-6141 45'

ENV 8, 27

110

UTILITY EASEMENT F16

COMMERCE DR

80' BORE
F17
1-4"D
(SOLO)

120

ENV 8, 27

396'
F17
(SOLO)

ENV 8, 27

130

72' BORE
F17
(SOLO)

140

ENV 8, 27

1,202'
F17
(JOINT)
PT 140-150

HOMESTEAD LN

25U17476
50A

25U17475

98

99

100

101

SHEET 5



↑ SHEET 6 ↑

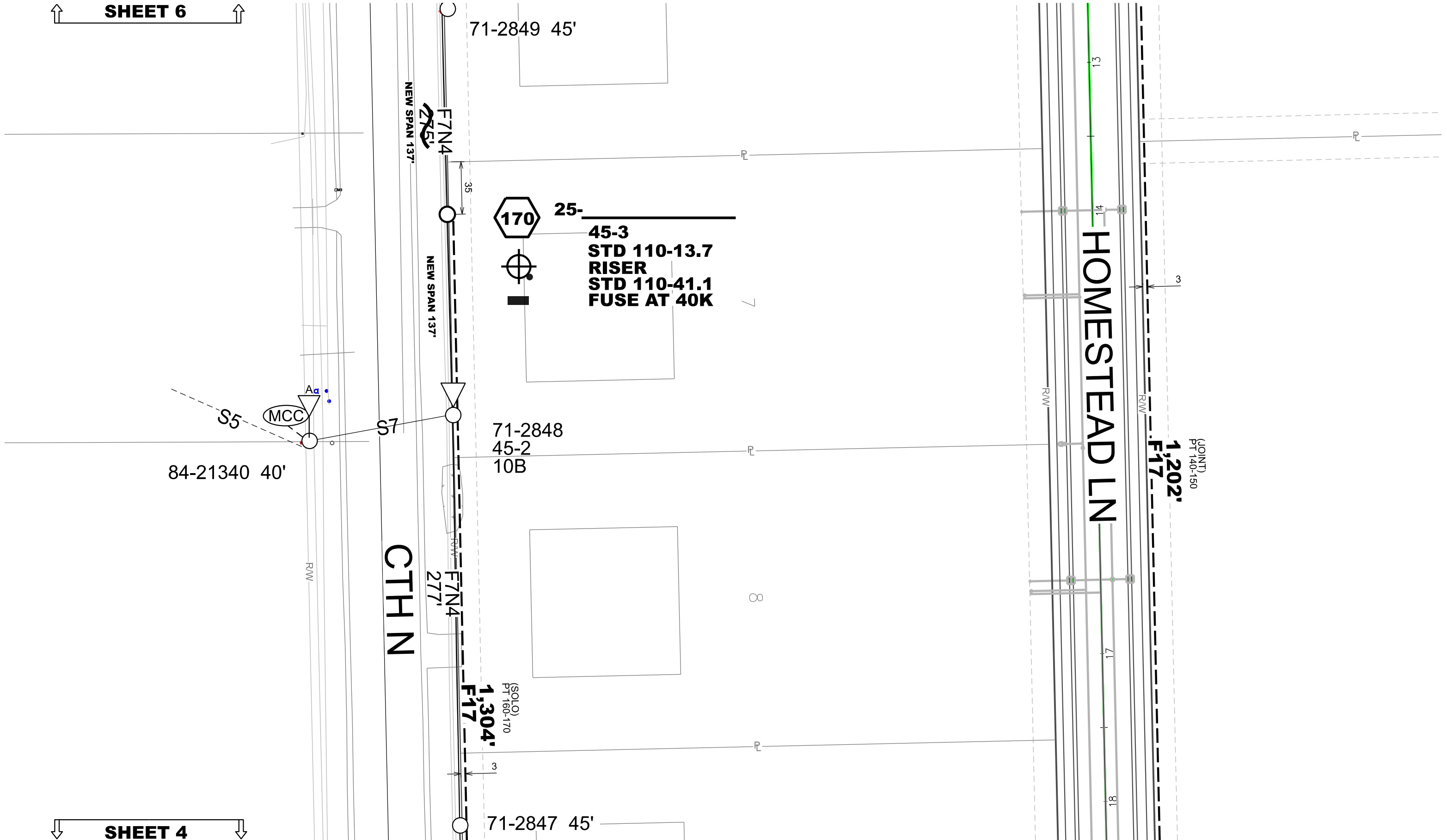

↓ SHEET 4 ↓

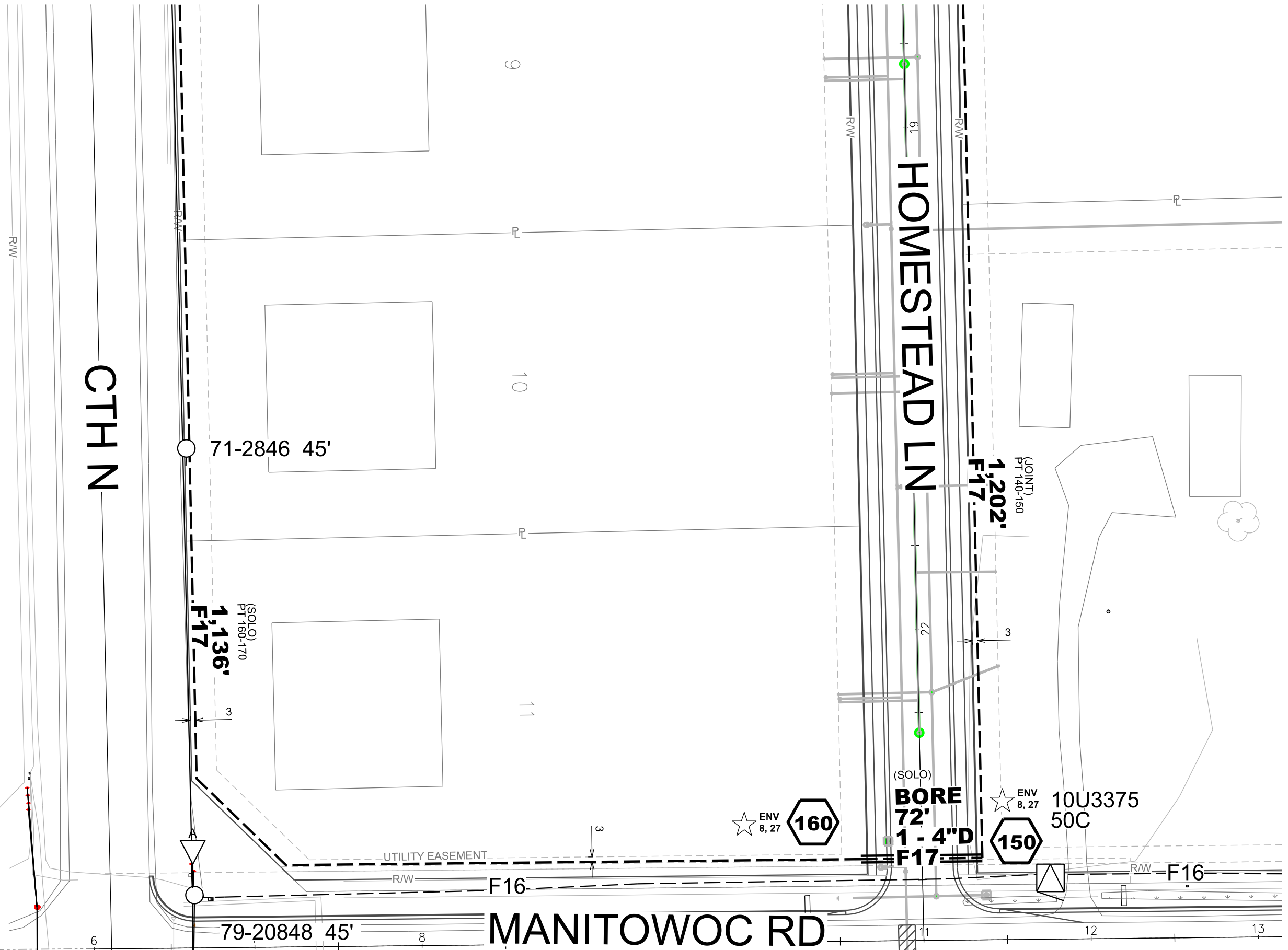

04-08786
45-4

SCALE 1" = 60'

SHEET 7 OF 7

WE ENERGIES - ELECTRIC OPERATIONS

CLEARANCE NOTES:

- LOCATION OF OBSTRUCTIONS ARE FROM RECORDS AND MUST BE VERIFIED IN THE FIELD.
- MAINTAIN 2' MIN. CLEARANCE BETWEEN OUTSIDE FACE OF MANHOLE & BELL OF PIPE.
- THIS APPLIES TO GAS AND WATER MAINS.
- MAINTAIN 2' MIN. VERTICAL CLEARANCE AT CROSSINGS OF SEWER OR WATER MAINS.
- MAINTAIN 5' MIN. HORIZONTAL DIST. BETWEEN CONDUIT AND SEWER.
- MAINTAIN 3' MIN. HORIZONTAL DIST. BETWEEN CONDUIT AND WATER MAINS.
- NOTE - CLEARANCES SHOWN ARE MINIMUM DISTANCES - REFERENCE PERMITS FOR SPECIFIC CLEARANCE REQUIREMENTS. ADDITIONAL UNDERGROUND INFORMATION ON EXCAVATION, BACKFILLING AND CLEARANCES CAN BE FOUND IN STD. 281-02.

OVERHEAD PRIMARY
E, F, H, Q, R, W, X or Z

- Z 1 #2 ACSR
- Z1 1 #1/0 ACSR
- Z2 1 #3/0 ACSR
- Z3 3 #2 ACSR
- Z4 3 #1/0 ACSR
- Z5 3 #3/0 ACSR
- Z7 3 #336 ACSR
- Z9 SPECIAL LIST ON SKETCH
- Z10 1 WIRE REMOVAL
- Z11 2 WIRE REMOVAL
- Z12 3WIRE REMOVAL

STANDARD WIRE KEY

DIRECT BURY PRIMARY - E, F, H, Q, R, W, X or Z

- Z13 1 #1 AL 25KV
- Z14 3 #1 AL 25KV
- Z15 3 #500 AL 28KV
- X16 1 #2 AL 15KV
- X17 3 #2 AL 15KV
- X18 3 #500 AL 15KV
- R19 3 #1/0 AL 35KV
- R20 3 #750 AL 35KV
- Z21 3 #750 AL 28KV
- X22 1 #2 Cu 15kV
- X23 3 #2 Cu 15kV
- Z24 1 #2 Cu 25kV
- Z25 3 #2 Cu 25kV
- X26 3 #500 Cu 15kV
- Z27 3 #500 Cu 28kV
- Z28 3 #750 Cu 28kV
- Z29 SPECIAL - LIST ON SKETCH

NEUTRAL

- N 1-#2 ACSR
- N1 1-#1/0 ACSR
- N2 1-#3/0 ACSR
- N3 1-#4/0 AL
- N4 1-#336 ACSR
- N5 REMOVAL
- GUYING
- G 1/4" ARM GUY
- G1 5/16" ARM GUY
- G2 3/8" ARM GUY
- G3 5/16" POLE GUY
- G4 3/8" POLE GUY
- G5 7/16" POLE GUY







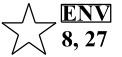

SECONDARY - 1PHASE

- S 6DX
- S1 4 TX
- S2 2 TX
- S3 1/0 TXR
- S4 3/0 TXR
- S5 350 TXR
- S6 750 TXR
- S7 1/0 TXF
- S8 4/0 TXF
- S9 336 TXR
- S10 750 TXF
- S11 3 WIRE REMOVAL
- S12 3 WIRE MAIN
- S14 6DX CIC
- S15 1/0TX CIC

SECONDARY - 3PHASE

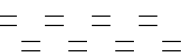
- \$ 1/0 TXF
- \$1 4/0 TXF
- \$2 336 TXF
- \$3 3/0 TX
- \$4 350 TX
- \$5 750 TX
- \$6 1/0 QXF
- \$7 3/0 QXF
- \$8 350 QXR
- \$9 750 QXR
- \$10 3 WIRE REMOVAL
- \$11 3/0 QXR
- \$12 4 WIRE REMOVAL

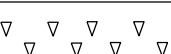
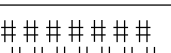
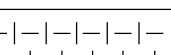
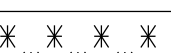
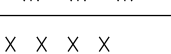
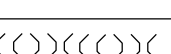
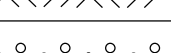
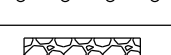
EROSION CONTROL LEGEND

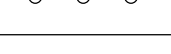
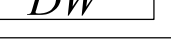
	APPROXIMATE LOCATION FOR UNDERGROUND FACILITY EXCAVATION
	INLET PROTECTION, TYPE
	12" WATTLE or 12"/20" SEDIMENT LOG or 9.5"/20" EROSION EEL
	STONE DITCH CHECK
	ROCK BAG
	MULCH
	SOIL STABILIZER, TYPE B
	EROSION MAT CLASS I, TYPE A
	EROSION MAT CLASS I, TYPE B
	EROSION MAT CLASS I, TYPE A URBAN
	EROSION MAT CLASS I, TYPE B URBAN
	EROSION MAT CLASS II
	EROSION MAT CLASS III
	VEGETATIVE BUFFER
	TRACKING PAD
	TIMBER MAT
	SILT FENCE
	APPROXIMATE DEWATERING BASIN LOCATION
	SURFACE WATER FLOW

WE ENERGIES WORK REQUEST ENVIRONMENTAL NOTES (Notes 1 through 7 apply to ALL work requests)

General

1. If WDNR and/or USACE permits were obtained for the project, all permit conditions shall be met during construction of the project.

Erosion Control

2. If soil disturbance occurs on slopes or channels/ditches leading to wetlands or waterways, or within wetlands, the disturbed areas shall be stabilized and appropriate erosion control Best Management Practices (BMP's) shall be implemented.
3. Erosion Control BMR's shall meet or exceed the approved WDNR Storm Watter Management Technical Standards (http://dnr.wi.gov/topic/stormwater/standards/const_standards.html). Refer to We Energies Construction Site Sediment and Erosion Control Standards.
4. Inspect installed erosion control BMP's at least one time per week and after 1/2" rain events: repair as necessary.
5. When temporary stabilization is required (e.g. for winter or short-term construction) prior to final restoration, soil stabilizer shall be installed wherever possible. Erosion mat shall be used temporarily only where appropriate, in accordance with state standards, and when approved by the Operations Supervisor.

Contaminated Soils

6. Whenever soil exhibiting obvious signs of contamination (e.g., discoloration, petroleum or solvent odor, free liquids other than water, buried containers or tanks, or other obvious signs of environmental impacts) is encountered during excavation or installation, cease work immediately, take appropriate immediate precautions to ensure worker health and safety, and contact the Operations Supervisor or Inspector.

Spills

7. If an oil spill occurs during construction, call the Environmental Incident Response Team (EIRT) at 414-430-3478:
 - a. Any quantity of oil is spilled into surface water;
 - b. Any oil spill greater than 50 ppm PCB into a sewer, vegetable garden, or grazing land;
 - c. Any oil spill containing greater than 500 ppm PCB;
 - d. Five gallons or more of oil spilled to the ground;
 - e. Any oil spill involving a police department, fire department, DNR, or concerned property owner.

Notes 8 through 27 apply as noted at specific points within each work request:

Dewatering

8. Dewatering of pits or trenches shall be done in accordance with state standards. Use an approved sediment bag, a straw bale dewatering basin, a combination of both, or equivalent.

Wetlands

9. As much as practicable, the majority of the work shall be staged from the public roadways and road shoulders, keeping equipment out of adjacent wetlands.
10. All work shall be conducted to minimize soil disturbance. No rutting will be allowed within the wetlands.
11. If soils are not frozen or stable to a point that avoids rutting, timber mats, mud tracks, or equivalent shall be utilized to access pole locations.
12. Excavated soils cannot be stockpiled in wetlands.

13. All excess spoils shall be removed from wetlands and placed in a suitable upland location.
14. Trenching and pit excavations within wetlands shall include soil segregation to facilitate restoration of pre-construction soil stratification, and restoration to pre-construction elevations.
15. Poles scheduled to be removed, and that occur within wetland, shall be cut at the ground surface.

Waterways

16. No work can be performed within the banks or below the ordinary high watermark of any navigable waterways/streams.
17. No crossing of navigable waterways with equipment can occur. Foot traffic is allowed.
18. Any disturbed soil within 75-feet of the ordinary high water mark of any navigable waterways/streams shall be stabilized within 24 hours of construction completion.

Threatened and Endangered Species

19. Threatened or endangered species are known to occur in the work area. It is illegal to harass, harm, or kill a protected species under state and federal regulations. Proper precautions shall be taken to ensure harm to individuals is avoided.
20. In order to protect the threatened or endangered species, work must be conducted between November 5 and March 15.
21. Exclusion fencing must be installed at the work area prior to March 15.
22. A qualified biologist must be present when conducting work at this location.

Invasive Species

23. State regulated invasive species are known to occur in the work area. Reasonable precautions are legally required to prevent the spread of these species. The Wisconsin Council on Forestry Transportation and Utility Rights-of-Way Best Management Practices should be followed: (<http://council.wisconsinforestry.org/invasives/transportation/>).

Cultural and Historical Resources, cont.

24. The project is within or adjacent to an area that is identified by the State of Wisconsin as potentially having Native American artifacts, burial mounds or burial sites, which could be encountered during construction.
25. If human bone or any artifacts are discovered during construction, work must cease immediately. Contact the Environmental Department who will contact the State Burial Sites Preservation Office and determine the next steps that must be taken in order to comply with state law. Work at that site MAY NOT PROCEED until the Environmental Department authorizes it.
26. A "qualified archaeologist," as specified under Wis. Stats 157.70 (1) (i) and Wis. Admin. Code HS 2.04 (6), must be present to monitor all ground disturbing activities.

Frac-out Contingency Plan

27. A frac-out contingency plan shall be on-site and implemented accordingly. The contingency plan shall incorporate the following components.
 - a. Continuously inspect the bore paths for frac-outs in order to respond quickly and appropriately.
 - b. Containment materials (e.g. silt fence, straw bales, sand bags, etc.) shall be on site and available should a frac-out occur.
 - c. A vac truck shall be accessible on short notice in order to respond quickly to a frac-out.



GRADE VERIFICATION FORM

Establishing the final grade on your property is necessary prior to the installation of We Energies underground facilities. To ensure public safety, state and national codes require us to install our facilities at certain depths. If relocation or repair of our facilities becomes necessary because of a grade change greater than 4 inches, you will be billed the full relocation or repair costs. Site must be ready and this form submitted by Nov. 1 to avoid seasonal charges for installations between Dec. 1 and March 31.

Project Details

Development Name: Village of Harrison Commerce Park

Municipality: V-Harrison

Work Request #: 5146977

AUTHORIZATION: I certify that I am the owner, or authorized representative of the owner, of the aforementioned development and that the entire route in which We Energies underground facilities are to be installed is within 4 inches of final grade. I certify the grade was confirmed by a surveying/engineering firm and that lot corner stakes are installed. I agree that I, or the owner of the property, will pay for any relocation or repair costs incurred by We Energies due to grade change in excess of 4 inches.

Signature: _____ Date: _____

Printed Name: _____

Title: _____