



Township Board Cover Sheet

Lake Shan-Gri-La – Aquatic Weed Control S.A.D.

Second Public Hearing to Re-Establish S.A.D. & Resolution to Adopt Assessment Roll

Information Packet:

Hamburg Township has received petitions from property owners requesting to re-establish the aquatic weed and algae treatment special assessment district for Lake Shan-Gri-La for a 10-year period. After the first public hearing it was determined that there was enough support to proceed with establishing the S.A.D.

- The maintenance district will be a “**self-funded**” S.A.D. that will pay for the services annually through an assessment on the winter tax bills.

The following items have been included for the Board’s review:

1. **Notice of Second Public Hearing:**

- A. Affidavit of Mailing
- B. Hearing Cover Letter
- C. Notice of Improvement Hearing – per Public Act 188 requirements
- D. Mailing List of Property Owners included in S.A.D.
- E. Supervisor’s Assessment Roll Certification
- F. Proposed Special Assessment Roll for Lake Shan-Gri-La Aquatic Weed Control S.A.D.

2. **Project Resolution:**

- **Resolution No. 3** – Resolution Confirming the Special Assessment Roll

NOTE: Property owners will have thirty (30) days to appeal their assessment with the Michigan Tax Tribunal once the Board confirms the Assessment Roll. The expiration date of the 30-day period to challenge the special assessment shall be August 14, 2025.



10405 Merrill Road ♦ P.O. Box 157
Hamburg, MI 48139
Phone: 810.231.1000 ♦ Fax: 810.231.4295
www.hamburg.mi.us

AFFIDAVIT OF MAILING

STATE OF MICHIGAN)
)ss
COUNTY OF LIVINGSTON)

BRITTANY K. CAMPBELL, being first duly sworn, deposes and says that she personally prepared for mailing, and did on July 2nd, 2025, send by first-class mail, the proposed **Lake Shan-Gri-La – Aquatic Weed Control Special Assessment District** notice of second public hearing, a true copy of which is attached hereto, to each record owner of or party in interest in all property to be assessed for the improvement described therein, as shown on the last local tax assessment records of the Township of Hamburg; that she personally compared the address on each envelope against the list of property owners as shown on the current tax assessment rolls of the Township; that each envelope contained therein such notice and was securely sealed with postage fully prepaid for first-class mail delivery and plainly addressed; and that she personally placed all of such envelopes in a United States Post Office receptacle on the above date.

Brittany K. Campbell
Brittany K. Campbell
Hamburg Township Utilities Coordinator

Subscribed and sworn to before me
this 2nd day of July, 2025
Courtney L. Paton
_____, Notary Public
Jackson County, MI

My commission expires: January 17, 2030
Acting in Livingston County

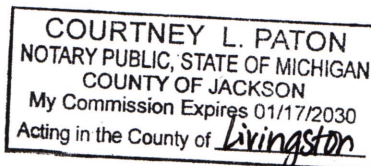



10405 Merrill Road ♦ P.O. Box 157
Hamburg, MI 48139
Phone: 810.231.1000 ♦ Fax: 810.231.4295
www.hamburg.mi.us

July 2nd, 2025

Re: Lake Shan-Gri-La – Aquatic Weed Control Special Assessment District
2nd Public Hearing Notice – July 15th, 2025 @ 6:30 P.M.

Dear Property Owner:

The Hamburg Township Board of Trustees has scheduled the second public hearing for the Lake Shan-Gri-La aquatic weed control special assessment district to be held on Tuesday, **July 15th, 2025 at 6:30 p.m.** at the Township Offices located at 10405 Merrill Road to discuss the assessment roll to be adopted by the Board. The assessment roll lists those properties included in the special assessment district and the amount to be assessed.

Enclosed please find the notice of public hearing and a map of the proposed special assessment district. The special assessment roll for the District has been prepared and is now on file in the offices of the Township Clerk and the Utilities Coordinator. The Roll is available for public examination during regular business hours at the Township Hall. This hearing is being held for the purpose of confirming the Assessment Roll.

The amount of the assessment for the first year to re-establish the district shall be **\$345.18** per parcel. The district will run over a ten (**10**) year period with the annual assessment to be included on the property taxes. The actual assessment amount will vary each year depending upon the amount of services provided under the prior budget year. Any money left over in the fund will be applied toward the money needed each year to furnish the requested aquatic weed treatment services. The assessment charge will appear annually on the winter tax bill.

The owner or other person having an interest in property that is assessed is entitled to file a written appeal with the Michigan Tax Tribunal within 30 days after confirmation of the Roll. However, appearance and protest at the public hearing are required by law in order to appeal the special assessment to the Michigan Tax Tribunal. An owner or other party in interest or his or her agent must file an objection in writing with the Township Clerk, Michael Dolan, before the closing of the hearing. The deadline to file an appeal if the Board adopts the Assessment Roll at the July 15, 2025 regularly scheduled Board meeting is August 14th, 2025. For more information regarding the special assessment district please contact Brittany Campbell, at (810) 231-1000 Ext. 210 or via email at bcampbell@hamburg.mi.us.

Sincerely,

Brittany K. Campbell
Hamburg Twp. Utilities/Special Projects Coordinator

FAX (810) 231-4295
TELEPHONE: (810) 231-1000



P.O. Box 157
10405 Merrill Road
Hamburg, MI 48139

Hamburg Township
Livingston County, Michigan

NOTICE OF PUBLIC HEARING
UPON SPECIAL ASSESSMENT ROLL FOR THE
LAKE SHAN-GRI-LA AQUATIC WEED CONTROL
SPECIAL ASSESSMENT DISTRICT

NOTICE IS HEREBY GIVEN:

(1) The Township Board of the Township of Hamburg, Livingston County, Michigan (the "Township") has determined to levy special assessments against lands in the LAKE SHAN-GRI-LA AQUATIC WEED CONTROL SPECIAL ASSESSMENT DISTRICT (the "District") that will be benefited by the aquatic weed and algae treatment services to be provided for the District. The District consists of the lands identified in the map attached to this notice and is more specifically identified by the following permanent parcel numbers:

15-21-404-001	15-21-404-002	15-21-404-008	15-21-404-009
15-21-404-014	15-21-404-015	15-21-404-020	15-21-404-021
15-21-404-022	15-21-404-023	15-21-404-024	15-21-404-025
15-21-404-029	15-21-404-030	15-21-404-031	15-21-404-032
15-21-404-033	15-21-404-034	15-21-404-035	15-21-404-036
15-21-405-004	15-21-405-007	15-21-405-011	15-21-405-012
15-21-405-017	15-21-405-018	15-12-405-019	15-21-405-020
15-21-405-021			

(2) The proposed special assessment roll for the District (the "Roll") has been prepared and is now on file in the office of the Township Clerk and is available at such office for public examination during the hours the Township Hall is regularly open to the public for business.

(3) The Township Board will conduct a public hearing beginning at 6:30 p.m., local time on Tuesday, July 15, 2025, at the Hamburg Township Hall, 10405 Merrill Road, Hamburg, Michigan to explain and answer questions pertaining to the Roll and to hear objections to the Roll. Any person objecting to the Roll must file his or her objections in writing before the close of the public hearing or within such additional time (if any) as the Township Board may grant.

(4) The owner or other person having an interest in property that is specially assessed is entitled to file a written appeal with the Michigan Tax Tribunal within 30 (thirty) days after confirmation of the Roll. However, appearance and protest at the public hearing are required by law in order to appeal the special assessment to the Michigan Tax Tribunal. An owner or other party in interest or his or her agent must file an objection in writing with the Township Clerk before the close of the hearing.

The Township Board will maintain a record of the persons who appear and protest at the hearing. If the hearing is terminated or adjourned for the day before a party is provided the opportunity to be heard, a party whose appearance was so recorded shall be considered to have protested the special assessment in person.

This notice is given by order of the Hamburg Township Board.

Dated: July 2nd, 2025
July 9th, 2025

Michael Dolan
Hamburg Township Clerk
10405 Merrill Rd. P.O. Box 157
Hamburg, MI 48139

LAKE SHAN-GRI-LA – AQUATIC WEED CONTROL SPECIAL ASSESSMENT DISTRICT

Hamburg Township, Livingston County, Michigan

The general service area in which a proposed special assessment district is to be designated. The Hamburg Township Board of Trustees may adjust the district boundaries based upon property owner response in support of creating an aquatic weed control special assessment district.

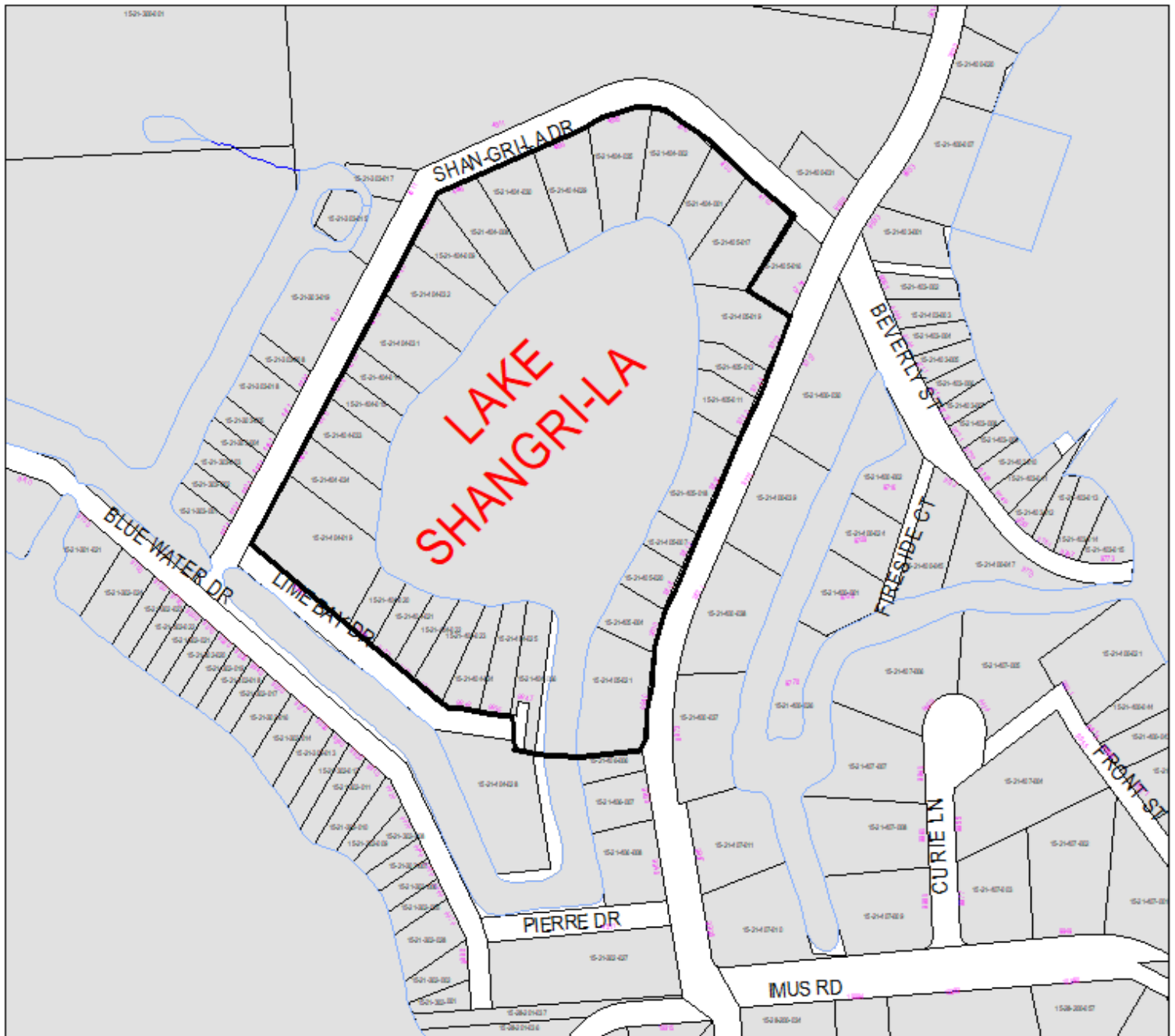

General service area establishing the Lake Shan-Gri-La Aquatic Weed Control Special Assessment District. **Proposed special assessment district boundary shown within thick black-lined area.**

15-21-404-001
Robert B. Schmidt Revocable Trust
1619 E. Bolingridge Dr.
Orange, CA 92865

15-21-404-002
Rodney & Elizabeth Howell
4678 Shan-Gri-La Dr.
Pinckney, MI 48169

15-21-404-008
Eric S. & Dana N. St. Pierre
4566 Shan-Gri-La Dr.
Pinckney, MI 48169

15-21-404-009
Michael Bollman
6100 Oak Valley Dr.
Whitmore Lake, MI 48189

15-21-404-014
Janet Leggat
4500 Shan-Gri-La Dr.
Pinckney, MI 48169

15-21-404-015
Nancy L. Bassett
4484 Shan-Gri-La Dr.
Pinckney, MI 48169

15-21-404-020
Patricia Hicks
9861 Lime Bay Dr. P.O. Box 561
Lakeland, MI 48143

15-21-404-021
Bradley & Michelle Fleenor
9873 Lime Bay Dr. P.O. Box 804
Lakeland, MI 48143

15-21-404-022
James L. & Teresa Ford
910 Savannah Rd.
Lewes, DE 19958

15-21-404-023
Jason Mackenzie
9901 Lime Bay Dr. P.O. Box 654
Lakeland, MI 48143

15-21-404-024
Deborah Kooperman
9919 Lime Bay Dr. P.O. Box 262
Lakeland, MI 48143

15-21-404-025
John P. Strauss
9935 Lime Bay Dr. P.O. Box 27
Lakeland, MI 48143

15-21-404-029
Michael G. & Angela M. Cesar
4636 Shan-Gri-La Dr.
Pinckney, MI 48169

15-21-404-030
Michael & Tammera Bollman
6100 Oak Valley Dr.
Whitmore Lake, MI 48189

15-21-404-031
Cynthia E. Voigtman
4518 Shan-Gri-La Dr.
Pinckney, MI 48169

15-21-404-032
Mary-Jelisse Bonello
4540 Shan-Gri-La Dr.
Pinckney, MI 48169

15-21-404-033
Gerald & Kathy Lilly
4476 Shan-Gri-La Dr. P.O. Box 369
Lakeland, MI 48143

15-21-404-034
Anthony T. & Elaine Rypkowski
2064 S. Cavalier Dr.
Canton, MI 48188

15-21-404-035
Pang Cheng-Xeng Hang
4666 Shan-Gri-La Dr.
Pinckney, MI 48169

15-21-404-035B
Pang Cheng-Xeng Hang
3370 Bauer Rd.
Brighton, MI 48116

15-21-404-036
John P. Strauss
9935 Lime Bay Dr. P.O. Box 27
Lakeland, MI 48143

15-21-405-004
John Morys III
9830 Kress Rd.
Pinckney, MI 48169

15-21-405-007
Virginia L. Maturen
9810 Kress Rd.
Pinckney, MI 48169

15-21-405-011
Larry P. Laughlin
9750 Kress Rd.
Pinckney, MI 48169

15-21-405-012
Kyle Jones & Tabitha Howk
9744 Kress Rd.
Pinckney, MI 48169

15-21-405-017
Dennis & Kathleen Down
4710 Shan-Gri-La Dr.
Pinckney, MI 48169

15-21-405-018
Donald R. & Dorothy Rogowski
9806 Kress Rd. P.O. Box 408
Lakeland, MI 48143

15-21-405-019
Rodney Marlow & Jill L. Love
9732 Kress Rd. P.O. Box 916
Lakeland, MI 48143

15-21-405-020
Cindy Clouse
9818 Kress Rd.
Pinckney, MI 48169

15-21-405-021
Kitty C. Campbell Trust
9840 Kress Rd.
Pinckney, MI 48169

FAX (810) 231-4295
TELEPHONE: (810) 231-1000



P.O. Box 157
10405 Merrill Road
Hamburg, MI 48139

CERTIFICATE

Lake Shan-Gri-La Aquatic Weed Control S.A.D.

I, the undersigned, Supervisor of Hamburg Township, Livingston County, Michigan (the "Township"), acting pursuant to a resolution duly adopted by the Board of the Township on June 17th, 2025 (the "Resolution") certify that (1) the attached special assessment roll for the Hamburg Township **Lake Shan-Gri-La** Aquatic Weed Control Special Assessment District, to which this Certificate is affixed, was made pursuant to the Resolution and (2) in making such roll, I have, according to my best judgment, conformed in all respects to the directions contained in the Resolution and the statutes of the State of Michigan, including Act No. 188, Public Acts of Michigan, 1954, as amended.

Dated: 6-23-2025

Patrick J. Hohl
Hamburg Township Supervisor

HAMBURG TOWNSHIP
LAKE SHAN-GRI-LA – AQUATIC WEED CONTROL DISTRICT
PROPOSED SPECIAL ASSESSMENT ROLL
EXHIBIT “B”

Tax I.D. #	Property Owner Name & Address	Legal Description	True Cash Value	Vacant/Occupied	Assessment
15-21-404-001	Robert B. Schmidt Revocable Trust 1619 E. Bolingridge Dr. Orange, CA 92865	SEC 21 T1N R5E SHAN GRI LA SUBN ANNEX NO. 5 LOT 84.	\$ 365,400.00	Occupied	\$ 345.18
15-21-404-002	Rodney & Elizabeth Howell 4678 Shan-Gri-La Dr. Pinckney, MI 48169	SEC 21 T1N R5E SHAN GRI LA SUBN ANNEX NO. 5 LOT 85 & E 1/2 LOT 86.	668,120.00	Occupied	345.18
15-21-404-008	Eric S. & Dana N. St. Pierre 4566 Shan-Gri-La Dr. Pinckney, MI 48169	SEC 21 T1N R5E SHAN GRI LA SUBN ANNEX NO. 5 OUTLET E.	546,100.00	Occupied	345.18
15-21-404-009	Michael Bollman 6100 Oak Valley Dr. Whitmore Lake, MI 48189	SEC 21 T1N R5E SHAN GRI LA SUBN ANNEX NO. 5 LOT 91.	148,020.00	Vacant	345.18
15-21-404-014	Janet Leggat 4500 Shan-Gri-La Dr. Pinckney, MI 48169	SEC 21 T1N R5E SHAN GRI LA SUBN ANNEX NO. 5 LOT 96.	380,580.00	Occupied	345.18
15-21-404-015	Nancy L. Bassett 4484 Shan-Gr-La Dr. Pinckney, MI 48169	SEC 21 T1N R5E SHAN GRI LA SUBN ANNEX NO. 5 LOT 97.	367,060.00	Occupied	345.18
15-21-404-020	Patricia Hicks 9861 Lime Bay, P.O. Box 561 Lakeland, MI 48143	SEC 21 T1N R5E SHAN GRI LA SUBN ANNEX NO. 5 LOT 101.	281,400.00	Occupied	345.18
15-21-404-021	Bradley & Michelle Fleenor 9873 Lime Bay, P.O. Box 804 Lakeland, MI 48143	SEC 21 T1N R5E SHAN GRI LA SUBN ANNEX NO. 5 LOT 102.	421,680.00	Occupied	345.18

HAMBURG TOWNSHIP
LAKE SHAN-GRI-LA – AQUATIC WEED CONTROL DISTRICT
PROPOSED SPECIAL ASSESSMENT ROLL
JULY 15, 2025

Tax I.D. #	Property Owner Name & Address	Legal Description	True Cash Value	Vacant/Occupied	Assessment
15-21-404-022	James L. & Teresa Ford 910 Savannah Rd. Lewes, DE 19958	SEC 21 T1N R5E SHAN GRI LA SUBN ANNEX NO. 5 LOT 103.	\$ 334,220.00	Occupied	\$ 345.18
15-21-404-023	Jason Mackenzie 9901 Lime Bay, P.O. Box 654 Lakeland, MI 48143	SEC 21 T1N R5E SHAN GRI LA SUBN ANNEX NO. 5 LOT 104.	431,420.00	Occupied	345.18
15-21-404-024	Daryl A. & Deborah Kooperman 9919 Lime Bay, P.O. Box 262 Lakeland, MI 48143	SEC 21 T1N R5E SHAN GRI LA SUBN ANNEX NO. 5 LOT 105.	449,200.00	Occupied	345.18
15-21-404-025	John P. Strauss 9935 Lime Bay, P.O. Box 27 Lakeland, MI 48143	SEC 21 T1N R5E SHAN GRI LA SUBN ANNEX NO. 5 LOT 106.	342,300.00	Occupied	345.18
15-21-404-029	Michael G. & Angela M. Cesar 4636 Shan-Gri-La Dr. Pinckney, MI 48169	SEC 21 T1N R5E SHAN GRI LA SUBN ANNEX NO. 5 LOT 88 & NELY 1/2 LOT 89.	538,880.00	Occupied	345.18
15-21-404-030	Michael & Tammera Bollman 6100 Oak Valley Dr. Whitmore Lake, MI 48189	SEC 21 T1N R5E SHAN GRI LA SUBN ANNEX NO. 5 THE SWLY 1/2 LOT 89 & LOT 90.	187,340.00	Vacant	345.18
15-21-404-031	Cynthia E. Voigtman 4518 Shan-Gri-La Dr. Pinckney, MI 48169	SEC 21 T1N R5E SHAN GRI LA SUBN ANNEX NO. 5 LOTS 94 & 95.	491,920.00	Occupied	345.18
15-21-404-032	Mary-Jelisse Bonello 4540 Shan-Gri-La Dr. Pinckney, MI 48169	SEC 21 T1N R5E SHAN GRI LA SUBN ANNEX NO. 5 LOTS 92 & 93.	542,700.00	Occupied	345.18

HAMBURG TOWNSHIP
LAKE SHAN-GRI-LA – AQUATIC WEED CONTROL DISTRICT
PROPOSED SPECIAL ASSESSMENT ROLL
JULY 15, 2025

Tax I.D. #	Property Owner Name & Address	Legal Description	True Cash Value	Vacant/Occupied	Assessment
15-21-404-033	Gerald & Kathy Lilly 4476 Lime Bay, P.O. Box 369 Lakeland, MI 48143	SEC 21 T1N R5E SHAN GRI LA SUBN ANNEX NO. 5 LOT 98 & NLY 1/2 LOT 99.	\$ 729,120.00	Occupied	\$ 345.18
15-21-404-034	Anthony T. & Elaine Rypkowski 2064 S. Cavalier Dr. Canton, MI 48188	SEC 21 T1N R5E SHAN GRI LA SUBN ANNEX NO. 5 LOT 100 & SLY 1/2 LOT 99.	323,040.00	Occupied	345.18
15-21-404-035	Pang Cheng-Xeng Hang 4666 Shan-Gri-La Dr. Pinckney, MI 48169	SEC 21 T1N R5E SHAN GRI LA SUBN ANNEX NO. 5 LOT 87 & W 1/2 LOT 86.	499,980.00	Occupied	345.18
15-21-404-036	John P. Strauss 9935 Lime Bay, P.O. Box 27 Lakeland, MI 48143	SEC 21 T1N R5E SHAN GRI LA SUBN ANNEX NO. 5 LOT 107 & OUTLOT G.	130,780.00	Occupied	345.18
15-21-405-004	John Morys III 9830 Kress Rd. Pinckney, MI 48169	SEC 21 T1N R5E SHAN GRI LA SUBN ANNEX NO. 4 LOT 72 & S 25.15 FT OF LOT 73.	366,440.00	Occupied	345.18
15-21-405-007	Virginia L. Maturen 9810 Kress Rd. Pinckney, MI 48169	SEC 21 T1N R5E SHAN GRI LA SUBN ANNEX NO. 4 LOT 75 & S 15 FT LOT 76.	346,780.00	Occupied	345.18
15-21-405-011	Larry P. Laughlin 9750 Kress Rd. Pinckney, MI 48169	SEC 21 T1N R5E SHAN GRI LA SUBN ANNEX NO. 4 LOT 80 & N 1/2 LOT 79.	328,340.00	Occupied	345.18
15-21-405-012	Kyle Jones & Tabitha Howk 9744 Kress Rd. Pinckney, MI 48169	SEC 21 T1N R5E SHAN GRI LA SUBN ANNEX NO. 4 LOT 81.	605,000.00	Occupied	345.18

HAMBURG TOWNSHIP
LAKE SHAN-GRI-LA – AQUATIC WEED CONTROL DISTRICT
PROPOSED SPECIAL ASSESSMENT ROLL
JULY 15, 2025

Tax I.D. #	Property Owner Name & Address	Legal Description	True Cash Value	Vacant/Occupied	Assessment
15-21-405-017	Dennis & Kathleen Down 4710 Shan-Gri-La Dr. Pinckney, MI 48169	SEC 21 T1N R5E PART OF OUTLOT D SHAN GRI LA SUB ANNEX 4 BEG AT PT N 58*W 119.05 FT FROM THE SE COR OUTLOT D TH N78*W 118.10 FT TH N 12*W 50 FT TH N 43*E 211.26 FT TH S 51*E 121.30 FT ALG THE SLY ROW SHAN GRI LA DR TH S 37*W 186.85 FT TO POB 0.66 AC PARCEL 1.	\$ 394,600.00	Occupied	\$ 345.18
15-21-405-018	Donald R. & Dorothy Rogowski 9806 Kress Rd., P.O. Box 408 Lakeland, MI 48143	SEC 21 T1N R5E SHAN GRI LA SUBN ANNEX NO. 4 LOT 76 EXC S 15 FT LOT 77 OUTLOT E LOT 78 & S 1/2 LOT 79.	422,620.00	Occupied	345.18
15-21-405-019	Rodney Marlow & Jill S. Love 9732 Kress Rd., P.O. Box 916 Lakeland, MI 48143	SEC 21 T1N R5E SHAN GRI LA SUBN ANNEX NO. 4 LOTS 82 & 83.	594,800.00	Occupied	345.18
15-21-405-020	Cindy Clouse 9818 Kress Rd. Pinckney, MI 48169	SEC 21 T1N R5E SHAN GRI LA SUBN ANNEX NO. 4 LOTS 73 EXC S 25.15 FT THEREOF & LOT 74.	300,540.00	Occupied	345.18
15-21-405-021	Kitty C. Campbell Trust 9840 Kress Rd. Pinckney, MI 48169	SEC 21 T1N R5E SHAN GRI LA SUBN ANNEX NO. 4 LOTS 69, 70 & 71.	402,660.00	Occupied	345.18
Total Project Assessments:					\$ 10,010.00
TOTAL ESTIMATED PROJECT COST:					<u>\$ 10,010.00</u>

**LAKE SHAN-GRI-LA – AQUATIC WEED CONTROL
SPECIAL ASSESSMENT DISTRICT RESOLUTION
(Resolution #3)**

TOWNSHIP OF HAMBURG

At a regular meeting of the Township Board of the Township of Hamburg, Livingston County, Michigan, (the “Township”) held at the Hamburg Township Hall on Tuesday, July 15th, 2025, at 7:30 p.m., there were

PRESENT: _____

ABSENT: _____

The following preamble and resolution were offered by _____ and seconded by _____.

**RESOLUTION CONFIRMING SPECIAL ASSESSMENT ROLL
FOR THE LAKE SHAN-GRI-LA
AQUATIC WEED CONTROL SPECIAL ASSESSMENT DISTRICT**

WHEREAS, the Township Board of the Township of Hamburg, Livingston County, Michigan, after due and legal notice, has conducted a public hearing upon a proposed Special Assessment Roll prepared by the Supervisor and Assessing Officer of the Township for the purpose of defraying the costs of aquatic weed control services to be performed within the Special Assessment District as requested by petitions received from the property owners for such project;

WHEREAS, the Township Board has acknowledged that the Township Supervisor has filed the proposed Special Assessment Roll with the Township Clerk;

WHEREAS, such public hearing was preceded by proper notice in the Livingston County Press & Argus, a newspaper of general circulation in the township, and by First Class Mail notice to each property owner of record within said district and upon said assessment roll;

WHEREAS, comments were received from those present at such public hearing concerning said assessment roll and opportunity to all present to be heard in the matter;

WHEREAS, written objections, if any, were received to said roll and levy;

WHEREAS, the oral comments received indicated the reasonableness of the following assessment roll and any amendments thereto;

WHEREAS, a record of those present to protest, and of written protests submitted at or before the public hearing was made a part of the minutes of the hearing;

WHEREAS, The Township Board has duly inspected the proposed Assessment Roll and has considered all comments and proposed amendments thereto, and has found the proposed Assessment Roll to be correct, just and reasonable;

NOW, THEREFORE, BE IT RESOLVED THAT:

1. Roll Confirmed. In accordance with Act No. 188, Michigan Public Acts of 1954, as amended, and the laws of the State of Michigan, the Township Board hereby confirms the Special Assessment Roll in the form of Exhibit "B" for the Lake Shan-Gri-La Aquatic Weed Control Special Assessment District (the "Roll").

2. Future Installments - Principal. The Township Board determines that each Special Assessment may be paid in 10 annual installments. The first installment shall be due on December 1, 2025. Each subsequent installment shall be due at intervals 12 months from the due date of the first installment.

3. Warrant. The Township Clerk is hereby directed to attach a warrant (in the form of Exhibit A to this resolution) to the Roll and to deliver such warrant and the Roll to the Township Treasurer, who shall thereupon collect the special assessments in accordance with the terms of this Resolution, the Clerk's warrant and the statutes of the State of Michigan.

5. Ratification of Notice. The form and content of the notice published and mailed to property owners in the special assessment district by the Township Clerk with respect to the public hearing held on July 15th, 2025, and all action of Township officials in scheduling such hearing, are hereby approved, ratified and confirmed.

6. Inconsistent Prior Resolutions. All previously adopted resolutions that are in conflict with this resolution are repealed to the extent of such conflict.

A vote on the foregoing resolution was taken and was as follows:

YES: _____

NO: _____

ABSENT: _____

Resolution _____.

CLERK'S CERTIFICATE

The undersigned, being the duly elected Clerk of the Township, hereby certifies that (1) the foregoing is a true and complete copy of a resolution duly adopted by the Township Board at a regular meeting at which meeting a quorum was present and remained throughout, (2) the original thereof is on file in the records in my office, (3) the meeting was conducted, and public notice thereof was given, pursuant to and in full compliance with the Open Meetings Act (Act No. 267, Public Acts of Michigan, 1976, as amended) and (4) minutes of such meeting were kept and will be or have been made available are required thereby.

Michael Dolan
Hamburg Township Clerk

EXHIBIT A

Public Act 188 of 1954 Proceedings

Warrant for Collection of Hamburg Township Special Assessment Roll No. X4499

TO: The Treasurer of Hamburg Township, Livingston County, Michigan

In accordance with the attached resolution of the Hamburg Township Board of Trustees adopted on July 15, 2025, you are hereby directed to collect the special assessments set forth in the attached Hamburg Township **Lake Shan-Gri-La – Aquatic Weed Control** Special Assessment Roll No. X4499 from the owners of the properties described in said assessment roll, together with such interest and penalties as set forth in said resolution and prescribed by statute.

Any sums due after December 1, 2025 shall bear interest at the rate of 0 percent per annum. Any assessments or portions thereof paid prior to December 1, 2025 shall not bear any interest.

In any installment of a special assessment is not paid when due, there shall be collected, in addition to interest, a penalty at the rate of 10 percent for each month or fraction of a month that the installment remains unpaid before being reported to the Township Board for reassessment upon the township tax roll under the provisions of PA 188 of 1954, as amended.

Township Clerk signature:_____

Dated: _____

Township: Hamburg