



# Township Board Cover Sheet

## **Zukey & Redding Drive – Road Improvement S.A.D.** **Second Public Hearing to Establish S.A.D. & Resolution to Adopt Assessment Roll**

### **Information Packet:**

Hamburg Township has received petitions from property owners requesting to establish a road improvement special assessment district for Zukey Drive and Redding Drive for a 10-year period. After the first public hearing it was determined that there was enough support to proceed with establishing the S.A.D.

- The S.A.D shall be funded through a bond sale that will pay for the road improvements through an annual assessment on the winter tax bills beginning December 1, 2024.

The following items have been included for the Board's review:

### 1. **Notice of Second Public Hearing:**

- A. Affidavit of Mailing
- B. Hearing Cover Letter
- C. Notice of Improvement Hearing – per Public Act 188 requirements
- D. Mailing List of Property Owners included in S.A.D.
- E. Supervisor's Assessment Roll Certification
- F. Proposed Special Assessment Roll for the Zukey & Redding Drive - Road Improvement S.A.D.

### 2. **Project Resolution:**

- **Resolution No. 5** – Resolution Confirming the Special Assessment Roll

**NOTE:** Property owners will have thirty (30) days to appeal their assessment with the Michigan Tax Tribunal once the Board confirms the Assessment Roll. The expiration date of the 30-day period to challenge the special assessment shall be **May 16<sup>th</sup>, 2024.**



10405 Merrill Road ♦ P.O. Box 157  
Hamburg, MI 48139  
Phone: 810.231.1000 ♦ Fax: 810.231.4295  
www.hamburg.mi.us

AFFIDAVIT OF MAILING

STATE OF MICHIGAN        )  
  )ss  
COUNTY OF LIVINGSTON)

BRITTANY K. CAMPBELL, being first duly sworn, deposes, and says that she personally prepared for mailing, and did on April 3<sup>rd</sup>, 2024, send by first-class mail, the **Zukey & Redding Drive - Road Improvement Special Assessment District** notice of second public hearing, a true copy of which is attached hereto, to each record owner of or party in interest in all property to be assessed for the improvement described therein, as shown on the last local tax assessment records of the Township of Hamburg; that she personally compared the address on each envelope against the list of property owners as shown on the current tax assessment rolls of the Township; that each envelope contained therein such notice and was securely sealed with postage fully prepaid for first-class mail delivery and plainly addressed; and that she personally placed all of such envelopes in a United States Post Office receptacle on the above date.

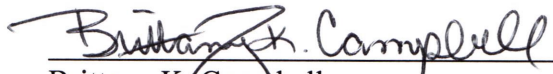
  
\_\_\_\_\_  
Brittany K. Campbell  
Hamburg Township Utilities Coordinator

Subscribed and sworn to before me  
this 3 day of April, 2024.

  
\_\_\_\_\_  
, Notary Public  
Livingston County, MI  
My commission expires:  
Acting in Livingston County



LISA D. PERSCHKE  
NOTARY PUBLIC - STATE OF MICHIGAN  
COUNTY OF LIVINGSTON  
My Commission Expires 11/08/2028  
Acting in the County of Livingston

FAX (810) 231-4295  
TELEPHONE: (810) 231-1000



P.O. Box 157  
10405 Merrill Road  
Hamburg, MI 48139

April 3<sup>rd</sup>, 2024

Re: **Notice of Public Hearing**  
Zukey & Redding Drive - Road Improvement Special Assessment District

Dear Property Owner,

The Hamburg Township Board of Trustees has scheduled the second public hearing for the Zukey & Redding Drive road improvement district to be held on Tuesday, **April 16<sup>th</sup>, 2024 at 6:30 p.m.** at the Township Offices located at 10405 Merrill Road to discuss the assessment roll to be adopted by the Board. The assessment roll lists those properties included in the special assessment district and the amount to be assessed.

Enclosed please find the notice of public hearing and a map of the proposed special assessment district. The special assessment roll for the District has been prepared and is now on file in the offices of the Township Clerk and the Utilities Coordinator. The Roll is available for public examination during regular business hours at the Township Hall. This hearing is being held for the purpose of confirming the Assessment Roll.

The amount of the special assessment is \$6,541.57 per parcel plus interest, the rate to be determined at the time the bonds to finance the project are sold. The district will run over a ten (10) year period with the annual assessment to be included on the property taxes beginning on December 1, 2024. The assessment charge will appear annually on the winter tax bill.

The owner or other person having an interest in property that is assessed is entitled to file a written appeal with the Michigan Tax Tribunal within 30 days after confirmation of the Roll. However, appearance and protest at the public hearing are required by law in order to appeal the special assessment to the Michigan Tax Tribunal. An owner or other party in interest or his or her agent must file an objection in writing with the Township Clerk, Michael Dolan, before the closing of the hearing. The deadline to file an appeal if the Board adopts the Assessment Roll at the April 16, 2024 regularly scheduled Board meeting is May 16<sup>th</sup>, 2024. For more information regarding the special assessment district please contact Brittany Campbell, at (810) 231-1000 Ext. 210 or via email at [bcampbell@hamburg.mi.us](mailto:bcampbell@hamburg.mi.us).

Sincerely,

  
Brittany K. Campbell  
Hamburg Township Utilities Coordinator

FAX (810) 231-4295  
TELEPHONE: (810) 231-1000



P.O. Box 157  
10405 Merrill Road  
Hamburg, MI 48139

## NOTICE OF PUBLIC HEARING

Hamburg Township  
Livingston County, Michigan

NOTICE OF PUBLIC HEARING  
UPON SPECIAL ASSESSMENT ROLL FOR THE  
ZUKEY & REDDING DRIVE ROAD IMPROVEMENT PROJECT  
SPECIAL ASSESSMENT DISTRICT

NOTICE IS HEREBY GIVEN:

(1) The Township Board of the Township of Hamburg, Livingston County, Michigan (the “Township”) has determined to levy special assessments against lands in the ZUKEY & REDDING DRIVE ROAD IMPROVEMENT PROJECT SPECIAL ASSESSMENT DISTRICT (the “District”) that will be benefited by the construction of road improvements in the District. The District consists of the lands identified in the map attached to this notice and is more specifically identified by the following permanent parcel numbers:

15-22-300-002	15-22-300-003	15-22-300-004	15-22-300-034
15-22-300-035	15-22-300-036	15-22-300-037	15-22-300-038
15-22-300-039	15-22-300-040	15-22-300-041	15-22-300-042
15-22-300-043	15-22-300-044	15-22-300-045	15-22-300-047
15-22-300-048	15-22-300-049	15-22-300-052	15-22-300-053
15-22-300-064	15-22-301-001	15-22-301-002	15-22-301-003
15-22-301-004	15-22-301-005	15-22-301-006	15-22-301-007
15-22-301-009	15-22-301-011	15-22-301-012	15-22-301-013
15-22-302-001	15-22-302-002	15-22-302-003	15-22-302-004
15-22-302-007	15-22-302-009	15-22-302-010	15-22-302-014
15-22-302-017	15-22-302-018	15-22-302-021	15-22-302-022
15-22-302-023	15-22-302-024	15-22-302-025	15-22-302-026
15-22-302-027	15-22-302-030	15-22-302-031	15-22-302-032
15-22-302-034	15-22-302-037	15-22-302-041	15-22-302-042
15-22-302-043	15-22-302-044	15-22-302-045	15-22-302-046
15-22-302-047			

(2) The proposed special assessment roll for the District (the “Roll”) has been prepared and is now on file in the office of the Township Clerk and is available at such office for public examination during the hours the Township Hall is regularly open to the public for business.

(3) The Township Board will conduct a public hearing beginning at 6:30 p.m., local time on Tuesday, April 16, 2024, at the Hamburg Township Hall, 10405 Merrill Road, Hamburg, Michigan to explain and answer questions pertaining to the Roll and to hear objections to the Roll. Any person objecting to the Roll must file his or her objections in writing before the close of the public hearing or within such additional time (if any) as the Township Board may grant.

(4) The owner or other person having an interest in property that is specially assessed is entitled to file a written appeal with the Michigan Tax Tribunal within 30 (thirty) days after confirmation of the Roll. However, appearance and protest at the public hearing are required by law in order to appeal the special assessment to the Michigan Tax Tribunal. An owner or other party in interest or his or her agent must file an objection in writing with the Township Clerk before the close of the hearing.

(5) The estimated cost of the Project is subject to quarterly periodic redetermination of costs, without further notice, pursuant to MCL 41.724(4).

The Township Board will maintain a record of the persons who appear and protest at the hearing. If the hearing is terminated or adjourned for the day before a party is provided the opportunity to be heard, a party whose appearance was so recorded shall be considered to have protested the special assessment in person.

This notice is given by order of the Hamburg Township Board.

Dated: April 3<sup>rd</sup>, 2024

Michael Dolan  
Hamburg Township Clerk  
10405 Merrill Rd. P.O. Box 157  
Hamburg, MI 48139

**Zukey & Redding Drive Road Improvement Project  
Hamburg Township, Livingston County, Michigan**

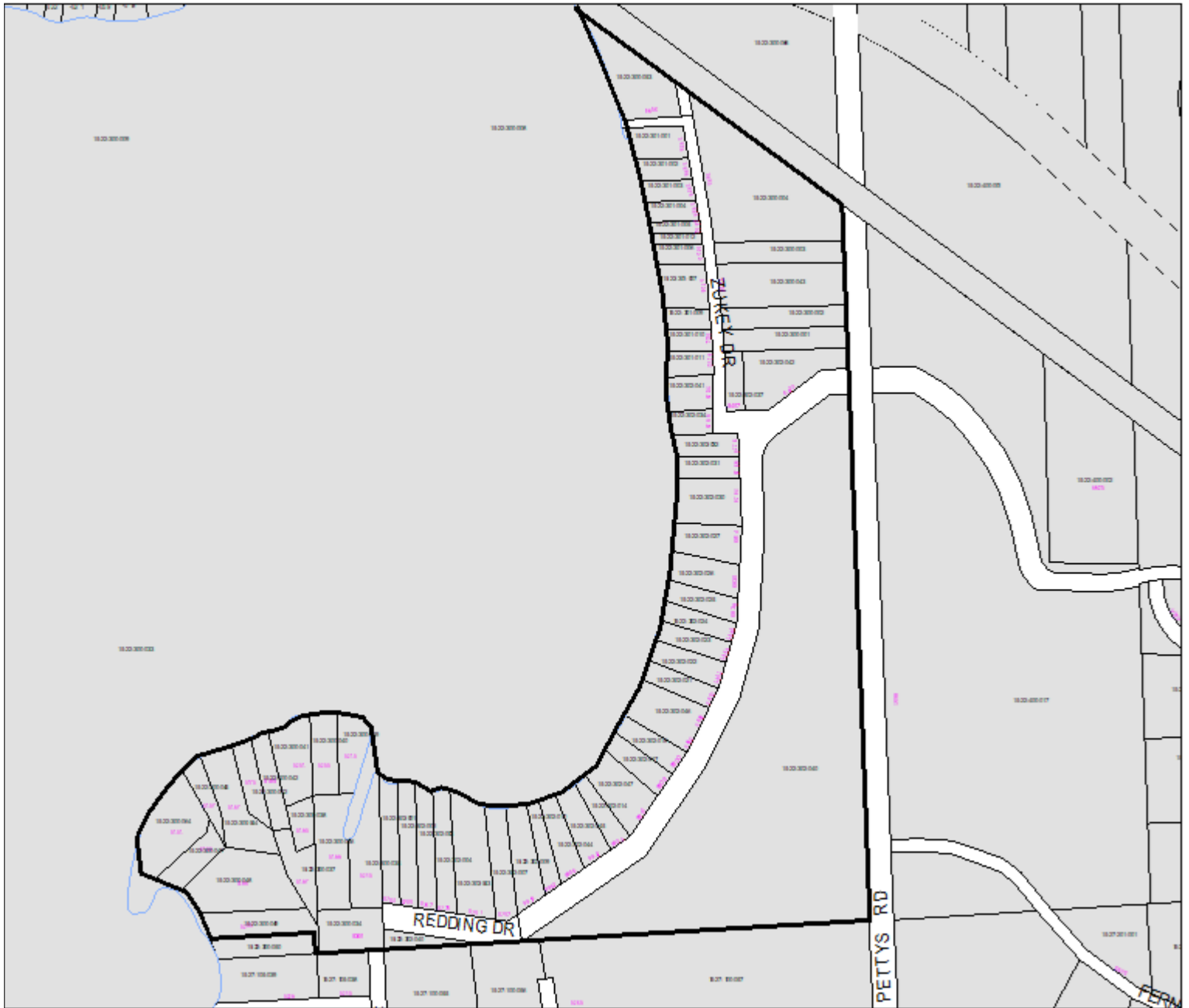

Zukey & Redding Drive Road Improvement Project.

15-22-300-002  
William D. Miller Rev. Trust  
910 E. Morris Dr.  
Palatine, IL 60074

15-22-300-003  
Nicholas & Jodi Graham  
9669 Zukey Dr.  
Pinckney, MI 48169

15-22-300-004  
Nicholas & Jodi Graham  
9669 Zukey Dr.  
Pinckney, MI 48169

15-22-300-034  
Robert M. & Kelly R. Miller  
5240 Redding Dr.  
Pinckney, MI 48169

15-22-300-035  
Todd A. Weiss  
5245 Redding Dr.  
Pinckney, MI 48169

15-22-300-036  
Kenneth Raszka & Janice Keen-  
Raszka  
1666 Knotty Pine  
North Port FL 34288

15-22-300-037  
Dawn Nelson  
P.O. Box 441  
Hamburg, MI 48139

15-22-300-038  
Paul & Siobhan Durand  
5195 Redding Dr.  
Pinckney, MI 48169

15-22-300-039  
Barbara A. Dicks  
P.O. Box 543  
Lakeland, MI 48143

15-22-300-040  
Edward Wachlarz  
4745 Kingsley Dr.  
Warren, MI 48092

15-22-300-041  
Glenn & Rosalinda Deline  
P.O. Box 194  
Lakeland, MI 48143

15-22-300-042  
Amy Bennett  
51840 Eva  
Macomb, MI 48042

15-22-300-043  
Elizabeth A. Winter Trust  
9715 Zukey Dr.  
Pinckney, MI 48169

15-22-300-044  
Scott W. Taylor  
P.O. Box 159  
Lakeland, MI 48143

15-22-300-045  
Randy M. & Catherine M. Layton  
5157 Redding Dr.  
Pinckney, MI 48169

15-22-300-047  
Joseph & Cathy Mazur  
8991 Thornapple  
Pinckney, MI 48169

15-22-300-048  
Jonathan B. Iras  
P.O. Box 7  
Pinckney, MI 48169

15-22-300-049  
Michael & Mary C. Arsenault  
P.O. Box 78  
Lakeland, MI 48143

15-22-300-052  
Kevin Keogh  
5175 Redding Dr.  
Pinckney, MI 48169

15-22-300-053  
Paul & Christy Stark  
11 Ashley Ct.  
Rocky River, OH 44116

15-22-300-064  
Angela McFadden  
5151 Redding Dr.  
Pinckney, MI 48169

15-22-301-001  
Stephen & Catherine L. Boston Living  
Trust  
P.O. Box 609  
Lakeland MI 48143

15-22-301-002  
Stephen & Catherine Boston Living  
Trust  
P.O. Box 609  
Lakeland MI 48143

15-22-301-003  
Richard M. & Elizabeth K. Beaudin  
P.O. Box 158  
Hamburg, MI 48139

15-22-301-004  
Paul R. & Jennifer M. Rohl  
P.O. Box 116  
Lakeland, MI 48143

15-22-301-005  
Jodi & Nicholas Graham  
9669 Zukey Dr.  
Pinckney, MI 48169

15-22-301-006  
John T. & Michelle J. Lamb  
9700 Zukey Dr.  
Pinckney, MI 48169

15-22-301-007  
Marlo K. & Troy Scheff  
9708 Zukey Dr.  
Pinckney, MI 48169

15-22-301-009  
William D. Miller Rev. Trust  
910 E. Morris Rd.  
Palatine, IL 60074

15-22-301-011  
William Mroan  
P.O. Box 583  
Lakeland, MI 48143

15-22-301-012  
Nicholas & Jodi Graham  
9669 Zukey Dr.  
Pinckney, MI 48169

15-22-301-013  
Steven A. Williams  
9732 Zukey Dr.  
Pinckney, MI 48169

15-22-302-001  
Charles & Suzanne Kronk  
P.O. Box 294  
Lakeland, MI 48143

15-22-302-002  
Diane Reschke  
P.O. Box 192  
Lakeland, MI 48143

15-22-302-003  
Pearl F. Monkiewicz  
3838 SW 112th Street  
Ocala, FL 34476

15-22-302-004  
Charles L. & Suzanne A. Kronk  
P.O. Box 294  
Lakeland, MI 48143

15-22-302-007  
Charles L. & Suzanne A. Kronk  
P.O. Box 294  
Lakeland, MI 48143

15-22-302-009  
David & Marianne Dauer  
3206 Stone Wall Rd.  
Maumee, OH 43537

15-22-302-010  
Patrick & Kimberly Fuller  
P.O. Box 750  
Lakeland, MI 48143

15-22-302-014  
Richard Desana  
9934 Zukey Dr.  
Pinckney, MI 48169

15-22-302-017  
James E. Merchant  
P.O. Box 872  
Lakeland, MI 48143

15-22-302-018  
Susan & David Smith  
P.O. Box 735  
Lakeland, MI 48143

15-22-302-021  
Matthew & Lauren Carlisle  
P.O. Box C  
Lakeland, MI 48143

15-22-302-022  
Joleen Bowman & Thelma J. Dasho  
9862 Zukey Dr.  
Pinckney, MI 48169

15-22-302-023  
David A. & Deborah A. Abramson  
P.O. Box 513  
Lakeland, MI 48143

15-22-302-024  
Virginia W. Bryant Trust  
905 Madison St.  
Brighton, MI 48116

15-22-302-025  
Andrew J. & Marlene E. Miller  
4680 Huntington Dr.  
Brighton, MI 48116

15-22-302-026  
David & Jennifer Chopp  
9830 Zukey Dr.  
Pinckney, MI 48169

15-22-302-027  
Michael R. & Susan E. Tomes Trust  
7015 Whittlebury Trail  
Bradenton, FL 34202

15-22-302-030  
James & Cynthia J. Maratta  
P.O. Box 572  
Lakeland, MI 48143

15-22-302-031  
Kathleen Masinda  
P.O. Box 339  
Lakeland, MI 48143

15-22-302-032  
Kathleen M. Sheehan  
9778 Zukey Dr.  
Pinckney, MI 48169

15-22-302-034  
Joyce Stimmell & Elizabeth Hodges  
10207 Ni River Dr.  
Spotsylvania, VA 22553

15-22-302-037  
William E. Moran  
P.O. Box 583  
Lakeland, MI 48143

15-22-302-041  
Patrick Curley  
P.O. Box 297  
Lakeland, MI 48143

15-22-302-042  
James A. Collins  
P.O. Box 125  
Lakeland, MI 48143

15-22-302-043  
Jeffrey L. Young  
P.O. Box 512  
Lakeland, MI 48143

15-22-302-044  
Douglas A. Bopp  
26338 Hidden Valley Ct.  
Farmington Hills, MI 48331

15-22-302-045  
Glenn S. Lieckfield  
P.O. Box 52  
Lakeland, MI 48143

15-22-302-046  
Joseph & Ann M. Szalony  
P.O. Box 753  
Lakeland, MI 48143



15-22-302-047

John M. & Pennie Bresette

4350 W. Ellsworth

Ann Arbor, MI 48103



10405 Merrill Road ♦ P.O. Box 157  
Hamburg, MI 48139  
Phone: 810.231.1000 ♦ Fax: 810.231.4295  
www.hamburg.mi.us

---

SUPERVISOR'S CERTIFICATE  
ZUKEY & REDDING DRIVE – ROAD IMPROVEMENT SAD

I, the undersigned, Supervisor of Hamburg Township, Livingston County, Michigan (the “Township”), acting pursuant to a resolution duly adopted by the Board of the Township on March 19<sup>th</sup>, 2024 (the “Resolution”) certify that (1) the attached special assessment roll for the Hamburg Township Zukey & Redding Drive Road Improvement Project Special Assessment District, to which this Certificate is affixed, was made pursuant to the Resolution and (2) in making such roll, I have, according to my best judgment, conformed in all respects to the directions contained in the Resolution and the statutes of the State of Michigan, including Act No. 188, Public Acts of Michigan, 1954, as amended.

Dated: 03-21-2024

Patrick J. Hohl  
Hamburg Township Supervisor

HAMBURG TOWNSHIP  
**ZUKEY & REDDING DRIVE ROAD IMPROVEMENT PROJECT**  
 PROPOSED SPECIAL ASSESSMENT ROLL  
**EXHIBIT "B"**

Tax I.D. #	Property Owner Name & Address	Legal Description	True Cash Value	Vacant/Occupied	Assessment
15-22-300-002	William D. Miller Revocable Trust 910 E. Morris Dr. Palatine, IL 60074	SEC 22 T1N R5E BEG 99 FT N OF SE COR OF NE1/4 OF SW1/4 N 49.5 FT W 386.5 FT TO ELY SIDE PETTYS DR S4*E 49.5 FT TH E 385 FT TO BEG	\$ 57,440.00	Vacant	\$ 6,541.57
15-22-300-003	Nicholas & Jodi Graham 9669 Zukey Dr. Pinckney, MI 48169	SEC 22 T1N R5E COM NE COR LOT 5 OF PETTYS SUB TH E 30 FT TH S 7* 30' E 48 FT FOR BEG TH S 7* 30' S 50 FT TH E TO RD TH N 50 FT TH W 387 FT TO POB	36,406.00	Vacant	6,541.57
15-22-300-004	Nicholas & Jodi Graham 9669 Zukey Dr. Pinckney, MI 48169	SEC 22 T1N R5E COM SE COR LOT 4 PETTYS SUB TH E30 FT TH N 13* 3' W 85.6 FT FOR POB TH N 82*30'E 316 FT TO SLY LN AARR TH N 54*35'0" W 417.7 FT ALG SD ROW LN TH S 13* 30'E 285.2 FT TO POB ALSO BEG 30FT E OF NE COR LOT 5 PETTYS SUB TH N 13*30'W 85.6 FT TH N 82*30'E 276 FT TH S 54*45'E 179 FT TH S 62FT TH W 387 FT TH N 07*30'W 48 FT TO POB	414,826.00	Occupied	6,541.57
15-22-300-034	Robert M. & Kelly R. Miller 5240 Redding Dr. Pinckney, MI 48169	SEC 22 T1N R5E COM AT SE COR OF SW 1/4 OF SW1/4 W 171 FT N 125 FT E 171 FT S 125 FT TO BEG	269,060.00	Occupied	6,541.57
15-22-300-035	Todd A. Weiss 5245 Redding Dr. Pinckney, MI 48169	SEC 22 T1N R5E BEG 125 FT N OF SE COR OF SW 1/4 OF SW 1/4 TH W 86 FT TH N 159.6 FT TO S END OF 20 FT CANAL TH W 10 FT ALG S EDGE OF CANAL, TH ALG CEN CANAL NELY TO ZUKEY LAKE TH ALG S EDGE OF LAKE TO PT N OF BEG TH S 315.1 FT TO POB	748,560.00	Occupied	6,541.57

**HAMBURG TOWNSHIP**  
**ZUKEY & REDDING DRIVE ROAD IMPROVEMENT PROJECT**  
**PROPOSED SPECIAL ASSESSMENT ROLL**  
**APRIL 16, 2024**

<b>Tax I.D. #</b>	<b>Property Owner Name &amp; Address</b>	<b>Legal Description</b>	<b>True Cash Value</b>	<b>Vacant/Occupied</b>	<b>Assessment</b>
15-22-300-036	Kenneth Raszka & Janice Keen-Raszka 1666 Knotty Pine North Port, FL 34288	SEC. 22 T1N R5E BEG 125 FT N & 86 FT W OF SE COR OF SW 1/4 OF SW 1/4 TH W 85 FT TH N 266.6 FT TH E TO CANAL TH SWLY ALG CEN OF CANAL TO S EDGE OF CANAL TH E 10 FT TH S 159.6 FT TO POB	\$ 442,878.00	Occupied	\$ 6,541.57
15-22-300-037	Dawn Nelson P.O. Box 441 Hamburg, MI 48139	SEC 22 T1N R5E BEG 171 FT W & 91.2 FT N OF SE COR OF SW 1/4 OF SW 1/4 OF SAID SEC TH N 32*42'W 143.1 FT TH N 17*08'W 115.2 FT TH E 49.5 FT TH S 10*7'E 54.7 FT TH N 74*43'E 54 FT TH S 191.6 FT TO POB	103,275.00	Occupied	6,541.57
15-22-300-038	Paul & Siobhan Durand 5195 Redding Dr. Pinckney, MI 48169	SEC 22 T1N R5E BEG 171 FT W & 282.8 FT N OF SE COR OF SW 1/4 OF SW1/4 TH S74*W 54 FT TH N10*W 54.7 FT TH N12*W 50 FT TH N74*E 74.8 FT TH S 108.8 FT TO POB	288,939.00	Occupied	6,541.57
15-22-300-039	Barbara A. Dicks P.O. Box 543 Lakeland, MI 48143	SEC 22 T1N R5E BEG 101 FT W & 391.6 FT N OF SE COR OF SW 1/4 OF SW 1/4 TH N 188.3 FT TO IRON PIPE ON S SHORE ZUKEY LAKE TH SELY ALG S SHORE OF LK TO W EDGE OF 20 FT CANAL. TH SWLY ALG W EDGE OF CANAL TO PT DUE E OF BEG TH W TO POB	929,996.00	Occupied	6,541.57
15-22-300-040	Edward Wachlarz 4745 Kingsley Dr. Warren, MI 48092	SEC 22 T1N R5E BEG 171 FT W & 391.6 FT N OF SE COR OF S W 1/4 OF SW 1/4 TH E 70 FT TH N 184.3 FT TO S SHORE ZUKEY LAKE TH ALG S SHORE 70.6 FT TH S 175 FT TO POB	398,511.00	Occupied	6,541.57

HAMBURG TOWNSHIP  
**ZUKEY & REDDING DRIVE ROAD IMPROVEMENT PROJECT**  
 PROPOSED SPECIAL ASSESSMENT ROLL  
**APRIL 16, 2024**

Tax I.D. #	Property Owner Name & Address	Legal Description	True Cash Value	Vacant/Occupied	Assessment
15-22-300-041	Glenn & Rosalinda Deline P.O. Box 194 Lakeland, MI 48143	SEC 22 T1N R5E BEG W 171 FT & N 566.6 FT FROM SE COR OF S W 1/4 OF SW 1/4 OF SEC TH S76*30' W 109.5 FT TH S12*E 175 FT TH NELY TO PT 175 FT S FROM BEG TH N 175 FT TO BEG EXC ROW 9.5 FT IN WIDTH ALG E SIDE OF LAND	\$ 821,494.00	Occupied	\$ 6,541.57
15-22-300-042	Amy Bennett 51840 Eva Macomb, MI 48042	SEC 22 T1N R5E BEG 341.5 FT W & 362.8 FT N FROM SE COR OF SW 1/4 OF SW 1/4 TH S 55*E 72.5 FT FOR POB TH E 49.5 FT TH N 12*W TO SHORE OF ZUKEY LAKETH WLY ALG SHORE OF LAKE 49.5 FT TH S 12*E 221 FT TO POB	784,838.00	Occupied	6,541.57
15-22-300-043	Elizabeth A. Winter Trust 9715 Zukey Dr. Pinckney, MI 48169	SEC 22 T1N R5E COM SE COR LOT 7 PETTY'S SUB TH N 89*59'58"E 30 FT FOR POB TH N 07*30'00"W 50.92 FT ALG ELY LN ZUKEY DR TH N 89*57'01"E 381.25 FT TH S 00*24'43" W 99.51 FT TH N 90*00'00"W 370 FT TO ELY LN ZUKEY DR TH N 04*30'00"W 49.5 FT TO POB	543,387.00	Occupied	6,541.57
15-22-300-044	Scott W. Taylor P.O. Box 159 Lakeland, MI 48143	SEC 22 T1N R5E COM SE COR OF SW 1/4 OF SW 1/4 TH W 248.5 FT TH N 211.5 FT TH N 65*26'W 173.8 FT TH N 5*37'W 73.9 FT FOR BEG TH N 17*15'W 134 FT TO SHORE OF ZUKEY LAKE TH N 64*45'E 86 FT ALG SHORE TH S 11*45'E 162 FT TH S 55*E 72.5 FT TH S 17*E 62.9 FT TH N 81*W 144.2 FT TH N 5*W 73.9 FT TO POB	538,900.00	Occupied	6,541.57

HAMBURG TOWNSHIP  
**ZUKEY & REDDING DRIVE ROAD IMPROVEMENT PROJECT**  
 PROPOSED SPECIAL ASSESSMENT ROLL  
**APRIL 16, 2024**

Tax I.D. #	Property Owner Name & Address	Legal Description	True Cash Value	Vacant/Occupied	Assessment
15-22-300-045	Randy M. & Catherine M. Layton 5157 Redding Dr. Pinckney, MI 48169	SEC 22 T1N R5E COM SE COR OF SW 1/4 OF SW 1/4 SAID SEC TH W 248.5 FT TH N 211.5 FT TH N 65*26'W 173.8 FT FOR POB TH N 28*48'57"W 195.58 FT TH N 56*56'51"E 55.14 FT TH S 17*15'00"E 133.76 FT TH S 06*29'23"E 74.17 FT TO POB 0.13 AC	\$ 672,015.00	Occupied	\$ 6,541.57
15-22-300-047	Joseph & Cathy Mazur 8991 Thornapple Pinckney, MI 48169	SEC 22 T1N R5E BEG AT PT W 422 FT & N 3*E 284.5 FT FROM SE COR OF SW 1/4 OF SW 1/4 TH S 49*15'W 149.5 FT TH N 69* 55'W 62.5 FT TH N 45*05'E 175.15 FT TH N 19*45'E 24 FT TH S 29*E 81.5 FT TO POB	438,139.00	Occupied	6,541.57
15-22-300-048	Jonathan B. Iras P.O. Box 7 Pinckney, MI 48169	SEC 22 T1N R5E COM SE COR OF SW 1/4 OF SW 1/4 OF SEC W 170.70 FT TH N 91.2 FT TH N 32*42'W 51.46 FT FOR POB TH N 32*42'W 91.64 FT TH N 17*08'W 52.3 FT TH N 81*20'W 144.2 FT TH S 49*15'W 149.5 FT TH S 30*08'E 62.9 FT TH E 289.7 FT TO POB 0.78 AC	476,411.00	Occupied	6,541.57
15-22-300-049	Michael & Mary C. Arsenault P.O. Box 78 Lakeland, MI 48143	SEC 22 T1N R5E BEG W 170.7 FT FROM SE COR OF SW 1/4 OF SW 1/4 OF SEC TH W 10.5 FT TH N 49.5 FT TH W 259.5 FT TH N 30*08'W 96.1 FT TH E 289.7 FT TH S 32*42'E 51.46 FT TH S 91.2 FT TO POB	494,853.00	Occupied	6,541.57
15-22-300-052	Kevin Keogh 5175 Redding Dr. Pinckney, MI 48169	SEC 22 T1N R5E BEG 341.3 FT W & 362.8 FT N FROM SE CO R OF SW 1/4 OF SW 1/4 OF SEC N 11*45' W 162 FT TO SHORE ZUKEY LAKE N 71* E 49.5 FT ALG SHORE ZUKEY LK S 12* E 221 FT N 55* W 72.5 FT TO POB	356,468.00	Occupied	6,541.57

HAMBURG TOWNSHIP  
**ZUKEY & REDDING DRIVE ROAD IMPROVEMENT PROJECT**  
 PROPOSED SPECIAL ASSESSMENT ROLL  
**APRIL 16, 2024**

Tax I.D. #	Property Owner Name & Address	Legal Description	True Cash Value	Vacant/Occupied	Assessment
15-22-300-053	Paul & Christy Stark 11 Ashley Ct. Rocky River, OH 44116	SEC 22 T1N R5E COM NE COR LOT 1 PETTYS SUB TH N13*30'00" W 25.10 FT TH S87*03'17" W 130.48 FT TH S87*03'17" W 8.22 FT TH N18* 10'20" W 150.18 FT TH N26*33'00" W 166.14 FT TH ALG CHD BRG S55*12'35" E 51.11 FT TH S 54*33'24" E 228.43 FT TH S14*19'10" E 126.54 FT TO POB .70 AC	\$1,158,100.00	Occupied	\$ 6,541.57
15-22-300-064	Angela McFadden 5151 Redding Dr. Pinckney, MI 48169	SEC 22 T1N R5E COM SE COR OF SW 1/4 OF SW 1/4 SAID SEC TH S 89*47'59"W 422 FT TH N 3*03'08"E 283.99 FT TH N 28*46'09"W 81.39 FT FOR POB TH S 20*37'33"W 23.98 FT TH S 45*05'00"W 175.17 FT TH N 69*23'53"W 43.32 FT TH N 04*53'37"E 69 FT TH N 16*53'37"E 81.50 FT TH N 40*14'54"E 126.10 FT TH S 28* 56'45"E 128.09 FT TO POB CONT 0.54 AC	1,064,229.00	Occupied	6,541.57
15-22-301-001	Stephen & Catherine L. Boston Living Trust P.O. Box 609 Lakeland, MI 48143	SEC 22 T1N R5E PETTYS SUBDIVISION LOT 1	1,125,231.00	Occupied	6,541.57
15-22-301-002	Stephen & Catherine L. Boston Living Trust P.O. Box 609 Lakeland, MI 48143	SEC 22 T1N R5E PETTYS SUBDIVISION LOT 2	454,267.00	Occupied	6,541.57
15-22-301-003	Richard M. & Elizabeth K. Beaudin P.O. Box 158 Hamburg, MI 48139	SEC 22 T1N R5E PETTYS SUBDIVISION LOT 3	358,508.00	Occupied	6,541.57

**HAMBURG TOWNSHIP**  
**ZUKEY & REDDING DRIVE ROAD IMPROVEMENT PROJECT**  
**PROPOSED SPECIAL ASSESSMENT ROLL**  
**APRIL 16, 2024**

<b>Tax I.D. #</b>	<b>Property Owner Name &amp; Address</b>	<b>Legal Description</b>	<b>True Cash Value</b>	<b>Vacant/Occupied</b>	<b>Assessment</b>
15-22-301-004	Paul R. & Jennifer M. Rohl P.O. Box 116 Lakeland, MI 48143	SEC 22 T1N R5E PETTYS SUBDIVISION LOT 4 EXC S 3 FT	\$ 382,006.00	Occupied	\$ 6,541.57
15-22-301-005	Jodi & Nicholas Graham 9669 Zukey Dr. Pinckney, MI 48169	SEC 22 T1N R5E PETTYS SUBDIVISION S 3 FT LOT 4 & N 1/2 LOT 5	236,990.00	Occupied	6,541.57
15-22-301-006	John T. & Michelle J. Lamb 9700 Zukey Dr. Pinckney, MI 48169	SEC 22 T1N R5E PETTYS SUBDIVISION LOT 6	622,630.00	Occupied	6,541.57
15-22-301-007	Marlo K. & Troy Scheff 9708 Zukey Dr. Pinckney, MI 48169	SEC 22 T1N R5E PETTYS SUBDIVISION LOTS 7 & 8	737,664.00	Occupied	6,541.57
15-22-301-008	William D. Miller Revocable Trust 910 E. Morris Rd. Palatine, IL 60074	SEC 22 T1N R5E PETTYS SUBDIVISION LOT 9	490,841.00	Occupied	6,541.57
15-22-301-009	William Moran P.O. Box 583 Lakeland, MI 48143	SEC 22 T1N R5E PETTYS SUBDIVISION LOT 11	345,022.00	Occupied	6,541.57
15-22-301-012	Nicholas & Jodi Graham 9669 Zukey Dr. Pinckney, MI 48169	SEC 27 T1N R5E S 1/2 LOT 5 PETTYS SUB	82,722.00	Vacant	6,541.57
15-22-301-013	Steven A. Williams 9732 Zukey Dr. Pinckney, MI 48169	SEC 22 T1N R5E P ETTYS SUB LOT 10 & INCLUDING COM 30 FT E O F SE COR OF LOT 10 OF PETTYS SUB E 382 FT TH N 49.5 FT TH W 382 FT TH S 49.5 FT TO POB	345,022.00	Occupied	6,541.57



**HAMBURG TOWNSHIP**  
**ZUKEY & REDDING DRIVE ROAD IMPROVEMENT PROJECT**  
**PROPOSED SPECIAL ASSESSMENT ROLL**  
**APRIL 16, 2024**

<b>Tax I.D. #</b>	<b>Property Owner Name &amp; Address</b>	<b>Legal Description</b>	<b>True Cash Value</b>	<b>Vacant/Occupied</b>	<b>Assessment</b>
15-22-302-001	Charles L. & Suzanne A. Kronk P.O. Box 294 Lakeland, MI 48143	SEC 22 T1N R5E ZUKEY WOODS BEG SW COR OF LOT 17 TH S 80*38'E 49 FT TH N 1*13'W 287.5 FT TH N 76*59'W 44.2 FT TO NW COR SAID LOT TH S 0*8'E 289.5 FT TO BEG	\$ 397,201.00	Occupied	\$ 6,541.57
15-22-302-002	Diane Reschke P.O. Box 192 Lakeland, MI 48143	SEC 22 T1N R5E BEG AT SE COR OF LOT 17 ZUKEY WOODS TH N 1*28'W 284.6 FT TH N 76*59'W 50 FT TH S 1*13'E 287.5 FT TH S 80*38'E 51 FT TO POB	756,394.00	Occupied	6,541.57
15-22-302-003	Pearl R. Monkiewicz 3838 SW 112th Street Ocala, FL 34476	SEC 22 T1N R5E BEG SW COR LOT 16 TH S80*E 51.8 FT TH N2*W 282 FT TH N76*W 49 FT TH S1*E 284.6 FT TO BEG	451,962.00	Occupied	6,541.57
15-22-302-004	Charles L. & Suzanne A. Kronk P.O. Box 294 Lakeland, MI 48143	SEC 22 T1N R5E ZUKEY WOODS SUB BEG SE COR LOT 16 TH N 3*8'W 280 FT TH N 76*59'W 48 FT TH S 2*8'E 282 FT TH S 80*38'E 52.2 FT TO BEG	471,261.00	Occupied	6,541.57
15-22-302-007	Charles L. & Suzanne A. Kronk P.O. Box 294 Lakeland, MI 48143	SEC 22 T1N R5E ZUKEY WOODS BEG SW COR LOT 14 TH S80*E 29.1 FT TH N60*E 23 FT TH N5*W 258 FT N76*W 53.1 FT THE S 5*E 276.5 FT TO POB	680,962.00	Occupied	6,541.57
15-22-302-009	David & Marianne Dauer 3206 Stone Wall Rd. Maumee, OH 43537	SEC 22 T1N R5E ZUKEY WOODS BEG SE COR LOT 14 TH N 13*18'W 221.9 FT TH S 72*32'W 35.5 FT TH N 76*59'W 12.2 FT TH S 5*8'E 250.4 FT TH N 60*52'E 84.5 FT TO BEG	440,750.00	Occupied	6,541.57

**HAMBURG TOWNSHIP**  
**ZUKEY & REDDING DRIVE ROAD IMPROVEMENT PROJECT**  
**PROPOSED SPECIAL ASSESSMENT ROLL**  
**APRIL 16, 2024**

<b>Tax I.D. #</b>	<b>Property Owner Name &amp; Address</b>	<b>Legal Description</b>	<b>True Cash Value</b>	<b>Vacant/Occupied</b>	<b>Assessment</b>
15-22-302-010	Patrick & Kimberly Fuller P.O. Box 750 Lakeland, MI 48143	SEC 22 T1N R5E ZUKEY WOODS BEG SW COR LOT 13 TH N 60*52'E 48 FT TH N 16*28'W 211.5 FT TH S 72*32'W 34 FT TH S 13*18'E 221.9 FT TO BEG	\$ 483,436.00	Occupied	\$ 6,541.57
15-22-302-014	Richard Desana 9934 Zukey Dr. Pinckney, MI 48169	SEC 22 T1N R5E COM SW COR OF LOT 11 ZUKEY WOODS TH N 60*52'E 59.4 FT TH N 39*30' W 181.8 FT TH S 72*32'W 35.5 FT TH S 31*38'E 186.2 FT TO POB	364,642.00	Occupied	6,541.57
15-22-302-017	James E. Merchant P.O. Box 872 Lakeland, MI 48143	SEC 22 T1N R5E ZUKEY WOODS BEG NE COR LOT 10 TH N 56*10'W 175 FT TH S 40*47'W 47 FT TH S 52*4'E 175.3 FT TH N 38*58'E TO BEG	593,937.00	Occupied	6,541.57
15-22-302-018	Susan & David Smith P.O. Box 735 Lakeland, MI 48143	SEC 22 T1N R5E BEG SE COR LOT 9 ZUKEY WOODS TH N 38*58'E 61.5 FT TH N 61*47'W 183.8 FT TH S 30*19'W 47 FT TH S 56*40'E 175 FT TO POB	695,723.00	Occupied	6,541.57
15-22-302-021	Matthew & Lauren Carlisle P.O. Box C Lakeland, MI 48143	SEC 22 T1N R5E ZUKEY WOODS SUB BEG NE COR LOT 8 TH N 67*49'W 194.5 FT TH S 22*44'W 49.2 FT TH S 67*30'E 187 FT TH N 31*5'E 51 FT TO BEG	522,691.00	Occupied	6,541.57
15-22-302-022	Joleen Bowman & Thelma J. Dasho 9862 Zukey Dr. Pinckney, MI 48169	SEC 22 T1N R5E ZUKEY WOODS BEG SE COR LOT 7 TH N 18*35'E 60 FT TH N 71*W 190.8 FT TH S 22*44'W 49.5 FT TH S 67*49' E 194.5 FT TO BEG	846,512.00	Occupied	6,541.57
15-22-302-023	David A. & Deborah A. Abramson P.O. Box 513 Lakeland, MI 48143	SEC 22 T1N R5E ZUKEY WOODS BEG NE COR LOT 7 TH N 71*51'W 187 FT TH S 22*44'W 49 FT TH S 71*E 1 90.8 FT TH N 18*35'E 52.5 FT TO BEG	746,456.00	Occupied	6,541.57

HAMBURG TOWNSHIP  
**ZUKEY & REDDING DRIVE ROAD IMPROVEMENT PROJECT**  
 PROPOSED SPECIAL ASSESSMENT ROLL  
**APRIL 16, 2024**

Tax I.D. #	Property Owner Name & Address	Legal Description	True Cash Value	Vacant/Occupied	Assessment
15-22-302-024	Virginia W. Bryant Trust 905 Madison St. Brighton, MI 48116	SEC 22 T1N R5E ZUKEY WOODS BEG SE COR LOT 6 TH N 18*35'E 46 FT TH N 71* 35'W 190.8 FT TH S 13*49'W 47.3 FT TH S 71*51'E 187 FT TO BEG	\$ 472,951.00	Occupied	\$ 6,541.57
15-22-302-025	Andrew J. & Marlene E. Miller 4680 Huntington Dr. Brighton, MI 48116	SEC 22 T1N R5E ZUKEY WOODS BEG NE COR LOT 6 TH N 73*50'W 182 FT TH S 13* 49'W 47.3 TH S 71*35'E 190.8 FT TH N 5*10' E 55.6 FT TO BEG	339,455.00	Occupied	6,541.57
15-22-302-026	David & Jennifer Chopp 9830 Zukey Dr. Pinckney, MI 48169	SEC 22 T1N R5E ZUKEY WOODS BEG SE COR LOT 5 TH N 5*10'E 77.5 FT TH N 77* 23'W 170 FT TH S 13*49'W 65.8 FT TH S 73*50'E 182 FT TO BEG	1,261,200.00	Occupied	6,541.57
15-22-302-027	Michael R. & Susan E. Tomes Trust 7015 Whittlebury Trail Bradenton, FL 34202	SEC 22 T1N R5E ZUKEY WOODS THAT PART LOTS 4 & 5 BEG NE COR LOT 4 TH S 1*08' E 31 FT FOR POB TH N 85*11' W 158.96 FT TH S 4*40' E 25 FT TH S 13*49' W 54.2 FT TH S 13*49' W 18.5 FT TH S 77* 12' E 170.62 FT TH N 5*10' E 22.5 FT TH N 5*10' E 67 FT TH N 1*08' W 31 FT TO POB	728,859.00	Occupied	6,541.57
15-22-302-030	James & Cynthia J. Maratta P.O. Box 572 Lakeland, MI 48143	SEC 22 T1N R5E ZUKEY WOODS BEG AT SE COR LOT 4 TH N 1*08'W 112 FT TH N 87*37'W 163 FT TH S 4*40'E 100 FT TH S 83*08'E 157.9 FT TO POB	679,900.00	Occupied	6,541.57
15-22-302-031	Kathleen Masinda P.O. Box 339 Lakeland, MI 48143	SEC 22 T1N R5E ZUKEY WOODS BEG NE COR LOT 3 TH N 87*42'W 166 FT TH S 04* 40'E 50 FT TH S 87*37'E 163 FT TH N 01* 08'W 50 FT TO BEG	617,939.00	Occupied	6,541.57

**HAMBURG TOWNSHIP**  
**ZUKEY & REDDING DRIVE ROAD IMPROVEMENT PROJECT**  
**PROPOSED SPECIAL ASSESSMENT ROLL**  
**APRIL 16, 2024**

<b>Tax I.D. #</b>	<b>Property Owner Name &amp; Address</b>	<b>Legal Description</b>	<b>True Cash Value</b>	<b>Vacant/Occupied</b>	<b>Assessment</b>
15-22-302-032	Kathleen M. Sheehan 9778 Zukey Dr. Pinckney, MI 48169	SEC 22 T1N R5E ZUKEY WOODS BEG SE COR LOT 2 TH N1*W 56 FT TH N89*W 169 FT TH S4*E 50 FT TH S87*E 166 FT TO BEG	\$ 666,750.00	Occupied	\$ 6,541.57
15-22-302-034	Joyce Stimmell & Elizabeth Hodges 10207 Ni River Dr. Spotsylvania, VA 22553	SEC 22 T1N R5E ZUKEY WOODS BEG NE COR LOT 2 TH S87*27' W 109.7 FT S4*40'E 50 FT TH S89*51'E 101 FT TH N 2*15'E 55 FT TO POB	363,401.00	Occupied	6,541.57
15-22-302-037	William E. Moran P.O. Box 583 Lakeland, MI 48143	SEC 22 T1N R5E ZUKEY WOODS BEG SW COR LOT 18 TH N89*E 45 FT TH N1*W 139.5 FT TH W 47.8 FT TO NW COR SD LOT TH S4*E 49.6 FT TH S1*E 90 FT TO POB	230,810.00	Occupied	6,541.57
15-22-302-041	Patrick Curley P.O. Box 297 Lakeland, MI 48143	SEC 22 T1N R5E ZUKEY WOODS SUB LOT 1	521,086.00	Occupied	6,541.57
15-22-302-042	James A. Collins P.O. Box 125 Lakeland, MI 48143	SEC 22 T1N R5E ZUKEY WOODS SUB LOT 19 ALSO BEG SE COR LOT 18 TH N1*W 139.5 FT W 45 FT TH S1*E 139.5 FT & N89* E 45 FT TO POB	290,536.00	Occupied	6,541.57
15-22-302-043	Jeffrey L. Young P.O. Box 512 Lakeland, MI 48143	SEC 22 T1N R5E ZUKEY WOODS BEG SE COR LOT 15 TH N5*W 276.5 FT TH N76* W 95.5 FT TH S03*E 280 FT TH S80*E 105 FT TO POB	569,432.00	Occupied	6,541.57
15-22-302-044	Douglas A. Bopp 26338 Hidden Valley Ct. Farmington Hills, MI 48331	SEC 22 T1N R5E ZUKEY WOODS THAT PART LOTS 12 & 13 BEG SW COR LOT 13 TH N 60*52'E 73 FT TH N 20*8' W 195 FT TH S 7 2*32' W 50.65 FT TH S 16*28' E 211.5 FT TO POB	326,155.00	Occupied	6,541.57

HAMBURG TOWNSHIP  
**ZUKEY & REDDING DRIVE ROAD IMPROVEMENT PROJECT**  
 PROPOSED SPECIAL ASSESSMENT ROLL  
**APRIL 16, 2024**

Tax I.D. #	Property Owner Name & Address	Legal Description	True Cash Value	Vacant/Occupied	Assessment
15-22-302-045	Glenn S. Lieckfield P.O. Box 52 Lakeland, MI 48143	SEC 22 T1N R5E ZUKEY WOODS THAT PART LOT 12 BEG SE COR LOT 12 TH N 31*38'W 186.2 FT TH S 72* 32' W 51.65 FT TH S 24*41'E 202 TH N 60*52' E 82 FT TO POB	\$ 438,141.00	Occupied	\$ 6,541.57
15-22-302-046	Joseph & Ann M. Szalony P.O. Box 753 Lakeland, MI 48143	SEC 22 TIN R5E ZUKEY WOODS SUB BEG SE COR LOT 8 TH N 31*50'E 67 FT TH N 67*30'W 187 FT TH S 30*19'W 96.4 FT TH S 61*47'E 183.8 FT TH N 31*51'E 48 FT TO POB	656,796.00	Occupied	6,541.57
15-22-302-047	John M. & Pennie Bresette 4350 W. Ellsworth Ann Arbor, MI 48103	SEC 22 T1N R5E ZUKEY WOODS SUB PART LOT 10 & PART LOT 11 BEG NE COR SD LOT 11 TH ALG WLY LN ZUKEY DR S 38*58'00"W 59.59 FT TH N 39*29'41" W 181.78 FT TO T RAV PT A TH N 39*29' 41"W 27.6 FT TO WTRS EDGE ZUKEY LAKE TH NELY ALG WTRS EDGE 76.2 FT TH S 51*50'31"E 19.5 FT TO TRAV PT B SD PT BEING N 40*52'16"E 81.23 FT FROM PT A TO PT B TH S 51*50'31"E 175.42 FT TO PT ON WLY LN ZUKEY DR TH S 38*58'00" W 60.43 FT TO POB CONT .45 AC	490,442.00	Occupied	6,541.57

Total Project Assessments:       \$ 399,035.65

TOTAL ESTIMATED PROJECT COST:       \$ 399,035.65

**Resolution #5 – Zukey & Redding Drive Road Improvement Project**

**TOWNSHIP OF HAMBURG**

At a regular meeting of the Township Board of the Township of Hamburg, Livingston County, Michigan (the “Township”) held at the Hamburg Township Hall Meeting Room on Tuesday, April 16<sup>th</sup>, 2024, beginning at 7:00 p.m. Eastern Time, there were:

PRESENT: \_\_\_\_\_

ABSENT: \_\_\_\_\_

The following preamble and resolution were offered by \_\_\_\_\_ and seconded by \_\_\_\_\_.

**RESOLUTION CONFIRMING SPECIAL ASSESSMENT ROLL FOR THE ZUKEY & REDDING DRIVE ROAD IMPROVEMENT PROJECT**

WHEREAS, the Township Board of Trustees (the “Township Board”) has determined that it is desirable to act favorably upon the request of the property owners to finance the construction of certain road improvements for their private roads, to be completed by a Contractor hired by the property owners, within the Township as described in Exhibit A (the “Project”);

WHEREAS, the Township Board has tentatively determined to finance the cost of the Project by issuing bonds (the “Bonds”), in accordance with Act No. 188, Michigan Public Acts of 1954, as amended (“Act 188”);

WHEREAS, the Township Board has determined to use Special Assessments levied under Act 188 to raise the funds to pay the Township’s obligations on the Bonds;

WHEREAS, the Special Assessment District for the Project has been determined by the Township Board;

WHEREAS, the Township Board has directed the Township Supervisor to prepare the proposed Special Assessment Roll;

WHEREAS, the Township Supervisor has prepared the proposed Special Assessment Roll and has filed the proposed Special Assessment Roll with the Township Clerk;

WHEREAS, the Township Board has scheduled a public hearing on the proposed Special Assessment Roll and notice of the hearing has been properly provided; and

WHEREAS, the Township Board conducted the public hearing on the proposed Special Assessment Roll on April 16, 2024.

NOW, THEREFORE, BE IT RESOLVED THAT:

1. Roll Confirmation. In accordance with Act No. 188, Michigan Public Acts of 1954, as amended, and the laws of the State of Michigan, the Township Board hereby confirms the Special Assessment Roll for the Hamburg Township Zukey & Redding Drive – Road Improvement Special Assessment District (the “Roll”). The estimated cost of the Project is subject to quarterly periodic redetermination of costs, without further notice, pursuant to MCL 41.724(4).

2. Future Installments – Principal. The Township Board determines that each Special Assessment may be paid in 10 equal installments. The first installment shall be due on December 1, 2024. Each subsequent installment shall be due at intervals 12 months from the due date of the first installment.

3. Future Installments – Interest. All unpaid installments shall bear interest, payable annually on each installment due date, at a rate equal to one percent (1%) above the average interest rate on the Township Bonds sold to finance the Project. Interest on such unpaid installments shall accrue from the first day of the month in which interest starts to accrue on such Township bonds.

4. Warrant. The Township Clerk is hereby directed to attach a warrant (in the form of Exhibit B to this resolution) to the Roll and to deliver such warrant and the Roll to the Township Treasurer, who shall thereupon collect the special assessments in accordance with the terms of this Resolution, the Township Clerk’s warrant and the statutes of the State of Michigan.

5. Ratification of Notice. The form and content of the notice published and mailed to property owners in the Special Assessment District by the Township Clerk with respect to the public hearing held on April 16, 2024 and all action of Township officials in scheduling such hearing, are hereby approved, ratified and confirmed.

6. Inconsistent Prior Resolutions. All previously adopted resolutions that are in conflict with this resolution are replaced to the extent of such conflict.

A vote on the foregoing resolution was taken and was as follows:

YES: \_\_\_\_\_

NO: \_\_\_\_\_

ABSENT: \_\_\_\_\_

Resolution declared \_\_\_\_\_.

CLERK'S CERTIFICATE

The undersigned, being the Clerk of the Township, hereby certifies that (1) the foregoing is a true and complete copy of a resolution duly adopted by the Township Board at a regular meeting at which meeting a quorum was present and remained throughout, (2) the original thereof is on file in the records in my office, (3) the meeting was conducted, and public notice thereof was given, pursuant to and in full compliance with the Open Meetings Act (Act No. 267, Public Acts of Michigan, 1976, as amended) and (4) minutes of such meeting were kept and will be or have been made available as required thereby.

---

Michael Dolan  
Hamburg Township Clerk



## **EXHIBIT A**

### **DESCRIPTION OF PROJECT**

In preparation for the anticipated road improvements, the project shall begin with tree removal services including cutting and road clearing as quoted by the property owner's selected Contractor. The project shall consist of the Contractor providing traffic control cones and flaggers as required. The Contractor shall then excavate and haul off the excess existing road surface gravel/millings to allow for smooth transitions and drainage. Contractor will proof roll the existing aggregate base to confirm stability and then shall fine grade and re-compact the existing gravel/millings in preparation for the new paving. The Contractor will then construct a final compacted four-inch (4") thick hot mixed asphalt (HMA) surface for the roads with a 2" 13A leveling course (~863 tons) and a 2" 36A topping course (~863 tons). Property Owners have also included additional funds for the project to cover any necessary road testing and/or engineering services as well as any required road grade repairs not anticipated in the initial road improvement bid. The street rehabilitation shall serve those properties on Zukey Drive and Redding Drive located in the Township that are within the boundaries indicated on the attached map.

Zukey & Redding Drive Road Improvement Project  
Hamburg Township, Livingston County, Michigan



FAX (810) 231-4295  
TELEPHONE: (810) 231-1000



P.O. Box 157  
10405 Merrill Road  
Hamburg, MI 48139

---

**EXHIBIT B**

**WARRANT**

TO: Treasurer  
Hamburg Township  
Livingston County, Michigan

I certify that attached to this Warrant is a true copy of the Special Assessment Roll confirmed by the Township Board of the Township of Hamburg on April 16, 2024 (the "Confirming Resolution"). You are hereby directed to proceed to collect the amounts due on such roll in accordance with this Warrant, the Confirming Resolution and the statutes of the State of Michigan.

---

Michael Dolan  
Hamburg Township Clerk