



Aqua-Weed Control Inc.
 414 Hadley St
 Holly, MI 48442
 (248) 634-8388
 www.aquaweed.com

Invoice

BILL TO
 Chain of Lakes
 C/o Progressive AE
 Jared Laughlin
 1811 4 Mile Rd. NE
 Grand Rapids, MI 49525
 Grand Rapids, MI 49525

SHIP TO
 Chain of Lakes
 C/o Progressive AE
 Jared Laughlin
 1811 4 Mile Rd. NE
 Grand Rapids, MI 49525
 Grand Rapids, MI 49525

INVOICE #	DATE	TOTAL DUE	DUE DATE	TERMS	ENCLOSED
21745	08/21/2024	\$10,190.00	10/05/2024	Net 30	

DATE	DESCRIPTION	QTY	RATE	AMOUNT
08/20/2024	(1.25) acres treated using Chelated Copper Herbicides for control of eel grass and/or naiads.	1.25	295.00	368.75
	(1.5) acres treated using AquaStrike for control of curlyleaf pondweed and other pondweeds.	1.50	425.00	637.50
	(10.75) acres treated using Flumioxazin for control of various weeds.	10.75	245.00	2,633.75
	(58.5) PDU's of ProcellaCOR for control of Milfoil.	58.50	80.00	4,680.00
	(17) acres treated using SeClear for control of Algae.	17	110.00	1,870.00

SUBTOTAL 10,190.00
 TAX (6%) 0.00
 TOTAL 10,190.00
BALANCE DUE \$10,190.00

GL CODE _____
 APPROVED _____

ENTERED _____
 DUE DATE _____

Thank you for your business. Please make your check payable to "Aqua-Weed Control Inc." Please call (248) 634-8388 if you have any questions. When purchasing product, please follow all product label directions carefully. A permit may be required before treatment, contact your local DNR/DEQ for information including permit forms.

Zukey, Strawberry, Gallagher

Aquatic Herbicide Treatment

Payment Submittal Form

Date of treatment: **8/20/2024**

Shade, color, or hatch area(s) on attached map for each chemical. Show your shading, coloring, or hatching scheme here:

CHEMICAL USED	METHOD OF APPLICATION	RATE OF APPLICATION (ex. 100 lbs/acre, 2.6 lbs/acre-foot)	TREATMENT AREA SIZE (acres)	TOTAL AMOUNT (ex. 4 gallons, 10 lbs.)	FOR CONTROL OF: (Plant and/or Algae names)
<input type="checkbox"/> Chemical Brand: Komeen Generic Name: Chelated Copper Herb.	Surface Spray & Subsurface Injection	3.29 gal acre-foot	1.25 acre 3 ft avg depth	12.35 gal	Vallisneria
<input type="checkbox"/> Chemical Brand: AquaStrike Generic Name: dothal and Diquat Dibrom	Surface Spray & Subsurface Injection	1.33 gal acre-foot	1.5 acre 3 ft avg depth	6.00 gal	Potamogetons
<input type="checkbox"/> Chemical Brand: Propeller Generic Name: Flumioxazin	Dissolving, then Spray / Injection	0.82 lbs acre-foot	10.75 acre 3 ft avg depth	26.60 lbs	Starry Stonewort
<input type="checkbox"/> Chemical Brand: ProcellaCOR EC Generic Name: Florypraudfen-Benzyl	Surface Spray & Subsurface Injection	9.89 oz acre-foot	6.25 acre 3 ft avg depth	185.45 oz	Eurasian Milfoil
<input type="checkbox"/> Chemical Brand: Secler G Generic Name: Copper Sulfate	Dissolving, then Spray / Injection	6.67 lbs acre-foot	17 acre 3 ft avg depth	340.00 lbs	Starry Stonewort
<input type="checkbox"/> Chemical Brand: Generic Name:					
<input type="checkbox"/> Chemical Brand: Generic Name:					

Signature of applicator: _____

CASEY THOMPSON

 CASEY THOMPSON (printed)

Complete all portions of this document, including treatment map, and send with invoice to:

Water Resources Department
 Progressive AE
 1811 4 Mile Road, NE
 Grand Rapids, MI 49525-2442

= 1 ACRE



GALLAGHER ISLAND CANALS AND CONNECTOR LIVINGSTON COUNTY, MICHIGAN

TREATMENT MAP

SURVEY DATE: AUGUST 05, 2024



Treatment
 SeClear G @ 20 lbs/acre (algae) = 6 acres

LAKE AREA = 21 ACRES
 REVISION DATE: FEBRUARY 2022

The applicator shall make adjustments, if needed, to comply with EGLE permit requirements.

**GALLAGHER LAKE
LIVINGSTON COUNTY, MICHIGAN
TREATMENT MAP
SURVEY DATE: AUGUST 05, 2024**

□ = 1 ACRE

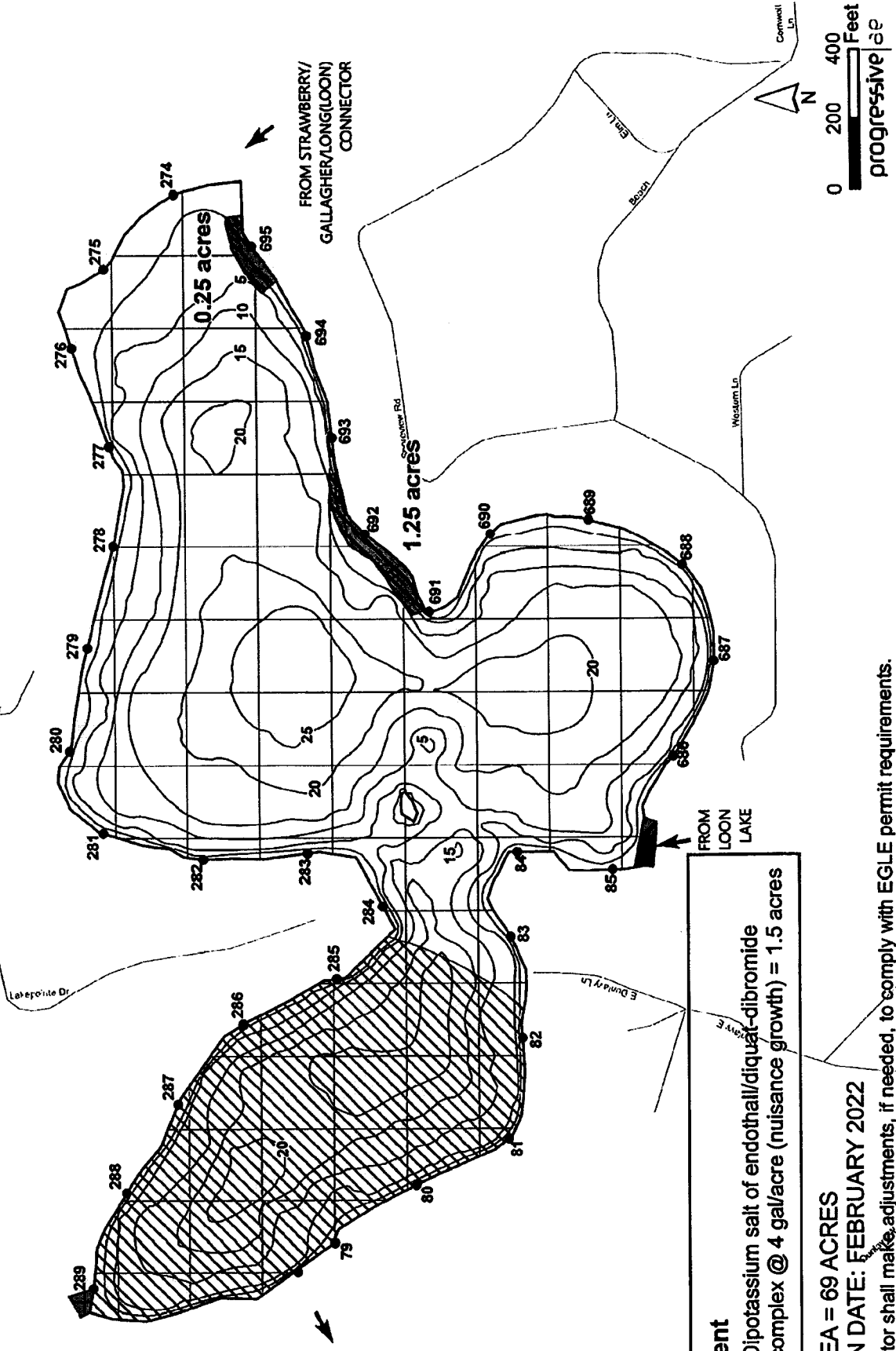

Treatment
 Dipotassium salt of endothall/diquat-dibromide complex @ 4 gal/acre (nuisance growth) = 1.5 acres

LAKE AREA = 69 ACRES
 REVISION DATE: FEBRUARY 2022
 The applicator shall make adjustments, if needed, to comply with EGLE permit requirements.

= 1 ACRE

LONG (LOON) LAKE LIVINGSTON COUNTY, MICHIGAN TREATMENT MAP

SURVEY DATE: AUGUST 05, 2024

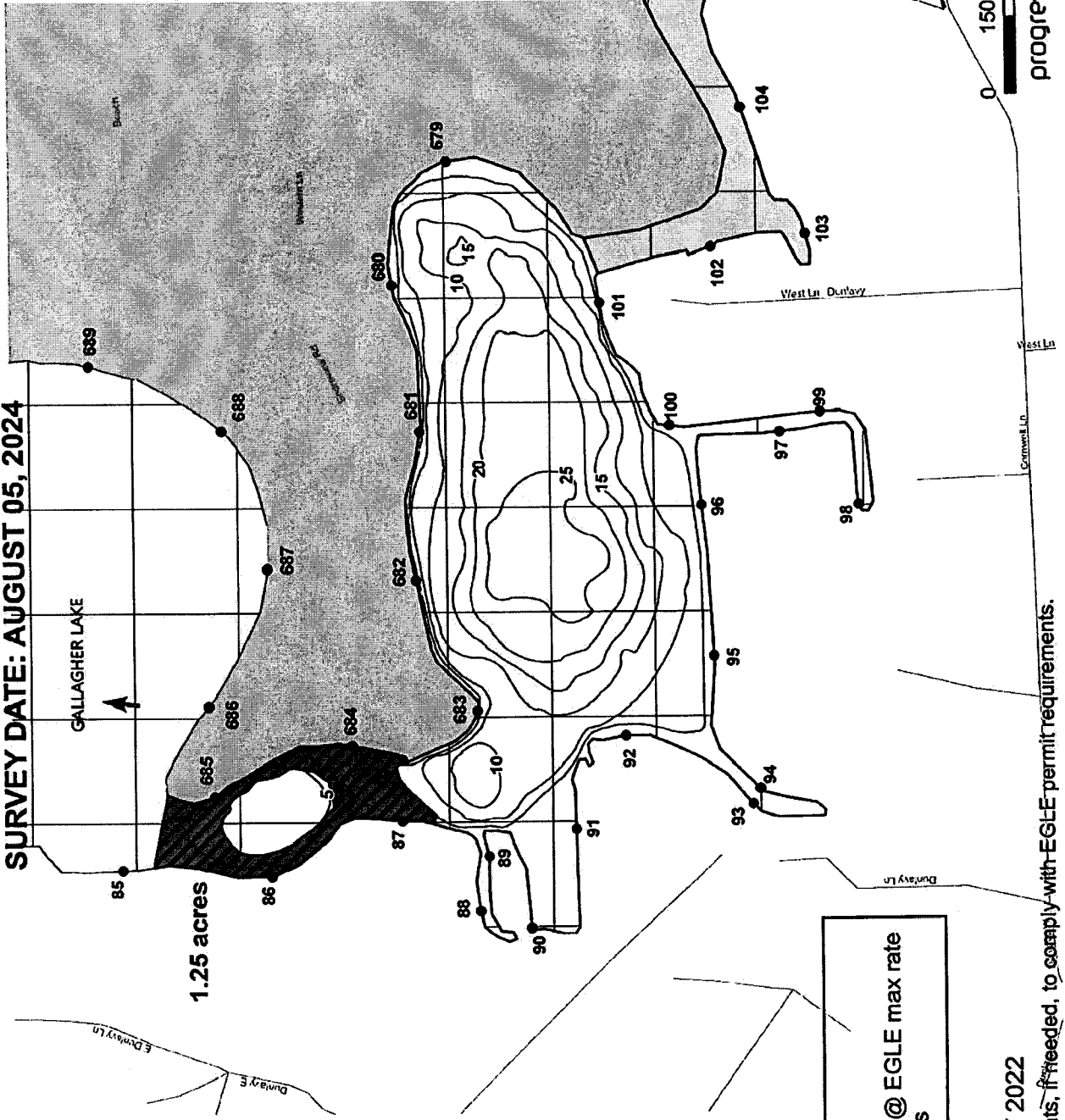

1.25 acres

Treatment
 ■ Chelated Copper Liquid @ EGLE max rate
 (wild celery) = 1.25 acres

LAKE AREA = 17 ACRES
 REVISION DATE: FEBRUARY 2022

The applicator shall make adjustments, if needed, to comply with EGLE permit requirements.

**STRAWBERRY/GALLAGHER/LONG(LOON) CONNECTOR
LIVINGSTON COUNTY, MICHIGAN**

TREATMENT MAP

SURVEY DATE: AUGUST 05, 2024

□ = 1 ACRE

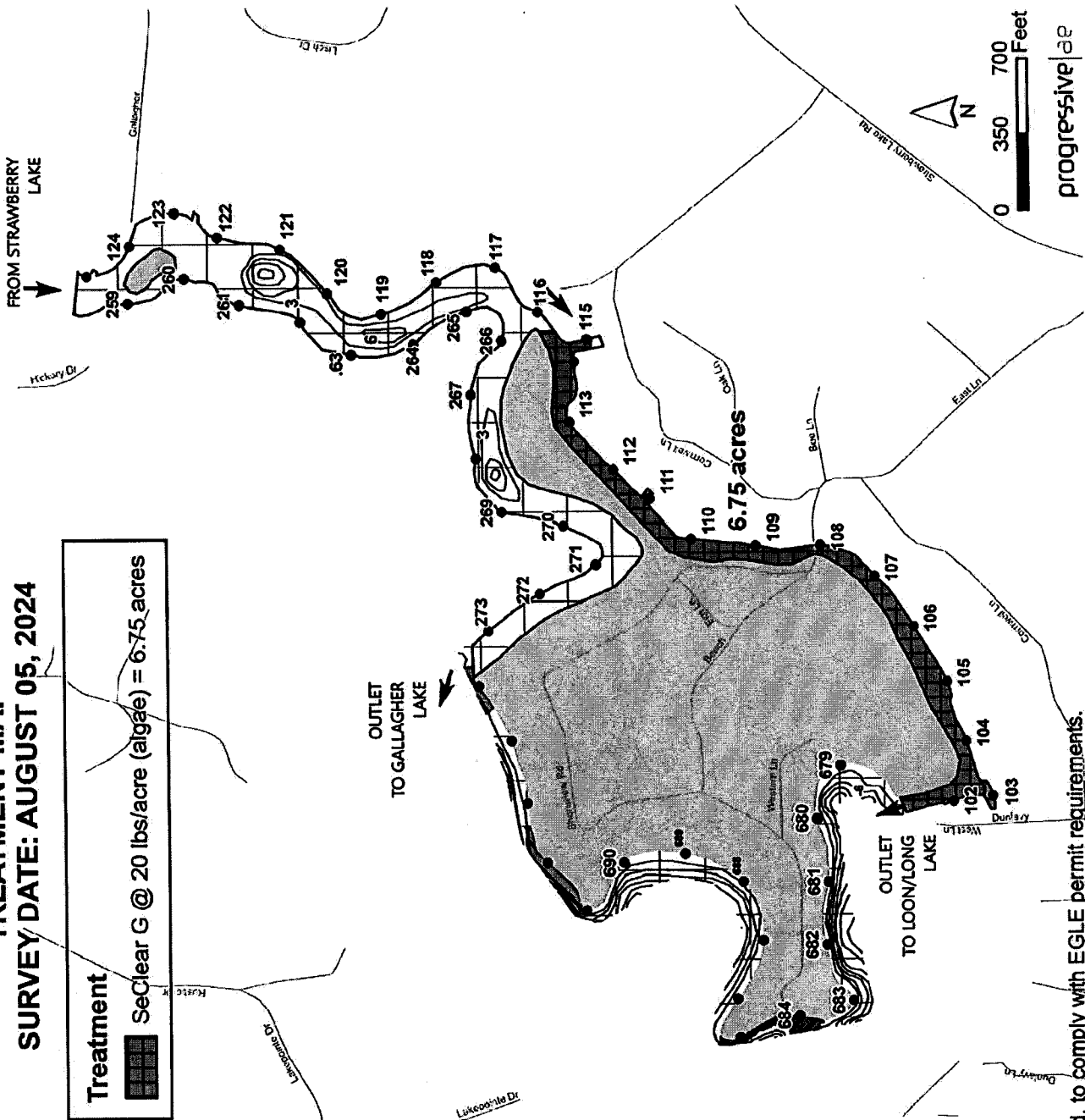

Treatment



SeClear G @ 20 lbs/acre (algae) = 6.75 acres

**LAKE AREA: 25 ACRES
REVISION DATE: FEBRUARY 2022**

The applicator shall make adjustments, if needed, to comply with EGLE permit requirements.

**STRAWBERRY LAKE
LIVINGSTON COUNTY, MICHIGAN
TREATMENT MAP**

SURVEY DATE: AUGUST 7TH, 2024

□ = 1 ACRE

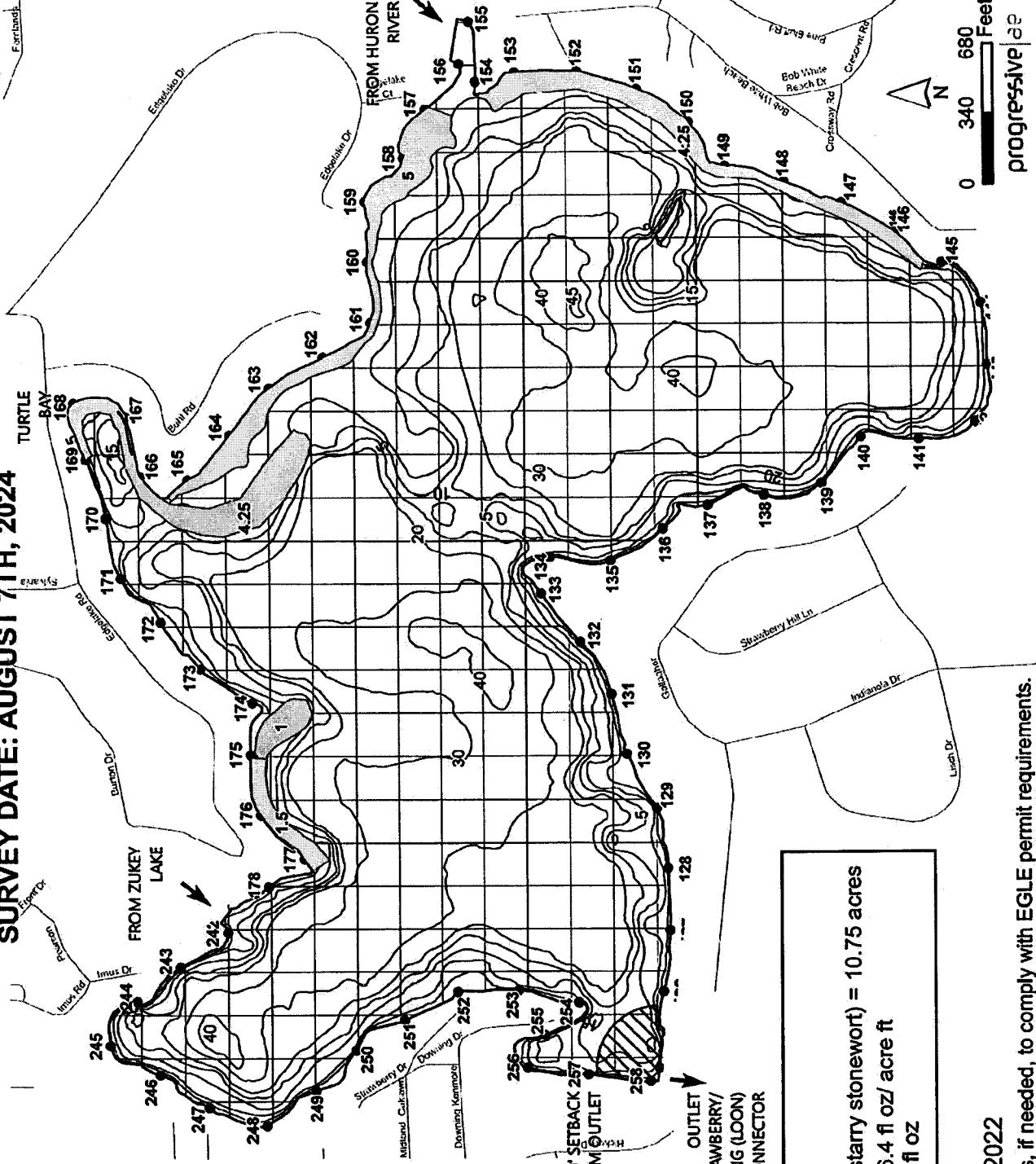

Treatment

- Flumioxazin @ 150 ppb (starry stonewort) = 10.75 acres
- Florpyrauxifen-benzyl @ 6.4 fl oz/ acre ft (milfoil) = 5.25 acres, 168 fl oz

**LAKE AREA: 255 ACRES
REVISION DATE: FEBRUARY 2022**

The applicator shall make adjustments, if needed, to comply with EGLE permit requirements.

□ = 1 ACRE

**ZUKEY LAKE
LIVINGSTON COUNTY
TREATMENT MAP
SURVEY DATE: AUGUST 7TH, 2024**

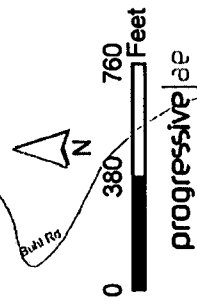
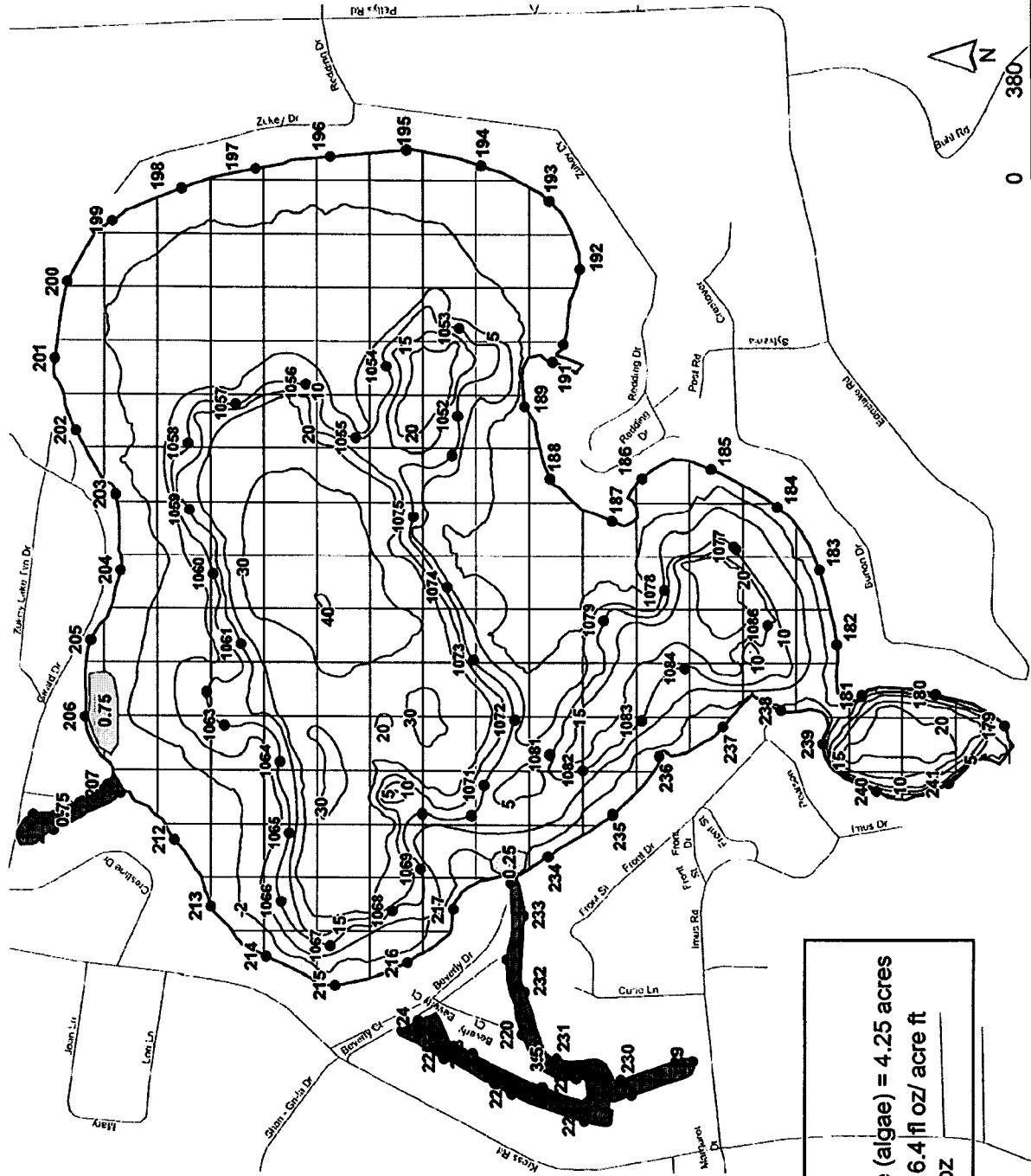

Treatment

- SeClear G @ 20 lbs/acre (algae) = 4.25 acres
- ▨ Florpyrauxifen-benzyl @ 6.4 fl oz/ acre ft (milfoil) = 1 acre, 19.2 fl oz

**LAKE AREA = 153 ACRES
REVISION DATE: FEBRUARY 2022**

The applicator shall make adjustments, if needed, to comply with EGLE permit requirements.

progressive | a e

